

ALLEY BETWEEN 4TH & 5TH STS.			
ITEM	ESTIMATE OF QUANTITIES	AMOUNT	UNIT
1	EXCAVATION	138	CU. YD.
2	AC. PAVING	955	SQ. YD.
3	ALLEY CURB	17	LN. FT.
4	ALLEY GUTTER	62	SQ. FT.
5	REMOVE CURB	3	LN. FT.

ALLEY BETWEEN OGDEN & STEWART AVES.			
ITEM	ESTIMATE OF QUANTITIES	AMOUNT	UNIT
1	EXCAVATION	275	CU. YD.
2	AC. PAVING	755	SQ. YD.
3	ALLEY CURB	29	LN. FT.
4	ALLEY GUTTER	62	SQ. FT.
6	REMOVE & REPLACE SIDEWALK	40	SQ. FT.

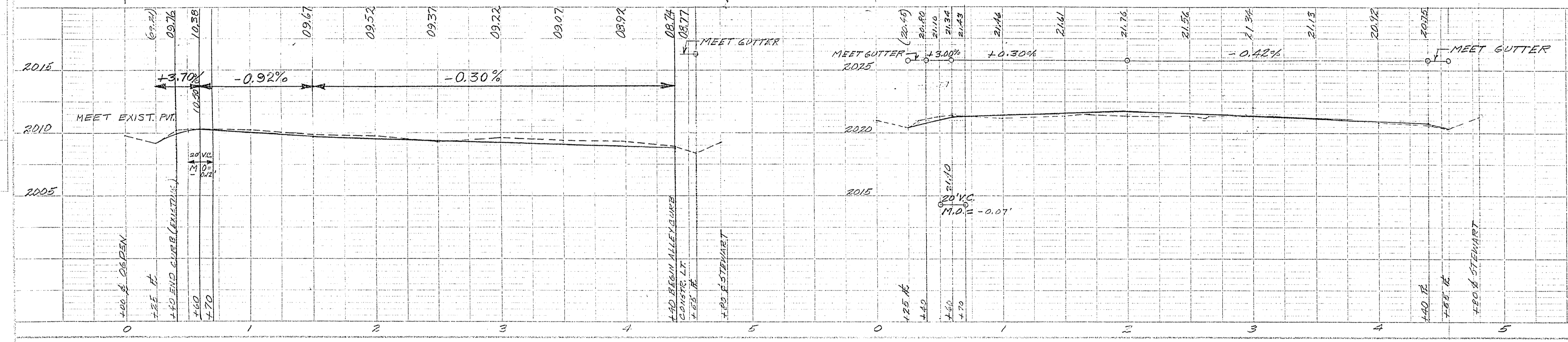

PLAN
 SCALE: 1" = 40'
 DATE: 11/18/54
 DRAWN BY: K.CRAWFORD
 CHECKED BY: K.CRAWFORD
 APPROVED BY: K.CRAWFORD

PROFILE
 SCALE: 1" = 10'
 DATE: 11/18/54
 DRAWN BY: K.CRAWFORD
 CHECKED BY: K.CRAWFORD
 APPROVED BY: K.CRAWFORD

C-18-57

CITY OF LAS VEGAS, NEVADA
ENGINEERING DEPT.

ALLEYS - OGDEN TO STEWART
Between 4th & 5th BLDG. Between 1st & MAIN

DESIGNED BY K.CRAWFORD	DATE 11-18-54	SCALE 1" = 20' HORIZ. 1" = 10' VERT.
DRAWN BY K.CRAWFORD	FIELD BOOK NO. 87-5	WORK ORDER NO. 497
CHECKED BY KCH	11/18/54	DRAWING NO.
APPROVED BY [Signature]	10/18	108-V-43