

PROJECT BENCHMARK
 DATUM: NORTH AMERICAN VERTICAL DATUM OF 1988 (NAVD88)
 CITY OF LAS VEGAS BENCHMARK: BLV99-13SE5
 NAVD88 ELEVATION: 869.606 METERS (2853.03 FEET)
 RIVET AND PLATE IN CONCRETE CYLINDER NW CORNER OF HUALAPAI AND ELKHORN
 NOTE: WHEN THE SURVEYING FOR THIS PROJECT BEGAN, THE ABOVE REFERENCED BENCHMARK BLV99-13SE5 WAS NOT PUBLISHED. THE BASIS FOR THE DATUM FOR THIS PROJECT IS SHOWN ON RECORD OF SURVEY FILE 124 PAGE 94, CLARK COUNTY BENCHMARK 1000-8N6, WHICH AT THE TIME OF THE ORIGINAL SURVEY (PRIOR TO THE CURRENT 2003 COUNTY BENCHMARK PUBLISHING) HAD AN ELEVATION OF 2584.61 FEET. TO CONVERT THE CURRENT CITY OF LAS VEGAS BENCHMARK BLV99-13SE5 TO MATCH THE ORIGINAL PROJECT DATUM, 0.34' NEEDS TO BE ADDED TO THE ELEVATION OF 2853.03 FEET.

BASIS OF BEARINGS
 THE BASIS OF BEARINGS FOR THIS PROJECT IS NORTH 00°08'16" EAST BEING THE EAST LINE OF THE NORTHWEST QUARTER (NE 1/4) OF THE SECTION 24, TOWNSHIP 19 SOUTH, RANGE 59 EAST, M.D.M., CLARK COUNTY, NEVADA, AS SHOWN ON A RECORD OF SURVEY ON FILE IN THE CLARK COUNTY, NEVADA, RECORDER'S OFFICE IN FILE 123 AT PAGE 32.

NOTE
 ALL DRAINAGE EASEMENTS MUST BE COMMON LOTS & PUBLIC DRAINAGE EASEMENTS TO BE PRIVATELY MAINTAINED BY H.O.A.

NOTES
 1. ALL PRIVATE STREETS AND PRIVATE DRIVES ARE P.U.E., PUBLIC SEWER EASEMENT, & PUBLIC DRAINAGE EASEMENT TO BE PRIVATELY MAINTAINED BY H.O.A.

CONTRACTOR NOTE
 CONTRACTOR SHALL VERIFY HORIZONTAL AND VERTICAL LOCATION OF EXISTING UTILITIES AND NOTIFY THE DESIGN ENGINEER IMMEDIATELY OF ANY DISCREPANCIES PRIOR TO CONSTRUCTION.

Avoid overhead power the contact it's costly
Call before you Overhead
 1-702-227-2929

Avoid cutting underground utility lines it's costly
Call before you Dig
 1-800-227-2600

AVOID HITTING UNDERGROUND TRAFFIC SIGNAL SYSTEMS AND STREET LIGHT SYSTEM CONDUITS IT'S COSTLY CALL BEFORE YOU DO UNDERGROUND

Call before you Underground
 1-702-455-7511
 CLARK COUNTY TRAFFIC OPERATIONS AND
 1-702-229-6611
 LAS VEGAS AREA COMPUTERIZED TRAFFIC SYSTEM

PROFILE SCALES:
 HORZ. = 1"=30'
 VERT. = 1"=3'

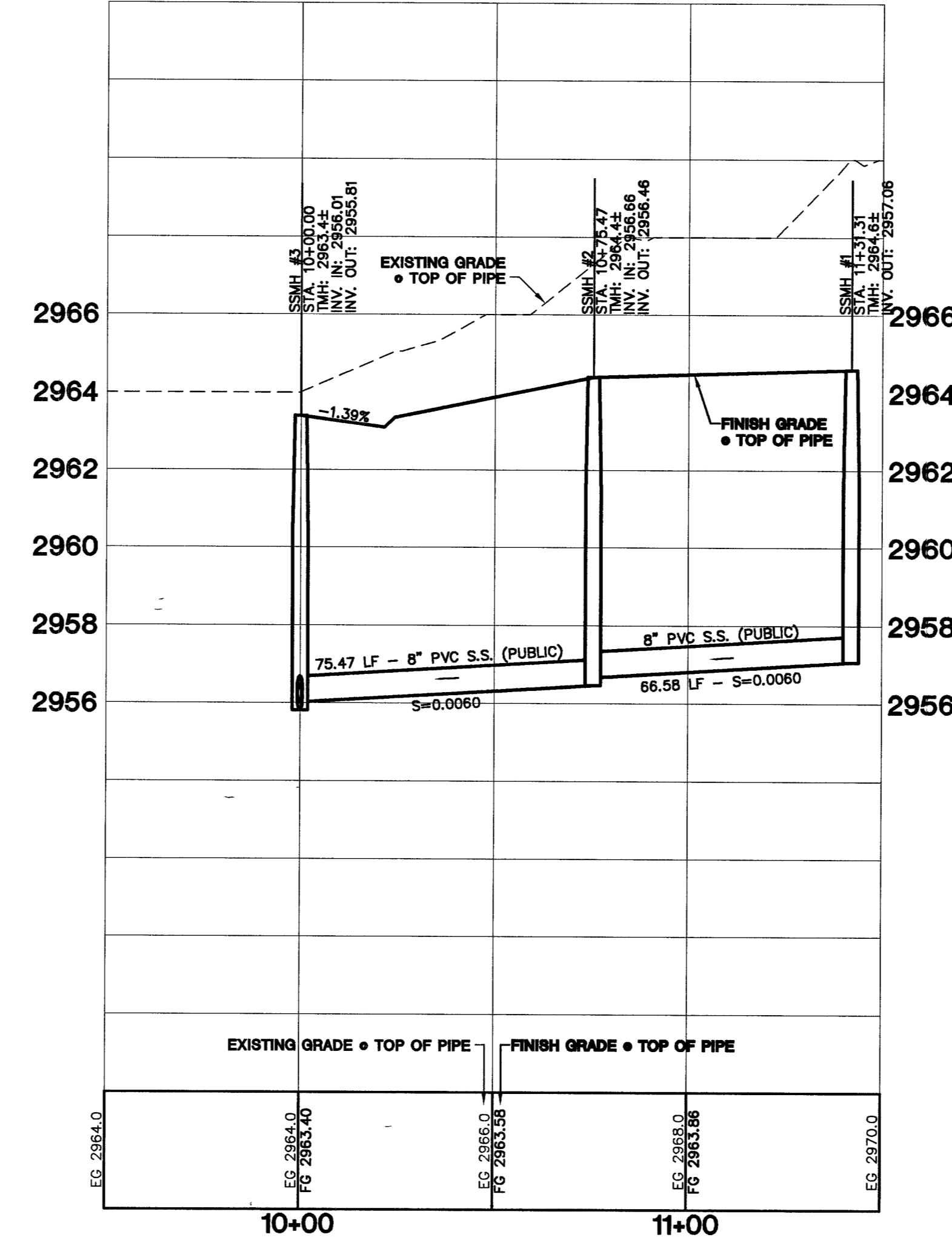
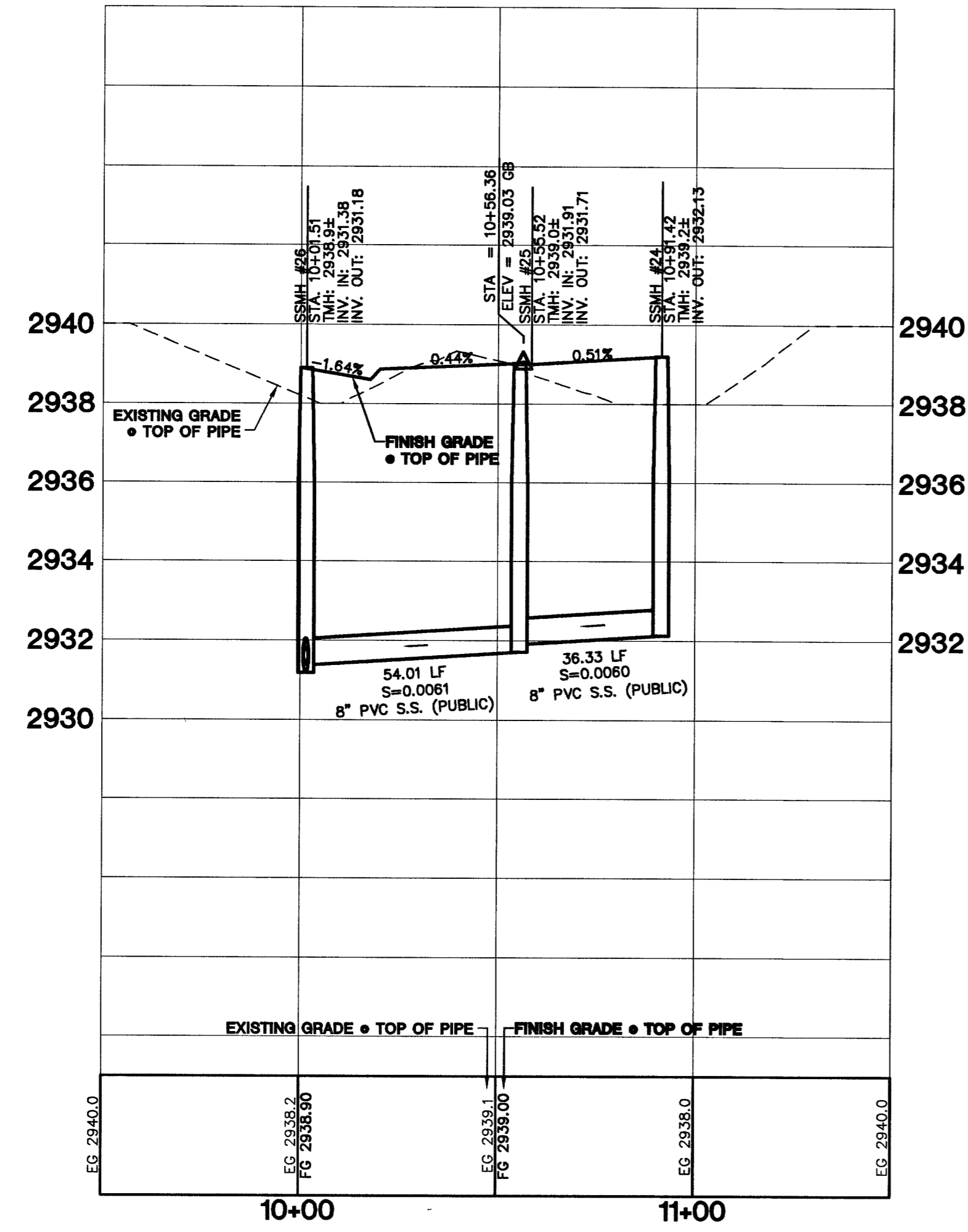

7	6	5	4	3	2	1
REV	DATE	BY	REVISION			

CITY OF LAS VEGAS

KIMBALL HILL
 W.L. SUITE 101
 1100 W. HENDERSON AVE., SUITE 101
 HENDERSON, NV 89014
 (702) 438-4882

2727 SOUTH RAINBOW BOULEVARD LAS VEGAS, NEVADA 89146-5148
 PH. (702) 873-7550 FAX (702) 862-2897
mtm nevada CONSULTING ENGINEERS & LAND SURVEYORS

**SEWER PLAN AND PROFILE
 WHITFORD AND ROSECRANS**

**BRIGHTON & KENSINGTON
 PROVIDENCE / CLIFFS EDGE
 UNIT 2**

DRAWN BY: TP
 DESIGNED BY: TP
 CHECKED BY: CRG
 PROJECT NO: 6389-2

2/25/05
 2/25/05
 2/25/05

SCALE: 1"=30' HORZ.
 1"=3' VERT.

EXPIRES: 06-30-07
 SHEET
SS11
 42 OF 52 SHEETS
 DRAWING NO.
 1074890-2

PROFESSIONAL ENGINEER STATE OF NEVADA
 CHRISTOPHER A. GRUBBS
 CIVIL
 No. 13956
 EXPIRES 11/18/05