

DOMAN AVENUE (PRIVATE)
BOOMER BEACH STREET FOR CONTINUATION SEE SHEET SS12

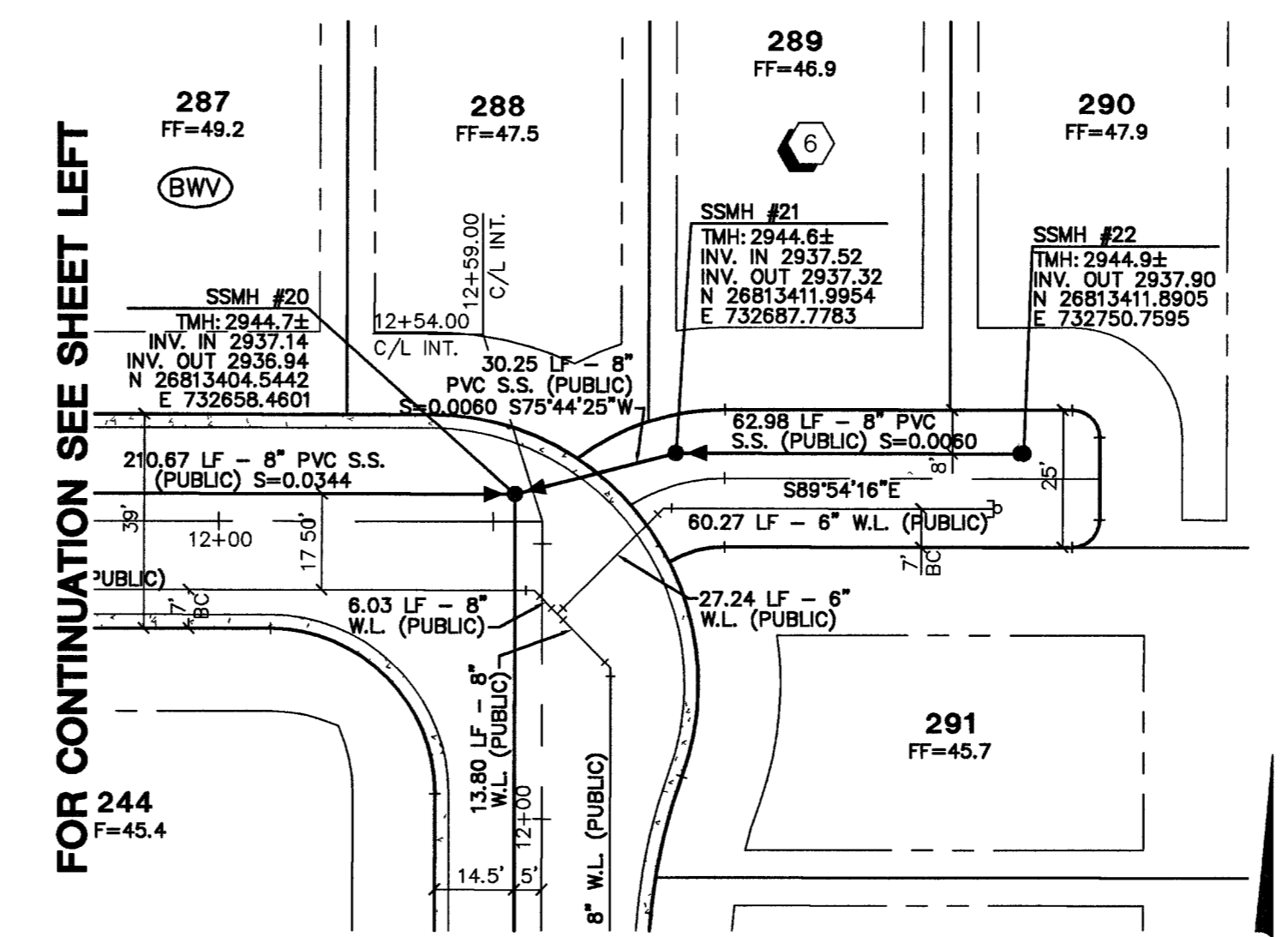

DOMAN AVENUE (STUB) (PRIVATE)
BOOMER BEACH STREET FOR CONTINUATION SEE SHEET SS12

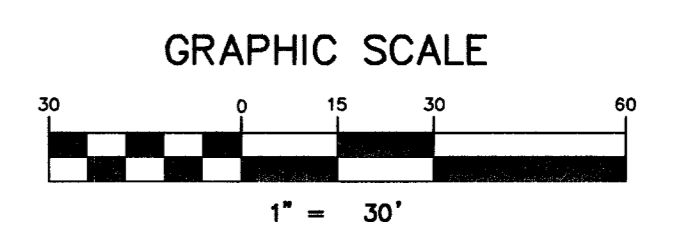
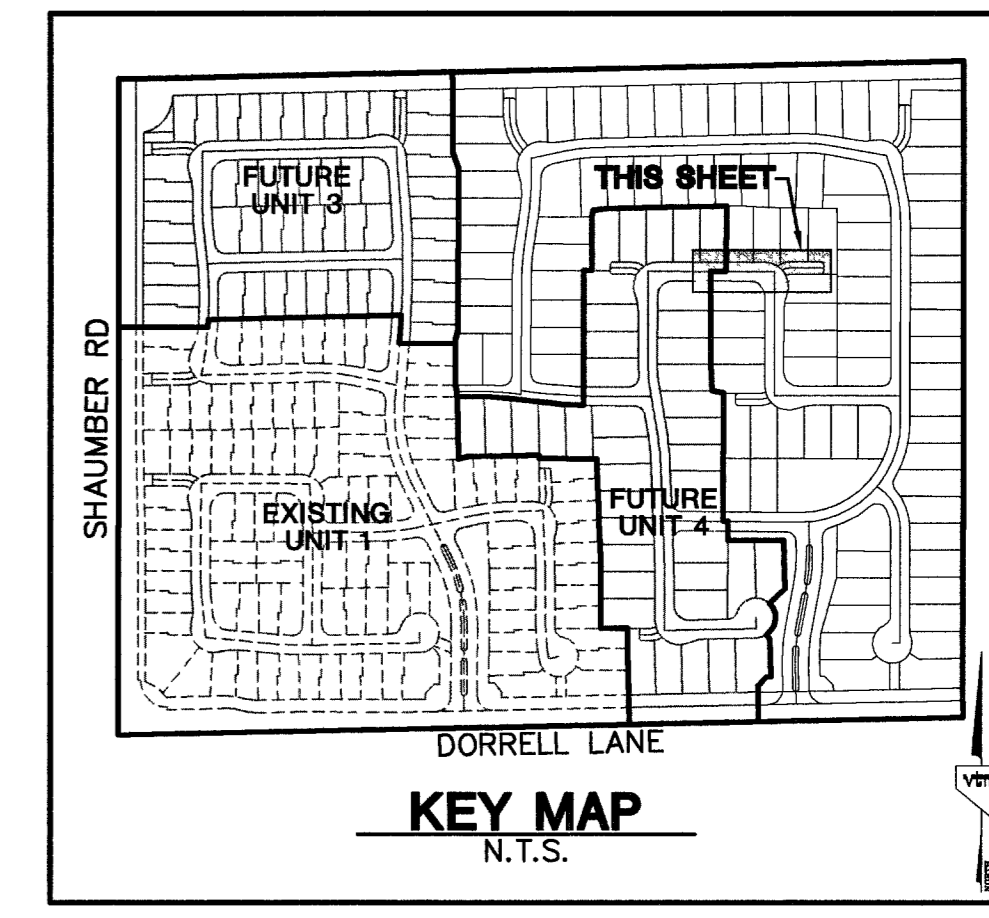

PROJECT BENCHMARK
 DATUM: NORTH AMERICAN VERTICAL DATUM OF 1988 (NAVD88)
 CITY OF LAS VEGAS BENCHMARK: BLV99:13SES
 NAVD88 ELEVATION: 869.606 METERS (2853.03 FEET)
 RIVET AND PLATE IN CONCRETE CYLINDER NW CORNER OF HUALAPAI AND ELKHORN

NOTE: WHEN THE SURVEYING FOR THIS PROJECT BEGAN, THE ABOVE REFERENCED BENCHMARK BLV99:13SES WAS NOT PUBLISHED. THE BASIS FOR THE DATUM FOR THIS PROJECT IS SHOWN ON RECORD OF SURVEY FILE 124 PAGE 94, CLARK COUNTY BENCHMARK 1000-BNS, WHICH AT THE TIME OF THE ORIGINAL SURVEY (PRIOR TO THE CURRENT 2003 COUNTY BENCHMARK PUBLISHING) HAD AN ELEVATION OF 2284.81 FEET. TO CONVERT THE CURRENT CITY OF LAS VEGAS BENCHMARK BLV99:13SES TO MATCH THE ORIGINAL PROJECT DATUM, 0.34' NEEDS TO BE ADDED TO THE ELEVATION OF 2853.03 FEET.

BASIS OF BEARINGS
 THE BASIS OF BEARINGS FOR THIS PROJECT IS NORTH 00°08'16" EAST BEING THE EAST LINE OF THE NORTHWEST QUARTER (NE 1/4) OF THE SECTION 24, TOWNSHIP 19 SOUTH, RANGE 59 EAST, M.D.M., CLARK COUNTY, NEVADA, AS SHOWN ON A RECORD OF SURVEY ON FILE IN THE CLARK COUNTY, NEVADA, RECORDER'S OFFICE IN FILE 123 AT PAGE 32.

NOTE:
 ALL DRAINAGE EASEMENTS MUST BE COMMON LOTS & PUBLIC DRAINAGE EASEMENTS TO BE PRIVATELY MAINTAINED BY H.O.A.

NOTES:
 1. ALL PRIVATE STREETS AND PRIVATE DRIVES ARE P.U.E., PUBLIC SEWER EASEMENT, & PUBLIC DRAINAGE EASEMENT TO BE PRIVATELY MAINTAINED BY H.O.A.

CONTRACTOR NOTE:
 CONTRACTOR SHALL VERIFY HORIZONTAL AND VERTICAL LOCATION OF EXISTING UTILITIES AND NOTIFY THE DESIGN ENGINEER IMMEDIATELY OF ANY DISCREPANCIES PRIOR TO CONSTRUCTION.

Avoid overhead power line contact. It's costly.

Call before you Overhead
 1-702-227-2929

Avoid cutting underground utility lines. It's costly.

Call before you Dig
 1-800-227-2600

AVOID HITTING UNDERGROUND TRAFFIC SIGNAL SYSTEMS AND STREET LIGHT SYSTEM CONDUITS

IT'S COSTLY CALL BEFORE YOU DO UNDERGROUND

Call before you Underground
 1-702-455-7511
 CLARK COUNTY TRAFFIC OPERATIONS AND
 1-702-229-5611
 LAS VEGAS AREA COMPUTERIZED TRAFFIC SYSTEM

PROFILE SCALES:
 HORZ. = 1"=30'
 VERT. = 1"=3'

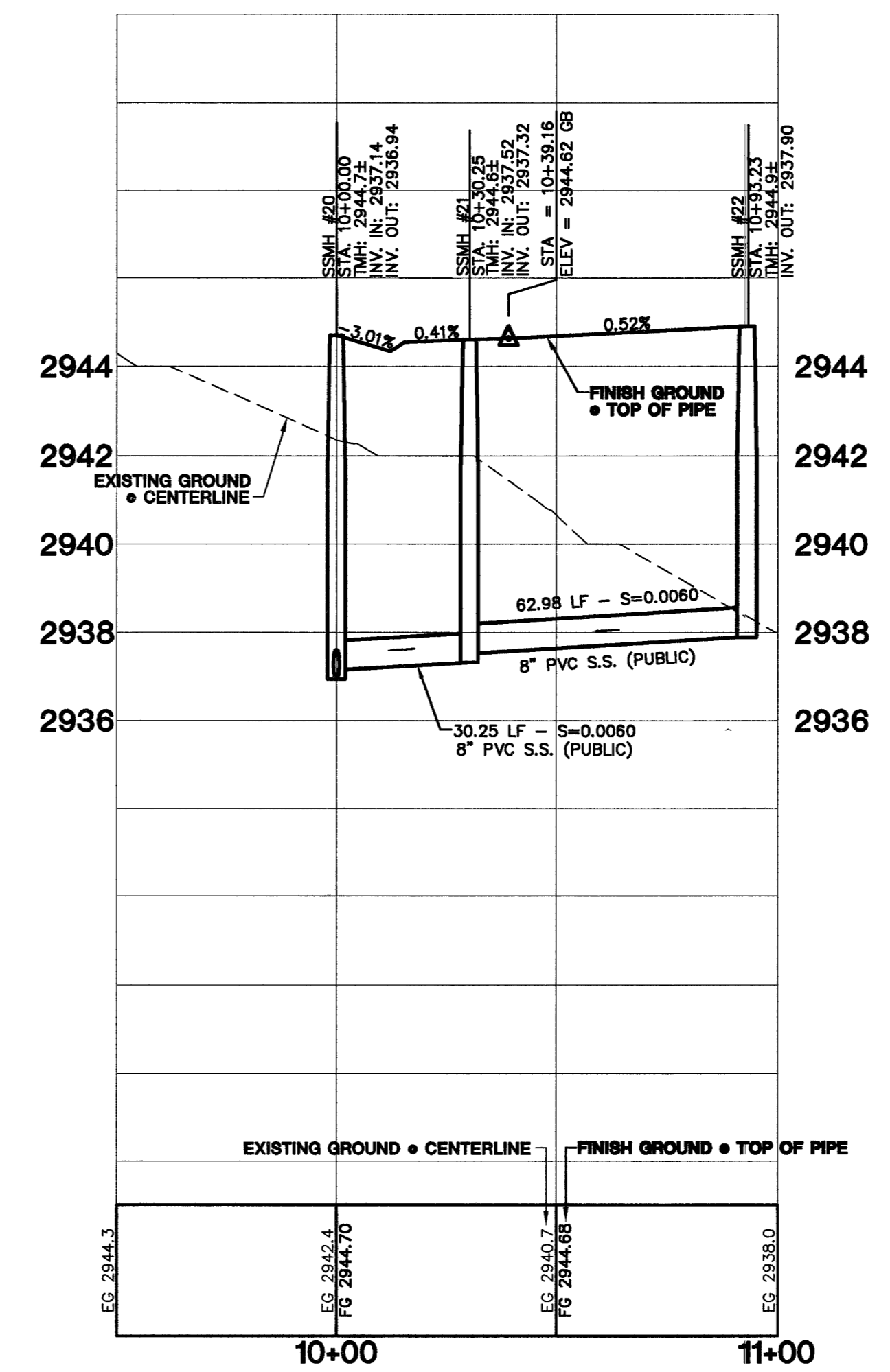
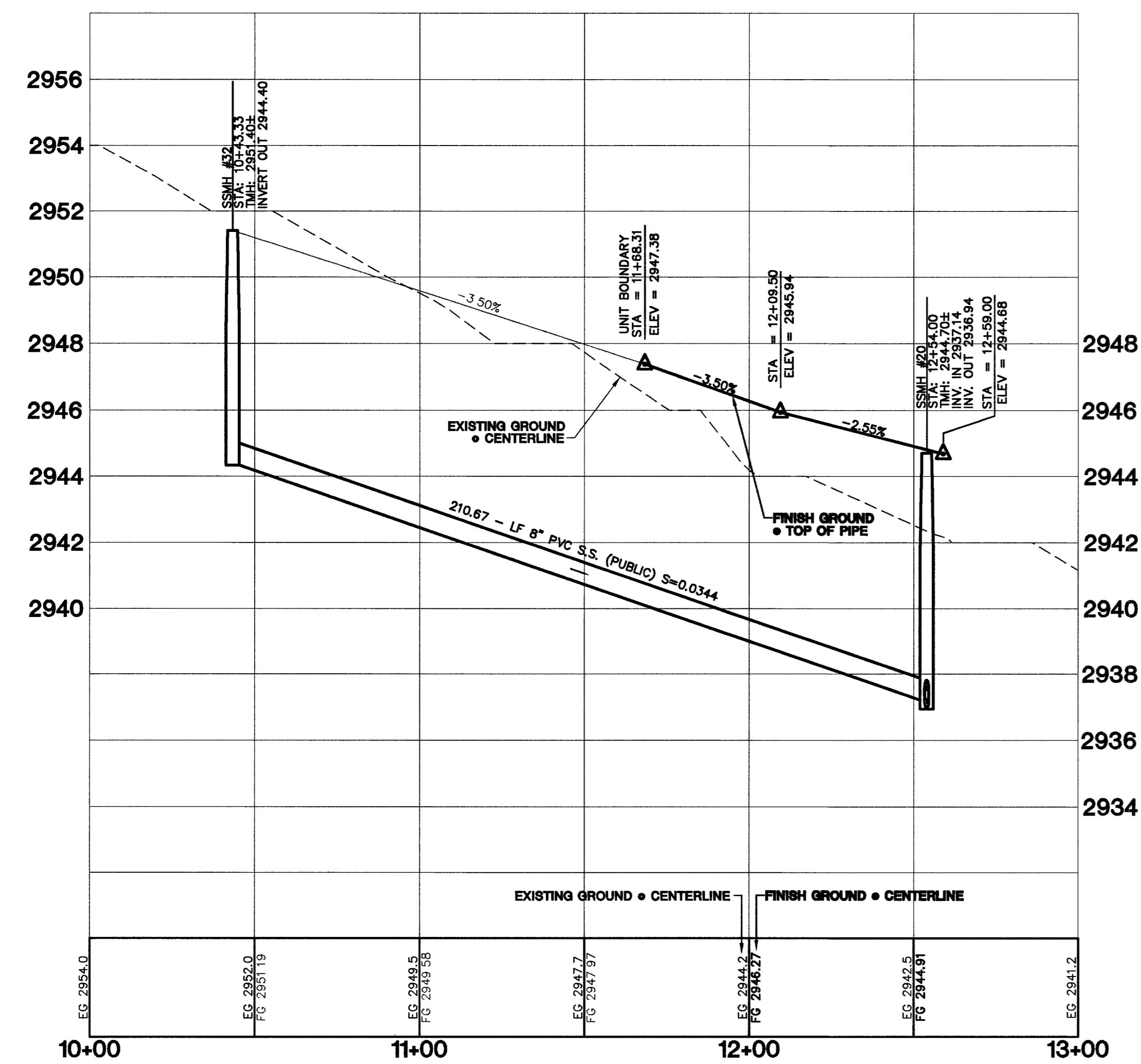

REVISION

7			
6			
5			
4			
3			
2			
1			

CITY OF LAS VEGAS

KIMBALL HILL
 8 SUNSET WAY, SUITE 101
 HENDERSON, NEVADA 89014
 (702) 438-1692

2727 SOUTH RAINBOW BOULEVARD LAS VEGAS, NEVADA 89146-5148
 PH. (702) 873-7550 FAX (702) 362-2597

nevada CONSULTING ENGINEERS • PLANNERS • LAND SURVEYORS

SEWER PLAN AND PROFILE
DOMAN AVENUE

BRIGHTON & KENSINGTON
PROVIDENCE / CLIFFS EDGE
UNIT 2

DRAWN BY: TP 2/25/05

DESIGNED BY: TP 2/25/05

CHECKED BY: CRG 2/25/05

PROJECT NO: E389-2 SCALE: 1"=30' HORZ. 1"=3' VERT.

EXPIRES 06-30-07 1/18/05

SHEET **SS5**
 36 OF 52 SHEETS

DRAWING NO. **10714890-2**

PROFESSIONAL ENGINEER - STATE OF NEVADA
 CHRISTOPHER J. BRUBAKER
 No. 78956

85665