

**ULRIC AVENUE (WEST STUB)**  
(PRIVATE)

**ULRIC AVENUE**  
(PRIVATE)

**PROJECT BENCHMARK**  
 DATUM: NORTH AMERICAN VERTICAL DATUM OF 1988 (NAVD88)  
 CITY OF LAS VEGAS BENCHMARK: BLV99-13SES  
 NAVD88 ELEVATION: 899.605 METERS (2953.03 FEET)  
 RIVET AND PLATE IN CONCRETE CYLINDER NW CORNER OF HUALAPAI AND ELKHORN

**NOTE:** WHEN THE SURVEYING FOR THIS PROJECT BEGAN, THE ABOVE REFERENCED BENCHMARK BLV99-13SES WAS NOT PUBLISHED. THE BASIS FOR THE DATUM FOR THIS PROJECT IS SHOWN ON RECORD OF SURVEY FILE 124 PAGE 94, CLARK COUNTY BENCHMARK 1000-618, WHICH AT THE TIME OF THE ORIGINAL SURVEY (PRIOR TO THE CURRENT 2003 COUNTY BENCHMARK PUBLISHING) HAD AN ELEVATION OF 2584.81 FEET. TO CONVERT THE CURRENT CITY OF LAS VEGAS BENCHMARK BLV99-13SES TO MATCH THE ORIGINAL PROJECT DATUM, 0.34' NEEDS TO BE ADDED TO THE ELEVATION OF 2853.03 FEET.

**BASIS OF BEARINGS**  
 THE BASIS OF BEARINGS FOR THIS PROJECT IS NORTH 00°08'16" EAST BEING THE EAST LINE OF THE NORTHWEST QUARTER (NE 1/4) OF THE SECTION 24, TOWNSHIP 19 SOUTH, RANGE 59 EAST, M.D.M., CLARK COUNTY, NEVADA, AS SHOWN ON A RECORD OF SURVEY ON FILE IN THE CLARK COUNTY, NEVADA, RECORDER'S OFFICE IN FILE 123 AT PAGE 32.

**NOTE:**  
 ALL DRAINAGE EASEMENTS MUST BE COMMON LOTS & PUBLIC DRAINAGE EASEMENTS TO BE PRIVATELY MAINTAINED BY H.O.A.

**NOTES:**  
 1. ALL PRIVATE STREETS AND PRIVATE DRIVES ARE P.U.E., PUBLIC SEWER EASEMENT, & PUBLIC DRAINAGE EASEMENT TO BE PRIVATELY MAINTAINED BY H.O.A.

**CONTRACTOR NOTE:**  
 CONTRACTOR SHALL VERIFY HORIZONTAL AND VERTICAL LOCATION OF EXISTING UTILITIES AND NOTIFY THE DESIGN ENGINEER IMMEDIATELY OF ANY DISCREPANCIES PRIOR TO CONSTRUCTION.

Avoid overhead power the contact. It's costly.

**Call before you Overhead**

1-702-227-2929

Avoid cutting underground utility lines. It's costly.

**Call before you Dig**

1-800-227-2600

AVOID HITTING UNDERGROUND TRAFFIC SIGNAL SYSTEMS AND STREET LIGHT SYSTEM CONDUITS

IT'S COSTLY CALL BEFORE YOU DO UNDERGROUND

**Call before you Underground**

1-702-455-7511  
CLARK COUNTY TRAFFIC OPERATIONS AND

1-702-229-6611  
LAS VEGAS AREA COMPUTERIZED TRAFFIC SYSTEM

**PROFILE SCALES:**  
 HORZ. = 1"=30'  
 VERT. = 1"=3'

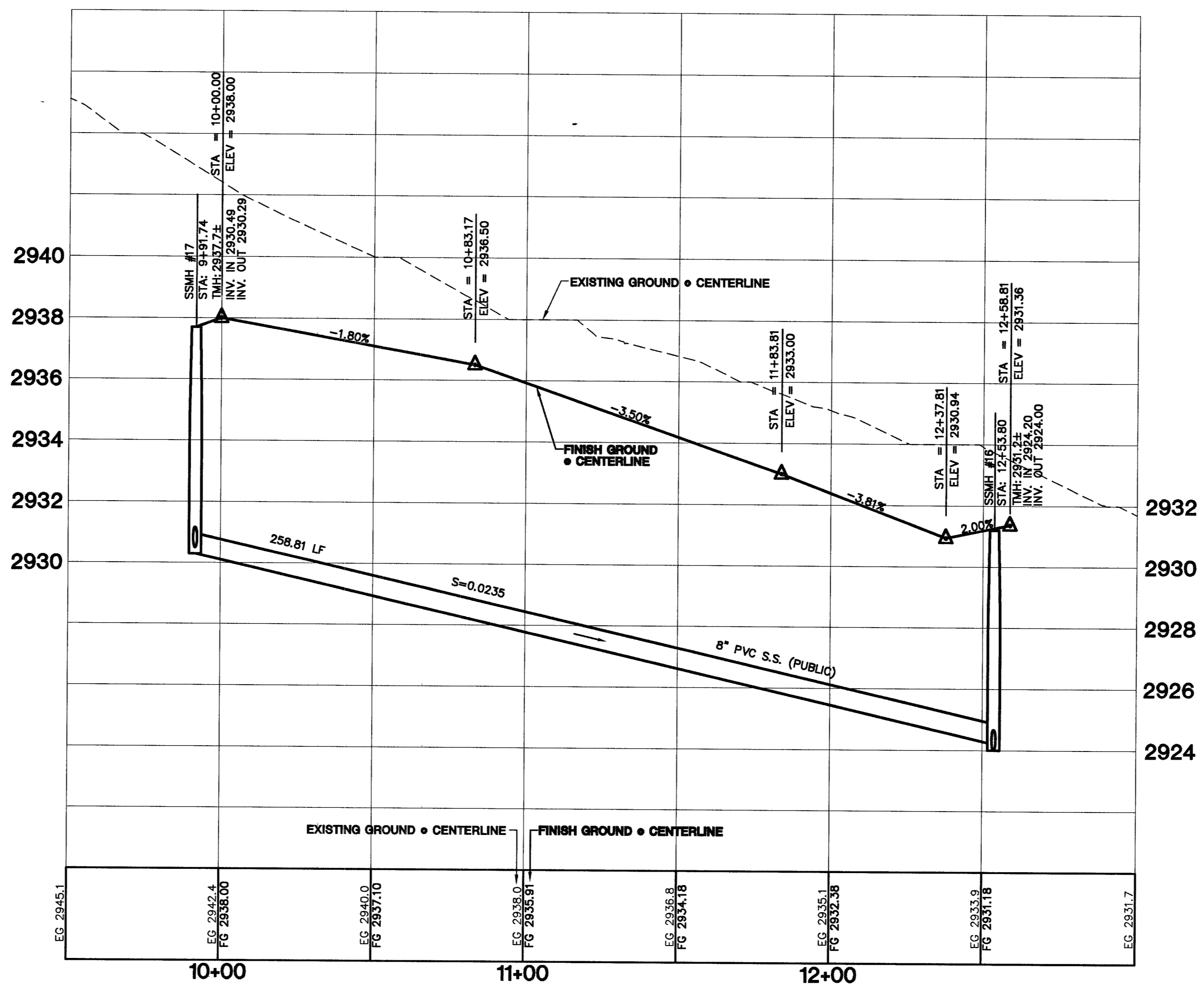
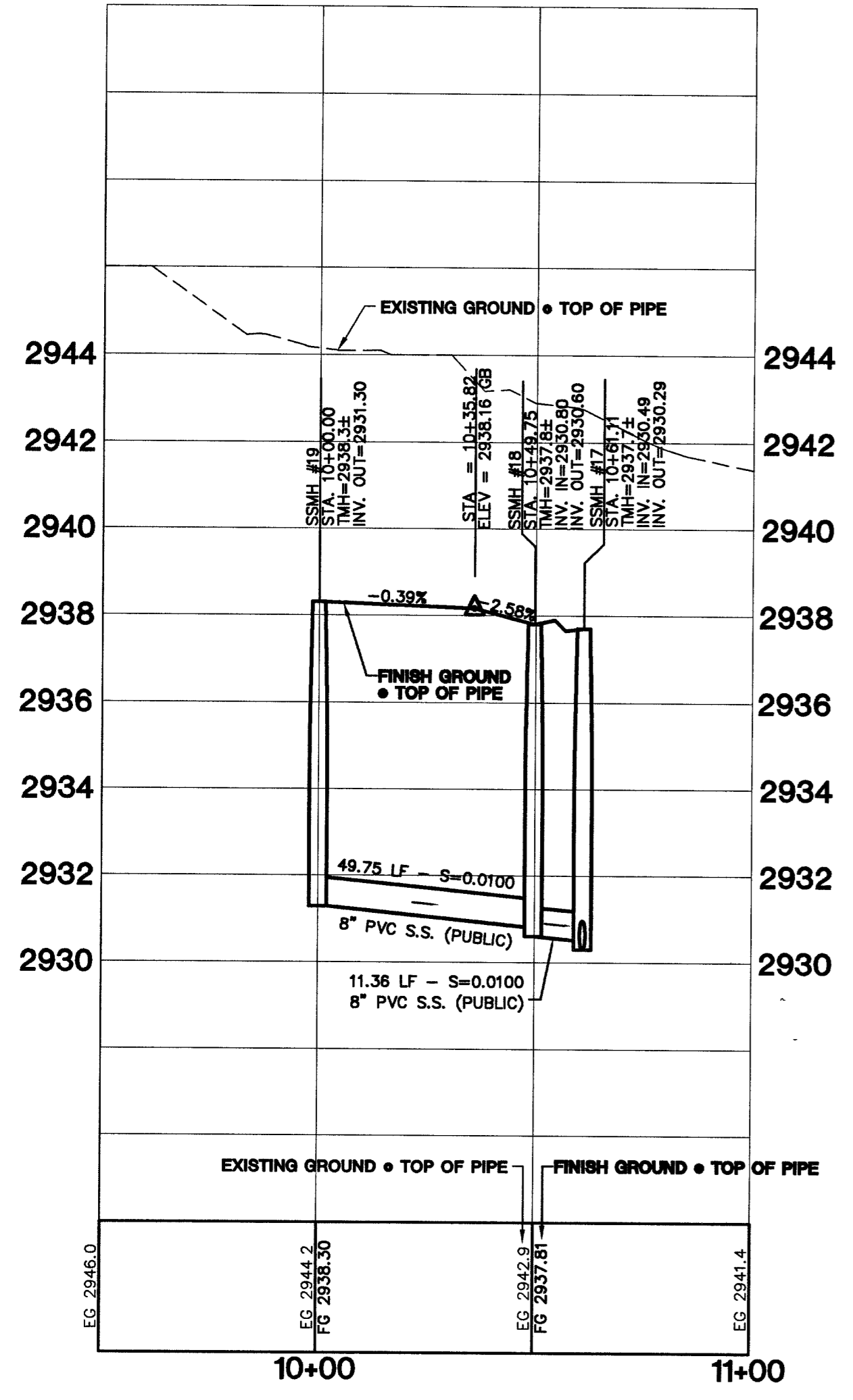

7									
6									
5									
4									
3									
2									
1									
	REV	DATE	BY						

**CITY OF LAS VEGAS**

**KIMBALL HILL**  
8 SUNSET WAY, SUITE 101  
HENDERSON, NEVADA 89014  
(702)436-4582

**SEWER PLAN AND PROFILE**  
**ULRIC AVENUE**

**BRIGHTON & KENSINGTON**  
**PROVIDENCE / CLIFFS EDGE**  
**UNIT 2**

DRAWN BY: \_\_\_\_\_ 2/25/05  
 DESIGNED BY: \_\_\_\_\_ 2/25/05  
 CHECKED BY: \_\_\_\_\_ 2/25/05  
 PROJECT NO: \_\_\_\_\_  
 SPP-2 SCALE: 1"=30' HORIZ.  
 1"=3' VERT.

EXPIRES 06-30-07 11/18/05

SHEET  
**SS4**  
35 OF 52 SHEETS  
DRAWING NO.  
1074492-2

85664