

CHANGED AREA SHALL BE COMPLETED AS PART OF CONTRACT, INCLUDING GRADING, PAVING, SIDEWALKS, CURBS, LANDSCAPING, ETC.

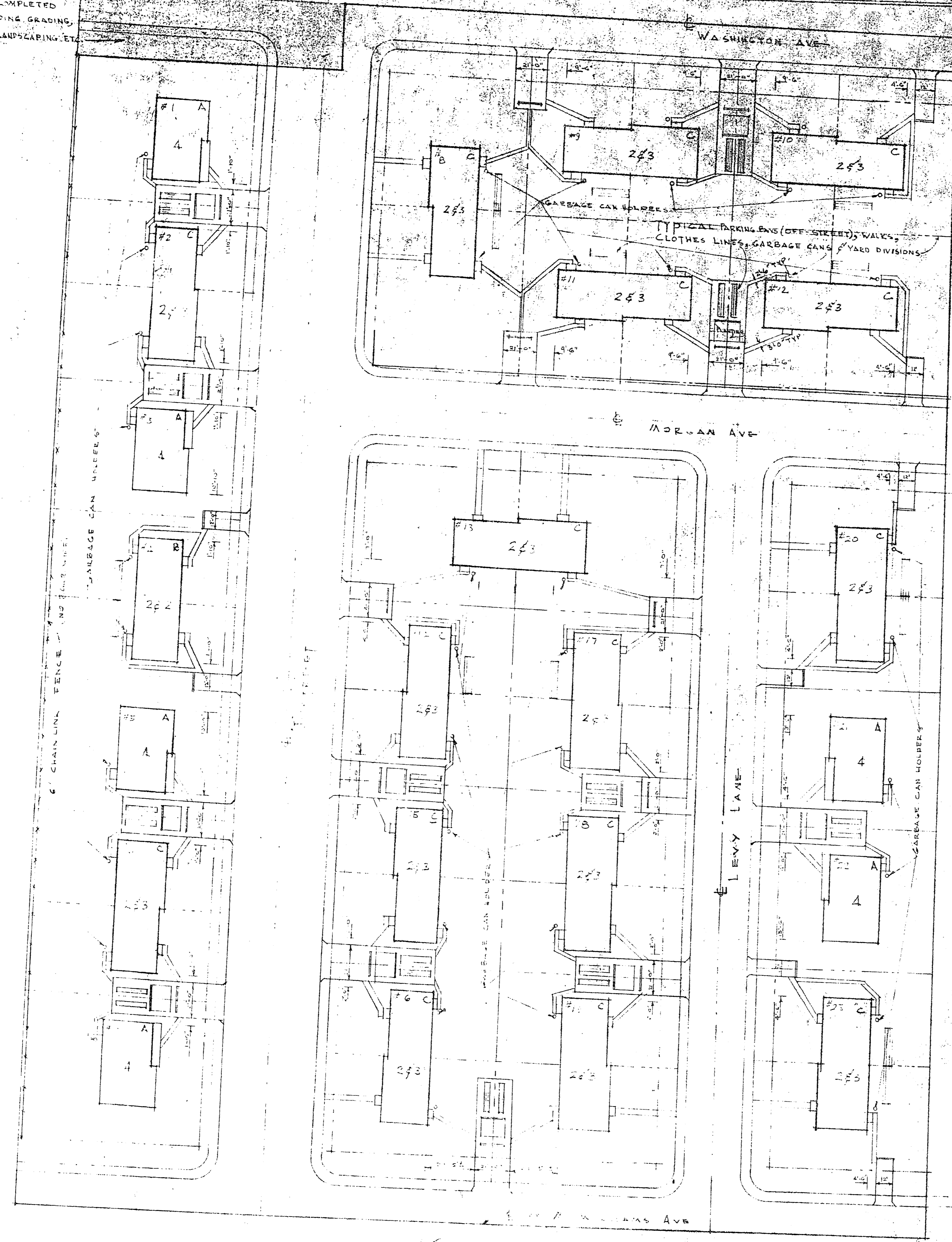

LEGEND	
	CENTER LINE
	PROPERTY LINE
	TENANT YARD DIVISIONS
	CLOTHES LINES
	GARBAGE CAN LOCATION
	CHAIN LINK FENCE
	BUILDING NUMBER

- NOTES: 1. ALL FRONT ENTRANCE WALKS SHALL BE 3'0\"/>

Marble Manor Housing

PLANNING PLANNING PARTS, WALKS & CLOTHES LINES ARCHITECT HOUSING AUTHORITY	HOUSING PROJECT FOR THE HOUSING AUTHORITY OF THE CITY OF LAS VEGAS NEVADA. PROJECT NO. 100-100-100-100
ARCHITECT ELMO C. BRUNER & ASSOCIATES ARCHITECTS PHONE 203-5111 203 N. 5TH ST., LAS VEGAS, NEVADA	DRAWN BY CHECKED BY DATE
CONTRACTOR REVISIONS	FRANK J. BATHUR REG. PROF. ENGINEER & LAND SURVEYOR - NEV. CERT. NO. 301 LAS VEGAS, NEVADA

SCALE 1/4\"/>