

**CITY OF LAS VEGAS FIRE DEPARTMENT NOTES**

- ALL WORK SHALL BE DONE IN STRICT ACCORDANCE WITH THE CITY OF LAS VEGAS FIRE DEPARTMENT "HYDRANT SPECIFICATIONS", "HYDRANT INSTALLATION SPECIFICATIONS" AND ORDINANCE #3318.
- AUTHORIZED HYDRANTS FOR THIS PROJECT ARE:
  - KENNEDY GUARDIAN
  - MUELLER A-423 CENTURIAN
  - CLOW MODEL 2546 MEDALLION
- ON ANY NEW HOME OR BUILDING INSTALLATION, ACCESSIBLE FIRE HYDRANTS SHALL BE INSTALLED BEFORE COMBUSTIBLE CONSTRUCTION COMMENCES AND SAID FIRE HYDRANTS SHALL BE IN GOOD WORKING ORDER WITH AN ADEQUATE WATER SUPPLY.
- CONTRACTOR SHALL PLACE A BLUE REFLECTIVE MARKER AS REQUIRED IN ORDINANCE #3545 TO IDENTIFY FIRE HYDRANT LOCATIONS.
- CALL THE LAS VEGAS BUILDING DEPARTMENT AT 229-2071 FOR UNDERGROUND INSPECTION, PRESSURE AND FLUSH VERIFICATION OF ALL FIRE HYDRANTS AND FIRE LINES BEFORE COVERING.
- PAINTING OF THE CURBS AND HYDRANTS AND ANY WORK NECESSARY FOR PROTECTION OF HYDRANTS FROM PHYSICAL DAMAGE PER ORDINANCE #3545 SHALL BE COMPLETED BEFORE APPROVAL BY THE CITY OF LAS VEGAS FIRE DEPARTMENT.
- A PERMIT IS REQUIRED FROM THE FIRE DEPARTMENT FOR WATER LINE AND FIRE HYDRANT INSTALLATIONS ON THE PRIVATE SIDE OF THE METER. THE PERMIT AND CONTRACTORS MATERIAL AND TEST CERTIFICATE FOR UNDERGROUND PIPING FORM SHALL BE OBTAINED FROM THE FIRE PROTECTION ENGINEER PRIOR TO ANY WORK BEGINNING.
- A FLOW TEST MUST BE WITNESSED BY THE FIRE DEPARTMENT PRIOR TO OCCUPANCY FOR VERIFICATION OF REQUIRED ON-SITE WATER SUPPLY.
- ALL ON-SITE FIRE MAIN MATERIALS MUST BE U.L. LISTED AND F.M. APPROVED.
- FIRE HYDRANT SPACING:
 

RESIDENTIAL - 500 FEET UNSPRINKLERED, 600 FEET SPRINKLERED  
 COMMERCIAL, INCLUDING MULTI-FAMILY - 300 FEET UNSPRINKLERED, 400 FEET SPRINKLERED.
- NO FIRE HYDRANT SHALL BE LOCATED WITHIN THE REQUIRED RADIUS OF A CUL-DE-SAC OR WITHIN 20 FT. OF THE PERIMETER OF THE RADIUS OF THE CUL-DE-SAC.
- NO FIRE HYDRANT SHALL BE LOCATED WITHIN 6 FT. OF ANY CURB RETURN, DRIVEWAY, POWER POLE, STREET LIGHT OR ANY OTHER OBSTRUCTION.
- ENSURE THAT FIRE HYDRANTS ARE CONNECTED TO A DEPENDABLE WATER SUPPLY CAPABLE OF SUPPLYING THE REQUIRED FIRE FLOW.
- NOT MORE THAN 2 HYDRANTS CAN BE OUT OF SERVICE DUE TO A SINGLE MAIN BREAK.
- THE TURNING RADIUS FOR ANY FIRE APPARATUS ACCESS ROAD AND/OR FIRE LANE, PUBLIC OR PRIVATE SHALL BE NOT LESS THAN 45 FEET OUTSIDE RADIUS AND 22 FEET INSIDE RADIUS.
- FIRE APPARATUS ROAD SHALL BE REQUIRED WHEN ANY PORTION OF AN EXTERIOR WALL OF THE FIRST STORY IS LOCATED MORE THAN 150 FEET FROM FIRE DEPARTMENT VEHICLE ACCESS. (SEE EXCEPTIONS IN UFC 88, SECTION 10.207).
- ALL DEAD END FIRE APPARATUS ACCESS ROADS AND/OR FIRE LANES PUBLIC OR PRIVATE IN EXCESS OF 150 FEET IN LENGTH SHALL BE PROVIDED WITH AN APPROVED TURNAROUND AREA. SEE ORDINANCE NO. 3545.

**CITY OF LAS VEGAS FIRE DEPARTMENT NOTES**

**BUILDING INFORMATION**

FIRE FLOW REQUIREMENT IS 1500 GALLONS PER MINUTE AT 20 POUNDS PER SQUARE INCH RESIDUAL.

BASED ON :

SQUARE FOOTAGE	8,347
HEIGHT	1 STORY
ROOF CONSTRUCTION	METAL
SPRINKLER SYSTEM	NO
EXPOSURES	
TYPE OF CONSTRUCTION	TYPE II -F.R.

*Spring Mitchell*  
 FIRE MARSHALL, CITY OF LAS VEGAS

9.13.95  
 DATE

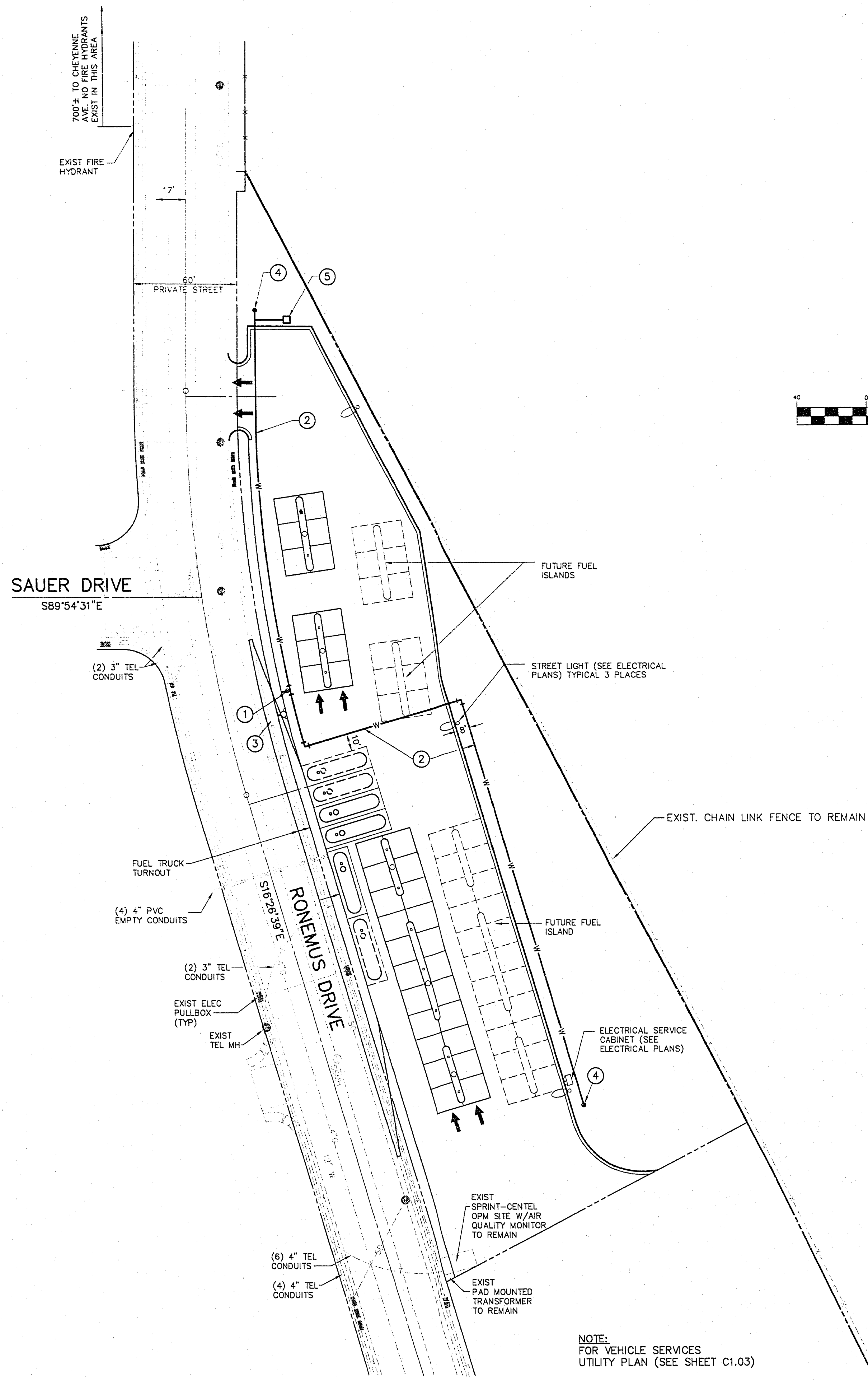

**UTILITY NOTES**

- 1-1/2"x1-1/2"x1-1/2" TEE w/ 1-1/2" GATE VALVE. CONNECT TO EXIST. 1-1/2" WATER LINE.
- CONSTRUCT 1-1/2" WATER LINE
- RELOCATE EXISTING FIRE HYDRANT. DISTANCE TO NEXT FIRE HYDRANT TO THE SOUTH IS 405 FEET.
- INSTALL 3/4" FREEZE PROOF HOSE BIBB.
- TAP WATER LINE AT WATER REEL

**BASIS OF BEARINGS:**  
 S89°56'51"E - BEING THE SOUTH LINE OF THE S.E. 1/4 OF THE S.W. 1/4 OF SECTION 10, T.20S., R.60E., M.D.B. & M.

**BASIS OF ELEVATION:**  
 7000-11C4-DRIVE RIVET IN A 2"x2" ALUMINUM PLATE, IN TOP OF CURB, NORTHWEST CORNER OF GOWAN ROAD AND TORREY PINES DRIVE.  
 ELEVATION: 2284.34 (NGVD), TO CONVERT ELEVATIONS ON THESE PLANS TO NAVD 88 DATUM, ADD 2.33 FT.

**NOTE:**  
 CONTRACTOR SHALL LOCATE AND VERIFY ALL EXISTING CONDITIONS PRIOR TO CONSTRUCTION.

**NOTE:**  
 THIS DRAWING PREPARED UNDER A SEPARATE CONTRACT BY POGGEMEYER DESIGN GROUP AND IS INCLUDED HEREIN AS A PART OF THIS BID PACKAGE.

Call before you Dig.  
 1-800-227-2600

**TATE & SNYDER ARCHITECTS**

709 Valle Verde Court  
 Henderson, Nevada 89014  
 Tel. 702.456.3000  
 Fax. 702.898.6209

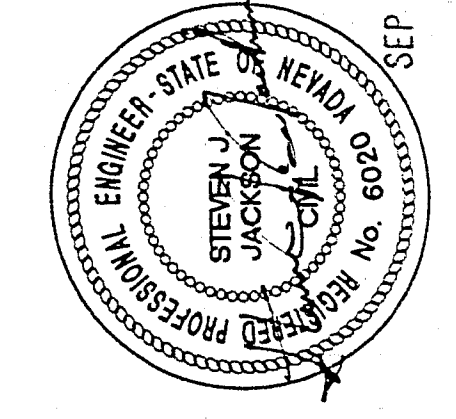

THESE DRAWINGS AND THE INFORMATION CONTAINED HEREIN ARE THE PROPERTY OF THE ARCHITECT AND MAY BE USED FOR ANY PURPOSE OR IN ANY MANNER WITHOUT THE WRITTEN CONSENT OF THE ARCHITECT. THESE DRAWINGS ARE NOT TO BE USED FOR ANY OTHER PROJECT WITHOUT THE WRITTEN CONSENT OF THE ARCHITECT. THESE DRAWINGS ARE NOT TO BE REPRODUCED, COPIED, OR TRANSMITTED IN ANY FORM OR BY ANY MEANS, ELECTRONIC OR MECHANICAL, INCLUDING PHOTOCOPYING, RECORDING, OR BY ANY INFORMATION STORAGE AND RETRIEVAL SYSTEM, WITHOUT THE WRITTEN CONSENT OF THE ARCHITECT.

Consultant  
 BUSINESS PLANNERS SURVEYORS  
**POGGEMEYER DESIGN GROUP**  
 200 NORTH TENNY WAY, LAS VEGAS, NEVADA 89102 (702) 250-1100

Sheet Title  
**UTILITY PLAN - VEHICLE FUELING**  
 Project  
**CITY OF LAS VEGAS WEST VEHICLE SERVICE CENTER**

Revisions

Date: 02.05.96  
 Sheet No. **C1.05**  
 SHEET 6 OF 7

146

SEP - 6 1995