

DETAIL - GAS SERVICE LOCATION MARKER

NO SCALE

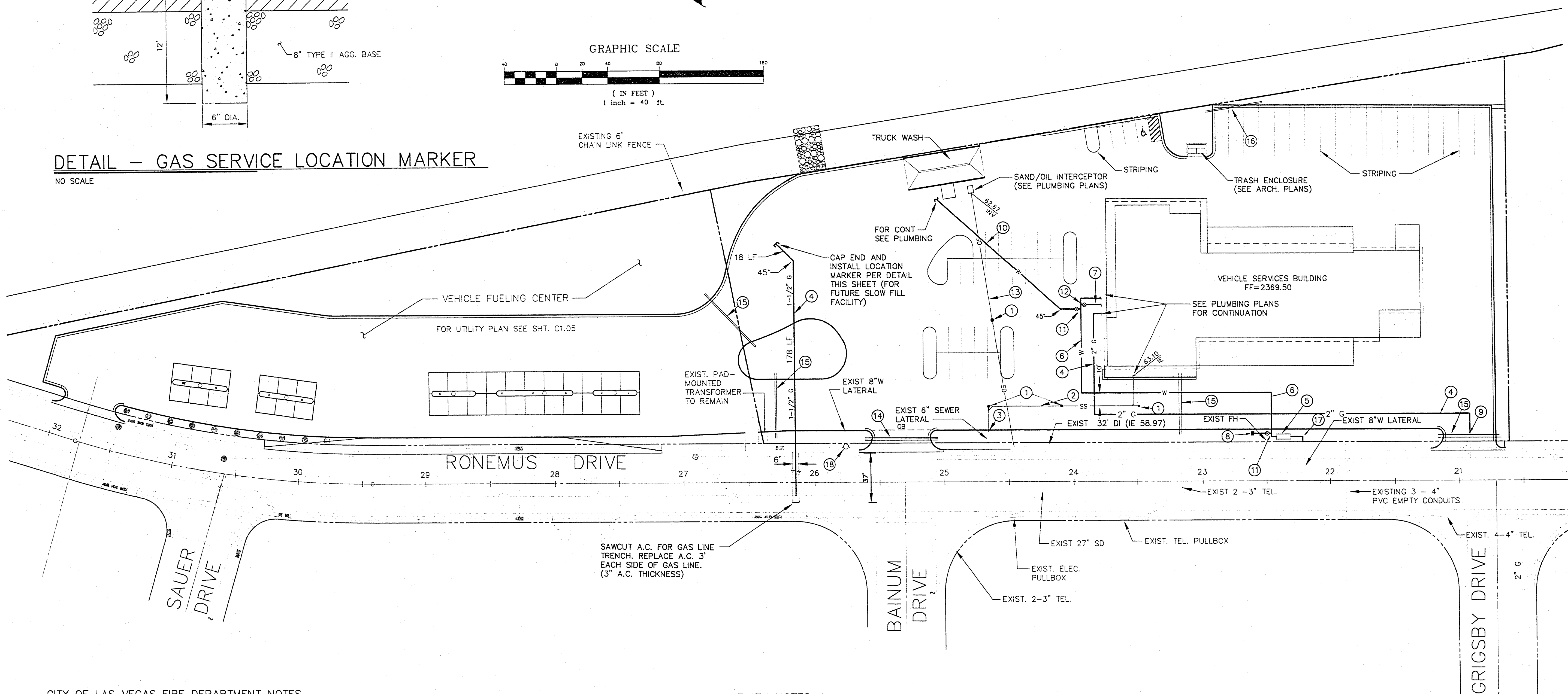
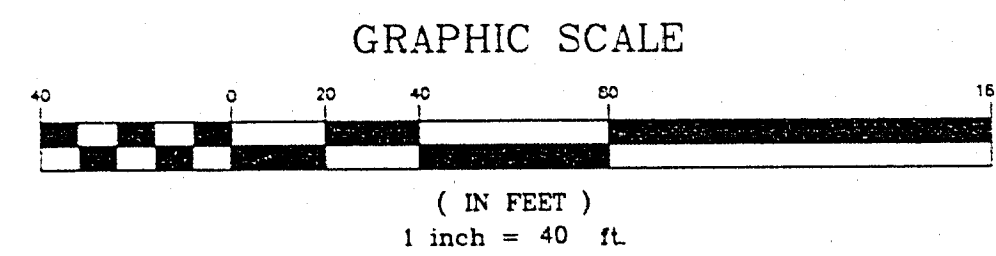

CITY OF LAS VEGAS FIRE DEPARTMENT NOTES

- ALL WORK SHALL BE DONE IN STRICT ACCORDANCE WITH THE CITY OF LAS VEGAS FIRE DEPARTMENT "HYDRANT SPECIFICATIONS", "HYDRANT INSTALLATION SPECIFICATIONS" AND ORDINANCE #3318.
- AUTHORIZED HYDRANTS FOR THIS PROJECT ARE:
 - KENNEDY GUARDIAN
 - MUELLER A-423 CENTURIAN
 - CLOW MODEL 2546 MEDALLION
- ON ANY NEW HOME OR BUILDING INSTALLATION, ACCESSIBLE FIRE HYDRANTS SHALL BE INSTALLED BEFORE COMBUSTIBLE CONSTRUCTION COMMENCES AND SAID FIRE HYDRANTS SHALL BE IN GOOD WORKING ORDER WITH AN ADEQUATE WATER SUPPLY.
- CONTRACTOR SHALL PLACE A BLUE REFLECTIVE MARKER AS REQUIRED IN ORDINANCE #3545 TO IDENTIFY FIRE HYDRANT LOCATIONS.
- CALL THE LAS VEGAS BUILDING DEPARTMENT AT 229-2071 FOR UNDERGROUND INSPECTION, PRESSURE AND FLUSH VERIFICATION OF ALL FIRE HYDRANTS AND FIRE LINES BEFORE COVERING.
- PAINTING OF THE CURBS AND HYDRANTS AND ANY WORK NECESSARY FOR PROTECTION OF HYDRANTS FROM PHYSICAL DAMAGE PER ORDINANCE #3545 SHALL BE COMPLETED BEFORE APPROVAL BY THE CITY OF LAS VEGAS FIRE DEPARTMENT.
- A PERMIT IS REQUIRED FROM THE FIRE DEPARTMENT FOR WATER LINE AND FIRE HYDRANT INSTALLATIONS ON THE PRIVATE SIDE OF THE METER. THE PERMIT AND CONTRACTORS MATERIAL AND TEST CERTIFICATE FOR UNDERGROUND PIPING FORM SHALL BE OBTAINED FROM THE FIRE PROTECTION ENGINEER PRIOR TO ANY WORK BEGINNING.
- A FLOW TEST MUST BE WITNESSED BY THE FIRE DEPARTMENT PRIOR TO OCCUPANCY FOR VERIFICATION OF REQUIRED ON-SITE WATER SUPPLY.
- ALL ON-SITE FIRE MAIN MATERIALS MUST BE U.L. LISTED AND F.M. APPROVED.
- FIRE HYDRANT SPACING:
 - RESIDENTIAL - 500 FEET UNSPRINKLERED, 600 FEET SPRINKLERED
 - COMMERCIAL, INCLUDING MULTI-FAMILY - 300 FEET UNSPRINKLERED, 400 FEET SPRINKLERED.
- NO FIRE HYDRANT SHALL BE LOCATED WITHIN THE REQUIRED RADIUS OF A CUL-DE-SAC OR WITHIN 20 FT. OF THE PERIMETER OF THE RADIUS OF THE CUL-DE-SAC.
- NO FIRE HYDRANT SHALL BE LOCATED WITHIN 6 FT. OF ANY CURB RETURN, DRIVEWAY, POWER POLE, STREET LIGHT OR ANY OTHER OBSTRUCTION.

- ENSURE THAT FIRE HYDRANTS ARE CONNECTED TO A DEPENDABLE WATER SUPPLY CAPABLE OF SUPPLYING THE REQUIRED FIRE FLOW.
- NOT MORE THAN 2 HYDRANTS CAN BE OUT OF SERVICE DUE TO A SINGLE MAIN BREAK.
- THE TURNING RADIUS FOR ANY FIRE APPARATUS ACCESS ROAD AND/OR FIRE LANE, PUBLIC OR PRIVATE SHALL BE NOT LESS THAN 45 FEET OUTSIDE RADIUS AND 22 FEET INSIDE RADIUS.
- FIRE APPARATUS ROAD SHALL BE REQUIRED WHEN ANY PORTION OF AN EXTERIOR WALL OF THE FIRST STORY IS LOCATED MORE THAN 150 FEET FROM FIRE DEPARTMENT VEHICLE ACCESS. (SEE EXCEPTIONS IN UFC 88, SECTION 10.207).
- ALL DEAD END FIRE APPARATUS ACCESS ROADS AND/OR FIRE LANES PUBLIC OR PRIVATE IN EXCESS OF 150 FEET IN LENGTH SHALL BE PROVIDED WITH AN APPROVED TURNAROUND AREA. SEE ORDINANCE NO. 3545.

BUILDING INFORMATION

FIRE FLOW REQUIREMENT IS 2,250 GALLONS PER MINUTE AT 20 POUNDS PER SQUARE INCH RESIDUAL.

BASED ON :

SQUARE FOOTAGE	21,000 SQ. FT.
HEIGHT	1 STORY
ROOF CONSTRUCTION	METAL
SPRINKLER SYSTEM	YES
EXPOSURES	
TYPE OF CONSTRUCTION	TYPE II N
OCCUPANCY	H4

Spring Marshall
FIRE MARSHALL, CITY OF LAS VEGAS
9-13-95
DATE

UTILITY NOTES

- PROVIDE CLEANOUT TO FINISH GRADE (100' OC MAX). SEE PLUMBING PLANS FOR DETAIL.
- CONSTRUCT 4" PVC SDR-35 SEWER LATERAL AT S=0.0425 FT./FT. TRENCH AND BACKFILL PER CCSD STD. DWG. SD-16B.
- POINT OF CONNECTION TO EXIST SEWER LATERAL.
- NATURAL GAS SUPPLY LINE TO BE INSTALLED BY SOUTHWEST GAS AND COORDINATED BY CONTRACTOR. METER FOR SLOW FILL FACILITY WILL BE INSTALLED WHEN FUTURE FACILITY IS CONSTRUCTED. REMOVE & REPLACE A.C. PAVEMENT IN RONEMUS DRIVE AS REQUIRED.
- INSTALL DOUBLE DETECTOR CHECK BACKFLOW ASSEMBLY AND INSULATED ENCLOSURE PER LVVMO UDS PLATE 11D.
- CONSTRUCT 6" WATERLINE.
- CONSTRUCT 2" WATERLINE.
- CONSTRUCT 1 1/2" IRRIGATION TEE, CAP FOR FUTURE EXTENSION.
- POINT OF CONNECTION TO EXIST. 2" PE GAS SERVICE.
- CONSTRUCT 1 1/2" WATERLINE.
- INSTALL 6"x1 1/2" REDUCER AND GATE VALVE.
- INSTALL 6"x2" REDUCER AND GATE VALVE.
- CONSTRUCT 4" PVC SDR-35 STORM DRAIN @ S=0.0188 FT./FT. AND CONNECT TO EXIST DROP INLET. TRENCH & BACKFILL PER CLV USD 503.
- INSTALL (2) 3" SCH. 40 PVC LANDSCAPE IRRIGATION SLEEVE AND (1) 1-1/2" SCH. 40 PVC WIRE CHASE SLEEVE. STUB OUT AND CAP MIN. 2' BEHIND BACK OF CURB.
- INSTALL (1) 2" SCH. 40 PVC LANDSCAPE IRRIGATION SLEEVE. STUB OUT AND CAP MIN. 2' BEHIND BACK OF CURB.
- INSTALL 8" X 6" REDUCER AT POINT OF CONNECTION TO EXIST. 8" LATERAL.
- INSTALL FIRE HYDRANT AT EXIST. WATER LATERAL PER CLV USD 516.

TATE & SNYDER ARCHITECTS

709 Valle Verde Court
Henderson, Nevada 89014
Tel. 702 . 456 . 3000
Fax. 702 . 898 . 6209

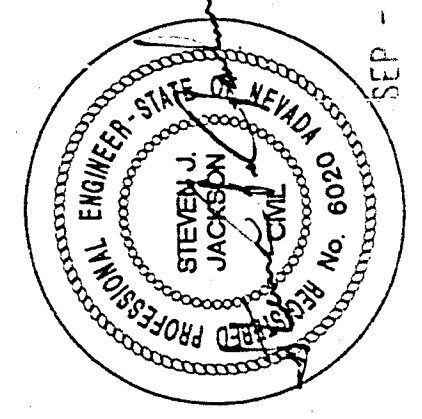

THESE DRAWINGS AND SPECIFICATIONS ARE THE ARCHITECT'S AND MAY BE USED FOR ANY PURPOSE WITHOUT THE ARCHITECT'S WRITTEN CONSENT. THESE DOCUMENTS ARE NOT TO BE USED FOR ANY OTHER PROJECT WITHOUT THE ARCHITECT'S WRITTEN AND SEALED CONSENT.

Consultant
ENGINEERS PLANNERS SURVEYORS
POGGEMEYER DESIGN GROUP
2801 NORTH TANANA WAY LAS VEGAS, NEVADA 89138 (702) 255-8100

Sheet Title
UTILITY PLAN - VEHICLE SERVICES
Project
**CITY OF LAS VEGAS
WEST VEHICLE SERVICE CENTER**

Revisions

Date:
02.05.96
Sheet No.
C1.03
SHEET 4 OF 7