

- CONSTRUCTION NOTES**
- ① 40' ROUND STEEL POLE WITH 4 - G.E. DECAFLOOD - PLQ/400 W.H.P.S. 208 V, REGULATOR BALLAST (CAT. NO. C6706502-0P3) WITH MOUNTING ADAPTER
 - ② 30' ROUND STEEL POLE (C.L.V. 400.1) WITH 1 - G.E. M400A, 120 V, CAT. NO. C7246571 LUMINAIRE, REGULATOR BALLAST, LU-250 LAMP, P.E. CONTROL.
 - ③ 30' ROUND STEEL POLE (C.L.V. 400.1) WITH 2 - G.E. M400A, 240V, REG. BALLAST, LU-250 LAMP (CAT. NO. 67246573)
 - ④ 60 AMP, 3 PHASE, 12 POSITION MIN. PANEL IN SURFACE MOUNT WEATHERTIGHT CABINET.
 - ⑤ THE CONTRACTOR SHALL CONNECT TO THE FUSE PANEL.

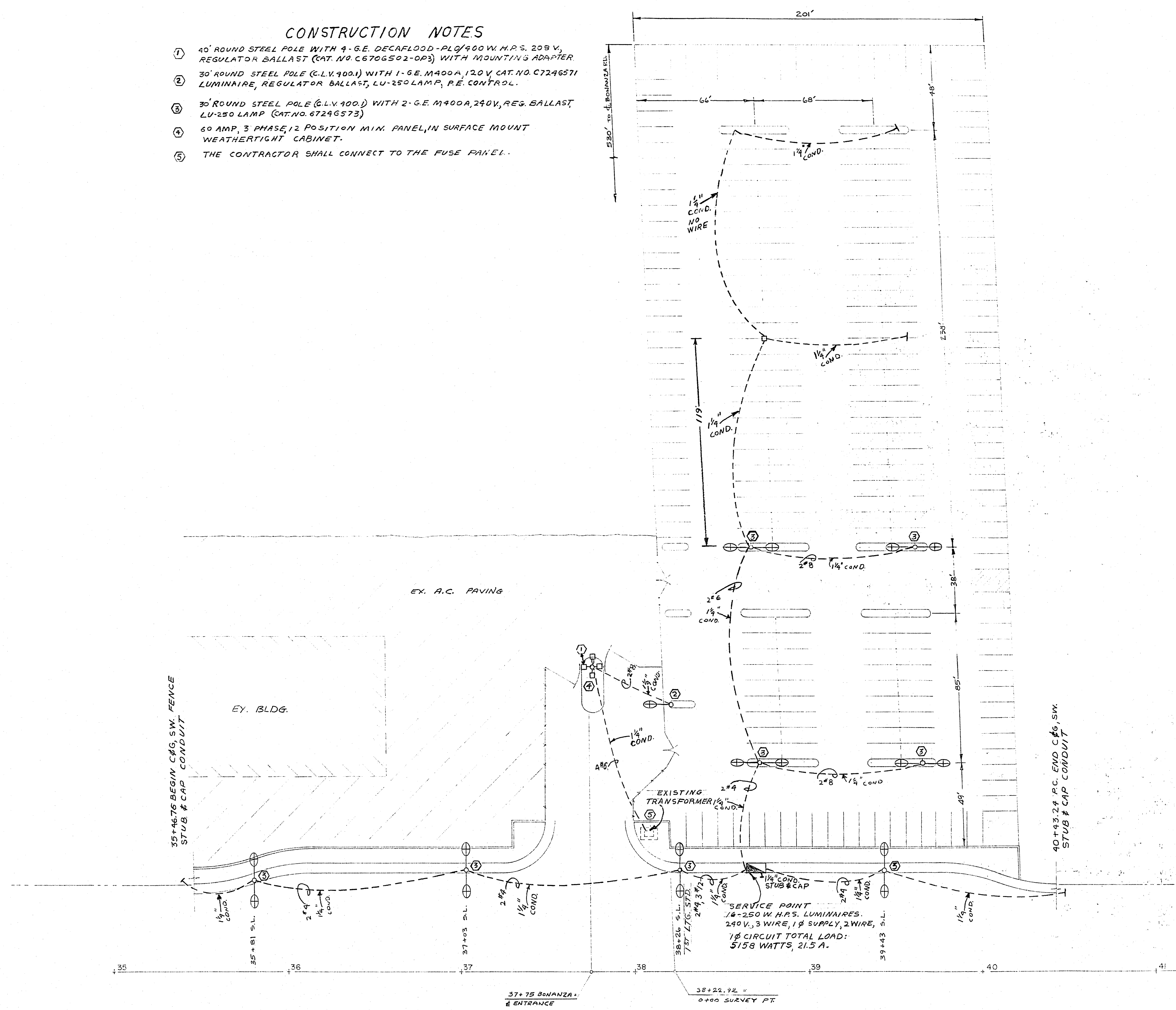

SCALE: 1"=30'

[Signature]
3/28/78

Department of Public Services		Engineering Design Division	
CITY YARDS ENTRANCE AND PARKING		LIGHTING PLAN	
PHASE I		W.O. no. 6595	
Scale (h) 1" = 30'	Scale (v)	Design by S. MOESE	Drawn by
Fid. bk. no.	Date	Approved by the Director of Public Services	
		Date 3/27/78	
		Revisions	
		Date	

