

PLANTING DETAILS
NO SCALE

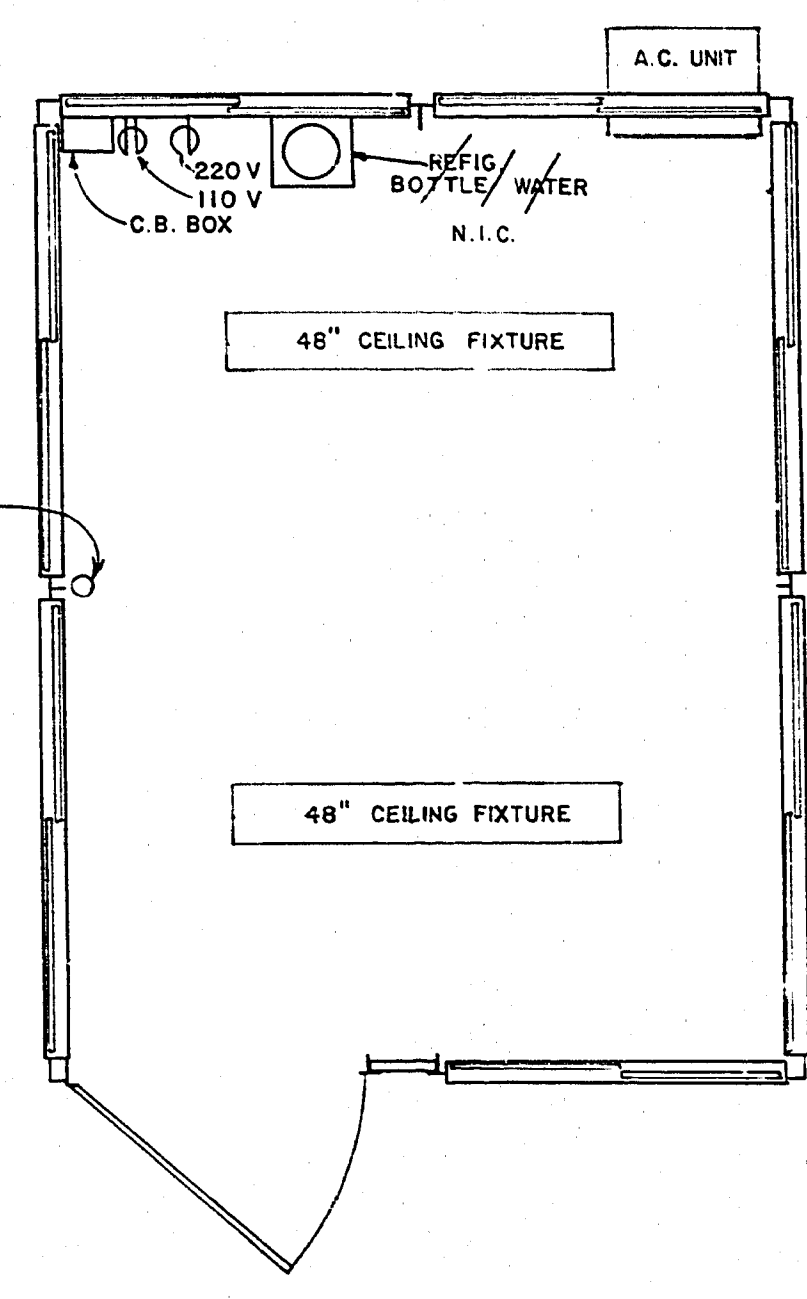
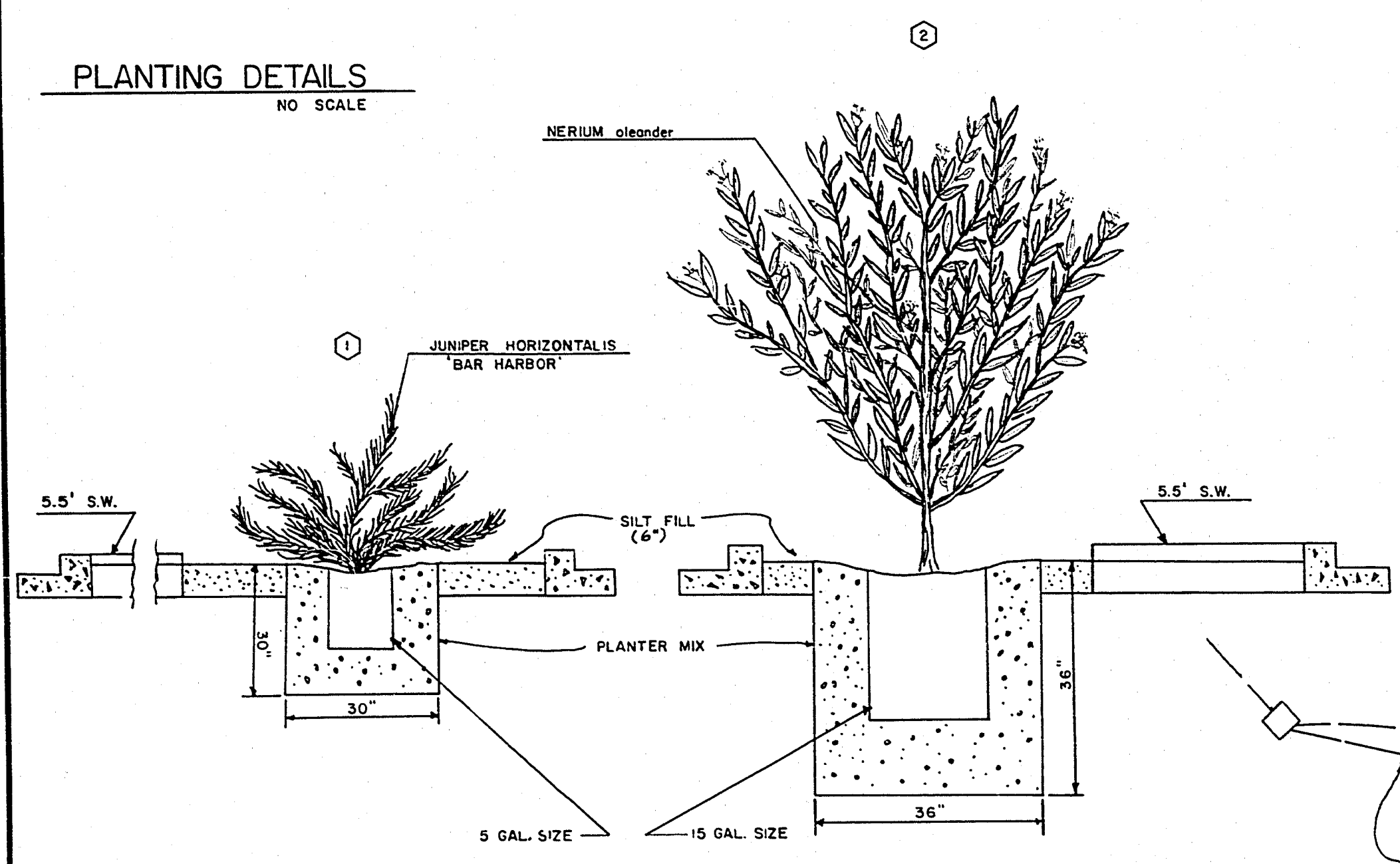

GUARD HOUSE DETAILS
1" = 2"

APPROXIMATE QUANTITIES			
ITEM		UNIT	QUANTITY
105.00	GUARD HOUSE - COMPLETE	L.S.	LS.
212.002	BAR HARBOR JUNIPER (5 GALLON)	E.A.	12
212.005	NERIUM OLEANDER (15 GALLON)	E.A.	39
212.800	6" SILT FILL	C.Y.	80
560.710	IRRIGATION SYSTEM	L.S.	LS.
	2" PVC PIPE SCH. 40	L.F.	360
	1" PVC PIPE SCH. 40	L.F.	440
	1/2" PVC PIPE SCH. 40	L.F.	110
	SHRUBBERY FLAT SPRAY HD.	E.A.	51
	2" MANUAL GATE VALVE W/BOX	E.A.	1
	1" MANUAL GATE VALVE W/BOX	E.A.	2

GENERAL NOTES

- IRRIGATION LINES TO BE 8" DEEP (MINIMUM).
- SHRUBBERY FLAT SPRAY HEADS TO BE RAINBIRD MODEL 2400 FLT-0 OR APPROVED EQUAL AND OPERATE IN THE RANGE OF 15 PSI TO 40 PSI.
- VALVES TO BE PROVIDED WITH CONCRETE BOXES WITH METAL LID.

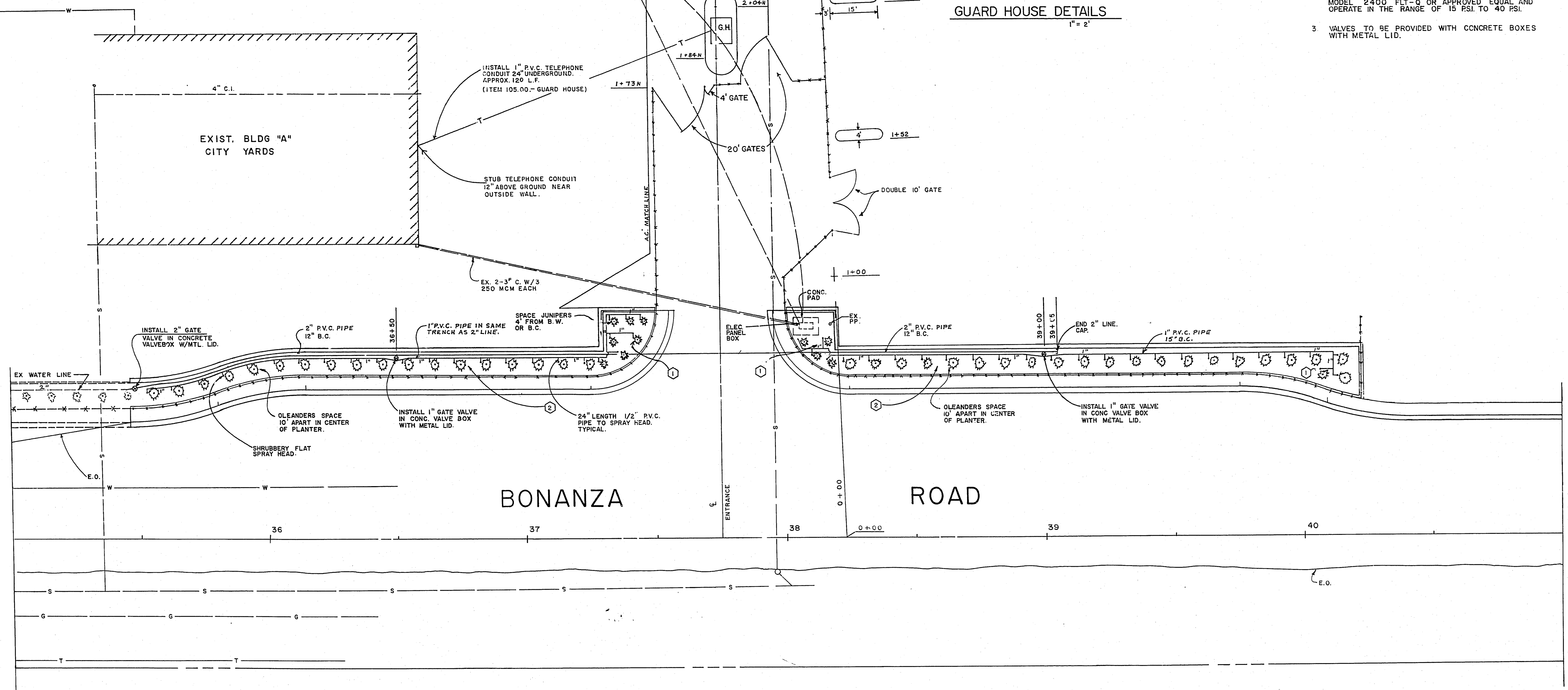

PHASE I

Department of Public Services Engineering Design Division
CITY YARDS PLANTER IRRIGATION & PLANTING
ENTRANCE & PARKING AND
LOT GUARD BUILDING INSTALLATION

W.O. no. 6595
 Scale (v) Date 3/21/78
 Design by D. MCGONIGLE Drawn by M. JONES
 Approved by the Director of Public Services Date 3/29/78

