

City of Las Vegas, Nevada
Office of Architectural Services and Project Control
 Don J. Saylor A.I.P. Deputy City Manager

CITY OF LAS VEGAS
 MUNICIPAL COURT REMODELING
 CARPET PLAN

Design By:	Date:
Drawn By: FGT	Date:
Revised By:	Date:
Revised By:	Date:
Scale:	

Division: TECHNICAL SERVICES

Sheet
 Drawing no:
 521-13-24
 VA 293
 of 1

INSTALLATION INSTRUCTIONS

- COURTROOM 3 AND COURTROOM 3 CHAMBERS:** These areas are to be carpeted by the date specified by the successful bidder as shown on his proposal.
- COURT CLERKS AREA:** This area must be carpeted beginning at 8:00 A.M. August 24, 1980, and must be completed no later than 5:00 P.M. August 26, 1980. This period of time does include any cleanup necessary.
- MUNICIPAL COURTS 1 & 2:** These areas must be carpeted beginning at 8:00 A.M. August 29, 1980, and must be completed no later than 5:00 P.M. August 31, 1980. MUNICIPAL COURT # 1 must be completed by 1:00 P.M. August 30, 1980.
- MISC. INFORMATION:** Commencing at 8:00 A.M. July 31, 1980, the furniture, files, and misc. material located in the Court Clerks area will be moved to Municipal Courts 1 & 2. This move will be completed by 5:00 P.M. August 1, 1980.
- Commencing August 2, 1980 through August 23, 1980, remodeling of the Court Clerks area will be accomplished.
- Commencing at 8:00 A.M. August 24, 1980, the carpeting will be installed in the Court Clerks area and must be completed no later than 5:00 P.M. August 26, 1980.
- Commencing at 8:00 A.M. August 27, 1980, the furniture, files, and misc. items located in Municipal Courts 1 & 2 will be moved back into the Court Clerks area. This move must be completed no later than 3:00 P.M. August 28, 1980 in order for bench removal to begin.
- The benches shown on the drawings in Municipal Courts 1 & 2 will be removed commencing at 3:00 P.M. August 28, 1980, with completion of the removal scheduled for no later than 8:00 A.M. August 29, 1980. In the event the benches have been removed prior to 3:00 A.M. August 29, 1980, the carpeting installation may be started.
- During the installation of the carpeting in Municipal Court 1, new benches are scheduled to be installed in Courtroom 3. When the carpeting has been installed in Courtroom 1, the benches will be reinstalled in Municipal Court 1 while the carpeting is being installed in Courtroom 2. When the carpeting has been installed in Courtroom 2, the benches will be reinstalled in Courtroom 2.
- Successful bidder must submit a seaming diagram of all carpeted areas.
- Benches will be removed and reinstalled and are not part of the carpeting contract.
- When benches are reinstalled, installer must pre-punch holes in carpet prior to drilling.
- Benches in "old" Courtroom 3 to be removed and relocated. Bench A to be installed at A₁. Benches B and C to be installed at B₁ and C₁. Benches D and E to be installed at D₁ and E₁. Benches B and C to be stored until wall graphic is completed.
- New benches will be installed in Courtroom 3.

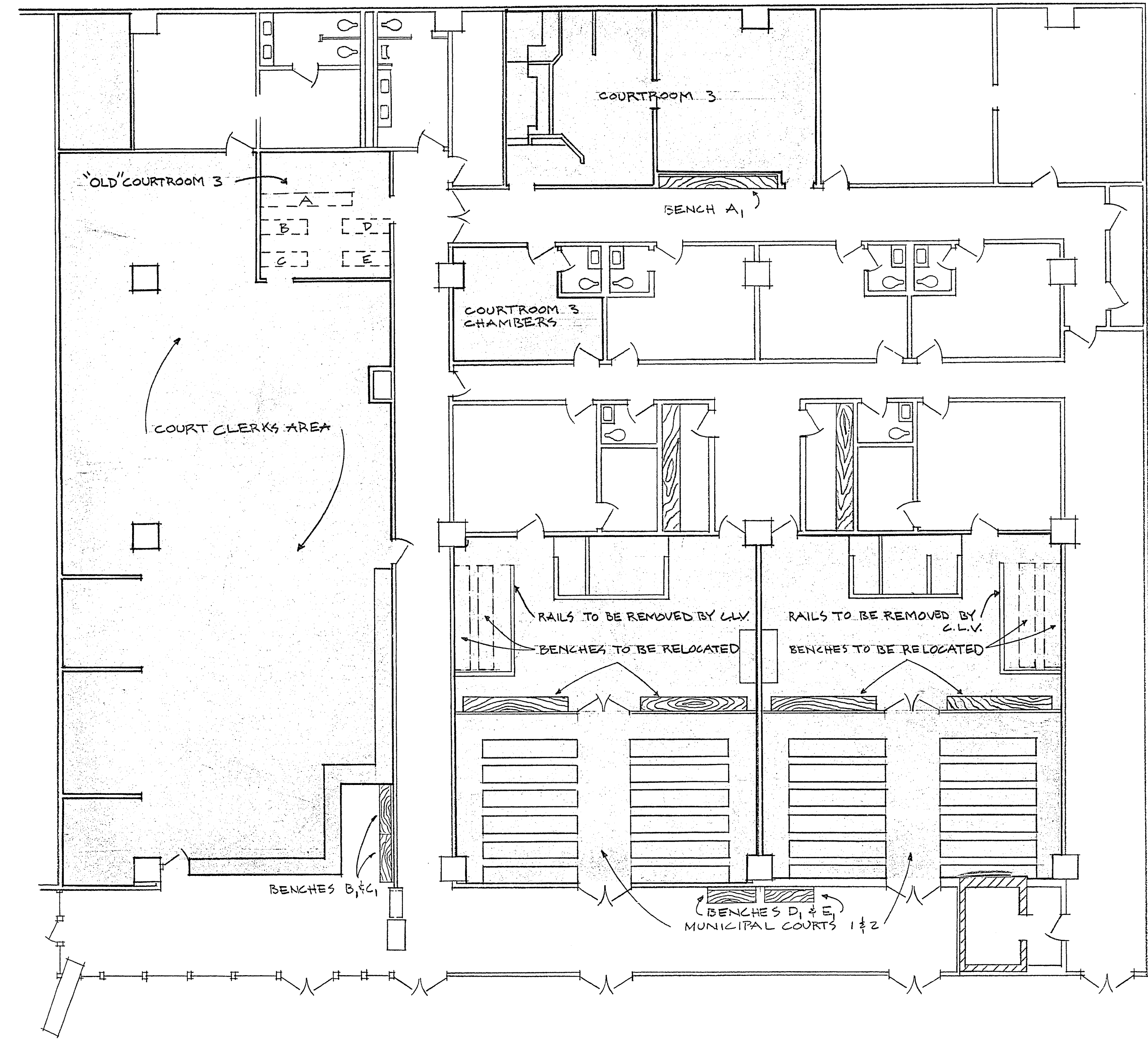

CARPET PLAN
 SCALE: 1/8" = 1'-0"

■ CARPETED AREA. CARPET W/COMPU-CARPET; COMMERCIAL SERIES; COLOR: NATURAL BERBER, # 013.
 763 SQ. YD. ±
 COVE BASE TO BE 4" "BURKE" TOP SET BASE # 597P EXCEPT IN COURT ROOMS 1 & 2; THESE TO BE 6" "BURKE" TOP SET BASE # 597P.
 740 L.F. ± 4" "BURKE"
 523 L.F. ± 6" "BURKE"

APPROVED BY: *[Signature]* DATE: 6/10/80