

LEGEND

1	INSTALL B-36 PULL BOX (24\"X36\"X24\")
2	EXISTING B-36 PULL BOX (24\"X36\"X24\")
3	INSTALL B-50 PULL BOX (13\"X24\"X24\")
4	EXISTING B-50 PULL BOX (13\"X24\"X24\")
5	INSTALL B-100 PULL BOX (24\"X36\"X24\")
6	EXISTING B-100 PULL BOX (24\"X36\"X24\")
7	INSTALL T-200 CATV VAULT (30\"X48\"X36\")
8	EXISTING T-200 CATV VAULT (30\"X48\"X36\")
9	INSTALL T-400 CATV VAULT (36\"X60\"X36\")
10	EXISTING T-400 CATV VAULT (36\"X60\"X36\")
11	INSTALL T-800 CATV VAULT (48\"X72\"X36\")
12	EXISTING T-800 CATV VAULT (48\"X72\"X36\")
13	INSTALL NEW CATV PEDESTAL
14	EXISTING NEW CATV PEDESTAL
15	R&R S/W SLAB(S)
16	POTHOLE
17	— — — — — SIDEWALK/DIRT TRENCH INSTALL
18	— — — — — ASPHALT/STREET TRENCH INSTALL
19	— B — B — PROPOSED BORE
20	— x — x — EXISTING CATV CONDUIT(S)
21	— OHC — PROPOSED OVERHEAD FIBER OPTIC CABLE OR COAX INSTALL
22	— XOHC — EXISTING OVERHEAD FIBER OPTIC CABLE OR COAX
23	— — — — — U.G. FIBER/COAX PULL
24	— — — — — RIGHT OF WAY LINE
25	— — — — — LOT/PROPERTY LINE
26 EDGE OF PAVEMENT
27	P EXISTING NVE PULL BOX
28	T EXISTING TELCO PULL BOX
29	TM EXISTING TELCO MANHOLE
30	T EXISTING TELCO POLE
31	● EXISTING NVE POLE
32	NVE EXISTING NVE TRANSMISSION POLE
33	⊗ EXISTING JOINT POLE
34	⊗ EXISTING JOINT POLE WITH TRANSFORMER
35	⊕ POLE ANCHOR
36	⊕ EXISTING NVE TRANSFORMER TRANSFORMER PAD
37	TS SNWA TEST STATION
38	⊕ COX POWER SUPPLY (49\"X24\"X52\")
39	RC INSTALL RHINO CABINET
40	⊕ RISER POLE/QUADRANT DETAIL RISER OWNERSHIP NOTED
41	RAILROAD
42	MH EXISTING MANHOLE (SS)(SD)...ECT
43	--- 1in CONDUIT LATERAL
44	
45	

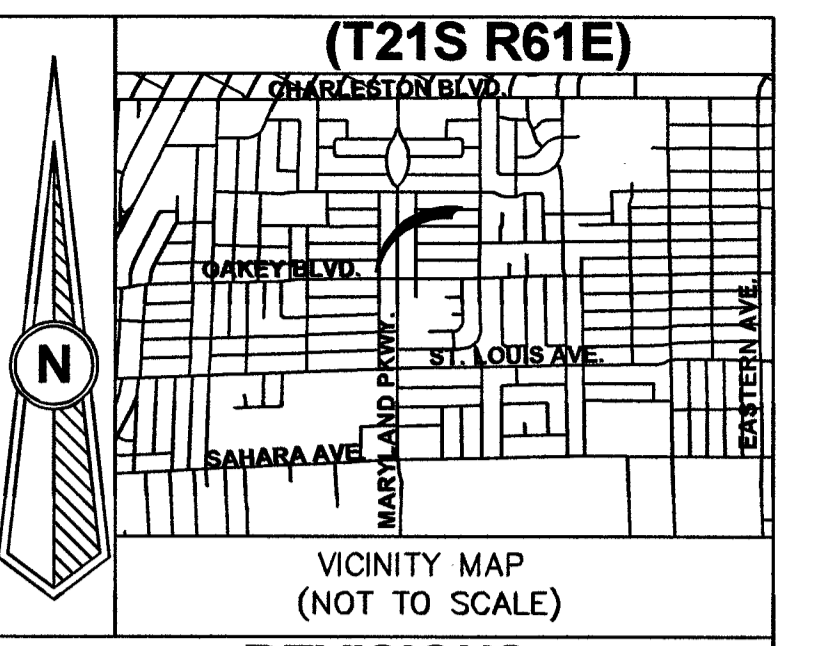

REVISIONS

REV	DESCRIPTION	DATE	BY
△			

ALL CONSTRUCTION AND MATERIALS SHALL BE IN ACCORDANCE WITH THE "UNIFORM STANDARD SPECIFICATIONS FOR PUBLIC WORKS CONSTRUCTION OFF-SITE IMPROVEMENTS, CLARK COUNTY AREA NEVADA" LATEST ISSUE, THE "UNIFORM STANDARD DRAWINGS FOR PUBLIC WORKS CONSTRUCTION, CLARK COUNTY AREA NEVADA" LATEST ISSUE; AND OTHER APPLICABLE APPROVED STANDARDS ISSUED BY THE CONTROLLING AGENCY; ALL LOCAL CITY CODES AND ORDINANCES APPLICABLE.

APPROVED FOR CONSTRUCTION

THIS APPROVAL IS FOR WORK IN CLV RW OR CLV EASEMENT ONLY. OBTAINING PERMISSION OR EASEMENT FOR WORK SHOWN IN PRIVATE PROPERTY IS THE RESPONSIBILITY OF THE UTILITY.

APPROVAL 11 6 17
 DATE

PERMIT #	130006
DRAWN BY:	WTB
DATE:	9-6-17
SCALE:	1:30
NODE:	130006
PROJECT #:	40520170000F130006
TECH #	702-357-6960
APPROVED BY:	CAREY D'AMBRA

COX
 1700 VEGAS DRIVE
 LAS VEGAS, NEVADA 89106
 PHONE: (702) 545-1606
 FAX: (702) 545-2806

DISCLAIMER NOTE

UTILITY LOCATIONS SHOWN HEREON ARE APPROXIMATE ONLY. IT SHALL BE THE CONTRACTOR'S RESPONSIBILITY TO DETERMINE THE EXACT HORIZONTAL AND VERTICAL LOCATION OF ALL EXISTING UNDERGROUND AND OVERHEAD UTILITIES PRIOR TO COMMENCING CONSTRUCTION. NO REPRESENTATION IS MADE THAT ALL EXISTING UTILITIES ARE SHOWN HEREON. THE ENGINEER ASSUMES NO RESPONSIBILITY FOR UTILITIES NOT SHOWN OR UTILITIES NOT SHOWN IN THEIR PROPER LOCATIONS.

AVOID CUTTING UNDERGROUND UTILITY LINES. IT'S COSTLY.
CALL BEFORE YOU DIG
 OR 1-800-227-2600
 UNDERGROUND SERVICE (USA)

AVOID OVERHEAD POWER LINE CONTACT
CALL BEFORE YOU OVERHEAD
 1-702-227-2828
 NEVADA POWER ENVIRONMENT AND SAFETY SERVICE DEPARTMENT

CITY OF LAS VEGAS
 333 N. RANCHO DRIVE
 LAS VEGAS, NEVADA 89106
 (702) 229-6886

CITY/ENTITY:
 CITY OF LAS VEGAS

PROJECT LOCATION:
 S 11TH ST & E OAKLEY BLVD

SUB-CONTRACTOR:
 THE BORING COMPANY

ENTITY NOTES:

TOTAL BORE 359'
 TOTAL DIRT TRENCH 30'
 TOTAL ASPHALT TRENCH 0'
 TOTAL TRENCH 30'
SIDEWALK REMOVAL/REPAIR
 TOTAL S/W PANELS 7
 TOTAL LINEAR FOOTAGE 35'

SHEET NO: **1**
 SHEET 1 OF 1

L 17-00970 10 17 17

TrueNet# 11478