

BLOCK 4
CURTIS PARK MANOR, UNIT No. 2
BOOK 5 OF PLATS, PAGE 24
 (POR. NE 1/4, SEC 24, T. 20S, R. 60E.)

LEGAL DESCRIPTION

That portion of the Northeast Quarter (NE 1/4) of Section 24, Township 20 South, Range 60 East, M.D.M., described as follows:
 BEGINNING at the Northeast corner of the Northeast Quarter (NE 1/4) of said Section 24; thence South 01° 10' 48" West along the East line of said Northeast Quarter (NE 1/4) a distance of 230.00 feet to a point on the Easterly prolongation of the South line of Lot 1, Block 4 of CURTIS PARK MANOR, UNIT No. 2 as shown by map thereof on file in Book 5 of Plats, Page 24, in the Office of the County Recorder of Clark County, Nevada; thence North 88° 42' 42" West along said prolongation and the South line of Lots 1 and 2 of said Block 4 a distance of 290.84 feet to the Southwest corner of said Lot 2; thence North 01° 17' 18" East along the West line of said Lot 2 and the Northerly prolongation thereof, a distance of 230.00 feet to a point on the North line of the Northeast Quarter (NE 1/4) of said Section 24; thence South 88° 42' 42" East along the North line of said Northeast Quarter (NE 1/4) a distance of 290.41 feet to the POINT OF BEGINNING.

SURVEYOR'S CERTIFICATE

I, NOLAN D. MITCHELL, A DULY REGISTERED LAND SURVEYOR, DO HEREBY CERTIFY THAT THIS MAP TRULY AND CORRECTLY REPRESENTS THE RESULTS OF A SURVEY MADE UNDER MY SUPERVISION AND COMPLETED ON THE 5 DAY OF JANUARY, 1978, OF AND FOR THE CITY OF LAS VEGAS, NEVADA. THIS SURVEY IS NOT A SUBDIVISION AS DEFINED IN PLANNING AND ZONING LAW AS SHOWN IN 1943-1949 SUPPLEMENT, NEVADA COMPLIED LAWS.

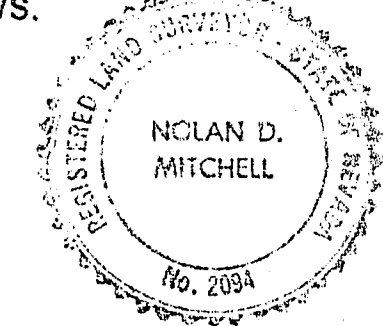

Nolan D. Mitchell
 NOLAN D. MITCHELL, REGISTERED LAND SURVEYOR, No. 2094

APPROVED THIS 9 DAY OF JANUARY, 1978.

William J. Purvis
 WILLIAM J. PURVIS, CITY ENGINEER, R.E. 3336

BASIS OF BEARINGS

THE EAST LINE OF THE NE 1/4 OF SECTION 24, TOWNSHIP 20 SOUTH, RANGE 60 EAST, M.D.M. SHOWN AS S. 01° 10' 48" W. ON MAP OF CURTIS PARK MANOR UNIT No. 2 ON FILE IN BOOK 5 OF PLATS, PAGE 24, CLARK COUNTY, NEVADA, RECORDS.

LEGEND

- FOUND RE-BAR & CAP MARKED R.L.S. 1803
- FOUND C.L.V. BRASS CAP
- ◇ FOUND NAIL & SHINER
- ▷ FOUND P.K. NAIL & SHINER

BOUNDARY SURVEY OF A PORTION OF THE
 NORTHEAST QUARTER OF SECTION 24,
 TOWNSHIP 20 SOUTH, RANGE 60 EAST, M.D.M.
 CLARK COUNTY, NEVADA
 ANNEXED TO THE CITY OF LAS VEGAS, NEVADA
 UNDER ORDINANCE NO. 1905

NO. 792046
 RECORDED AT THE REQUEST OF
 CITY OF LAS VEGAS
 DATE 1-10-78 AT 1:54 P.M.
 FILE 32 PAGE 11
 OF SURVEYS
 OFFICIAL RECORDS BOOK NO. 833
 CLARK COUNTY NEVADA, RECORDS
 JOAN SWIFT
 RECORDER
 FEE D.H.
 DEPUTY G.V.