

SURVEYOR'S CERTIFICATE

I, NOLAN D. MITCHELL, A DULY REGISTERED LAND SURVEYOR, DO HEREBY CERTIFY THAT THIS MAP TRULY AND CORRECTLY REPRESENTS THE RESULTS OF A SURVEY MADE UNDER MY SUPERVISION AND COMPLETED ON THE 20th DAY OF NOVEMBER, 1978, OF AND FOR THE CITY OF LAS VEGAS, NEVADA. THIS SURVEY IS NOT A SUBDIVISION AS DEFINED IN PLANNING AND ZONING LAW AS SHOWN IN 1943 - 1949 SUPPLEMENT, NEVADA COMPILED LAWS.

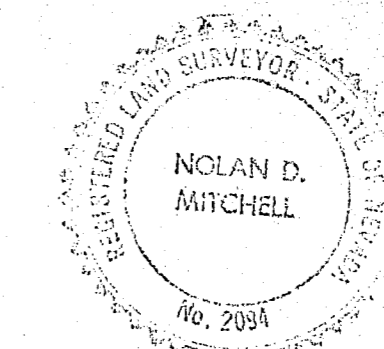

Nolan D. Mitchell
NOLAN D. MITCHELL, REGISTERED LAND SURVEYOR, No. 2094

APPROVED THIS 21st DAY OF MARCH, 1979

Gary W. Holler
GARY W. HOLLER, CITY ENGINEER, R.E. 1920

BASIS OF BEARING

SOUTH 0°11'06" WEST - THE WEST LINE OF CHARLESTON RAINBOW - UNIT 14D AS SHOWN BY MAP THEREOF ON FILE IN BOOK 19 OF PLATS, PAGE 53 IN THE OFFICE OF THE COUNTY RECORDER, CLARK COUNTY, NEVADA.

LEGEND

⊙ FOUND MONUMENT AS NOTED

LEGAL DESCRIPTION

That portion of the North Half (N 1/2) of the Northeast Quarter (NE 1/4) of Section 33, Township 20 South, Range 60 East, M. D. M., County of Clark, State of Nevada, described as follows:
 BEGINNING at the Northwest corner of the Northeast Quarter (NE 1/4) of said Section 33; thence North 88°45'38" East along the North line of said Northeast Quarter (NE 1/4) a distance of 1365.63 feet to the Northwest corner of that certain parcel of land annexed to the City of Las Vegas under Ordinance No. 1941, as shown by map thereof in File 32 of Surveys, Page 85, in the Office of the County Recorder of Clark County, Nevada; thence South 00°11'06" West along the West line of said parcel of land a distance of 1357.89 feet to the Southwest corner of said parcel of land, said Southwest corner also being a point in the South line of the North Half (N 1/2) of the Northeast Quarter (NE 1/4) of said Section 33; thence South 88°56'22" West along said South line a distance of 1359.39 feet to the Southwest corner of the Northwest Quarter (NW 1/4) of the Northeast Quarter (NE 1/4) of said Section 33; thence North 00°04'30" West along the West line of said Northwest Quarter (NW 1/4) of the Northeast Quarter (NE 1/4) a distance of 1353.50 feet to the POINT OF BEGINNING.

BOUNDARY SURVEY OF A PORTION OF THE NORTH HALF OF THE NORTHEAST QUARTER OF SECTION 33, TOWNSHIP 20 SOUTH, RANGE 60 EAST, M. D. M. CLARK COUNTY, NEVADA ANNEXED TO THE CITY OF LAS VEGAS, NEVADA UNDER ORDINANCE No. 1988	NO. <u>0992361</u>
	RECORDED AT THE REQUEST OF CITY OF LAS VEGAS
	DATE <u>4-2-79</u> AT <u>1:54 PM</u>
	FILE <u>33</u> PAGE <u>86</u>
	OF SURVEYS
	OFFICIAL RECORDS BOOK NO. <u>1033</u>
CLARK COUNTY NEVADA, RECORDS	
JOAN SWIFT RECORDER	
FEE <u>DH</u>	
DEPUTY <u>BH B</u>	