

LEGEND	
1	INSTALL B-36 PULL BOX (24"x36"x24")
2	EXISTING B-36 PULL BOX (24"x36"x24")
3	INSTALL B-50 PULL BOX (13"x24"x24")
4	EXISTING B-50 PULL BOX (13"x24"x24")
5	INSTALL B-100 PULL BOX (24"x36"x24")
6	EXISTING B-100 PULL BOX (24"x36"x24")
7	INSTALL T-200 CATV VAULT (30"x48"x36")
8	EXISTING T-200 CATV VAULT (30"x48"x36")
9	INSTALL T-400 CATV VAULT (36"x60"x36")
10	EXISTING T-400 CATV VAULT (36"x60"x36")
11	INSTALL T-600 CATV VAULT (48"x72"x36")
12	EXISTING T-600 CATV VAULT (48"x72"x36")
13	INSTALL NEW CATV PEDESTAL
14	EXISTING NEW CATV PEDESTAL
15	R&R S/W SLAB(S)
16	POTHOLE
17	--- SIDEWALK/DIRT TRENCH INSTALL
18	--- ASPHALT/STREET TRENCH INSTALL
19	--- PROPOSED BORE
20	EXISTING CATV CONDUIT(S)
21	--- PROPOSED OVERHEAD FIBER OPTIC CABLE OR COAX INSTALL
22	--- EXISTING OVERHEAD FIBER OPTIC CABLE OR COAX
23	--- U.G. FIBER/COAX PULL
24	--- RIGHT OF WAY LINE
25	--- LOT/PROPERTY LINE
26	EDGE OF PAVEMENT
27	P EXISTING NVE PULL BOX
28	T EXISTING TELCO PULL BOX
29	TM EXISTING TELCO MANHOLE
30	T EXISTING TELCO POLE
31	EXISTING NVE POLE
32	EXISTING NVE TRANSMISSION POLE
33	EXISTING JOINT POLE
34	EXISTING JOINT POLE WITH TRANSFORMER
35	POLE ANCHOR
36	EXISTING NVE TRANSFORMER TRANSFORMER PAD
37	SNWA TEST STATION
38	COX POWER SUPPLY (49"x24"x52")
39	RC INSTALL RHINO CABINET
40	RISER POLE/QUADRANT DETAIL RISER OWNERSHIP NOTED
41	RAILROAD
42	EXISTING MANHOLE (SS),(SD)...ECT
43	--- 1in CONDUIT LATERAL
44	
45	

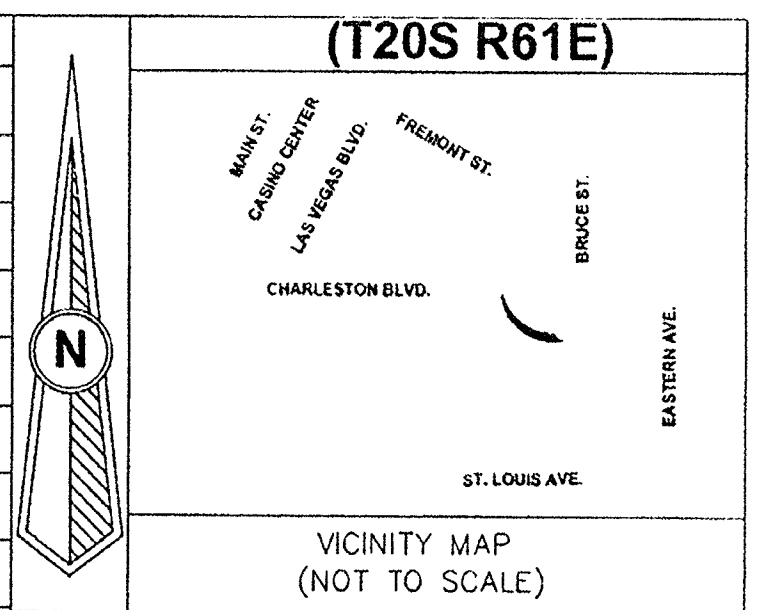

REVISIONS			
REV	DESCRIPTION	DATE	BY
1			
2			
3			
4			
5			
6			
7			
8			
9			
10			
11			
12			
13			
14			
15			
16			
17			
18			
19			
20			
21			
22			
23			
24			
25			
26			
27			
28			
29			
30			
31			
32			
33			
34			
35			
36			
37			
38			
39			
40			
41			
42			
43			
44			
45			

ALL CONSTRUCTION AND MATERIALS SHALL BE IN ACCORDANCE WITH THE "UNIFORM STANDARD SPECIFICATIONS FOR PUBLIC WORKS CONSTRUCTION OFF-SITE IMPROVEMENTS, CLARK COUNTY AREA NEVADA" LATEST ISSUE; THE "UNIFORM STANDARD DRAWINGS FOR PUBLIC WORKS CONSTRUCTION, CLARK COUNTY AREA NEVADA" LATEST ISSUE; AND OTHER APPLICABLE APPROVED STANDARDS ISSUED BY THE CONTROLLING AGENCY; ALL LOCAL CITY CODES AND ORDINANCES APPLICABLE.

APPROVED FOR CONSTRUCTION
 THIS APPROVAL IS FOR WORK IN CLV RW OR CLV EASEMENT ONLY. OBTAINING PERMISSION OR EASEMENT FOR WORK SHOWN IN PRIVATE PROPERTY IS THE RESPONSIBILITY OF THE UTILITY.

APPROVAL: [Signature] DATE: 8 24 17

PERMIT #	130050
DRAWN BY:	WTB
DATE:	8-3-17
SCALE:	1:20
NODE:	130050
DESIGNER:	40520170000F130050
TECH #	702-265-8505
APPROVED BY:	WILLIAM BESECKER

COX
 1700 VEGAS DRIVE
 LAS VEGAS, NEVADA 89106
 PHONE: (702) 545-1606
 FAX: (702) 545-2606

DISCLAIMER NOTE
 UTILITY LOCATIONS SHOWN HEREON ARE APPROXIMATE ONLY. IT SHALL BE THE CONTRACTOR'S RESPONSIBILITY TO DETERMINE THE EXACT HORIZONTAL AND VERTICAL LOCATION OF ALL EXISTING UNDERGROUND AND OVERHEAD UTILITIES PRIOR TO COMMENCING CONSTRUCTION. NO REPRESENTATION IS MADE THAT ALL EXISTING UTILITIES ARE SHOWN HEREON. THE ENGINEER ASSUMES NO RESPONSIBILITY FOR UTILITIES NOT SHOWN OR UTILITIES NOT SHOWN IN THEIR PROPER LOCATIONS.

CALL BEFORE YOU DIG
 1-800-227-2600
 UNDERGROUND SERVICE (USA)

CALL BEFORE YOU OVERHEAD
 1-702-227-2929
 NEVADA POWER LABORERS AND SAFETY SERVICE DEPARTMENT

TOTAL BORE	222'
TOTAL DIRT TRENCH	0'
TOTAL ASPHALT TRENCH	5'
TOTAL TRENCH	5'
TOTAL S/W PANELS	3
TOTAL LINEAR FOOTAGE	15'

CITY OF LAS VEGAS
 333 N. RANCHO DRIVE
 LAS VEGAS, NEVADA 89106
 (702) 229-6885

PROJECT LOCATION: S 16TH ST & E CHARLESTON BLVD

SUB-CONTRACTOR: TBD

ENTRY NOTES:

SHEET No: **1**

SHEET 1 OF 1

