

MATCHLINE "A" SEE SHEET 2 OF 3

LEGEND

1	INSTALL B-36 PULL BOX (24"X36"X24")
2	EXISTING B-36 PULL BOX (24"X36"X24")
3	INSTALL B-50 PULL BOX (13"X24"X24")
4	EXISTING B-50 PULL BOX (13"X24"X24")
5	INSTALL B-100 PULL BOX (24"X36"X24")
6	EXISTING B-100 PULL BOX (24"X36"X24")
7	INSTALL T-200 CATV VAULT (30"X48"X36")
8	EXISTING T-200 CATV VAULT (30"X48"X36")
9	INSTALL T-400 CATV VAULT (36"X60"X36")
10	EXISTING T-400 CATV VAULT (36"X60"X36")
11	INSTALL T-600 CATV VAULT (48"X72"X36")
12	EXISTING T-600 CATV VAULT (48"X72"X36")
13	INSTALL NEW CATV PEDESTAL
14	EXISTING NEW CATV PEDESTAL
15	R&R S/W SLAB(S)
16	POTHOLE
17	—C—C— SIDEWALK/DIRT TRENCH INSTALL
18	—C—C— ASPHALT/STREET TRENCH INSTALL
19	—B—B— PROPOSED BORE
20	—X—X— EXISTING CATV CONDUIT(S)
21	—OHC— PROPOSED OVERHEAD FIBER OPTIC CABLE OR COAX INSTALL
22	—OHC— EXISTING OVERHEAD FIBER OPTIC CABLE OR COAX
23	—U.G.— U.G. FIBER/COAX PULL
24	—R/W— RIGHT OF WAY LINE
25	—LOT— LOT/PROPERTY LINE
26	—E/P— EDGE OF PAVEMENT
27	P EXISTING NVE PULL BOX
28	T EXISTING TELCO PULL BOX
29	TM EXISTING TELCO MANHOLE
30	T EXISTING TELCO POLE
31	NVE EXISTING NVE POLE
32	NVE EXISTING NVE TRANSMISSION POLE
33	J EXISTING JOINT POLE
34	JW EXISTING JOINT POLE WITH TRANSFORMER
35	A POLE ANCHOR
36	TS EXISTING NVE TRANSFORMER TRANSFORMER PAD
37	TS SNWA TEST STATION
38	TS COX POWER SUPPLY (49"X24"X52")
39	RC INSTALL RHINO CABINET
40	RISER POLE/QUADRANT DETAIL RISER OWNERSHIP NOTED
41	RAILROAD
42	MH EXISTING MANHOLE (SS),(SD)...ECT
43	—1in— 1in CONDUIT LATERAL
44	
45	

DISCLAIMER NOTE

UTILITY LOCATIONS SHOWN HEREON ARE APPROXIMATE ONLY. IT SHALL BE THE CONTRACTOR'S RESPONSIBILITY TO DETERMINE THE EXACT HORIZONTAL AND VERTICAL LOCATION OF ALL EXISTING UNDERGROUND AND OVERHEAD UTILITIES PRIOR TO COMMENCING CONSTRUCTION. NO REPRESENTATION IS MADE THAT ALL EXISTING UTILITIES ARE SHOWN HEREON. THE ENGINEER ASSUMES NO RESPONSIBILITY FOR UTILITIES NOT SHOWN OR UTILITIES NOT SHOWN IN THEIR PROPER LOCATIONS.

FOR BETTER UNDERGROUND TRAFFIC SIGNAL SYSTEMS AND TRAFFIC SIGNAL SYSTEMS CALL BEFORE YOU DIG. IT'S COELEY.

CALL BEFORE YOU UNDERGROUND. CALL BEFORE YOU UNDERGROUND. CALL BEFORE YOU UNDERGROUND. CLARK COUNTY TRAFFIC OPERATIONS AND LAS VEGAS AREA COMPUTERIZED SYSTEM.

AVOID CUTTING UNDERGROUND UTILITY LINES. IT'S COSTLY. CALL BEFORE YOU DIG OR 1-800-227-2600 UNDERGROUND SERVICE (USA)

AVOID OVERHEAD POWER LINE CONTACT. CALL BEFORE YOU OVERHEAD. 1-702-227-2929 NEVADA POWER ENVIRONMENT AND SAFETY SERVICE DEPARTMENT

TOTAL BORE 0'
 TOTAL DIRT TRENCH 0'
 TOTAL ASPHALT TRENCH 0'
 TOTAL TRENCH 0'
 SIDEWALK REMOVAL/REPAIR
 TOTAL S/W PANELS 1
 TOTAL LINEAR FOOTAGE 5'

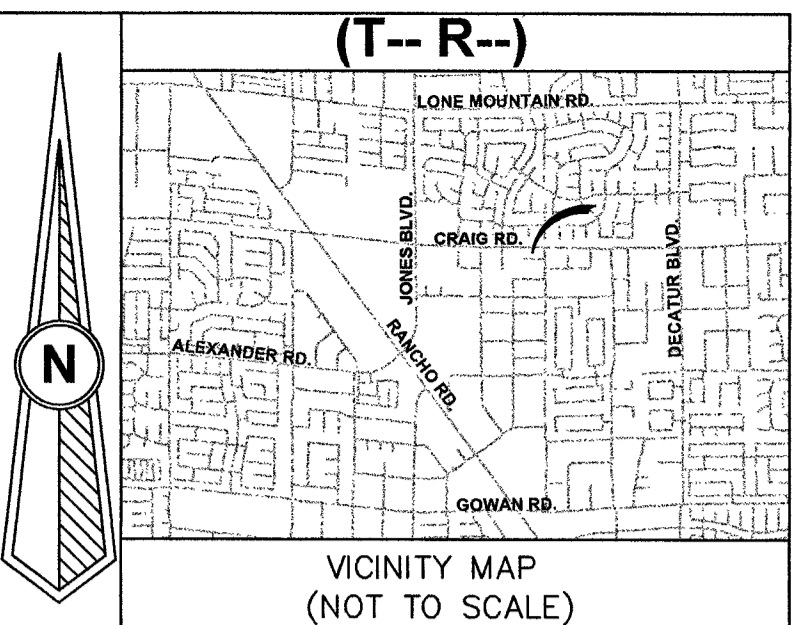

REVISIONS

REV	DESCRIPTION	DATE	BY
△			

ALL CONSTRUCTION AND MATERIALS SHALL BE IN ACCORDANCE WITH THE "UNIFORM STANDARD SPECIFICATIONS FOR PUBLIC WORKS CONSTRUCTION OFF-SITE IMPROVEMENTS, CLARK COUNTY AREA NEVADA" LATEST ISSUE; THE "UNIFORM STANDARD DRAWINGS FOR PUBLIC WORKS CONSTRUCTION, CLARK COUNTY AREA NEVADA", LATEST ISSUE; AND OTHER APPLICABLE APPROVED STANDARDS ISSUED BY THE CONTROLLING AGENCY; ALL LOCAL CITY CODES AND ORDINANCES APPLICABLE.

APPROVED FOR CONSTRUCTION

THIS APPROVAL IS FOR WORK IN CLV R/W OR CLV EASEMENT ONLY. OBTAINING PERMISSION OR EASEMENT FOR WORK SHOWN IN PRIVATE PROPERTY IS THE RESPONSIBILITY OF THE UTILITY.

APPROVAL: *[Signature]* DATE: 7/19/17

PERMIT # 13215-05
 DRAWN BY: WTB
 DATE: 6-19-17
 SCALE: 1:40
 NODE: N/A
 DESIGNER: 40505170000REB3RDP
 TECH # 702-210-7024
 APPROVED BY: GENE SIEGEL

COX
 1700 VEGAS DRIVE
 LAS VEGAS, NEVADA 89106
 PHONE: (702) 545-1006
 FAX: (702) 545-2606

CITY/ENTITY: CITY OF LAS VEGAS
 333 N. RANCHO DRIVE
 LAS VEGAS, NEVADA 89106
 (702) 229-6885

PROJECT LOCATION: W CRAIG RD & BRADLEY RD

SUB-CONTRACTOR: CLOVER

ENTITY NOTES:

SHEET No: 1

SHEET 1 OF 3

7/5/17
 17-00199
 TrueNet# 11069

MATCHLINE "A" SEE SHEET 1 OF 3

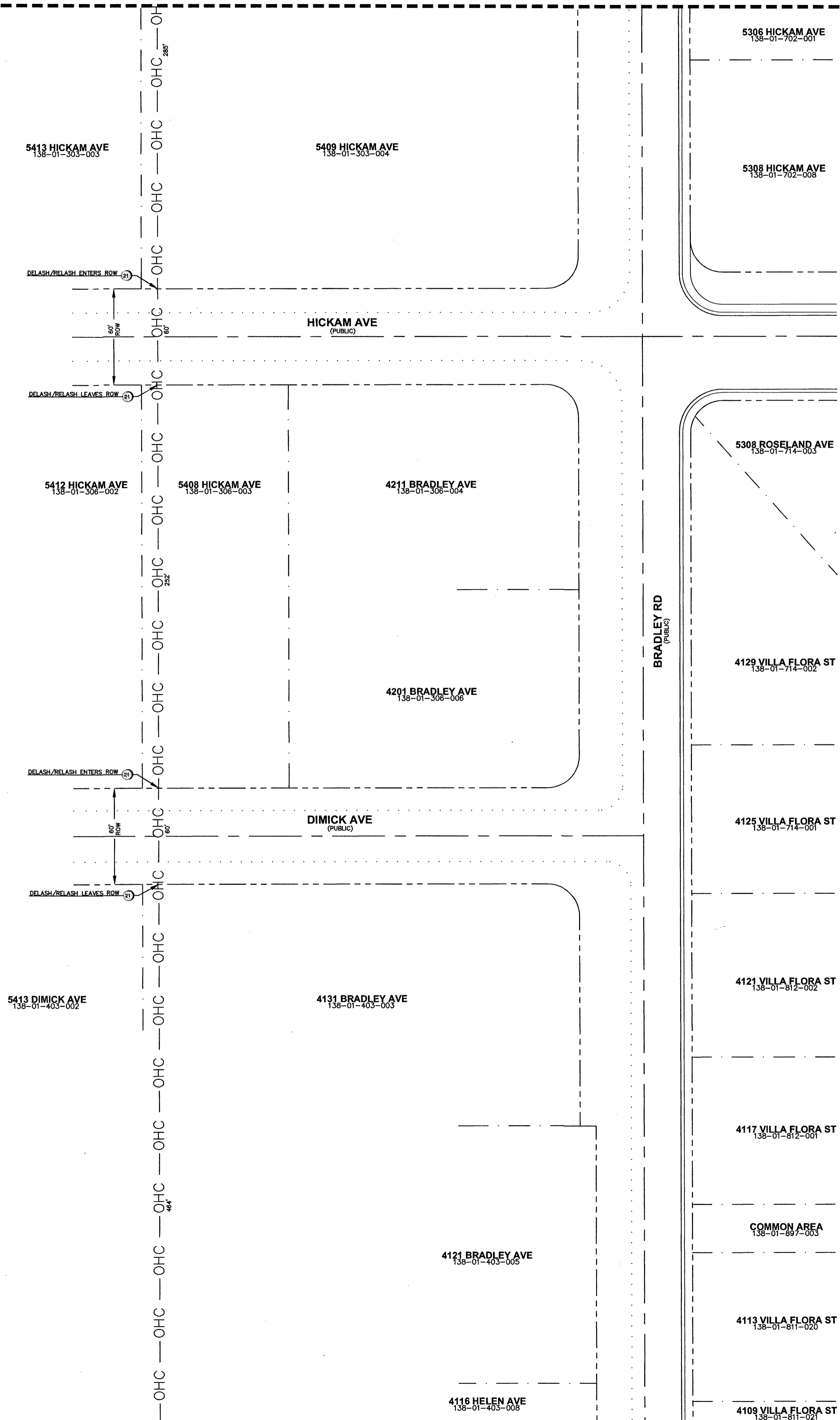

MATCHLINE "B" SEE SHEET 3 OF 3

LEGEND

1	INSTALL B-36 PULL BOX (24"X36"X24")
2	EXISTING B-36 PULL BOX (24"X36"X24")
3	INSTALL B-50 PULL BOX (13"X24"X24")
4	EXISTING B-50 PULL BOX (13"X24"X24")
5	INSTALL B-100 PULL BOX (24"X36"X24")
6	EXISTING B-100 PULL BOX (24"X36"X24")
7	INSTALL T-200 CATV VAULT (30"X48"X36")
8	EXISTING T-200 CATV VAULT (30"X48"X36")
9	INSTALL T-400 CATV VAULT (36"X60"X36")
10	EXISTING T-400 CATV VAULT (36"X60"X36")
11	INSTALL T-600 CATV VAULT (48"X72"X36")
12	EXISTING T-600 CATV VAULT (48"X72"X36")
13	INSTALL NEW CATV PEDESTAL
14	EXISTING NEW CATV PEDESTAL
15	R&R S/W SLAB(S)
16	POTHOLE
17	— — — — — SIDEWALK/DIRT TRENCH INSTALL
18	— — — — — ASPHALT/STREET TRENCH INSTALL
19	— — — — — PROPOSED BORE
20	— — — — — EXISTING CATV CONDUIT(S)
21	— OHC — PROPOSED OVERHEAD FIBER OPTIC CABLE OR COAX INSTALL
22	— OHC — EXISTING OVERHEAD FIBER OPTIC CABLE OR COAX
23	— — — — — U.G. FIBER/COAX PULL
24	— — — — — RIGHT OF WAY LINE
25	— — — — — LOT/PROPERTY LINE
26 EDGE OF PAVEMENT
27	P EXISTING NVE PULL BOX
28	T EXISTING TELCO PULL BOX
29	TM EXISTING TELCO MANHOLE
30	T EXISTING TELCO POLE
31	EXISTING NVE POLE
32	NVE EXISTING NVE TRANSMISSION POLE
33	EXISTING JOINT POLE
34	EXISTING JOINT POLE WITH TRANSFORMER
35	POLE ANCHOR
36	EXISTING NVE TRANSFORMER TRANSFORMER PAD
37	TS SNWA TEST STATION
38	COX POWER SUPPLY (49"X24"X52")
39	RC INSTALL RHINO CABINET
40	RISER POLE/QUADRANT DETAIL RISER OWNERSHIP NOTED
41	RAILROAD
42	MH EXISTING MANHOLE (SS),(SD)...ECT
43	— — — — — 1in CONDUIT LATERAL
44	
45	

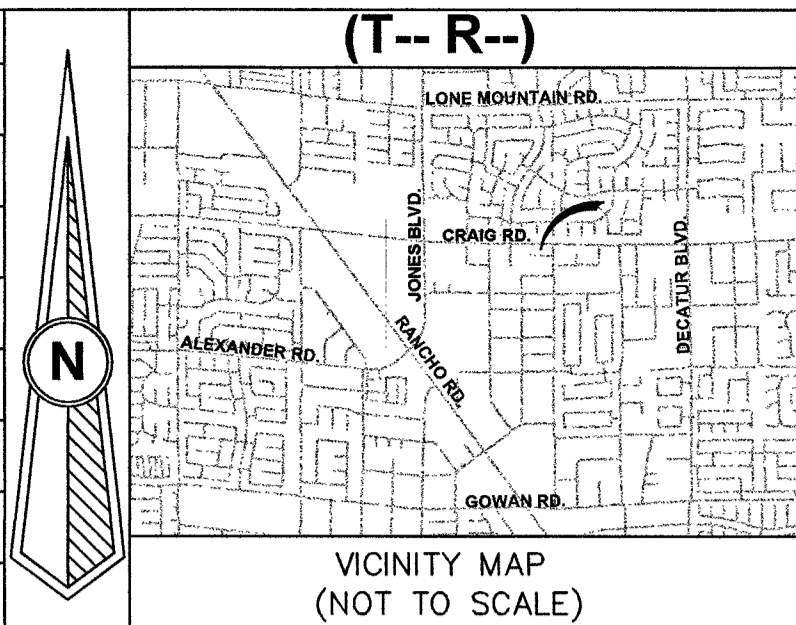

REVISIONS

REV	DESCRIPTION	DATE	BY
△			

ALL CONSTRUCTION AND MATERIALS SHALL BE IN ACCORDANCE WITH THE "UNIFORM STANDARD SPECIFICATIONS FOR PUBLIC WORKS CONSTRUCTION OFF-SITE IMPROVEMENTS, CLARK COUNTY AREA NEVADA" LATEST ISSUE; THE "UNIFORM STANDARD DRAWINGS FOR PUBLIC WORKS CONSTRUCTION, CLARK COUNTY AREA NEVADA", LATEST ISSUE; AND OTHER APPLICABLE APPROVED STANDARDS ISSUED BY THE CONTROLLING AGENCY; ALL LOCAL CITY CODES AND ORDINANCES APPLICABLE.

APPROVED FOR CONSTRUCTION
 THIS APPROVAL IS FOR WORK IN CLV R/W OR CLV EASEMENT ONLY. OBTAINING PERMISSION OR EASEMENT FOR WORK SHOWN IN PRIVATE PROPERTY IS THE RESPONSIBILITY OF THE UTILITY.

PERMIT #	13215-05
DRAWN BY:	
WTB	
DATE:	6-19-17
SCALE:	1:40
NOB:	N/A
DESIGNER:	40505170000REB3RDP
TECH #	
APPROVED BY:	702-210-7024
	GENE SIEGEL

DISCLAIMER NOTE

UTILITY LOCATIONS SHOWN HEREON ARE APPROXIMATE ONLY. IT SHALL BE THE CONTRACTOR'S RESPONSIBILITY TO DETERMINE THE EXACT HORIZONTAL AND VERTICAL LOCATION OF ALL EXISTING UNDERGROUND AND OVERHEAD UTILITIES PRIOR TO COMMENCING CONSTRUCTION. NO REPRESENTATION IS MADE THAT ALL EXISTING UTILITIES ARE SHOWN HEREON. THE ENGINEER ASSUMES NO RESPONSIBILITY FOR UTILITIES NOT SHOWN OR UTILITIES NOT SHOWN IN THEIR PROPER LOCATIONS.

BEFORE YOU DIG
 OR 1-800-227-2600
 UNDERGROUND SERVICE (USA)

CALL BEFORE YOU DIG
 1-702-432-4300
 CLARK COUNTY TRAFFIC OPERATIONS
 LAS VEGAS AREA COMPUTERIZED SYSTEM

BEFORE YOU OVERHEAD
 1-702-227-2929
 NEVADA POWER ENVIRONMENT AND SAFETY SERVICE DEPARTMENT

AVOID CUTTING UNDERGROUND UTILITY LINES. IT'S COSTLY.
 CALL BEFORE YOU DIG

AVOID OVERHEAD POWER LINE CONTACT
 CALL BEFORE YOU OVERHEAD

TOTAL BORE	0'
TOTAL DIRT TRENCH	0'
TOTAL ASPHALT TRENCH	0'
TOTAL TRENCH	0'
TOTAL S/W PANELS	1
TOTAL LINEAR FOOTAGE	5'

CITY/ENTITY:
CITY OF LAS VEGAS
 333 N. RANCHO DRIVE
 LAS VEGAS, NEVADA 89106
 (702) 229-6885

PROJECT LOCATION:
W CRAIG RD & BRADLEY RD

SUB-CONTRACTOR:
CLOVER

ENTITY NOTES:
2

SHEET No: **2**

SHEET 2 OF 3

7/5/17
 117-00199
 TrueNet# 11069

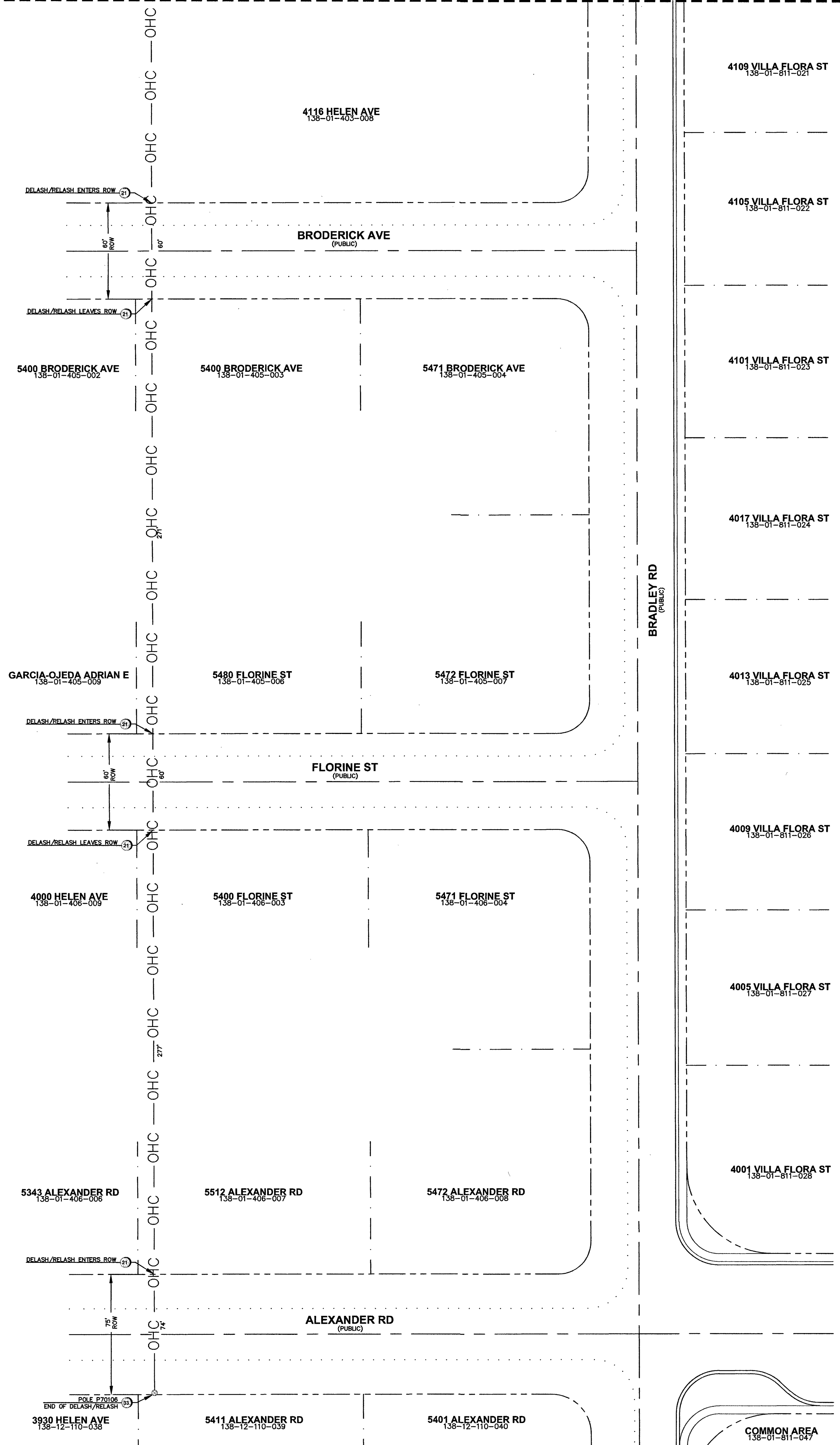

LEGEND

1	INSTALL B-36 PULL BOX (24"x36"x24")
2	EXISTING B-36 PULL BOX (24"x36"x24")
3	INSTALL B-50 PULL BOX (13"x24"x24")
4	EXISTING B-50 PULL BOX (13"x24"x24")
5	INSTALL B-100 PULL BOX (24"x36"x24")
6	EXISTING B-100 PULL BOX (24"x36"x24")
7	INSTALL T-200 CATV VAULT (30"x48"x36")
8	EXISTING T-200 CATV VAULT (30"x48"x36")
9	INSTALL T-400 CATV VAULT (36"x60"x36")
10	EXISTING T-400 CATV VAULT (36"x60"x36")
11	INSTALL T-600 CATV VAULT (48"x72"x36")
12	EXISTING T-600 CATV VAULT (48"x72"x36")
13	INSTALL NEW CATV PEDESTAL
14	EXISTING NEW CATV PEDESTAL
15	R&R S/W SLAB(S)
16	POTHOLE
17	—c—c—c— SIDEWALK/DIRT TRENCH INSTALL
18	—c—c—c— ASPHALT/STREET TRENCH INSTALL
19	—b—b— PROPOSED BORE
20	—x—x—x— EXISTING CATV CONDUIT(S)
21	—OHC— PROPOSED OVERHEAD FIBER OPTIC CABLE OR COAX INSTALL
22	—x—x—x— EXISTING OVERHEAD FIBER OPTIC CABLE OR COAX
23	— — — U.G. FIBER/COAX PULL
24	— — — RIGHT OF WAY LINE
25	— — — LOT/PROPERTY LINE
26 EDGE OF PAVEMENT
27	P EXISTING NVE PULL BOX
28	T EXISTING TELCO PULL BOX
29	TM EXISTING TELCO MANHOLE
30	T EXISTING TELCO POLE
31	EXISTING NVE POLE
32	NVE EXISTING NVE TRANSMISSION POLE
33	EXISTING JOINT POLE
34	EXISTING JOINT POLE WITH TRANSFORMER
35	POLE ANCHOR
36	EXISTING NVE TRANSFORMER TRANSFORMER PAD
37	TS SNWA TEST STATION
38	COX POWER SUPPLY (49"x24"x52")
39	RC INSTALL RHINO CABINET
40	RISER POLE/QUADRANT DETAIL RISER OWNERSHIP NOTED
41	RAILROAD
42	MT EXISTING MANHOLE (SS)(SD)...ECT
43	— — — 1in CONDUIT LATERAL
44	
45	

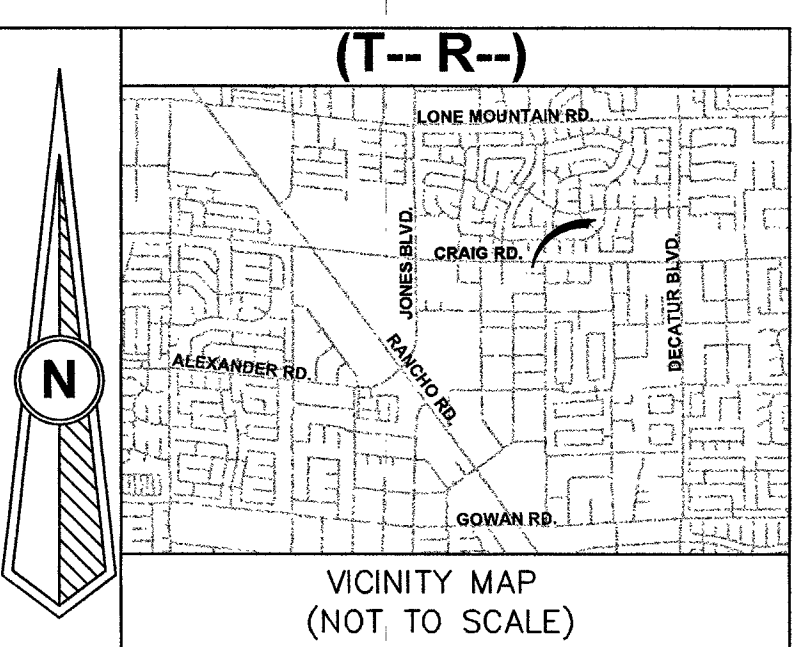

REVISIONS

REV	DESCRIPTION	DATE	BY
△			

ALL CONSTRUCTION AND MATERIALS SHALL BE IN ACCORDANCE WITH THE "UNIFORM STANDARD SPECIFICATIONS FOR PUBLIC WORKS CONSTRUCTION OFF-SITE IMPROVEMENTS, CLARK COUNTY AREA NEVADA" LATEST ISSUE; THE "UNIFORM STANDARD DRAWINGS FOR PUBLIC WORKS CONSTRUCTION, CLARK COUNTY AREA NEVADA", LATEST ISSUE; AND OTHER APPLICABLE APPROVED STANDARDS ISSUED BY THE CONTROLLING AGENCY; ALL LOCAL CITY CODES AND ORDINANCES APPLICABLE.

APPROVED FOR CONSTRUCTION
 THIS APPROVAL IS FOR WORK IN CLV RW OR CLV EASEMENT ONLY. OBTAINING PERMISSION OR EASEMENT FOR WORK SHOWN IN PRIVATE PROPERTY IS THE RESPONSIBILITY OF THE UTILITY.

APPROVAL	DATE

PERMIT # 13215-05
 DRAWN BY: WTB
 DATE: 6-19-17
 SCALE: 1:40
 NODE: N/A
 DESIGNER: 40505170000REB3RDP
 TECH # 702-210-7024
 APPROVED BY: GENE SIEGEL

COX
 1700 VEGAS DRIVE
 LAS VEGAS, NEVADA 89106
 PHONE: (702) 545-1606
 FAX: (702) 545-2606

CITY OF LAS VEGAS
 333 N. RANCHO DRIVE
 LAS VEGAS, NEVADA 89106
 (702) 229-6885

PROJECT LOCATION: W CRAIG RD & BRADLEY RD
 SUB-CONTRACTOR: CLOVER
 ENTITY NOTES:

SHEET No: **3**
 SHEET 3 OF 3

DISCLAIMER NOTE

UTILITY LOCATIONS SHOWN HEREON ARE APPROXIMATE ONLY. IT SHALL BE THE CONTRACTOR'S RESPONSIBILITY TO DETERMINE THE EXACT HORIZONTAL AND VERTICAL LOCATION OF ALL EXISTING UNDERGROUND AND OVERHEAD UTILITIES PRIOR TO COMMENCING CONSTRUCTION. NO REPRESENTATION IS MADE THAT ALL EXISTING UTILITIES ARE SHOWN HEREON. THE ENGINEER ASSUMES NO RESPONSIBILITY FOR UTILITIES NOT SHOWN OR UTILITIES NOT SHOWN IN THEIR PROPER LOCATIONS.

BEFORE YOU DIG
 OR 1-800-227-2600
 UNDERGROUND SERVICE (USA)

CALL BEFORE YOU OVERHEAD
 1-702-227-2929
 NEVADA POWER ENVIRONMENT AND SAFETY SERVICE DEPARTMENT

TOTAL BORE	0'
TOTAL DIRT TRENCH	0'
TOTAL ASPHALT TRENCH	0'
TOTAL TRENCH	0'
SIDEWALK REMOVAL/REPAIR	
TOTAL S/W PANELS	1
TOTAL LINEAR FOOTAGE	5'

