

CAUTION: HIGH PRESSURE GAS!
 CALL SOUTHWEST GAS AT 702-651-2111
 FOR STANDBY WHEN EXCAVATING OVER
 OR NEAR HIGH PRESSURE GAS LINES.

STATE	PROJECT NO.	COUNTY	SHEET NO.
NEVADA	SPSR-0159(015)	CLARK	13

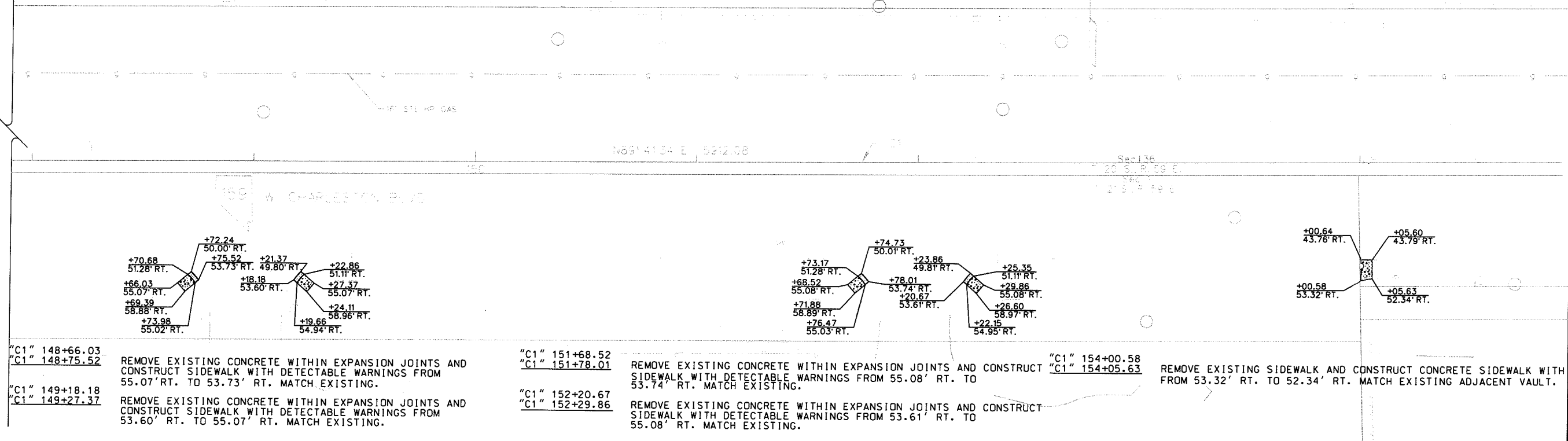

"C1" 148+66.03
 "C1" 148+75.52

REMOVE EXISTING CONCRETE WITHIN EXPANSION JOINTS AND CONSTRUCT SIDEWALK WITH DETECTABLE WARNINGS FROM 55.07' RT. TO 53.73' RT. MATCH EXISTING.

"C1" 149+18.18
 "C1" 149+27.37

REMOVE EXISTING CONCRETE WITHIN EXPANSION JOINTS AND CONSTRUCT SIDEWALK WITH DETECTABLE WARNINGS FROM 53.60' RT. TO 55.07' RT. MATCH EXISTING.

"C1" 151+68.52
 "C1" 151+78.01

REMOVE EXISTING CONCRETE WITHIN EXPANSION JOINTS AND CONSTRUCT SIDEWALK WITH DETECTABLE WARNINGS FROM 55.08' RT. TO 53.74' RT. MATCH EXISTING.

"C1" 152+20.67
 "C1" 152+29.86

REMOVE EXISTING CONCRETE WITHIN EXPANSION JOINTS AND CONSTRUCT SIDEWALK WITH DETECTABLE WARNINGS FROM 53.61' RT. TO 55.08' RT. MATCH EXISTING.

"C1" 154+00.58
 "C1" 154+05.63

REMOVE EXISTING SIDEWALK AND CONSTRUCT CONCRETE SIDEWALK WITH FROM 53.32' RT. TO 52.34' RT. MATCH EXISTING ADJACENT VAULT.

"C1" 159+80.69
 "C1" 159+95.62

REMOVE EXISTING SIDEWALK, CURB & GUTTER. CONSTRUCT TYPE A CONCRETE CURB RAMP WITH DETECTABLE WARNINGS FROM 56.47' LT. TO 51.33' LT.

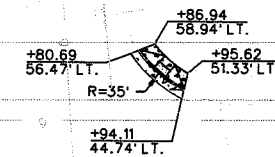

STATE OF NEVADA
 DEPARTMENT OF TRANSPORTATION

GEOMETRICS

STATE	PROJECT NO.	COUNTY	SHEET NO.
NEVADA	SPSR-0159(015)	CLARK	14

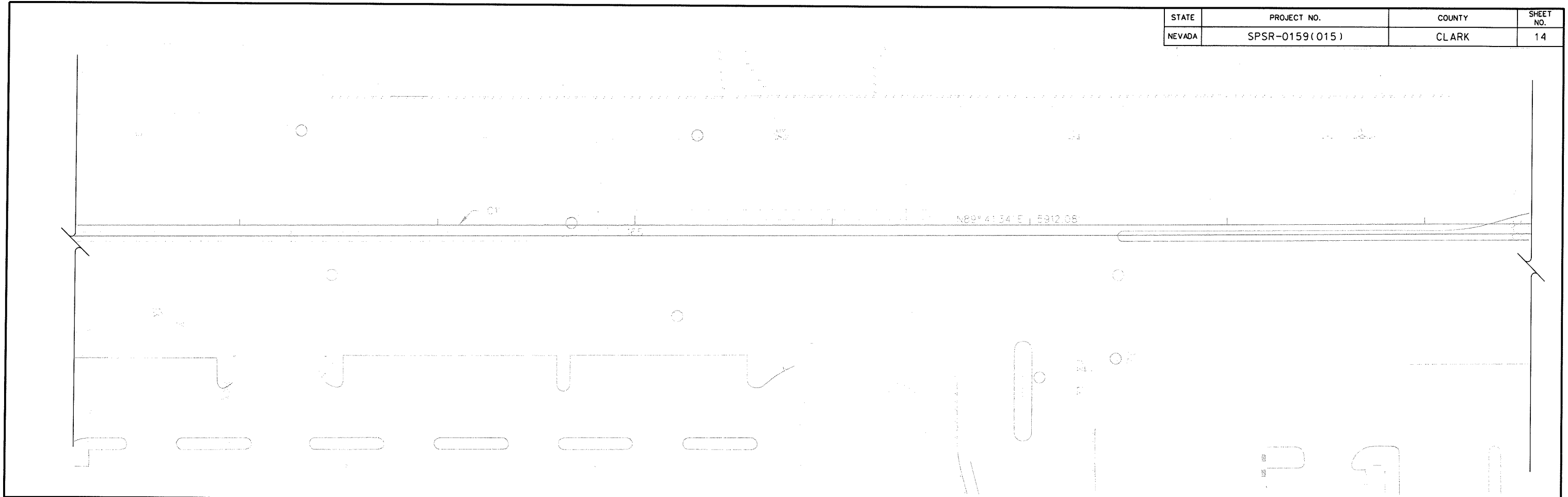

"C1" 162+63.29
 "C1" 162+67.94

REMOVE EXISTING SIDEWALK AND CONSTRUCT 6' CONCRETE SIDEWALK WITH BASE PREP FROM 56.38' LT., TO 50.53' LT.

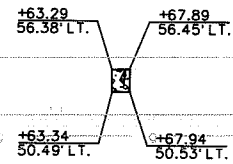

CAUTION: HIGH PRESSURE GAS!
 CALL SOUTHWEST GAS AT 702-651-2111
 FOR STANDBY WHEN EXCAVATING OVER
 OR NEAR HIGH PRESSURE GAS LINES.

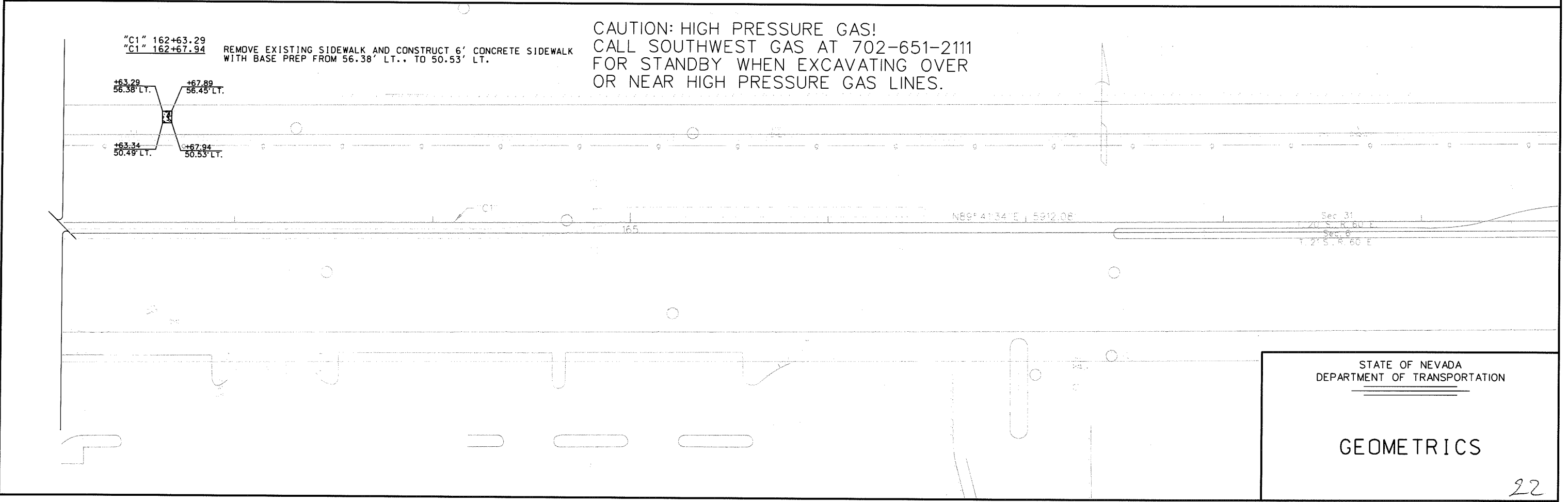

STATE OF NEVADA
 DEPARTMENT OF TRANSPORTATION

GEOMETRICS

CAUTION: HIGH PRESSURE GAS!
 CALL SOUTHWEST GAS AT 702-651-2111
 FOR STANDBY WHEN EXCAVATING OVER
 OR NEAR HIGH PRESSURE GAS LINES.

"C1" 173+41.82
 "C1" 173+43.85

GRIND CONCRETE SIDEWALK FROM 53.93' LT. TO 59.79' LT. TO
 MATCH EXISTING ADJACENT CONCRETE SIDEWALK.

STATE	PROJECT NO.	COUNTY	SHEET NO.
NEVADA	SPSR-0159(015)	CLARK	15

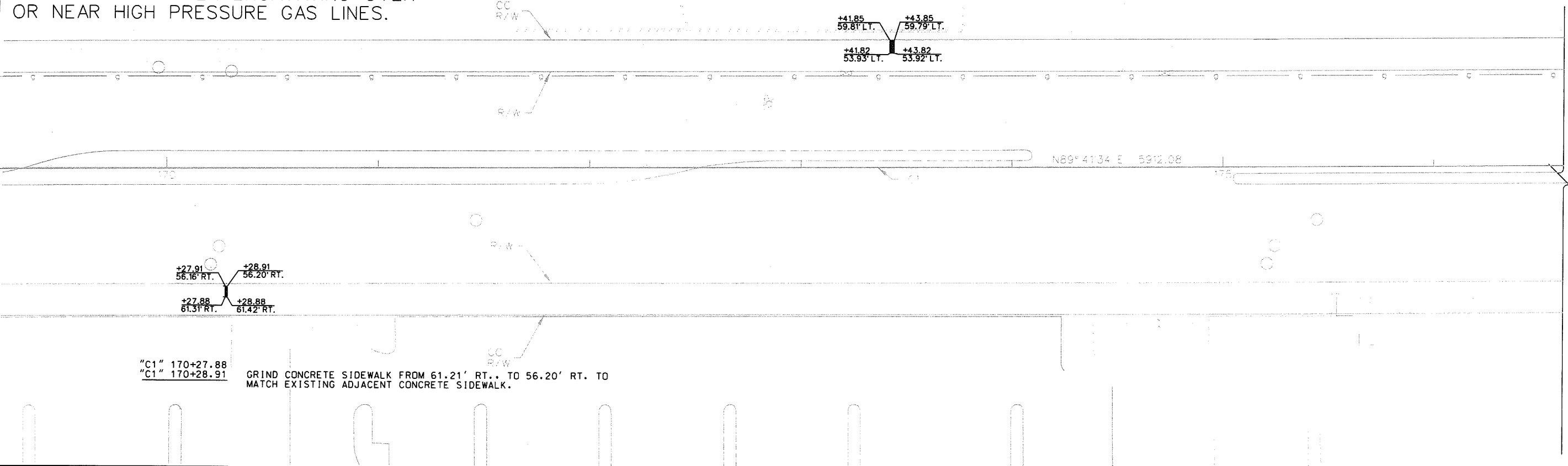

"C1" 170+27.88
 "C1" 170+28.91

GRIND CONCRETE SIDEWALK FROM 61.21' RT. TO 56.20' RT. TO
 MATCH EXISTING ADJACENT CONCRETE SIDEWALK.

"C1" 189+53.28
 "C1" 189+70.05

REMOVE EXISTING PAVERS. INSTALL CONCRETE SIDEWALK
 WITH BASE PREP FROM 43.70' LT. TO 46.90' LT.

"C1" 189+75.05
 "C1" 189+88.14

REMOVE EXISTING PAVERS. INSTALL CONCRETE SIDEWALK
 WITH BASE PREP FROM 43.71' LT. TO 46.92' LT.

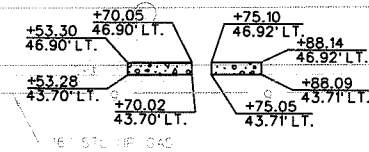

N89°41'34" E 5912.08'

N89°40'09" E 2611.26'

Sec. 31
 20 S
 Sec. 6
 21 S

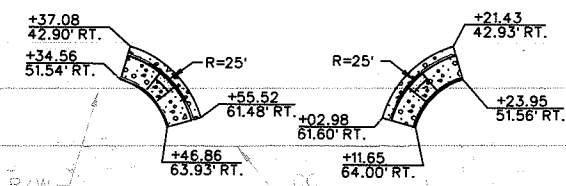

"C1" 186+34.56
 "C1" 186+55.52

REMOVE EXISTING CONCRETE RAMP AND CONSTRUCT TYPE D
 CONCRETE CURB RAMP WITH DETECTABLE WARNINGS FROM
 51.54' RT. TO 61.48' RT.

"C1" 187+02.98
 "C1" 187+23.95

REMOVE EXISTING CONCRETE RAMP AND CONSTRUCT TYPE D
 CONCRETE CURB RAMP WITH DETECTABLE WARNINGS FROM
 61.60' RT. TO 51.56' RT.

"C1" 191+21.21
 "C1" 191+36.38

REMOVE EXISTING CONCRETE RAMP AND CONSTRUCT TYPE A
 CONCRETE CURB RAMP WITH DETECTABLE WARNINGS FROM
 52.38' RT. TO 57.61' RT.

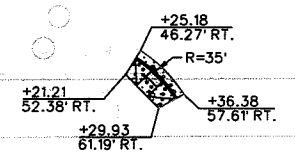

STATE OF NEVADA
 DEPARTMENT OF TRANSPORTATION

GEOMETRICS

23

CAUTION: HIGH PRESSURE GAS!
 CALL SOUTHWEST GAS AT 702-651-2111
 FOR STANDBY WHEN EXCAVATING OVER
 OR NEAR HIGH PRESSURE GAS LINES.

STATE	PROJECT NO.	COUNTY	SHEET NO.
NEVADA	SPSR-0159(015)	CLARK	16

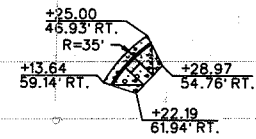

"C1" 192+13.64
 "C1" 192+28.97

REMOVE EXISTING CONCRETE RAMP AND CONSTRUCT TYPE A CONCRETE CURB RAMP WITH DETECTABLE WARNINGS FROM 59.14' RT.. TO 54.76' RT.

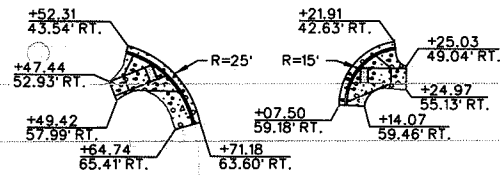

"C1" 195+47.77
 "C1" 195+71.18

REMOVE EXISTING CONCRETE RAMP AND CONSTRUCT TYPE A CONCRETE CURB RAMP WITH DETECTABLE WARNINGS FROM 52.93' RT.. TO 63.60' RT. PROTECT IN PLACE EXISTING WATER METERS.

"C1" 196+07.50
 "C1" 196+25.03

REMOVE EXISTING CONCRETE RAMP AND CONSTRUCT TYPE A CONCRETE RAMP WITH DETECTABLE WARNINGS FROM 59.18' RT.. TO 49.04' RT.

N89° 40' 09" E 2611.26'

Sec. 31
 200
 205

STATE OF NEVADA
 DEPARTMENT OF TRANSPORTATION

GEOMETRICS

CAUTION: HIGH PRESSURE GAS!
 CALL SOUTHWEST GAS AT 702-651-2111
 FOR STANDBY WHEN EXCAVATING OVER
 OR NEAR HIGH PRESSURE GAS LINES.

STATE	PROJECT NO.	COUNTY	SHEET NO.
NEVADA	SPSR-0159(015)	CLARK	17

"C1" 212+44.59
 "C1" 212+51.80

REMOVE EXISTING CONCRETE WITHIN EXPANSION JOINTS AND
 CONSTRUCT SIDEWALK WITH DETECTABLE WARNINGS
 FROM 51.02' LT. TO 52.77' LT. MATCH EXISTING.

"C1" 213+22.06
 "C1" 213+29.17

REMOVE EXISTING CONCRETE WITHIN EXPANSION JOINTS AND
 CONSTRUCT SIDEWALK WITH DETECTABLE WARNINGS
 FROM 53.73' LT. TO 52.35' LT. MATCH EXISTING.

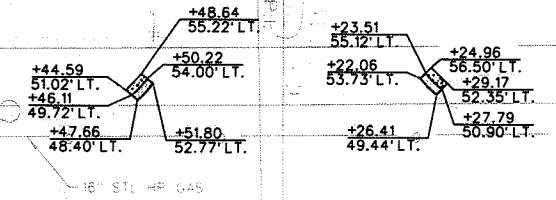

N89°40'09"E 2611.26

N89°26'26"E 2650.59
 Sec. 32
 T. 26
 S. 17

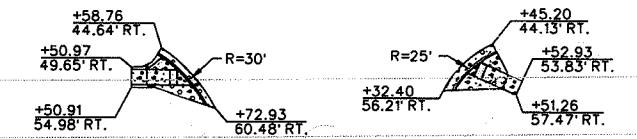

"C1" 212+50.91
 "C1" 212+72.93

REMOVE EXISTING CONCRETE RAMP AND CONSTRUCT TYPE A CONCRETE CURB RAMP
 WITH DETECTABLE WARNING FROM 54.98' RT.. TO 60.48' RT.

"C1" 213+32.40
 "C1" 213+52.93

REMOVE EXISTING CONCRETE RAMP AND CONSTRUCT TYPE A CONCRETE CURB RAMP
 WITH DETECTABLE WARNING FROM 56.21' RT.. TO 53.83' RT.

N89°26'26"E 2650.59

Sec. 32
 T. 26
 S. 17

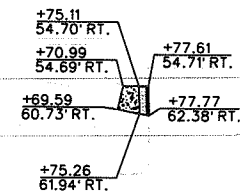

"C1" 218+69.59
 "C1" 218+77.77

REMOVE EXISTING CONCRETE WITHIN EXPANSION JOINTS
 AND CONSTRUCT SIDEWALK WITH DETECTABLE
 WARNINGS FROM 60.73' RT. TO 62.38' RT. MATCH EXISTING.

"C1" 220+64.51
 "C1" 220+70.56

REMOVE EXISTING CONCRETE WITHIN EXPANSION JOINTS
 AND CONSTRUCT SIDEWALK WITH DETECTABLE
 WARNINGS FROM 52.11' RT. TO 52.19' RT. MATCH EXISTING.

"C1" 220+98.18
 "C1" 221+07.89

REMOVE EXISTING CONCRETE WITHIN EXPANSION JOINTS
 AND CONSTRUCT SIDEWALK WITH DETECTABLE
 WARNINGS FROM 49.02' RT. TO 48.66' RT. MATCH EXISTING.

STATE OF NEVADA
 DEPARTMENT OF TRANSPORTATION

GEOMETRICS

CAUTION: HIGH PRESSURE GAS!
 CALL SOUTHWEST GAS AT 702-651-2111
 FOR STANDBY WHEN EXCAVATING OVER
 OR NEAR HIGH PRESSURE GAS LINES.

STATE	PROJECT NO.	COUNTY	SHEET NO.
NEVADA	SPSR-0159(015)	CLARK	18

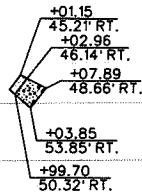

"C1" 221+81.45
 "C1" 221+91.86

REMOVE EXISTING CONCRETE WITHIN EXPANSION JOINTS AND CONSTRUCT SIDEWALK WITH DETECTABLE WARNINGS FROM 55.13' RT. TO 56.25' RT. MATCH EXISTING.

"C1" 222+15.09
 "C1" 222+20.74

REMOVE EXISTING CONCRETE WITHIN EXPANSION JOINTS AND CONSTRUCT SIDEWALK WITH DETECTABLE WARNINGS FROM 57.45' RT. TO 51.57' RT. MATCH EXISTING.

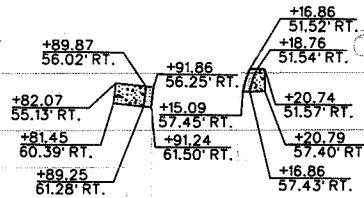

"C1" 225+47.48
 "C1" 225+68.49

REMOVE EXISTING CONCRETE RAMP AND CONSTRUCT TYPE D CONCRETE CURB RAMP WITH BACK CURB INSIDE RAMP AND DETECTABLE WARNING FROM 66.41' RT. TO 72.93' RT.

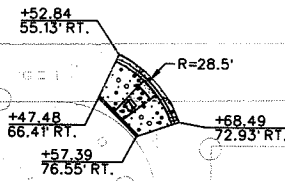

"C1" 226+72.88
 "C1" 226+96.60

REMOVE EXISTING CONCRETE RAMP AND CONSTRUCT TYPE D CONCRETE CURB RAMP WITH BACK CURB INSIDE OF RAMP AND DETECTABLE WARNING FROM 55.90' RT. TO 50.81' RT. PROTECT IN PLACE EXISTING WATER METER AND FACILITIES.

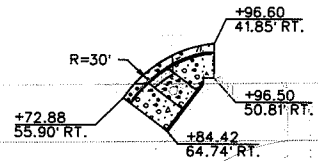

"C1" 232+13.31
 "C1" 232+20.40

REMOVE EXISTING CONCRETE WITHIN EXPANSION JOINTS AND CONSTRUCT SIDEWALK WITH DETECTABLE WARNINGS FROM 53.05' LT. TO 50.65' LT. MATCH EXISTING.

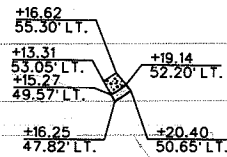

"C1" 232+97.20
 "C1" 233+02.15

REMOVE EXISTING CONCRETE WITHIN EXPANSION JOINTS AND CONSTRUCT SIDEWALK WITH DETECTABLE WARNINGS FROM 53.91' LT. TO 51.86' LT. MATCH EXISTING.

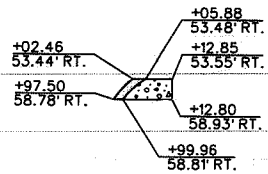
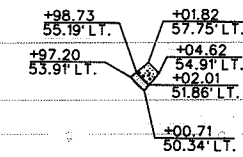

"C1" 229+97.50
 "C1" 230+12.85

REMOVE EXISTING CONCRETE WITHIN EXPANSION JOINTS AND CONSTRUCT SIDEWALK WITH DETECTABLE WARNINGS FROM 58.78' RT. TO 53.55' RT. MATCH EXISTING.

"C1" 232+77.92
 "C1" 232+82.03

REMOVE EXISTING CONCRETE WITHIN EXPANSION JOINTS AND CONSTRUCT SIDEWALK WITH DETECTABLE WARNINGS FROM 58.60' RT. TO 61.81' RT. MATCH EXISTING.

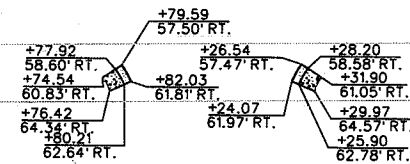

"C1" 233+24.07
 "C1" 233+31.90

REMOVE EXISTING CONCRETE WITHIN EXPANSION JOINTS AND CONSTRUCT SIDEWALK WITH DETECTABLE WARNINGS FROM 61.97' RT. TO 61.05' RT. MATCH EXISTING.

STATE OF NEVADA
 DEPARTMENT OF TRANSPORTATION

GEOMETRICS

STATE	PROJECT NO.	COUNTY	SHEET NO.
NEVADA	SPSR-0159(015)	CLARK	19

"C1" 238+96.32
"C1" 239+03.79

REMOVE EXISTING CONCRETE WITHIN EXPANSION JOINTS AND CONSTRUCT SIDEWALK WITH DETECTABLE WARNINGS FROM 56.89' LT. TO 57.36' LT. MATCH EXISTING.

"C1" 239+71.04
"C1" 239+78.41

REMOVE EXISTING CONCRETE WITHIN EXPANSION JOINTS AND CONSTRUCT SIDEWALK WITH DETECTABLE WARNINGS FROM 56.01' LT. TO 56.45' LT. MATCH EXISTING.

CAUTION: HIGH PRESSURE GAS!
CALL SOUTHWEST GAS AT 702-651-2111
FOR STANDBY WHEN EXCAVATING OVER OR NEAR HIGH PRESSURE GAS LINES.

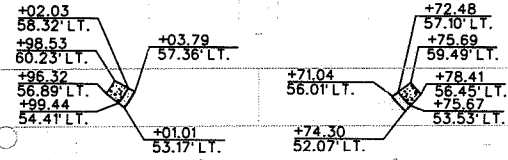

16" ST. HP GAS

N89° 26' 26" E 2650.59

N89° 40' 04" E 5312.99

S&C 32
7' 20" IS
SEC. 6
21'

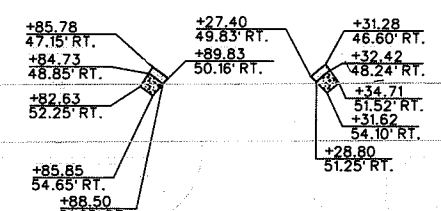
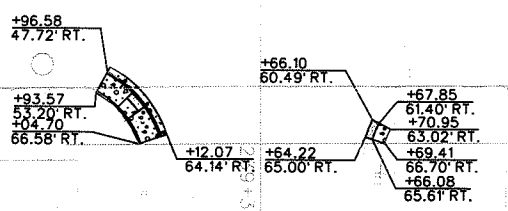

"C1" 238+93.57
"C1" 239+10.64

REMOVE EXISTING CONCRETE RAMP AND CONSTRUCT TYPE D CONCRETE CURB RAMP WITH DETECTABLE WARNING AND BACK CURB INSIDE OF RAMP FROM 53.20' RT. TO 64.61' RT.

"C1" 239+64.22
"C1" 239+70.95

REMOVE EXISTING CONCRETE WITHIN EXPANSION JOINTS AND CONSTRUCT SIDEWALK WITH DETECTABLE WARNINGS FROM 65.00' RT. TO 63.02' RT. MATCH EXISTING.

"C1" 241+82.63
"C1" 241+89.83

REMOVE EXISTING CONCRETE WITHIN EXPANSION JOINTS AND CONSTRUCT SIDEWALK WITH DETECTABLE WARNINGS FROM 52.25' RT. TO 50.16' RT. MATCH EXISTING.

"C1" 242+27.40
"C1" 242+34.71

REMOVE EXISTING CONCRETE WITHIN EXPANSION JOINTS AND CONSTRUCT SIDEWALK WITH DETECTABLE WARNINGS FROM 49.83' RT. TO 51.52' RT. MATCH EXISTING.

"C1" 245+35.05
"C1" 245+55.51

REMOVE AND CONSTRUCT TYPE D CONCRETE RAMP AND TYPE 5 CURB & GUTTER WITH BACK CURB OUTSIDE OF RAMP FROM 52.31' LT. TO 66.67' LT. INSTALL DETECTABLE WARNINGS.

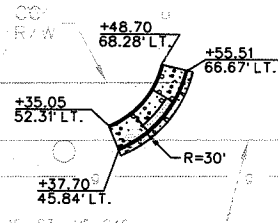

16" ST. HP GAS

16" ST. HP GAS

4" PE GAS

N89° 40' 04" E 5312.99

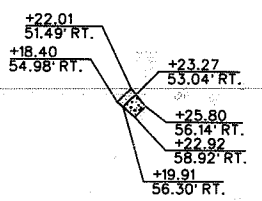

"C1" 246+18.40
"C1" 246+25.80

REMOVE EXISTING CONCRETE WITHIN EXPANSION JOINTS AND CONSTRUCT SIDEWALK WITH DETECTABLE WARNINGS FROM 54.98' RT. TO 56.14' RT. MATCH EXISTING.

"C1" 246+87.12
"C1" 246+89.16

GRIND CONCRETE SIDEWALK FROM 50.10' RT. TO 43.56' RT. TO MATCH EXISTING ADJACENT CONCRETE SIDEWALK.

STATE OF NEVADA
DEPARTMENT OF TRANSPORTATION

GEOMETRICS

CAUTION: HIGH PRESSURE GAS!
 CALL SOUTHWEST GAS AT 702-651-2111
 FOR STANDBY WHEN EXCAVATING OVER
 OR NEAR HIGH PRESSURE GAS LINES.

STATE	PROJECT NO.	COUNTY	SHEET NO.
NEVADA	SPSR-0159(015)	CLARK	20

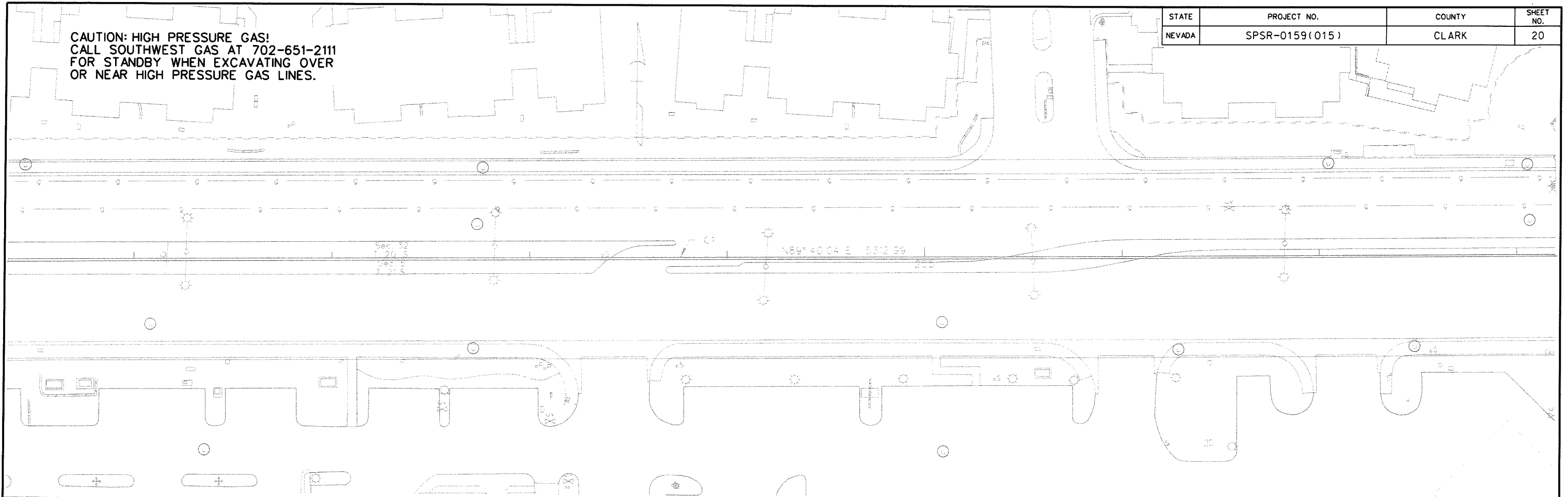

"C1" 261+54.22
 "C1" 261+73.08
 "C1" 261+88.91
 "C1" 261+94.45

REMOVE EXISTING SIDEWALK AND CONSTRUCT 6' CONCRETE SIDEWALK FROM 50.22' LT. TO 43.66' LT.

REMOVE EXISTING SIDEWALK AND CONSTRUCT 6' CONCRETE SIDEWALK FROM 43.53' LT. TO 49.86' LT.

"C1" 263+63.28
 "C1" 263+71.32

REMOVE EXISTING SIDEWALK AND CONSTRUCT 6' CONCRETE SIDEWALK FROM 43.22' LT. TO 49.86' LT.

"C1" 263+76.04

GRIND CONCRETE AT LUMINAIRE BASE TO MATCH EXISTING SIDEWALK AT 48.96' LT.

"C1" 265+20.69
 "C1" 265+29.70

REMOVE AND CONSTRUCT CONCRETE AND REBAR ON TOP OF D.I. FROM 43.30' LT. TO 46.77' LT. SEE SD1.

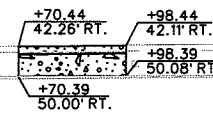
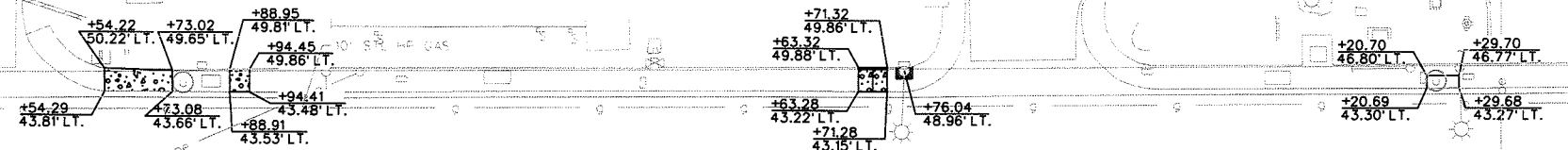

"C1" 263+70.39
 "C1" 263+98.44

REMOVE CONCRETE DRIVEWAY. CONSTRUCT 6' SIDEWALK AND TYPE 5 CURB & GUTTER FROM 50.00' RT. TO 42.11' RT.

STATE OF NEVADA
 DEPARTMENT OF TRANSPORTATION

GEOMETRICS

STATE	PROJECT NO.	COUNTY	SHEET NO.
NEVADA	SPSR-0159(015)	CLARK	21

"C1" 265+93.72
"C1" 266+09.11

REMOVE EXISTING CONCRETE RAMP AND CONSTRUCT TYPE A CONCRETE CURB RAMP WITH DETECTABLE WARNING FROM 43.51' LT. TO 58.34' LT.

"C1" 266+32.60
"C1" 266+47.24

REMOVE EXISTING CONCRETE RAMP AND CONSTRUCT TYPE E CONCRETE CURB RAMP WITH DETECTABLE WARNING FROM 53.89' LT. TO 51.46' LT.

"C1" 267+25.81
"C1" 267+32.76

REMOVE EXISTING CONCRETE WITHIN EXPANSION JOINTS AND CONSTRUCT SIDEWALK WITH DETECTABLE WARNINGS FROM 49.23' RT. TO 52.40' RT. MATCH EXISTING.

"C1" 267+42.41
"C1" 267+56.16

REMOVE AND CONSTRUCT CONCRETE SIDEWALK AND TYPE 5 CURB & GUTTER FROM 42.06' LT. TO 42.19' LT. PROTECT IN PLACE ELECTRICAL VAULT.

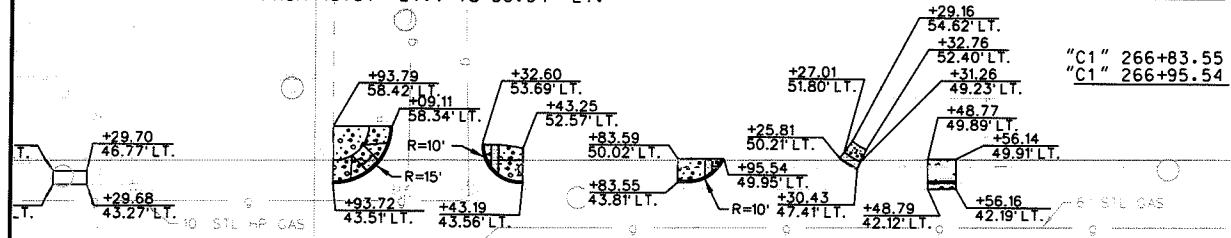

"C1" 266+83.55
"C1" 266+95.54

REMOVE EXISTING CONCRETE RAMP AND CONSTRUCT TYPE E CONCRETE CURB RAMP WITH DETECTABLE WARNING FROM 43.81' LT. TO 49.95' LT.

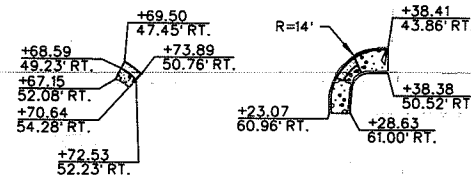

"C1" 268+68.59
"C1" 268+73.89

REMOVE EXISTING CONCRETE WITHIN EXPANSION JOINTS AND CONSTRUCT SIDEWALK WITH DETECTABLE WARNINGS FROM 49.23' RT. TO 50.76' RT. MATCH EXISTING.

"C1" 269+23.07
"C1" 269+38.41

REMOVE AND CONSTRUCT TYPE D CONCRETE RAMP AND TYPE 5 CURB & GUTTER WITH BACK CURB OUTSIDE OF RAMP FROM 60.96' RT. TO 43.86' RT. INSTALL DETECTABLE WARNINGS.

CAUTION: HIGH PRESSURE GAS!
CALL SOUTHWEST GAS AT 702-651-2111
FOR STANDBY WHEN EXCAVATING OVER
OR NEAR HIGH PRESSURE GAS LINES.

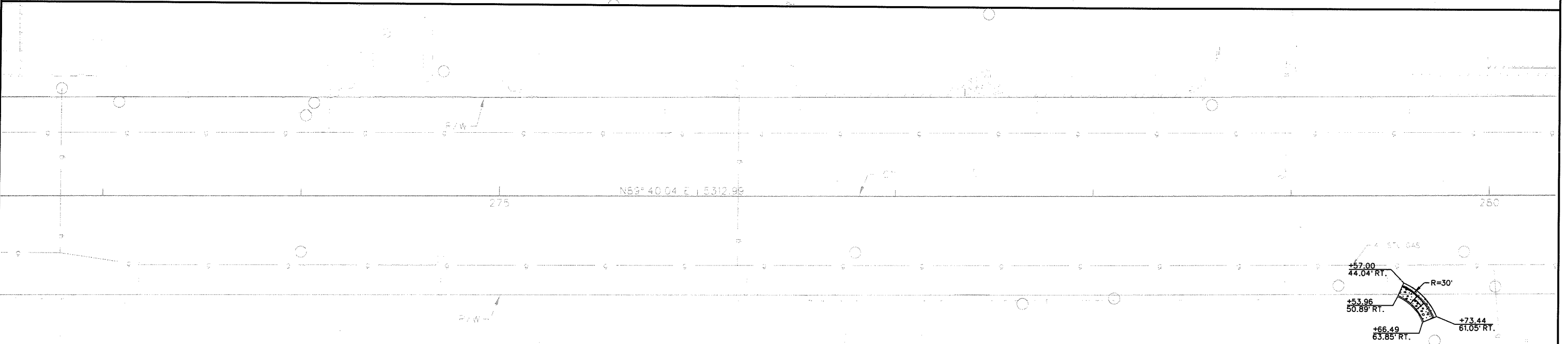

"C1" 279+53.96
"C1" 279+73.44

REMOVE EXISTING CONCRETE RAMP AND CONSTRUCT TYPE D CONCRETE CURB RAMP WITH DETECTABLE WARNING AND BACK CURB INSIDE OF RAMP FROM 50.89' RT. TO 61.05' RT.

STATE OF NEVADA
DEPARTMENT OF TRANSPORTATION

GEOMETRICS

NOTE:
1. SEE STANDARD PLAN SHEET R-5.1.1. FOR ROLL CURB TRANSITION TO VERTICAL FACE.

STATE	PROJECT NO.	COUNTY	SHEET NO.
NEVADA	SPSR-0159(015)	CLARK	22

"C1" 285+42.90
"C1" 285+61.64

REMOVE EXISTING CONCRETE RAMP AND CONSTRUCT TYPE D CONCRETE CURB RAMP WITH DETECTABLE WARNING AND BACK CURB INSIDE RAMP FROM 51.37' LT. TO 61.30' LT.

"C1" 286+30.69
"C1" 286+53.05

REMOVE EXISTING CONCRETE RAMP AND CONSTRUCT TYPE D CONCRETE CURB RAMP WITH DETECTABLE WARNING AND BACK CURB INSIDE RAMP FROM 62.42' LT. TO 51.65' LT.

"C1" 286+82.59
"C1" 286+90.63

REMOVE EXISTING SIDEWALK AND CONSTRUCT 6' CONCRETE SIDEWALK FROM 43.52' LT. TO 50.03' LT.

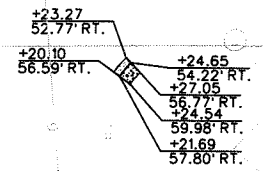
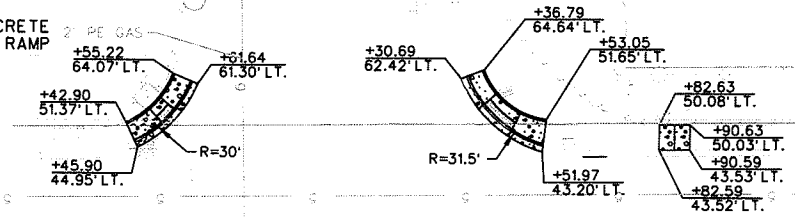

"C1" 280+20.10
"C1" 280+27.05

REMOVE EXISTING CONCRETE WITHIN EXPANSION JOINTS AND CONSTRUCT SIDEWALK WITH DETECTABLE WARNINGS FROM 56.59' RT. TO 56.77' RT. MATCH EXISTING.

"C1" 285+42.66
"C1" 285+61.87

REMOVE EXISTING CONCRETE RAMP AND CONSTRUCT TYPE D CONCRETE CURB RAMP WITH DETECTABLE WARNING AND BACK CURB OUTSIDE RAMP FROM 52.93' RT. TO 62.60' RT.

"C1" 286+32.75
"C1" 286+52.09

REMOVE EXISTING CONCRETE RAMP AND CONSTRUCT TYPE D CONCRETE CURB RAMP WITH DETECTABLE WARNING AND BACK CURB INTSIDE RAMP FROM 62.15' RT. TO 52.53' RT.

"C1" 287+02.56
"C1" 287+11.58

REMOVE AND CONSTRUCT CONCRETE AND REBAR ON TOP OF D.I. FROM 47.18' RT. TO 43.65' RT. SEE SD1.

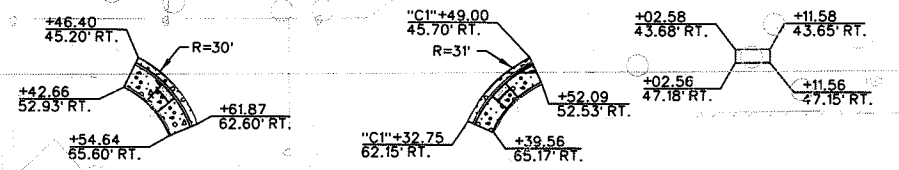

"C1" 292+53.60 REMOVE EXISTING CONCRETE BASE OF LUMINAIRE AT 49.28' LT.

"C1" 293+29.35 REMOVE AND CONSTRUCT CONCRETE AND REBAR ON DI TOP FROM 44.08' LT TO 46.04' LT. SEE SD1.
"C1" 293+41.85

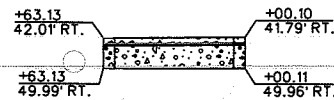
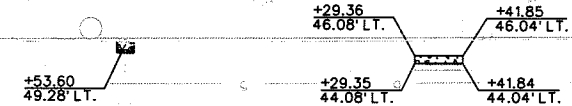

"C1" 288+63.13
"C1" 289+00.11

REMOVE CONCRETE DRIVEWAY. CONSTRUCT 6' SIDEWALK WITH TYPE 8 CURB & GUTTER FROM 49.99' RT. TO 49.96' RT.

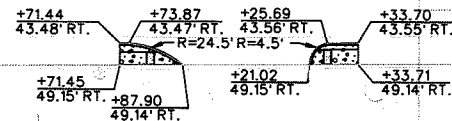

"C1" 291+71.44
"C1" 291+87.90

REMOVE EXISTING CONCRETE RAMP AND CONSTRUCT TYPE E CONCRETE RAMP WITH DETECTABLE WARNING FROM 43.48' RT. TO 49.14' RT.

"C1" 292+21.02
"C1" 292+33.71

REMOVE EXISTING CONCRETE RAMP AND CONSTRUCT TYPE E CONCRETE RAMP WITH DETECTABLE WARNING FROM 49.15' RT. TO 49.14' RT.

STATE OF NEVADA
DEPARTMENT OF TRANSPORTATION

GEOMETRICS

STATE	PROJECT NO.	COUNTY	SHEET NO.
NEVADA	SPSR-0159(015)	CLARK	23

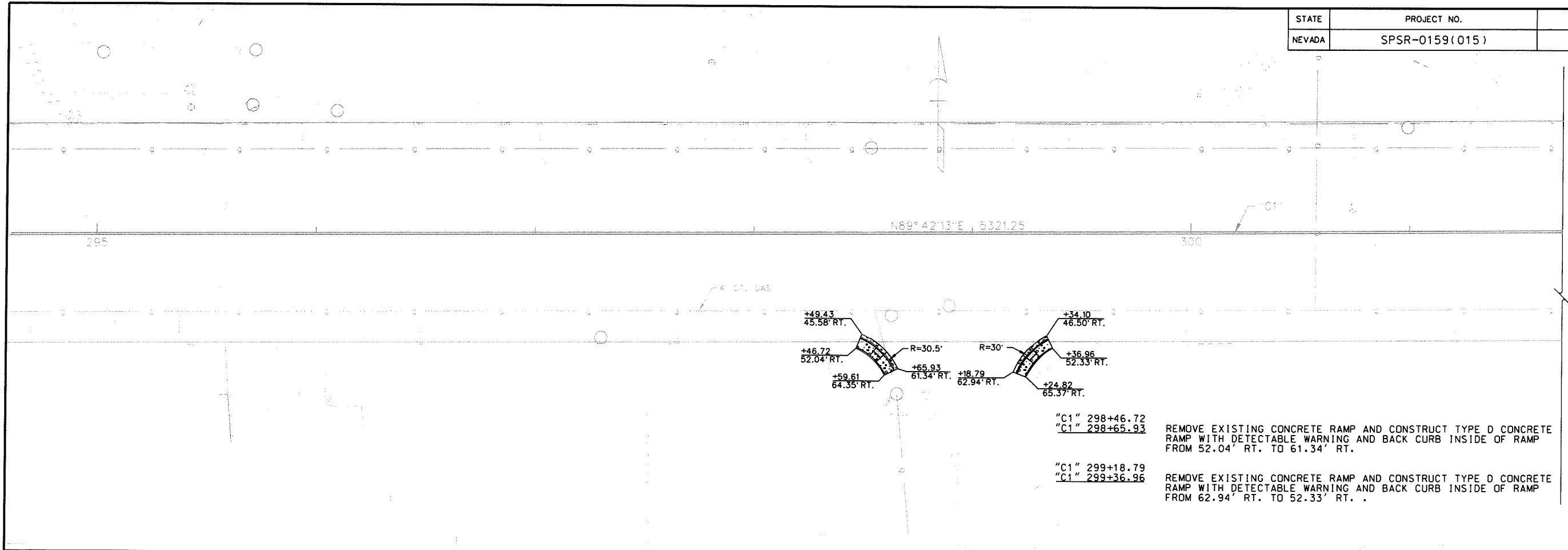

"C1" 298+46.72
 "C1" 298+65.93 REMOVE EXISTING CONCRETE RAMP AND CONSTRUCT TYPE D CONCRETE RAMP WITH DETECTABLE WARNING AND BACK CURB INSIDE OF RAMP FROM 52.04' RT. TO 61.34' RT.

"C1" 299+18.79
 "C1" 299+36.96 REMOVE EXISTING CONCRETE RAMP AND CONSTRUCT TYPE D CONCRETE RAMP WITH DETECTABLE WARNING AND BACK CURB INSIDE OF RAMP FROM 62.94' RT. TO 52.33' RT.

"C1" 306+45.42 GRIND CONCRETE AT LUMINAIRE BASE TO MATCH EXISTING SIDEWALK AT 46.21' LT.

"C1" 307+63.22 GRIND CONCRETE AT LUMINAIRE BASE TO MATCH EXISTING SIDEWALK AT 45.91' LT.

"C1" 308+83.43 GRIND CONCRETE AT LUMINAIRE BASE TO MATCH EXISTING SIDEWALK AT 46.01' LT.

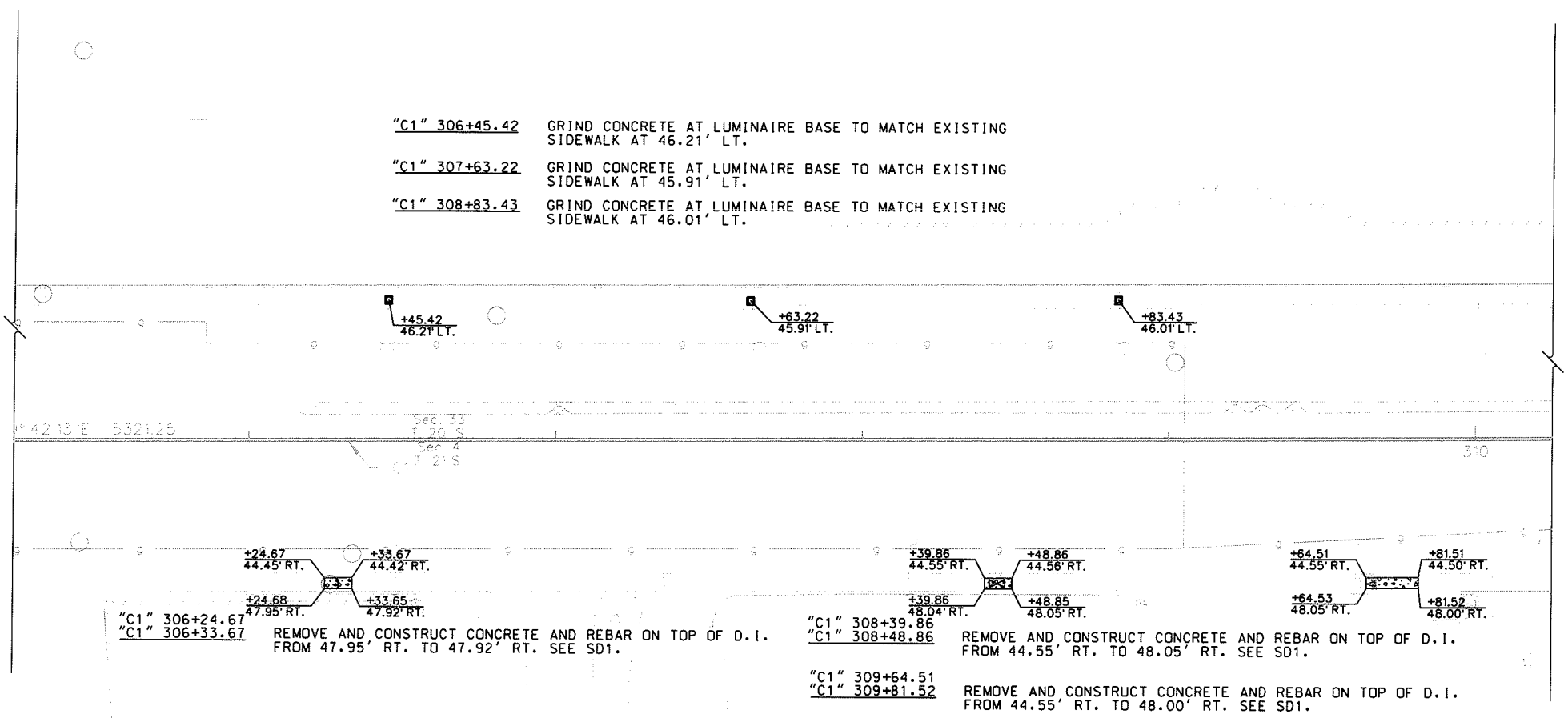

"C1" 306+24.67
 "C1" 306+33.67 REMOVE AND CONSTRUCT CONCRETE AND REBAR ON TOP OF D.I. FROM 47.95' RT. TO 47.92' RT. SEE SD1.

"C1" 308+39.86
 "C1" 308+48.86 REMOVE AND CONSTRUCT CONCRETE AND REBAR ON TOP OF D.I. FROM 44.55' RT. TO 48.05' RT. SEE SD1.

"C1" 309+64.51
 "C1" 309+81.52 REMOVE AND CONSTRUCT CONCRETE AND REBAR ON TOP OF D.I. FROM 44.55' RT. TO 48.00' RT. SEE SD1.

STATE OF NEVADA
 DEPARTMENT OF TRANSPORTATION

GEOMETRICS

31

NOTE:
SEE STANDARD PLAN SHEET R-5.1.1. FOR ROLL CURB
TRANSITION TO VERTICAL FACE.

STATE	PROJECT NO.	COUNTY	SHEET NO.
NEVADA	SPSR-0159(015)	CLARK	25

- "C1" 329+84.41
"C1" 329+99.94 REMOVE CONCRETE SIDEWALK AND CURB AND GUTTER. CONSTRUCT SIDEWALK WITH TYPE 5 CURB AND GUTTER TAPERING TO A 1' GUTTER PAN FROM 43.44' LT. TO 50.34' LT.
- "C1" 331+09.95
"C1" 331+19.59 REMOVE AND CONSTRUCT 5' CONCRETE SIDEWALK AND TYPE 5 CURB & GUTTER FROM 43.44' LT. TO 50.39' LT.
- "C1" 331+75.21 GRIND CONCRETE AT LUMINAIRE BASE TO MATCH EXISTING SIDEWALK AT 46.56' LT.

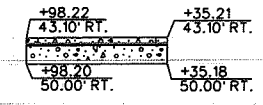
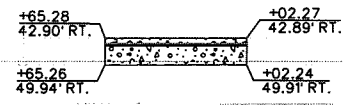
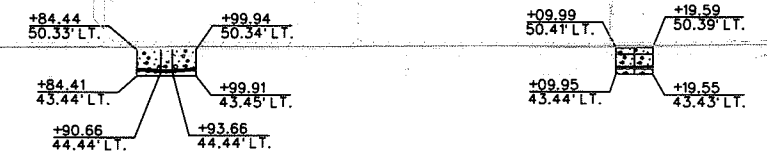

- "C1" 326+65.26
"C1" 327+02.27 REMOVE CONCRETE DRIVEWAY. CONSTRUCT 5' SIDEWALK AND TYPE 8 CURB & GUTTER FROM 49.94' RT. TO 42.89' RT.
- "C1" 329+98.20
"C1" 330+35.21 REMOVE CONCRETE DRIVEWAY. CONSTRUCT 5' SIDEWALK AND TYPE 8 CURB & GUTTER FROM 50.00' RT. TO 43.10' RT.

- "C1" 332+97.30 GRIND CONCRETE AT LUMINAIRE BASE TO MATCH EXISTING SIDEWALK AT 46.38' LT.
- "C1" 333+02.69
"C1" 333+20.19 REMOVE AND CONSTRUCT TYPE D CONCRETE RAMP AND TYPE 5 CURB & GUTTER FROM 50.67' LT. TO 62.48' LT. INSTALL DETECTABLE WARNINGS.

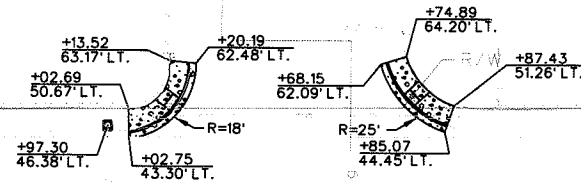

- "C1" 333+68.15
"C1" 333+87.43 REMOVE AND CONSTRUCT TYPE D CONCRETE RAMP AND TYPE 5 CURB & GUTTER FROM 62.09' LT. TO 51.26' LT. INSTALL DETECTABLE WARNINGS.
- "C1" 334+27.38 GRIND CONCRETE AT LUMINAIRE BASE TO MATCH EXISTING SIDEWALK AT 46.07' LT.
- "C1" 335+52.99 GRIND CONCRETE AT LUMINAIRE BASE TO MATCH EXISTING SIDEWALK AT 46.50' LT.
- "C1" 336+75.41 GRIND CONCRETE AT LUMINAIRE BASE TO MATCH EXISTING SIDEWALK AT 46.06' LT.

- "C1" 337+11.67
"C1" 337+27.21 REMOVE CONCRETE SIDEWALK AND CURB AND GUTTER. CONSTRUCT SIDEWALK WITH TYPE 5 CURB AND GUTTER TAPERING TO A 1' GUTTER PAN FROM 43.04' LT. TO 50.07' LT.
- "C1" 337+95.36 GRIND CONCRETE AT LUMINAIRE BASE TO MATCH EXISTING SIDEWALK AT 46.18' LT.
- "C1" 338+72.83
"C1" 338+76.84 REMOVE AND CONSTRUCT 5' CONCRETE SIDEWALK FROM 44.74' LT. TO 50.21' LT.

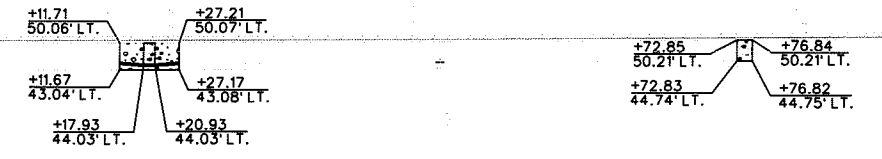

- "C1" 334+07.17
"C1" 334+26.36 REMOVE AND CONSTRUCT TYPE D CONCRETE RAMP AND TYPE 5 CURB & GUTTER FROM 51.79' RT. TO 61.24' RT. INSTALL DETECTABLE WARNINGS.
- "C1" 334+69.16
"C1" 334+88.30 REMOVE AND CONSTRUCT TYPE D CONCRETE RAMP AND TYPE 5 CURB & GUTTER FROM 61.33' RT. TO 51.32' RT. INSTALL DETECTABLE WARNINGS.

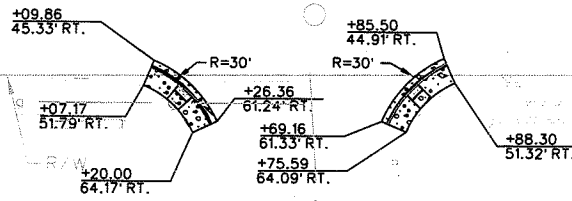

STATE OF NEVADA
DEPARTMENT OF TRANSPORTATION

GEOMETRICS

STATE	PROJECT NO.	COUNTY	SHEET NO.
NEVADA	SPSR-0159(015)	CLARK	26

"C1" 339+16.63 GRIND CONCRETE AT LUMINAIRE BASE TO MATCH EXISTING SIDEWALK AT 46.17' LT.
 "C1" 340+35.64 GRIND CONCRETE AT LUMINAIRE BASE TO MATCH EXISTING SIDEWALK AT 46.24' LT.
 "C1" 341+03.28 REMOVE CONCRETE SIDEWALK AND CURB AND GUTTER. CONSTRUCT SIDEWALK WITH TYPE 5 CURB AND GUTTER TAPERING TO A 1' GUTTER PAN FROM 44.84' LT. TO 44.80' LT.
 "C1" 341+18.79

"C1" 346+06.70 REMOVE CONCRETE SIDEWALK. CONSTRUCT CONCRETE SIDEWALK AROUND PEDESTRIAN PUSH BUTTON FROM 67.28' LT TO 64.97' LT.
 "C1" 346+13.39

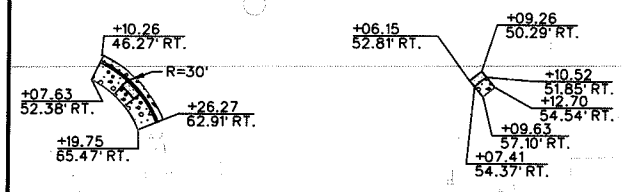
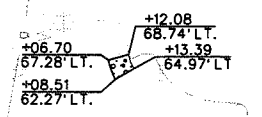
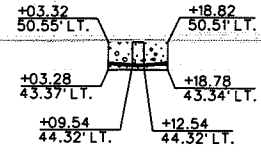

"C1" 339+07.63 REMOVE AND CONSTRUCT TYPE D CONCRETE RAMP AND TYPE 5 CURB & GUTTER FROM 52.38' RT. TO 62.91' RT. INSTALL DETECTABLE WARNINGS.
 "C1" 339+26.27
 "C1" 340+06.15 REMOVE EXISTING CONCRETE WITHIN EXPANSION JOINTS AND CONSTRUCT SIDEWALK WITH DETECTABLE WARNINGS FROM 52.81' RT. TO 54.54' RT. MATCH EXISTING.
 "C1" 340+12.70

"C1" 352+77.66 REMOVE AND CONSTRUCT CONCRETE WITH REBAR DI TOP WITH CURB FACE AND GUTTER PAN FROM 50.50' LT. TO 43.03' LT. SEE SD1.
 "C1" 352+86.68
 "C1" 352+93.36 GRIND CONCRETE SIDEWALK FROM 55.56' LT., TO 53.11' LT. TO MATCH EXISTING ADJACENT CONCRETE SIDEWALK.
 "C1" 352+98.86

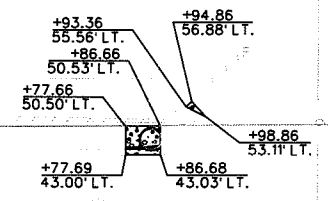

STATE OF NEVADA
 DEPARTMENT OF TRANSPORTATION

GEOMETRICS

STATE	PROJECT NO.	COUNTY	SHEET NO.
NEVADA	SPSR-0159(015)	CLARK	27

"C1" 357+26.79
 "C1" 357+26.82 GRIND CONCRETE SIDEWALK FROM 44.82' LT. TO 50.33' LT. TO MATCH EXISTING ADJACENT CONCRETE SIDEWALK.

"C1" 357+42.20
 "C1" 357+54.22 REMOVE EXISTING CONCRETE RAMP AND CONSTRUCT TYPE E CONCRETE RAMP WITH DETECTABLE WARNING FROM 44.77' LT. TO 50.13' LT.

"C1" 357+69.30
 "C1" 357+81.02 REMOVE EXISTING CONCRETE RAMP AND CONSTRUCT TYPE E CONCRETE RAMP WITH DETECTABLE WARNING FROM 50.44' LT. TO 50.39' LT.

"C1" 360+07.48
 "C1" 360+11.51 REMOVE AND CONSTRUCT 5' CONCRETE SIDEWALK FROM 45.05' LT. TO 50.28' LT. PROTECT IN PLACE UTILITY VAULT.

"C1" 360+79.12 GRIND CONCRETE AT LUMINAIRE BASE TO MATCH EXISTING SIDEWALK AT 46.03' LT.

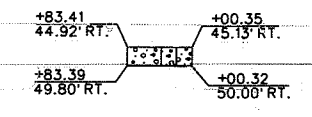
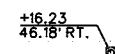
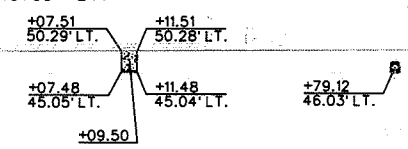
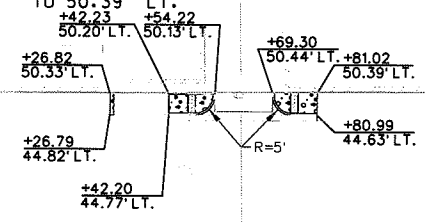

"C1" 354+16.23 GRIND CONCRETE AT LUMINAIRE BASE TO MATCH EXISTING SIDEWALK AT 46.18' RT.

"C1" 356+74.50
 "C1" 358+46.27 CONSTRUCT 5' CONCRETE SIDEWALK FROM 50.10' RT. TO 50.18' RT. ADJUST MANHOLE. (METHOD C).

"C1" 359+07.57 GRIND CONCRETE AT LUMINAIRE BASE TO MATCH EXISTING SIDEWALK AT 45.93' RT.

"C1" 359+83.39
 "C1" 360+00.35 REMOVE CONCRETE SIDEWALK AND DRIVEWAY. CONSTRUCT 5' CONCRETE SIDEWALK AND DRIVEWAY FROM 49.80' RT. TO 45.13' RT.

"C1" 365+73.25
 "C1" 365+81.29 REMOVE AND CONSTRUCT 5' CONCRETE SIDEWALK FROM 44.75' LT. TO 44.72' LT.

"C1" 366+20.33
 "C1" 366+25.19 REMOVE EXISTING CONCRETE WITHIN EXPANSION JOINTS AND CONSTRUCT SIDEWALK WITH DETECTABLE WARNINGS FROM 54.17' LT. TO 53.06' LT. MATCH EXISTING.

"C1" 367+66.90
 "C1" 367+73.44 REMOVE EXISTING CONCRETE WITHIN EXPANSION JOINTS AND CONSTRUCT SIDEWALK WITH DETECTABLE WARNINGS FROM 53.03' LT. TO 55.26' LT. MATCH EXISTING.

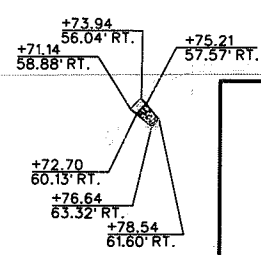
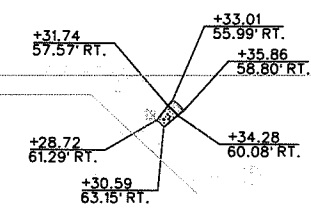
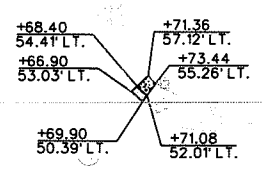
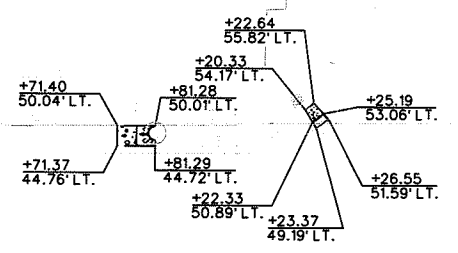

"C1" 366+28.72
 "C1" 366+35.86 REMOVE EXISTING CONCRETE WITHIN EXPANSION JOINTS AND CONSTRUCT SIDEWALK WITH DETECTABLE WARNINGS FROM 61.29' RT. TO 58.80' RT. MATCH EXISTING.

"C1" 367+71.14
 "C1" 367+78.45 REMOVE EXISTING CONCRETE WITHIN EXPANSION JOINTS AND CONSTRUCT SIDEWALK WITH DETECTABLE WARNINGS FROM 58.88' RT. TO 61.48' RT. MATCH EXISTING.

STATE OF NEVADA
 DEPARTMENT OF TRANSPORTATION

GEOMETRICS

STATE	PROJECT NO.	COUNTY	SHEET NO.
NEVADA	SPSR-0159(015)	CLARK	SD1

- NOTES:
1. ALL DEPICTED UTILITY LOCATIONS ARE APPROXIMATE ONLY. CONTRACTOR TO VERIFY EXISTENCE AND LOCATION OF UNDERGROUND UTILITIES PRIOR TO CONSTRUCTION.
 2. ALL CONCRETE SHALL BE CLASS A.
 3. SET ELEVATION OF TOP OF DROP INLET SO THAT IT IS FLUSH WITH ADJACENT SIDEWALK CONSTRUCTION.

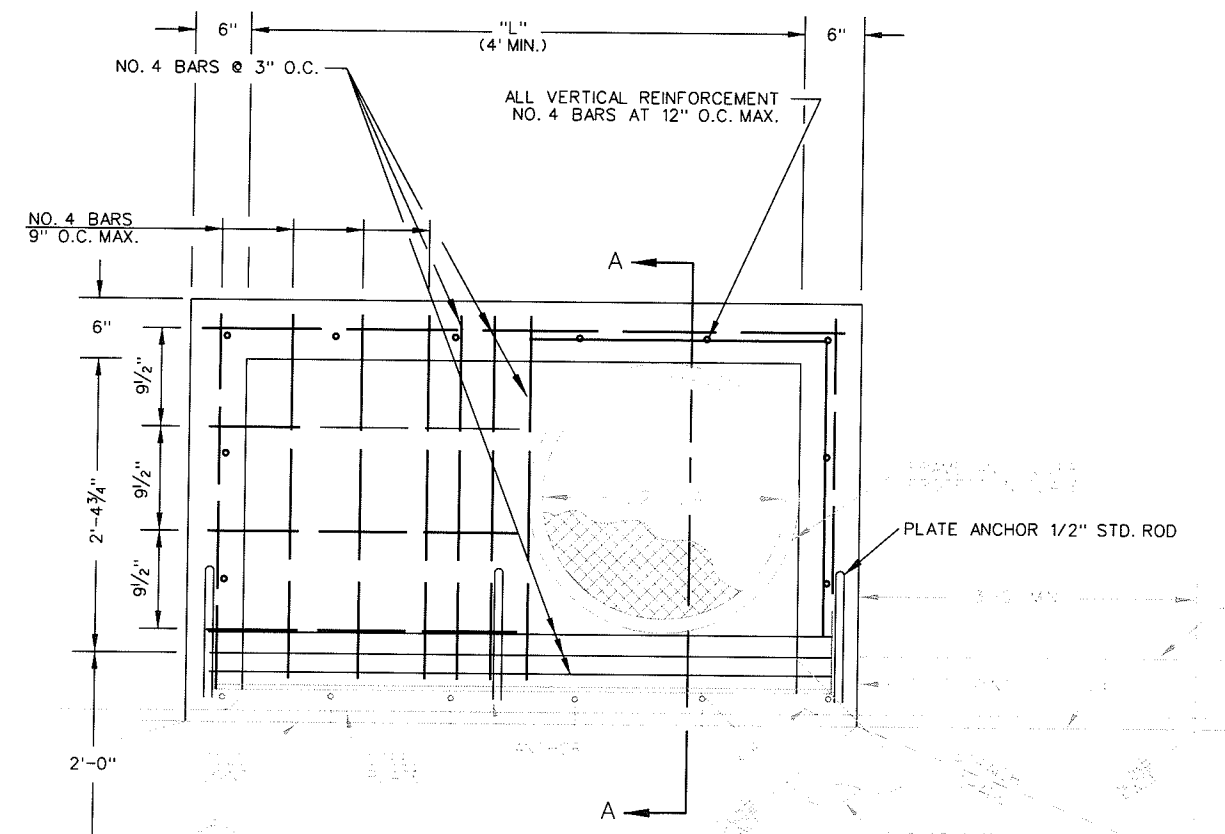

TOP VIEW

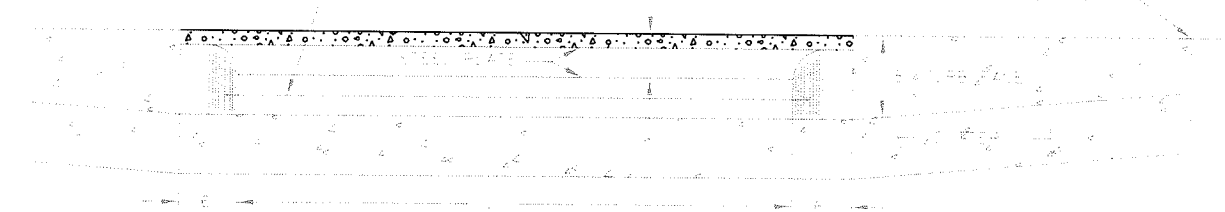

FRONT VIEW

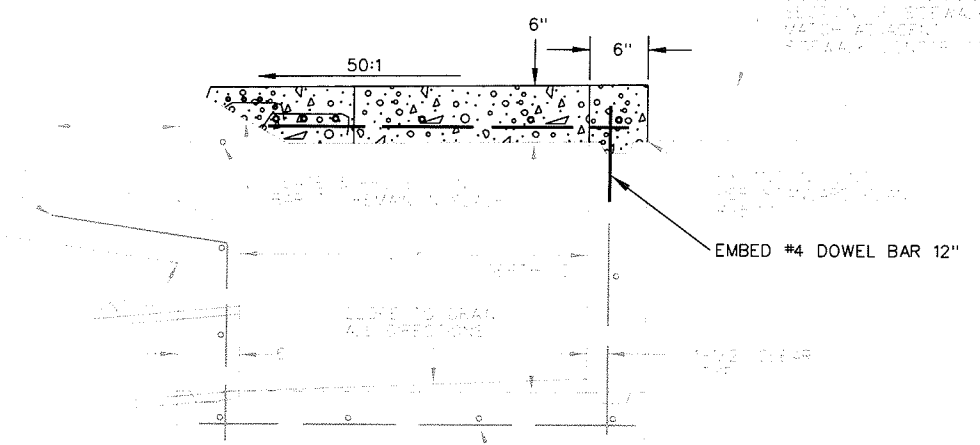

SECTION A-A

STATE OF NEVADA
DEPARTMENT OF TRANSPORTATION

SPECIAL DETAIL

NOT TO SCALE

STATE	PROJECT NO.	COUNTY	SHEET NO.
NEVADA	SPSR-0159(015)	CLARK	ST1

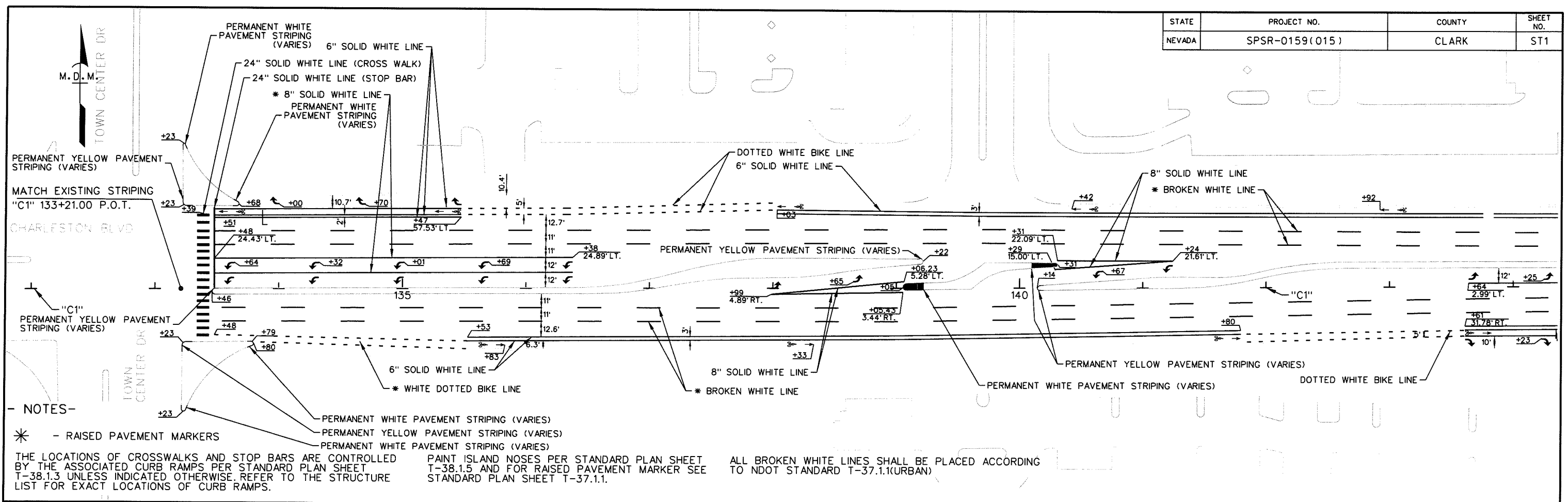

NOTES-

* - RAISED PAVEMENT MARKERS

THE LOCATIONS OF CROSSWALKS AND STOP BARS ARE CONTROLLED BY THE ASSOCIATED CURB RAMPS PER STANDARD PLAN SHEET T-38.1.3 UNLESS INDICATED OTHERWISE. REFER TO THE STRUCTURE LIST FOR EXACT LOCATIONS OF CURB RAMPS.

PAINT ISLAND NOSES PER STANDARD PLAN SHEET T-38.1.5 AND FOR RAISED PAVEMENT MARKER SEE STANDARD PLAN SHEET T-37.1.1.

ALL BROKEN WHITE LINES SHALL BE PLACED ACCORDING TO NDOT STANDARD T-37.1.1(URBAN)

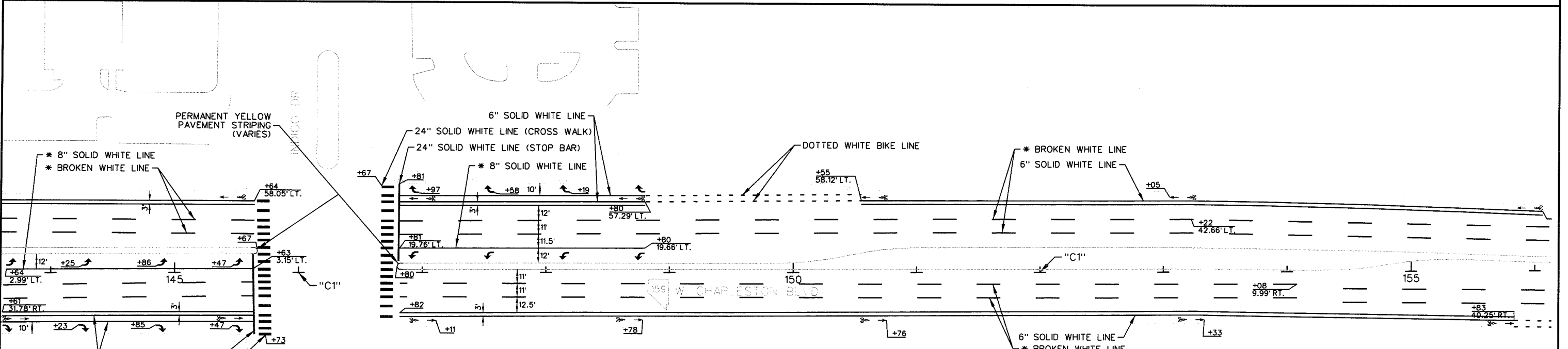

STATE OF NEVADA
DEPARTMENT OF TRANSPORTATION

PERMANENT STRIPING DETAILS

38

