

**ELECTRICAL POWER PLAN AREA B**

SCALE: 1/8"=1'-0"

**NOTES:**

- 1 PROVIDE J-BOX AT SUB FLOOR (BELOW WOOD FLOOR) FOR FUTURE CONNECTION TO BLEACHERS.
- 2 PROVIDE J-BOX FOR FUTURE CONNECTION TO ROLL-UP DOORS. MOUNT ABOVE ACCESSIBLE CEILING, IF PRESENT. MINIMUM DEDICATED 1" C.
- 3 J-BOX FOR SCOREBOARD. VERIFY HEIGHT WITH ARCHITECT.
- 4 SEE DETAIL 5/E4.01 FOR FLOOR BOX AND INSTALLATION INFORMATION. REFER TO ARCHITECTURAL DRAWINGS FOR DIMENSIONING.
- 5 HOOP/CURTAIN CONTROL EQUIPMENT. SEE DETAIL 1/E2.01.
- 6 J-BOX FOR ADJUSTABLE BASKETBALL HOOP. MOUNTED PER MANUFACTURER SPECIFICATIONS. SEE DETAIL 1/E2.01 FOR CONTROL INFORMATION.
- 7 DOUBLE DUPLEX RECEPTACLE FOR SOUND SYSTEM EQUIPMENT.
- 8 J-BOX FOR FUTURE DIVIDER CURTAIN. SEE DETAIL 1.E3.01 FOR CONTROL INFORMATION.
- 9 SEE ONLINE DIAGRAM FOR FEEDER INFORMATION.
- 10 J-BOX FOR ELECTRIC FLUSH VALVES AND SENSORS. COORDINATED INSTALLATION OF 3#12, 1/2" C BETWEEN EACH FLUSH VALVE AND SENSORS WITH MECHANICAL CONTRACTOR.
- 11 ROUTE CIRCUIT THROUGH WFD. COORDINATE LOCATION WITH MECHANICAL CONTRACTOR.
- J-BOX FOR ELECTRIC SENSOR AT SINK. COORDINATE INSTALLATION OF 3#12, 1/2" C BETWEEN EACH SINK SENSOR WITH MECHANICAL CONTRACTOR.

**GENERAL NOTES:**

1. ALL WIRING AND CONDUIT SHALL BE CONCEALED WITHIN THE WALLS, INCLUDING BLOCK WALLS. COORDINATE CONDUIT INSTALLATION WITH OTHER TRADES PRIOR TO ROUGH-IN.
2. REFER TO SPECIFICATIONS AND ARCHITECTURAL FINISH SCHEDULE FOR DEVICE COVERPLATE REQUIREMENTS.

THESE RECORD DOCUMENTS HAVE BEEN PREPARED BASED ON INFORMATION PROVIDED BY OTHERS. THE DESIGN PROFESSIONAL HAS NOT VERIFIED THE ACCURACY AND/OR COMPLETENESS OF THIS INFORMATION AND SHALL NOT BE RESPONSIBLE FOR ANY ERRORS OR OMISSIONS WHICH MAY BE INCORPORATED HEREIN AS A RESULT.

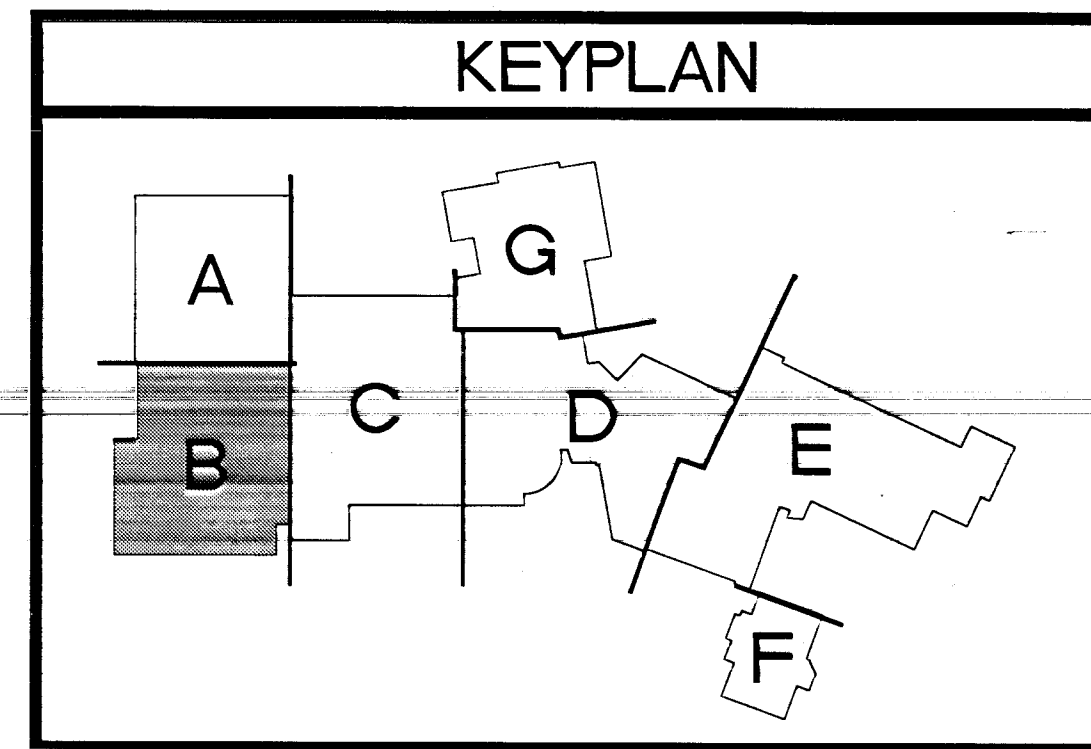

| <p>REVISIONS</p> <table border="1" style="width: 100%; border-collapse: collapse;"> <tr> <th>NO.</th> <th>DESCRIPTION</th> <th>DATE</th> </tr> <tr> <td> </td> <td> </td> <td> </td> </tr> </table> <p>CONSULTANT</p>                                                                                                                                                  | NO.         | DESCRIPTION | DATE |  |  |  | <p>OWNER: CITY OF LAS VEGAS<br/>DEPARTMENT OF PUBLIC WORKS<br/>ARCHITECTURAL SERVICES</p> <p>400 EAST STEWART AVENUE<br/>LAS VEGAS, NEVADA 89101<br/>PHONE: (702) 229-5533<br/>FAX: (702) 229-5545<br/>TDD: (702) 386-9108</p> <p>DATE: 03/20/05<br/>SCALE: 1/8"=1'-0"<br/>REV NO: 05.1534101<br/>REV DATE: 6-11-03</p> <p>047 E2.02 JIF<br/>12/1/04</p> |
|------------------------------------------------------------------------------------------------------------------------------------------------------------------------------------------------------------------------------------------------------------------------------------------------------------------------------------------------------------------------|-------------|-------------|------|--|--|--|----------------------------------------------------------------------------------------------------------------------------------------------------------------------------------------------------------------------------------------------------------------------------------------------------------------------------------------------------------|
| NO.                                                                                                                                                                                                                                                                                                                                                                    | DESCRIPTION | DATE        |      |  |  |  |                                                                                                                                                                                                                                                                                                                                                          |
|                                                                                                                                                                                                                                                                                                                                                                        |             |             |      |  |  |  |                                                                                                                                                                                                                                                                                                                                                          |
| <p>CITY OF LAS VEGAS<br/>CENTENNIAL HILLS COMMUNITY CENTER<br/>RECORD DRAWINGS<br/>ELECTRICAL POWER PLAN AREA B</p>                                                                                                                                                                                                                                                    |             |             |      |  |  |  |                                                                                                                                                                                                                                                                                                                                                          |
| <p>500 PILOT ROAD, SUITE A<br/>LAS VEGAS, NEVADA 89119<br/>702.263.7811<br/>702.263.8111 FAX</p> <p><b>LUCCHESI .GALATI</b></p>                                                                                                                                                                                                                                        |             |             |      |  |  |  |                                                                                                                                                                                                                                                                                                                                                          |
| <p>DISCLAIMER: THESE RECORD DRAWINGS PREPARED BY LUCCHESI GALATI ARCHITECTS, INC., ARE BASED ON INFORMATION PROVIDED BY OTHERS. LUCCHESI GALATI ARCHITECTS, INC. HAS NOT VERIFIED THE ACCURACY AND/OR COMPLETENESS OF THIS INFORMATION SUPPLIED BY OTHERS, AND SHALL NOT BE RESPONSIBLE FOR ANY ERRORS OR OMISSIONS, WHICH MAY BE INCORPORATED HEREIN AS A RESULT.</p> |             |             |      |  |  |  |                                                                                                                                                                                                                                                                                                                                                          |
| <p>DRAWING NO: E2.02</p>                                                                                                                                                                                                                                                                                                                                               |             |             |      |  |  |  |                                                                                                                                                                                                                                                                                                                                                          |