

ELECTRICAL LIGHTING PLAN AREA D

SCALE: 1/8"=1'-0"

SHEET NOTES:

- ① SEE SHEET E1.03 FOR CONTINUATION OF CIRCUIT H2-3.
- ② ROUTE CIRCUIT THROUGH TIMECLOCK AND CONTACTOR. SEE CONTACTOR SCHEDULE.
- ③ PROVIDE ADDITIONAL WIRE TO CIRCUIT TO MAINTAIN CONSTANT HOT TO THE EMERGENCY BALLAST.
- ④ SEE SHEET E1.03 FOR CONTINUATION OF CIRCUIT H1-34.
- ⑤ AREA TO BE CONTROLLED BY DAY LIGHTING SENSOR. SEE DETAIL 2/E4.04 FOR ADDITIONAL INFORMATION.
- ⑥ SEE SHEET E1.05 FOR CONTINUATION OF CIRCUIT H4-11.

2.13 REFERENCE: DRAWING E1.04
 ADD: JUNCTION BOX AS REQUIRED FOR BUILDING SIGNAGE INDICATED ON ARCHITECTURAL DRAWING AS.01 ROUTE 3#10, 3/4" FROM SIGNAGE TO L2B-15. ROUTE THROUGH CONTACTOR C1c.

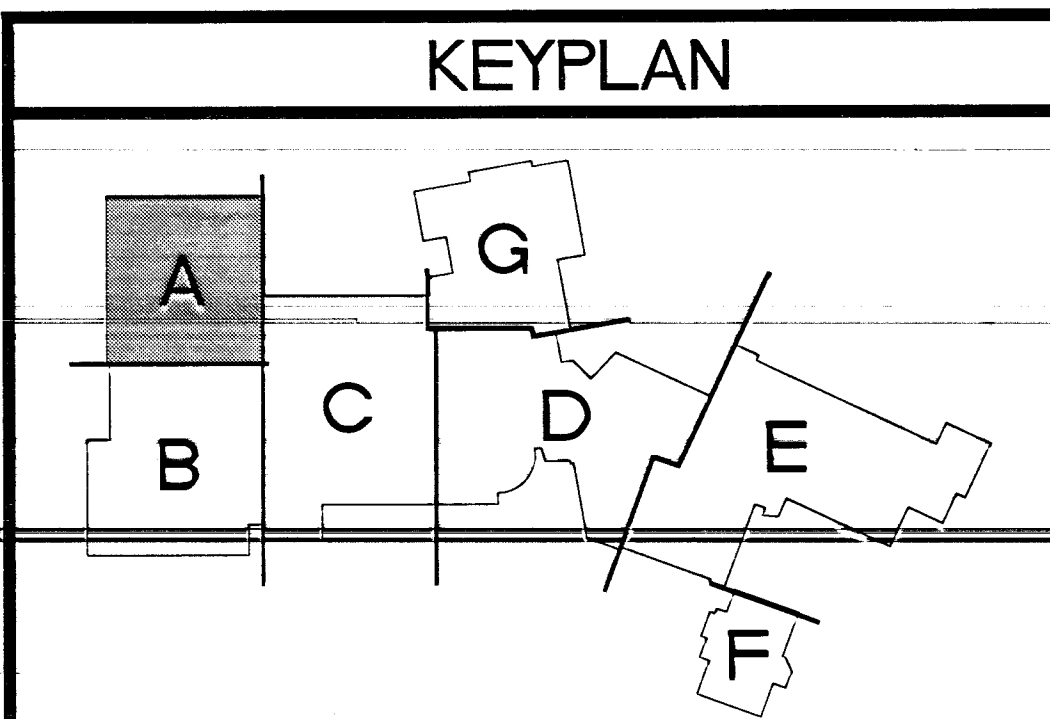

THESE RECORD DOCUMENTS HAVE BEEN PREPARED BASED ON INFORMATION PROVIDED BY OTHERS. THE DESIGN PROFESSIONAL HAS NOT VERIFIED THE ACCURACY AND/OR COMPLETENESS OF THIS INFORMATION AND SHALL NOT BE RESPONSIBLE FOR ANY ERRORS OR OMISSIONS WHICH MAY BE INCORPORATED HEREIN AS A RESULT.

RECORD DRAWINGS 10/27/07

CONTRACT

OWNER: CITY OF LAS VEGAS
 DEPARTMENT OF PUBLIC WORKS
 ARCHITECTURAL SERVICES

400 EAST STEWART AVENUE
 LAS VEGAS, NEVADA 89103
 PHONE: (702) 229-8535
 FAX: (702) 388-8848
 TDD: (702) 388-9108

DATE: 03/26/08
 SCALE: AS SHOWN
 DRAWING NO: 05.5341.01
 DATE: 6/11/08

E1.04

DISCLAIMER: THESE RECORD DRAWINGS PREPARED BY LUCCHESI GALATI ARCHITECTS, INC. ARE BASED ON INFORMATION PROVIDED BY OTHERS. LUCCHESI GALATI ARCHITECTS, INC. HAS NOT VERIFIED THE ACCURACY AND/OR COMPLETENESS OF THIS INFORMATION SUPPLIED BY OTHERS, AND SHALL NOT BE RESPONSIBLE FOR ANY ERRORS OR OMISSIONS, WHICH MAY BE INCORPORATED HEREIN AS A RESULT.

LUCCHESI GALATI
 300 WEST KANT AVENUE
 LAS VEGAS, NEVADA 89109
 (702) 263-3711
 (702) 263-3811 FAX