

SHEET NOTES

- ① DROP 8" SD/OSD TO TERMINATE OUT OF WALL @ 6" ABOVE FINISH GRADE.
- ② 5" SD/OSD DOWN FROM ROOF DRAINAGE AND ROUTE BELOW ROOF STRUCTURE.
- ③ DROP 1/2" CW IN WALL. TEE 1/2" CW IN WALL TO HEATER. ROUTE 1/2" HW FROM HEATER TO SINK. RISE 2" V UP AND DROP 2" SS TO ROUTE BELOW FLOOR.
- ④ RISE 2" V UP FROM BELOW FLOOR IN WALL TO CEILING.
- ⑤ 4" SD/OSD DOWN FROM ROOF DRAINAGE AND ROUTE BELOW ROOF STRUCTURE.
- ⑥ 3" SD/OSD DOWN FROM ROOF DRAINAGE AND ROUTE BELOW ROOF STRUCTURE.
- ⑦ DROP 3/4" CW ALONG WALL.
- ⑧ DROP 1/2" CW IN WALL WITH ANGLE STOP IN WALL BOX TO SERVE ICE MAKER.
- ⑨ DROP 6" SD/OSD TO TERMINATE OUT OF WALL @ 6" ABOVE FINISH GRADE.
- ⑩ 3/4" CW TO SERVE WH-3 ON ROOF.

PLUMBING PIPING SHALL NOT BE RUN IN CMU BLOCK. ROUTE PIPING EITHER IN FURRED OUT OR STUD WALLS.

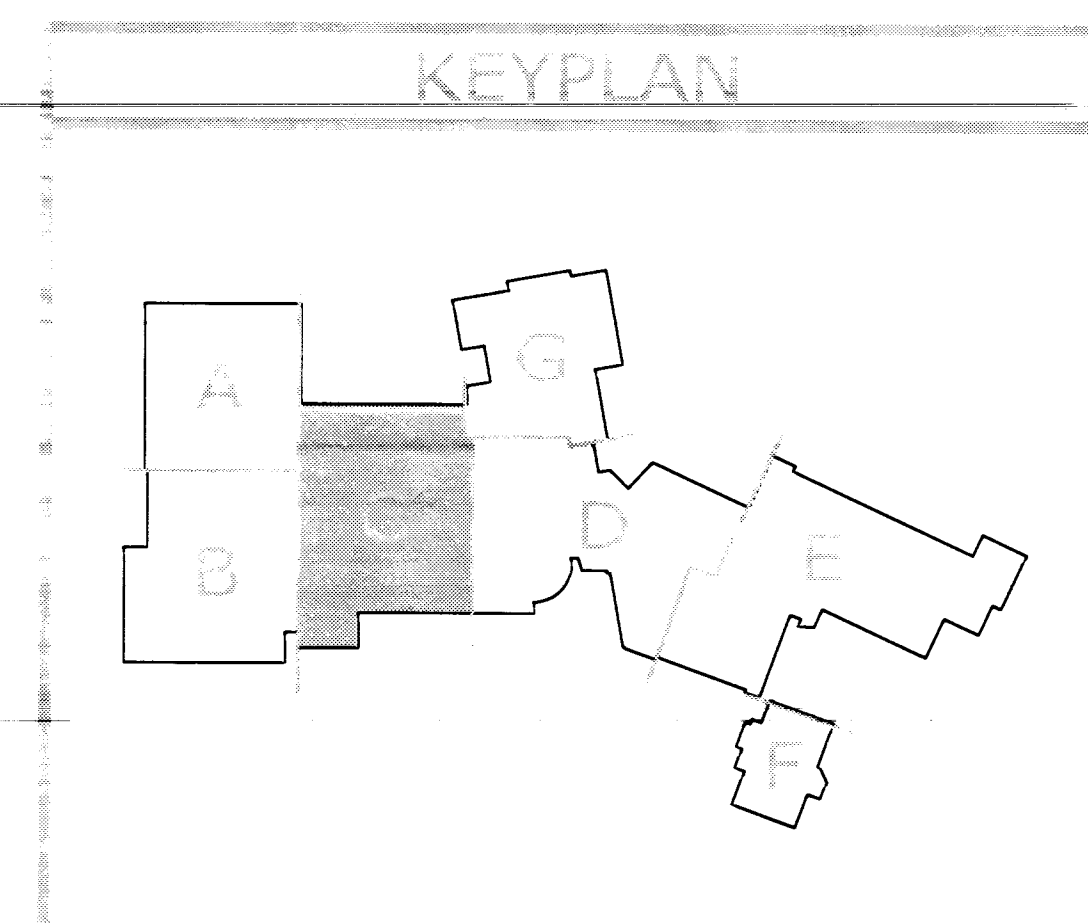

FLOOR PLAN - AREA C
 P2.03 SCALE: 1/8" = 1'-0"

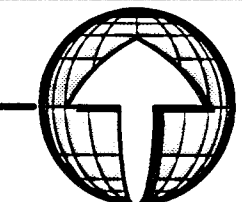

RECORD DRAWING: 10/5/07
 800 RENO ROAD, SUITE A
 LAS VEGAS, NEVADA 89169
 TEL: 702-333-7111 FAX: 702-333-7111
LUCCHESI GALATI
 Disclaimers: These record drawings prepared by Lucchesi Galati Architects, Inc., are based on information provided by others. Lucchesi Galati Architects, Inc. has not verified the accuracy and/or completeness of the information supplied by others, and shall not be responsible for any errors or omissions, which may be incorporated herein as a result.

CITY OF LAS VEGAS
 CENTENNIAL HILLS COMMUNITY CENTER
 FLOOR PLAN - AREA C

DATE	12-13-07
BY	...
NO.	051534101
REV.	6711-49