

Jun 15, 2010 - 7:21am - USBR_dchd_casabhyr - K:\PHX_Roadway\02-Las Vegas\02256019-Bonnevill...Clark, CA\CAD\Bonneville-Clark, IR01-07\256019\01_07.dwg

MATCHLINE ~ STA 215+25
 SEE SHEET IR-06

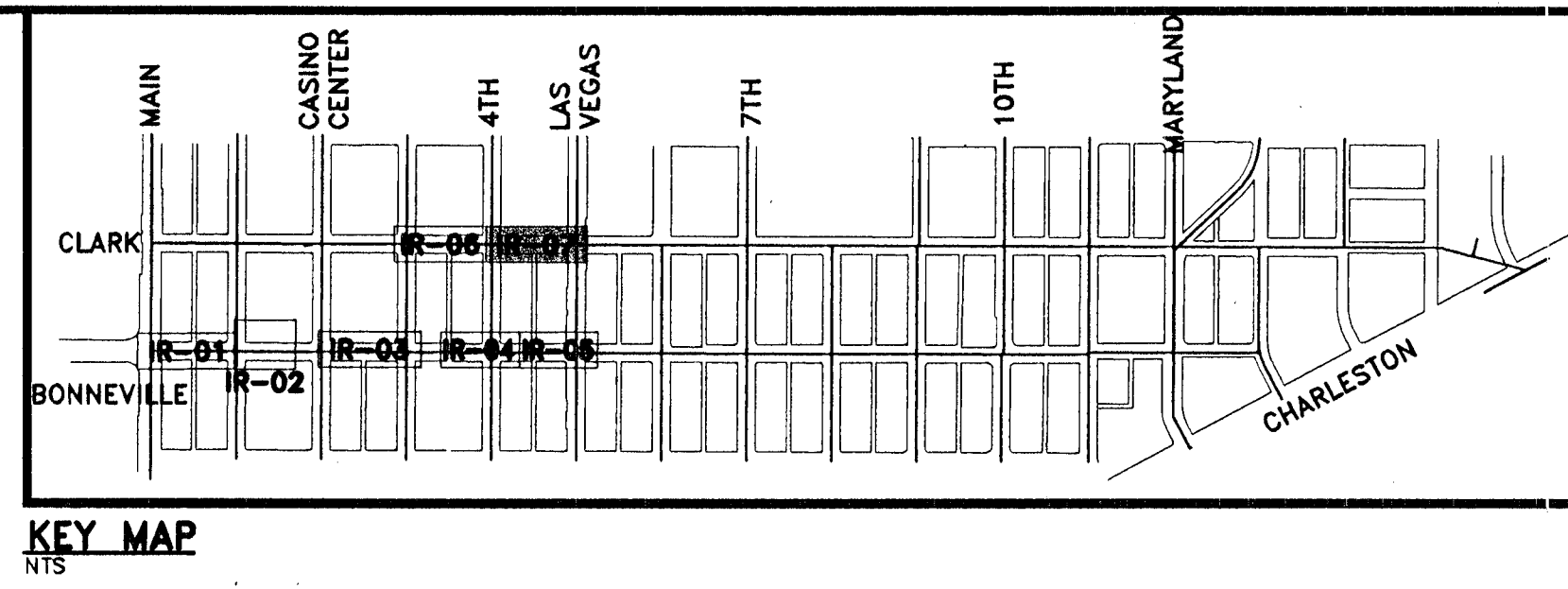
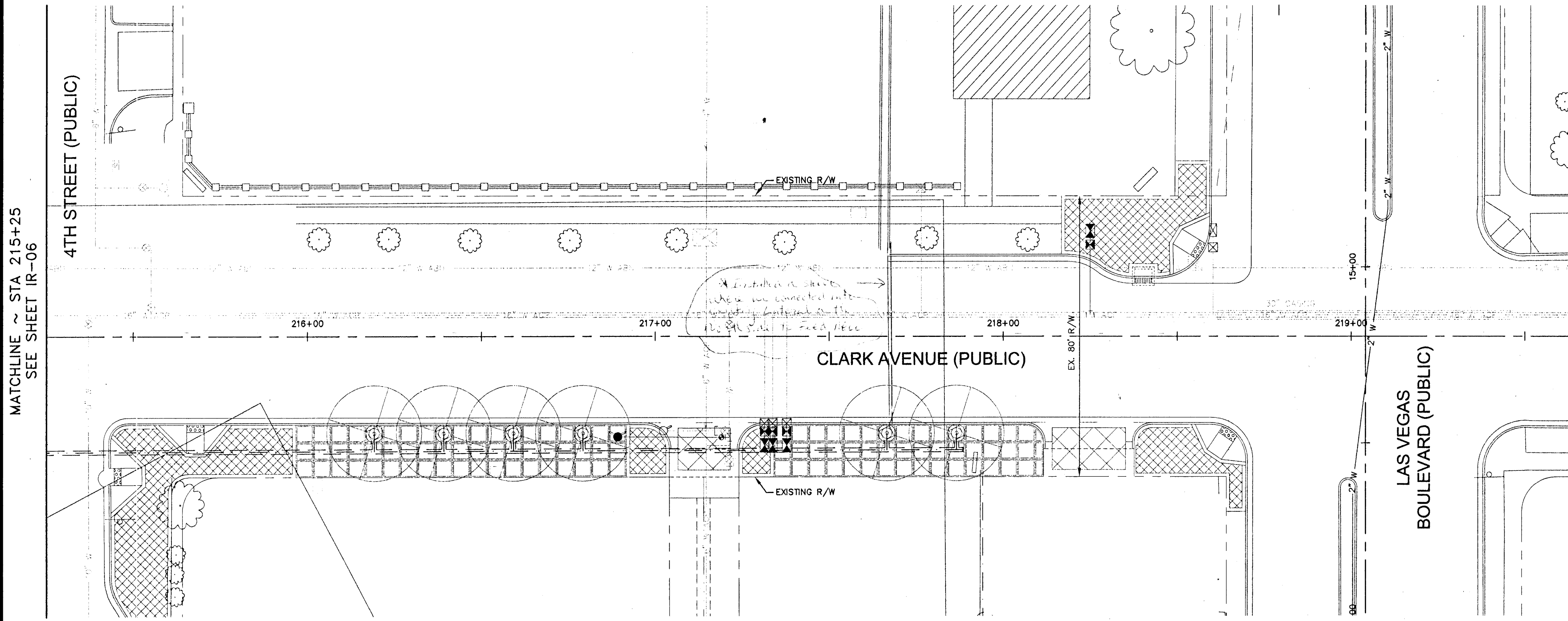

IRRIGATION SCHEDULE

| EMITTERS | | | | | | | | |
|-----------|-------------|------|------|-----|---------|--------------|--------------------------------|--------------|
| SYMBOL | DESCRIPTION | PAT. | RAD. | PSI | GPM/H | MANUFACTURER | MODEL | DETAIL/SHEET |
| NOT SHOWN | BUBBLER | BUB. | - | 10 | 25 GPM | RAINBIRD | 1401 IN PALM TUBE (3) PER PALM | - |
| NOT SHOWN | EMITTER | DRIP | - | 7 | 2.0 GPH | BOWSMITH | SL-220 (FOR TREES) | J/IR-08 |
| NOT SHOWN | EMITTER | DRIP | - | 7 | 1.0 GPH | BOWSMITH | SL-210 (FOR SHRUBS) | J/IR-08 |

| EQUIPMENT | | | |
|-----------|---|---|--------------|
| SYMBOL | DESCRIPTION | MODEL | DETAIL/SHEET |
| | AUTOMATIC PEDESTAL MOUNT CONTROLLER(S) (A-D) - 12 STATION CONTROLLER | RAINBIRD ESP-SITE-SAT-S WITH ONE REMOTE CONTROL TECHNOLOGY COMMANDER PER PROJECT. | A/IR-08 |
| | WATER METER (SEE SHEET UT-01 TO UT-02) | | |
| | BACKFLOW PREVENTION DEVICE: (SEE SHEET UT-01 TO UT-02) | | |
| | FLOW SENSOR ASSEMBLY (OPERABLE BETWEEN 7.0 TO 225.0 GPM) | DATA INDUSTRIAL | C/IR-08 |
| | GATE VALVE (1") | NIBCO T-113 | D/IR-08 |
| | DRIP VALVE (SIZE PER PLAN) (OPERATING RANGES FROM 3.0 - 20.0 GPM) | XCZ-100-B-00M SERIES RAINBIRD | E/IR-08 |
| | DRIP VALVE (SIZE PER PLAN) (OPERATING RANGES FROM .20 - 5.0 GPM) | XCZ-LF-100 SERIES RAINBIRD | E/IR-08 |
| | PALM VALVE ASSEMBLY: CENTURY 700 SERIES ELECTRIC VALVE (1") WITH FLOW CONTROL | | E/IR-08 |
| | 1" QUICK COUPLER VALVE | RAINBIRD 44 LRC, 1", 30GPM | F/IR-08 |
| | DRIP END BALL VALVE | | G/IR-08 |

| PIPE | | | |
|--------|--|-----------|--------------|
| SYMBOL | MANUFACTURER - MODEL NUMBER | MODEL | DETAIL/SHEET |
| | MAINLINE: PVC SCH. 40 (1"); UNLESS NOTED OTHERWISE | | H/IR-08 |
| | LATERAL TREE LINE: PVC SCH. 40 MIN. (3/4" MIN. SIZE NOTED OTHERWISE) | EXCALIBUR | H/IR-08 |
| | LATERAL SHRUB LINE: PVC SCH. 40 MIN. (3/4" MIN. SIZE NOTED OTHERWISE) | EXCALIBUR | H/IR-08 |
| | LATERAL PALM LINE: PVC SCH. 40 MIN. (3/4" MIN. SIZE NOTED OTHERWISE) | EXCALIBUR | H/IR-08 |
| | MAINLINE SLEEVES, PVC SCH. 40 - 2 TIMES (2X) DIA. OF MAINLINE PIPE BEING USED; UNLESS OTHERWISE NOTED; MIN. 2" | | I/IR-08 |
| | LATERAL SLEEVES, PVC SCH. 40 - 2 TIMES (2X) DIA. OF LATERAL PIPE BEING USED; UNLESS OTHERWISE NOTED; MIN. 2" | | I/IR-08 |

NOTES

- THE IRRIGATION PLANS ARE SCHEMATIC, PLACE ALL EQUIPMENT, PIPING AND WIRING IN LANDSCAPE PLANTERS WHEREVER POSSIBLE.
- IT IS THE INTENT OF THESE DRAWINGS TO PROVIDE A 100% COVERAGE IRRIGATION SYSTEM TO ALL PROPOSED PLANTINGS.
- IF DISCREPANCIES EXIST BETWEEN THESE PLANS AND ACTUAL SITE CONDITIONS, BRING THE DISCREPANCIES TO THE IMMEDIATE ATTENTION OF THE CONSTRUCTION MANAGER.
- THE CONTRACTOR SHALL COMPLY WITH ALL LAWS, CODES AND ORDINANCES AS THEY PERTAIN TO THE SPECIFIED WORK.
- THE CONTRACTOR IS RESPONSIBLE FOR OBTAINING AND PAYING FOR ALL PERMITS AND FEES ASSOCIATED WITH THE SPECIFIED WORK, EXCEPT ORDINANCES AS THEY PERTAIN TO THE SPECIFIED WORK.
- THE LANDSCAPE ARCHITECT HAS WORKED TO ASCERTAIN THE LOCATION OF UTILITIES THAT MAY CONFLICT WITH THE WORK. IT IS THE CONTRACTOR'S RESPONSIBILITY TO ARRANGE FOR THE MARKING OF ALL UTILITIES PRIOR TO BEGINNING WORK.
- THE CONTRACTOR SHALL BE RESPONSIBLE FOR ALL DAMAGE TO EXISTING UTILITIES AND OR STRUCTURES DURING THE CONSTRUCTION PERIOD. THE CONTRACTOR SHALL REPAIR ALL DAMAGE TO THE OWNER'S STANDARDS AT NO ADDITIONAL COST TO THE OWNER.
- THE CONTRACTOR SHALL CAP ALL IRRIGATION LINES AND RELOCATE EXISTING EMITTERS CURRENTLY LOCATED IN DEMOLITION AREAS. CONTRACTOR SHALL REGRADE, REPAIR AND REPLACE BOULDER BANDS, CRUSHED STONE PAVING, REPLACE GLASS BLOCK BAND AND ILLUMINATOR AT CONTRACTORS EXPENSE. CONTRACTOR IS RESPONSIBLE FOR VERIFYING CONDITIONS PRIOR TO BIDDING.

A-1

- CONTROLLER/STATION NUMBER
- 1" VALVE SIZE
- 00.0 GPM
- SHRUB TREE/SHRUB

LOCATION OF IRRIGATION EQUIPMENT IS SHOWN DIAGRAMMATICALLY FOR CLARITY. LOCATE EQUIPMENT WITHIN PLANTING AREAS WHEREVER POSSIBLE.

| EMITTER QUANTITIES | |
|--------------------|----------|
| PLANT SIZE | QTY |
| TREES: | |
| 36" BOX | 10-2 GPH |
| SHRUBS: | |
| 5 GAL | 2-1 GPH |

| CONTROLLER | STATION | VALVE SIZE | GPM | TYPE |
|------------|---------|------------|------|-------|
| A | 2 | 1" | 1.85 | TREE |
| A | 3 | 1" | 3.10 | SHRUB |
| A | 4 | 1" | 4.50 | PALM |
| B | 5 | 1" | 2.64 | TREE |
| C | 6 | 1" | 3.30 | SHRUB |
| C | 7 | 1" | 3.17 | TREE |
| D | 8 | 1" | 0.80 | SHRUB |
| D | 9 | 1" | 5.54 | TREE |

TAND, INC.
AS-BUILT
 DATE: 11/14/10
 DANIEL MEYER

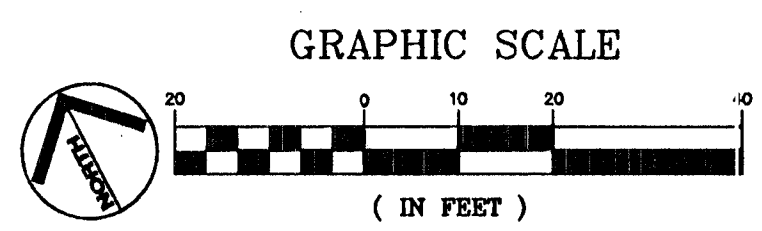

811 SAFETY ALERT
 Call Before You Dig
 Before You Overhead
 Call before you dig! 1-702-227-2929

REVISIONS: SHEET REPLACEMENT
 DATE: 06/17/10
 SCALE (H): 1"=20'
 SCALE (V): N/A
 DESIGNED BY: DJC
 CHECKED BY: ACP
 DRAWN BY: FR
 DATE: FEBRUARY 2010
 PROJECT: BONNEVILLE/CLARK ONEWAY COUPLER PHASE 1 IMPROVEMENT PLANS
 SHEET: IRRIGATION SHEET
 CONTRACTOR: Kimley-Horn and Associates, Inc.
 Engineering, Planning, and Environmental Consultants
 2080 E. Flamingo Road, Suite 210, Las Vegas, NV 89119
 FAX (702) 735-4949
 DEPARTMENT OF PUBLIC WORKS
 STATE OF NEVADA
 REGISTERED LANDSCAPE ARCHITECT
 7911
 Expires: 6-30-11
 SHEET NO. IR-08 OF 91
 DRAWING NO. 107V5201
 BID # 09.1730.37 REV 3