

Jun 15, 2010 - 7:45am - USER: gawd.cassibury  
 C:\Users\gawd.cassibury\AppData\Local\Temp\102225011-Bonnevill-Clark-LA01-0712560198-01\_07.dwg

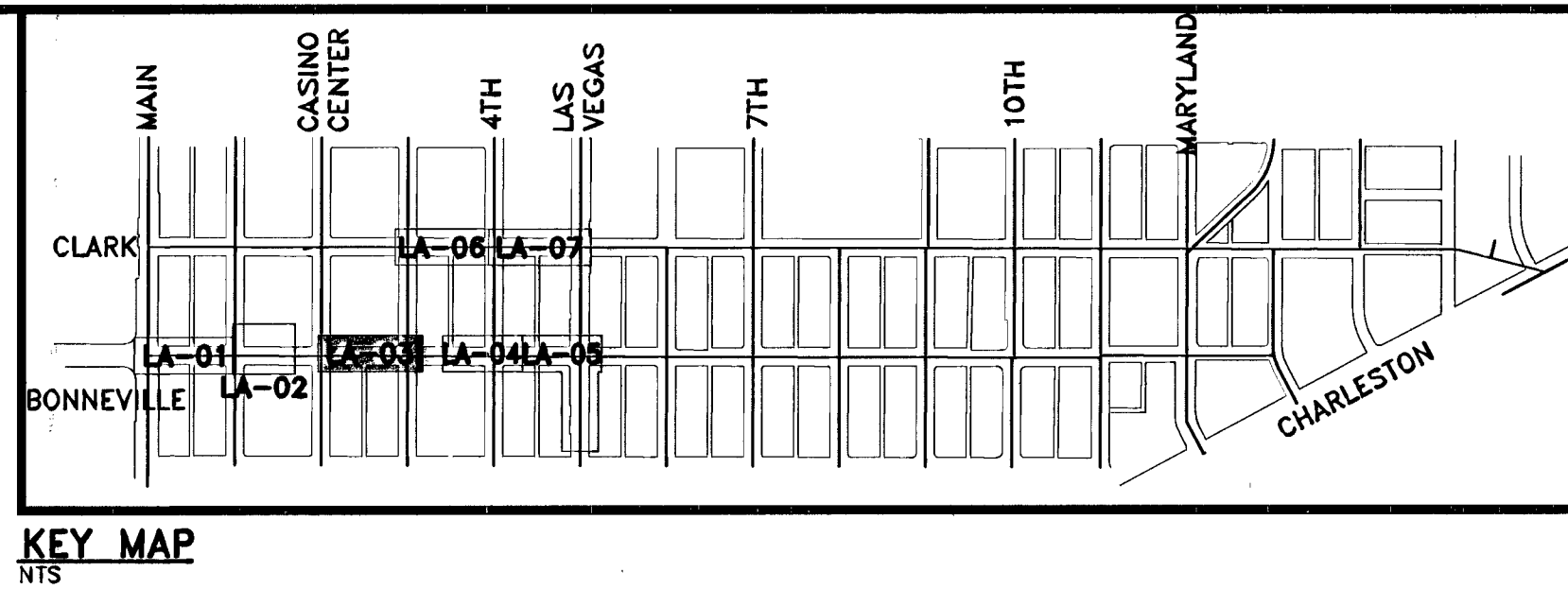
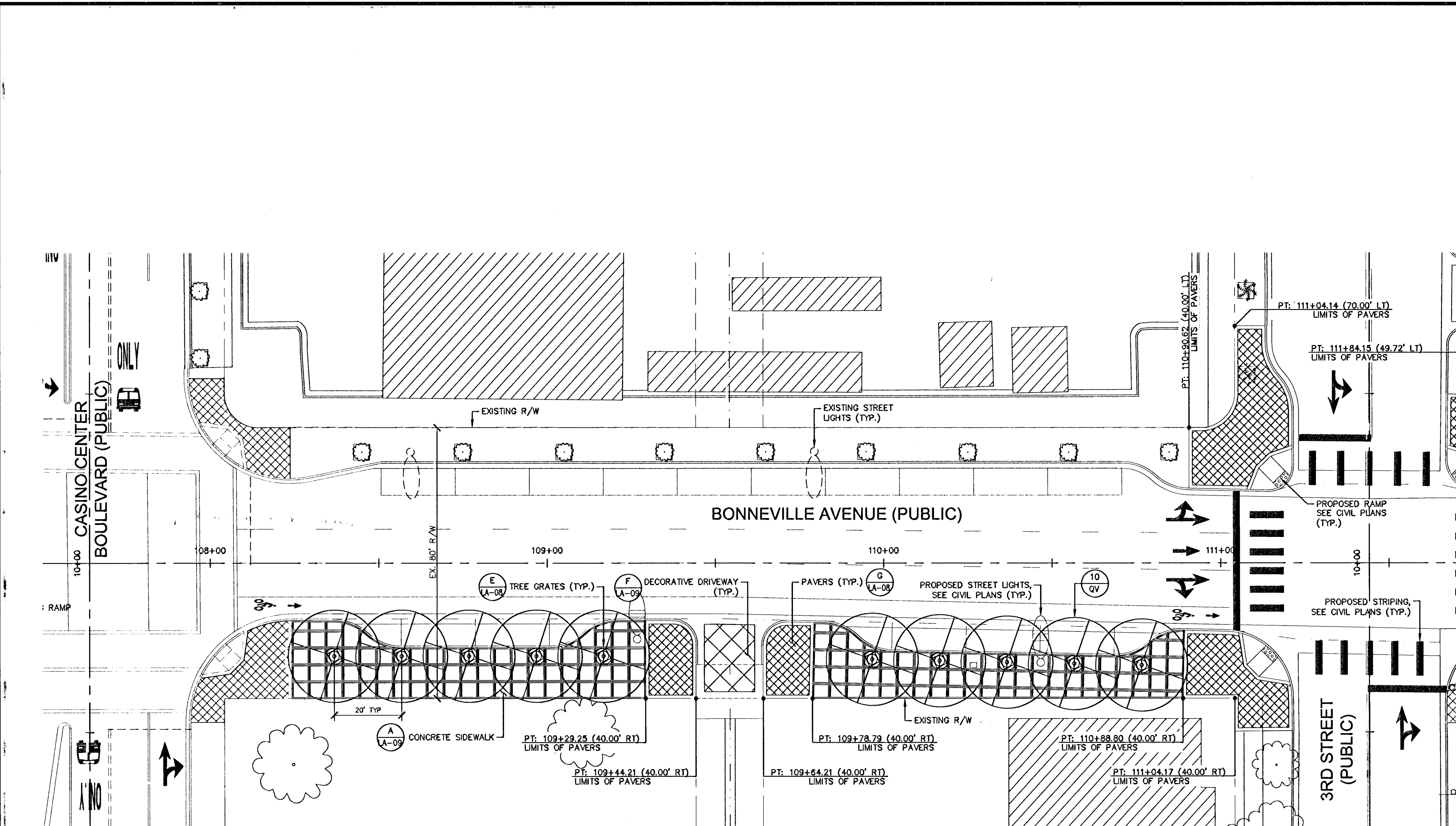

**PLANT SCHEDULE**

TREES, EXISTING TREES, SHRUBS & GROUNDCOVERS				
SYMBOL	BOTANICAL NAME	COMMON NAME	QTY.	SIZE
	QV - Quercus virginiana	Southern Live Oak	49	36" BOX
	PD - Phoenix dactylifera	Phoenix Date Palm	17	36" ROOT BALL 25' HEIGHT
	XT - EXISTING TREE			
	XP - EXISTING PALM TREE			
	CN - Cassia nemophila	Desert Cassia	137	5 GAL
	CD - Cotoneaster dammeri 'Coral Beauty'	Coral Beauty Cotoneaster	122	5 GAL
	AR - Acacia redolens 'Desert Carpet'	Desert Carpet	52	5 GAL
	CO - Convolvulus cneorum	Bush Morning Glory	35	5 GAL
	LS - Lantana camara 'New Gold'	New Gold Lantana	47	5 GAL

**NOTES**

- CONTRACTOR IS RESPONSIBLE TO VERIFY ALL PLANT QUANTITIES. THE PLANT SCHEDULE IS INTENDED AS A REFERENCE ONLY.
  - LANDSCAPE ARCHITECT IS TO APPROVE ALL PLANT MATERIAL PRIOR TO INSTALLATION WITH A 48 HOUR ADVANCED NOTICE.
  - PLANT MATERIAL IS TO HAVE IDENTIFICATION TAGS ON 10% OF THE TOTAL QUANTITY OF EACH SPECIES, SHOWING GENUS, SPECIES, VARIETY, ETC.
  - CONTRACTOR TO PROVIDE MATCHING SIZES AND FORMS OF LIKE SHRUB SPECIES AS SHOWN ON DRAWINGS.
  - DECOMPOSED GRANITE, 1/2" MINUS, COLOR: "PINK CORAL", 2" DEPTH TYPICAL IN ALL PLANTING BEDS. DECOMPOSED GRANITE SHALL CONTAIN 60% AGGREGATE AND 40% FINES. CONTRACTOR TO RECEIVE VERIFICATION FROM ROCK SUPPLIER AND PRESENT VERIFICATION TO THE OWNER PRIOR TO ANY CONSTRUCTION.
- WHOLESALE DEALER:  
 KALAMAZOO MATERIALS, INC.  
 2251 SOUTH FORT APACHE ROAD, SUITE 2079  
 LAS VEGAS, NV 89117  
 TELEPHONE: (702) 298-9133
- 20% 4' LARGEST DIAMETER\*  
 40% 3' LARGEST DIAMETER  
 40% 2' LARGEST DIAMETER  
 TOTAL QUANTITY OF BOULDERS: 68
- \* NOT TO BE USED IN AREAS LESS THAN 7'
- LANDSCAPE UPLIGHTING—  
 INSTALL TRAILBLAZER LANDSCAPE LIGHT, PRODUCT CODE LT-24-12W-45D-RD-VC-TW-LT6912GRS, OR APPROVED EQUAL

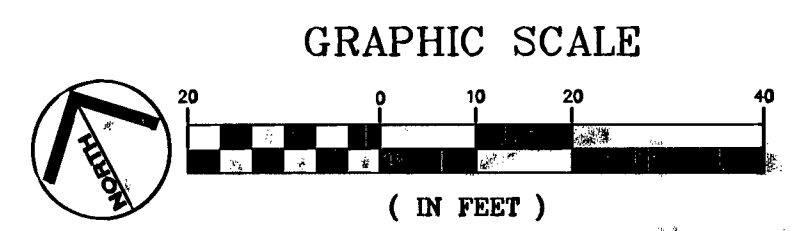

REVISIONS SHEET REPLACEMENT	DATE 6/15/10	DATE: FEBRUARY 2010 CHECKED BY: ACP	SCALE (V): N/A DESIGNED BY: DJC	SCALE (H): 1"=20' DRAWN BY: FR	PROJECT: BONNEVILLE/CLARK ONEWAY COUPLER PHASE 1 IMPROVEMENT PLANS
DEPARTMENT OF PUBLIC WORKS LANDSCAPE SHEET					
Kimley-Horn and Associates, Inc. Engineering, Planning, and Environmental Consultants 2080 E. Flamingo Road, Suite 210, Las Vegas, NV 89119 PH: (702) 734-4949 FAX: (702) 735-4949					
811 SAFETY ALERT Before You Overhead Call before you dig! 1-702-227-2929					
UNDERGROUND Before you dig Call before you dig! 1-702-227-2929					
SHEET NO. LA-03 SHEET 75 OF 91 DRAWING NO. 1075201					

124564

BID# 09.1730.37 REV 3