

Jan 18, 2010 - 10:40am - USER: peter.meyerhofer
\\LAVP01\Projects\LAU_Public\Tran\0622255\019_Bonneville-Clark_2008\CADD\256019sm-01_06.dwg

MATCHLINE ~ SEE SHEET SM-02

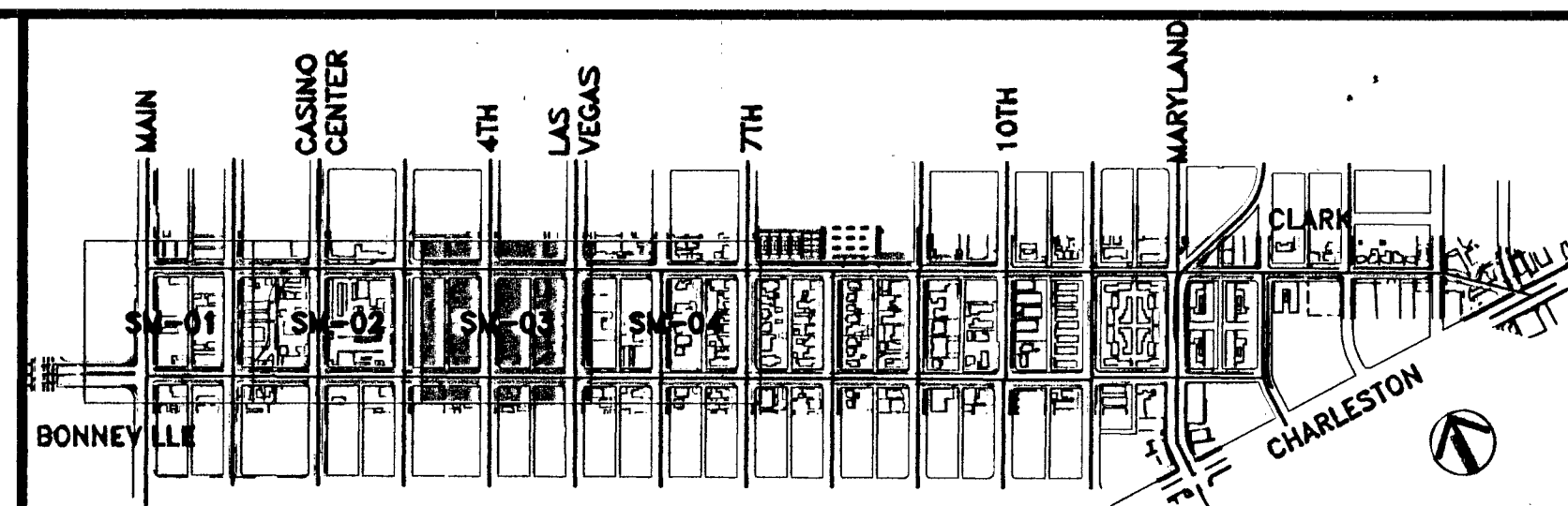
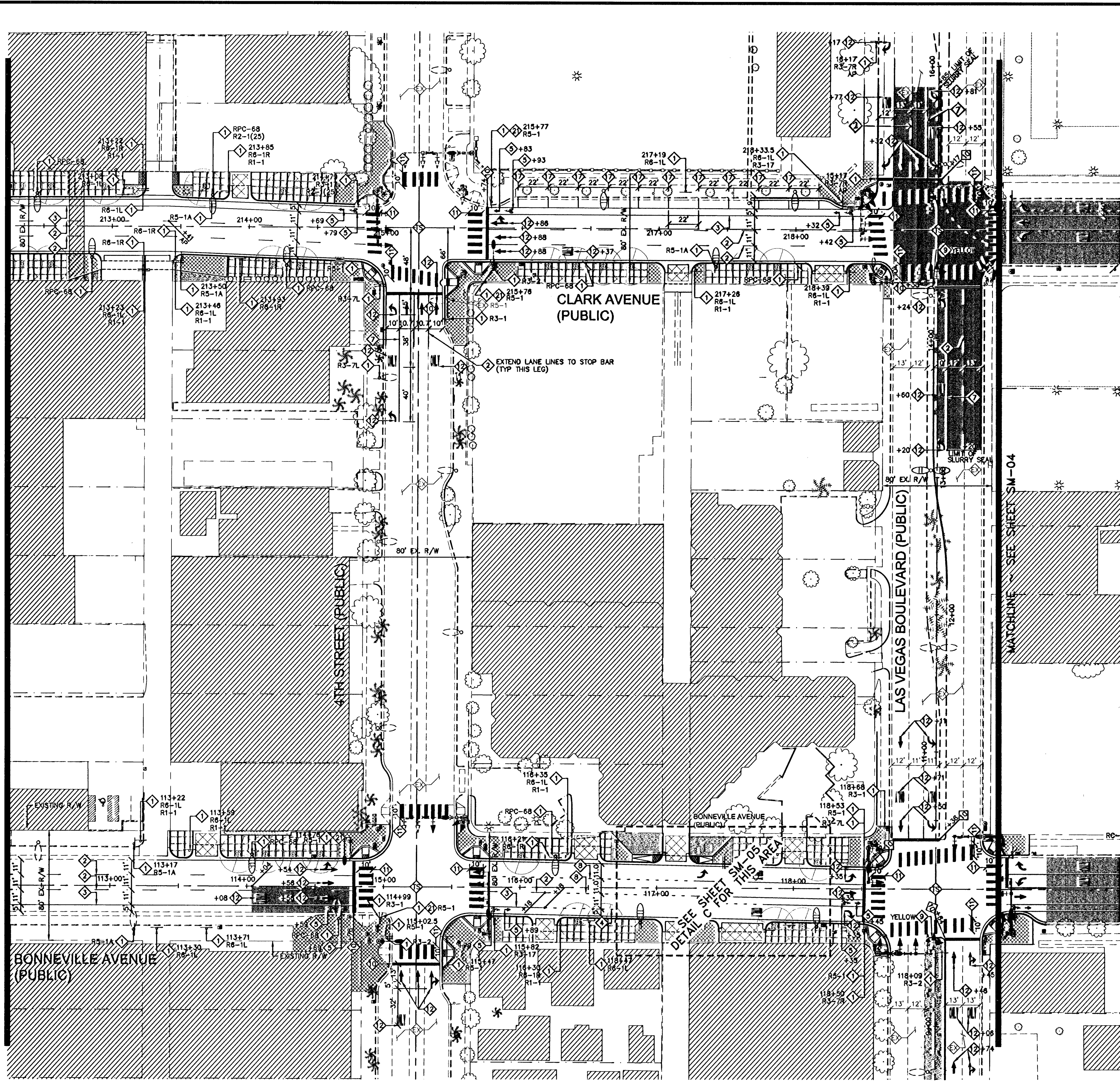

KEY MAP

CONSTRUCTION NOTES

- CRACK AND SLURRY SEAL EXISTING ASPHALT SURFACE, TO LIMITS SHOWN ON PLANS, AFTER ALL TRENCH WORK HAS BEEN COMPLETED AND PRIOR TO THE INSTALLATION OF ANY STRIPING SHOWN HERE WITHIN.
- INSTALL 1" UTACS OVER 1-1/2" ASPHALTIC CONCRETE (AC DENSE GRADE) TO LIMITS SHOWN ON DM SHEETS (MILL LIMITS).
- EXISTING SIGN SHALL REMAIN.
- EXISTING PAVEMENT MARKING SHALL REMAIN.
- TRAFFIC SIGNAL CONTROLLED INTERSECTION. SEE TS SHEETS FOR ADDITIONAL SIGNAGE.
- INSTALL NEW SIGN(S) WITH ENCAPSULATED LENS RETROREFLECTIVE SHEETING (CLASS 6 REFLECTIVE SHEETING OR APPROVED EQUAL). SIGN(S) SHALL BE GROUND MOUNTED ON POST (PER CCAUSD No. 249A), MOUNTED TO STREET LIGHT POLE, OR AS DIRECTED BY THE ENGINEER.
- INSTALL TYPE 4 LANE LINE PER CCAUSD No. 244A (POLYUREA WHITE PAINT).
- INSTALL 6" (POLYUREA WHITE PAINT) BICYCLE LANE LINE PER CCAUSD No. 244.5.
- INSTALL 6"x2" BIKE SKIP LINE 8' ON CENTER (POLYUREA WHITE PAINT) BICYCLE LANE LINE PER CCAUSD No. 244.5.
- INSTALL BIKE PAVEMENT LEGEND (WHITE PAVEMENT MARKING FILM) PER CCAUSD No. 244.5. LEGEND SHALL BE CENTERED IN BIKE LANE AS ANNOTATED.
- INSTALL TYPICAL LANE DELINEATION IN TRANSITION SECTION WHERE TRAFFIC FLOWS IN OPPOSING DIRECTION PER CCAUSD No. 245 (2 of 3) (YELLOW PAVEMENT MARKING FILM).
- INSTALL 8" (POLYUREA WHITE PAINT) STORAGE LANE LINE PER CCAUSD No. 248.
- INSTALL DROP LANE LINE PER CCAUSD 248A (POLYUREA WHITE PAINT).
- INSTALL MEDIAN NOSE MARKINGS PER CCAUSD No. 248. ANY MEDIAN 2 FEET OR LESS IN WIDTH, OR AS DIRECTED BY THE ENGINEER, SHALL BE PAINTED THE SAME COLOR AS ITS CORRESPONDING MEDIAN NOSE.
- INSTALL STOP BAR (WHITE PAVEMENT MARKING FILM) PER CCAUSD No. 254A.
- INSTALL CROSSWALK LINES (WHITE PAVEMENT MARKING FILM) PER CCAUSD No. 254A.
- INSTALL PAVEMENT LEGEND (WHITE PAVEMENT MARKING FILM) PER CCAUSD No. 248A. LEGEND SHALL BE CENTERED IN LANE AS ANNOTATED.
- INSTALL K-71 SELF-ERECTING MARKER POST (COLOR PER MEDIAN NOSE COLORING).
- INSTALL "CAT TRACK" MARKING (POLYUREA WHITE PAINT) PER DETAIL SHEET SM-08.
- INSTALL 6" (POLYUREA WHITE PAINT) SHOULDER STRIPE 1' FROM EDGE OF PAVEMENT.
- INSTALL TYPE 1 CENTERLINE (POLYUREA YELLOW PAINT) PER CCAUSD No. 244.
- INSTALL 4" (POLYUREA WHITE PAINT) PARKING LINE.
- NOT USED.
- NOT USED.
- INSTALL TYPICAL LANE DELINEATION IN TRANSITION SECTION WHERE TRAFFIC FLOWS IN SAME DIRECTION PER CCAUSD No. 245 (3 of 3) (WHITE PAVEMENT MARKING FILM).
- INSTALL SIGN AT 20° ANGLE.

GENERAL NOTES

1. CONTRACTOR SHALL REMOVE ANY EXISTING STRIPING THAT CONFLICTS WITH THE PROPOSED STRIPING.
2. ALL EXISTING SIGNS THAT CONTRADICT PROPOSED IMPROVEMENTS SHALL BE REMOVED. VERIFY IN THE FIELD WITH THE DESIGN ENGINEER.
3. THE CONTRACTOR SHALL TAKE ALL PRECAUTIONARY MEASURES NECESSARY TO PROTECT EXISTING IMPROVEMENTS FROM DAMAGE. ALL IMPROVEMENTS OR STRUCTURES DAMAGED BY THE CONTRACTORS OPERATIONS SHALL BE REPAIRED OR REPLACED TO THE SATISFACTION OF THE ENGINEER AT THE EXPENSE OF THE CONTRACTOR.
4. ALL DIMENSIONS ARE FROM THE EDGE OF PAVEMENT UNLESS OTHERWISE NOTED ON PLANS.
5. REFER TO SHEET SM-08 FOR SIGNING AND MARKING RELATED DETAILS AND ESTIMATED QUANTITIES.
6. REFER TO SHEET SM-08 FOR SIGNING AND MARKING SCHEDULES INCLUDING DESIGNATIONS, SYMBOLS, AND SIZES.
7. STREET NAME SIGNS SHALL BE INSTALLED AT EVERY INTERSECTION WITH IN THE PROJECT LIMITS, PER USDOCA No. 249 AND 250.
8. THE CONTRACTOR SHALL REFER TO DM SHEETS FOR LIMITS OF UTACS/DENSE GRADE IMPROVEMENTS.

BASIS OF BEARING

THE BASIS OF BEARINGS FOR THIS SURVEY IS GRID NORTH AS DEFINED BY THE NORTH AMERICAN DATUM OF 1983 (NAD 83), NEVADA STATE PLANE EAST (2701) ZONE. SAID BEARINGS WERE DETERMINED BY STATIC GLOBAL POSITIONING SYSTEM (GPS) MEASUREMENTS PROCESSED BY THE NATIONAL GEODETIC SURVEY DIVISION OF THE NATIONAL OCEANIC AND ATMOSPHERIC ADMINISTRATION USING THE ON-LINE POSITIONING USER SERVICE (OPUS). THE REFERENCE FRAME USED WAS NAD83 (CORRS9) WITH AN EPOCH OF 2002.0000. ALL DISTANCES SHOWN HEREON ARE GROUND VALUES.

BENCHMARK

CITY OF LAS VEGAS VERTICAL CONTROL POINT "6001 345W6", BEING A RIVET & PLATE IN TOP OF CURB ON THE EAST SIDE OF MAIN BETWEEN BONNEVILLE & GARCES @ LIGHT POLE.
ELEVATION: 2027.08 (FEET)
617.8544 (METERS)
CITY OF LAS VEGAS VERTICAL CONTROL DATED 08/2002 BASED UPON THE NORTH AMERICAN VERTICAL DATUM OF 1988 (NAVD 88).

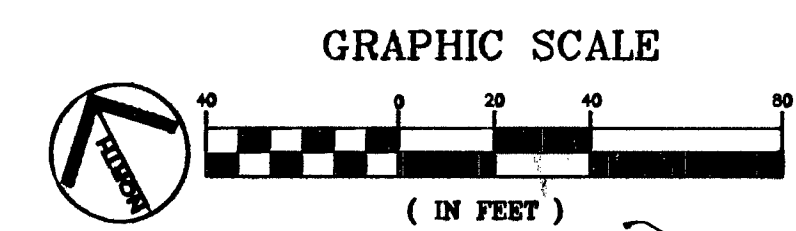

811 SAFETY ALERT
Call Before You Dig
Call Before You Overhead

Underground Utility Marking
1-702-432-5300
www.811nevada.com

REVISIONS	DATE	SHEET REPLACEMENT
	6/16/10	

DATE: FEBRUARY 2010
CHECKED BY: CC/PM
DESIGNED BY: TEA
SCALE (V): N/A
SCALE (H): 1"=40'
DRAWN BY: TEA

Kimley-Horn and Associates, Inc.
Engineering, Planning, and Environmental Consultants
2080 E. Flamingo Road, Suite 210, Las Vegas, NV 89119
FAX (702) 735-4949



PROJECT: **BONNEVILLE/CLARK ONEWAY COUPLET PHASE 1 IMPROVEMENT PLANS**

SHEET: **SIGNING AND MARKING SHEET**

PROFESSIONAL ENGINEER STATE OF NEVADA
PETER N. MEYERHOFER
Exp: 12/31/11
CIVIL
No. 18093
6/17/10

SHEET NO. SM-03
SHEET 56 OF 91
DRAWING NO. 107V5201

BID# 09.1730.37 REV 3