

825 N. LAMB#326

Bona Steffy 8-11-82

DEPT. of BLDG. & SAFETY - CITY of LAS VEGAS, NEVADA

OWNER JOE N BROWN ADDRESS 825 N Lamb #326 DATE 9/23/75
GEN. CONT. Sun City Mobile Homes TYPE OF STRUCTURE Install mobile home
PERMIT NO. 4138 LEGAL DESCRIPTION Por No 825 Sec 29 T20S R62 E

BUILDING	MECHANICAL	ELECTRICAL
Investigation	Plumbing Cont. _____ Date _____	Temp. Cont. _____ Date _____
Location & Footing	Permit No. _____	Inspection _____ Date _____
Steam Wall	Heat & Vent. A/C Cont. _____ Date _____	Electrical Cont. _____ Date _____
Concrete Slab Floor	Permit No. _____	Permit No. _____
Floor Framing	Sewer Cont. _____ Date _____	Fixtures Cont. _____ Date _____
Hearth Footing	Permit No. _____	Permit No. _____
Chimney Steel	Rough Soil _____	Slab _____
Vert. Steel Reinf.	Rough Water _____	Rough _____
Horiz. Steel Reinf.	Top-Out _____	Final Rough _____
Roof Sheathing	Rough Gas _____	Final Fixture _____
Framing	A/C Rough Duct _____	Final Electrical <u>9-27-75</u>
Backing for siding	Ref. Rough Piping _____	Temporary Service _____
Ext. Lath	Final Plumbing <u>9-24-75</u>	MISCELLANEOUS
Ext. Scratch	Final Gas <u>9-24-75</u>	Grading & Drainage _____
Ext. Brown	Final Air Cond. _____	On-Site Parking Spaces _____ App. _____
Int. Lath	Final Refrig. _____	Eng. Approval of _____
Int. Brown	Final Sewer _____	Off-Site Improvements _____
Drywall	Final Septic Tank _____	
Permit No. _____		
Final Building _____		
Appr. for Occu. _____		

INSPECTOR: _____

DATE _____

APPROVED FOR OCCUPANCY & METER

PLEASE NOTE REMARKS ON REVERSE SIDE 825 N Lamb #326

LOG # _____

AREA # _____

Dona Novak 2-25-83

CITY OF LAS VEGAS, NEVADA

6-18-006

LOG NO. & AREA _____ CONST. VAL. \$ _____

DEPARTMENT OF PUBLIC SERVICES
DIVISION OF BUILDING AND SAFETY

APPLICATION # BUILDING PERMIT - for:
Dwellings, Duplexes, Misc. Residential Const.

ADDRESS OF CONSTRUCTION: 825 N. LAMB #326 OWNER: KELEUTIC, JOHN

LOT(s) _____ BLOCK _____ SUBDIVISION _____ ZONE R-MHP

Existing structure on lot: Dwelling Accessory Bldg. Vacant Lot Other

PROPOSED CONSTRUCTION: MOBILE HOME USE: _____

MATERIALS OF CONSTRUCTION: Wood Frame Concrete Block Reinforced Concrete Steel Frame

SQUARE FEET OF FLOOR AREAS: 1st _____ 2nd _____ 3rd _____ Other _____ TOTAL SQ. FT. _____

FIRE ZONE: _____ Occupancy Group _____ CONST. TYPE: _____

ARCHITECT: _____ ENGINEER: _____ NO. of UNITS _____ NO. of STORIES _____

Plans Submitted: Yes No Calculations Submitted: Yes No Sewer Fee Req'd: Yes No

CONTRACTOR: WESTWOOD Homes STATE LICENSE # 1020 CITY LICENSE # T10-14922

ADD'L. PERMITS REQ'D.: Air Cond. Elec. Plumbing Signs Paving Fence Public Walks Curb-gutters
Generators Fire Sprinkling System

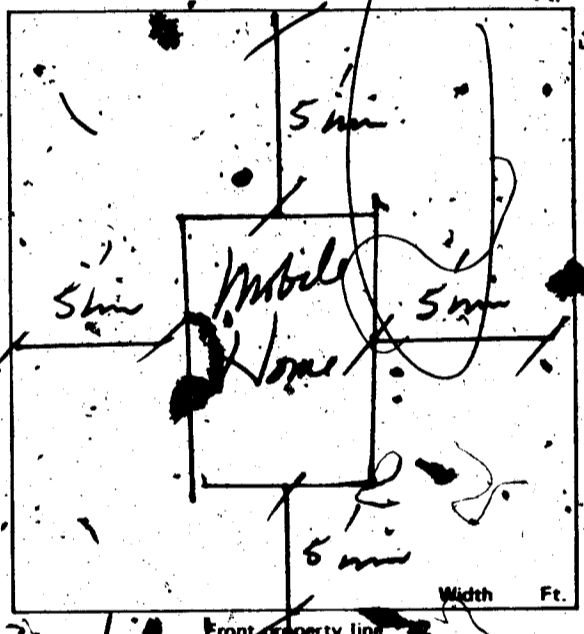

CONDITIONS OF THE PERMIT:

- I agree to call the City Building Department for inspections before concrete is poured, before rough wiring, electrical, plumbing, framing is covered. Also for Air conditioning, drywall and sheathing inspection.
- I agree that when the job is complete I will call for final inspection before occupancy.
- I agree to perform all construction in accordance with City Ordinances and Building Codes.
- The Contractor's signature below denotes authority for the owner to sign in his behalf and that the owner is aware of all requirements of this application and permit. Separate permits must be taken out for work outlined above this agreement.
- I have read and understand the contents of this application and permit. I hereby state that the information provided in this application is true and correct.

SFD \$ 40.00
 STL \$ 40.00
 TOTAL \$ 40.00
 CHECK \$ 40.00
 RA 7582 SR# 001/01
 CITY OF LAS VEGAS
 BLDG. & SAFETY

Approval for the work under this permit will be given only after review and debris have been removed from job site and public right of way. Separate permits are required for work within the public right of way.

SIGNED: Michael L. Miller Contractor
BY: _____ Agent or Owner

PLANNING DEPT. _____ Date: 2/23/83
 PUBLIC WORKS DEPT. _____ Date: _____
 BUILDING DIVISION: _____ Date: _____
 PERMIT NO.: 7582 PERMIT FEE \$ 4000

RECEIPT
 MUST BE MACHINE VALIDATED

2300-2401

Dona Hovaly 3-14-83

OWNER John Keletic		ADDRESS 25 N. Lamb #326	
DATE 2-24-83	GEN. CONT. Westwood Homes		
TYPE OF STRUCTURE M.H.	PERMIT NO. 1582	FINAL INSPECTION	
LEGAL DESCRIPTION See App.	LOG NO.	AREA NO.	
APPROVED FOR OCCUPANCY & METER			
BUILDING		MECHANICAL	
Investigation	Plumbing Cont.		
Location Noting	Permit No.	Date	
Concrete Slab Floor	Floor & Vent. A/C Cont.		
Fireplace Footing	Permit No.	Date	
Chimney Steel	Sewer Cont.		
Vert. Steel Band	Permit No.	Date	
Horiz. Steel Band	Rough Soil		
Framing	Rough Water		
Ext. Lath	Top Out		
Ext. Brown	Rough Gbs		
Drivell	A/C Rough Duct		
Final Building RS 22483	Final Plumbing		
App. for Occu.	Final Gas		
ELECTRICAL		Final Air Cond.	
Temp. Pole Cont.	Final Sewer		
Permit No.	Date	REMARKS	
Inspection	Date		
Electrical Cont.			
Permit No.	Date	PLEASE NOTE ADDITIONAL REMARKS ON REVERSE SIDE	
Rough	DEPT OF BLDG & SAFETY		
Final Rough	CITY OF LAS VEGAS		
Final Electrical	REV. 82-3-29		
Temporary Service			

Dona H. Walsh 3-15-83

Dona

CITY OF LAS VEGAS, NEVADA

6-18-006

LOG NO. & AREA

CONST. VAL. \$ 480.00

DEPARTMENT OF PUBLIC SERVICES
DIVISION OF BUILDING AND SAFETY

APPLICATION & BUILDING PERMIT - for:
Dwelling, Duplexes, Misc. Residential Const./

ADDRESS OF CONSTRUCTION

825 RANCHO VEGAS
N. LAMB #326

OWNER: John Kelenik

LOT(S)

Block: N. NEWBY SUBDIVISION

720 P.M.H.R.

Existing structure on lot: Dwelling Accessory Bldg. Vacant Lot Other

PROPOSED CONSTRUCTION: Club Dwelling

USE: PATIO

MATERIALS OF CONSTRUCTION: Wood Frame Concrete Block Reinforced Concrete Steel Frame

SQUARE FEET OF FLOOR AREAS: 1st 2nd 3rd Other TOTAL SQ. FT. 160

FIRE ZONE: Occupancy Group: CONST. TYPE:

ARCHITECT: ENGINEER: NO. of UNITS: NO. of STORIES: 1

Plans Submitted: Yes No Calculations Submitted: Yes No Sewer Fee Req'd: Yes No

CONTRACTOR: Viking Bldg. STATE LICENSE: 12444 CITY LICENSE: CU-124191

ADD'L. PERMITS REQ'D.: Con. Elec. Plumbing Signs Paving Fence Public Walks Curb/Gutter?
Mechanical Fire Sprinkling System

CONDITIONS OF THE PERMIT

- I agree to call the City Building Department for inspections before concrete is poured, before rough wiring, electrical, plumbing, framing is covered. Also for Airconditioning, drywall and sheathing inspection.
- I agree that when the job is completed that I will call for final inspection before occupancy.
- I agree to perform all construction in accordance with City Ordinances and Building Codes.
- The Contractor's signature below denotes authority from the owner to sign in his behalf and that the owner is aware of all requirements of this application and permit. Separate permits must be taken out for work outlined above this agreement.
- I have read and understand the contents of this application and permit. I hereby state that the information I have supplied on this application is true and correct.

Approval for the work under this permit will be given only after refuse and debris have been removed from job site and public right of way. Separate permits are required for work within the public right of way.

SIGNED: Stephen J. Janning Contractor

BY: [Signature] Agent or Owner

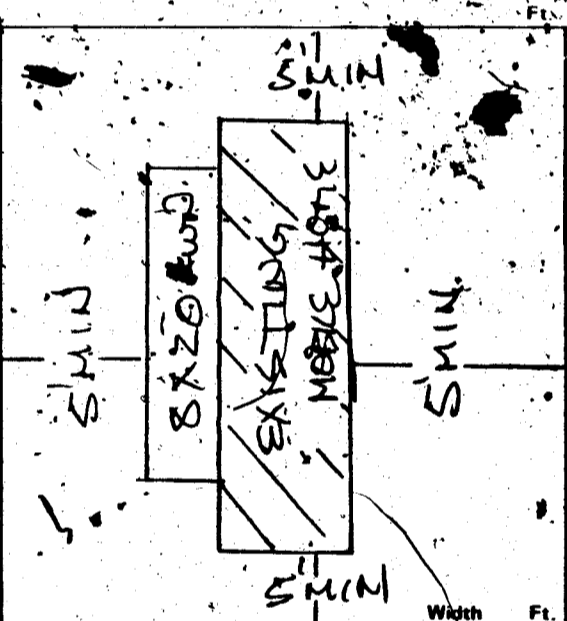

Front property line

PLANNING DEPT: [Signature] Date: 3/11/83

PUBLIC WORKS DEPT: [Signature] Date: 3/11/83

BUILDING DIVISION: [Signature] Date: 3/11/83

PERMIT NO.: 80986 PERMIT FEES 10.00

2300-2401

RECEIPT

MUST BE MACHINE VALIDATED

Don. Hooley 3-29-83

OWNER John Keventic		ADDRESS 825 N. Lamb #326	
DATE 3-11-83	GEN. CONT. Viking Bldrs.		
TYPE OF STRUCTURE Awning	PERMIT NO. 8048-6	FINAL INSPECTION	
LEGAL DESCRIPTION see app	LOG NO.	AREA NO.	
APPROVED FOR OCCUPANCY & METER			
BUILDING		MECHANICAL	
Investigation	Plumbing Cont.		
Location & Footing	Permit No.	Date	
Concrete Slab Floor	Heat & Vent. A/C Cont.		
Fireplace Footing	Permit No.	Date	
Chimney Stack	Sewer Cont.		
Vert. Steel Rainf.	Permit No.	Date	
Horiz. Steel Rainf.	Rough Gas		
Framing	Rough Water		
Ext. Lath	Top-Out		
Ext. Brown	Rough Gas		
Drywall	A/C Rough Inlet		
Final Building RS-25-83	Final Plumbing		
Appr. for Occu.	Final Gas		
ELECTRICAL		Final Air Cond.	
Temp. Pole Cont.	Final Sewer		
Permit No.	Date	REMARKS	
Inspection	Date		
Electrical Cont.			
Permit No.	Date		
Rough	PLEASE NOTE ADDITIONAL REMARKS ON REVERSE SIDE.		
Final Rough	DEPT. OF BLDG. & SAFETY		
Final Electrical	CITY OF LAS VEGAS		
Temporary Service	REV: 82-3-29		