

4408 HANFORD AVE.

L27 B1 Char Est 6-A Zone R-1

Gloria Gatewood 7-3-79

CITY OF LAS VEGAS, NEVADA

1967
CONST. VAL. 120

LOG NO. & AREA

DEPARTMENT OF BUILDING & SAFETY

APPLICATION & BUILDING PERMIT for:
Fence, Wall, Retaining Wall.

ADDRESS OF CONSTRUCTION:

4408 Hanford

OWNER:

Maxwell

LOT(s)

27

BLOCK

1

SUBDIVISION

Ocean Estates Co. A

6-A

ZONE: R-1

Materials of Construction:

Block

Concrete

Wire

Wood

Other

Yes No

PLANS:

CALCS:

ARCHITECT:

ENGINEER:

CONTRACTOR:

Fencing Co.

STATE LICENSE #

10019

CITY LICENSE

700-2

TOTAL SQUARE FEET:

TOTAL LINEAL FEET: 120

Remarks:

Empty table for remarks.

CONDITIONS OF THE PERMIT:

- Any type of retaining wall must be engineered by a Civil or Structural Engineer.
- If a home owner takes out the Building Permit and if the owner sublets the work to a Contractor, then the Contractor must take out the permit and pay for it.
- No fence or wall can be built on City property or rights-of-way, but this is not intended to preclude construction within utility easements if utilities will not be damaged or made inaccessible.
- The fence or wall shall not enclose any water meter, light standard, or fire alarm box and shall not come closer than 24" from the nearest fire hydrant outlet.
- Department Inspectors must approve footings before concrete is poured and block wall reinforcing before grouting is done.
- Maximum height of any wall or fence is 6' side and rear yards; 4' maximum in front yard with the vertical surface above the height of 2' - 50% open and further that fencing within 6' of the intersection of curb faces on corner and through lots is limited to a maximum height of 30".
- I must not obstruct required onsite parking space (1 space for each dwelling unit) by the erection of this fence or wall.
- By the signing of this application I herewith agree to the requirements outlined above.

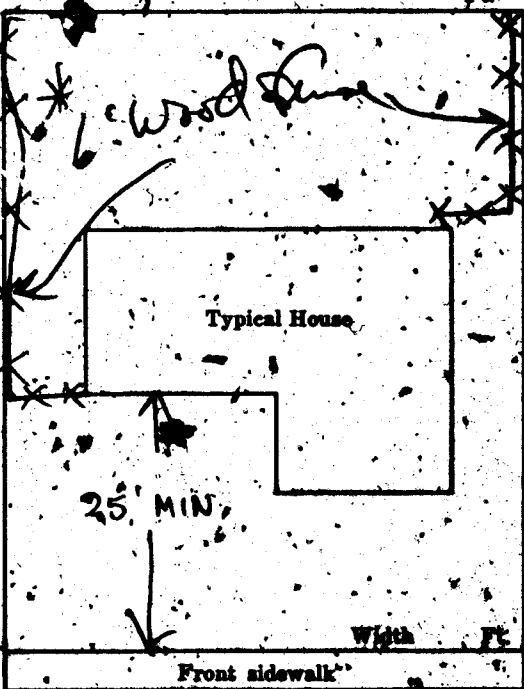

SIGNED:

[Signature]

DATE

6-29-67

CONTRACTOR AGENT OWNER

PLANNING DEPT:

[Signature]

Date:

6-29-67

ENGINEERING DEPT:

Date:

BUILDING DEPT:

[Signature]

Date:

6-29-67

#1285

PERMIT NO: 35035

PERMIT FEE: \$200

RECEIPT
5649 \$004.00 - 8
CITY OF LAS VEGAS
DEPT. OF BUILDING & SAFETY
MUST BE MACHINE VALIDATED
30 JUN 67

L. Collins 3-26-82

DEPT. of BLDG & SAFETY - CITY of LAS VEGAS, NEVADA
OWNER: Sproul Homes, Inc. ADDRESS: 4408 Hanford Avenue DATE: 31 July 1964
GEN/CONT: Same TYPE OF STRUCTURE: S.F.D.
PERMIT NO: 66 LEGAL DESCRIPTION: Lot 27 Block 1 Chas. Estates 6-A

BUILDING	MECHANICAL	ELECTRICAL
LOCATION: <u>4408 Hanford</u>	PLUMBING CONT. <u>16531</u> DATE: <u>8-7-64</u>	TEMP. POLE CONT. _____ DATE _____
FIREPLACE FTB. _____	PERMIT NO. <u>16531</u> DATE: <u>8-7-64</u>	INSPECTION _____ DATE _____
FOOTINGS: <u>UH 8-4-64 - DB 8-21-64</u>	HEAT & VENT. AC CONT. <u>repaired</u>	ELECTRICAL CONT. <u>repaired</u>
FOUNDATION WALL: <u>8-6-64</u>	PERMIT NO. <u>16531</u> DATE: <u>8-7-64</u>	PERMIT NO. <u>18145</u> DATE: <u>8-27-64</u>
FLOOR FRAMING _____	SEWER CONT. <u>16531</u> DATE: <u>8-7-64</u>	FIXTURES CONT. <u>repaired</u>
SLAB: <u>8-7-64</u>	PERMIT NO. <u>16531</u> DATE: <u>8-7-64</u>	PERMIT NO. <u>18145</u> DATE: <u>8-27-64</u>
CHIMNEY STEEL (FIREPLACE) _____	ROUGH SOL. <u>8-6-64</u>	SLAB _____
WALL STEEL _____	ROUGH WATER <u>8-6-64</u>	ROUGH _____
COLUMN STEEL _____	TOP-OUT <u>8-27-64</u>	FINAL ROUGH _____
BEAM STEEL _____	ROUGH GAS _____	FINAL FIXTURE _____
FRAMING _____	AC ROUGH DUCT <u>8-26-64</u>	TEMPORARY SERVICE _____
ROOF SHEATHING _____	REF. ROUGH PIPING _____	MISCELLANEOUS _____
DRYWALL _____	FINAL PLUMBING <u>8-10-64</u>	GRADING & DRAINAGE _____
LATHING _____	FINAL GAS _____	ON-SITE PARKING SPACES _____ APP. _____
BACKING (SIGNS) _____	FINAL AIR COND. <u>10-3-64</u>	ENG. APPROVAL OF _____
PLASTER SCRATCH _____	FINAL REFRIG. _____	OFF-SITE IMPROVEMENTS _____
PLASTER BROWN _____	FINAL SEWER <u>8-27-64</u>	
URBAN REDEVELOPMENT, APPROVAL _____	FINAL SEPTIC TANK _____	
FINAL BLDG _____ DATE _____		

APPROVED FOR OCCUPANCY & METER: [Signature] DATE: 10-25-64
PLEASE NOTE REMARKS ON REVERSE SIDE. LOG: T-23 AREA # 23.04
4408 Hanford Avenue

DEPARTMENT OF BUILDING & SAFETY
CITY OF LAS VEGAS, NEVADA

KARDEX CARD
FENCE & RETAINING WALLS
DATE: 6/29/67
PERMIT NO. 38038

OWNER: Maxwell
CONTRACTOR: Fencing Inc.
LOT 27 BLOCK 1 Charleston Estates 6-A
Fence (wire, wood, etc.) Walls (masonry, rock, etc.)

Location _____
Final Inspection _____

Retaining Wall (masonry)
Location _____
Footing _____
Wall Steel 1st _____ 2d _____ 3d _____
Bond Beam 1st _____ 2d _____ 3d _____
Final Inspection _____

Retaining Wall (concrete)
Location _____
Footing _____
Wall Steel 1st _____ 2d _____ 3d _____
Final Inspection _____

23.14 B AREA