

1601 N. "H" STREET

*Marion Perera June 21, 1966*

CITY OF LAS VEGAS, NEVADA  
DEPARTMENT OF BUILDING AND SAFETY  
APPLICATION FOR FENCE, WALL OR  
RETAINING WALL

LOG NO. \_\_\_\_\_  
AREA: \_\_\_\_\_  
KARDEX CARD: \_\_\_\_\_  
TELEPHONE: \_\_\_\_\_

CONSTRUCTION VALUATION: 2130<sup>00</sup>  
INSPECTION VALUATION: 1704<sup>00</sup>  
PERMIT FEE: 12<sup>00</sup>  
PERMIT NUMBER: 32810  
DATE: 3-4 1966

ADDRESS OF CONSTRUCTION: 1601 N. 11<sup>th</sup> OWNER'S NAME: H.P. Corp OWNER'S ADDRESS: \_\_\_\_\_

Lot (s) \_\_\_\_\_ Block \_\_\_\_\_ Subdivision: PT S.W. 1/4, S.W. 1/4, S.W. 1/4, S.W. 1/4, S.W. 1/4, S.W. 1/4, S.W. 1/4, S.W. 1/4 Zone: C-1

Materials of Construction: Block  Concrete  Wire  Wood  Other

Total Square Feet: \_\_\_\_\_ Total Lineal Feet: 1852

CONTRACTOR'S NAME: Fenoglio + McJannet STATE LICENSE # 6626-B CITY LICENSE # 1029

Architect's Name: \_\_\_\_\_ PLANS SUBMITTED: Yes  No   
Engineer's Name: \_\_\_\_\_ CALCULATIONS: Yes  No

Street Name: "H" St  
Front Yard: \_\_\_\_\_ Feet

I understand that any portion of this (fence) (wall) constructed or erected on City property or right-of-way will be removed from said location at my expense upon request received from the City of Las Vegas, Nevada. I understand that the (fence) (wall) shall not enclose water meter, light standard, fire alarm box and shall not come closer than two (2') feet in any direction from any fire hydrant. I further state that I am familiar with effective Ordinances of the City of Las Vegas, Nev. and effective Statutes of the State of Nevada covering construction and use of above type; I agree to perform said construction in conformity therewith. I further agree that issuance of a permit on above application will not excuse me from conforming with said Ordinances and Statutes, despite any errors on the part of the Building Inspector or Engineer in checking plans and applications herewith submitted.

I have read and understand the contents of above application; I hereby state that same are true and correct.

SIGN HERE: [Signature]  
By: \_\_\_\_\_

APPROVED BY: [Signature]  
PLANNING DEPT. & CODE ASSISTANCE DATE: \_\_\_\_\_  
FIRE DEPARTMENT DATE: \_\_\_\_\_  
BUILDING & SAFETY DEPT. DATE: 3/4/66

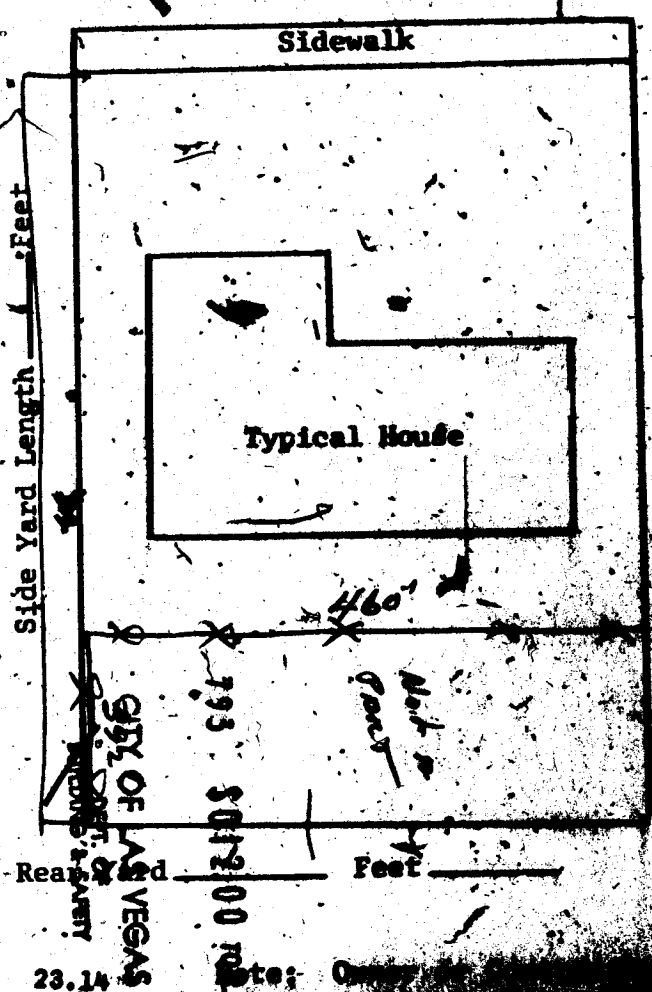

Side Yard Length - Feet

Side Yard Length - Feet

Rear Yard - Feet

City of Las Vegas

All inspections required.

Marion Perera June 2, 1977

1968

CITY OF LAS VEGAS, NEVADA  
DEPARTMENT OF BUILDING & SAFETY

PERMIT FEE \$ \_\_\_\_\_  
SIGNS - APPLICATION & PERMIT  
INSPECTION VALUATION: 900.00

ADDRESS OF CONSTRUCTION: 40 WEN'S NW CORNER  
1601 H ST.

SIGN OWNER: ECONO

SIGN CONTRACTOR: Dullman

STATE LICENSE # 6631

CITY LICENSE # 6782

PROPERTY OWNER'S NAME: \_\_\_\_\_

LOG NO. & AREA

PLANNING ZONE: C-1

BILLBOARD TYPE (NON-ELECTRIFIED)

Single face (If on roof, marquee or projecting - 2 times fee listed below)	
25 sq. ft. to 50 sq. ft.	\$4.00
51 sq. ft. to 300 sq. ft.	5.00
Over 300 sq. ft.	7.50

Double faced or V-type (If on roof, marquee or projecting 2 times fee below)	
25 sq. ft. to 50 sq. ft.	\$6.00
51 sq. ft. to 300 sq. ft.	7.50
Over 300 sq. ft.	11.25

Plan check fee (If required), \$20.00

Electric permit required Yes No

SUB-SECTION "D" TYPE (ELECTRIFIED)

Material of Signs:  
Metal ( ) Wood ( ) Plastic ( ) Other ( )

Type of Job:  
New Sign Replacement Relocate

Real width Ft.

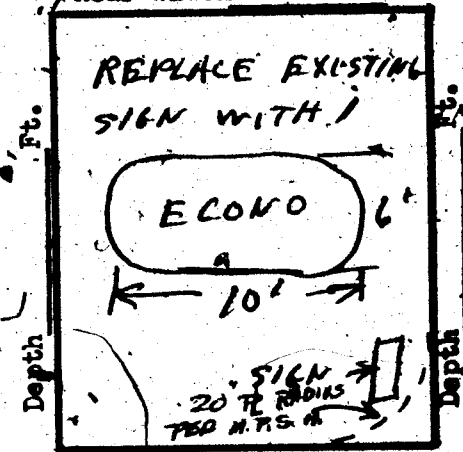

Front width Ft.

STREET OWENS

Wall or Marquee or single face  
sq. ft. of display surface \$12.00

Projecting or roof or double face  
60 sq. ft. of display surface \$15.00

Signs 25 sq. ft. & under min. fee \$4.00

Signs Moving per each sign \$5.00

Minimum permit fee \$4.00

TOTAL PERMIT FEE

200

I hereby certify that I have carefully examined and read the above application; that the same is true & correct & that the work herein described is to be done in accordance with all the provisions of the applicable Ordinances of the City of Las Vegas and State laws whether specified or not.

Signed: William Dullman Date: 10-7-68  
Master Neon/Elec. Billboard Contractor

APPROVED BY:

PLANNING DEPARTMENT: JAM

DATE 10-7-68

ENGINEERING DEPARTMENT: DM

DATE 10-7-68

BUILDING DEPARTMENT: H.T. Elleg

DATE: \_\_\_\_\_

# 12880

PERMIT NO. 44566

PERMIT FEE: 8.00

RECEIPT  
5968 \$008.00 - 5

CITY OF LAS VEGAS  
DEPT. OF  
BUILDING & SAFETY

Must be machine validated  
- 7 OCT 68

Sharon Rivera June 21, 1977

8-16

1207

# CITY OF LAS VEGAS, NEVADA

LOG NO. & AREA

DEPARTMENT OF PUBLIC SERVICES  
DIVISION OF BUILDING AND SAFETY

APPLICATION & BUILDING PERMIT - for:  
Commercial or Public Structures.

ADDRESS OF CONSTRUCTION: 1601 North H Street (Econo Station) OWNER: Jack Cason

LOT(s) Porter BLOCK 51/2 SB 48221 T 20 SA 611 ZONE: C1

Existing structure on lot: Dwelling  Accessory Bldgs.  Vacant Lot  Commercial Bldg.  Other

PROPOSED CONSTRUCTION: Demolition

USE: \_\_\_\_\_

MATERIALS OF CONSTRUCTION: Wood Frame  Concrete Block  Reinforced Concrete  Steel Frame

SQUARE FEET OF FLOOR AREAS: 1st \_\_\_\_\_ 2nd \_\_\_\_\_ Other \_\_\_\_\_ TOTAL SQ. FT. \_\_\_\_\_

FIRE ZONE: \_\_\_\_\_ Occupancy Group \_\_\_\_\_

CONST. TYPE: \_\_\_\_\_

ARCHITECT: \_\_\_\_\_ ENGINEER: \_\_\_\_\_ NO. of UNITS \_\_\_\_\_ NO. of STORIES \_\_\_\_\_

Plans Submitted: Yes  No  Calculations Submitted: Yes  No  Sewer Fee Req'd: Yes  No

CONTRACTOR: Art Goldstrom Enterprises STATE LICENSE # 10795 CITY LICENSE # 07814

ADD'L. PERMITS REQ'D: Air Cond.  Elec.  Plumbing  Signs  Paving  Fence  Public Walks  Curb-gutters   
Incinerators  Fire Sprinkling System

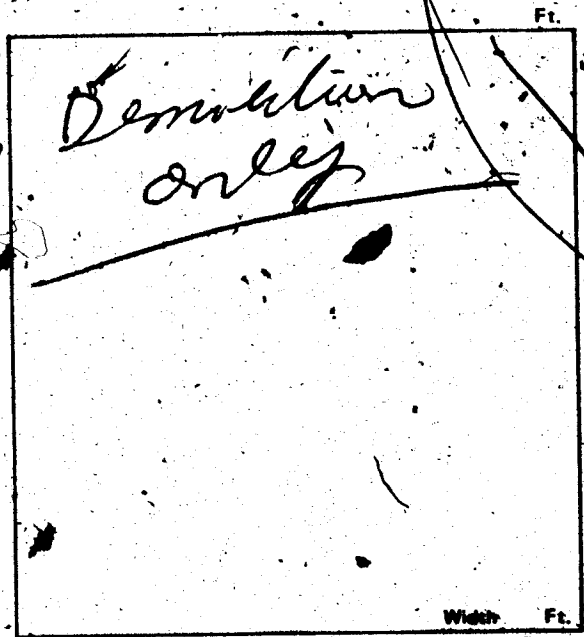

### CONDITIONS OF THE PERMIT:

- I agree to call the City Building Department for inspections before concrete is poured, before rough wiring, electrical, plumbing, framing is covered. Also for Air conditioning, drywall and sheathing inspection.
- I agree that when the job is completed that I will call for final inspection before occupancy.
- I agree to perform all construction in accordance with City Ordinances and Building Codes.
- The Contractor's signature below denotes authority from the owner to sign in his behalf and that the owner is aware of all requirements of this application and permit. Separate permits must be taken out for work outlined above this agreement.
- I have read and understand the contents of this application and permit; I hereby state that the information I have supplied on this application is true and correct.

Approval for the work under this permit will be given only after refuse and debris have been removed from job site and public right of way.

SIGNED: Art Goldstrom Enterprises Contractor

COMP \$ 20.00

BY: Sharon Rivera Agent or Owner

TOTL \$ 20.00

CHEK \$ Date 20.00

Clark County Health Department

3411 SR#001/01

Las Vegas Fire Department

CITY - LAS VEGAS

BLDG. & SAFETY

04/25/RECEIPT

PLANNING DEPT: \_\_\_\_\_ Date: 4-25-78

PUBLIC WORKS DEPT: \_\_\_\_\_ Date: 11

BUILDING DIVISION: \_\_\_\_\_ Date: 4-25-78

76-10-13 PERMIT NO.: 3411 PERMIT FEE \$ 20.00  
154-01-220

MUST BE MACHINE VALIDATED

L Collins 3-26-62

DEPARTMENT OF BUILDING & SAFETY  
CITY OF LAS VEGAS, NEVADA

KARDEX CARD  
SIGN

OWNER ECORD ADDRESS 1601 "H" STREET DATE: 10/7/68

CONTRACTOR Galbraith PERMIT NO. 44566

LOT \_\_\_\_\_ BLOCK \_\_\_\_\_ SUBDIVISION \_\_\_\_\_

LOCATION _____	ELECT. ROUGH _____
SHOP (WIRING, CONST.) _____	ELECT. FINAL _____
SITE (BLDG., ETC.) _____	
INST. (SERV. STRUCT.) _____	
BILLBOARD _____	
ELECTRIFIED _____	
FINAL <u>10-14-68</u>	

23.07 D ADDRESS 1601 "H" Street LOG NO. \_\_\_\_\_ AREA \_\_\_\_\_

OWNER PHILLIPS 66 DEPT. of BLDG. & SAFETY - CITY of LAS VEGAS, NEVADA DATE Sept. 29, 1961  
GEN. CONT. Best Sign Co. ADDRESS 1601 H Street TYPE OF STRUCTURE 4 SIGNS  
PERMIT NO. 373 LEGAL DESCRIPTION \_\_\_\_\_

LOCATION _____	FIREPLACE FTS. _____	PLUMBING CONT. _____	TEMP. POLE CONT. _____
FOUNDINGS _____	PILES _____	PERMIT NO. _____	PERMIT NO. _____
FOUND _____	PIERS _____	HEAT & VENT. CONT. _____	INSPECTION _____
FLOOR _____	SLAB _____	PERMIT NO. _____	ELECTRICAL CONT. _____
ANCHOR BOLTS _____	BASE PLATES _____	SEWER CONT. _____	PERMIT NO. _____
WALL STEEL _____		PERMIT NO. _____	DATE _____
COLUMN STEEL _____		ROUGH SOIL _____	OUTLETS _____
BEAM STEEL _____		ROUGH WATER _____	MOTORS _____ H.P. _____
FRAMING _____		TOP-OUT _____	SLAB _____
ROOF SHEATHING _____		ROUGH GAS _____	ROUGH _____
STEEL FABRICATION _____		A.G. ROUGH DUCT _____	FINAL ROUGH _____
STEEL CONNECTION _____		REF. ROUGH PIPING _____	FIXTURES CONT. _____
	INTERIOR _____		PERMIT NO. _____
LATHING _____	EXTERIOR _____	SEWER _____	DATE _____
BACKING _____		SEPIC TANK _____	FIXTURES _____
PLASTER SCRATCH _____			FINAL FIXTURE _____
PLASTER BROWN _____			
FINAL BLDG. _____	DATE _____		
GRADING & DRAINAGE _____		FINAL PLUMBING _____	URBAN REDEVELOPMENT APPROVAL
ON-SITE PARKING _____	SPACES _____	FINAL GAS _____	<input type="checkbox"/>
		FINAL HEATING _____	
ENG. APPROVAL OF _____		FINAL AIR COND. _____	
OFF-SITE IMPROVEMENTS _____		FINAL REFRIG. _____	

INSPECTOR \_\_\_\_\_ DATE Sept 13, 1961  
APPROVED FOR OCCUPANCY \_\_\_\_\_  
APPROVED FOR METER \_\_\_\_\_  
PLEASE NOTE REMARKS ON REVERSE SIDE 1601 H Street 4 signs LOG# \_\_\_\_\_ AREA# \_\_\_\_\_ 23.04

*L. Collins 3-26-82*

**DEPT. OF BLDG & SAFETY—CITY OF LAS VEGAS, NEVADA**

OWNER Corbin ADDRESS 1601 "H" Street DATE 9/2/64  
 GEN. CONT. Gulbransen Neon TYPE OF STRUCTURE Sign  
 PERMIT NO. 1643 LEGAL DESCRIPTION \_\_\_\_\_

BUILDING	MECHANICAL	ELECTRICAL
LOCATION _____	PLUMBING CONT. _____	TEMP. POLE CONT. _____
FIREPLACE FTS. _____	PERMIT NO. _____ DATE _____	PERMIT NO. _____ DATE _____
FOOTINGS _____	HEAT & VENT. AC CONT. _____	INSPECTION _____ DATE _____
FOUNDATION WALL _____	PERMIT NO. _____ DATE _____	ELECTRICAL CONT. _____
FLOOR FRAMING _____	SEWER CONT. _____	PERMIT NO. _____ DATE _____
SLAB _____	PERMIT NO. _____ DATE _____	FIXTURES CONT. _____
CHIMNEY STEEL (FIREPLACE) _____	ROUGH SOIL _____	PERMIT NO. _____ DATE _____
WALL STEEL _____	ROUGH WATER _____	SLAB _____
COLUMN STEEL _____	TOP-OUT _____	ROUGH _____
BEAM STEEL _____	ROUGH GAS _____	FINAL ROUGH _____
FRAMING _____	AC ROUGH DUCT _____	FINAL FIXTURE _____
ROOF SHEATHING _____	REF. ROUGH PIPING _____	FINAL ELECTRICAL _____
INTERIOR _____	FINAL PLUMBING _____	TEMPORARY SERVICE _____
EXTERIOR _____	FINAL GAS _____	MISCELLANEOUS
DRYWALL _____	FINAL AIR COND. _____	GRADING & DRAINAGE _____
LATHING _____	FINAL REFRIG. _____	ON-SITE PARKING SPACES _____ APP. _____
BACKING (SIDS) _____	FINAL SEWER _____	ENG. APPROVAL OF _____
PLASTER SCRATCH _____	FINAL SEPTIC TANK _____	OFF-SITE IMPROVEMENTS _____
PLASTER BROWN _____		
URBAN REDEVELOPMENT APPROVAL _____		
FINAL BLDG _____ DATE _____		

APPROVED FOR OCCUPANCY & METER *[Signature]* DATE 9-2-64  
 PLEASE NOTE REMARKS ON REVERSE SIDE LOG # \_\_\_\_\_ AREA # 23.04  
 1601 "H" St. M 791

DEPARTMENT OF BUILDING & SAFETY  
 CITY OF LAS VEGAS, NEVADA

KARDEX CARD  
 FENCE & RETAINING  
 WALLS

OWNER H & P Corp ADDRESS 1601 North H DATE \_\_\_\_\_  
 CONTRACTOR Franklin & McInnis PERMIT NO. 32810  
 SWG. SWP. SEC. 22-20-103  
 LOT Por BLOCK \_\_\_\_\_

Fence (wire, wood, etc.)	Walls (masonry, rock, etc.)
Location _____	Location <u>213 2-2-66</u>
Final Inspection _____	Footing <u>213 3-2-66</u>
	Wall Steel 1st <u>213 3-14-66</u>
	Final Inspection <u>213 3-14-66</u>
Retaining Wall (masonry)	Retaining Wall (concrete)
Location _____	Location _____
Footing _____	Footing _____
Wall Steel 1st _____ 2d _____ 3d _____	Wall Steel 1st _____ 2d _____ 3d _____
Bond Beam 1st _____ 2d _____ 3d _____	Final Inspection _____
Final Inspection _____	

23.14 B ADDRESS 1601 North H AREA \_\_\_\_\_

L. Collins 3-26-82

DEPT. of BLDG. & SAFETY - CITY of LAS VEGAS, NEVADA  
 OWNER, JACK GASON ADDRESS 1601 W 1st St. DATE Aug. 3, 1961  
 GEN. CONT. N.J. Helgeson Const. TYPE OF STRUCTURE gas station  
 PERMIT NO. 5488 LEGAL DESCRIPTION \_\_\_\_\_

LOCATION _____ FIREPLACE FTS. _____ FOOTINGS <u>Found 8-24-61</u> PILES _____ FOUND _____ PIERS _____ FLOOR _____ SLAB <u>8-11-61</u> ANCHOR BOLTS _____ BASE PLATES _____ WALL STEEL _____ COLUMN STEEL _____ BEAM STEEL <u>Burlingame 8-21-61 3-27-61</u> FRAMING <u>Burlingame 8-22-61</u> ROOF SHEATHING <u>Burlingame 8-28-61</u> STEEL FABRICATION <u>Burlingame 8-17-61</u> STEEL CONNECTION _____	PLUMBING CONT. <u>Dehert</u> PERMIT NO. <u>3383</u> DATE <u>8-18-61</u> HEAT & VENT. CONT. _____ PERMIT NO. _____ DATE _____ SEWER CONT. <u>Dehert</u> PERMIT NO. <u>3383</u> DATE <u>8-18-61</u> ROUGH SOIL _____ ROUGH WATER _____ TOP-OUT _____ ROUGH GAS _____ AC ROUGH DUCT _____ REF. ROUGH PIPING _____ SEWER <u>London 8-24-61</u> SEPIC TANK _____ FINAL PLUMBING <u>Dehert 9-22-61</u> FINAL GAS _____ FINAL HEATING _____ FINAL AIR COND. _____ FINAL REFRIG. _____	TEMP. POLE CONT. _____ PERMIT NO. _____ DATE _____ INSPECTION _____ DATE _____ ELECTRICAL CONT. <u>Black G</u> PERMIT NO. <u>3390</u> DATE <u>8-11-61</u> OUTLETS <u>25</u> MOTORS _____ H.P. _____ SLAB <u>Found 8-11-61</u> ROUGH _____ FINAL ROUGH _____ FIXTURES CONT. <u>Black G</u> PERMIT NO. <u>3393</u> DATE <u>8-14-61</u> FIXTURES <u>20</u> FINAL FIXTURE <u>Found 8-26-61</u> URBAN REDEVELOPMENT APPROVAL _____
--	--	---

ENG. APPROVAL OF \_\_\_\_\_  
 OFF-SITE IMPROVEMENTS \_\_\_\_\_

APPROVED FOR OCCUPANCY Burlingame 9-25-61 INSPECTOR \_\_\_\_\_ DATE \_\_\_\_\_  
 APPROVED FOR METER West 9-26-61 OFF site improvements included  
 PLEASE NOTE REMARKS ON REVERSE SIDE 1601 W 1st St. LOG# 283 AREA: # 3 23.04

DEPT. of BLDG. & SAFETY - CITY of LAS VEGAS, NEVADA  
 OWNER, Chief Gasoline ADDRESS 1601 E. H Owens & H Street DATE Sept. 18, 1961  
 GEN. CONT. Young Elec. Sign Co. TYPE OF STRUCTURE SIGN  
 PERMIT NO. 367 LEGAL DESCRIPTION \_\_\_\_\_

LOCATION _____ FIREPLACE FTS. _____ FOOTINGS _____ PILES _____ FOUND _____ PIERS _____ FLOOR _____ SLAB _____ ANCHOR BOLTS _____ BASE PLATES _____ WALL STEEL _____ COLUMN STEEL _____ BEAM STEEL _____ FRAMING _____ ROOF SHEATHING _____ STEEL FABRICATION _____ STEEL CONNECTION _____	PLUMBING CONT. _____ PERMIT NO. _____ DATE _____ HEAT & VENT. CONT. _____ PERMIT NO. _____ DATE _____ SEWER CONT. _____ PERMIT NO. _____ DATE _____ ROUGH SOIL _____ ROUGH WATER _____ TOP-OUT _____ ROUGH GAS _____ AC ROUGH DUCT _____ REF. ROUGH PIPING _____ SEWER _____ SEPIC TANK _____ FINAL PLUMBING _____ FINAL GAS _____ FINAL HEATING _____ FINAL AIR COND. _____ FINAL REFRIG. _____	TEMP. POLE CONT. _____ PERMIT NO. _____ DATE _____ INSPECTION _____ DATE _____ ELECTRICAL CONT. _____ PERMIT NO. _____ DATE _____ OUTLETS _____ MOTORS _____ H.P. _____ SLAB _____ ROUGH _____ FINAL ROUGH _____ FIXTURES CONT. _____ PERMIT NO. _____ DATE _____ FIXTURES _____ FINAL FIXTURE _____ URBAN REDEVELOPMENT APPROVAL _____
--	--	---

ENG. APPROVAL OF \_\_\_\_\_  
 OFF-SITE IMPROVEMENTS \_\_\_\_\_

APPROVED FOR OCCUPANCY J. E. Dwyer INSPECTOR \_\_\_\_\_ DATE 9-26-61  
 APPROVED FOR METER Owens & H 1601 H  
 PLEASE NOTE REMARKS ON REVERSE SIDE Owens & H 1601 H LOG# 394 AREA: # 2 23.04

1  
 B-26-82

OWNER <i>Jack Olson</i>		ADDRESS <i>1601 No. "H" St.</i>	
DATE <i>4-26-79</i>		GEN. CONT. <i>Art Goldstrom Ent</i>	
TYPE OF STRUCTURE <i>Demolition</i>		PERMIT NO. <i>3411</i>	FINAL INSPECTION
LEGAL DESCRIPTION <i>Portion S4, SE4, Sec 21, T20S, R61E</i>			
APPROVED FOR OCCUPANCY & METER			
BUILDING		MECHANICAL	
Investigation		Plumbing Cont.	
Location & Footing		Permit No.	Date
Concrete Slab Floor		Heat & Vent. A/C Cont.	
Vert. Steel Reinf.		Permit No.	Date
Horiz. Steel Reinf.		Sewer Cont.	
Framing		Permit No.	Date
Ext. Lath		Rough Soil	
Ext. Brown		Rough Water	
Final Building <i>EC 6-27-79</i>		Top-Out	
Appr. for Occu.		Rough Gas	
		A/C Rough Duct	
		Final Plumbing	
		Final Gas	
ELECTRICAL		Final Air Cond.	
Temp. pole cont.		Final Sewer	
Permit No.	Date		
Inspection	Date		
Electrical Cont.	Date		
Permit No.	Date	PLEASE NOTE REMARKS ON REVERSE SIDE	
Rough		DIV OF BLDG & SAFETY CITY OF LAS VEGAS REV 10-78	
Final Rough			
Final Electrical		2-1-32	
Temporary Service		E-Z-WAY SYSTEMS NEWARK OH 43075 LITHO IN U.S.A.	