

· 1932 Gerlach ·

· L39& 52 · B6 Sierra Nev No 2 Zone R-4 ·

U Jones 6-4-73

CITY OF LAS VEGAS, NEVADA

LOG NO. & AREA

CONST. VAL. \$

4,800.00

DEPARTMENT OF BUILDING & SAFETY

APPLICATION & BUILDING PERMIT — for:

Fence, Wall, Retaining Wall.

ADDRESS OF CONSTRUCTION:

1932 GERLICH DRIVE

OWNER:

SIERRA NEVADA ARMS

LOT(S)

39-52

BLOCK

C

SUBDIVISION

Sierra Nevada No 2

ZONE:

R-4

Materials of Construction:

Block

Concrete

Wife

Wood

Other

Yes

No

PLANS:

ARCHITECT:

ENGINEER:

CALCS:

CONTRACTOR:

SUN HOME BUILDERS, INC.

STATE LICENSE #

CITY LICENSE #

TOTAL SQUARE FEET: 4800

TOTAL LINEAL FEET: 1063

Remarks:

CONDITIONS OF THE PERMIT:

- Any type of retaining wall must be engineered by a Civil or Structural Engineer.
- If a home owner takes out the Building Permit and if the owner surrenders the work to a Contractor, then the Contractor must take out the permit and pay for it.
- No fence or wall can be built on City property or rights-of-way, but this is not intended to preclude construction within utility easements if utilities will not be damaged or made inaccessible.
- The fence or wall shall not enclose any water meter, light standard, or fire alarm box and shall not come closer than 24" from the nearest fire hydrant outlet.
- Department Inspectors must approve footings before concrete is poured and block wall reinforcing before routing is done.
- Maximum height of any wall or fence is 6', side and rear yards; 4' maximum in front yard with the vertical surface above the height of 2' — 50% open.
- I must not obstruct required onsite parking space (2 spaces for each dwelling unit) by the erection of this fence or wall.
- By the signing of this application I herewith agree to the requirements outlined above.

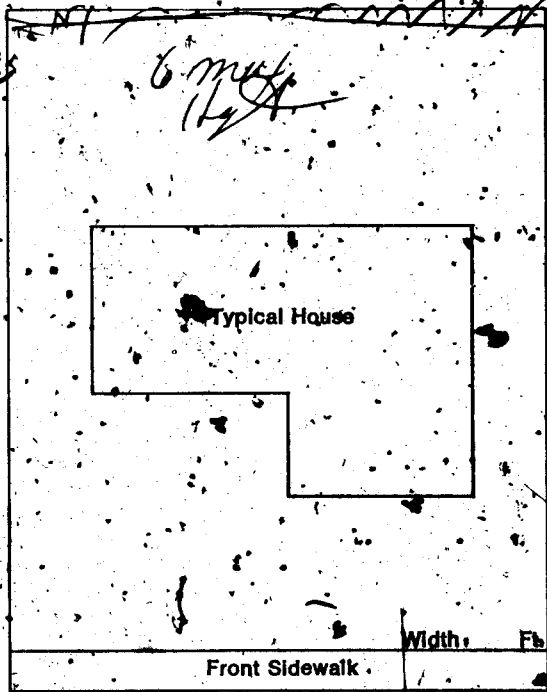

SIGNED:

SUN HOME BUILDERS, INC.

DATE: 5/3/73

CONTRACTOR

AGENT

OWNER

PLANNING DEPT:

MA

Date:

5-9-73

PUBLIC WORKS DEPT:

DP

Date:

5-4-73

BUILDING DEPT:

Date:

5-4-73

#12850

PERMIT NO:

11090

PERMIT FEE:

33.00

RECEIPT

5798 \$033.00 - 8

CITY OF LAS VEGAS  
DEPT. OF BUILDING & SAFETY  
MUST BE MACHINE VALIDATED

4 MAY 73

U. Jones 6479

LOG NO. & AREA C-72-3

CITY OF LAS VEGAS, NEVADA

CONST. VAL. \$ 49,500<sup>00</sup>

DEPARTMENT OF BUILDING & SAFETY

APPLICATION & BUILDING PERMIT - for:  
Commercial or Public Structures.

ADDRESS OF CONSTRUCTION: 193 Gerlach Drive

OWNER: Sierra Nevada Arms

LOT(s) See Attached

BLOCK

SUBDIVISION

Sierra Nevada Unit # 2

ZONE: Rt

Existing structure on lot: Dwelling  Accessory Bldg.  Vacant Lot  Commercial Bldg.  Other

PROPOSED CONSTRUCTION: Apt. Bldg. # 67 Factory Built USE: Res.

MATERIALS OF CONSTRUCTION: Wood Frame  Concrete Block  Reinforced Concrete  Steel Frame

SQUARE FEET OF FLOOR AREAS: 1st  2nd  3rd  Other  TOTAL SQ. FT. \_\_\_\_\_

FIRE ZONE: 1  2  3  Occupancy Group: A B C D E F G  H I J-1-2-3-4-5 CONST. TYPE: I II III IV  V

ARCHITECT: B. Greene ENGINEER: B.H.T. Engrs. NO. of UNITS 4 NO. of STORIES 2

Plans Submitted: Yes  No  Calculations Submitted: Yes  No  Sewer Fee Req'd.: Yes  No

CONTRACTOR: Sun Home Builders, Inc. STATE LICENSE # 6660 CITY LICENSE # 06059

ADD'L. PERMITS REQ'D.: Air Cond.  Elec.  Plumbing  Signs  Paving  Fence  Public Walks  Curb gutters  Incinerators  Fire Sprinkling System

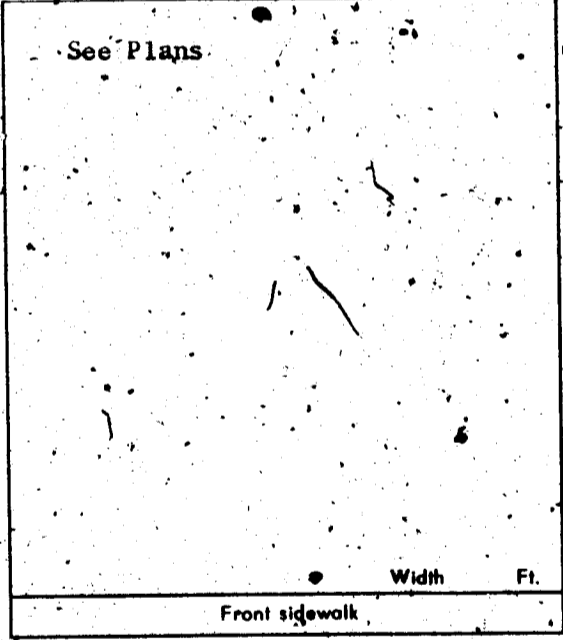

CONDITIONS OF THE PERMIT:

1. I agree to call the City Building Department for inspections before concrete is poured, before rough wiring, electrical, plumbing, framing is covered. Also for Air conditioning, sheet-rock and sheathing inspection.
2. I agree that when the job is completed that I will call for final inspection before occupancy.
3. I agree to perform all construction in accordance with City Ordinances and Building Codes.
4. The Contractor's signature below denotes authority from the owner to sign in his behalf and that the owner is aware of all requirements of this application and permit. Separate permits must be taken out for work outlined above this agreement.
5. I have read and understand the contents of this application and permit; I hereby state that the information I have supplied on this application is true and correct.

SIGNED: Sun Home Builders Inc. Contractor

BY: [Signature] Agent or Owner

CLARK COUNTY HEALTH DEPT. Date: \_\_\_\_\_

LAS VEGAS FIRE DEPARTMENT Date: \_\_\_\_\_

PLANNING DEPT.: [Signature] Date: 5/30/72

PUBLIC WORKS DEPT.: [Signature] Date: 5-31

BUILDING DEPT.: [Signature] Date: 5-15-72

#12850 PERMIT NO.: 4823 PERMIT FEE \$ 162<sup>00</sup>

RECEIPT

7963 \$162.00 - 8

CITY OF LAS VEGAS  
DEPT. OF BUILDING & SAFETY

MUST BE MACHINE VALIDATED

31 MAY-72

*J. Jones 6-4-72*

CITY OF LAS VEGAS, NEVADA

DEPARTMENT OF BUILDING & SAFETY - APPLICATION AND PERMIT FOR PLUMBING

ADDRESS OF CONSTRUCTION: **1932 Gerlach**

OWNER'S NAME: **Sun Homes**

CIRCLE: New Bldg.; Add'n; Remodel; TYPE OF BLDG.: SFD. APT. PUB. COMM.

STATE LICENSE # **10680A** CITY **C11-537-2-10212** LICENSE #

CONTRACTOR'S NAME: **Edwards Plumbing Inc.**

UNITS	DESCRIPTION	FEE	TOTAL
	Bathtub	1.00	
	Shower	1.00	
	Lavatory	1.00	
	Toilet	1.00	
	Urinal	1.00	
	Floor Drain	1.00	
	Floor Sink	1.00	
	Wash Tray	1.00	
	Sink	1.00	
	Garbage Disposal	1.00	
	Garbage Disposal (comm.)	3.00	
	Clothes Dryer (gas)	1.00	
	Clothes Washer	1.00	
	Clothes Washer (comm.)	5.00	
	Dishwasher	1.00	
	Dishwasher (commercial)	5.00	
	Dental Unit	10.00	
	Drinking Fountain	1.00	
	Any Water using Equipment	1.00	
	Water Heater (gas) (elec)	1.00	
1	Sewer System - New, Replacement, or any Drainage System	4.00	4.00
	Grease or Sand Trap	2.00	
	Trailer Trap	2.00	
	Septic Disposal System	4.00	
WATER SOFTENERS			
	Nonpermanent Type	4.00	
	Permanent Type (connected to Drainage)	5.00	
SWIMMING POOLS			
	Private or Wading Pool	10.00	
	Public or Semi-public	20.00	

UNITS	DESCRIPTION	FEE	TOTAL
WATER DISTRIBUTION SYSTEM			
	Single Family Dwelling	4.00	
	Multiple Family Dwelling plus each unit	4.00	
		2.00	
	Bldg. Group "A" thru "G" per each floor	6.00	6.00
	Hotel or Motel plus each bath	4.00	
		1.50	
	Trailer Park plus each space	20.00	
		1.00	
	Irrigation	4.00	
GAS PIPING SYSTEM			
	Single Family Dwelling	3.00	
	Multiple Family Dwelling plus each unit	6.00	
		1.00	
	Commercial Bldg. per floor plus each unit	3.00	
		1.00	
	Gas Appliance (any type)	1.00	
AUTOMATIC FIRE EXTINGUISHING SYSTEM			
	Underground Piping	10.00	
	Distribution Piping ea. ft.	.01	
	Sprinkler Head each	.10	
	In Range Hood and Vent	5.00	
DRY STANDPIPE SYSTEM			
	Piping	50.00	
	Each Outlet	1.00	
WET STANDPIPE SYSTEM			
	Piping	5.00	
	Fire Hose Cabinet	1.00	
	MINIMUM PERMIT FEE	4.00	
PIPELINE CONTRACTOR, SECT 14-B P.F.F.			
TOTAL PERMIT FEE \$			10.00

I hereby certify that I have carefully examined and read the above application; that the same is true and correct; and that the work herein described is to be done in accordance with all the provisions of the applicable Ordinances of the City of Las Vegas, Nevada, and the State Laws, whether herein specified or not.

Signed *Robert Edwards* Date: \_\_\_\_\_  
REGISTERED MASTER PLUMBER, SPEC. CONTR. OR OWNER

Building Department *NM* Date: \_\_\_\_\_

#12870 Permit No. *5374* Permit Fee \$ *10*

RECEIPT

9321 \$010.00

CITY OF LAS VEGAS  
 DEPT. OF  
 BUILDING & SAFETY

MUST BE MACHINE VALIDATED  
 22 JUN 72

*10 June 64 79*

CITY OF LAS VEGAS, NEVADA

DEPARTMENT OF BUILDING & SAFETY - APPLICATION AND PERMIT FOR PLUMBING

ADDRESS OF CONSTRUCTION: **1932 ~~Clark~~ Gerlach**

OWNER'S NAME: **Sun Homes**

CIRCLE: New Bldg.; Add'n; Remodel; TYPE OF BLDG.: SFD. APT. PUB. COMM.

STATE CITY **C11-537-2-10212**  
 LICENSE # **10680A** LICENSE #

CONTRACTOR'S NAME: **Edwards Plumbing Inc.**

UNITS	DESCRIPTION	FEE	TOTAL
	Bathtub	1.00	
	Shower	1.00	
	Lavatory	1.00	
	Toilet	1.00	
	Urinal	1.00	
	Floor Drain	1.00	
	Floor Sink	1.00	
	Wash Tray	1.00	
	Sink	1.00	
	Garbage Disposal	1.00	
	Garbage Disposal (comm.)	3.00	
	Clothes Dryer (gas)	1.00	
	Clothes Washer	1.00	
	Clothes Washer (comm.)	5.00	
	Dishwasher	1.00	
	Dishwasher (commercial)	5.00	
	Dental Unit	10.00	
	Drinking Fountain	1.00	
	Any Water using Equipment	1.00	
	Water Heater (gas) (elec)	1.00	
1	Sewer System - New, Replacement, or any Drainage System	4.00	4.00
	Grease or Sand Trap	2.00	
	Trailer Trap	2.00	
	Septic Disposal System	4.00	
WATER SOFTENERS			
	Nonpermanent Type	1.00	
	Permanent Type (connected to Drainage)	5.00	
SWIMMING POOLS			
	Private or Wading Pool	10.00	
	Public or Semi-public	20.00	

UNITS	DESCRIPTION	FEE	TOTAL
WATER DISTRIBUTION SYSTEM			
	Single Family Dwelling	4.00	
	Multiple Family Dwelling plus each unit	4.00	
	Bldg. Group "A" thru "G" per each floor	2.00	
1	Hotel or Motel plus each bath	6.00	6.00
	Trailer Park plus each space	4.00	
	Irrigation	1.00	
GAS PIPING SYSTEM			
	Single Family Dwelling	3.00	
	Multiple Family Dwelling plus each unit	6.00	
	Commercial Bldg. per floor plus each unit	3.00	
	Gas Appliance (any type)	1.00	
AUTOMATIC FIRE EXTINGUISHING SYSTEM			
	Underground Piping	10.00	
	Distribution Piping ea. ft.	.01	
	Sprinkler Head each	.10	
	In Range Hood and Vent	5.00	
DRY STANDPIPE SYSTEM			
	Piping	50.00	
	Each Outlet	1.00	
WET STANDPIPE SYSTEM			
	Piping	5.00	
	Fire Hose Cabinet	1.00	
MINIMUM PERMIT FEE 4.00			
PIPELINE CONTRACTOR, SECT 14 B P F \$			
TOTAL PERMIT FEE \$			10.00

I hereby certify that I have carefully examined and read the above application, that the same is true and correct, and that the work herein described is to be done in accordance with all the provisions of the applicable Ordinances of the City of Las Vegas, Nevada and the State Laws, whether herein specified or not.

Signed *Robert Edwards*  
 REGISTERED MASTER PLUMBER, SPEC. CONTR. OR OWNER

Date: \_\_\_\_\_

Building Department

Date: \_\_\_\_\_

#12870

Permit No. **5374** Permit Fee \$ **10**

RECEIPT

9321 \$010.00

CITY OF LAS VEGAS  
 DEPT OF BUILDING & SAFETY

MUST BE MACHINE VALIDATED

22 JUN 72

*U. Jones to 479*

**CITY OF LAS VEGAS, NEVADA**  
**DEPARTMENT OF BUILDING & SAFETY - APPLICATION AND PERMIT FOR PLUMBING**

ADDRESS OF CONSTRUCTION: 1932 Gerlach

OWNER'S NAME: Sun Home Builders Inc.

CIRCLE: New Bldg. Add'n; Remodel; TYPE OF BLDG.: SFD. APT. PUBLIC COMM.

CONTRACTOR'S NAME: Edwards

STATE LICENSE # \_\_\_\_\_ CITY LICENSE # \_\_\_\_\_

UNITS	DESCRIPTION	FEE	TOTAL
4	Bathub	1.00	4.00
	Shower	1.00	
4	Lavatory	1.00	4.00
4	Toilet	1.00	4.00
	Urinal	1.00	
	Floor Drain	1.00	
	Floor Sink	1.00	
	Wash Tray	1.00	
4	Sink	1.00	4.00
	Garbage Disposal	1.00	
	Garbage Disposal (comm.)	3.00	
	Clothes Dryer (gas)	1.00	
	Clothes Washer	1.00	
	Clothes Washer (comm.)	5.00	
	Dishwasher	1.00	
	Dishwasher (commercial)	5.00	
	Dental Unit	10.00	
	Drinking Fountain	1.00	
	Any Water using Equipment	1.00	
4	Water Heater (gas) (elect.)	1.00	4.00
	Sewer System - New, Replacement, or any Drainage System	4.00	
	Grease or Sand Trap	2.00	
	Trailer Trap	2.00	
	Septic Disposal System	4.00	
WATER SOFTENERS			
	Nonpermanent Type	4.00	
	Permanent Type (connected to Drainage)	5.00	
SWIMMING POOLS			
	Private or Wading Pool	10.00	
	Public or Semi-public	20.00	

UNITS	DESCRIPTION	FEE	TOTAL
WATER DISTRIBUTION SYSTEM			
	Single Family Dwelling	4.00	
	Multiple Family Dwelling plus each unit	2.00	
	Bldg. Group "A" thru "G" per each floor	6.00	
	Hotel or Motel plus each bath	4.00	
	Trailer Park plus each space	1.00	
	Irrigation	4.00	
GAS PIPING SYSTEM			
	Single Family Dwelling	3.00	
1	Multiple Family Dwelling plus each unit	6.00	6.00
1	Commercial Bldg. per floor plus each unit	1.00	4.00
	Commercial Bldg. per floor plus each unit	3.00	
	Gas Appliance (any type)	1.00	
AUTOMATIC FIRE EXTINGUISHING SYSTEM			
	Underground Piping	10.00	
	Distribution Piping ea. ft.	.01	
	Sprinkler Head each	.10	
	In Range Hood and Vert	5.00	
DRY STANDPIPE SYSTEM			
	Piping	50.00	
	Each Outlet	1.00	
WET STANDPIPE SYSTEM			
	Piping	5.00	
	Fire Hose Cabinet	1.00	
	MINIMUM PERMIT FEE	4.00	
PIPELINE CONTRACTOR, SECT. 14-B.P.F. \$			
TOTAL PERMIT FEE \$			30.00

I hereby certify that I have carefully examined and read the above application; that the same is true and correct; and that the work herein described is to be done in accordance with all the provisions of the applicable Ordinances of the City of Las Vegas, Nevada and the State Laws, whether herein specified or not.

Signed *Paul Edwards* Date: \_\_\_\_\_  
REGISTERED MASTER PLUMBER, SPEC. CONTRACTOR, OR OWNER

Building Department *N. Miller* Date: \_\_\_\_\_  
 #12870 Permit No. 7618 Permit Fee \$ 30.00

**RECEIPT**

5979 \$030.00 - 7

CITY OF LAS VEGAS  
 DEPT. OF BUILDING & SAFETY

MUST BE MACHINE VALIDATED

- 8 NOV 72

12-19-72

CITY OF LAS VEGAS, NEVADA

DEPARTMENT OF BUILDING & SAFETY — ELECTRICAL APPLICATION & PERMIT

ADDRESS OF CONSTRUCTION: 1932 Gerlach OWNER'S NAME: Sun Home Builders

CIRCLE: New Bldg.; Add'n; Remodel; TYPE OF BLDG.: SFD. APT. PUBLIC COMM.

CONTRACTOR'S NAME: Howard Electric Company STATE LICENSE #: 8191 CITY LICENSE #: 102-68

NUMBER	FIXTURE OR INSTALLATION	UNIT PRICE	
28	Fixture or sockets	.15	4.20
148	Light, receptacle or switch outlet	.20	29.60
	Wall or ceiling space heater	.35	
	Blast coil heater per kilowatt	.35	
4	Garbage grinder outlet	.35	1.40
	Dishwasher outlet	.35	
	Clothes dryer outlet	.35	
	Automatic clothes washer	.35	
	Electric range outlet	.35	
4	Electric water heater outlet	.35	1.40
	Mercury arc lamp and equipment	.35	
	Special purpose outlet	.35	
	X-ray unit and its appurtenances	5.00	
	Watts of festoon lighting (Watts) First 3000 watts for each additional thousand watts	4.00 1.50	
1	Horsepower — all motors first horsepower or less for each additional horsepower	1.75 .35	1.75 1.05
1	Temporary power and lights (temporary pole)	4.00	
3	Electric service (including any single meter socket) for each additional socket	3.00 .35	3.00 1.05
	Air conditioning service amps	1.50	
	Each KW (KVA) Generator (Transformer) (Welder) KW (KVA) First 100 KVA — For each additional KW (KVA)	2.00 .01	
	Special inspection per hour	4.00	
	Speaker outlets	.15	
	Signal or Alarm outlets	.15	
	Amplifiers	.50	
	Control panels	.25	
4	T. V. outlets — master system only	.15	.60
	Radio outlets	.15	
	Main control racks	1.00	
	T. V. and Radio antennas — master system only	.75	
	Minimum fee for any permit	4.00	
	Total fee		44.05

I hereby certify that I have carefully examined and read the above application; that the same is true and correct; and that the work herein described is to be done in accordance with all the provisions of the applicable Ordinances of the City of Las Vegas, Nevada and State laws whether herein specified or not.

SIGNED: [Signature] DATE: 12-19-72  
MASTER (ELECTRICIAN) (TECHNICIAN) (OWNER)

BUILDING DEPARTMENT: [Signature] DATE:

#12860 PERMIT NO.: 4913 PERMIT FEE: \$ 44.05

RECEIPT

7989 \$044.05 - 6

CITY OF LAS VEGAS  
DEPT. OF BUILDING & SAFETY  
MUST BE MACHINE VALIDATED.

21 DEC 72

12/24/72

### CITY OF LAS VEGAS, NEVADA

### DEPARTMENT OF BUILDING & SAFETY — AIR CONDITIONING APPLICATION & PERMIT

ADDRESS OF CONSTRUCTION: 1432 GARCACH DR. OWNER'S NAME: SUN HOME BLDGS

CIRCLE: Addition; Remodel; New Bldg. TYPE OF BLDG.: SFD APT. COMM. PUBLIC

CONTRACTOR'S NAME: BEST Air STATE LICENSE 9881-A CITY LICENSE

UNITS	DESCRIPTION	FEE	TOTAL	UNITS	DESCRIPTION	FEE	TOTAL
	Unit heater — floor, wall or suspended	4.00			EVAPORATIVE COOLERS:		
	FOR EACH FORCED-AIR OR GRAVITY-TYPE FURNACE OR BURNER INCLUDING DUCTS AND VENT ATTACHED TO SUCH APPLIANCES:				5 outlets or under	3.00	
	Up to and including 100,000 B.t.u.'s	4.00			Over 5 and up to and including 10	5.00	
	Over 100,000 B.t.u.'s	6.00			Each additional outlet over 10	.25	
	FOR EACH HEATING APPLICATION, REFRIGERATION UNIT, COMFORT COOLING AND HEATING UNIT, ABSORPTION UNIT, COMPRESSOR OR BOILER:				VENTILATION:		
4	Up to and including 3 ton or horsepower, or absorption system up to and including 100,000 B.t.u.'s	4.00	16.00	4	For each fan connected to a single duct	1.00	4.00
	Over 3 ton or 3 horsepower up to and including 10, or absorption system over 100,000 B.t.u.'s up to and including 250,000 B.t.u.'s	7.00			For each commercial or industrial ventilation system	5.00	
	Over 10 ton or 10 horsepower up to and including 30, or absorption system over 250,000 B.t.u.'s up to and including 1,000,000 B.t.u.'s	12.00			For each commercial kitchen hood	5.00	
	Over 30 ton or 30 horsepower up to and including 50, or absorption system over 1,000,000 B.t.u.'s up to and including 1,700,000 B.t.u.'s	20.00			MISCELLANEOUS:		
	Over 50 ton or 50 horsepower, or absorption system over 1,700,000 B.t.u.'s	30.00			For each water cooling tower	8.00	
	FOR EACH AIR HANDLING UNIT INCLUDING DUCTS ATTACHED THERETO:				Duct work only — each opening	.25	
	Up to and including 10,000 CFM	2.00			For installation or relocation of each commercial or industrial incinerator	15.00	
	Over 10,000 CFM	4.00			Gas piping related to the air cond. work in single family dwelling only	3.00	
					For each appliance, piece of equipment, any mechanical work or alteration or replacement not included in this schedule, the permit fee shall be computed the same as building permit fees by using the cost of installation for the valuation amount.		
					FOR THE ISSUANCE OF EACH PERMIT		3.00
					TOTAL PERMIT FEE \$		23.00

I hereby certify that I have carefully examined and read the above application; that the same is true and correct; and that the work herein described is to be done in accordance with all the provisions of the applicable Ordinances of the City of Las Vegas, Nevada and the State Laws, whether herein specified or not.

SIGNED [Signature] Date \_\_\_\_\_  
Air Conditioning Contractor - Owner

BUILDING DEPARTMENT [Signature] Date 12-27-72

PERMIT NO. 3046 PERMIT FEE \$ 23.00

#12890

RECEIPT  
8198 \$023.00 - 4  
CITY OF LAS VEGAS  
DEPT. OF BUILDING & SAFETY  
MUST BE MACHINE VALIDATED  
26 DEC 72

*Lila Collins 3-3-82*

DEPT. of BLDG & SAFETY - CITY of LAS VEGAS, NEVADA 91-72  
 OWNER: Sierra Nevada Arms ADDRESS: 1932 Gerlach Drive DATE: 5-28-72  
 GEN. CONT. Sun Home Bldrs TYPE OF STRUCTURE Apt # 67  
 PERMIT NO. 4823 LEGAL DESCRIPTION: see application

BUILDING		MECHANICAL		ELECTRICAL	
LOCATION <i>BW 7-18-72</i>		PLUMBING CONT. <i>Howard</i>		TEMP. POCE CONT.	
FIREPLACE FTG.		PERMIT NO. <i>5374</i>	DATE <i>6-24-72</i>	PERMIT NO.	DATE
FOOTINGS <i>BW 7-18-72</i>		HEAT & VENT. AC CONT. <i>But Air</i>		INSPECTION	DATE
FOUNDATION WALL <i>BW 8-2-72</i>		PERMIT NO. <i>3046</i>	DATE <i>12-16-72</i>	ELECTRICAL CONT. <i>Howard</i>	
FLOOR FRAMING		SEWER CONT. <i>Sun Home</i>		PERMIT NO. <i>4913</i>	DATE <i>11-20-72</i>
SLAB		PERMIT NO. <i>4800</i>	DATE	FIXTURES CONT.	
CHIMNEY STEEL (FIREPLACE)		ROUGH SOIL <i>WPR 1-23-72</i>		PERMIT NO.	DATE
WALL STEEL		ROUGH WATER		SLAB	
COLUMN STEEL		TOP-OUT <i>4-11-72</i>		ROUGH	
BEAM STEEL		ROUGH GAS <i>4-11-72</i>		FINAL ROUGH	
FRAMING		AC ROUGH DUCT <i>4-11-72</i>		FINAL FIXTURE	
ROOF SHEATHING		REF. ROUGH PIPING		FINAL ELECTRICAL <i>7-4-73-73</i>	
DRYWALL	INTERIOR	FINAL PLUMBING <i>4-3-72</i>		TEMPORARY SERVICE	
LATHING	EXTERIOR	FINAL GAS <i>4-3-72</i>			
BACKING (SIDING)		FINAL AIR COND. <i>4-3-72</i>			
PLASTER SCRATCH		FINAL REFRIG.			
PLASTER BROWN		FINAL SEWER			
URBAN REDEVELOPMENT APPROVAL		FINAL SEPTIC TANK			
FINAL BLDG	DATE				

APPROVED FOR OCCUPANCY & METER *BW 3-27-73* INSPECTOR \_\_\_\_\_ DATE \_\_\_\_\_  
 PLEASE NOTE REMARKS ON REVERSE SIDE LOG: # \_\_\_\_\_ AREA: # \_\_\_\_\_ 23.04  
 1932 Gerlach Drive C 72-3

DEPARTMENT OF BUILDING & SAFETY  
 CITY OF LAS VEGAS, NEVADA  
 OWNER: Sierra Nevada  
 CONTRACTOR: Sun Home Builders  
 LOT: 39-52 BLOCK: 6 SUBDIVISION: Sierra Nevada # 2 block fence  
 KARDEX CARD  
 FENCE & RETAINING WALLS  
 DATE: 5-4-73  
 PERMIT NO. 11090

Fence (wire, wood, etc.)	Walls (masonry, rock, etc.)
Location _____	Location <i>BW 5-8-73</i>
Final Inspection _____	Footing <i>BW 5-8-73</i>
	Wall Steel 1st _____ 2d _____ 3d _____
	Final Inspection _____
Retaining Wall (masonry)	Retaining Wall (concrete)
Location _____	Location _____
Footing _____	Footing _____
Wall Steel 1st _____ 2d _____ 3d _____	Wall Steel 1st _____ 2d _____ 3d _____
Bond Beam 1st _____ 2d _____ 3d _____	Final Inspection _____
Final Inspection _____	

*Retained 8-6-73*  
 23.14 B ADDRESS: 1932 Gerlach Drive AREA: \_\_\_\_\_