

4228 Gaye Lane

L1 B1 Stonehaven Zone R-1

Shannon Greer 5/17/79

LOG NO. & AREA T-10-3 CITY OF LAS VEGAS, NEVADA CONST. VAL. \$ 31,660.00

DEPARTMENT OF BUILDING & SAFETY APPLICATION & BUILDING PERMIT for:

ADDRESS OF CONSTRUCTION: 4828 GAYE LN OWNER: ROYAL CREST INC

LOT(S) 1 BLOCK 1 SUBDIVISION STONEHAVEN ZONE: R-1

Existing structure on lot: Dwelling Accessory Bldg Vacant lot Other

PROPOSED CONSTRUCTION: S.F.D. USE: S.F.D.

MATERIALS OF CONSTRUCTION: Wood Frame Concrete Block Reinforced Concrete Steel Frame

SQUARE FEET OF FLOOR AREAS: 1st 2243 2nd 3rd Other 484 TOTAL SQ. FT. 2727

FIRE ZONE: 1 2 3 Occupancy Group A B C D E F G H I J-1-2-3-4-5 CONST. TYPE: I II III IV V

ARCHITECT: _____ ENGINEER: _____ NO. of UNITS _____ NO. of STORIES _____

Plans Submitted: Yes No Calculations Submitted Yes No Sewer Fee Req'd. Yes No

CONTRACTOR: ROYAL CREST INC STATE LICENSE # 5623 CITY LICENSE # 6255

ADD'L. PERMITS REQ'D: Air Cond. Elec. Plumbing Signs Paving Fence Public Walks Curb-gutters Incinerators Fire Sprinkling System

5 BDRM
PLAN 53-22
MODIFIED
SEE NOT PLAN
Width Ft.
Front sidewalk

CONDITIONS OF THE PERMIT:

- I agree to call the City Building Department for inspections before concrete is poured, before rough wiring, electrical, plumbing, framing is covered. Also for Air conditioning, sheet-rock and sheathing inspection.
- I agree that when the job is completed that I will call for final inspection before occupancy.
- I agree to perform all construction in accordance with City Ordinances and Building Codes.
- The Contractor's signature below denotes authority from the owner to sign in his behalf and that the owner is aware of all requirements of this application and permit. Separate permits must be taken out for work outlined above this agreement.
- I have read and understand the contents of this application and permit; I hereby state that the information I have supplied on this application is true and correct.

SIGNED: ROYAL CREST INC Contractor

BY: Gene Park Agent or Owner

CLARK COUNTY HEALTH DEPT. Date: _____

LAS VEGAS FIRE DEPARTMENT Date: _____

PLANNING DEPT: MM Date: 5-2-69

ENGINEERING DEPT: MM Date: 5-2

BUILDING DEPT: R. Greer Date: 5-5-69

#12850 PERMIT NO: 47428 PERMIT FEE \$ 19850

RECEIPT
082 \$098.50
CITY OF LAS VEGAS
DEPT. OF BUILDING & SAFETY
MUST BE MACHINE VALIDATED
- 6 MAY 69

Sharon Lewis 5/17/79

CITY OF LAS VEGAS, NEVADA
DEPARTMENT OF BUILDING & SAFETY

SEWER CONNECTION FEE: \$ 150

RECEIPT
for
SEWER CONNECTION FEE

JOB ADDRESS: 4228 GAGE LN OWNER'S NAME: ROYAL CREST IN
LOT 1 BLOCK 1 SUBDIVISION: STONEHAVEN

QUANTITY	OCCUPANCY	UNIT FEE	AMOUNT
1	S.F.O.	150	150

TOTAL 150
 Less Credit*
 TOTAL FEE \$ 150

*Credit for existing sewer is applied to the new sewer connection fee based on previous type of occupancy and only when the new occupancy requires an additional fee.
 This receipt does not authorize the owner or his representative to start any work without obtaining a plumbing permit.

J. Wilson
 DEPARTMENT OF BUILDING & SAFETY 5-5-69
 DATE

Receipt
 083 \$150.00 - 3
 CITY OF LAS VEGAS
 DEPT. OF BUILDING & SAFETY
 Must be machine validated
 6 MAY 69

73102 RECEIPT NO. 26848 SEWER FEE \$ 150

Sharon Trevis 5/17/79

CITY OF LAS VEGAS, NEVADA

DEPARTMENT OF BUILDING & SAFETY - APPLICATION AND PERMIT FOR PLUMBING

ADDRESS OF CONSTRUCTION: 4228 Gaye Lane OWNER'S NAME: Roy Crest Inc.

CIRCLE: New Bldg. Add'n; Remodel; TYPE OF BLDG.: SFD APT. PUBLIC COMM.

CONTRACTOR'S NAME: C. Plumbing STATE LICENSE # 7596 CITY LICENSE # 10100

UNITS	DESCRIPTION	FEE	TOTAL
2	Bathtub	1.00	2.00
	Shower	1.00	
2	Lavatory	1.00	2.00
2	Toilet	1.00	2.00
	Urinal	1.00	
	Floor Drain	1.00	
	Floor Sink	1.00	
	Wash Tray	1.00	
1	Sink	1.00	1.00
	Garbage Disposal	1.00	
	Garbage Disposal (comm.)	3.00	
	Clothes Dryer (gas)	1.00	
1	Clothes Washer	1.00	1.00
	Clothes Washer (comm.)	5.00	
	Dishwasher	1.00	
	Dishwasher (commercial)	5.00	
	Dental Unit	10.00	
	Drinking Fountain	1.00	
	Any Water using Equipment	1.00	
1	Water Heater (gas)(elect.)	1.00	1.00
	Sewer System - New, Replacement, or any Drainage System	4.00	4.00
	Grease or Sand Trap	2.00	
	Trailer Trap	2.00	
	Septic Disposal System	4.00	
WATER SOFTENERS			
	Nonpermanent Type	4.00	
	Permanent Type (connected to Drainage)	5.00	
SWIMMING POOLS			
	Private or Wading Pool	10.00	
	Public or Semi-public	20.00	

UNITS	DESCRIPTION	FEE	TOTAL
WATER DISTRIBUTION SYSTEM			
	Single Family Dwelling	4.00	4.00
	Multiple Family Dwelling plus each unit	4.00	
	Bldg. Group "A" thru "G" per each floor	2.00	
	Hotel or Motel plus each bath	6.00	
	Trailer Park plus each space	4.00	
	Irrigation	1.00	
GAS PIPING SYSTEM			
	Single Family Dwelling	3.00	
	Multiple Family Dwelling plus each unit	6.00	
	Commercial Bldg. per floor plus each unit	1.00	
	Gas Appliance (any type)	3.00	
		3.00	
		1.00	
AUTOMATIC FIRE EXTINGUISHING SYSTEM			
	Underground Piping	10.00	
	Distribution Piping ea. ft.	.01	
	Sprinkler Head each	.10	
	In Range Hood and Vent	5.00	
DRY STANDPIPE SYSTEM			
	Piping	50.00	
	Each Outlet	1.00	
WET STANDPIPE SYSTEM			
	Piping	5.00	
	Fire Hose Cabinet	1.00	
	MINIMUM PERMIT FEE	4.00	
TOTAL PERMIT FEE \$			17.00

I hereby certify that I have carefully examined and read the above application; that the same is true and correct; and that the work herein described is to be done in accordance with all the provisions of the applicable Ordinances of the City of Las Vegas, Nevada and the State Laws, whether herein specified or not.

Signed: Dale E. Cas Date: _____
REGISTERED MASTER PLUMBER, SPEC. CONTR. OR OWNER

Building Department: L.H. Date: 5-12-69

#12870 Permit No. 26920 Permit Fee \$ 17.00

RECEIPT
 400 \$017.00 - 7

CITY OF LAS VEGAS
 DEPT. OF BUILDING & SAFETY

MUST BE MACHINE VALIDATED
 12 MAY 69

Sharon Lewis 5/17/79

CITY OF LAS VEGAS, NEVADA

DEPARTMENT OF BUILDING & SAFETY - ELECTRICAL APPLICATION & PERMIT

ADDRESS OF CONSTRUCTION: 4228 Gaye Lane OWNER'S NAME: Edward P. Morley

CIRCLE: New Bldg., Add'n, Remodel; TYPE OF BLDG.: SFD, APT, PUBLIC, COMM

CONTRACTOR'S NAME: Owner STATE LICENSE # CITY LICENSE #

NUMBER	FIXTURE OR INSTALLATION	UNIT PRICE	
13	Fixture or sockets	.15	1.95
95	Light, receptacle or switch outlet	.20	19.00
	Wall or ceiling space heater	.35	
1	Blast coil heater 100 per kilowatt	.35	3.50
1	Garbage grinder outlet	.35	1.35
1	Dishwasher outlet	.35	.35
1	Clothes dryer outlet	.35	.35
1	Automatic clothes washer	.35	.35
2	Electric range outlet	.35	1.70
2	Electric water heater outlet	.35	.70
	Mercury arc lamp and equipment	.35	
	Special purpose outlet	.35	
	X-ray unit and its appurtenances	5.00	
	Watts of festoon lighting (Watts) First 3,000 watts	4.00	
	for each additional thousand watts	1.50	
	Horsepower - all motors first horsepower or less	1.75	
	for each additional horsepower	.35	
	Temporary power and lights (temporary pole)	4.00	
	Electric service (including any single meter socket)	3.00	
	for each additional socket	.35	3.00
200 Amp	Air conditioning service	1.50	1.50
5 Ton	amps		
	Each KW (KVA) Generator (Transformer) (Welder) KW (KVA)	2.00	
	First 100 KVA - For each additional KW (KVA)	.01	
	Special inspection per hour	4.00	
	Speaker outlets	.15	
	Signal or Alarm outlets	.15	
	Amplifiers	.50	
	Control panels	.25	
	T. V. outlets - master system only	.15	
	Radio outlets	.15	
	Main control racks	1.00	
	T. V. and Radio antennas - master system only	.75	
	Minimum fee for any permit	4.00	
	Total fee		31.75

I hereby certify that I have carefully examined and read the above application; that the same is true and correct; and that the work herein described is to be done in accordance with all the provisions of the applicable Ordinance of the City of Las Vegas, Nevada and State laws whether herein specified or not.

SIGNED: [Signature] DATE: 5/13/69

BUILDING DEPARTMENT: [Signature] DATE: 5-14-69

PERMIT NO.: 27990 PERMIT FEE: \$ 31.75

RECEIPT 5576 \$031.75 CITY OF LAS VEGAS DEPT. OF BUILDING & SAFETY MUST BE MACHINE VALIDATED 14 MAY 69

Sharon Lewis 5/17/79

CITY OF LAS VEGAS, NEVADA
DEPARTMENT OF BUILDING & SAFETY - AIR CONDITIONING APPLICATION & PERMIT

ADDRESS OF CONSTRUCTION: 4228 Gaye Lane OWNER'S NAME: Collins Bros
 CIRCLE: New bldg.; Old bldg.; Add'n; Remodel; TYPE OF BLDG. SFD APT. COMM.
 CONTRACTOR'S NAME: Dick Bernard STATE LICENSE # 6410 CITY LICENSE # 9737

UNITS	HEATERS	PRICE	FEE	UNITS	GAS	PRICE	FEE
	Unit Heaters (floor, suspended & wall)	\$2.00			Gas piping system 1 to 5 outlets	\$3.00	
	Floor Furnace	\$3.00			Gas piping system over 5 outlets (per outlet)	.20	
	Forced Air or Gravity Type under 100,000 BTU's	\$7.00			Swimming pool heater	\$4.00	
	Steam or hot water heating system under 15 outlets (Boiler Excluded)	\$8.00		VENTS			
	Steam or hot water heating system 15 to 30 outlets (Boiler Excluded)	\$10.00			Combustion products vent other than a chimney	\$1.00	
	Each outlet over 30	.50			Residential kitchen or bathroom vent each	.25	
	Radiant type heating system under 1000 sq. ft. to be heated	\$8.00			Commercial Hood	\$4.00	
	Radiant type heating system 1000 to 2000 sq. ft. to be heated	\$10.00			Ventilation system not a portion of any heating or air conditioning system up to \$1,000 valuation	\$5.00	
	Each additional 500 sq. ft. over 2000 sq. ft.	.50		BOILER			
AIR CONDITIONING					Boiler installation 15 H.P. and under	\$5.00	
	Heat pump or refrigerant 3 tons or less.	\$4.00			Boiler installation over 15 H.P.	\$10.00	
1	Heat pump or refrigerant 3 tons to 10 tons	\$6.00	6.00	REPAIR			
	Each addn. ton over 10 ton	.50			Inspection of alteration or replacement of any mechanical cooling equipment which is a portion of any air conditioning system	\$3.00	
	Refrigeration system 3 ton or less	\$5.00			DUCT WORK ONLY (each opening)	.25	
	Refrigeration system 3 to 10 ton	\$7.00			WATER TOWER	\$4.00	
	Each addn. ton over 10 ton	.50			MINIMUM PERMIT FEE	\$4.00	
	Evaporative cooler 5 outlets and under	\$3.00		TOTAL PERMIT FEE			
	Evaporative cooler 5 to 10 outlets	\$5.00				6.00	
	Each addn. outlet over 10	.25					

I hereby certify that I have carefully examined and read the above application; that the same is true and correct; and that the work herein described is to be done in accordance with all the provisions of the applicable Ordinances of the City of Las Vegas, Nevada and the State laws, whether herein specified or not.

SIGNED Dick Bernard Date 6-2-69
 AIR CONDITIONING CONTRACTOR - OWNER
 BUILDING DEPARTMENT J. Wenzel Date 6-3-69
 #12890 PERMIT NO. 27496 PERMIT FEE \$ 6.00

RECEIPT
 7519 \$006.00
 CITY OF LAS VEGAS
 DEPT. OF BUILDING & SAFETY
 MUST BE MACHINE VALIDATED
 - 3 JUN 69

Sharon Terera 5/17/79

CITY OF LAS VEGAS, NEVADA

LOG NO. & AREA _____ CONST. VAL. \$ 10.50

DEPARTMENT OF BUILDING & SAFETY

APPLICATION & BUILDING PERMIT for: Fence, Wall, Retaining Wall.

ADDRESS OF CONSTRUCTION: 4228 Gay Ln. OWNER: Royal Crest

LOT(s) 1 BLOCK 1 SUBDIVISION Stonehenge ZONE: R-1

Materials of Construction: Block Concrete Wire Wood Other PLANS:

ARCHITECT: _____ ENGINEER: _____ CALCS:

CONTRACTOR: Daley Masonry STATE LICENSE # 5799C CITY LICENSE # 5839

TOTAL SQUARE FEET: _____ TOTAL LINEAL FEET: 175

Remarks: _____

CONDITIONS OF THE PERMIT:

- 1. Any type of retaining wall must be engineered by a Civil or Structural Engineer.
2. If a home owner takes out the Building Permit and if the owner sublets the work to a Contractor, then the Contractor must take out the permit and pay for it.
3. No fence or wall can be built on City property or rights-of-way, but this is not intended to preclude construction within utility easements if utilities will not be damaged or made inaccessible.
4. The fence or wall shall not enclose any water meter, light standard, or fire alarm box and shall not come closer than 24" from the nearest fire hydrant outlet.
5. Department Inspectors must approve footings before concrete is poured and block wall reinforcing before grouting is done.
6. Maximum height of any wall or fence is 6', side and rear yards; 4' maximum in front yard with the vertical surface above the height of 2' - 50% open and further that fencing within 25' of the intersection of curb faces on corner and through lots is limited to a maximum height of 30".
7. I must not obstruct required onsite parking space (1 space for each dwelling unit) by the erection of this fence or wall.
8. By the signing of this application I herewith agree to the requirements outlined above.

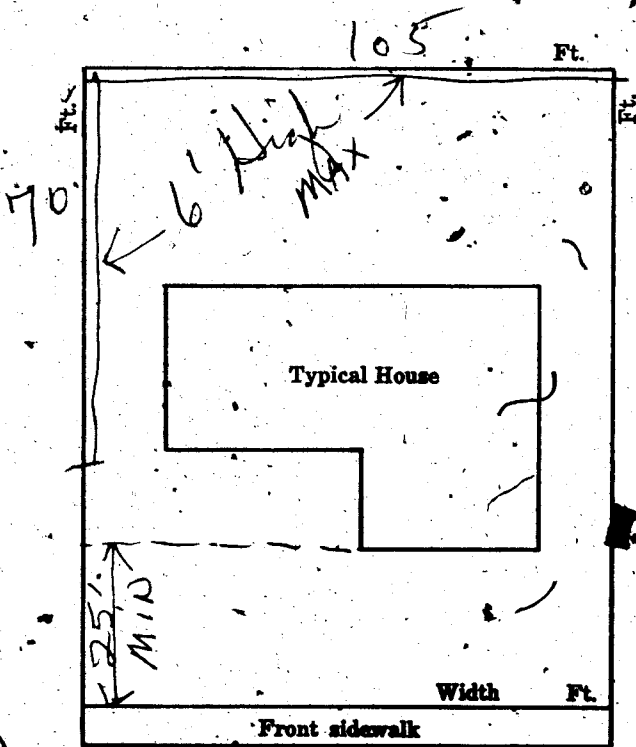

SIGNED: Daley Masonry 9-8-69
CONTRACTOR AGENT OWNER

PLANNING DEPT: MC Date: 9/8/69
ENGINEERING DEPT: _____ Date: _____
BUILDING DEPT: J. Wenzl Date: 9-9-69
#1285 PERMIT NO: 49236 PERMIT FEE \$ 12.00

RECEIPT
1916 \$012.00 -
CITY OF LAS VEGAS
DEPT. OF BUILDING & SAFETY
MUST BE MACHINE VALIDATED
- 9 SEP 69

Sharon Drevia 5/17/79

CITY OF LAS VEGAS, NEVADA

LOG NO. & AREA

DEPARTMENT OF BUILDING & SAFETY

CONST. VAL. \$ 7500

APPLICATION & BUILDING PERMIT - for: Fence, Wall, Retaining Wall

ADDRESS OF CONSTRUCTION: 4728 GAY LN

OWNER: MORLEY LEONARD

LOT(s) 1 BLOCK 1 SUBDIVISION STONE HAVEN

ZONE R-D

Materials of Construction: Block Concrete Wire Wood Other

Yes No

ARCHITECT: ENGINEER:

PLANS:

CALCS:

CONTRACTOR: OWNER

STATE LICENSE #

CITY LICENSE #

TOTAL SQUARE FEET: 20

TOTAL LINEAL FEET: 275'

Remarks:

CONDITIONS OF THE PERMIT:

- Any type of retaining wall must be engineered by a Civil or Structural Engineer.
- If a home-owner takes out the Building Permit and if the owner sublets the work to a Contractor, then the Contractor must take out the permit and pay for it.
- No fence or wall can be built on City property or rights-of-way, but this is not intended to preclude construction within utility easements if utilities will not be damaged or made inaccessible.
- The fence or wall shall not enclose any water meter, light standard, or fire alarm box and shall not come closer than 24" from the nearest fire hydrant outlet.
- Department inspectors must approve footings before concrete is poured and block wall reinforcing before grouting is done.
- Maximum height of any wall or fence is 6', side and rear yards; 4' maximum in front yard with the vertical surface above the height of 2' - 50% open.
- It must not obstruct required onsite parking space (1 space for each dwelling unit) by the erection of this fence or wall.
- By the signing of this application I herewith agree to the requirements outlined above.

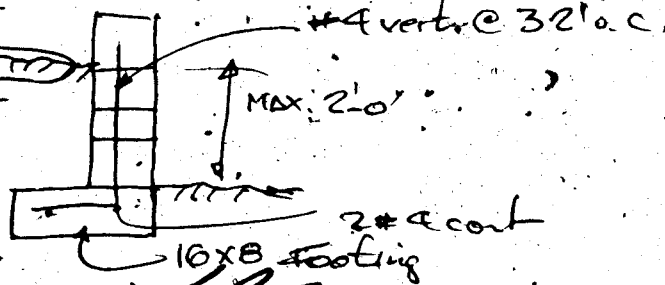
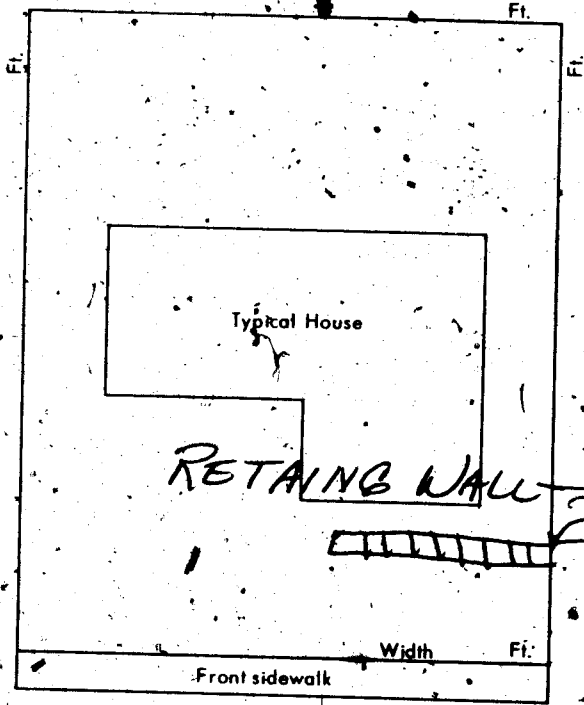

SIGNED: [Signature]

DATE:

CONTRACTOR AGENT OWNER

PLANNING DEPT.: [Signature]

Date: 11-16-70

PUBLIC WORKS DEPT.: [Signature]

Date: 11-16-70

BUILDING DEPT.: [Signature]

Date: 11-16-70

#12850 PERMIT NO.: 55585

PERMIT FEE \$ 500

RECEIPT

2114 \$005.00 - 8

CITY OF LAS VEGAS
DEPT. OF BUILDING & SAFETY
MUST BE MACHINE VALIDATED

17 NOV 70

Sharon Pereira 5/17/79

CITY OF LAS VEGAS, NEVADA

LOG NO. & AREA _____
DEPARTMENT OF BUILDING & SAFETY

CONST. VAL. \$ 380.00

APPLICATION & BUILDING PERMIT - for:
Dwellings, Duplexes, Misc. Residential Const.

ADDRESS OF CONSTRUCTION: 4228 Gaye Lane OWNER: Morley, Leonard

LOT(s) 1 BLOCK 1 SUBDIVISION STONE HAVEN ZONE R-D

Existing structure on lot: Dwelling Accessory bldgs. Vacant lot Other

PROPOSED CONSTRUCTION: Parking slab USE: SAME

MATERIALS OF CONSTRUCTION: Wood Frame Concrete Block Reinforced Concrete Steel Frame

SQUARE FEET OF FLOOR AREAS: 1st _____ 2nd _____ 3rd _____ Other _____ TOTAL SQ. FT. 700

FIRE ZONE: 1 2 3 Occupancy Group: A C D E F G H I J 1-2-3-4-5 CONJ. TYPE: I II III IV V

ARCHITECT: _____ ENGINEER: _____ NO. of UNITS: _____ NO. of STORIES: _____

Plans Submitted: Yes No Calculations Submitted: Yes No Sewer Fee Req'd.: Yes No

CONTRACTOR: owner STATE LICENSE # _____ CITY LICENSE # _____

ADD'L. PERMITS REQ'D.: Air Cond. Elec. Plumbing Signs Paving Fence Public Walks Curb-gutters Incinerators Fire Sprinkling System

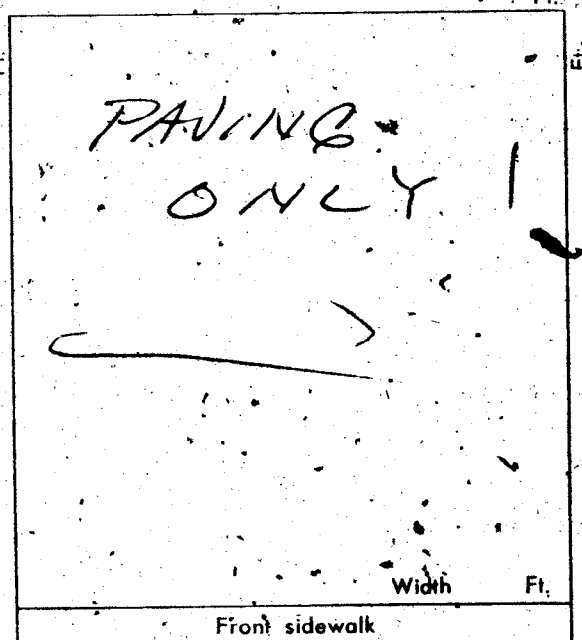

CONDITIONS OF THE PERMIT:

- 1. I agree to call the City Building Department for inspections before concrete is poured, before rough wiring, electrical, plumbing, framing is covered. Also for Air conditioning, sheet-rock and sheathing inspection.
- 2. I agree that when the job is completed that I will call for final inspection before occupancy.
- 3. I agree to perform all construction in accordance with City Ordinances and Building Codes.
- 4. The Contractor's signature below denotes authority from the owner to sign his behalf and that the owner is aware of all requirements of this application and permit. Separate permits must be taken out for work outlined above this agreement.
- 5. I have read and understand the contents of this application and permit, I hereby state that the information I have supplied on this application is true and correct.

SIGNED: Leonard Morley Contractor
BY: _____ Agent or Owner

CLARK COUNTY HEALTH DEPT. Date: _____
LAS VEGAS FIRE DEPARTMENT Date: _____

PLANNING DEPT: MO Date: 11-16-70
PUBLIC WORKS DEPT. Date: _____
BUILDING DEPT: RR Date: 11-16-70
#12850 PERMIT NO: 55584 - PERMIT FEE \$ 6.00

RECEIPT: 2115 \$006.00 - 8
CITY OF LAS VEGAS
DEPT. OF BUILDING & SAFETY
MUST BE MACHINE VERIFIED
7 NOV 70

Sharon Pereira 5/17/79

CITY OF LAS VEGAS, NEVADA

LOG NO. & AREA

CONST. VAL. \$ 350.00

DEPARTMENT OF BUILDING & SAFETY

APPLICATION & BUILDING PERMIT - for: Dwellings, Duplexes, Misc. Residential Const.

ADDRESS OF CONSTRUCTION: 4228 Gay Lane

OWNER: Morley, Leonard

LOT(s) 1 BLOCK 1 SUBDIVISION STONE HAVEN

ZONE: R-D

Existing structure on lot: Dwelling Accessory bldgs. Vacant lot Other

PROPOSED CONSTRUCTION: Parking slab USE: SAME

MATERIALS OF CONSTRUCTION: Wood Frame Concrete Block Reinforced Concrete Steel Frame

SQUARE FEET OF FLOOR AREAS: 1st 2nd 3rd Other TOTAL SQ. FT. 700

FIRE ZONE: 1-2-3 Occupancy Group A B C D E F G H I J-1-2-3-4-5 CONST. TYPE: I II III IV V

ARCHITECT: ENGINEER: NO. of UNITS NO. of STORIES

Plans Submitted: Yes No Calculations Submitted: Yes No Sewer Fee Req'd: Yes No

CONTRACTOR: owner STATE LICENSE # CITY LICENSE #

ADD'L PERMITS REQ'D: Air Cond. Elec. Plumbing Signs Paving Fence Public Walks Curb-gutters Incinerators Fire Sprinkling System

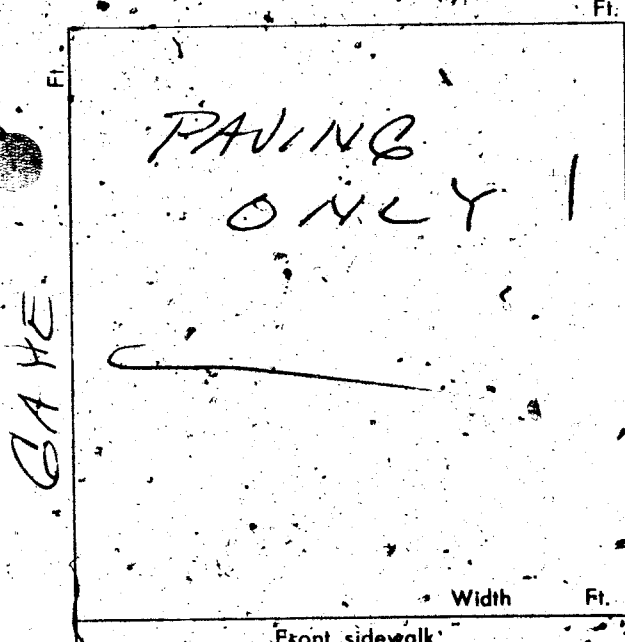

CONDITIONS OF THE PERMIT:

- 1. I agree to call the City Building Department for inspections before concrete is poured, before rough wiring, electrical, plumbing, framing is covered. Also for Air conditioning, sheet-rock and sheathing inspection.
2. I agree that when the job is completed that I will call for final inspection before occupancy.
3. I agree to perform all construction in accordance with City Ordinances and Building Codes.
4. The Contractor's signature below denotes authority from the owner to sign in his behalf and that the owner is aware of all requirements of this application and permit. Separate permits must be taken out for work outlined above this agreement.
5. I have read and understand the contents of this application and permit. Thereby state that the information I have supplied on this application is true and correct.

SIGNED: [Signature] Contractor
BY: _____ Agent or Owner

CLARK COUNTY HEALTH DEPT. Date
LAS VEGAS FIRE DEPARTMENT Date

PLANNING DEPT: [Signature] Date: 11-16-70

PUBLIC WORKS DEPT: _____ Date: _____

BUILDING DEPT: [Signature] Date: 11-16-70

#12850 PERMIT NO: 55584 PERMIT FEE \$ 6.00

RECEIPT - 2115 \$006.00 - 8

CITY OF LAS VEGAS DEPT. OF BUILDING & SAFETY

MUST BE MACHINE VERIFIED 7 NOV 70

Sub Area 3-5

DEPT. of BLDG & SAFETY—CITY of LAS VEGAS, NEVADA

OWNER Leonard Morley ADDRESS 4228 Gaye Lane DATE 11-16-70
 GEN. CONT Owner TYPE OF STRUCTURE parking slab
 PERMIT NO. 55584 LEGAL DESCRIPTION Lot 1 block 1 Stonehaven

BUILDING		MECHANICAL	ELECTRICAL
LOCATION		PLUMBING CONT.	TEMP. POLE CONT.
FIREPLACE PTC.		PERMIT NO. _____ DATE _____	PERMIT NO. _____ DATE _____
FOOTINGS		HEAT & VENT. AC CONT.	INSPECTION _____ DATE _____
FOUNDATION WALL		PERMIT NO. _____ DATE _____	ELECTRICAL CONT.
FLOOR FRAMING		SEWER CONT.	PERMIT NO. _____ DATE _____
SLAB		PERMIT NO. _____ DATE _____	FIXTURES CONT.
CHIMNEY STEEL (FIREPLACE)		ROUGH SOL.	PERMIT NO. _____ DATE _____
WALL STEEL		ROUGH WATER	SLAB _____
COLUMN STEEL		TOP-OUT	ROUGH _____
BEAM STEEL		ROUGH GAS	FINAL ROUGH _____
FRAMING		AC ROUGH DUCT	FINAL FIXTURE _____
ROOF SHEATHING		REF. ROUGH PIPING	FINAL ELECTRICAL _____
	INTERIOR _____ EXTERIOR _____	FINAL PLUMBING _____	
DRYWALL		FINAL GAS _____	TEMPORARY SERVICE _____
LATHING		FINAL AIR COND. _____	
BACKING (STONS)		FINAL REFRIG. _____	MISCELLANEOUS
PLASTER SCRATCH		FINAL SEWER _____	SHADING & DRAINAGE _____
PLASTER BROWN		FINAL SEPTIC TANK _____	ON-SITE PARKING SPACES _____ APP. _____
URBAN REDEVELOPMENT APPROVAL			ENG. APPROVAL OF _____
FINAL BLDG _____ DATE _____			OFF-SITE IMPROVEMENTS _____

APPROVED FOR OCCUPANCY & METER *Office 2-7-71* INSPECTOR _____ DATE _____
 PLEASE NOTE REMARKS ON REVERSE SIDE 4228 Gaye Lane LOG # _____ AREA # _____ 23.04

DEPARTMENT OF BUILDING & SAFETY CITY OF LAS VEGAS, NEVADA KARDEX CARD FENCE & RETAINING WALLS

OWNER Leonard Morley ADDRESS 4228 Gaye Lane DATE 11-15-70
 CONTRACTOR Owner PERMIT NO. 55585
 LOT 1 BLOCK 1 SUBDIVISION Stonehaven block fence

Fence (wire, wood, etc.)	Walls (masonry, rock, etc.)
Location _____	Location <u>SE 425-71</u>
Final Inspection _____	Footing <u>2 4-25-71</u>
	Wall Steel 1st _____ 2d _____ 3d _____
	Final Inspection _____
Retaining Wall (masonry)	Retaining Wall (concrete)
Location _____	Location _____
Footing _____	Footing _____
Wall Steel 1st _____ 2d _____ 3d _____	Wall Steel 1st _____ 2d _____ 3d _____
Bond Beam 1st _____ 2d _____ 3d _____	Final Inspection _____
Final Inspection _____	

Pulled 7-3-72
 23.14 B ADDRESS 4228 Gaye Lane LOG NO. _____ AREA _____

DEPARTMENT OF BUILDINGS
CITY OF LAS VEGAS, NEVADA

KAREN CARD

ROCK & RETAINING WALLS

OWNER - Royal Crest

DATE 9/9/69

CONTRACTOR Daley Masonry

PERMIT NO. 49236

LOT 1 BLOCK 1 SUBDIVISION Stonehaven Block

Fence (wire, wood, etc.)	Walls (masonry, rock, etc.)
Location _____	Location _____
Final Inspection _____	Footings <u>WES 11 69</u>
	Wall Steel 1st <u>WES 12 29 69</u> 3d
	Final Inspection <u>WES 12 29 69</u>
Retaining Wall (masonry)	Retaining Wall (concrete)
Location _____	Location _____
Footings _____	Footings _____
Wall Steel 1st _____ 2d _____ 3d _____	Wall Steel 1st _____ 2d _____ 3d _____
Board Beam 1st _____ 2d _____ 3d _____	Final Inspection _____
Final Inspection _____	

23.14

ADDRESS 4228 GAYE LN.

DEPT. of BLDG. & SAFETY - CITY of LAS VEGAS, NEVADA
OWNER ROYAL CREST INC. ADDRESS 4228 GAYE LN. DATE 5-6-69
GEN. CONT. SAME TYPE OF STRUCTURE S.F.D.
PERMIT NO. 17428 LEGAL DESCRIPTION Lot 1, Blk. 1, Stonehaven

BUILDING	MECHANICAL	ELECTRICAL
LOCATION _____	PLUMBING CONT. <u>Carl</u>	TEMP. POLE CONT. _____
FIREPLACE FT. _____	PERMIT NO. <u>26820</u> DATE <u>5-12-69</u>	PERMIT NO. _____ DATE _____
FOUNDATIONS <u>WES 5-6-69-5-14-69</u>	HEAT & VENT. AC CONT. <u>Mich. Bernard</u>	INSPECTION _____ DATE _____
FOUNDATION WALL <u>WES 5-8-69-5-14-69</u>	PERMIT NO. <u>17496</u> DATE <u>4-3-69</u>	ELECTRICAL <u>Plumer</u>
FLOOR FRAMING _____	SEWER CONT. <u>ROYAL CREST</u>	PERMIT NO. <u>299</u> DATE <u>5-15-69</u>
SLAB _____	PERMIT NO. <u>26818</u> DATE <u>5-6-69</u>	FIXTURES CONT. _____
CHIMNEY STEEL (FIREPLACE) _____	ROUGH SOL. <u>WES 5-14-69</u>	PERMIT NO. _____ DATE _____
WALL STEEL _____	ROUGH WATER <u>WES 5-14-69</u>	SLAB _____
COLUMN STEEL _____	TOP-OUT <u>WES 5-15-69</u>	ROUGH <u>Miller Co. 2-20-69</u>
BEAM STEEL _____	ROUGH GAS _____	FINAL ROUGH _____
FRAMING _____	AC ROUGH DUCT <u>WES 6-23-69</u>	FINAL FIXTURE _____
ROOF SHEATHING <u>WES 6-17-69</u>	REF. ROUGH PIPING _____	FINAL ELECTRICAL _____
DRYWALL <u>WES 7-7-69</u>	FINAL PLUMBING <u>WES 7-4-69</u>	TEMPORARY SERVICE _____
LATHING _____	FINAL GAS _____	
BACKING (SIDING) _____	FINAL AIR COND. _____	
PLASTER SCRATCH _____	FINAL REFRIG. _____	
PLASTER BROWN _____	FINAL SEWER _____	
URBAN REDEVELOPMENT APPROVAL _____	FINAL SEPTIC TANK _____	
FINAL BLDG. _____ DATE _____		

APPROVED FOR OCCUPANCY & METER

4228 GAYE LN.

LOG # T-10-3

AREA #

23.04

4-15-83

CITY OF LAS VEGAS, NEVADA

024-044-004

LOG NO. & AREA

CONST. VAL. \$ 1320.00

DEPARTMENT OF PUBLIC SERVICES
DIVISION OF BUILDING AND SAFETY

APPLICATION & BUILDING PERMIT - for:
Dwellings, Duplexes, Misc. Residential Const.

ADDRESS OF CONSTRUCTION: 4228 Gay Ln

OWNER: Morley, Leonard

LOT: 1 BLOCK: 1 SUBDIVISION: STONEHAVEN

ZONE: R-1/4

Existing structure on lot: Dwelling Accessory Bldgs. Vacant Lot Other

PROPOSED CONSTRUCTION: shed + shed USE:

MATERIALS OF CONSTRUCTION: Wood Frame Concrete Block Reinforced Concrete Steel Frame

SQUARE FEET OF FLOOR AREAS: 1st 240 2nd 3rd Other TOTAL SQ. FT. 240

FIRE ZONE: Occupancy Group M-1 CONST. TYPE: V-N

ARCHITECT: ENGINEER: NO. of UNITS: NO. of STORIES: 1

Plans Submitted: Yes No Calculations Submitted: Yes No Sewer Fee Req'd: Yes No

CONTRACTOR: Owner STATE LICENSE: CITY LICENSE:

ADD'L. ITEMS REQ'D.: Air Cond. Elec. Plumbing Signs Paving Fence Public Walks Curb-gutters
Incinerators Fire Sprinkling System

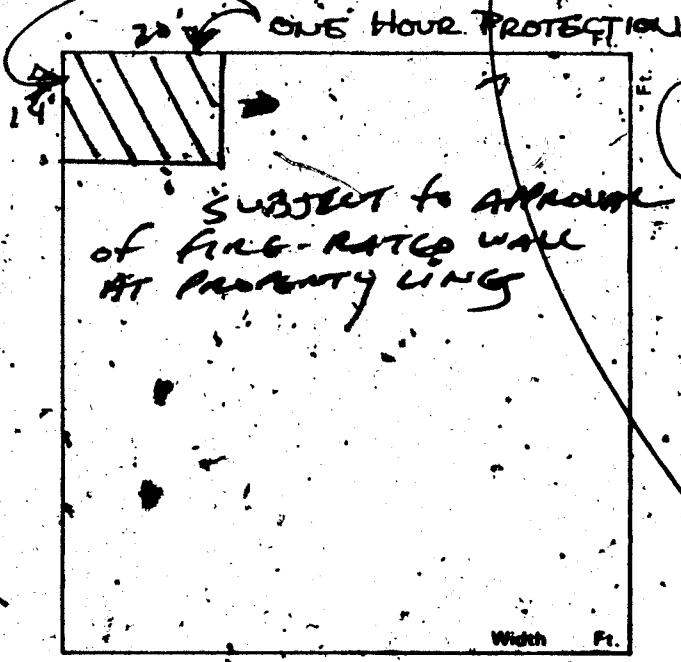

CONDITIONS OF THE PERMIT:

- I agree to call the City Building Department for inspections before concrete is poured, before rough wiring, electrical, plumbing, framing is covered. Also for Air conditioning, dry wall and finishing inspections.
- I agree that when the job is completed that I will call for final inspection before occupancy.
- I agree to perform all construction in accordance with Ordinance and Building Codes.
- The Contractor's signature below denotes authority for the owner to sign in his behalf and that the owner is aware of all requirements of this application and permit. Separate permits must be taken for work outlined above in this agreement.
- I have read and understand the contents of this application and permit. I hereby state that the information I have supplied on this application is true and correct.

Approval for the work under this permit will not be granted unless release and debris have been removed from the site and public right of way. Special permits are required for work within the public right of way.

SIGNED: Leonard Morley Contractor
BY: Agent or Owner

PLANNING DEPT.: SW Date: 4-13-83
 PUBLIC WORKS DEPT.: TURK Date: 4/13/83
 BUILDING DIVISION: M.J. Date: 4-13-83
 PERMIT NO.: 894 PERMIT FEE \$ 32.50

RECEIPT
 MUST BE MACHINE VALIDATED

Dona Spealy 7-1-83

OWNER	Leonard Morley		ADDRESS	4428 Gay Lane	
DATE	4-14-83	GEN. CONT.	Owner		
TYPE OF STRUCTURE	shed/slab		PERMIT NO.	8941	
LEGAL DESCRIPTION	L 1 B 1 Stonehaven		LOG NO.	AREA NO.	
APPROVED FOR OCCUPANCY & METE					
BUILDING			MECHANICAL		
Investigation			Plumbing Cont.		
Location & Footing	CM 6-29-83		Permit No.	Date	
Concrete Slab Floor	CM 6-29-83		Heat & Vent. A/C Cont.		
Hearth & Fireplace			Permit No.	Date	
Chimney Stack			Sewer Cont.		
Vert. Steel Rainf.			Permit No.	Date	
Horiz. Steel Rainf.			Rough Soil		
Framing			Rough Water		
Ext. Lath			Top-Out	7	
Ext. Bricks			Rough Gas		
Drywall			A/C Rough Duct		
Final Building	CM 6-29-83		Final Plumbing		
Appr. for Occu.			Final Gas		
ELECTRICAL			Final Air Cond.		
Temp. Pipe Cont.			Final Sewer		
Permit No.	Date		REMARKS		
Inspection	Date				
Electrical Cont.					
Permit No.	Date				
Rough			PLEASE NOTE ADDITIONAL REMARKS ON REVERSE SIDE.		
Final Rough			DEPT. OF BLDG. & SAFETY		
Final Electrical			CITY OF LAS VEGAS		
Temporary Service			REV. 82-3-29		

M. J. Francis 72484

CITY OF LAS VEGAS, NEVADA

LOG NO. & AREA _____ DATE _____ CONST. VAL. \$ _____

DEPARTMENT OF BUILDING AND SAFETY
PHONE 386-6251

PLUMBING PERMIT

ADDRESS OF CONSTRUCTION 4328 Goya Lane OWNER Leonard Morley

CONTRACTOR American Solar Ent STATE LICENSE NO. 41724 CITY LICENSE NO. 17077

LOT(S) _____ BLOCK _____ SUBDIVISION _____ ZONE _____

PROPOSED CONSTRUCTION: Solar hot water USE: _____
PLUMBING PERMIT NO. 205027

Approval for the work under this permit will be given only after refuse and debris have been removed from job site and public right of way

UNITS	DESCRIPTION	FEE	TOTAL
PERMIT ISSUANCE			
	For Issuing Each Permit	10.00	10.00
	For Issuing Each Supplemental Permit	4.50	
FIXTURE CHARGE			
	Bathub, Shower, Lavatory, Toilet, Urinal	EA 2.00	
	Floor Drain, Floor Sink, Wash Tray, Sink	EA 2.00	
	Garbage Disposal, Clothes Washer, Dishwasher (residential)	EA 2.00	
	Garbage Disposal (commercial)	EA 8.00	
	Clothes Washer, Dishwasher (commercial)	EA 2.00	
	Clothes Dryer (gas) (venting)	2.00	
	Dental Unit	8.00	
	Drinking Fountain	2.00	
	Refrigerator - Ice Maker, Water Dispenser	2.00	
	Any other water using equipment, Attached Coffee Makers, Ice Makers	2.00	
	Hot Water Heater (Gas or Electric)	EA 2.00	
SEWER SYSTEM			
	New, Replacement, Modification, or Any Drainage Work	10.00	
	Grease or Sand Trap or Interceptor	2.00	
	Trailer Trap (rental works)	5.00	
WATER SOFTENERS			
	Non-Permanent Type (rental)	2.00	
	Permanent Type (connected to drain)	2.00	
SWIMMING POOLS			
	Private or Wading Pool (including spa)	25.00	
	Public or Semi-Public	30.00	
	Spas - Preformed (private)	10.00	
	Spas - Preformed (commercial)	20.00	
WATER DISTRIBUTION SYSTEM			
	Single Family Dwelling	6.00	
	Multi-Family Dwelling	6.00	
	Plus Each Dwelling Unit	3.00	
	Commercial Building per floor	3.00	
	Plus Each Unit (leased space or office)	2.00	
	Hotel or Motel	8.00	
	Plus Each Unit	3.00	
	Trailer Park	30.00	
	Plus Each Space	2.00	
	Irrigation	8.00	
FUEL PIPING SYSTEM			
	Single Family Dwelling	6.00	
	Multi-Family Dwelling	10.00	
	Plus Each Unit	2.00	
	Commercial Building (per floor)	6.00	
	Plus Each Unit (leased space or office)	6.00	

UNITS	DESCRIPTION	FEE	TOTAL
	Medium Pressure Gas System (plan check)	12.00	
	Each Gas Appliance (any type)	2.00	
	Standby Emergency (generating engines)	5.00	
	Steam Boilers	5.00	
	Service Station Fuel Tank and Piping System	10.00	
	Fuel Tanks (ea)	10.00	
AUTOMATIC FIRE EXTINGUISHING SYSTEM			
	Underground Piping	20.00	
	Distribution Piping (per-foot)	05	
	Sprinkler Head (each)	20	
	In Range Hood and Vent	10.00	
	Dry Standpipe System		
	Piping	75.00	
	Each Outlet	2.00	
	Wet Standpipe System		
	Piping	10.00	
	Fire Hose Cabinet	2.00	
SOLAR ENERGY SYSTEMS			
2	Collectors (including piping) (per collector)	5.00	10.00
	Storage Tanks (each)	5.00	
PIPELINE CONTRACT			
For Onsite Sewer, Gas or Water Contract Val. Fee based on Building Code, Permit Unit Charge			
NO STORAGE TANKS			
OTHER INSPECTIONS AND FEES:			
	Inspections outside of normal business hours (minimum charge - three hours)	25.00	per hour
	Reinspection fee assessed under provisions of TABLE 3-A of the Uniform Building Code = \$15.00 EACH	15.00	each
	Inspections for which no fee is specifically indicated (minimum charge - one-half hour)	15.00	per hour
	Additional plan review required by changes, additions or revisions to approved plans (minimum charge two hours)	15.00	per hour

Plumbing permit fees may be computed the same as building permit fees by using the cost of installation for valuation amount when such work is not included in the above schedule

RECEIPT

SEWER # 71143654 CONNECTION

FIXTURES X

FEE _____

PERMIT FEE _____

TOTAL FEES 20.00

I hereby certify that I have carefully examined and read the above application, that the same is true and correct, and that the work herein described is to be done in accordance with all the provisions of the applicable Ordinances of the City of Las Vegas, Nevada and the State Laws, whether herein specified or not. #2310-2403

SIGNED Homer G. Daw Drake CONTRACTOR MASTER CARD NO. _____
BY M. J. Francis Registered Master Plumber, Spec. Conf'r. of Owner

BUILDING DEPT. _____ DATE _____

JACKIE B. 2-20-86

ELEC. ONLY PLBG. ONLY, A.C. ONLY		
OWNER	Leonard Morley	
DATE	7-20-84	
ADDRESS	4228 Daze Ln.	
CONTRACTOR	PERMIT NO.	FINAL INSPECTION
LOT	BLOCK	SUBDIVISION
LOG NO.	AREA Solar Hot Water	
ELECTRIC ONLY		PLUMBING ONLY
Contractor	Contractor American Solar Int.	
Permit No.	Permit No. 0502-1	
Rough Elec.	Rough Soil	
Final Rough	Rough Water	
Final Elec.	Top Out	
Temp. Service	Rough Gas	
HEAT & VENT. A/C ONLY	Final Plbg.	
Contractor	Final Gas	
Permit No.	Sewer Final	
A/C Rough Duct		
Rough Gas		
Final A/C		
Final Gas		
79-5-15 (831-81) DEPT. OF BLDG. & SAFETY CITY OF LAS VEGAS		