

Gardenia
320 GERDENIA

Lot 39 Blk.5 Sub Twin Lakes Village #10 Zone R-1

Sharon Davis 5/17/79

PERMIT FEE: \$ 3.00

CITY OF LAS VEGAS, NEVADA
DEPARTMENT OF BUILDING & SAFETY
APPLICATION & BUILDING PERMIT
for FENCE, WALL, RETAINING WALL

LOG NO: & AREA

CONSTRUCTION VALUATION: \$ 370.00
INSPECTION VALUATION: \$

ADDRESS OF CONSTRUCTION: 320

OWNER'S NAME: Robt. Lyne

OWNER'S ADDRESS: 320 GARDEN LANE

Lot (s) 39 Block 5 Subdivision Twin Lakes Village # 16 Zone R-1

Materials of Construction: Concrete Block () Concrete (-) Wire () Wood (X) Other ()

Total Square Feet: Total Lineal Feet: 320

CONTRACTOR'S NAME: STATE LICENSE # CITY LICENSE #

Architect's Name: PLANS SUBMITTED: Yes No
Engineer's Name: CALCULATIONS: Yes No

Proposed fence is on rear yard only

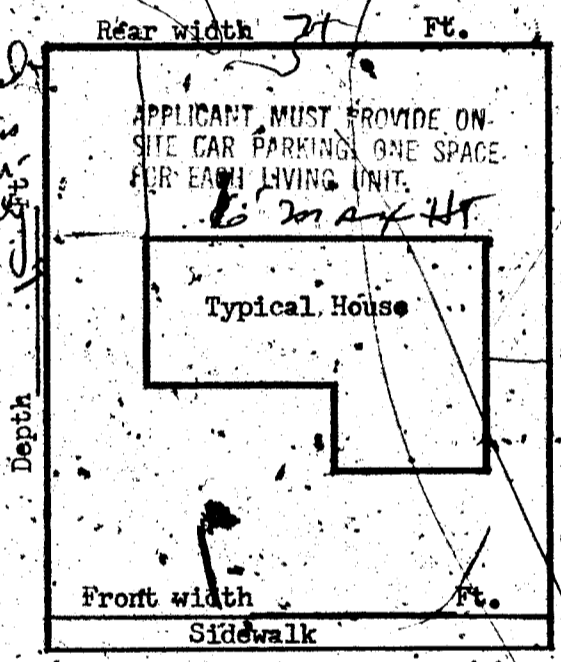

I understand that any portion of this (fence) (wall) constructed or erected on City property of right-of-way will be removed from said location at my expense upon request received from the City of Las Vegas, Nevada. I understand that the (fence) (wall) shall not enclose water meter, light standard, fire alarm box & shall not come closer than two (2') feet in any direction from any fire hydrant. I further state that I am familiar with effective Ordinances of the City of Las Vegas, Nevada & effective Statutes of the State of Nevada covering construction and use of the above type; I agree to perform said construction in conformity therewith. I further agree that issuance of a permit on above application will not excuse me from conforming with said Ordinances, and Statutes, despite any errors on the part of the Building Inspector or Engineer in checking plans and applications herewith submitted. I have read and understand the contents of above application & permit; I hereby state that same are true and correct.

SIGN HERE: Robert Lyne Date: 12-27-66

APPROVED BY: [Signature] DATE: 12-26-66
PLANNING DEPT. & CODE ASSISTANCE

FIRE DEPARTMENT DATE

ENGINEERING DEPARTMENT DATE

BUILDING & SAFETY DEPARTMENT DATE: 12-27-66

RECEIPT
154 \$003.00 - 8
CITY OF LAS VEGAS
DEPT. OF BUILDING & SAFETY
Must be machine validated
28 DEC 66

#1285 PERMIT NO. 35737 PERMIT FEE \$ 3.00
23.14

Lula Collins 3-3-62

DEPT of BLDG & SAFETY - CITY of LAS VEGAS, NEVADA
OWNER JACOBSON & ASSOC. ADDRESS 320 Gardenia Ln. DATE 4-25-62
GEN. CONT. Viking Const. Co. TYPE OF STRUCTURE S.F. Dw.
PERMIT NO. 9556 LEGAL DESCRIPTION

BUILDING		MECHANICAL		ELECTRICAL	
LOCATION	4-25-62	PLUMBING CONT.	3-3-62	TEMP. POLE CONT.	
FIREPLACE FTG.		PERMIT NO.	5356	PERMIT NO.	
FOUNDATIONS	4-25-62	HEAT & VENT. AC CONT.	4-7-62	INSPECTION	
FOUNDATION WALL		PERMIT NO.	3762	ELECTRICAL CONT.	4-19-62
STEM WALL	5-2-62	SEWER CONT.	5-5-62	PERMIT NO.	6419
FLOOR FRAMING		PERMIT NO.	5556	FIXTURES CONT.	6-13-62
SLAB	5-23-62	ROUGH SOIL	5-18-62	PERMIT NO.	6419
CHIMNEY STEEL (FIREPLACE)		ROUGH WATER	6-13-62	SLAB	
WALL STEEL		TOP-OUT	6-13-62	ROUGH	6-18-62
COLUMN STEEL		ROUGH GAS	6-20-62	FINAL ROUGH	
BEAM STEEL		AC ROUGH DUCT	6-20-62	FINAL FIXTURE	
STEEL FABRICATION		REF. ROUGH PIPING	8-11-62	TEMPORARY SERVICE	
FRAMING	6-15-62	FINAL PLUMBING	8-11-62	MISCELLANEOUS	
ROOF SHEATHING	6-2-62	FINAL GAS		URBAN REDEVELOPMENT APPROVAL	
INTERIOR		FINAL AIR COND.	8-13-62	<input type="checkbox"/>	
EXTERIOR		FINAL REFRIG.		GRADING & DRAINAGE	
DRYWALL	6-26-62	FINAL SEWER	5-18-62	ON-SITE PARKING SPACES	
BATHING	6-26-62	FINAL SEPTIC TANK		ENG. APPROVAL OF	
BACKING (SIDING)				OFF-SITE IMPROVEMENTS	
PLASTER SCRATCH				DATE	
PLASTER BROWN					
FINAL BLDG	6-13-62				

APPROVED FOR OCCUPANCY W. Siebert 9-13-62
APPROVED FOR METER West 9-11-62
PLEASE NOTE REMARKS ON REVERSE SIDE
LOG # AREA # 23.04
320 Gardenia Ln. T-18 3

DEPARTMENT OF BUILDING & SAFETY
CITY OF LAS VEGAS, NEVADA
OWNER Robert Ryne ADDRESS 320 Gardenia Lane DATE 12/27/66
CONTRACTOR Owner PERMIT NO. 35737
LOT 39 BLOCK 5 SUBDIVISION Twin Lakes Village #16
Wood Fence

KARDEX CARD
FENCE & RETAINING
WALLS

Fence (wire, wood, etc.)		Walls (masonry, rock, etc.)	
Location		Location	
Final Inspection	1-13-67	Footing	
		Wall Steel 1st	2d 3d
		Final Inspection	
Retaining Wall (masonry)		Retaining Wall (concrete)	
Location		Location	
Footing		Footing	
Wall Steel 1st	2d 3d	Wall Steel 1st	2d 3d
Bond Beam 1st	2d 3d	Final Inspection	
Final Inspection			

23.14 B ADDRESS 320 Gardenia LOG NO. AREA