

4711 FULION PLACE

LOT 536 BL 22 HYDE PARK #3 ZONE R-1

D. Gatewood 5-1-79

CITY OF LAS VEGAS, NEVADA

LOG NO. & AREA

CONST. VAL. \$ 400

DEPARTMENT OF BUILDING & SAFETY

APPLICATION & BUILDING PERMIT — for: Fence, Wall, Retaining Wall.

ADDRESS OF CONSTRUCTION:

4711 FULTON PL.

OWNER:

ROBERT PARCELL

LOT(S)

536 BLOCK 22

SUBDIVISION:

Hyde Park # 3

ZONE R-1

Materials of Construction:

Block

Concrete

Wire

Wood

Other

Yes No

ARCHITECT:

ENGINEER:

PLANS:

CALCS:

CONTRACTOR:

owner

STATE LICENSE #

CITY LICENSE #

TOTAL SQUARE FEET:

TOTAL LINEAL FEET: 109

Remarks:

CONDITIONS OF THE PERMIT:

- Any type of retaining wall must be engineered by a Civil or Structural Engineer.
- If a home owner takes out the Building Permit and if the owner sublets the work to a Contractor, then the Contractor must take out the permit and pay for it.
- No fence or wall can be built on City property or rights-of-way, but this is not intended to preclude construction within utility easements if utilities will not be damaged or made inaccessible.
- The fence or wall shall not enclose any water meter, light standard, or fire alarm box and shall not come closer than 24" from the nearest fire hydrant outlet.
- Department Inspectors must approve footings before concrete is poured and block-wall reinforcing before grouting is done.
- Maximum height of any walk fence is 6', side and rear yards; 4' maximum in front yard with the vertical surface above the height of 2' — 50% open.
- Must not obstruct required onsite parking space (2 spaces for each dwelling unit) by the erection of this fence or wall.
- By the signing of this application I herewith agree to the requirements outlined above.

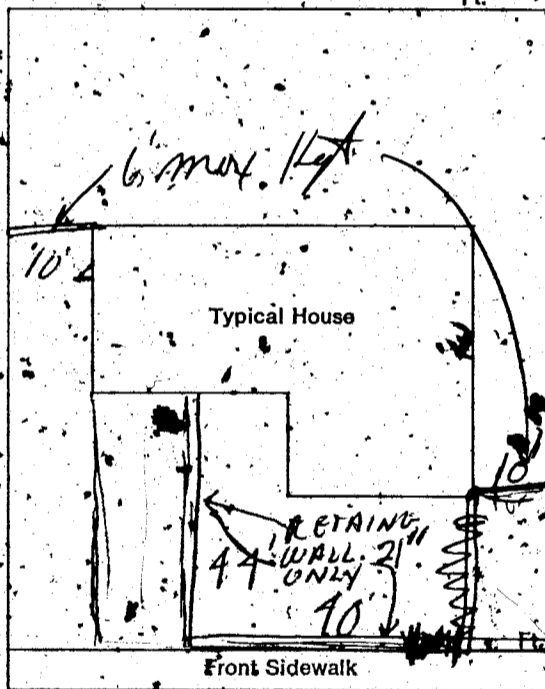

SIGNED:

Robert Parcell

DATE:

1-23-74

CONTRACTOR

AGENT

OWNER

PLANNING DEPT:

[Signature]

Date:

1-23-74

PUBLIC WORKS DEPT:

[Signature]

Date:

1-23-74

BUILDING DEPT:

H. T. Fidler

Date:

#12850

PERMIT NO:

14601

PERMIT FEE \$

6.00

RECEIPT

6390 \$006.00 - 8

CITY OF LAS VEGAS

DEPT. OF BUILDING & SAFETY

MUST BE MACHINE VALIDATED

24 JAN 74

G. Gatewood 5-1-79

CITY OF LAS VEGAS, NEVADA

DEPARTMENT OF PUBLIC SERVICES—ELECTRICAL APPLICATION & PERMIT DIVISION OF BUILDING AND SAFETY

ADDRESS OF CONSTRUCTION: 4711 Fulton OWNER'S NAME: Sharples, Nan

CIRCLE: New Bldg; Add'n.; Remodel; TYPE OF BLDG.: SFD. APT. PUBLIC COMM.

CONTRACTOR'S NAME: Owner STATE LICENSE # _____ CITY LICENSE # 7

NUMBER	FIXTURE OR INSTALLATION	UNIT PRICE	TOTAL
	Rm addition, carport or garage enclosure	4.00	
	Temporary power	4.00	
	Light, receptacle or switch outlet	.20	
	Wall or ceiling space heater	.35	
	Garbage grinder outlet	.35	
	Dishwasher outlet	.35	
	Clothes dryer outlet	.35	
	Automatic clothes washer	.35	
	Electric range outlet	.35	
	Electric water heater outlet	.35	
	Special purpose outlet	.35	
	X-ray unit and its appurtenances	5.00	
	Watts of festoon lighting (Watts) First 3,000 watts for each additional thousand watts	4.00 1.50	
	Horsepower—each motor first horsepower or less for each additional horsepower	1.75 .35	
	Electric service (including any single meter socket) for each additional socket	3.00 .35	
	Air conditioning service	1.50	
	Each KW(KVA) Generator (Transformer, Welder) First 100 KVA for each additional KW(KVA)	2.00 .01	
	Speaker, signal or alarm outlet	.15	
	Amplifiers	.50	
	Control panels	.25	
	Main control racks	1.00	
	T.V. and radio antennas—master system only	.75	
	Minimum fee for any permit	4.00	
	TOTAL FEE		

Approval for the work under this permit will be given only after refuse and debris have been removed from job site and public right of way.

I hereby certify that I have carefully examined and read the above application; that the same is true and correct; and that the work herein described is to be done in accordance with all the provisions of the applicable Ordinances of the City of Las Vegas, Nevada and State laws whether herein specified or not.

SIGNED Nan Sharples DATE _____
MASTER (ELECTRICIAN) (TECHNICIAN) (OWNER)

BUILDING DIVISION: N. Miller DATE 6-24-77

PERMIT NO. 2862 PERMIT FEE: \$ 4.50

RECEIPT

3206 \$004.50

CITY OF LAS VEGAS

DEPT. OF
BUL. BLDG. & SAFETY

MUST BE MACHINE VALIDATED

24 JUN 77

D. Gatewood 5-1-79

CITY OF LAS VEGAS, NEVADA

DEPARTMENT OF BUILDING & SAFETY - AIR CONDITIONING APPLICATION & PERMIT

ADDRESS OF CONSTRUCTION: 4711 FULTON OWNER'S NAME: NAN SHARPLES

CIRCLE: Addition; Remodel; New Bldg; TYPE OF BLDG.: SFD APT COMM. PUBLIC

CONTRACTOR'S NAME: WM. S. LESSENSKI STATE LICENSE # 11806 CITY LICENSE # 05229

UNITS	DESCRIPTION	FEE	TOTAL	UNITS	DESCRIPTION	FEE	TOTAL
	Unit heater - floor, wall or suspended	4.00			EVAPORATIVE COOLERS:		
FOR EACH FORCED-AIR OR GRAVITY-TYPE FURNACE OR BURNER INCLUDING DUCTS AND VENT ATTACHED TO SUCH APPLIANCES:					5 outlets or under	3.00	
	Up to and including 100,000 B.t.u.'s	4.00		Over 5 and up to and including 10	5.00		
	Over 100,000 B.t.u.'s	6.00		Each additional outlet over 10	.25		
FOR EACH HEATING APPLICATION, REFRIGERATION UNIT, COMFORT COOLING AND HEATING UNIT, ABSORPTION UNIT, COMPRESSOR OR BOILER:					VENTILATION:		
	Up to and including 3 ton or horsepower, or absorption system up to and including 100,000 B.t.u.'s	4.00		For each fan connected to a single duct	1.00		
	Over 3 ton or 3 horsepower up to and including 10, or absorption system over 100,000 B.t.u.'s up to and including 250,000 B.t.u.'s	7.00	7.00	For each commercial or industrial ventilation system	5.00		
	Over 10 ton or 10 horsepower up to and including 30, or absorption system over 250,000 B.t.u.'s up to and including 1,000,000 B.t.u.'s	12.00		For each commercial kitchen hood	5.00		
	Over 30 ton or 30 horsepower up to and including 50, or absorption system over 1,000,000 B.t.u.'s up to and including 1,700,000 B.t.u.'s	20.00		MISCELLANEOUS:			
	Over 50 ton or 50 horsepower, or absorption system over 1,700,000 B.t.u.'s	30.00		For each water cooling tower	8.00		
FOR EACH AIR HANDLING UNIT INCLUDING DUCTS ATTACHED THERETO:					Duct work only - each opening	.25	
	Up to and including 10,000 CFM	2.00		For installation or relocation of each commercial or industrial incinerator	15.00		
	Over 10,000 CFM	4.00		Gas piping related to the air cond. work in single family dwelling only	3.00		
				For each appliance, piece of equipment, any mechanical work or alteration or replacement not included in this schedule, the permit fee shall be computed the same as building permit fees by using the cost of installation for the valuation amount.			
				FOR THE ISSUANCE OF EACH PERMIT	3.00		
				TOTAL PERMIT FEE \$	10.00		

I hereby certify that I have carefully examined and read the above application; that the same is true and correct; and that the work herein described is to be done in accordance with all the provisions of the applicable Ordinances of the City of Las Vegas, Nevada and the State Laws, whether herein specified or not.

Approval for the work under this permit will be given only after refuse and debris have been removed from job site and public right of way.

SIGNED William S. Lessenski Date 8/24/77
Air Conditioning Contractor - Owner

BUILDING DEPARTMENT [Signature] Date 8-29-77

PERMIT NO. 1135 PERMIT FEE \$ 10.00

#12890

RECEIPT

CITY OF LAS VEGAS
DEPT. OF BUILDING & SAFETY

MUST BE MACHINE VALIDATED

24 AUG 77

Lula Collins 2-1-83

Department of Building & Safety
City of Las Vegas, Nevada

Special Kardex
Elec. only, Plbg. only, A.C. only

Owner Nan Sharpless Address 4711 Fulton Date 8-24-77
Contractor _____ Permit No. _____
Lot _____ Block _____ Subdivision _____

Electric Only	Plumbing Only	Heat & Vent. A/C Only
Contractor _____	Contractor _____	Contractor <u>Lescenki</u>
Permit No. _____	Permit No. _____	Permit No. <u>8-24-77</u>
Slab _____	Rough Soil _____	A/C Rough Duct _____
Rough Elec. _____	Rough Water _____	Ref. Ro. Piping _____
Final Rough _____	Top Out _____	Rough Gas _____
Final Fixture _____	Rough Gas _____	Final Refrig. _____
Final Elec. _____	Final Plbg. _____	Final A/C _____
Temp. Service _____	Final Gas _____	Final Gas _____
	Final Sewer _____	
	Final Septic Tank _____	

23.06D Address 4711 Fulton Log No. _____ Area _____

Department of Building & Safety
City of Las Vegas, Nevada

Special Kardex
Elec. only, Plbg. only, A.C. only

Owner Nan Sharpless Address 4711 Fulton Date 6-24-77
Contractor _____ Permit No. _____
Lot _____ Block _____ Subdivision _____

Electric Only	Plumbing Only	Heat & Vent. A/C Only
Contractor <u>Owner</u>	Contractor _____	Contractor <u>Owner</u>
Permit No. <u>2862</u>	Permit No. _____	Permit No. <u>808</u>
Slab _____	Rough Soil _____	A/C Rough Duct _____
Rough Elec. _____	Rough Water _____	Ref. Ro. Piping _____
Final Rough _____	Top Out _____	Rough Gas _____
Final Fixture _____	Rough Gas _____	Final Refrig. _____
Final Elec. <u>VP 6-24-77</u>	Final Plbg. _____	Final A/C _____
Temp. Service _____	Final Gas _____	Final Gas _____
	Final Sewer _____	
	Final Septic Tank _____	

4711 Fulton

Electric & AC

23.06D Address _____ Log No. _____ Area _____

Lulu Collins 2-1-82

DEPARTMENT OF BUILDING & SAFETY
CITY OF LAS VEGAS, NEVADA

KARDEX CARD
FENCE & RETAINING
WALLS
DATE 1-23-74

OWNER Robert Pureell ADDRESS 4711 Fulton Pl PERMIT NO. 14601

CONTRACTOR Owner

LOT 536 BLOCK 22 SUBDIVISION Hyde Park # 3 block fence

Fence (wire, wood etc.) Walls (masonry, rock, etc.)

Location
Final Inspection
Location
Footing
Wall Steel 1st 2d 3d
Final Inspection

Retaining Wall (masonry) Retaining Wall (concrete)

Location
Footing
Wall Steel 1st 2d 3d
Bond Beam 1st 2d 3d
Final Inspection
Location
Footing
Wall Steel 1st 2d 3d
Final Inspection

23.14 B ADDRESS 4711 Fulton Place LOG NO. AREA