

4301 FULTON PLACE

LOT 146 BLK 6 HYDE PARK #1 ZONE #1 ZONE R-1

D. Gatewood 5-1-79

CITY OF LAS VEGAS, NEVADA

1969  
CONST. VAL. \$ 70.00

LOG NO. & AREA \_\_\_\_\_ DEPARTMENT OF BUILDING & SAFETY APPLICATION & BUILDING PERMIT for: Fence, Wall, Retaining Wall.

ADDRESS OF CONSTRUCTION: 4301 FULTON Pk. OWNER: RALPH STANTON

LOT(S) 146 BLOCK 6 SUBDIVISION Slide Pk. St. #1 ZONE: R-1

Materials of Construction: Block  Concrete  Wire  Wood  Other  Yes No  
ARCHITECT: \_\_\_\_\_ ENGINEER: \_\_\_\_\_ PLANS:    
CALCS:

CONTRACTOR: W. Kinley Ent. STATE LICENSE # 7263-B CITY LICENSE # C11-3178

TOTAL SQUARE FEET: \_\_\_\_\_ TOTAL LINEAL FEET: 35x3

Remarks:  
\_\_\_\_\_  
\_\_\_\_\_  
\_\_\_\_\_

CONDITIONS OF THE PERMIT:

1. Any type of retaining wall must be engineered by a Civil or Structural Engineer.
2. If a home owner takes out the Building Permit and if the owner sublets the work to a Contractor, then the Contractor must take out the permit and pay for it.
3. No fence or wall can be built on City property or rights-of-way, but this is not intended to preclude construction within utility easements if utilities will not be damaged or made inaccessible.
4. The fence or wall shall not enclose any water meter, light standard, or fire alarm box and shall not come closer than 24" from the nearest fire hydrant outlet.
5. Department Inspectors must approve footings before concrete is poured and block wall reinforcing before grouting is done.
6. Maximum height of any wall or fence is 6' side and rear yards; 4' maximum in front yard with the vertical surface above the height of 2' - 50% open and further that fencing within 25' of the intersection of curb faces on corner and through lots is limited to a maximum height of 30".
7. I must not obstruct required onsite parking space (1 space for each dwelling unit) by the erection of this fence or wall.
8. By the signing of this application I herewith agree to the requirements outlined above.

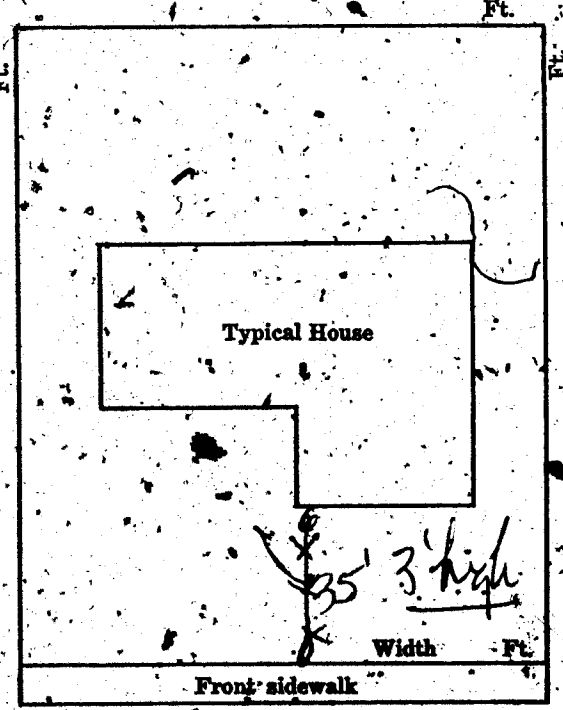

SIGNED: [Signature] DATE: 2/3/69  
CONTRACTOR  AGENT  OWNER

PLANNING DEPT: [Signature] Date: 2-3-69  
ENGINEERING DEPT: \_\_\_\_\_ Date: \_\_\_\_\_  
BUILDING DEPT: [Signature] Date: 2-3-69  
#1285 PERMIT NO: 45824 PERMIT FEE \$ 13.00

RECEIPT  
66 \$003.00 - 8  
CITY OF LAS VEGAS  
DEPT. OF BUILDING & SAFETY  
MUST BE MACHINE VALIDATED  
- 3 FEB 69

G. Gatewood 5-1-79

1966

PERMIT FEE \$ 300

CITY OF LAS VEGAS, NEVADA  
DEPARTMENT OF BUILDING & SAFETY  
APPLICATION & BUILDING PERMIT  
RESIDENTIAL  
(Single family dwelling, duplex,  
miscellaneous residential)

CONSTRUCTION  
VALUATION: \$             
INSPECTION  
VALUATION: \$           

LOG NO. & AREA           

SEWER CONN. FEE: \$             
(Eng. Dept.)

ADDRESS OF CONSTRUCTION: 4301 Fulton Place OWNER'S NAME: Ralph K. Stanton  
LOT(S) 146 BLOCK            SUBDIVISION Hyde Park ZONE R1

CIRCLE EXISTING STRUCTURE ON LOT: Dwelling, Accessory Building(s) Vacant Lot  
PROPOSED CONSTRUCTION: Remove shade to 5' from property line USE extend in front

MATERIALS OF CONSTRUCTION: Wood  Concrete  Reinforced  Steel   
Frame  Block  Concrete  Frame

SQUARE FEET OF FLOOR AREAS: 1st            2nd            TOTAL SQUARE FEET           

FIRE ZONE: 1 2 3 OCCUPANCY GROUPS: I J / 1 2 BUILDING TYPE I II III IV V

ARCHITECT'S NAME:            ENGINEER'S NAME:             
PLANS SUBMITTED: YES  NO  CALCULATIONS SUBMITTED: YES  NO

CONTRACTOR'S NAME: OWNER State            City             
License #            License #           

ADDITIONAL PERMITS REQUIRED: Air Conditioning  Electrical  Plumbing   
Other   
IF Trac House Insert Model Number Here           

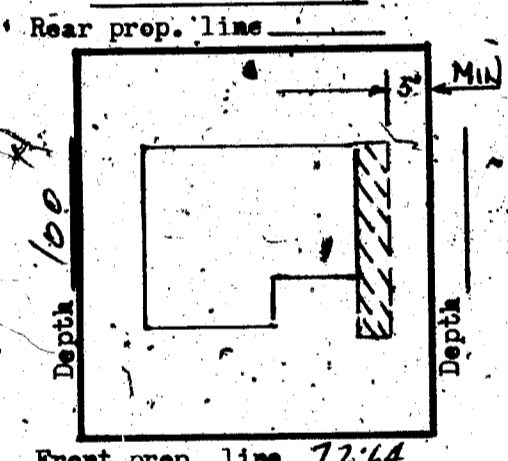

I state that I am familiar with effective Ordinances of the City of Las Vegas, Nevada and effective Statutes of the State of Nevada covering construction and use of the above type; I agree to perform said construction in conformity therewith. I further agree that issuance of a permit will not excuse me from conforming with said Ordinances and Statutes despite any errors on the part of the Building Inspector or Engineer in checking plans and applications herewith submitted.

I have read and understand the contents of above application and permit; I hereby state that same are true and correct.

SIGN HERE: Ralph K. Stanton Contractor  
BY            Agent or Owner

Front prop. line 72'64  
STREET Fulton

CUT ROOF SHADE STRUCTURE 5' FROM PROP LINE  
The Contractor's signature above denotes authority from the owner to sign in his behalf and that the owner is aware of all requirements of this application and permit. Separate permits must be obtained for all Electrical, Plumbing, Air Conditioning, Sign, Sidewalk, Paving, Curb & Gutters, Flammable Tank Storage, Incinerator & Fire Sprinkler Systems.

APPROVED BY:  
Planning Department C. P. Thomas Date: Oct 20 1966  
Engineering Department            Date:             
Building Department J. H. Replogle Date: 10-20-66  
#1285. PERMIT NO: 35311 PERMIT FEE \$ 300

156 800300  
CITY OF LAS VEGAS  
DEPT. OF  
BUILDING & SAFETY  
Must be machine validated  
21 OCT 66

D. Gatewood 5-1-79

CITY OF LAS VEGAS, NEVADA

LOG NO. & AREA

DEPARTMENT OF BUILDING & SAFETY

CONST. VAL. \$ 42000

APPLICATION & BUILDING PERMIT - for Dwellings, Duplexes, Misc. Residential Const.

ADDRESS OF CONSTRUCTION: 4301 Fulton Place

OWNER: Ralph K. Stanton

LOT(s) 146 BLOCK 0 SUBDIVISION HYDE PARK #1 ZONE R1

Existing structure on lot: Dwelling [x] Accessory bldgs. [ ] Vacant lot [ ] Other [ ]

PROPOSED CONSTRUCTION: Enclose extended patio USE: FAMILY Rm

MATERIALS OF CONSTRUCTION: Wood Frame [ ] Concrete Block [ ] Reinforced Concrete [ ] Steel Frame [ ]

SQUARE FEET OF FLOOR AREAS: 1st 2nd 3rd Other TOTAL SQ. FT. 126

FIRE ZONE: 1 2 3 Occupancy Grp A B C D E F G H I J-1-2-3-4-5 CONST. TYPE: I II III IV V

ARCHITECT: ENGINEER: NO. of UNITS NO. of STORIES

Plans Submitted: Yes [ ] No [ ] Calculations Submitted Yes [ ] No [ ] Sewer Fee Req'd. Yes [ ] No [ ]

CONTRACTOR: Owner STATE LICENSE # CITY LICENSE #

ADDITIONAL PERMITS REQ'D: Air Cond. [ ] Elec. [x] Plumbing [ ] Signs [ ] Paving [ ] Fence [ ] Public Walks [ ] Curb-gutters [ ] Incinerators [ ] Fire Sprinkling System [ ]

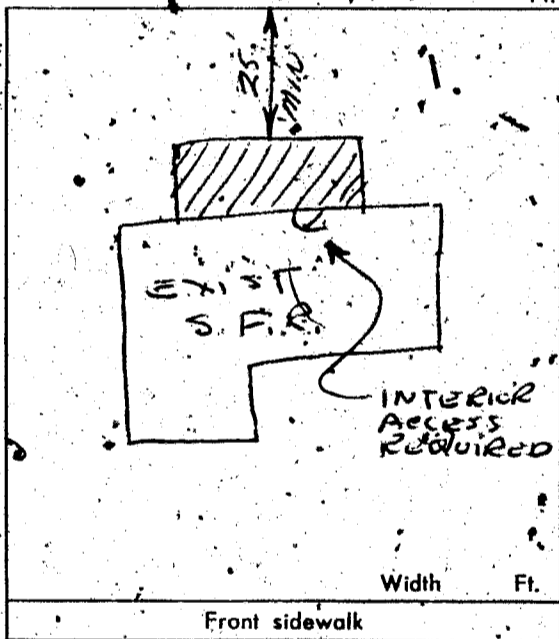

CONDITIONS OF THE PERMIT:

- 1. I agree to call the City Building Department for inspections before concrete is poured, before rough wiring, electrical, plumbing, framing is covered. Also for Air conditioning, sheet-rock and sheathing inspection.
- 2. I agree that when the job is completed that I will call for final inspection before occupancy.
- 3. I agree to perform all construction in accordance with City Ordinances and Building Codes.
- 4. The Contractor's signature below denotes authority from the owner to sign in his behalf and that the owner is aware of all requirements of this application and permit. Separate permits must be taken out for work outlined above this agreement.
- 5. I have read and understand the contents of this application and permit; I hereby state that the information I have supplied on this application is true and correct.

SIGNED: RALPH K. STANTON Contractor

BY: Ralph K. Stanton Agent or Owner

CLARK COUNTY HEALTH DEPT. Date

LAS VEGAS FIRE DEPARTMENT Date

PLANNING DEPT: [Signature] Date: 4/8/70

PUBLIC WORKS DEPT: [Signature] Date:

BUILDING DEPT: [Signature] Date: 4-8-70

#12850 PERMIT NO: 51938 PERMIT FEE \$ 700

RECEIPT 1775 \$007.00 - 8 CITY OF LAS VEGAS DEPT. OF BUILDING & SAFETY

MUST BE MACHINE VALIDATED 8 APR 70

Y. Gatewood 5-1-79

CITY OF LAS VEGAS, NEVADA

DEPARTMENT OF BUILDING & SAFETY - ELECTRICAL APPLICATION & PERMIT

ADDRESS OF CONSTRUCTION: 4301 FULTON PLACE

OWNER'S NAME: RALPH STANTON

CIRCLE: New Bldg., Add'n, Remodel TYPE OF BLDG.: (SFD.) APJ PUBLIC COMM.

CONTRACTOR'S NAME: SIMPSON & BOZARTH ELECT. INC. STATE LICENSE # 6424A CITY LICENSE # 7564

NUMBER	FIXTURE OR INSTALLATION	UNIT PRICE	
2	Fixture or sockets	.15	.30
8	Light, receptacle or switch outlet	.20	1.60
	Wall or ceiling space heater	.35	
	Base coil heater per kilowatt	.35	
	Garbage grinder outlet	.35	
	Dishwasher outlet	.35	
	Clothes dryer outlet	.35	.35
	Automatic clothes washer	.35	
	Electric range outlet	.35	
	Electric water heater outlet	.35	
	Mercury arc lamp and equipment	.35	
1	Special purpose outlet	.35	.35
	X-ray unit and its appurtenances	5.00	
	Watts of festoon lighting (Watts) First 3,000 watts	4.00	
	for each additional thousand watts	1.50	
	Horsepower - all motors first horsepower or less	1.75	
	for each additional horsepower	.35	
	Temporary power and lights (temporary pole)	4.00	
1	Electric service (including any single meter socket) for each additional socket	3.00	
	Increase to 150 AMP	.35	3.00
	Air conditioning service amps	1.50	
	Each KW (KVA) Generator (Transformer) (Welder) KW (KVA)	2.00	
	First 100 KVA - For each additional KW (KVA)	.01	
	Special inspection per-hour	4.00	
	Speaker outlets	.15	
	Signal or Alarm outlets	.15	
	Amplifiers	.50	
	Control panels	.25	
	T. V. outlets - master system only	.15	
	Radio outlets	.15	
	Main control rack	1.00	
	T. V. and Radio antennas - master system only	.75	
	Minimum fee for any permit	4.00	
	Total fee		5.60

I hereby certify that I have carefully examined and read the above application; that the same is true and correct; and that the work herein described is to be done in accordance with all the provisions of the applicable Ordinances of the City of Las Vegas, Nevada and State laws whether herein specified or not.

SIGNED William B. Simpson DATE 4-9-70  
MASTER (ELECTRICIAN) (TECHNICAL)

BUILDING DEPARTMENT J. W. [Signature] DATE 4-10-70

#12860 PERMIT NO. 30289 PERMIT FEE: \$ 5.60

RECEIPT

2021 \$005.60 - 6

CITY OF LAS VEGAS  
DEPT. OF BUILDING & SAFETY  
MUST BE MACHINE VALIDATED

10 APR 70

D. Gatewood 5-1-79

5497

CITY OF LAS VEGAS, NEVADA

LOG NO. & AREA

CONST. VAL: \$

DEPARTMENT OF BUILDING & SAFETY

APPLICATION & BUILDING PERMIT - for:

Dwellings, Duplexes, Misc. Residential Const.

ADDRESS OF CONSTRUCTION: 4301 Judson pl

OWNER: Stanton

LOT(s) BLOCK SUBDIVISION ZONE:

Existing structure on lot: Dwelling  Accessory bldgs.  Vacant lot  Other

PROPOSED CONSTRUCTION: Roofing USE:

MATERIALS OF CONSTRUCTION: Wood Frame  Concrete Block  Reinforced Concrete  Steel Frame

SQUARE FEET OF FLOOR AREAS: 1st 2nd 3rd Other TOTAL SQ. FT.

FIRE ZONE: 1 2 3 Occupancy Group A B C D E F G H I J-1-2-3-4-5 CONST. TYPE: I II III IV V

ARCHITECT: ENGINEER: NO. of UNITS NO. of STORIES

Plans Submitted: Yes  No  Calculations Submitted: Yes  No  Sewer Fee Req'd. Yes  No

CONTRACTOR: Las Vegas Roofing STATE LICENSE # CITY LICENSE #

ADD'L. PERMITS REQ'D: Air Cond.  Elec.  Plumbing  Signs  Drivng  Fence  Public Walks  Curb-gutters  Incinerators  Fire Sprinkling System

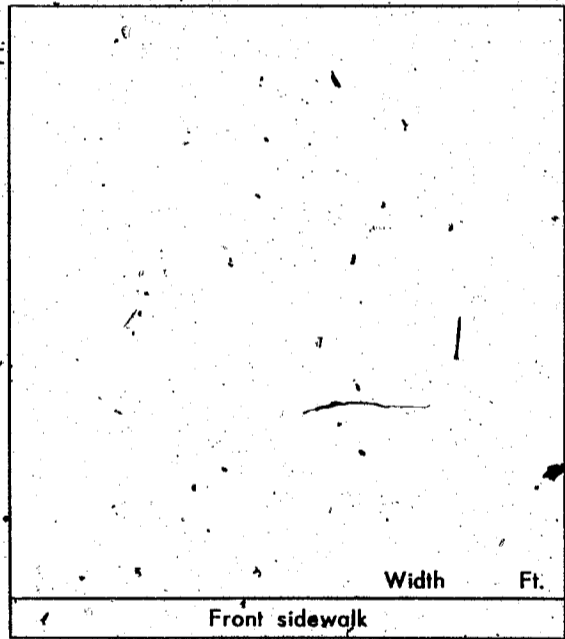

CONDITIONS OF THE PERMIT:

- 1. I agree to call the City Building Department for inspections before concrete is poured, before rough wiring, electrical, plumbing, framing is covered. Also for Air conditioning, sheet-rock and sheathing inspection.
2. I agree that when the job is completed that I will call for final inspection before occupancy.
3. I agree to perform all construction in accordance with City Ordinances and Building Codes.
4. The Contractor's signature below denotes authority from the owner to sign, in his behalf and that the owner is aware of all requirements of this application and permit. Separate permits must be taken out for work outlined above this agreement.
5. I have read and understand the contents of this application and permit; I hereby state that the information I have supplied on this application is true and correct.

SIGNED: [Signature] Contractor

BY: Agent or Owner

CLARK COUNTY HEALTH DEPT.

LAS VEGAS FIRE DEPARTMENT

PLANNING DEPT: Date:

PUBLIC WORKS DEPT: Date:

BUILDING DEPT: G. Wenz Date: 8-17-70

#12850 PERMIT NO: 54549 PERMIT FEE \$ 5.00

RECEIPT 8544 \$005.00 - 8 CITY OF LAS VEGAS DEPT. OF BUILDING & SAFETY MUST BE MACHINE VALIDATED 17 AUG 70

D. Gatewood 5/1-79

CITY OF LAS VEGAS, NEVADA  
Department of Building and Safety

### CERTIFICATE OF INSPECTION



Address 4301 Fulton Pl Owner Ralph Stanton  
Legal Lot 146 blk 6 Date 6-9-76  
Hyde Park #1

This certificate issued pursuant to the requirements of Section 306 of the UNIFORM BUILDING CODE certifying that at the time of this issuance the improvements on this property were in compliance with CITY OF LAS VEGAS, HOUSING, BUILDING, ELECTRICAL, PLUMBING and MECHANICAL CODES

DIRECTOR  
Department of Building & Safety  
William K. Fitzgerald

This Certificate does not include conditions subject to normal maintenance.

No. 240915 Fee \$ 10<sup>00</sup>

RECEIPT  
Must be machine validated  
Paid 6/1/76  
WR 7

B. Gatewood 5-1-79

MAYOR ORAN K. GRAGSON  
COMMISSIONERS  
PAUL J. CHRISTENSEN  
GEORGE E. FRANKLIN  
RON LURIE  
HAL F. MORELLI  
CITY ATTORNEY  
CARL E. LOVELL  
CITY MANAGER  
A. R. TRELEASE

# CITY OF LAS VEGAS



DEPARTMENT BUILDING & SAFETY  
BUILDING INSPECTION REPORT OF REQUIREMENTS FOR COMPLIANCE WITH CITY OF LAS VEGAS  
BUILDING CODES AND ZONING ORDINANCE

ADDRESS 4301 Fulton

OWNER \_\_\_\_\_

DATE June 8, 1976

PERMITS REQUIRED

BLDG.  Carport Illegal  
ELEC.  None  
PLBG.  ✓  
A.C.  \_\_\_\_\_

CORRECTIONS TO BE MADE

BLDG. Do Carport illegal  
ELEC. None  
PLBG. ✓  
A.C. \_\_\_\_\_  
MISC. \_\_\_\_\_

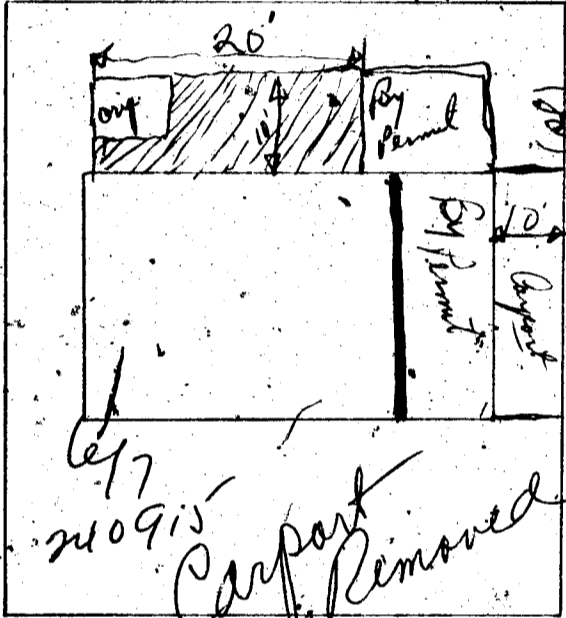

CERTIFICATE OF INSPECTION

APPROVED [Signature] DATE 6-9-76

NOT APPROVED - CALL FOR REINSPECTION. 386-6251

REMARKS Carport built illegally to P. Plan will either Remove or apply for Variance

BLDG. INSPECTOR [Signature]

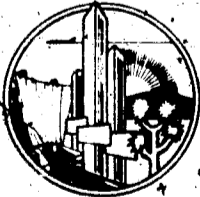

Lila Collins 2-1-82

DEPT. of BLDG & SAFETY - CITY of LAS VEGAS, NEVADA

OWNER Stanton ADDRESS 4301 Fulton Place DATE 8/17/70  
GEN. CONT. Las Vegas Roofing TYPE OF STRUCTURE reroof  
PERMIT NO. 54549 LEGAL DESCRIPTION

BUILDING		MECHANICAL		ELECTRICAL	
LOCATION		PLUMBING CONT.		TEMP. POLE CONT.	
FIREPLACE FTS.		PERMIT NO.	DATE	PERMIT NO.	DATE
FOOTINGS		HEAT & VENT. AC CONT.		INSPECTION	DATE
FOUNDATION WALL		PERMIT NO.	DATE	ELECTRICAL CONT.	
FLOOR FRAMING		SEWER CONT.		PERMIT NO.	DATE
SLAB		PERMIT NO.	DATE	FIXTURES CONT.	
CHIMNEY STEEL (FIREPLACE)		ROUGH SOIL		PERMIT NO.	DATE
WALL STEEL		ROUGH WATER		SLAB	
COLUMN STEEL		TOP-OUT		ROUGH	
BEAM STEEL		ROUGH GAS		FINAL ROUGH	
FRAMING		AC ROUGH DUCT		FINAL FIXTURE	
ROOF SHEATHING		REF. ROUGH PIPING		FINAL ELECTRICAL	
	INTERIOR	EXTERIOR		TEMPORARY SERVICE	
DRYWALL		FINAL PLUMBING			
LATHING		FINAL GAS			
BACKING (SIDING)		FINAL AIR COND.			
PLASTER SCRATCH		FINAL REFRIG.			
PLASTER BROWN		FINAL SEWER			
URBAN REDEVELOPMENT APPROVAL		FINAL SEPTIC TANK			
FINAL BLDG.					

APPROVED FOR OCCUPANCY & METER PS 12-7-70 INSPECTOR DATE

PLEASE NOTE REMARKS ON REVERSE SIDE 4301 Fulton Place LOG: # AREA: # 23.04

DEPT. of BLDG & SAFETY - CITY of LAS VEGAS, NEVADA

OWNER Ralph K. Stanton ADDRESS 4301 Fulton Place DATE 10/20/66  
GEN. CONT. Owner TYPE OF STRUCTURE Remove shade to 5' of prop. line  
PERMIT NO. 35311 LEGAL DESCRIPTION Lot 146, Hyde Park

BUILDING		MECHANICAL		ELECTRICAL	
LOCATION		PLUMBING CONT.		TEMP. POLE CONT.	
FIREPLACE FTS.		PERMIT NO.	DATE	PERMIT NO.	DATE
FOOTINGS		HEAT & VENT. AC CONT.		INSPECTION	DATE
FOUNDATION WALL		PERMIT NO.	DATE	ELECTRICAL CONT.	
FLOOR FRAMING		SEWER CONT.		PERMIT NO.	DATE
SLAB		PERMIT NO.	DATE	FIXTURES CONT.	
CHIMNEY STEEL (FIREPLACE)		ROUGH SOIL		PERMIT NO.	DATE
WALL STEEL		ROUGH WATER		SLAB	
COLUMN STEEL		TOP-OUT		ROUGH	
BEAM STEEL		ROUGH GAS		FINAL ROUGH	
FRAMING		AC ROUGH DUCT		FINAL FIXTURE	
ROOF SHEATHING		REF. ROUGH PIPING		FINAL ELECTRICAL	
	INTERIOR	EXTERIOR		TEMPORARY SERVICE	
DRYWALL		FINAL PLUMBING			
LATHING		FINAL GAS			
BACKING (SIDING)		FINAL AIR COND.			
PLASTER SCRATCH		FINAL REFRIG.			
PLASTER BROWN		FINAL SEWER			
URBAN REDEVELOPMENT APPROVAL		FINAL SEPTIC TANK			
FINAL BLDG.					

APPROVED FOR OCCUPANCY & METER C.H.S. 10-66 INSPECTOR DATE

PLEASE NOTE REMARKS ON REVERSE SIDE 4301 Fulton Place LOG: # AREA: # 23.04

Lula Collins 2-1-82

DEPT. of BLDG. & SAFETY - CITY of LAS VEGAS, NEVADA  
OWNER: RALPH STANTON ADDRESS: 4301 Fulton Place DATE: 11/26/58  
GEN. CONT. OWNER TYPE OF STRUCTURE STORAGE BLDG. 8x10  
PERMIT NO. 32201 LEGAL DESCRIPTION:

LOCATION & FLOOR/ELEVATION	PLUMBING CONT. PERMIT NO. DATE	TEMP. POLE CONT. PERMIT NO. DATE
FOOTINGS	HEAT & VENT. CONT. PERMIT NO. DATE	INSPECTION DATE
FOUND. & PIERS	SEWER CONT. PERMIT NO. DATE	ELECTRICAL CONT. PERMIT NO. DATE
WALL STEEL	ROUGH SOIL	OUTLETS
BOND BEAM STEEL	ROUGH WATER	MOTORS H.P.
FRAMING & ROOF SHEATHING	SEWER OR SEPTIC TANK	SLAB
STEEL FABRICATION	TOP-OUT	ROUGH
CONNECTIONS & PAINTING	ROUGH GAS	FINAL ROUGH
INTERIOR EXTERIOR	ROUGH DUCT	FIXTURE CONT. PERMIT NO. DATE
LATHING	FINAL PLUMBING	FIXTURES
PLASTER	FINAL HEATING	FINAL FIXTURE
SCRATCH	FINAL GAS	APPROVED FOR METER
BROWN		
FINAL BLDG. 4-6-59		
GRADING & DRAINAGE		
ON-SITE PARKING SPACES		
ENG. APPROVAL OF OFF-SITE IMPROVEMENTS		

APPROVED for OCCUPANCY: INSPECTOR DATE  
\* PLEASE NOTE REMARKS ON REVERSE SIDE  
4301 Fulton Place STORAGE BLDG. 8x10 11/26/58 23.04

DEPT. of BLDG. & SAFETY - CITY of LAS VEGAS, NEVADA  
OWNER: Ralph Stanton ADDRESS: 4301 Fulton Place DATE: 4/8/70  
GEN. CONT. Owner TYPE OF STRUCTURE Eng. Patio  
PERMIT NO. 51038 LEGAL DESCRIPTION L 116 R 6 Hyde Park #1

BUILDING	MECHANICAL	ELECTRICAL
LOCATION	PLUMBING CONT. PERMIT NO. DATE	TEMP. POLE CONT. PERMIT NO. DATE
FIREPLACE FTG.	HEAT & VENT. AC CONT. PERMIT NO. DATE	INSPECTION DATE
FOOTINGS	SEWER CONT. PERMIT NO. DATE	ELECTRICAL CONT. Simpson Board DATE 4-18-76
FOUNDATION WALL	ROUGH SOIL	PERMIT NO. 30289 DATE 4-18-76
FLOOR FRAMING	ROUGH WATER	FIXTURES CONT. PERMIT NO. DATE
SLAB	TOP-OUT	SLAB
CHIMNEY STEEL (FIREPLACE)	ROUGH GAS	ROUGH 2nd-10-70
WALL STEEL	AC ROUGH DUCT	FINAL ROUGH
COLUMN STEEL	REF. ROUGH PIPING	FINAL FIXTURE
BEAM STEEL	FINAL PLUMBING	FINAL ELECTRICAL
FRAMING	FINAL GAS	TEMPORARY SERVICE
ROOF SHEATHING	FINAL AIR COND.	MISCELLANEOUS
INTERIOR EXTERIOR	FINAL REFRIG.	GRADING & DRAINAGE
DRYWELL	FINAL SEWER	ON-SITE PARKING SPACES APP
LATHING	FINAL SEPTIC TANK	ENG. APPROVAL OF OFF-SITE IMPROVEMENTS
BACKING (SIDING)		
PLASTER		
SCRATCH		
BROWN		
URBAN REDEVELOPMENT APPROVAL		
FINAL BLDG. DATE		

APPROVED FOR OCCUPANCY & METER HB 9-9-70 INSPECTOR DATE  
PLEASE NOTE REMARKS ON REVERSE SIDE 4301 Fulton Place LOG # AREA # 23.04

Lula Collins 2-1-32

DEPT. of BLDG. & SAFETY - CITY of LAS VEGAS, NEVADA  
OWNER: RALPH STANTON ADDRESS: 4301 Fulton St. DATE: 10/20/58  
GEN. CONT. R. J. GORDON CONSTR. CO. TYPE OF STRUCTURE: ENCLOSE CARPORT  
PERMIT NO. 31896 LEGAL DESCRIPTION: Lot 146, Bl. 6, Hyde Park #1.

LOCATION & FLOOR ELEVATION	PLUMBING CONT. _____ DATE _____	TEMP. POLE CONT. _____ DATE _____
FOOTINGS	PERMIT NO. _____ DATE _____	PERMIT NO. _____ DATE _____
FOUND. & PIERS	HEAT & VENT. CONT. _____ DATE _____	INSPECTION _____ DATE _____
WALL STEEL	PERMIT NO. _____ DATE _____	ELECTRICAL CONT. FITZGERALD ELEC. PERMIT NO. 23050 DATE 10/21/58
BOND BEAM STEEL	SEWER CONT. _____ DATE _____	PERMIT NO. _____ DATE _____
FRAMING & ROOF SHEATHING	PERMIT NO. _____ DATE _____	OUTLETS _____ Min. _____
STEEL FABRICATION	ROUGH SOIL _____	MOTORS _____ H.P. _____
CONNECTIONS & PAINTING	ROUGH WATER _____	SLAB _____
INTERIOR _____ EXTERIOR _____	SEWER OR SEPTIC TANK _____	ROUGH _____
LATHING _____	TOP-OUT _____	FINAL ROUGH J.O. 10/22/58
PLASTER _____	ROUGH GAS _____	FIXTURE CONT. _____ DATE _____
SCRATCH _____	ROUGH DUCT _____	PERMIT NO. _____ DATE _____
BROWN _____	FINAL PLUMBING _____	FIXTURES _____
FINAL BLDG. Walter 10-30-58	FINAL HEATING _____	FINAL FIXTURE _____
GRADING & DRAINAGE	FINAL GAS _____	APPROVED FOR METER: [Signature] 2/26/59
ON-SITE PARKING _____ SPACES _____		
ENG APPROVAL OF OFF-SITE IMPROVEMENTS		

APPROVED for OCCUPANCY: \_\_\_\_\_ INSPECTOR \_\_\_\_\_ DATE \_\_\_\_\_

\* PLEASE NOTE REMARKS ON REVERSE SIDE

4301 Fulton St. ENCLOSE CARPORT 10/20/58

23.04

DEPARTMENT OF BUILDING & SAFETY  
CITY OF LAS VEGAS, NEVADA

KARDEX CARD  
FENCE & RETAINING WALLS

OWNER Ralph Stanton ADDRESS 4301 Fulton DATE 2/3/69

CONTRACTOR McKinley PERMIT NO. 45821

LOT 146 BLOCK 6 SUBDIVISION Hyde Park #1 Wire

Fence (wire, wood, etc.)	Walls (masonry, rock, etc.)
Location _____	Location _____
Final Inspection 2-3-14-69	Footings _____
	Wall Steel 1st _____ 2d _____ 3d _____
	Final Inspection _____
Retaining Wall (masonry)	Retaining Wall (concrete)
Location _____	Location _____
Footings _____	Footings _____
Wall Steel 1st _____ 2d _____ 3d _____	Wall Steel 1st _____ 2d _____ 3d _____
Bond Beam 1st _____ 2d _____ 3d _____	Final Inspection _____
Final Inspection _____	

23.14 B ADDRESS 4301 Fulton LOG NO. \_\_\_\_\_ AREA \_\_\_\_\_