

601 Fandwood Lane

L-71 B- Sub Cimmarro West Z\_-P.D.9

*Maron Pereira May 16, 1979*

# CITY OF LAS VEGAS, NEVADA

LOG NO. & AREA T-35-3 CONST. VAL. \$ 36,270  
DEPARTMENT OF PUBLIC SERVICES APPLICATION & BUILDING PERMIT - for:  
DIVISION OF BUILDING AND SAFETY Dwellings, Duplexes, Misc. Residential Const.

ADDRESS OF CONSTRUCTION: 601 Fandwood Lane OWNER: Arkco Development Inc.

LOT(S) 71 BLOCK \_\_\_\_\_ SUBDIVISION: Cinarron West ZONE: R-PO9

Existing structure on lot: Dwelling  Accessory Bldgs.  Vacant Lot  Other

PROPOSED CONSTRUCTION: Single family dwelling USE: Residence

MATERIALS OF CONSTRUCTION: Wood Frame  Concrete Block  Reinforced Concrete  Steel Frame

SQUARE FEET OF FLOOR AREAS: 1st 1601 2nd \_\_\_\_\_ 3rd \_\_\_\_\_ Other 430 TOTAL SQ. FT. 2031

FIRE ZONE: 3 Occupancy Group R-3 + MI CONST. TYPE: V-N

ARCHITECT: Keith Farris ENGINEER: Alca Engineering NO. of UNITS: 1 NO. of STORIES: 1

Plans Submitted: Yes  No  Calculations Submitted: Yes  No  Sewer Fee Req'd: Yes  No

CONTRACTOR: Arkco Development Inc. STATE LICENSE # 15213 CITY LICENSE # C1102879

ADD'L. PERMITS REQ'D: Air Cond.  Elec.  Plumbing  Signs  Paving  Fence  Public Walks  Curb gutters   
Incinerators  Fire Sprinkling System

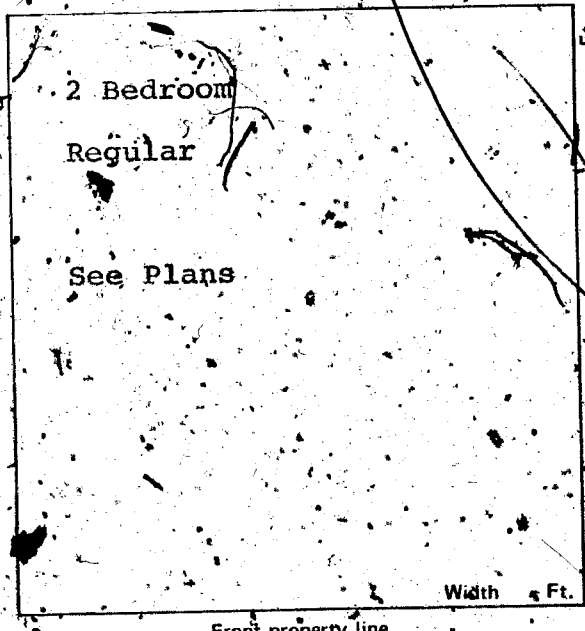

### CONDITIONS OF THE PERMIT:

1. I agree to call the City Building Department for inspections before concrete is poured, before rough wiring, electrical, plumbing, framing is covered. Also for Air conditioning, drywall and sheathing inspection.
2. I agree that when the job is completed that I will call for final inspection before occupancy.
3. I agree to perform all construction in accordance with City Ordinances and Building Codes.
4. The Contractor's signature below denotes authority from the owner to sign in his behalf and that the owner is aware of all requirements of this application and permit. Separate permits must be taken out for work outlined above this agreement.
5. I have read and understand the contents of this application and permit. I hereby state that the information I have supplied on this application is true and correct.

Approval for work under this permit will be given only after refuse and debris has been removed from job site and public right of way.

SIGNED: \_\_\_\_\_ Contractor  
BY: \_\_\_\_\_ Agent or Owner

PLANNING DEPT. \_\_\_\_\_ Date: 9/12/78  
PUBLIC WORKS DEPT. \_\_\_\_\_ Date: 9-15-78  
BUILDING DIVISION: \_\_\_\_\_ Date: 9-18-78  
PERMIT NO.: 9826-18-37 PERMIT FEE \$ 151.50

RECEIPT  
MUST BE MACHINE VALIDATED

154-01-220

*Maaron Beretta Day 11/14/79*

*601 Sandwood*

**CITY OF LAS VEGAS, NEVADA**

**DEPARTMENT OF PUBLIC SERVICES—APPLICATION AND PERMIT FOR PLUMBING  
DIVISION OF BUILDING AND SAFETY**

ADDRESS OF CONSTRUCTION: *601 Sandwood* OWNER'S NAME: *Arco Realty*

CIRCLE: New Bldg. Add'n.; Remodel; TYPE OF BLDG.: SFD. APT. PUBLIC COMM.

CONTRACTOR'S NAME: *Tom & Loretta Kelly* STATE LICENSE # *119780* CITY LICENSE # *14013*

| UNITS                  | DESCRIPTION   | FEE   | TOTAL |
|------------------------|---|-------|-------|
| 2                      | Bathtub   | 1.00  | 2.00  |
| 1                      | Shower  | 1.00  | 1.00  |
| 2                      | Lavatory  | 1.00  | 2.00  |
| 2                      | Toilet  | 1.00  | 2.00  |
|                        | Urinal  | 1.00  |       |
|                        | Floor Drain   | 1.00  |       |
|                        | Floor Sink  | 1.00  |       |
|                        | Wash Tray   | 1.00  |       |
| 1                      | Sink  | 1.00  |       |
| 1                      | Garbage Disposal                                    | 1.00  |       |
|                        | Garbage Disposal (comm.)                            | 3.00  |       |
|                        | Clothes Dryer (gas)                                 | 1.00  |       |
|                        | Clothes Washer                                      | 1.00  |       |
|                        | Clothes Washer (comm.)                              | 5.00  |       |
| 1                      | Dishwasher  | 1.00  |       |
|                        | Dishwasher (commercial)                             | 5.00  |       |
|                        | Dental Unit   | 10.00 |       |
|                        | Drinking Fountain                                   | 1.00  |       |
|                        | Any Water using Equipment                           | 1.00  |       |
|                        | Water Heater (gas) (elect.)                         | 1.00  |       |
| 1                      | Sewer Main—New, Replacement, or any Drainage System | 4.00  |       |
|                        | Grease or Sand Trap                                 | 2.00  |       |
|                        | Traylor Trap  | 2.00  |       |
|                        | Septic Disposal System                              | 4.00  |       |
| <b>WATER SOFTENERS</b> |   |       |       |
|                        | Nonpermanent Type                                   | 4.00  |       |
|                        | Permanent Type (connected to Drainage)              | 5.00  |       |
| <b>SWIMMING POOLS</b>  |   |       |       |
|                        | Private or Wading Pool                              | 10.00 |       |
|                        | Public or Semi public                               | 20.00 |       |

| UNITS  | DESCRIPTION                               | FEE           | TOTAL |
|--|---|---------------|-------|
| <b>WATER DISTRIBUTION SYSTEM</b>               |   |               |       |
|  | Single Family Dwelling                    | 4.00          |       |
|  | Multiple Family Dwelling plus each unit   | 4.00<br>2.00  |       |
|  | Commercial Bldg. per floor                | 6.00          |       |
|  | Hotel or Motel plus each bath             | 4.00<br>1.50  |       |
|  | Trailer Park plus each space              | 20.00<br>1.00 |       |
|  | Irrigation                                | 4.00          |       |
| <b>GAS PIPING SYSTEM</b>                       |   |               |       |
|  | Single Family Dwelling                    | 3.00          |       |
|  | Multiple Family Dwelling plus each unit   | 6.00<br>1.00  |       |
|  | Commercial Bldg. per floor plus each unit | 3.00<br>3.00  |       |
|  | Gas Appliance (any type)                  | 1.00          |       |
| <b>AUTOMATIC FIRE EXTINGUISHING SYSTEM</b>     |   |               |       |
|  | Underground Piping                        | 10.00         |       |
|  | Distribution Piping ea. ft.               | .01           |       |
|  | Sprinkler Head each                       | .10           |       |
|  | In Range Hood and Vent                    | 5.00          |       |
| <b>DRY STANDPIPE SYSTEM</b>                    |   |               |       |
|  | Piping                                    | 50.00         |       |
|  | Each Outlet                               | 1.00          |       |
| <b>WET STANDPIPE SYSTEM</b>                    |   |               |       |
|  | Piping                                    | 5.00          |       |
|  | Fire Hose Cabinet                         | 1.00          |       |
|  | <b>MINIMUM PERMIT FEE</b>                 | 4.00          |       |
| <b>PIPELINE CONTRACTOR; SECT. 14-B P.F. \$</b> |   |               |       |
| <b>TOTAL PERMIT FEE \$</b>                     |   |               |       |

I hereby certify that I have carefully examined and read the above application, that the same is true and correct, and that the work herein described is to be done in accordance with all the provisions of the applicable Ordinances of the City of Las Vegas, Nevada and the State Laws, whether herein specified or not.

Approval for the work under this permit will be given only after refuse and debris have been removed from job site and public right of way.

Signed: *William Bonhoff* Date: *9/29/78*  
Registered Master Plumber, Spec. Contr. or Owner

Building Division: *B.D.* Date: *9-29-78*

Permit No. *9859-15* Permit Fee \$ *23.00*

154-01-222

**RECEIPT**

MUST BE MACHINE VALIDATED

Marion Brown May 16, 1979

# CITY OF LAS VEGAS, NEVADA

## DEPARTMENT OF PUBLIC SERVICES—ELECTRICAL APPLICATION & PERMIT DIVISION OF BUILDING AND SAFETY

ADDRESS OF CONSTRUCTION: 601 Fandwood Lane OWNER'S NAME: Asko

CIRCLE: New Bldg; Add'n.; Remodel; TYPE OF BLDG.: SFD. APT. PUBLIC COMM.

CONTRACTOR'S NAME: Southern Electric Co. STATE LICENSE # 9290A CITY LICENSE #

| NUMBER | FIXTURE OR INSTALLATION  | UNIT PRICE   | TOTAL        |
|--------|--|--------------|--------------|
|        | Rm addition, carport or garage enclosure   | 4.00         |              |
|        | Temporary power  | 4.00         |              |
| 53     | Light, receptacle or switch outlet   | .20          | 10.60        |
|        | Wall or ceiling space heater   | .35          |              |
| 1      | Garbage grinder outlet   | .35          | .35          |
| 1      | Dishwasher outlet  | .35          | .35          |
|        | Clothes dryer outlet   | .35          |              |
| 1      | Automatic clothes washer   | .35          | .35          |
|        | Electric range outlet  | .35          |              |
|        | Electric water heater outlet   | .35          |              |
|        | Special purpose outlet   | .35          |              |
|        | X-ray unit and its appurtenances   | 5.00         |              |
|        | Watts of festoon lighting (Watts) First 3,000 watts for each additional thousand watts | 4.00<br>1.50 |              |
|        | Horsepower each motor first horsepower or less for each additional horsepower          | 1.75<br>.35  |              |
| 1      | Electric service (including any single meter socket) for each additional socket        | 3.00<br>.35  | 3.00         |
|        | Air conditioning service   | 1.50         |              |
|        | Each KW(KVA) Generator (Transformer, Welder) First 100 KVA for each additional KW(KVA) | 2.00<br>.01  |              |
|        | Speaker, signal or alarm outlet  | .15          |              |
|        | Amplifiers   | .50          |              |
|        | Control panels   | .25          |              |
|        | Main control racks   | 1.00         |              |
|        | T.V. and radio antennas-master system only   | .75          |              |
|        | Minimum fee for any permit   | 4.00         |              |
|        | <b>TOTAL FEE</b>   |              | <b>14.65</b> |

Approval for the work under this permit will be given only after refuse and debris have been removed from job site and public right of way.

I hereby certify that I have carefully examined and read the above application; that the same is true and correct; and that the work herein described is to be done in accordance with all the provisions of the applicable Ordinances of the City of Las Vegas, Nevada and State laws whether herein specified or not.

SIGNED Riley Hovey DATE 12-7-78  
 MASTER (ELECTRICIAN) (TECHNICIAN) (OWNER)

BUILDING DIVISION: WR7 DATE 12/8/78

PERMIT NO. 1144442 PERMIT FEE \$ 14.65

RECEIPT

MUST BE MACHINE VALIDATED

*Maron Perera May 16, 1979*

**CITY OF LAS VEGAS, NEVADA**

**DEPARTMENT OF PUBLIC SERVICES — AIR CONDITIONING APPLICATION & PERMIT**  
 DIVISION OF BUILDING AND SAFETY

ADDRESS OF CONSTRUCTION: 601 Fandwood Lane OWNER'S NAME: Fred Ahlstrom Construction

CIRCLE: Addition; Remodel; New Bldg. TYPE OF BLDG.: SFD APT. COMM. PUBLIC

CONTRACTOR'S NAME: Quality Air Conditioning STATE LICENSE # 10867A CITY LICENSE # C11766-200-577

| UNITS | DESCRIPTION  | FEE   | TOTAL | UNITS | DESCRIPTION   | FEE   | TOTAL        |
|-------|--|-------|-------|-------|---|-------|--------------|
|       | Unit heater — floor, wall or suspended   | 4.00  |       |       | <b>EVAPORATIVE COOLERS:</b>   |       |              |
|       | FOR EACH FORCED-AIR OR GRAVITY-TYPE FURNACE OR BURNER INCLUDING DUCTS AND VENT ATTACHED TO SUCH APPLIANCES:                              |       |       |       | 5 outlets or under  | 3.00  |              |
|       | Up to and including 100,000 B.t.u.'s   | 4.00  |       |       | Over 5 and up to and including 10   | 5.00  |              |
|       | Over 100,000 B.t.u.'s  | 6.00  |       |       | Each additional outlet over 10  | .25   |              |
|       | FOR EACH HEATING APPLICATION, REFRIGERATION UNIT, COMFORT COOLING AND HEATING UNIT, ABSORPTION UNIT, COMPRESSOR OR BOILER:               |       |       |       | <b>VENTILATION:</b>   |       |              |
|       | Up to and including 3-ton or horsepower, or absorption system up to and including 100,000 B.t.u.'s                                       | 4.00  |       |       | For each fan connected to a single duct   | 1.00  |              |
|       | Over 3 ton or 3 horsepower up to and including 10, or absorption system over 100,000 B.t.u.'s up to and including 250,000 B.t.u.'s       | 7.00  | 7.00  |       | For each commercial or industrial ventilation system  | 5.00  |              |
|       | Over 10 ton or 10 horsepower up to and including 30, or absorption system over 250,000 B.t.u.'s up to and including 1,000,000 B.t.u.'s   | 12.00 |       |       | For each commercial kitchen hood  | 5.00  |              |
|       | Over 30 ton or 30 horsepower up to and including 50, or absorption system over 1,000,000 B.t.u.'s up to and including 1,700,000 B.t.u.'s | 20.00 |       |       | <b>MISCELLANEOUS:</b>   |       |              |
|       | Over 50 ton or 50 horsepower, or absorption system over 1,700,000 B.t.u.'s   | 30.00 |       |       | For each water cooling tower  | 8.00  |              |
|       | FOR EACH AIR HANDLING UNIT INCLUDING DUCTS ATTACHED THERETO:   |       |       |       | Duct work only — each opening   | .25   | 50           |
|       | Up to and including 10,000 CFM   | 2.00  |       |       | For installation or relocation of each commercial or industrial incinerator   | 15.00 |              |
|       | Over 10,000 CFM  | 4.00  |       |       | Gas piping related to the air cond. work in family dwelling only  | 3.00  |              |
|       |  |       |       |       | For each appliance, piece of equipment, any mechanical work, or alteration or replacement not included in this schedule, the permit fee shall be computed the same as building permit fees using the cost of installation for the valuation amount. |       |              |
|       |  |       |       |       | <b>FOR THE ISSUANCE OF EACH PERMIT</b>  |       | 3.00         |
|       |  |       |       |       | <b>TOTAL PERMIT FEE \$</b>  |       | <b>10.50</b> |

I hereby certify that I have carefully examined and read the above application; that the same is true and correct; and that the work herein described is to be done in accordance with all the provisions of the applicable Ordinances of the City of Las Vegas, Nevada and the State Laws whether herein specified or not.

Approval for the work under this permit will be given only after refuse and debris have been removed from job site and public right of way.

SIGNED Alvin Baillie Date 2/28/79  
 Air Conditioning Contractor - Owner

BUILDING DIVISION PLS Date 2/28/79

PERMIT NO. 1531-11 PERMIT FEE \$ 10.50

154-01-224

#12890

RECEIPT

MUST BE MACHINE VALIDATED

OWNER Arkco Dv. Inc. - ADDRESS 601 Sandwood Ln  
 DATE 9-28-78 GEN. CONT. Same  
 TYPE OF STRUCTURE SFD 9826-12 PERMIT NO. FINAL INSPECTION  
 LEGAL DESCRIPTION L-71 Cimarron Rd. T-35 AREA # 3  
 Z-38-73  
 APPROVED FOR OCCUPANCY & METER

| BUILDING                                      | MECHANICAL                                    |
|---|---|
| Investigation                                 | Plumbing Cont. <i>from abnity</i>             |
| Location & Footing <i>OK 9-2-78</i>           | Permit No. <i>9854-15</i> Date <i>9-24-78</i> |
| Concrete Slab Floor <i>OK 6-17-78</i>         | Heat & Vent. A/C Cont. <i>Quality</i>         |
| Fireplace Footing                             | Permit No. <i>1531-11</i> Date <i>7-28-79</i> |
| Chimney Steel                                 | Sewer Cont. <i>Approved</i>                   |
| Vert. Steel Reinf.                            | Permit No. <i>9826</i> Date                   |
| Horiz. Steel Reinf.                           | Rough Soil <i>ME 10-4-78</i>                  |
| Framing <i>OK 5-14-79</i>                     | Rough Water                                   |
| Ext. Lath                                     | Top-Out <i>ME 12-13-78</i>                    |
| Ext. Brown                                    | Rough Gas <i>ME 4-13-78</i>                   |
| Drywall <i>OK 3-20-79</i>                     | A/C Rough Duct <i>ME 1-4-79</i>               |
| Final Building <i>FC 6-1-79</i>               | Final Plumbing <i>ME 2-21-79</i>              |
| Appr. for Occu.                               | Final Gas <i>ME 5-21-79</i>                   |
| ELECTRICAL                                    | Final Air Cond. <i>ME 5-21-79</i>             |
| Temp. Pole Cont.                              | Final Sewer <i>ME 1-9-79</i>                  |
| Permit No. Date.                              | REMARKS                                       |
| Inspection Date                               |   |
| Electrical Cont. <i>Southern</i>              |   |
| Permit No. <i>1444-12</i> Date <i>12-8-78</i> |   |
| Rough <i>OK 2-9-79</i>                        |   |
| Final Rough                                   |   |
| Final Electrical <i>JO 5-30-79</i>            |   |
| Temporary Service                             |   |

PLEASE NOTE ADDITIONAL REMARKS ON REVERSE SIDE.  
 DIV. OF BLDG. & SAFETY  
 CITY OF LAS VEGAS  
 REV. 10-78  
 89-3-16

1-15-78

Roof. Sheathing 11-15-78  
Insulation 12-3-79  
Per # 9826-12