

4201 El Camino Ave

L91 B6 Las Verdes Unit 2 Zone R-1

A. Date: 3-26-74

PERMIT FEE: \$ 3.00

CITY OF LAS VEGAS, NEVADA  
DEPARTMENT OF BUILDING & SAFETY  
APPLICATION & BUILDING PERMIT  
for FENCE, WALL, RETAINING WALL

CONSTRUCTION VALUATION: \$ 50.00  
INSPECTION VALUATION: \$

ADDRESS OF CONSTRUCTION: 4201 Clearview OWNER'S NAME: Julia Congliaro OWNER'S ADDRESS: 4201 Clearview

Lot (s) 91 Block 6 Subdivision Las Vegas Blvd 2 Zone R-1

Materials of Construction: Concrete Block ( ) Concrete ( ) Wire ( ) Wood ( ) Other ( )

Total Square Feet: Total Lineal Feet 50 FT.

CONTRACTOR'S NAME: chista STATE LICENSE # 5926 CITY LICENSE # 3787

Architect's Name: PLANS SUBMITTED: Yes No  
Engineer's Name: CALCULATIONS: Yes No

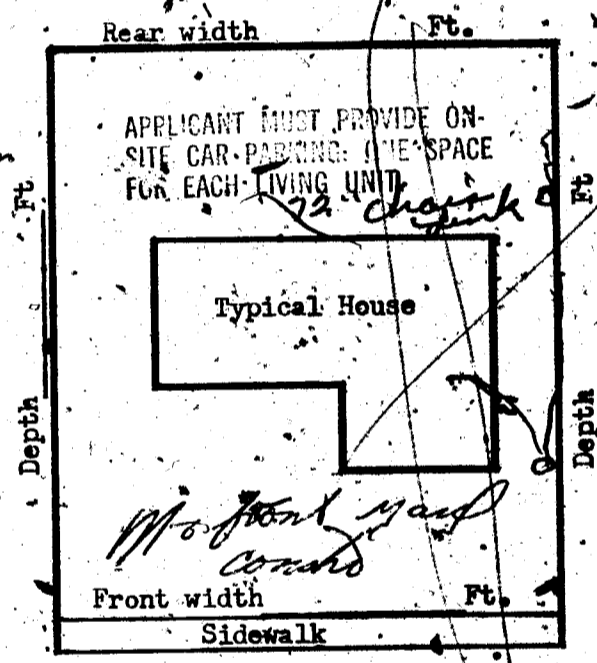

I understand that any portion of this (fence) (wall) constructed or erected on City property or right-of-way will be removed from said location at my expense upon request received from the City of Las Vegas, Nevada. I understand that the (fence) (wall) shall not enclose water meter, light standard, fire alarm box & shall not come closer than two (2) feet in any direction from any fire hydrant. I further state that I am familiar with effective Ordinances, of the City of Las Vegas, Nevada & effective Statutes of the State of Nevada covering construction and use of the above type; I agree to perform said construction in conformity therewith. I further agree that issuance of a permit on above application will not excuse me from conforming with said Ordinances and Statutes; despite any errors on the part of the Building Inspector or Engineer, in checking plans and applications herewith submitted. I have read and understand the contents of above application & permit; I hereby state that same are true and correct.

SIGN HERE: chista Date: By:

APPROVED BY: [Signature] DATE: 4/21/67

PLANNING DEPT. & CODE ASSISTANCE DATE

FIRE DEPARTMENT DATE

ENGINEERING DEPARTMENT DATE

BUILDING & SAFETY DEPARTMENT DATE: 2-21-67

#1285 PERMIT NO. 36178 PERMIT FEE \$ 3.00

RECEIPT  
014 \$003.00 - 8  
CITY OF LAS VEGAS  
DEPT. OF BUILDING & SAFETY  
Must be machine validated  
21 FEB 67

J. Dated 3-26-70

1970

PERMIT FEE \$ \_\_\_\_\_

CITY OF LAS VEGAS, NEVADA  
DEPARTMENT OF BUILDING & SAFETY  
APPLICATION & PERMIT FOR  
SWIMMING POOL

CONSTRUCTION  
VALUATION: \$ 2000  
INSPECTION  
VALUATION: \$ \_\_\_\_\_

LOG NO. & AREA M-88

ADDRESS OF CONSTRUCTION: 4201 EL CAMINO OWNER'S NAME: Julius Conigliaro

LOT (s) 7 / BLOCK 6 SUBDIVISION LAS VERDES HGTS UNIT 2 ZONE R-1

CIRCLE TYPE OF POOL THAT APPLIES:  PRIVATE  SEMI-PUBLIC  PUBLIC

MATERIALS OF CONSTRUCTION: Reinforced Gunite  Reinforced Concrete  Other

SQUARE FEET OF SURFACE AREA: \_\_\_\_\_

ARCHITECT'S NAME: \_\_\_\_\_ ENGINEER'S NAME: \_\_\_\_\_

PLANS SUBMITTED: Yes  No  CALCULATIONS SUBMITTED: Yes  No

CONTRACTOR'S NAME: \_\_\_\_\_ State \_\_\_\_\_ City \_\_\_\_\_ License # \_\_\_\_\_ License # \_\_\_\_\_

ADDITIONAL PERMITS REQUIRED: Electrical  Plumbing  Other

I state that I am familiar with effective Ordinances of the City of Las Vegas Nevada and effective Statutes of the State of Nevada covering construction and use of above type; I agree to perform said construction in conformity therewith. I further agree that issuance of a permit on above application will not excuse me from conforming with said Ordinances and Statutes despite any errors on the part of the Building Inspector or Engineer in checking plans and application herewith submitted.

All swimming pools must be fenced before the pool is filled with water. No electric lines shall go over a pool. I have read and understand the contents of above application; I hereby state that same are true and correct.

SIGN HERE: \_\_\_\_\_  
BY: Julius Conigliaro (Contractor)  
(Agent or Owner)

The Contractor's signature above denotes authority from the owner to sign on his behalf and that the owner is aware of all requirements of this application. Separate permits must be obtained for all electrical and plumbing work.

**CITY SWIMMING POOL ORDINANCE:**  
Applicant must have separate plot plan showing location of power pole, proposed or existing pool fencing and location of swimming pool.

APPROVED BY:  
PLAN. DEPT. M.C. DATE: 3-11-70  
ENG. DEPT. \_\_\_\_\_ DATE: \_\_\_\_\_  
HEALTH DEPT. \_\_\_\_\_ DATE: \_\_\_\_\_

Sewer Conn. Fee: \$ \_\_\_\_\_  
(Eng. Dept)

BUILDING DEPARTMENT: H.T. Poldo DATE: \_\_\_\_\_  
#12850 PERMIT NO. 51459 PERMIT FEE: 18.50

RECEIPT  
286 \$018.00 - 8  
CITY OF LAS VEGAS  
DEPT. OF BUILDING & SAFETY  
Must be machine validated  
11 MAR 70

J. Entwined 3-26-79

CITY OF LAS VEGAS, NEVADA  
DEPARTMENT OF BUILDING & SAFETY

RECEIPT  
FOR  
SEWER CONNECTION FEE

JOB ADDRESS: 4701 El Camino OWNER'S NAME: Julius Conditore

LOT \_\_\_\_\_ BLOCK \_\_\_\_\_ SUBDIVISION \_\_\_\_\_

QUANTITY	OCCUPANCY	UNIT FEE	AMOUNT
1	Sewer Conn - Pool	37.50	37.50

PAID BY: \_\_\_\_\_

TOTAL	37.50
Less Credit	_____
<b>TOTAL FEE \$</b>	<b>37.50</b>

\*Credit for existing sewer is applied to the new sewer connection fee based on previous type of occupancy and only when the new occupancy requires an additional fee.  
This receipt does not authorize the owner or his representative to start any work without obtaining a plumbing permit.

J. Entwined 3-11-70  
DEPARTMENT OF BUILDING & SAFETY DATE

73102

RECEIPT NO. 29509 SEWER FEE \$ 37.50

RECEIPT  
287 \$037.50 - 3

CITY OF LAS VEGAS  
DEPT. OF  
BUILDING & SAFETY

MUST BE MACHINE VALIDATED  
11 MAR 70

DEPARTMENT OF BUILDING & SAFETY  
CITY OF LAS VEGAS, NEVADA

KARDEX CARD  
FENCE & RETAINING  
WALLS

OWNER Julius Conigliano ADDRESS 4201 El Camino DATE 2/21/67

CONTRACTOR Chester PERMIT NO. 36178

LOT 91 BLOCK 4 SUBDIVISION Las Verdes Unit #2  
Wire Fence

Fence (wire, wood, etc.)	Walls (masonry, rock, etc.)
Location _____	Location _____
Final Inspection <u>W 2-16-67</u>	Footing _____
	Wall Steel 1st _____ 2d _____ 3d _____
	Final Inspection _____
Retaining Wall (masonry)	Retaining Wall (concrete)
Location _____	Location _____
Footing _____	Footing _____
Wall Steel 1st _____ 2d _____ 3d _____	Wall Steel 1st _____ 2d _____ 3d _____
Bond Beam 1st _____ 2d _____ 3d _____	Final Inspection _____
Final Inspection _____	

23.14 B ADDRESS 4201 El Camino LOG NO. \_\_\_\_\_ AREA \_\_\_\_\_

DEPARTMENT OF BUILDING & SAFETY  
CITY OF LAS VEGAS, NEVADA

KARDEX CARD  
SWIMMING POOL

OWNER Julius Conigliano ADDRESS 4201 El Camino DATE 3/11/70

CONTRACTOR Owner PERMIT NO. 51459

LOT 91 BLOCK 6 SUBDIVISION Las Verdes Heights #2

LOCATION <u>2-13-70</u>	FINAL PLUMBING <u>3-6-70</u>
ROUGH SOIL <u>2-13-70</u>	FINAL ELECTRIC _____
ROUGH WATER <u>2-13-70</u>	FINAL GAS _____
ROUGH GAS _____	FINAL SEWER _____
ROUGH ELECTRIC 1st <u>2-13-70</u> 2d <u>3-31-70</u> 3d <u>4-29-70</u>	FINAL SEPTIC TANK _____
STEEL INSPECTION _____	

Sewer-Owner-29509

FINAL POOL INSPECTION 2-4-70 DATE \_\_\_\_\_  
(Inspector)

23.24 B ADDRESS 4201 El Camino

DEPARTMENT OF BUILDING & SAFETY  
CITY OF LAS VEGAS, NEVADA

KARDEX CARD  
FENCE & RETAINING  
WALLS

OWNER Julius Conigliaro ADDRESS 4201 El Camino DATE 2/21/67

CONTRACTOR Chester PERMIT NO. 36178

LOT 91 BLOCK 4 SUBDIVISION Las Verdes Unit #2  
Wire Fence

Fence (wire, wood, etc.)	Walls (masonry, rock, etc.)
Location _____	Location _____
Final Inspection <u>W 2-16-67</u>	Footings _____
	Wall Steel 1st _____ 2d _____ 3d _____
	Final Inspection _____
Retaining Wall (masonry)	Retaining Wall (concrete)
Location _____	Location _____
Footings _____	Footings _____
Wall Steel 1st _____ 2d _____ 3d _____	Wall Steel 1st _____ 2d _____ 3d _____
Bond Beam 1st _____ 2d _____ 3d _____	Final Inspection _____
Final Inspection _____	

23.14 B ADDRESS 4201 El Camino LOG NO. \_\_\_\_\_ AREA \_\_\_\_\_

DEPARTMENT OF BUILDING & SAFETY  
CITY OF LAS VEGAS, NEVADA

KARDEX CARD  
SWIMMING POOL

OWNER Julius Conigliaro ADDRESS 4201 El Camino DATE 3/11/70

CONTRACTOR Owner PERMIT NO. 51459

LOT 91 BLOCK 6 SUBDIVISION Las Verdes Heights #2

LOCATION <u>2-13-70</u>	FINAL PLUMBING <u>2-4-70</u>
ROUGH SOIL <u>2-13-70</u>	FINAL ELECTRIC _____
ROUGH WATER <u>2-13-70</u>	FINAL GAS _____
ROUGH GAS _____	FINAL SEWER _____
ROUGH ELECTRIC 1st <u>2-13-70</u> 2d <u>2-31-70</u> 3d <u>2-29-70</u>	FINAL SEPTIC TANK _____
STEEL INSPECTION _____	

Sewer-Owner-29509

FINAL POOL INSPECTION 2-4-70 DATE \_\_\_\_\_  
(Inspector)

23.20 B ADDRESS 4201 El Camino

DEPT. of BLDG. & SAFETY - CITY of LAS VEGAS, NEVADA  
 OWNER: L.S. WHALEY & SONS, INC. ADDRESS: 4201 El Camino Ave. DATE: 5/15/59  
 GEN. CONT. SAME TYPE OF STRUCTURE: S. P. DWELLING  
 PERMIT NO. 33527 LEGAL DESCRIPTION: Lot 91, Bl. 6, Las Verdes Hts. - unit 2.

LOCATION & FLOOR ELEVATION	PLUMBING CONT. <u>ace</u>	TEMP POLE CONT.
FOOTINGS <u>Anderson 8-5-59</u>	PERMIT NO. <u>31076</u> DATE <u>7-9-59</u>	PERMIT NO. _____ DATE _____
FOUND. & PIERS	HEAT & VENT. CONT.	INSPECTION _____ DATE _____
WALL STEEL	PERMIT NO. _____ DATE _____	ELECTRICAL CONT. <u>ace</u>
BOND BEAM STEEL	SEWER CONT. <u>ace</u>	PERMIT NO. <u>25324</u> DATE <u>12-8-59</u>
FRAMING & ROOF SHEATHING <u>ace</u>	ROUGH SOIL <u>Anderson 7-16-59</u>	OUTLETS <u>66</u>
STEEL FABRICATION	ROUGH WATER <u>Anderson 7-16-59</u>	MOTORS _____ "H.P."
CONNECTIONS & PAINTING	SEWER OR SEPTIC TANK <u>Anderson 7-16-59</u>	SLAB _____
LATHING	TOP-OUT <u>Anderson 11-18-59</u>	ROUGH <u>Anderson 11-16-59</u>
PLASTER	ROUGH GAS <u>Anderson 11-18-59</u>	FINAL ROUGH _____
SCRATCH	ROUGH DUCT <u>Anderson 11-18-59</u>	FIXTURE CONT. <u>ace</u>
BROWN	FINAL PLUMBING <u>Anderson 3-7-60</u>	PERMIT NO. <u>25324</u> DATE <u>12-8-59</u>
FINAL BLDG. <u>Anderson 3-17-60</u>	FINAL HEATING <u>Anderson 3-7-60</u>	FIXTURES <u>13</u>
GRADING & DRAINAGE	FINAL GAS <u>Anderson 3-7-60</u>	FINAL FIXTURE _____
ON-SITE PARKING _____ SPACES _____		APPROVED FOR METER: <u>H. J. Taylor 4-21-60</u>
ENG APPROVAL OF _____		
OFF-SITE IMPROVEMENTS _____		

APPROVED for OCCUPANCY: \_\_\_\_\_  
 INSPECTOR: \_\_\_\_\_ DATE: \_\_\_\_\_  
 X PLEASE NOTE REMARKS ON REVERSE SIDE  
4201 El Camino, Ave. DWELLING  DATE: 5/15/59 23.04