

8221 Eginton Ave

L-17 Blk 2 Sub Charleston Rainbow 18-A Z:R=1

Y. Gatewood June 11, 1980

CITY OF LAS VEGAS, NEVADA

LOG NO. & AREA: T-21-4/80 CONST. VAL. \$ 40,418.00

DEPARTMENT OF PUBLIC SERVICES
DIVISION OF BUILDING AND SAFETY

APPLICATION & BUILDING PERMIT - for:
Dwellings, Duplexes, Misc. Residential Const.

ADDRESS OF CONSTRUCTION: 8221 Eginton Avenue

OWNER: Sproul Homes of Nevada

LOT(S) 17 BLOCK 2 SUBDIVISION Charleston Rainbow 18-A ZONE: R-1

Existing structure on lot: Dwelling Accessory Bldgs. Vacant lot Other

PROPOSED CONSTRUCTION: Single Family Dwelling USE: Same

MATERIALS OF CONSTRUCTION: Wood Frame Concrete Block Reinforced Concrete Steel Frame

SQUARE FEET OF FLOOR AREAS: 1st 1471 2nd 480 Other 63 TOTAL SQ. FT. 2014

FIRE ZONE: Occupancy Group R-3 CONST. TYPE V-N

ARCHITECT: _____ ENGINEER: _____ NO. of UNITS 1 NO. of STORIES 1

Plans Submitted: Yes No Calculations Submitted: Yes No Sewer Fee Req'd.: Yes No

CONTRACTOR: Sproul Homes of Nevada STATE LICENSE # 6011B CITY LICENSE # 6429

ADD'L. PERMITS REQ'D.: Air Cond. Elec. Plumbing Signs Paving Fence Public Walk Curb-cutters
Incinerators Fire Sprinkling System

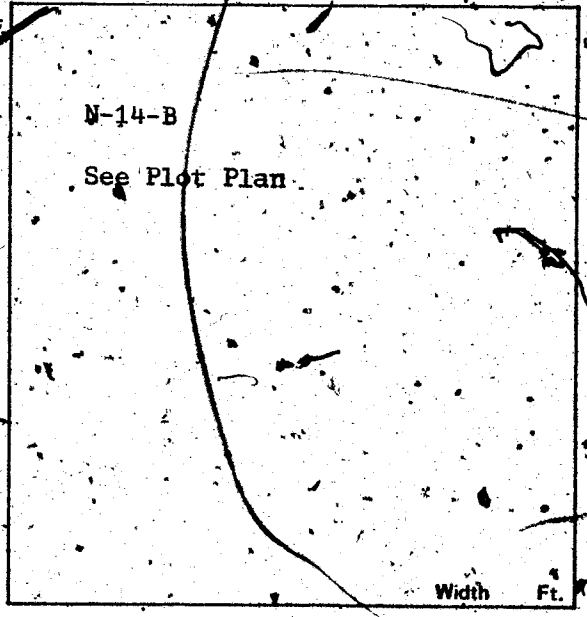

CONDITIONS OF THE PERMIT:

1. I agree to call the City Building Department for inspections before concrete is poured, before rough wiring, electrical, plumbing, framing is covered. Also for Air conditioning, drywall and sheathing inspection.
2. I agree that when the job is completed that I will call for final inspection before occupancy.
3. I agree to perform all construction in accordance with City Ordinances and Building Codes.
4. The Contractor's signature below denotes authority from the owner to sign in his behalf and that the owner is aware of all requirements of this application and permit. Separate permits must be taken out for work outlined above this agreement.
5. I have read and understand the contents of this application and permit; I hereby state that the information I have supplied on this application is true and correct.

Approval for the work under this permit will be given only after refusal and debris have been removed from job site and public right of way.

SIGNED: Sproul Homes of Nevada Contractor

BY: John E. Suber Agent of Owner

PLANNING DEPT.: J. Robinson Date: 5/28/80

PUBLIC WORKS DEPT.: Charles Sub Date: 5/28/80

BUILDING DIVISION: MMJ Date: 5-29-80

PERMIT NO.: 2958-31 PERMIT FEES 172.00

1721-2401

RECEIPT

MUST BE MACHINE VALIDATED

Y. Gatewood June 11, 1980

17-21

CITY OF LAS VEGAS, NEVADA

DEPARTMENT OF PUBLIC SERVICES—PLUMBING APPLICATION & PERMIT
DIVISION OF BUILDING AND SAFETY

ADDRESS OF CONSTRUCTION: 7221 E GINTON AVE OWNER'S NAME: SPROUL HOMES, INC.

CITY FILE: Addition; Remodel; New Bldg. TYPE OF BLDG: SFD APT. COMM. PUBLIC

CONTRACTOR'S NAME: UNITED PLMBC STATE LICENSE # 1295 CITY LICENSE # 904

UNITS	DESCRIPTION	FEE	TOTAL
PERMIT ISSUANCE			
1	For Issuing Each Permit	7.00	7.00
	For Issuing Each Supplemental Permit	4.25	
FIXTURE CHARGE			
1	Bath/Tub	1.50	1.50
1	Shower	1.50	1.50
1	Lavatory	1.50	3.00
2	Toilet	1.50	3.00
	Urinal	1.50	
	Floor Drain	1.50	
	Floor Sink	1.50	
	Wash. Tray	1.50	
	Sink	1.50	1.50
	Garbage Disposal (residential)	1.50	
	Garbage Disposal (commercial)	5.50	
	Clothes Dryer (residential)	1.50	
1	Clothes Washer (residential)	1.50	1.50
	Clothes Washer (commercial)	1.50	
	Dishwasher (residential)	1.50	
	Dishwasher (commercial)	1.50	
	Dental Unit	1.50	
	Drinking Fountain	1.50	
	Refrigerator, Ice Maker, Water Dispenser	1.50	
	Any other water using equipment, Attached coffee Makers, Ice Makers	1.50	
1	Water heaters (gas) (electric)	1.50	1.50
SEWER SYSTEM			
1	New, Replacement, Modification, or Any Drainage Work	7.50	7.50
	Grease or Sand Trap or Interceptor	2.00	
	Trailer Trap (rental parks)	3.50	
WATER SOFTENERS			
	Non Permanent Type (rental)	2.00	
	Permanent Type (connected to drain)	2.00	
SWIMMING POOLS			
	Private or Wading Pool (including spa)	15.00	
	Public or Semi Public	25.00	
	Spas, Preformed (private)	10.00	
	Spas, Preformed (commercial)	15.00	
WATER DISTRIBUTION SYSTEM			
1	Single Family Dwelling	5.00	5.00
	Multi Family Dwelling	5.00	
	Plus Each Dwelling Unit	2.50	
	Commercial Building per floor	3.00	
	Plus Each (leased space or office)	6.00	

UNITS	DESCRIPTION	FEE	TOTAL
	Hotel or Motel	6.00	
	Plus Each Unit	2.50	
	Trailer Park	25.00	
	Plus Each Space	1.50	
	Irrigation	6.00	
FUEL PIPING SYSTEM			
1	Single Family Dwelling	4.50	4.50
	Multi-Family Dwelling	8.00	
	Plus Each Unit	1.50	
	Commercial Building (per floor)	4.50	
	Plus Each Unit (leased space or office)	4.50	
	Medium Pressure Gas System (plan check)	6.00	
	Each Gas Appliance (any type)	1.50	
	Standby Emergency (generating engines)	2.50	
	Steam Boilers	2.50	
	Service Station Fuel Tank and Piping System	5.00	
		5.00	
AUTOMATIC FIRE EXTINGUISHING SYSTEM			
	Underground Piping	15.00	
	Distribution Piping (per foot)	.03	
	Sprinkler Head (each)	.15	
	In Range-Hood and Vent	7.50	
	Dry Standpipe System	62.50	
	Piping	1.50	
	Each Outlet	7.50	
	Wet Standpipe System	1.50	
	Piping	2.50	
	Fire Hose Cabinet	2.50	
SOLAR ENERGY SYSTEMS			
	Collectors (including piping) (per collector)	2.50	
	Storage Tanks (each)	2.50	
PIPELINE CONTRACT			
	For Onsite Sewer, Gas or Water Contract Value. Fee based on Building Code Permit Valuation Chart.		
	Inspections for which no fee is specifically indicated (minimum charge, one half hour)	7.50 per hour	
	Additional plan review required by changes, additions or revisions to approved plans (minimum charge, one half hour)	7.50 per hour	

Plumbing permit fees may be computed the same as building permit fees by using the cost of installation for valuation amount when such work is not included in the above schedule.

I hereby certify that I have carefully examined and read the above application; that the same is true and correct; and that the work herein described is to be done in accordance with all the provisions of the applicable Ordinances of the City of Las Vegas, Nevada and the State Laws, whether herein specified or not.

Approval for the work under this permit will be given only after refuse and debris have been removed from job site and public right of way.

SIGNED: J. Davis Date: 6-3-80
Registered Master Plumber, Spec. Cont'r. or Owner

BUILDING DIVISION: T. Davis Date: 6/4/80

PERMIT NO. 2985-26 PERMIT FEE \$ 37.50

RECEIPT

MUST BE MACHINE VALIDATED

Waterwood June 25, 1980

CITY OF LAS VEGAS, NEVADA

DEPARTMENT OF PUBLIC SERVICES — ELECTRICAL APPLICATION & PERMIT
DIVISION OF BUILDING AND SAFETY

ADDRESS OF CONSTRUCTION: 8221 Eginton Ave. OWNER'S NAME: Sproul Homes
CIRCLE: Addition; Remodel; New Bldg. TYPE OF BLDG.: SFD APT. COMM. PUBLIC
CONTRACTOR'S NAME: Roberts Electric Company STATE LICENSE #: 4528 CITY LICENSE #: 3392

UNITS	DESCRIPTION	FEE	TOTAL
59	Receptacles <u>32</u> Outlets <u>12</u> Switches <u>12</u>	.30	17.70
	Wall or Ceiling Space Heaters	.50	
	Blast Coil Heaters (per kilowatt)	.35	
	Garbage Grinder Outlet	.50	.50
	Trash Compactor	.35	
	Dishwasher Outlet	.50	.50
	Clothes Dryer Outlet	.50	.50
	Automatic Clothes Washer Outlet	.50	.50
	Electric Range	.50	.50
	Electric Water Heater	.50	
14	Each Fixture or Socket	.15	2.10
	Each Mercury Arc Lamp and Equipment (sodium)	.50	
	Each Special Purpose Outlet	.50	
	Each X-ray Unit and its Appurtenances	7.50	
	Area Lighting — First 3000 Watts	6.00	
	For Each Additional 1000 Watts	2.25	
	Total Horsepower Each Motor — Generator, Transformer, Welder	2.50	
	First Horsepower or KVA	.40	
	For Each Additional Horsepower up to 50	.15	
	For Each Horsepower over 50	.15	
	Temporary Power and Lights — Temporary Pole	5.00	
	Electric Service, Including First Meter Socket	4.50	
	For Each Additional Meter Socket	.40	4.50
	Services over 200 to 600 Amperes	6.25	
	600 to 1200 Amperes	12.50	
	over 1200 Amperes	25.00	
	Sub Panel	1.50	
	Permanently Connected Air Conditioning Service (Heating/Cooling)	2.25	2.25
	Speaker Outlets	.20	
	Signal or Alarm Outlets	.25	
	Amplifiers	1.25	
	Control Panels	.35	
	T.V. Outlets — Master System Only	.30	
	Swimming Pool (residential)	10.00	
	Swimming Pool (commercial)	15.00	
	Spas	4.00	
	Recreational Vehicles (per space)	1.50	
	Busways — for Trolley and Plug-in Type Busways, Each 100 Feet or Fraction Thereof	1.50	
	Fee for issuing Each Permit	7.00	7.00

Other inspections and fees:

1. Inspections outside of normal business hours = \$7.50 per hour (minimum charge two hours).
2. Re-inspection fee assessed under provisions of Section 305(h) of the Uniform Building Code = \$7.50 per hour.
3. Inspections for which no fee is specifically indicated = \$7.50 per hour (minimum charge one half hour).
4. Additional plan review required by changes, additions or revisions to approved plans = \$7.50 per hour (minimum charge one half hour).

*Approval for the work under this permit will be given only after refuse and debris have been removed from job site and public right of way.

I hereby certify that I have carefully examined and read the above application; that the same is true and correct; and that the work herein described is to be done in accordance with all the provisions of the applicable Ordinances of the City of Las Vegas, Nevada and the State Laws, whether herein specified or not.

SIGNED: George D. Waugh Date: 6-19-80
Master (Electrician) (Technician) (Owner)
BUILDING DIVISION: Joule Date: 6/20/80
PERMIT NO.: 3375-26 PERMIT FEE \$ 36.05

#1721-2402 (REV. 3/80)

RECEIPT

MUST BE MACHINE VALIDATED

H. Ealy July 29, 1980

CITY OF LAS VEGAS, NEVADA

DEPARTMENT OF PUBLIC SERVICES — AIR CONDITIONING APPLICATION & PERMIT
DIVISION OF BUILDING AND SAFETY

ADDRESS OF CONSTRUCTION: 8221 Eginton Avenue OWNER'S NAME: Sproul Homes of Nevada
 CIRCLE: Addition; Remodel; New Bldg. TYPE OF BLDG.: SFD APT. COMM. PUBLIC
 CONTRACTOR'S NAME: Gearing Air Conditioning STATE LICENSE # 6058 CITY LICENSE # 7618

UNITS	DESCRIPTION	FEE	TOTAL
PERMIT ISSUANCE			
	For the issuance of each permit:	6.50	6.50
	For issuing each supplemental permit.	3.00	
UNIT FEE SCHEDULE			
	For the installation or relocation of each forced-air or gravity-type furnace or burner, including ducts and vents attached to such appliance, up to and including 100,000 Btu/h.	5.00	
	For the installation or relocation of each forced-air or gravity-type furnace or burner, including ducts and vents attached to such appliance over 100,000 Btu/h.	5.75	
	For the installation or relocation of each floor furnace, including vent.	5.00	
	For the installation or relocation of each suspended heater, recessed wall heater or floor-mounted unit heater.	5.00	
	For the installation, relocation or replacement of each appliance vent installed and not included in an appliance permit.	2.00	
	For the repair of, alteration of, or addition to each heating appliance, refrigeration unit, cooling unit, absorption unit, or each heating, cooling, absorption, or evaporative cooling system, including installation of controls regulated by this code.	5.00	
	For the installation or relocation of each boiler or compressor to and including three horsepower, or each absorption system to and including 100,000 Btu/h.	5.00	
1	For the installation or relocation of each boiler or compressor over three horsepower to and including 15 horsepower, or each absorption system over 100,000 Btu/h and including 500,000 Btu/h.	9.00	9.00
	For the installation or relocation of each boiler or compressor over 15 horsepower to and including 30 horsepower, or each absorption system over 500,000 Btu/h to and including 1,000,000 Btu/h.	11.00	
	For the installation or relocation of each boiler or compressor over 30 horsepower to and including 50 horsepower, or for each absorption system over 1,000,000 Btu/h to and including 1,750,000 Btu/h.	21.25	
	For the installation or relocation of each boiler or refrigeration compressor over 50 horsepower, or each absorption system over 1,750,000 Btu/h.	33.75	

UNITS	DESCRIPTION	FEE	TOTAL
	For each air-handling unit to and including 10,000 cubic feet per minute, including ducts attached thereto. <i>Note: This fee shall not apply to an air-handling unit which is a portion of a factory-assembled appliance, cooling unit, evaporative cooler or absorption unit for which a permit is required elsewhere in this code.</i>	3.25	
	For each air-handling unit over 10,000 cfm.	5.75	
	For each evaporative cooler other than portable type.	3.75	
	For each ventilation fan connected to a single duct.	3.00	
	For each ventilation system which is not a portion of any heating or air-conditioning system authorized by a permit.	2.75	
	For the installation of each hood which is served by mechanical exhaust, including the ducts for such hood.	4.25	
	For the installation or relocation of each domestic-type incinerator.	5.25	
	For the installation or relocation of each commercial or industrial-type incinerator.	22.50	
	For each appliance or piece of equipment regulated by this code but not classed in other appliance categories, or for which no other fee is listed in this code.	3.75	
	When Chapter 22 is applicable (see Section 103), permit fees for fuel-gas piping shall be as follows: For each gas-piping system of one to four outlets. For each gas-piping system of more than four outlets, per outlet.	2.00 .50	
OTHER INSPECTIONS AND FEES:			
	Inspections outside of normal business hours (minimum charge — two hours).	7.50 per hour	
	Reinspection fee assessed under provisions of Section 305 (1).	7.50 each	
	Inspections for which no fee is specifically indicated (minimum charge — one-half hour).	7.50 per hour	
	Additional plan review required by changes, additions or revisions to approved plans (minimum charge — one-half hour).	7.50 per hour	
TOTAL PERMIT FEE \$		15.50	

I hereby certify that I have carefully examined and read the above application; that the same is true and correct; and that the work herein described is to be done in accordance with all the provisions of the applicable Ordinances of the City of Las Vegas, Nevada and the State Laws, whether herein specified or not.

Approval for the work under this permit will be given only after refuse and debris have been removed from job site and public right of way.

SIGNED E.E. Gearing (Signature) Date 7/10/80
 Air Conditioning Contractor/Owner
 E.E. Gearing
 BUILDING DIVISION J. Jones (Signature) Date 7/22/80
 PERMIT NO. 39767 PERMIT FEE \$ 15.50

RECEIPT

MUST BE MACHINE VALIDATED

#172 (REV. 3/80)

OWNER <i>Sprout Homes of Nev</i> ADDRESS <i>8721 Eganton Ave</i>	
DATE <i>6-4-80</i>	GEN. CONT. <i>Samb</i>
TYPE OF STRUCTURE <i>SFD W/EP</i>	PERMIT NO. <i>2958-31</i>
LEGAL DESCRIPTION <i>E-17 B Charleston Rainbow 18-A</i>	FINAL INSPECTION LOG # AREA #
APPROVED FOR OCC. PLANCY & METER <i>R T21- 4/80</i>	
BUILDING	MECHANICAL
Investigation	Plumbing Cont. <i>United Plmb</i>
Location & Footing <i>B 26/4-80</i>	Permit No. <i>2985-26</i> Date <i>6-4-80</i>
Concrete Slab Footing <i>B 26/4-80</i>	Heat & Vent. A/C Cont. <i>None</i>
Fireplace Footing	Permit No. <i>3976</i> Date <i>12/10</i>
Chimney Steel	Sewer Cont. <i>Sprout Homes</i>
Vert. Steel Reint	Permit No. <i>2958</i> Date <i>4-80</i>
Horiz. Steel Reint	Rough Soil <i>MM 6-24-80</i>
Framing	Rough Water <i>MM 6-24-80</i>
Ext. Lath	Top Out <i>MM 8-7-80</i>
Ext. Brown	Rough Gas <i>MM 8-1-80</i>
Drywall <i>B Mt 11/6</i>	A/C Rough Duct <i>MM 8-24-80</i>
Final Building <i>B Mt 9-25-80</i>	Final Plumbing <i>MM 8-27-80</i>
Appr. for Occu. <i>AM 8-27-80</i>	Final Gas <i>MM 8-24-80</i>
ELECTRICAL	Final Air Cond. <i>MM 8-24-80</i>
Temp. Pole Cont.	Final Sewer <i>MM 1-16-80</i>
Permit No. Date	REMARKS
Inspection Date	
Electrical Cont. <i>Rebeck</i>	
Permit No. <i>3370-26</i> Date <i>6-27-80</i>	
Rough <i>2097-26-80</i>	PLEASE NOTE ADDITIONAL REMARKS ON REVERSE SIDE.
Final Rough	DIV. OF BLDG. & SAFETY
Final Electrical <i>2097-26-80</i>	CITY OF LAS VEGAS
Temporary Service	REV. 10-78

Rev Shultz 6M7-25-70

Regulation 13m P-4.6

Put # 2958 21

Stone Hedges 9-14-83

CITY OF LAS VEGAS, NEVADA

487.50
195.20

LOG NO. & AREA _____ DATE 9-12-83 CONST. VAL. \$ 487.50

DEPARTMENT OF BUILDING AND SAFETY PHONE 386-6251 450-195-017 DEVELOPMENT PERMIT AND BUILDING PERMIT
FOR: Fence, Wall, Retaining Wall

ADDRESS OF CONSTRUCTION: 8221- Gentry Ave OWNER: Louis Reiger

CONTRACTOR: owner STATE LICENSE NO. _____ CITY LICENSE NO. _____

LOT(s): 17 BLOCK: 2 SUBDIVISION: Charleston 158A ZONE: R-1

PROPOSED CONSTRUCTION: Block Wall
BUILDING PERMIT NO. 2789 ENGINEER _____

Approval for the work under this permit will be given only after refuse and debris have been removed from job site and public right of way.

Remarks:

TOTAL SQUARE FEET: _____ TOTAL LINEAL FEET: _____

OTHER INSPECTIONS AND FEES

1. Inspections outside of normal business hours = \$25.00 per hour (minimum charge three hours).
2. Re-inspection fee during normal business hours assessed under provisions of TABLE 3-A of the Uniform Building Code = \$15.00 each.
3. Inspections during normal business hours for which no fee is specifically indicated = \$15.00 per hour (minimum charge one half hour).
4. Additional plan review required by changes, additions or revisions of approved plans = \$25.00 per hour (minimum charge two hours).

CONDITIONS OF THE PERMIT:

1. Any type of retaining wall must be engineered by a Civil or Structural Engineer.
2. If a home owner takes out the Building Permit and if the owner sublets the work to a Contractor, then the Contractor must take out the permit and pay for it.
3. No fence or wall can be built on City property or rights-of-way, but this is not intended to preclude construction within utility easements if utilities will not be damaged or made inaccessible.
4. The fence or wall shall not enclose any water meter, light standard, or fire alarm box and shall not come closer than 24" from the nearest fire hydrant outlet.
5. Department Inspectors must approve footings before concrete is poured and block wall reinforcing before grouting is done.
6. Maximum height of any wall or fence is 6' side and rear yards; 4' maximum in front yard with the vertical surface above the height of 2' - 50% open.
7. I must not obstruct required onsite parking space (2 spaces for each dwelling unit) by the erection of this fence or wall.
8. By the signing of this application I herewith agree to the requirements outlined above.

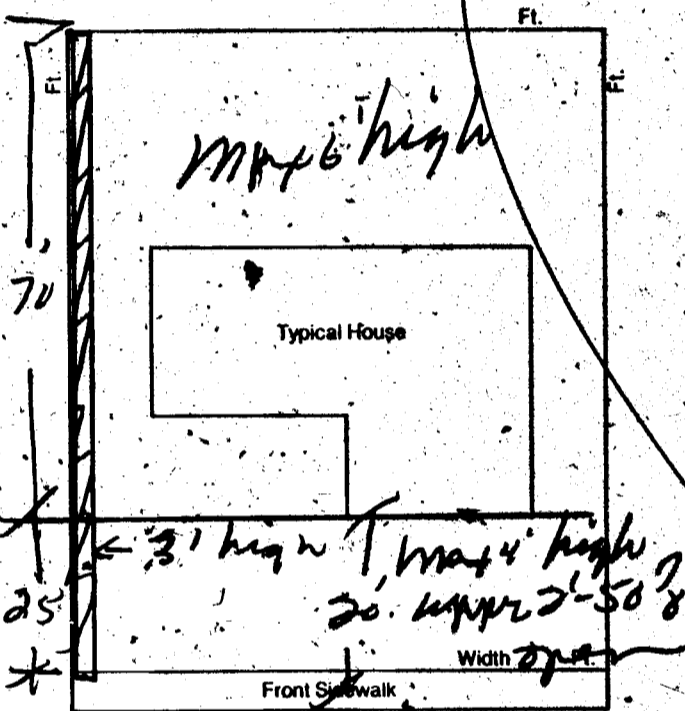

SIGNED Louis Reiger CONTRACTOR - AGENT / OWNER

PLANNING DEPT. _____ DATE 9/12/83

BUILDING DEPT. _____ DATE _____

I hereby certify that I have reviewed this application and the proposed plans and have found that the proposed development meets the requirements of the City of Las Vegas Flood Hazard Reduction Ordinance for the issuance of this Development Permit.

Kent Nash 9-12-83
LAND DEVELOPMENT AND FLOOD CONTROL ENGINEER

PLAN REVIEW FEE _____
PERMIT FEE _____
TOTAL FEES 10.00

RECEIPT	
1 DOW	\$.00
WALL	\$ 10.00
STL	\$ 10.00
TOTL	\$ 10.00
CHEK	\$ 10.00
A#2789, SR#001/01	
CITY - LAS VEGAS	
BLDG. & SAFETY	
09/12/83	

383 Permit Expires 180 Days After Abandonment of Work

MUST BE MACHINE VALIDATED

Some Holes 9-14-83

CITY OF LAS VEGAS, NEVADA

487.50
195.00

LOG NO. & AREA _____ DATE 9-12-83 CONST. VAL. \$ _____

DEPARTMENT OF BUILDING AND SAFETY PHONE 386-6251 450-195-017 DEVELOPMENT PERMIT AND BUILDING PERMIT FOR: Fence, Wall, Retaining Wall

ADDRESS OF CONSTRUCTION: 8221 Ginton Ave OWNER Louise Reiger

CONTRACTOR owner STATE LICENSE NO. _____ CITY LICENSE NO. _____

LOT(s) 17 BLOCK 2 SUBDIVISION Chm Linton 158A ZONE R-1

PROPOSED CONSTRUCTION: Block Wall
BUILDING PERMIT NO. 2789 ENGINEER _____

Approval for the work under this permit will be given only after refuse and debris have been removed from job site and public right of way.

Remarks:

TOTAL SQUARE FEET: _____ TOTAL LINEAL FEET: _____

OTHER INSPECTIONS AND FEES

1. Inspections outside of normal business hours = \$25.00 per hour (minimum charge three hours).
2. Re-inspection fee during normal business hours assessed under provisions of TABLE 3-A of the Uniform Building Code = \$15.00 each.
3. Inspections during normal business hours for which no fee is specifically indicated = \$15.00 per hour (minimum charge one half hour).
4. Additional plan review required by changes, additions or revisions of approved plans = \$25.00 per hour (minimum charge two hours).

CONDITIONS OF THE PERMIT:

1. Any type of retaining wall must be engineered by a Civil or Structural Engineer.
2. If a home owner takes out the Building Permit and if the owner sublets the work to a Contractor, then the Contractor must take out the permit and pay for it.
3. No fence or wall can be built on City property or rights-of-way, but this is not intended to preclude construction within utility easements if utilities will not be damaged or made inaccessible.
4. The fence or wall shall not enclose any water meter, light standard, or fire alarm box and shall not come closer than 24" from the nearest fire hydrant outlet.
5. Department inspectors must approve footings before concrete is poured and block wall reinforcing before grouting is done.
6. Maximum height of any wall or fence is 6' side and rear yards; 4' maximum in front yard with the vertical surface above the height of 2' - 50% open.
7. I must not obstruct required onsite parking space (2 spaces for each dwelling unit) by the erection of this fence or wall.
8. By the signing of this application I herewith agree to the requirements outlined above.

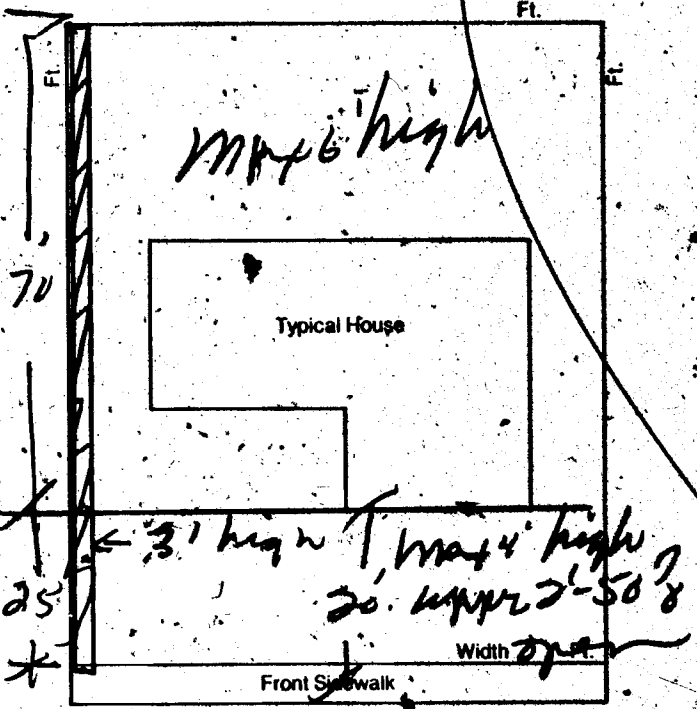

2310-2401

SIGNED Louise Reiger CONTRACTOR - AGENT / OWNER

PLANNING DEPT. _____ DATE 9/12/83

BUILDING DEPT. _____ DATE _____

I hereby certify that I have reviewed this application and the proposed plans and have found that the proposed development meets the requirements of the City of Las Vegas Flood Hazard Reduction Ordinance for the issuance of this Development Permit.

Kent Nash 9-12-83
LAND DEVELOPMENT AND FLOOD CONTROL ENGINEER DATE

PLAN REVIEW FEE _____

PERMIT FEE _____

TOTAL FEES 10.00

RECEIPT	
1 DONA	\$.00
WALL	\$ 10.00
STL	\$ 10.00
TOTL	\$ 10.00
CHEK	\$ 10.00
A#2789, SR#001/01	
CITY - LAS VEGAS	
BLDG. & SAFETY	
09/12/83	

3/83 Permit Expires 180 Days After Abandonment of Work

MUST BE MACHINE VALIDATED