

4412 Del Monte

L4 B3 Royal Crest Park Zone R-1

G. Gatewood 3-6-79

LOG NO. & AREA T-3/4 CITY OF LAS VEGAS, NEVADA CONST. VAL. \$ 720⁰⁰

DEPARTMENT OF BUILDING & SAFETY

APPLICATION & BUILDING PERMIT — for:
Fence, Wall, Retaining Wall.

ADDRESS OF CONSTRUCTION: 4412 DEL MONTE AVE. OWNER: ROYAL CREST, INC.

LOT(s) 4 BLOCK 3 SUBDIVISION ROYAL CREST PARK ZONE: R-1

Materials of Construction: Block Concrete Wire Wood Other Yes No
ARCHITECT: _____ ENGINEER: KRAEMER PLANS:
CALCS:

CONTRACTOR: ROYAL CREST, INC. STATE LICENSE # 5623 CITY LICENSE # 6255

TOTAL SQUARE FEET: 864 TOTAL LINEAL FEET: 144

Remarks:
430⁰⁰

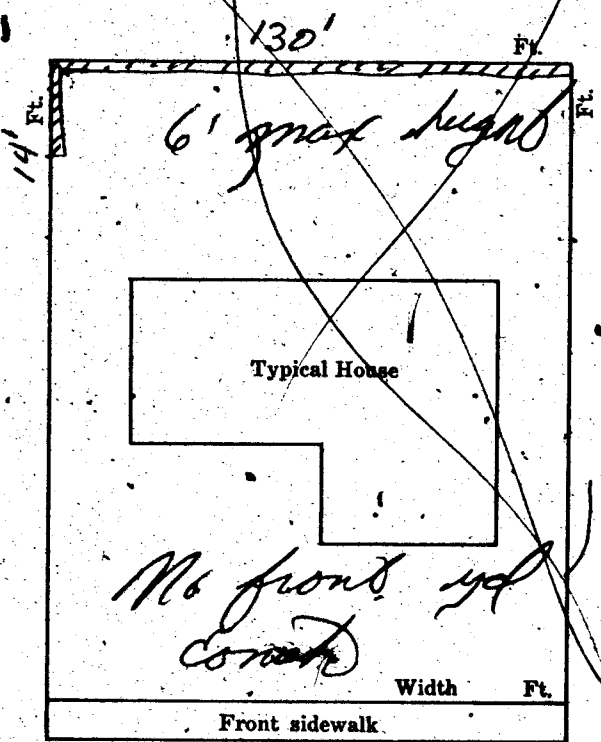

CONDITIONS OF THE PERMIT:

1. Any type of retaining wall must be engineered by a Civil or Structural Engineer.
2. If a home owner takes out the Building Permit and if the owner sublets the work to a Contractor, then the Contractor must take out the permit and pay for it.
3. No fence or wall can be built on City property or rights-of-way, but this is not intended to preclude construction within utility easements if utilities will not be damaged or made inaccessible.
4. The fence or wall shall not enclose any water meter, light standard, or fire alarm box and shall not come closer than 24" from the nearest fire hydrant outlet.
5. Department Inspectors must approve footings before concrete is poured and block wall reinforcing before grouting is done.
6. Maximum height of any wall or fence is 6', side and rear yards; 4' maximum in front yard with the vertical surface above the height of 2' - 50% open and further that fencing within 25' of the intersection of curb faces on corner and through lot is limited to a maximum height of 30".
7. I must not obstruct required site parking space (1 space for each dwelling unit) by the erection of this fence or wall.
8. By the signing of this application I herewith agree to the requirements outlined above.

SIGNED: Philip J. DATE: 4/6/67
CONTRACTOR AGENT OWNER

PLANNING DEPT: [Signature] Date: 4/6/67
ENGINEERING DEPT: [Signature] Date: _____
BUILDING DEPT: [Signature] Date: 4/6/67
#1285 PERMIT NO. 36823 PERMIT FEE \$ 8⁰⁰

RECEIPT
949 \$008.00 - 8
CITY OF LAS VEGAS
DEPT. OF BUILDING & SAFETY
MUST BE MACHINE VALIDATED
- 7 APR 67

G. Gatewood 3-6-79

CITY OF LAS VEGAS, NEVADA
DEPARTMENT OF BUILDING & SAFETY

PERMIT FEE \$ 150.00
APPLICATION & PERMIT FOR

JOB ADDRESS: 4412 DEL MONTE AVE OWNER'S NAME: ROYAL CREST INC PLUMBING

LOT 4 BLOCK 3 SUBDIVISION ROYAL CREST PARK Bldg. type: SFD APT COMM

Circle: New bldg; Old bldg; Add'n; Remodel; Pool; Wtr. Sftner; Lawn Sprkr; Other

CONTRACTOR: State Lic. # 5723 City Lic. # 6255

QUANTITY	FIXTURE OR INSTALLATION	Unit Price	AMOUNT
1	Bathtub <u>SEWER CONN</u>	1.00	<u>150.00</u>
	Clothes dryer (gas)	1.00	
	Clothes washer	1.00	
	Dental unit	1.00	
	Dishwasher	1.00	
	Drinking fountain	1.00	
	Fire sprinkling - underground piping	5.00	
	Fire sprinkling - distribution piping per each foot.	.01	
	Fire sprinkling heads - per each head	.10	
	Floor drain \$1.00 Floor sink	1.00	
	Gas appliance (any type)	1.00	
	Gas piping system - single family dwelling	3.00	
	Gas piping system - multiple family \$3 per each unit plus	1.00	
	Gas piping system - commercial bldg. per each floor	3.00	
	Grease trap	1.00	
	Irrigation system	4.00	
	Lavatory	1.00	
	Minimum fee for any permit	4.00	
	Piping, Drainage	4.00	
	Sewer replacement	4.00	
	Septic disposal system - Health Dept. approval required.	4.00	
	Shower	1.00	
	Sink - kitchen type	1.00	
	Swimming pool - private - wading pool	8.00	
	Swimming pool - public - semi-public	12.00	
	Toilet	1.00	
	Urinal	1.00	
	Water distribution system, single family dwelling	4.00	
	Water distribution system multiple dwg. \$4 + each unit	1.00	
	Water distribution system, Group "A" thru "G" per each floor	4.00	
	Water distribution system, Group "H" (Hotel) \$4 + per bath*	.50	
	Water heater (gas) (electric)	1.00	
	Water using equipment	1.00	
	Water softener nonpermanent type	4.00	
	Water softener permanent (connected to drainage)	5.00	
	Wash tray	1.00	

I hereby certify that I have carefully examined & read the above application; that the same is true & correct; and the work herein described is to be done in accordance with the provisions of City of Las Vegas Ordinances & State Laws, whether herein specified or not. * As defined in City Code and Ordinances.

TOTAL FEE \$ 150.00

SIGNED: ROYAL CREST INC Date: 6-7-67
Registered Plumber G. Gatewood Owner

Engineering Dept. Date Building Department Date
Sewer Comm. Fees
Paid in Engr. Dept. PERMIT NO 21724 PERMIT FEE \$ 150.00
23.10 #1287

RECEIPT
393 \$150.00 - 3
CITY OF LAS VEGAS
DEPT. OF BUILDING & SAFETY
Must be machine validated
- 2 JUN 67

H. Gatewood 3-6-79

LOG NO. & AREA

T-5/4

CITY OF LAS VEGAS, NEVADA

CONST. VAL. \$

21,523

DEPARTMENT OF BUILDING & SAFETY

APPLICATION & BUILDING PERMIT — for:
Dwellings, Duplexes, Misc. Residential Const.

ADDRESS OF CONSTRUCTION

4412 DEL MONTE AVE

OWNER

ROYAL CREST INC.

LOT(s)

4

BLOCK

3

SUBDIVISION

ROYAL CREST PARK

ZONE

R-1

Existing structure on lot: Dwelling Accessory bldgs. Vacant lot Other

PROPOSED CONSTRUCTION:

S.F.D.

USE:

MATERIALS OF CONSTRUCTION: Wood Frame Concrete Block Reinforced Concrete Steel Frame

SQUARE FEET OF FLOOR AREAS: 1st

1907

2nd

3rd

Other 491

TOTAL SQ. FT.

2,398

FIRE ZONE: 1 2 3

Occupancy Group A B C D E F G H I J 1-2-3-4-5

CONST. TYPE: I II III IV V

ARCHITECT:

ENGINEER:

NO. of UNITS

NO. of STORIES

Plans Submitted: Yes No

Calculations Submitted Yes No

Sewer Fee Req'd. Yes No

CONTRACTOR:

ROYAL CREST INC.

STATE LICENSE

5723

CITY LICENSE

6255

ADD'L. PERMITS REQ'D: Air Cond. Elec. Plumbing Signs Paving Fence Public Walks Curb-gutters Incinerators Fire Sprinkling System

4 BDDM. PLAN 'A'
W/ FIREPLACE

SEE PLOT PLAN

Width Ft.
Front sidewalk

CONDITIONS OF THE PERMIT:

1. I agree to call the City Building Department for inspections before concrete is poured, before rough wiring, electrical, plumbing, framing is covered. Also for Air conditioning, sheet-rock and sheathing inspection.
2. I agree that when the job is completed that I will call for final inspection before occupancy.
3. I agree to perform all construction in accordance with City Ordinances and Building Codes.
4. The Contractor's signature below denotes authority from the owner to sign in his behalf and that the owner is aware of all requirements of this application and permit. Separate permits must be taken out for work outlined above this agreement.
5. I have read and understand the contents of this application and permit; I hereby state that the information I have supplied on this application is true and correct.

SIGNED:

ROYAL CREST INC.
Contractor

BY:

Agent or Owner

CLARK COUNTY HEALTH DEPT.

Date

LAS VEGAS FIRE DEPARTMENT

Date

PLANNING DEPT:

[Signature]

Date:

6-1-67

ENGINEERING DEPT:

[Signature]

Date:

6-1-67

BUILDING DEPT:

[Signature]

Date:

6-1-67

#1285

PERMIT NO:

37704

PERMIT FEE \$

72.00

RECEIPT

394 \$072.00 - 3

CITY OF LAS VEGAS
DEPT. OF BUILDING & SAFETY

MUST BE MACHINE VALIDATED

- 2 JUN 67

H. Gatewood 3-6-79

CITY OF LAS VEGAS, NEVADA
DEPARTMENT OF BUILDING & SAFETY

PERMIT FEE \$ _____
APPLICATION & PERMIT FOR
PLUMBING

JOB ADDRESS: 4412 Del Monte OWNER'S NAME: Royal Crest Inc.

LOT 4 BLOCK 3 SUBDIVISION RC Park Bldg. type: SFD APT COMM
Circle: New bldg; Old bldg; Add'n; Remodel; Pool; Wtr. Sfaner; Lawn Sprkr; Other

CONTRACTOR: Cal Plumbing State Lic. # 7596 City Lic. # 10100

QUANTITY	FIXTURE OR INSTALLATION	Unit Price	AMOUNT
2	Bathtub	1.00	2 ⁰⁰
	Clothes dryer (gas)	1.00	
1	Clothes washer	1.00	1 ⁰⁰
	Dental unit	1.00	
	Dishwasher	1.00	
	Drinking fountain	1.00	
	Fire sprinkling - underground piping	5.00	
	Fire sprinkling - distribution piping per each foot	.01	
	Fire sprinkling heads per each head	.10	
	Floor drain \$1.00 Floor sink	1.00	
	Gas appliance (any type)	1.00	
	Gas piping system - single family dwelling	3.00	
	Gas piping system - multiple family \$3 per each unit plus	1.00	
	Gas piping system - commercial bldg. per each floor	3.00	
	Grease trap	1.00	
	Irrigation system	4.00	
3	Lavatory	1.00	3 ⁰⁰
	Minimum fee for any permit	4.00	
1	Piping, Drainage	4.00	4 ⁰⁰
	Sewer replacement	4.00	
	Septic disposal system - Health Dept. approval required	4.00	
	Shower	1.00	
1	Sink - kitchen type	1.00	1 ⁰⁰
	Swimming pool - private - wading pool	8.00	
	Swimming pool - public - semi-public	12.00	
2	Toilet	1.00	2 ⁰⁰
	Urinal	1.00	
1	Water distribution system, single family dwelling	4.00	4 ⁰⁰
	Water distribution system multiple dwg. \$4 + each unit	1.00	
	Water distribution system, Group "A" thru "G" per each floor	4.00	
	Water distribution system, Group "H" (hotel) \$4 + per bath*	.50	
1	Water heater (gas) (electric)	1.00	1 ⁰⁰
	Water using equipment	1.00	
	Water softener nonpermanent type	4.00	
	Water softener permanent (connected to drainage)	5.00	
	Wash tray	1.00	

TOTAL FEE \$ 18⁰⁰

I hereby certify that I have carefully examined & read the above application; that the same is true & correct; and the work herein described is to be done in accordance with the provisions of City of Las Vegas Ordinances & State Laws, whether herein specified or not. * As defined in City Code and Ordinances.

SIGNED: Orlando E. Cal Date: _____
Registered Plumber Spec. Cont'r, Owner

Engineering Dept. Date _____ Building Department Date _____

Sewer Conn. Fees _____
Paid in Engr. Dept. PERMIT NO 4285 PERMIT FEE \$ 18⁰⁰
23.10 #1287

RECEIPT
665 \$018.00 - 7

CITY OF LAS VEGAS
DEPT. OF BUILDING & SAFETY

Must be machine validated
- 8 JUN 67

H. Gatewood 3-6-79

CITY OF LAS VEGAS, NEVADA

DEPARTMENT OF BUILDING & SAFETY - ELECTRICAL APPLICATION & PERMIT

ADDRESS OF CONSTRUCTION: 442 Del Monte OWNER'S NAME: Royal Crest

LOT(S) 4 BLOCK 3 SUBDIVISION Royal Crest Park Type of bldg: SFD Apt. Comm.

Check Proper Construction: New Bldg. Addn. Remodel Temporary Pole Old Bldg.

CONTRACTOR'S NAME FitzGerald Electric Inc. STATE LICENSE # 3851 CITY LICENSE # 1041

NUMBER	FIXTURE OR INSTALLATION	UNIT PRICE	
15	Fixture or sockets	.15	2.25
62	Light, receptacle or switch outlet	.20	12.40
	Wall or ceiling space heater	.35	
	Blast coil heater per kilowatt	.35	
1	Garbage grinder outlet	.35	.35
1	Dishwasher outlet	.35	.35
1	Clothes dryer outlet	.35	.35
1	Automatic clothes washer	.35	.35
1	Electric range outlet	.35	.35
1	Electric water heater outlet	.35	.35
	Mercury arc lamp and equipment	.35	
2	Special purpose outlet	.35	.70
	X-ray unit and its appurtenances	5.00	
	Watts of festoon lighting (Watts) First 3,000 watts	4.00	
	for each additional thousand watts	1.50	
	Horsepower - all motors first horsepower or less	1.75	
	for each additional horsepower	.35	
	Temporary power and lights (temporary pole)	4.00	
1	Electric service (including any single meter socket)	3.00	3.00
	for each additional socket	.35	
1	Air conditioning service	1.50	1.50
	amps		
	Each KW (KVA) Generator (Transformer) (Welder) KW (KVA)	2.00	
	First 100/KVA - For each additional KW (KVA)	.01	
	Special inspection per hour	4.00	
	Speaker outlets	.15	
	Signal or Alarm outlets	.15	
	Amplifiers	.50	
	Control panels	.25	
	T. V. outlets - master system only	.15	
	Radio outlets	.15	
	Main control racks	1.00	
	T. V. and Radio antennas - master system only	.75	
	Minimum fee for any permit	4.00	
	Total fee		21.95

I hereby certify that I have carefully examined and read the above application; that the same is true and correct; and that the work herein described is to be done in accordance with all the provisions of the applicable Ordinances of the City of Las Vegas, Nevada and State laws whether herein specified or not.

SIGNED [Signature] Date 7-12-67
MASTER (ELECTRICIAN) (TECHNICIAN) (OWNER)
 BUILDING DEPARTMENT [Signature] Date 7/17/67
 #1286 PERMIT NO. 23555 PERMIT FEE: \$ 21.95

RECEIPT
[Signature] \$021.95 - 6
 CITY OF LAS VEGAS
 DEPT. OF BUILDING & SAFETY
 MUST BE MACHINE VALIDATED
 18 JUL 67

G. Gatewood 3-6-79

1969

CITY OF LAS VEGAS, NEVADA

LOG NO. & AREA _____

CONST. VAL. \$ 175⁰⁰

DEPARTMENT OF BUILDING & SAFETY

APPLICATION & BUILDING PERMIT — for:
Fence, Wall, Retaining Wall.

ADDRESS OF CONSTRUCTION: 4412 Del-Monte

OWNER: Mel Sutton

LOT(s): 4

BLOCK 3

SUBDIVISION ROYAL CREST PARK

ZONE: R-1

Materials of Construction: Block Concrete Wire Wood Other

Yes No

PLANS:

ARCHITECT: _____

ENGINEER: _____

CALCS:

CONTRACTOR: Daley

STATE LICENSE # _____

CITY LICENSE # _____

TOTAL SQUARE FEET: 175 TOTAL LINEAL FEET: 35

Remarks:

CONDITIONS OF THE PERMIT:

1. Any type of retaining wall must be engineered by a Civil or Structural Engineer.
2. If a home owner takes out the Building Permit and if the owner sublets the work to a Contractor, then the Contractor must take out the permit and pay for it.
3. No fence or wall can be built on City property or rights-of-way, but this is not intended to preclude construction within utility easements if utilities will not be damaged or made inaccessible.
4. The fence or wall shall not enclose any water meter, light standard, or fire alarm box and shall not come closer than 24" from the nearest fire hydrant outlet.
5. Department Inspectors must approve footings before concrete is poured and block wall reinforcing before grouting is done.
6. Maximum height of any wall or fence is 6', side and rear yards; 4' maximum in front yard with the vertical surface above the height of 2' — 50% open and further that fencing within 25' of the intersection of curb faces on corner and through lots is limited to a maximum height of 30".
7. I must not obstruct required onsite parking space (1 space for each dwelling unit) by the erection of this fence or wall.
8. By the signing of this application I herewith agree to the requirements outlined above.

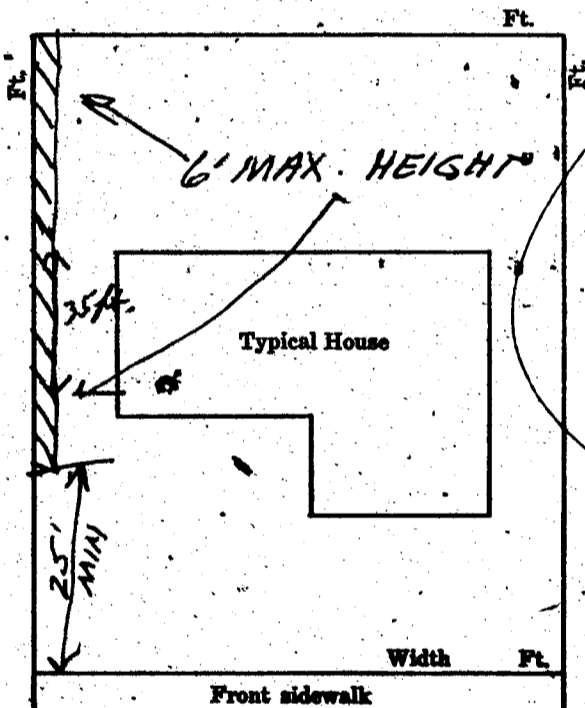

SIGNED: [Signature] DATE: _____
CONTRACTOR AGENT OWNER

PLANNING DEPT: [Signature] Date: 5-21-69

ENGINEERING DEPT: _____ Date: _____

BUILDING DEPT: [Signature] Date: 5-21-69

#1285

PERMIT NO: 47825

PERMIT FEE \$ 4⁰⁰

RECEIPT
987 \$004.00 — 8
CITY OF LAS VEGAS
DEPT. OF BUILDING & SAFETY
MUST BE MACHINE VALIDATED
2-2 MAY 69

DEPARTMENT OF BUILDING & SAFETY
CITY OF LAS VEGAS, NEVADA

KARDEX CARD
FENCE & RETAINING
WALLS

OWNER Mel Sutton ADDRESS 4412 Del Monte DATE 5/22/69

CONTRACTOR JOHN DALEY PERMIT NO. 47825

LOT 4 BLOCK 3 SUBDIVISION Royal Crest Park
Block fence

Fence (wire, wood, etc.)	Walls (masonry, rock, etc.)
Location _____	Location <u>LP 5-21-69</u>
Final Inspection _____	Footing <u>LK 5-21-69</u>
	Wall Steel 1st _____ 2d _____ 3d _____
	Final Inspection <u>4-5-69</u> <u>4-27-69</u> <u>5-22-69</u>
Retaining Wall (masonry)	Retaining Wall (concrete)
Location _____	Location _____
Footing _____	Footing _____
Wall Steel 1st _____ 2d _____ 3d _____	Wall Steel 1st _____ 2d _____ 3d _____
Bond Beam 1st _____ 2d _____ 3d _____	Final Inspection _____
Final Inspection _____	

23.14 B ADDRESS 4412 Del Monte LOG NO. _____ AREA _____

DEPARTMENT OF BUILDING & SAFETY
CITY OF LAS VEGAS, NEVADA

KARDEX CARD
FENCE & RETAINING
WALLS

OWNER Royal Crest ADDRESS 4412 Del Monte DATE 1/7/67

CONTRACTOR Same PERMIT NO. 36823

LOT 4 BLOCK 3 SUBDIVISION Royal Crest Park
Concrete Fence

Fence (wire, wood, etc.)	Walls (masonry, rock, etc.)
Location _____	Location <u>WEL 4-25-67 CH 8-15-67</u>
Final Inspection _____	Footing <u>Submitt 4-12-67 4-25-67 CH 8-15-67 2-21-67</u>
	Wall Steel 1st <u>4-13-67</u> <u>4-27-67</u> <u>WEL 4-16-67</u>
	Final Inspection <u>4-13-67</u> <u>4-27-67</u> <u>2-22-67</u>
Retaining Wall (masonry)	Retaining Wall (concrete)
Location _____	Location _____
Footing _____	Footing _____
Wall Steel 1st _____ 2d _____ 3d _____	Wall Steel 1st _____ 2d _____ 3d _____
Bond Beam 1st _____ 2d _____ 3d _____	Final Inspection _____
Final Inspection _____	

23.14 B ADDRESS 4412 Del Monte LOG NO. 7-3 AREA 4

DEPT. of BLDG & SAFETY—CITY of LAS VEGAS, NEVADA

OWNER Royal Crest ADDRESS 1112 Del Monte Ave. DATE 6/7/67
 GEN. CONT. Same TYPE OF STRUCTURE SED
 PERMIT NO. 37706 LEGAL DESCRIPTION L. H. B 3 Royal Crest Park

BUILDING	MECHANICAL	ELECTRICAL
LOCATION <u>WCS 6-13-67</u>	PLUMBING CONT. <u>607 50 mg</u>	TEMP. POLE CONT. _____
FIREPLACE FPG _____	PERMIT NO. <u>21285</u> DATE <u>6-7-67</u>	PERMIT NO. _____ DATE _____
FOOTINGS _____	HEAT & VENT. AC CONT. <u>Malley Bros</u>	INSPECTION _____ DATE _____
FOUNDATION WALLS <u>ES 6-14-67</u>	PERMIT NO. <u>131923</u> DATE <u>7-12-67</u>	ELECTRICAL CONT. <u>John Paul & Son</u>
FLOOR FRAMING <u>WCS 6-15-67</u>	SEWER CONT. <u>Royal Crest</u>	PERMIT NO. <u>23553</u> DATE <u>7-12-67</u>
SLAB _____	PERMIT NO. <u>21221</u> DATE <u>6/7/67</u>	FIXTURES CONT. <u>John Paul & Son</u>
CHIMNEY STEEL (FIREPLACE) _____	ROUGH SOL. <u>WCS 6-14-67</u>	PERMIT NO. <u>23555</u> DATE _____
WALL STEEL <u>WCS 7-14-67</u>	ROUGH WREN <u>WCS 6-14-67</u>	SLAB _____
COLUMN STEEL _____	TOP-OUT <u>WCS 7-13-67</u>	ROUGH <u>WCS 8-18-67</u>
BEAM STEEL _____	ROUGH GAS _____	FINAL ROUGH _____
FRAMING <u>WCS 7-18-67</u>	AC ROUGH DUCT <u>WCS 7-13-67</u>	FINAL FIXTURE _____
ROOF SHEATHING <u>WCS 7-7-67</u>	REF. ROUGH PIPING <u>WCS 10-13-67</u>	FINAL ELECTRICAL _____
INTERIOR _____	FINAL PLUMBING _____	TEMPORARY SERVICE _____
EXTERIOR _____	FINAL GAS _____	MISCELLANEOUS _____
DRYWALL _____	FINAL AIR COND. <u>WCS 10-3-67</u>	GRADING & DRAINAGE _____
LATHING _____	FINAL REFRIG. _____	ON-SITE PARKING SPACES _____ APP. _____
FRAMING (SIDING) _____	FINAL SEWER <u>WCS 7-18-67</u>	ENG. APPROVAL OF _____
PLASTER SCRATCH _____	FINAL SEPTIC TANK _____	OFF-SITE IMPROVEMENTS _____
PLASTER BROWN <u>WCS 10-28-67</u>		
URBAN REDEVELOPMENT APPROVAL _____		
FINAL BLDG <u>WCS 11-7-67</u> DATE <u>11-7-67</u>		

APPROVED FOR OCCUPANCY & METER _____

INSPECTOR _____

DATE _____

PLEASE NOTE REMARKS ON REVERSE SIDE 1112 Del Monte

LOG: # T-5

AREA: # 4

23.04