

1843 W. CHARLESTON

H. Gatewood 2-21-79

Log No. _____

Cons Valuation \$ 2016⁰⁰

CITY OF LAS VEGAS, NEVADA

DEPARTMENT OF BUILDING & SAFETY - SIGN APPLICATION & PERMIT

ADDRESS OF CONSTRUCTION: 1843 W. CHARLES ST. WESTWOOD SIGN OWNER: DOURNEY OUTDOOR ADV. CO.
 SIGN CONTRACTOR: DOURNEY OUTDOOR ADV. CO. STATE LICENSE # 7763 CITY LICENSE # 103
 PROPERTY OWNER'S NAME: DR. SOL T. DELVE ZONE: C-1

TYPE	SIZE	HEIGHT ZONE			VALUATION	PERMIT FEE
		Up to 30'	B Over 30' up to 50'	C Over 50'		
BILLBOARD - NON-ELECTRIFIED:						
Single faced freestanding	sq. ft. @	\$ 4.00	\$ 6.00	\$ 8.00	\$	\$
Single faced roof, marquee or projecting	<u>288</u> sq. ft. @	\$ 5.00	<u>\$ 7.00</u>	\$ 9.00	<u>\$ 2016</u>	<u>\$ 18⁰⁰</u>
Double faced or V-type freestanding	sq. ft. @	\$ 6.00	\$ 8.00	\$ 10.00	\$	\$
Double faced or V-type on roof, marquee or projected	sq. ft. @	\$ 8.00	\$ 10.00	\$ 12.00	\$	\$
NEON OR OTHER ELECTRIFIED:						
Single faced	sq. ft. @	\$ 12.00	\$ 14.00	\$ 16.00	\$	\$
Double faced	sq. ft. @	\$ 16.00	\$ 18.00	\$ 20.00	\$	\$
For sign not included above use construction valuation						
Political Signs						\$ 25.00
Sign 25 sq. ft. or less						\$ 5.00

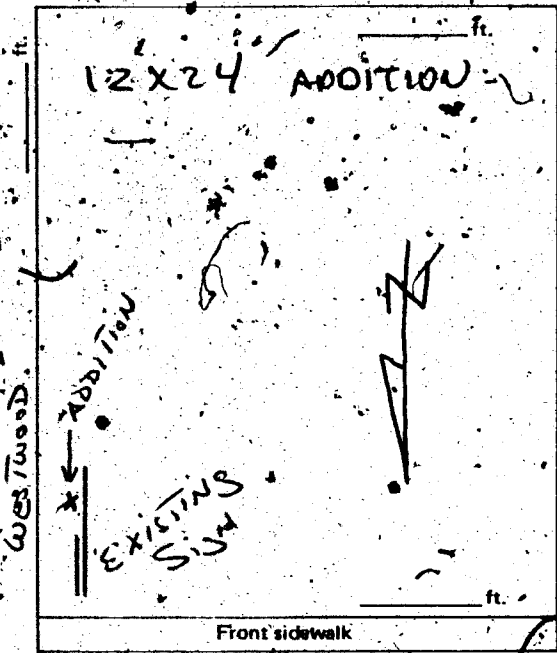

MATERIAL FOR SIGN:
 Metal Wood Plastic Other
 TYPE OF PROJECT:
 New Sign Replacement Relocation

CONDITION OF THE PERMIT:
 I hereby certify that I have carefully examined and read the above application; that the same is true and correct and that the work herein described is to be in accordance with all provisions of the applicable Ordinances of the City of Las Vegas and State Laws whether specified or not.

Signed: FOR DOURNEY OUTDOOR ADV. CO. Date: 1/7/76
 Master Sign Erector-Billboard Contractor

PLANNING DEPT. [Signature] Date: 1/2/76
 Approved based on sign questionnaire attached
 PUBLIC WORKS DEPT. [Signature] Date: 1-7
 BUILDING DEPT. [Signature] Date: 1-7-76
 PERMIT No. 150 PERMIT FEE \$ 18⁰⁰

5112 \$018.00 - 5
 RECEIPT
 CITY OF LAS VEGAS
 DEPT. OF BUILDING & SAFETY
 MUST BE MACHINE VALIDATED
 - 2-21-76

Thomas Kinako 3-26-81

DEPARTMENT OF BUILDING & SAFETY
CITY OF LAS VEGAS, NEVADA

KARDEX CARD
- SIGN

OWNER Dr. Sol T. DeLoe ADDRESS 1843 W. Charleston DATE: 1-7-76

CONTRACTOR Donrey Outdoor Adv. PERMIT NO. 50

LOT _____ BLOCK _____ SUBDIVISION _____

LOCATION _____	ELECT. ROUGH _____
SHOP (WIRING, CONST.) _____	ELECT. FINAL _____
SITE (BLDG., ETC.) _____	
INST. (SERV: STRUCT.) _____	
BILLBOARD _____	
ELECTRIFIED _____	
FINAL _____	

23.07 D ADDRESS 1843 W. Charleston LOG NO. _____ AREA _____

Handwritten mark