

1212 W. CHARLESTON

G. Gatewood 2-21-79

M-364
1970

PERMIT FEE \$ 5.00

CITY OF LAS VEGAS, NEVADA
DEPARTMENT OF BUILDING & SAFETY

SIGNS - APPLICATION & PERMIT
INSPECTION VALUATION: 500

ADDRESS OF Charleston Ave 550' 40'
CONSTRUCTION: Commercial

SIGN OWNER: Donkey Outdoor
STATE _____ CITY _____

SIGN CONTRACTOR: Donkey Outdoor

LICENSE # 7743 LICENSE # 103

PROPERTY OWNER'S NAME: Union Pacific R.R. Co

LOG NO. _____ PLANNING ZONE: M
& AREA _____

BILLBOARD TYPE (NON-ELECTRIFIED)	
Single face (If on roof, marquee or projecting - 2 times fee listed below)	
25 sq. ft. to 50 sq. ft.	\$4.00
51 sq. ft. to 300 sq. ft.	5.00
Over 300 sq. ft.	7.50
<u>5.00</u>	
Double faced or V-type (If on roof, marquee or projecting 2 times fee below)	
25 sq. ft. to 50 sq. ft.	\$6.00
51 sq. ft. to 300 sq. ft.	7.50
Over 300 sq. ft.	11.25
Plan check fee (If required)	\$20.00
Electric permit required	Yes No

SUB-SECTION "D" TYPE (ELECTRIFIED)

Material of Signs:
Metal () Wood () Plastic () Other ()

Type of Job:
New Sign Replacement Relocate

Rear width _____ Ft.

Wall or Marquee or single face	
_____ sq. ft. of display surface	\$12.00
Projecting or roof or double face	
_____ sq. ft. of display surface	\$15.00
Signs 25 sq. ft. & under min. fee	\$4.00
Signs Moving per each sign	\$5.00
Minimum permit fee	\$4.00
TOTAL PERMIT FEE	<u>5.00</u>

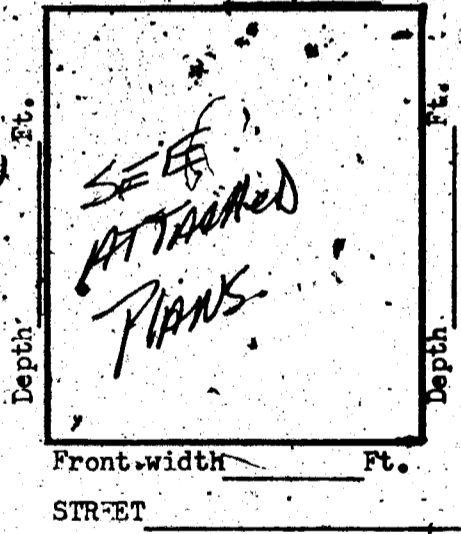

I hereby certify that I have carefully examined and read the above application; that the same is true & correct & that the work herein described is to be done in accordance with all the provisions of the applicable Ordinances of the City of Las Vegas and State laws whether specified or not.

Signed: Frank J. Keyser Date: _____
Master Neon/Elec. Billboard Contractor

APPROVED BY:

PLANNING DEPARTMENT: [Signature] DATE: 9-30-70

ENGINEERING DEPARTMENT: [Signature] DATE: 9-30

BUILDING DEPARTMENT: [Signature] DATE: 9-30-70

#12880 PERMIT NO. 55057 PERMIT FEE: 5.00
23.07

RECEIPT
789 \$005.00 - 5
CITY OF LAS VEGAS
DEPT. OF BUILDING & SAFETY
Must be machine validate
30 SEP 70

Gatewood 2-21-79

file
12/12 W. Chas

August 17, 1972

Arthur J. and Gertrude M. Borch
1212 Maryland Parkway
Las Vegas, Nevada 89104

Re: 2-62-72

At a regular meeting of the Board of City Commissioners held August 16, 1972, your application for reclassification of property generally located at 1212 South Maryland Parkway, on the northwest corner of Maryland Parkway and Norman Avenue, from R-1 to P-R was APPROVED as recommended by the Planning Commission, subject to the following conditions:

1. Resolution of intent be restricted to a twelve (12) months time limit.
2. Conformance to the plot plan.
3. Dedication of necessary rights-of-way and signing an agreement and posting a bond for the installation of off-site improvements as required by the Department of Public Works.
4. Conformance to the requirements of the Fire and Building Departments.
5. Landscaping shall be provided as required by the Planning Commission and shall be permanently maintained in a satisfactory manner. Failure to properly maintain required

21 Gatewood 2-21-79

Arthur J. and Gertrude M. Borch

August 17, 1972

Re: E-82-72

landscaping shall be cause for revocation of a business license.

Conformance to the requirements of the P-R Zone.

EDWINA M. COLE
CITY CLERK

EMC:dkk

- cc: Planning Department
- Public Works Department
- Fire Department
- Building Department

These Lynaks 3-26-81

DEPARTMENT OF BUILDING & SAFETY
CITY OF LAS VEGAS, NEVADA

KARDEX CARD
SIGN

OWNER Donrey Outdoor ADDRESS 1212 W. Charleston DATE 9/30/70

CONTRACTOR Same PERMIT NO. 55057

LOT _____ BLOCK _____ SUBDIVISION _____

LOCATION _____	ELECT. ROUGH _____
SHOP (WIRING, CONST.) _____	ELECT. FINAL _____
SITE (BLDG., ETC.) _____	
INST. (SERV: STRUCT.) _____	
BILLBOARD _____	
ELECTRIFIED _____	
FINAL <u>2-2-71</u>	

23.07 D ADDRESS 1212 W. Charleston LOG NO. M-364 AREA _____

1