

2505 Canosa

L 16 B4 Sub. Dowson Port TR. #2 Zone R-1

D. Gatewood 4-11-79

1-11-79

CITY OF LAS VEGAS, NEVADA

LOG NO. & AREA

CONST. VAL. \$

2100

DEPARTMENT OF PUBLIC SERVICES  
DIVISION OF BUILDING & SAFETY

APPLICATION & BUILDING PERMIT for:  
Fence, Wall, Retaining Wall.

ADDRESS OF CONSTRUCTION:

2505 Canosa

OWNER:

Wickman

LOT(s)

16

BLOCK

4

SUBDIVISION

Division Park Tr. 2

ZONE

R1

Materials of Construction:

Block

Concrete

Wire

Wood

Other

Yes

No

PLANS:

CALCS:

ARCHITECT:

2

ENGINEER:

CONTRACTOR:

owner

STATE LICENSE #

CITY LICENSE #

TOTAL SQUARE FEET:

TOTAL LINEAL FEET:

70'

Remarks:

CONDITIONS OF THE PERMIT:

- Any type of retaining wall must be engineered by a Civil or Structural Engineer.
- If a home owner takes out the Building Permit and the owner sublets the work to a Contractor, then the Contractor must take out the permit and pay for it.
- No fence or wall can be built on City property or rights-of-way, but this is not intended to preclude construction within utility easements if utilities will not be damaged or made inaccessible.
- The fence or wall shall not enclose any water meter, light standard, or fire alarm box and shall not come closer than 24" from the nearest fire hydrant outlet.
- Department Inspectors must approve footings before concrete is poured and block wall reinforcing before grouting is done.
- Maximum height of any wall or fence is 6', side and rear yards; 4' maximum in front yard with the vertical surface above the height of 2' — 50% open.
- It must not obstruct required on-site parking space (2 spaces for each dwelling unit) by the erection of this fence or wall.
- By the signing of this application I herewith agree to the requirements outlined above.

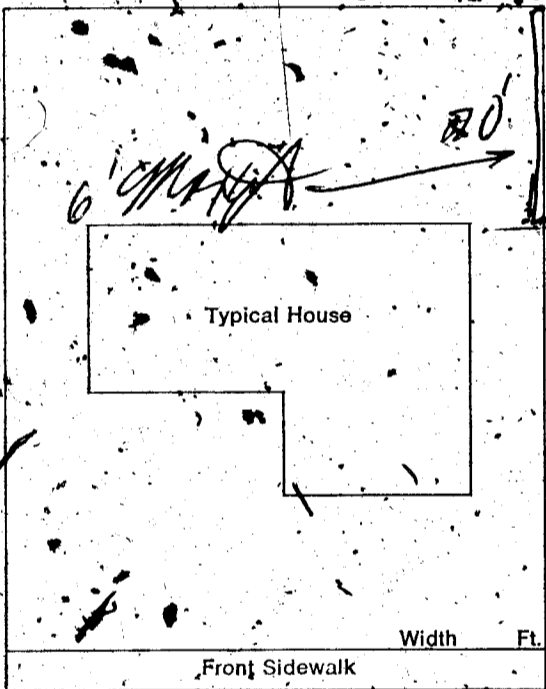

SIGNED:

DATE:

CONTRACTOR  AGENT  OWNER

PLANNING DEPT:

[Signature]

Date:

8-1-78

PUBLIC WORKS DEPT:

[Signature]

Date:

8-1-78

BUILDING DIVISION:

[Signature]

Date:

8-1-78

#12850

PERMIT NO:

8432

PERMIT FEE \$

50.00

RECEIPT

MUST BE MACHINE VALIDATED

*Shirley Reynolds 3/3/81*

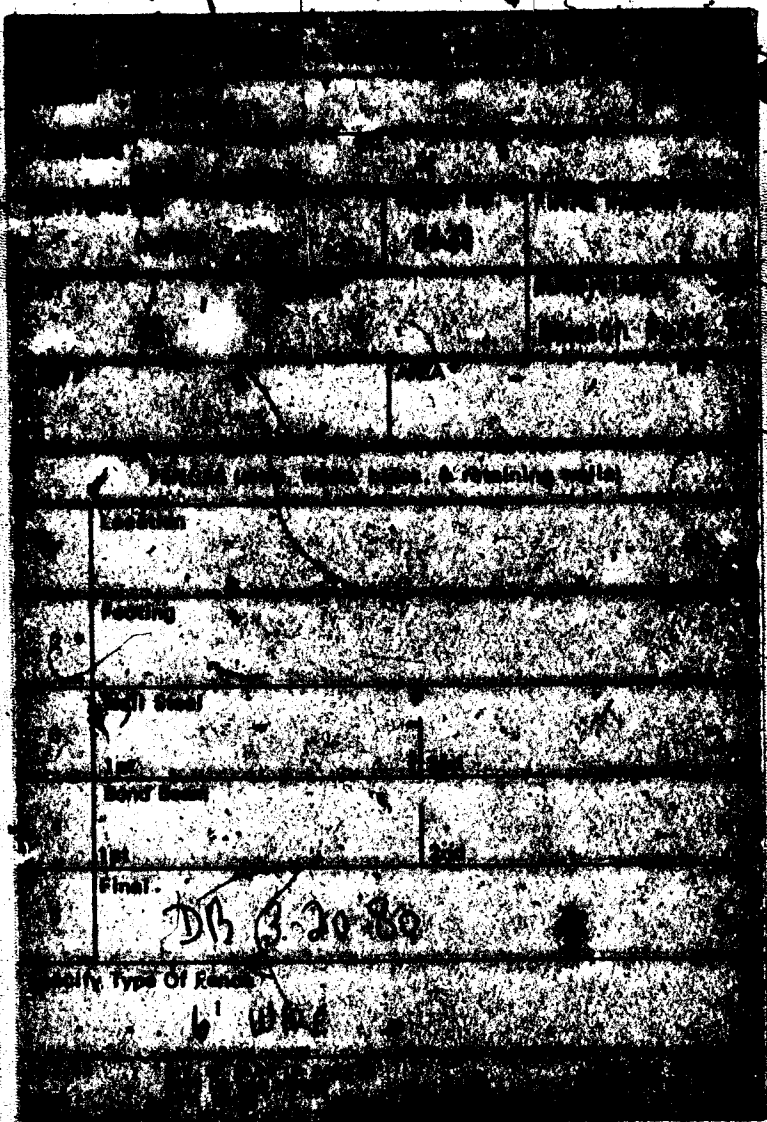

**DEPT. of BLDG. & SAFETY - CITY of LAS VEGAS, NEVADA**

OWNER WENDELL W. WEHRMAN ADDRESS 2505 Canosa Ave. DATE 2/13/61

GEN. CONT. OWNER TYPE OF STRUCTURE WOOD FENCE

PERMIT NO. 3159 LEGAL DESCRIPTION Lot 16, Bl. 4, Dawson Pk. #2

LOCATION _____ FIREPLACE FTG. _____ FOOTINGS _____ PILES _____ FOUND _____ PIERS _____ FLOOR _____ SLAB _____ ANCHOR BOLTS _____ BASE PLATES _____ WALL STEEL _____ COLUMN STEEL _____ BEAM STEEL _____ FRAMING _____ ROOF SHEATHING _____ STEEL FABRICATION _____ STEEL CONNECTION _____ INTEIOR _____ EXTERIOR _____ LATHING _____ BACKING SCRATCH _____ PLASTER BROWN _____ FINAL BLDG. _____ DATE _____ GRADING & DRAINAGE _____ ON-SITE PARKING _____ SPACES _____ ENG. APPROVAL OF _____ OFF-SITE IMPROVEMENTS _____	PLUMBING CONT. _____ PERMIT NO. _____ DATE _____ HEAT. & VENT. CONT. _____ PERMIT NO. _____ DATE _____ SEWER CONT. _____ PERMIT NO. _____ DATE _____ ROUGH SOIL _____ ROUGH WATER _____ TOP-OUT _____ ROUGH GAS _____ AC ROUGH DUCT _____ REF. ROUGH PIPING _____ SEWER _____ SEPIC TANK _____ FINAL PLUMBING _____ FINAL GAS _____ FINAL HEATING _____ FINAL AIR COND. _____ FINAL REFRIG. _____	TEMP. POLE CONT. _____ PERMIT NO. _____ DATE _____ INSPECTION _____ DATE _____ ELECTRICAL CONT. _____ PERMIT NO. _____ DATE _____ OUTLETS _____ MOTORS _____ H.P. _____ SLAB _____ ROUGH _____ FINAL ROUGH _____ FIXTURES CONT. _____ PERMIT NO. _____ DATE _____ FIXTURES _____ FINAL FIXTURE _____ URBAN REDEVELOPMENT APPROVAL _____ <input type="checkbox"/>
--	---	---

APPROVED FOR OCCURANCY W. W. Wehrman 2-16-62 INSPECTOR \_\_\_\_\_ DATE \_\_\_\_\_

APPROVED FOR METER \_\_\_\_\_

PLEASE NOTE REMARKS ON REVERSE SIDE 2505 Canosa Ave. LOG# \_\_\_\_\_ AREA: # \_\_\_\_\_ 23.04