

1121 Cahill Ave.

D. L. Lattwood May 27, 1980

### CITY OF LAS VEGAS, NEVADA

#### DEPARTMENT OF PUBLIC SERVICES - AIR CONDITIONING APPLICATION & PERMIT DIVISION OF BUILDING AND SAFETY

ADDRESS OF / CONSTRUCTION: 1121 Cahill Ave. OWNER'S NAME: US Homes

CIRCLE: Addition; Remodel; New Bldg. TYPE OF BLDG.: SFD APT. COMM. PUBLIC

CONTRACTOR'S NAME: Carl's Air Conditioning STATE LICENSE # 8370B CITY LICENSE # 230-2-10793

UNITS	DESCRIPTION	FEE	TOTAL	UNITS	DESCRIPTION	FEE	TOTAL
	Unit heater - floor, wall or suspended	4.00			EVAPORATIVE COOLERS:		
FOR EACH FORCED-AIR OR GRAVITY-TYPE FURNACE OR BURNER INCLUDING DUCTS AND VENT ATTACHED TO SUCH APPLIANCES:							
	Up to and including 100,000 B.t.u.'s	4.00			5 outlets or under	3.60	
	Over 100,000 B.t.u.'s	6.00			Over 5 and up to and including 10	5.00	
FOR EACH HEATING APPLICATION, REFRIGERATION UNIT, COMFORT COOLING AND HEATING UNIT, ABSORPTION UNIT, COMPRESSOR OR BOILER:							
	Up to and including 3 ton or horsepower, or absorption system up to and including 100,000 B.t.u.'s	4.00			For each additional outlet over 10	.25	
	Over 3 ton or 3 horsepower up to and including 10, or absorption system over 100,000 B.t.u.'s up to and including 250,000 B.t.u.'s	7.00	7.00	VENTILATION:			
	Over 10 ton or 10 horsepower up to and including 30, or absorption system over 250,000 B.t.u.'s up to and including 1,000,000 B.t.u.'s	12.00			For each fan connected to a single duct	1.00	
	Over 30 ton or 30 horsepower up to and including 50, or absorption system over 1,000,000 B.t.u.'s up to and including 1,700,000 B.t.u.'s	20.00			For each commercial or industrial ventilation system	5.00	
	Over 50 ton or 50 horsepower, or absorption system over 1,700,000 B.t.u.'s	30.00			For each commercial kitchen hood	5.00	
FOR EACH AIR HANDLING UNIT INCLUDING DUCTS AS SPECIFIED HERETO:							
	Up to and including 10,000 CFM	2.00		MISCELLANEOUS:			
	Over 10,000 CFM	4.00			For each water cooling tower	8.00	
					Dust work only - each opening	.25	
					For installation or relocation of each commercial or industrial incinerator	15.00	
					Gas piping related to the air cond. work in single family dwelling only	3.00	
					For each appliance, piece of equipment, any mechanical work or alteration or replacement not included in this schedule, the permit fee shall be computed the same as building permit fees by using the cost of installation for the valuation amount.		
				FOR THE ISSUANCE OF EACH PERMIT			3.00
				TOTAL PERMIT FEE \$ <b>10.00</b>			

I hereby certify that I have carefully examined and read the above application; that the same is true and correct, and that the work herein described is to be done in accordance with all the provisions of the applicable Ordinances of the City of Las Vegas, Nevada and the State Laws, whether herein specified or not.

Approval for the work under this permit will be given only after refuse and debris have been removed from job site and public right of way.

SIGNED Carl Brittle Date \_\_\_\_\_  
Air Conditioning Contractor - Owner

BUILDING DIVISION Josie Date 2/29/80

PERMIT NO. 066-27 PERMIT FEE \$ 10.00

RECEIPT  
  
  
  
  
  
  
  
  
  
  
MUST BE MACHINE VALIDATED

#12890

CITY OF LAS VEGAS, NEVADA

LOG NO. & AREA T12-A CONST. VAL. \$ 44,780.00

DEPARTMENT OF PUBLIC SERVICES  
DIVISION OF BUILDING AND SAFETY

APPLICATION & BUILDING PERMIT - for:  
Dwellings, Duplexes, Misc. Residential Const.

ADDRESS OF CONSTRUCTION: 1121 Cahill Ave. OWNER: U.S. Home Corporation

LOT(s) 22 BLOCK 3 SUBDIVISION Rainbow West Unit IV ZONE: R-1

Existing structure on lot: Dwelling  Accessory Bldgs.  Vacant lot  Other

PROPOSED CONSTRUCTION: SFD USE: RES

MATERIALS OF CONSTRUCTION: Wood Frame  Concrete Block  Reinforced Concrete  Steel Frame

SQUARE FEET OF FLOOR AREAS: 1st 1702 2nd \_\_\_\_\_ 3rd \_\_\_\_\_ Other 431 TOTAL SQ. FT. 2133

FIRE ZONE: 3 Occupancy Group R-3 CONST. TYPE: Frame & Stucco

ARCHITECT John Sherman ENGINEER: \_\_\_\_\_ NO. of UNITS 1 NO. of STORIES 1

Plans Submitted: Yes  No  Calculations Submitted Yes  No  Sewer Fee Req'd. Yes  No

CONTRACTOR: U. S. Home Corporation STATE LICENSE # 14506 CITY LICENSE # C11 17512

ADD'L. PERMITS REQ'D.: Air Cond.  Elec.  Plumbing  Signs  Paving  Fence  Public Walks  Curb gutters   
Incinerators  Fire Sprinkling System

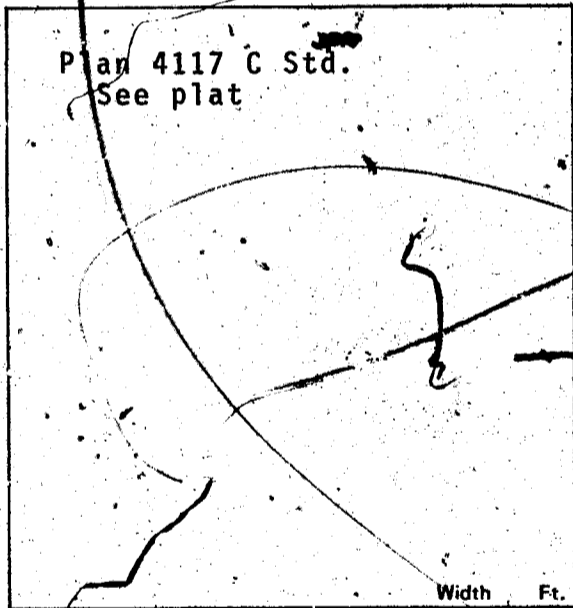

CONDITIONS OF THE PERMIT:

1. I agree to call the City Building Department for inspections before concrete is poured, before rough wiring, electrical, plumbing, framing is covered. Also for Air conditioning, drywall and sheathing inspection.
2. I agree that when the job is completed that I will call for final inspection before occupancy.
3. I agree to perform all construction in accordance with City Ordinances and Building Codes.
4. The Contractor's signature below denotes authority from the owner to sign in his behalf and that the owner is aware of all requirements of this application and permit. Separate permits must be taken out for work outlined above this agreement.
5. I have read and understand the contents of this application and permit; I hereby state that the information I have supplied on this application is true and correct.

Approval for the work under this permit will be given only after refuse and debris have been removed from job site and public right of way.

SIGNED: U. S. Home Corporation Contractor

BY: William T. Ode Agent or Owner

05/16/80

PLANNING DEPT.: J. Brown Date: 3/5/80  
PUBLIC WORKS DEPT.: Nail Date: 3-5-80  
BUILDING DIVISION: M.J. Date: 3-6-80  
PERMIT NO.: 2581 PERMIT FEE \$ 171.00

154-01-220

RECEIPT

MUST BE MACHINE VALIDATED

CITY OF LAS VEGAS, NEVADA

LOG NO. & AREA

T12-A

CONST. VAL. \$

44,780.00

DEPARTMENT OF PUBLIC SERVICES  
DIVISION OF BUILDING AND SAFETY

APPLICATION & BUILDING PERMIT - for:  
Dwellings, Duplexes, Misc. Residential Const.

ADDRESS OF  
CONSTRUCTION:

1121 Cahill Ave.

OWNER: U.S. Home Corporation

LOT(s)

22

BLOCK

3

SUBDIVISION

Rainbow West Unit IV

ZONE: R-1

Existing structure on lot:

Dwelling

Accessory Bldgs.

Vacant

Other

PROPOSED CONSTRUCTION:

SFD

USE: RES:

MATERIALS OF CONSTRUCTION:

Wood Frame

Concrete Block

Reinforced Concrete

Steel Frame

SQUARE FEET OF FLOOR AREAS:

1st 1702

2nd

3rd

Other 431

TOTAL SQ. FT. 2133

FIRE ZONE:

3

Occupancy Group

R-3

CONST. TYPE: Frame & Stucco

ARCHITECT

John Sherman

ENGINEER:

NO. of UNITS

1

NO. of STORIES

1

Plans Submitted:

Yes

No

Calculations Submitted

Yes

No

Sewer Fee Req'd.

Yes

No

CONTRACTOR:

U.S. Home Corporation

STATE LICENSE #

14506

CITY LICENSE #

C11 17512

ADD'L. PERMITS REQ'D.:

Air Cond.

Elec.

Plumbing

Signs

Paving

Fence

Public Walks

Curbs/gutters

Incinerators

Fire Sprinkling System

CONDITIONS OF THE PERMIT:

1. I agree to call the City Building Department for inspections before concrete is poured, before rough wiring, electrical, plumbing, framing is covered. Also for Air conditioning, drywall and sheathing inspection.
2. I agree that when the job is completed that I will call for final inspection before occupancy.
3. I agree to perform all construction in accordance with City Ordinances and Building Codes.
4. The Contractor's signature below denotes authority from the owner to sign in his behalf and that the owner is aware of all requirements of this application and permit. Separate permits must be taken out for work outlined above this agreement.
5. I have read and understand the contents of this application and permit; I hereby state that the information I have supplied on this application is true and correct.

Approval for the work under this permit will be given only after refuse and debris have been removed from job site and public right of way.

SIGNED: U.S. Home Corporation Contractor  
BY: William T. O'Connell Agent or Owner

05/16/80

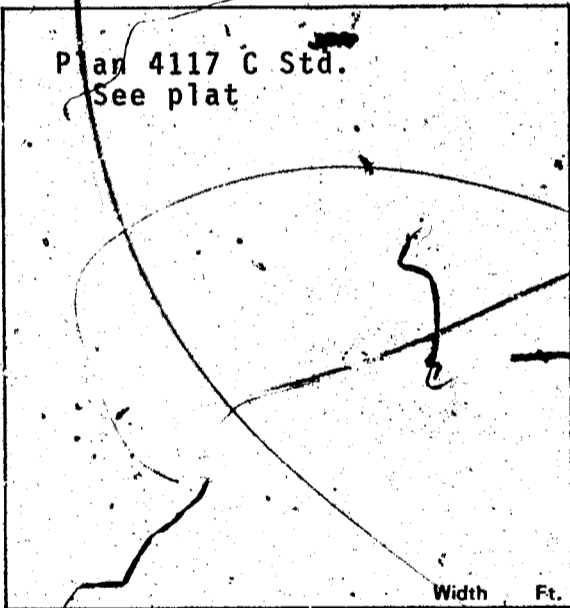

PLANNING DEPT.:

J. Brown

Date:

3/5/80

PUBLIC WORKS DEPT.:

Nail

Date:

3-5-80

BUILDING DIVISION:

nmj

Date:

3-6-80

PERMIT NO.:

2581

PERMIT FEE \$

171.00

154-01-220

RECEIPT

MUST BE MACHINE VALIDATED

D. Dated May 27, 1980

**CITY OF LAS VEGAS, NEVADA**  
**DEPARTMENT OF BUILDING & SAFETY**

**RECEIPT**  
**FOR**  
**SEWER CONNECTION FEE**

JOB ADDRESS: 1121 Cahill OWNER'S NAME: U.S. Homes

LOT \_\_\_\_\_ BLOCK \_\_\_\_\_ SUBDIVISION \_\_\_\_\_

QUANTITY	OCCUPANCY	UNIT FEE	AMOUNT
<u>1</u>	<u>Spd</u>		<u>250.00</u>

PAID BY: U.S. Home Corp

TOTAL 250.00

Less Credit\* \_\_\_\_\_

TOTAL FEE \$ 250.00

\*Credit for existing sewer is applied to the new sewer connection fee based on previous type of occupancy and only when the new occupancy requires an additional fee.

This receipt does not authorize the owner or his representative to start any work without obtaining a plumbing permit.

WR7  
DEPARTMENT OF BUILDING & SAFETY

5/13/80  
DATE

RECEIPT NO. 2581-1 SEWER FEE \$ 250.00

RECEIPT

MUST BE MACHINE VALIDATED

H. Haterwood May 27, 1980

PLUMBING

# CITY OF LAS VEGAS, NEVADA

DEPARTMENT OF PUBLIC SERVICES - PLUMBING APPLICATION & PERMIT  
DIVISION OF BUILDING AND SAFETY

ADDRESS OF CONSTRUCTION: 1124 Cahill Ave

OWNER'S NAME: J.S. Homes

CIRCLE: Addition; Remodel; New Bldg TYPE OF BLDG.: APT. COMM. PUBLIC

CONTRACTOR'S NAME: Town & Country Plumb STATE LICENSE # 015619 CITY LICENSE # 0146013

UNITS	DESCRIPTION	FEE	TOTAL
<b>PERMIT ISSUANCE</b>			
1	For Issuing Each Permit	7.00	7
	For Issuing Each Supplemental Permit	4.25	
<b>FIXTURE CHARGE</b>			
2	Bathtub	1.50	3
	Shower	1.50	
2	Laundry	1.50	3
2	Toilet	1.50	3
	Urinal	1.50	
	Floor Drain	1.50	
	Floor Sink	1.50	
	Wash-Tray	1.50	
	Sink	1.50	
	Garbage Disposal (residential)	1.50	
	Garbage Disposal (commercial)	5.50	
	Clothes Dryer (gas) (venting)	1.50	
	Clothes Washer (residential)	1.50	1.50
	Clothes Washer (commercial)	1.50	
	Dishwasher (residential)	1.50	1.50
	Dishwasher (commercial)	1.50	
	Dental Unit	1.50	
	Drinking Fountain	1.50	
	Refrigerator - Ice Maker, Water Dispenser	1.50	
	Any other water using equipment, Attached coffee Makers, Ice Makers	1.50	
1	Water Heaters (gas) (electric)	1.50	1.50
<b>SEWER SYSTEM</b>			
1	New, Replacement, Modification, or Any Drainage Work	7.50	7.50
	Grease or Sand Trap or Interceptor	2.00	
	Trailer Trap (rental parks)	3.50	
<b>WATER SOFTENERS</b>			
	Non Permanent Type (rental)	2.00	
	Permanent Type (connected to drain)	2.00	
<b>SWIMMING POOLS</b>			
	Private or Wading Pool (including spa)	15.00	
	Public or Semi-Public	25.00	
	Spas - Preformed (private)	10.00	
	Spas - Preformed (commercial)	15.00	
<b>WATER DISTRIBUTION SYSTEM</b>			
1	Single Family Dwelling	5.00	5.00
	Multi-Family Dwelling	5.00	
	Plus Each Dwelling Unit	2.50	
	Commercial Building per floor	3.00	
	Plus Each Unit (leased space or office)	6.00	

UNITS	DESCRIPTION	FEE	TOTAL
	Note: or Motel	6.00	
	Plus Each Unit	2.50	
	Trailer Park	25.00	
	Plus Each Space	1.50	
	Irrigation	6.00	
<b>FUEL PIPING SYSTEM</b>			
1	Single Family Dwelling	4.50	4.50
	Multi-Family Dwelling	8.00	
	Plus Each Unit	1.50	
	Commercial Building (per floor)	4.50	
	Plus Each Unit (leased space or office)	4.50	
	Medium Pressure Gas System (plan check)	6.00	
4	Each Gas Appliance (any type)	1.50	6.00
	Standby Emergency (generating engines)	2.50	
	Steam Boilers	2.50	
	Service Station Fuel Tank and Piping System	5.00	
		5.00	
<b>AUTOMATIC FIRE EXTINGUISHING SYSTEM</b>			
	Underground Piping	15.00	
	Distribution Piping (per foot)	.03	
	Sprinkler Head (each)	.15	
	In Range Hood and Vent	7.50	
	Dry Standpipe System	62.50	
	Piping	1.60	
	Each Outlet	7.50	
	Wet Standpipe System	1.50	
	Piping	2.50	
	Fire Hose Cabinet	2.50	
<b>SOLAR ENERGY SYSTEMS</b>			
	Collectors (including piping) (per collector)	2.50	
	Storage Tanks (each)	2.50	
<b>PIPELINE CONTRACT</b>			
	For Onsite Sewer, Gas or Water Contract Value. Fee based on Building Code Permit Valuation Chart.		
	Inspections for which no fee is specifically indicated (minimum charge one half hour)	7.50	7.50
	Additional plan review required by changes, additions or revisions to approved plans (minimum charge one half hour)	7.50	7.50

Plumbing permit fees may be computed the same as building permit fees by using the cost of installation for valuation amount when such work is not included in the above schedule.

I hereby certify that I have carefully examined and read the above application; that the same is true and correct; and that the work herein described is to be done in accordance with all the provisions of the applicable Ordinances of the City of Las Vegas, Nevada and the State Laws, whether herein specified or not.

Approval for the work under this permit will be given only after refuse and debris have been removed from job site and public right of way.

SIGNED Roger E. Hoel Date \_\_\_\_\_  
Registered Master Plumber, Spec. Cont'r or Owner

BUILDING DIVISION WB7 Date 5/27/80

PERMIT NO. 3689-2 PERMIT FEE \$ 46.00

RECEIPT

MUST BE MACHINE VALIDATED

#721 2463 (REV. 3/80)

43 50

D. Haterwood May 27, 1980

Plumb Lot 22

# CITY OF LAS VEGAS, NEVADA

DEPARTMENT OF PUBLIC SERVICES - PLUMBING APPLICATION & PERMIT  
DIVISION OF BUILDING AND SAFETY

ADDRESS OF CONSTRUCTION: 1124 Caball Ave

OWNER'S NAME: J.S. Homes

CIRCLE: Addition; Remodel; New Bldg TYPE OF BLDG.:  APT.  COMM.  PUBLIC

CONTRACTOR'S NAME: Town & Country Plumb STATE LICENSE # 015619 CITY LICENSE # 014013

UNITS	DESCRIPTION	FEE	TOTAL
<b>PERMIT ISSUANCE</b>			
1	For Issuing Each Permit	7.00	7
	For Issuing Each Supplemental Permit	4.25	
<b>FIXTURE CHARGE</b>			
2	Bath Tub	1.50	3
	Shower	1.50	
2	Laundry	1.50	3
2	Toilet	1.50	3
	Urinal	1.50	
	Floor Drain	1.50	
	Floor Sink	1.50	
	Wash-Tray	1.50	
1	Sink	1.50	1.50
	Garbage Disposal (residential)	1.50	
	Garbage Disposal (commercial)	5.50	
	Clothes Dryer (gas) (venting)	1.50	
1	Clothes Washer (residential)	1.50	1.50
	Clothes Washer (commercial)	1.50	
1	Dishwasher (residential)	1.50	1.50
	Dishwasher (commercial)	1.50	
	Dental Unit	1.50	
	Drinking Fountain	1.50	
	Refrigerator - Ice Maker, Water Dispenser	1.50	
	Any other water using equipment, Attached coffee Makers, Ice Makers	1.50	
1	Water Heaters (gas) (electric)	1.50	1.50
<b>SEWER SYSTEM</b>			
1	New, Replacement, Modification, or Any Drainage Work	7.50	7.50
	Grease or Sand Trap or Interceptor	2.00	
	*Trailer Trap (rental parks)	3.50	
<b>WATER SOFTENERS</b>			
	Non Permanent Type (rental)	2.00	
	Permanent Type (connected to drain)	2.00	
<b>SWIMMING POOLS</b>			
	Private or Wading Pool (including spa)	15.00	
	Public or Semi-Public	25.00	
	Spas - Preformed (private)	10.00	
	Spas - Preformed (commercial)	15.00	
<b>WATER DISTRIBUTION SYSTEM</b>			
1	Single Family Dwelling	5.00	5.00
	Multi-Family Dwelling	5.00	
	Plus Each Dwelling Unit	2.50	
	Commercial Building per floor	3.00	
	Plus Each Unit (leased space or office)	6.00	

UNITS	DESCRIPTION	FEE	TOTAL
	Note, or Motel	6.00	
	Plus Each Unit	2.50	
	Trailer Park	25.00	
	Plus Each Space	1.50	
	Irrigation	6.00	
<b>FUEL PIPING SYSTEM</b>			
1	Single Family Dwelling	4.50	4.50
	Multi-Family Dwelling	8.00	
	Plus Each Unit	1.50	
	Commercial Building (per floor)	4.50	
	Plus Each Unit (leased space or office)	4.50	
1	Medium Pressure Gas System (plan check)	6.00	
4	Each Gas Appliance (any type)	1.50	6.00
	Standby Emergency (generating engines)	2.50	
	Steam Boilers	2.50	
	Service Station Fuel Tank and Piping System	5.00	
		5.00	
<b>AUTOMATIC FIRE EXTINGUISHING SYSTEM</b>			
	Underground Piping	15.00	
	Distribution Piping (per foot)	.03	
	Sprinkler Head (each)	.15	
	In Range Hood and Vent	7.50	
	Dry Standpipe System	62.50	
	Piping	1.50	
	Each Outlet	7.50	
	Wet Standpipe System	1.50	
	Piping	2.50	
	Fire Hose Cabinet	2.50	
<b>SOLAR ENERGY SYSTEMS</b>			
	Collectors (including piping) (per collector)	2.50	
	Storage Tanks (each)	2.50	
<b>PIPELINE CONTRACT</b>			
	For Onsite Sewer, Gas or Water Contract Value. Fee based on Building Code Permit Valuation Chart.		
	Inspections for which no fee is specifically indicated (minimum charge - one half hour)	7.50 per hour	
	Additional plan review required by changes, additions or revisions to approved plans (minimum charge - one half hour)	7.50 per hour	

Plumbing permit fees may be computed the same as building permit fees by using the cost of installation for valuation amount when such work is not included in the above schedule.

I hereby certify that I have carefully examined and read the above application; that the same is true and correct; and that the work herein described is to be done in accordance with all the provisions of the applicable Ordinances of the City of Las Vegas, Nevada and the State Laws, whether herein specified or not.

Approval for the work under this permit will be given only after refuse and debris have been removed from job site and public right of way.

SIGNED Roger E. Haef Date \_\_\_\_\_  
Registered Master Plumber, Spec. Cont'r or Owner

BUILDING DIVISION WB7 Date 5/27/80

PERMIT NO. 2689-2 PERMIT FEE \$ 46.00

#1721 2463 (REV. 3/79)

RECEIPT

MUST BE MACHINE VALIDATED

40.00

Lotwood June 9, 1980

# CITY OF LAS VEGAS, NEVADA

DEPARTMENT OF PUBLIC SERVICES — ELECTRICAL APPLICATION & PERMIT  
DIVISION OF BUILDING AND SAFETY

ADDRESS OF CONSTRUCTION: 1121 Cahill Ave. OWNER'S NAME: U.S. HOMES, INC.

CIRCLE: Addition; Remodel; New Bldg. TYPE OF BLDG.: SED APT. COMM. PUBLIC

CONTRACTOR'S NAME: ANDERSON ELECTRIC STATE LICENSE # 10997 CITY LICENSE # 090-2-00350

UNITS	DESCRIPTION	FEE	TOTAL
75	Receptacles 38 Outlets Switches 21	.30	22.50
	Wall or Ceiling Space Heaters	.50	
	Blast Coil Heaters (per kilowatt)	.35	
1	Garbage Grinder Outlet	.50	.50
	Trash Compactor	.35	
1	Dishwasher Outlet	.50	.50
1	Clothes Dryer Outlet	.50	.50
1	Automatic Clothes Washer Outlet	.50	.50
	Electric Range	.50	
1	Electric Water Heater	.50	.50
17	Each Fixture or Socket	.15	2.55
	Each Mercury Arc Lamp and Equipment (sodium)	.50	
	Each Special Purpose Outlet	.50	
	Each X-ray Unit and its Appurtenances	7.50	
	Area Lighting—First 3000 Watts	6.00	
	For Each Additional 1000 Watts	2.25	
	Total Horsepower Each Motor—Generator, Transformer, Welder		
	First Horsepower or KVA	2.50	
	For Each Additional Horsepower up to 50	.40	
	For Each Horsepower over 50	.15	
	Temporary Power and Lights — Temporary Pole	5.00	
1	Electric Service, Including First Meter Socket	4.50	4.50
	For Each Additional Meter Socket	.40	
	Services over 200 to 600 Amperes	6.25	
	600 to 1200 Amperes	12.50	
	over 1200 Amperes	25.00	
	Sub Panel	1.50	
1	Permanently Connected Air Conditioning Service (Heating/Cooling)	2.25	2.25
	Speaker Outlets	.20	
2	Signal or Alarm Outlets	.25	.50
	Amplifiers	1.25	
	Control Panels	.35	
	T.V. Outlets — Master System Only	.30	
	Swimming Pool (residential)	10.00	
	Swimming Pool (commercial)	15.00	
	Spas	4.00	
	Recreational Vehicles (per space)	1.50	
	Busways—for Trolley and Plug-in Type Busways, Each 100 Feet or Fraction Thereof	1.50	
1	Fee for issuing Each Permit	7.00	7.00

Other inspections and fees: 1. Inspections outside of normal business hours = \$7.50 per hour (minimum charge two hours). 2. Re-inspection fee assessed under provisions of Section 305(h) of the Uniform Building Code = \$7.50 per hour. 3. Inspections for which no fee is specifically indicated = \$7.50 per hour (minimum charge one half hour). 4. Additional plan review required by changes, additions or revisions to approved plans = \$7.50 per hour (minimum charge one half hour).

Approval for the work under this permit will be given only after refuse and debris have been removed from job site and public right of way.

I hereby certify that I have carefully examined and read the above application; that the same is true and correct; and that the work herein described is to be done in accordance with all the provisions of the applicable Ordinances of the City of Las Vegas, Nevada and the State Laws, whether herein specified or not.

SIGNED: [Signature] Date 5-7-80  
 Master (Electrician) (Technician) (Owner) #26  
 BUILDING DIVISION: Toxic Date 6/9/80  
 PERMIT NO. 3062-1 PERMIT FEE \$ 41.00

#1721-2402 (REV. 3-80)

**RECEIPT**

MUST BE MACHINE VALIDATED

Therese Kyriakos 3-2-81

OWNER <u>U.S. Homes Corp.</u> ADDRESS <u>1121 Cahill Ave</u>	
DATE <u>5-16-80</u>	GEN. CONT. <u>U.S. Home Corp.</u>
TYPE OF STRUCTURE <u>SIP</u> <u>2581</u>	PERMIT NO. <u>2581</u> FINAL INSPECTION
LEGAL DESCRIPTION <u>B-22 B-3</u>	LOG # AREA #
APPROVED FOR OCCUPANCY & METER	
BUILDING	MECHANICAL
Investigation	Plumbing Cont. <u>Louis Pamb</u>
Location & Footing <u>FC 5-19-80</u>	Permit No. <u>2609</u> Date <u>5-25-80</u>
Concrete Slab Floor <u>FC 5-22-80</u>	Heat & Vent. A/C Cont. <u>Carla</u>
Fireplace Footing	Permit No. <u>1606</u> Date <u>2-28-80</u>
Chimney Steel	Sewer Cont. <u>U.S. Home Corp.</u>
Vert. Steel Reinf.	Permit No. <u>2581-1</u> Date <u>5-15-80</u>
Horiz. Steel Reinf.	Rough Soil <u>MIC 5-22-80</u>
Framing <u>FC 6-13-80</u>	Rough Water
Ext. Lath <u>FC 6-14-80</u>	Top Out <u>M.C. 6-12-80</u>
Ext. Brown	Rough Gas <u>M.C. 6-13-80</u>
Drywall <u>FC 6-24-80</u>	A/C Rough Duct <u>M.C. 6-13-80</u>
Final Building <u>FC 7-17-80</u>	Final Plumbing <u>9/7-17-80</u>
Appr. for Occu	Final Gas <u>9/7-17-80</u>
ELECTRICAL	Final Air Cond <u>9/7-17-80</u>
Temp. Pole Cont.	Final Sewer <u>MIC 5-22-80</u>
Permit No. Date	REMARKS
Inspection Date	
Electrical Cont. <u>Indran</u>	
Permit No. <u>3062</u> Date <u>6-9-80</u>	
Rough <u>MIC 6-16-80</u>	PLEASE NOTE ADDITIONAL REMARKS ON REVERSE SIDE.
Final Rough	DIV. OF BLDG. & SAFETY
Final Electrical <u>RP 7-17-80</u>	CITY OF LAS VEGAS
Temporary Service	REV. 10-78
	79-3-16

Theresa Kymalos 3-2-81

1. Roof Sheathing FC 6-10-80  
Insulation FC 6-17-80

P.H. 2581

SPILLIE B

6/13/86

# CITY OF LAS VEGAS, NEVADA

LOG NO. & AREA \_\_\_\_\_ DATE 03A-452-086 CONST. VAL. \$ 1,035.00

DEPARTMENT OF BUILDING AND SAFETY PHONE 386-6251 **DEVELOPMENT PERMIT AND BUILDING PERMIT**  
FOR: Fence, Wall, Retaining Wall

ADDRESS OF CONSTRUCTION 1127 Cahill OWNER LAE WOODIE

CONTRACTOR Blackman Masonry STATE LICENSE NO. 14598 LICENSE NO. \_\_\_\_\_

LOT(S) 22 BLOCK 3 SUBDIVISION Rainbow West A 4 ZONE R1

PROPOSED CONSTRUCTION: BUILDING PERMIT NO. 8228 ENGINEER \_\_\_\_\_

Approval for the work under this permit will be given only after refuse and debris have been removed from job site and public right of way.

Remarks:  
\_\_\_\_\_  
\_\_\_\_\_  
\_\_\_\_\_

TOTAL SQUARE FEET: 414A TOTAL LINEAL FEET: 69'

### OTHER INSPECTIONS AND FEES

1. Inspections outside of normal business hours = \$25.00 per hour (minimum charge three hours)
2. Re-inspection fee during normal business hours assessed under provisions of TABLE 3-A of the Uniform Building Code = \$45.00 each
3. Inspections during normal business hours for which no fee is specifically indicated = \$15.00 per hour (minimum charge one half hour)
4. Additional plan review required by changes, additions or revisions at approved plans = \$25.00 per hour (minimum charge two hours)

### CONDITIONS OF THE PERMIT:

1. Any type of retaining wall must be engineered by a Civil or Structural Engineer.
2. If a home owner takes out the Building Permit and if the owner sublets the work to a Contractor, then the Contractor must take out the permit and pay for it.
3. No fence or wall can be built on City property or rights-of-way, but this is not intended to preclude construction within utility easements if utilities will not be damaged or made inaccessible.
4. The fence or wall shall not enclose any water meter, light standard, or fire alarm box and shall not come closer than 24" from the nearest fire hydrant outlet.
5. Department Inspectors must approve footings before concrete is poured and block wall reinforcing before grouting is done.
6. Maximum height of any wall or fence is 6' side and rear yards; 4' maximum in front yard with the vertical surface above the height of 2' — 50% open.
7. It must not obstruct required onsite parking space (2' spaces for each dwelling unit) by the erection of this fence or wall.
8. By the signing of this application I herewith agree to the requirements outlined above.

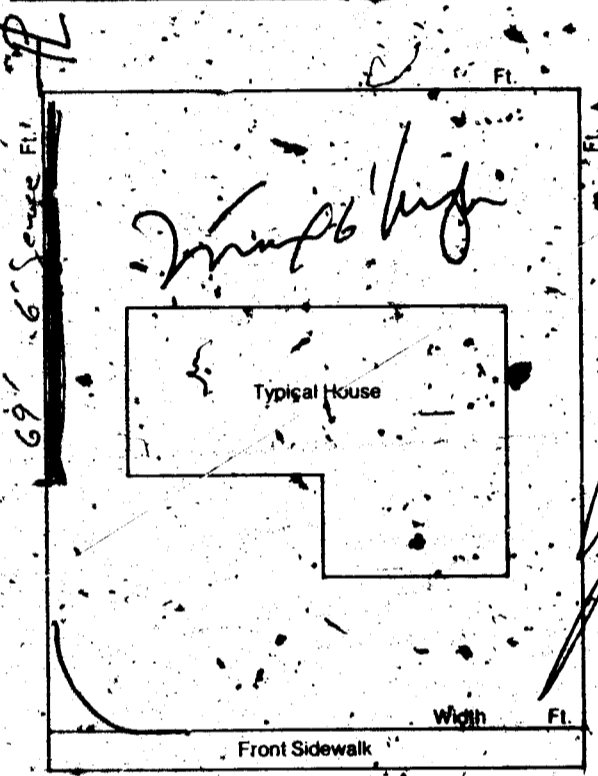

2310-2401

06/13/86

### RECEIPT

\*\*0004\*\*  
 WALL 32.50  
 CHEK 32.50  
 8228A000 14:09

Signed \_\_\_\_\_ CONTRACTOR - AGENT - OWNER

PLANNING DEPT. \_\_\_\_\_ DATE 6/13/86

BUILDING DEPT. \_\_\_\_\_ DATE 6/13/86

I hereby certify that I have reviewed this application and the proposed plans and have found that the proposed development meets the requirements of the City of Las Vegas Flood Hazard Reduction Ordinance for the issuance of this Development Permit.

\_\_\_\_\_  
LAND DEVELOPMENT AND FLOOD CONTROL ENGINEER DATE 6/13/86

PLAN REVIEW FEE \_\_\_\_\_  
 PERMIT FEE 32.50  
 TOTAL FEES \_\_\_\_\_

MUST BE MACHINE VALIDATED

3/83 Permit Expires 180 Days After Abandonment of Work,

Debbie Ingram 8-15-86

FENCE & RETAINING WALLS

OWNER Woollee, Tai		DATE 6-16-86
ADDRESS 1121 Cahill		
CONTRACTOR Blockman Masonry		PERMIT NO. 8228
FINAL INSPECTION		
LOT	BLOCK	SUBDIVISION
LOG #	AREA	
FENCES (wire, wood, block, & retaining walls)		
1	Location	
2	Footing	
3	Wall Step	
	1st	2nd
4	Bond Beam	
	1st	2nd
5	Final	
Specify Type Of Fence		
2-1-85 DIV. OF BLDG. & SAFETY CITY OF LAS VEGAS REV. 10-78		

*6-16-86*

*B.M. 7-1-86*