

4033 EVENING BREEZE CT

LOT 3 BLK N SUB SUNDOWN #1 ZONE PUD

Sharon Pereira 4-25-79

CITY OF LAS VEGAS, NEVADA

LOG NO. & AREA T-32-4 DEPARTMENT OF BUILDING & SAFETY APPLICATION & BUILDING PERMIT - for: Dwelling, Duplexes, Misc. Residential Const. CONST. VAL. \$ 16,560.00

ADDRESS OF CONSTRUCTION: 4033 Evening Breeze Court OWNER: Laketree

LOT(s) 3 BLOCK N SUBDIVISION Sundown #1 ZONE: P.U.D.

Existing structure on lot: Dwelling [] Accessory bldgs. [] Vacant lot [] Other []

PROPOSED CONSTRUCTION: (1) Single family dwelling USE: Resid:

MATERIALS OF CONSTRUCTION: Wood Frame [x] Concrete Block [] Reinforced Concrete [] Steel Frame [x]

SQ. FEET OF FLOOR AREAS: 1st 650 2nd 660 3rd Other 303 TOTAL SQ. FT. 1,310

FIRE ZONE: 1 2 (3) Occupancy Group (1) 1-2 CONST. TYPE: I II III IV (V)

ARCHITECT: L. J. ... ENGINEER: NO. of UNITS 1 NO. of STORIES 2

Plans Submitted: Yes [x] No [] Calculations Submitted Yes [] No [] Sewer Fee Req'd. Yes [x] No []

CONTRACTOR: Chequer, Inc. STATE LICENSE # 11114 CITY LICENSE # 7358

ADD'L. PERMITS REQ'D: Air Cond. [x] Elec. [x] Plumbing [x] Signs [] Paving [] Fence [] Public Walks [] Curb-gutters [] Incinerators [] Fire Sprinkling System []

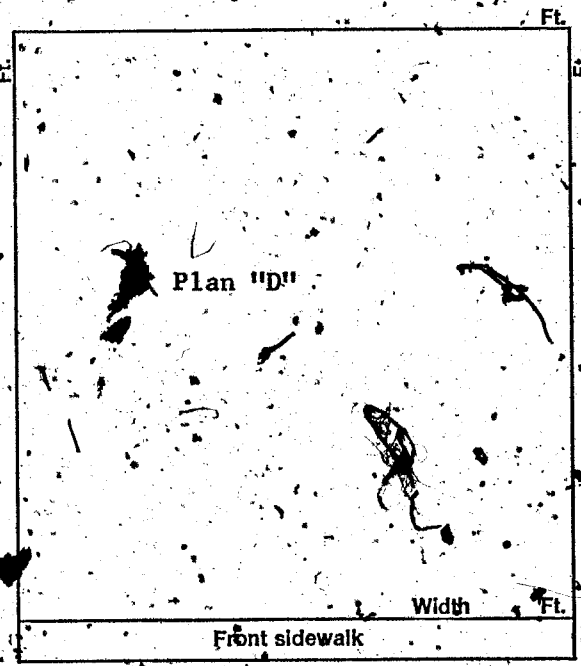

CONDITIONS OF THE PERMIT:

- 1. I agree to call the City Building Department for inspections before concrete is poured, before rough wiring, electrical, plumbing, framing is covered. Also for air conditioning, sheet-rock and sheathing inspection.
2. I agree that when the job is completed that I will call for final inspection before occupancy.
3. I agree to perform all construction in accordance with City Ordinances and Building Codes.
4. The Contractor's signature below denotes authority from the owner to sign in his behalf and that the owner is aware of all requirements of this application and permit. Separate permits must be taken out for work outlined above this agreement.
5. I have read and understand the contents of this application and permit; hereby state that the information I have supplied on this application is true and correct.

SIGNED: [Signature] Contractor Agent, or Owner

Date: [] Date: [] CLARK COUNTY HEALTH DEPT. LAS VEGAS FIRE DEPARTMENT

PLANNING DEPT.: [Signature] Date: 3/28/73

PUBLIC WORKS DEPT.: [Signature] Date: 3-28

BUILDING DEPT.: [Signature] Date: 3/29/73

#12850 PERMIT NO.: 10253 PERMIT FEE \$ 70.00

RECEIPT 3468 \$070.00 - 8 CITY OF LAS VEGAS DEPT. OF BUILDING & SAFETY MUST BE MACHINE VALIDATED - 2 APR 73

Sharon Perera, 4-25-79

CITY OF LAS VEGAS, NEVADA

LOG NO. & AREA T-32-4

CONST. VAL. \$ 16,560.00

DEPARTMENT OF BUILDING & SAFETY

APPLICATION & BUILDING PERMIT — for: Dwellings, Duplexes, Misc. Residential Const.

ADDRESS OF CONSTRUCTION: 4033 Evening Breeze Court

OWNER: Laketree

LOT(s) 3 BLOCK N SUBDIVISION Sundown #1

ZONE: P.U.D.

Existing structure on lot: Dwelling Accessory bldgs. Vacant lot Other

PROPOSED CONSTRUCTION: (1) Single family dwelling USE: Resid:

MATERIALS OF CONSTRUCTION: Wood Frame Concrete Block Reinforced Concrete Steel Frame

SQ. FEET OF FLOOR AREAS: 1st 650 2nd 660 3rd Other 303 TOTAL SQ. FT. 1,310

FIRE ZONE: 1 2(3) Occupancy Group (1) 1-2 CONST. TYPE: I II III IV (V)

ARCHITECT: L. M. ... ENGINEER: NO. of UNITS 1 NO. of STORIES 2

Plans Submitted: Yes No Calculations Submitted Yes No Sewer Fee Req'd. Yes No

CONTRACTOR: Chequer, Inc. STATE LICENSE # 11114 CITY LICENSE # 7358

ADD'L. PERMITS REQ'D: Air Cond. Elec. Plumbing Signs Paying Fence Public Walks Curb-gutters Incinerators Fire Sprinkling System

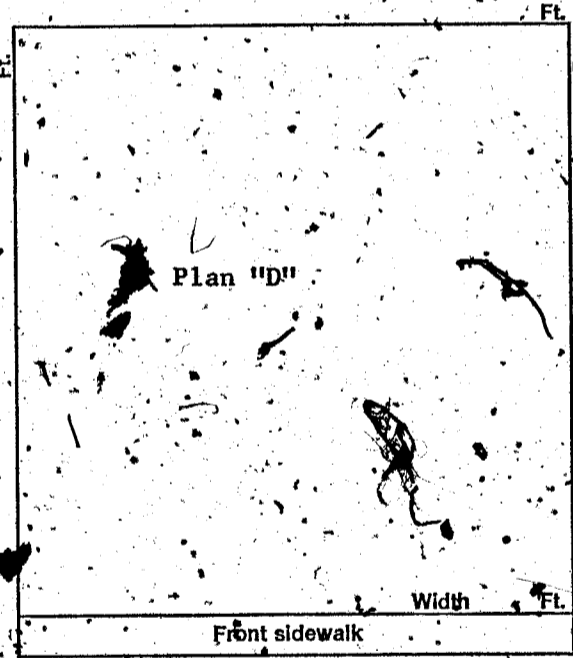

CONDITIONS OF THE PERMIT:

- 1. I agree to call the City Building Department for inspections before concrete is poured, before rough wiring, electrical, plumbing, framing is covered. Also for air conditioning, sheet-rock and sheathing inspection.
2. I agree that when the job is completed that I will call for final inspection before occupancy.
3. I agree to perform all construction in accordance with City Ordinances and Building Codes.
4. The Contractor's signature below denotes authority from the owner to sign in his behalf and that the owner is aware of all requirements of this application and permit. Separate permits must be taken out for work outlined above this agreement.
5. I have read and understand the contents of this application and permit; I hereby state that the information I have supplied on this application is true and correct.

SIGNED: Contractor

Agent, or Owner

*CLARK COUNTY HEALTH DEPT. Date
LAS VEGAS FIRE DEPARTMENT Date

PLANNING DEPT.: Date: 3/28/73

PUBLIC WORKS DEPT.: Date: 3/28

BUILDING DEPT.: Date: 3/29/73

#12850 PERMIT NO.: 10253 PERMIT FEE \$ 70.00

RECEIPT
3468 - \$070.00 - 8
CITY OF LAS VEGAS
DEPT. OF BUILDING & SAFETY
MUST BE MACHINE VALIDATED
- 2 APR 73

Sharon Perera 4-25-79

CITY OF LAS VEGAS, NEVADA
DEPARTMENT OF BUILDING & SAFETY
**RECEIPT
FOR
SEWER CONNECTION FEE**

JOB ADDRESS: 4033 Evening Breeze Court OWNER'S NAME: Laketree

LOT 3 BLOCK N SUBDIVISION Sundown #1

QUANTITY	OCCUPANCY	UNIT FEE	AMOUNT
1	Single family dwelling	\$150.00	\$150.00

PAID BY: Laketree
Chiquet Inc

TOTAL	\$150.00
Less Credit*	- 0 -
TOTAL FEE \$	150.00

*Credit for existing sewer is applied to the new sewer connection fee based on previous type of occupancy and only when the new occupancy requires an additional fee.

This receipt does not authorize the owner or his representative to start any work without obtaining a plumbing permit.

wrt 3/14/73
DEPARTMENT OF BUILDING & SAFETY DATE

RECEIPT NO. 9482 SEWER FEE \$ 150.00

73102

RECEIPT
3435 \$150.00 - 3
CITY OF LAS VEGAS
DEPT. OF BUILDING & SAFETY
MUST BE MACHINE VALIDATED
- 2 APR 73

Sharon Perera 4-25-79

**CITY OF LAS VEGAS, NEVADA
DEPARTMENT OF BUILDING & SAFETY — APPLICATION AND PERMIT FOR PLUMBING**

ADDRESS OF CONSTRUCTION: 4033 Evening Breeze Court OWNER'S NAME: Cheger, Inc.
 CIRCLE: New Bldg. Add'n.; Remodel; TYPE OF BLDG.: SFD. APT. PUBLIC COMM.
 CONTRACTOR'S NAME: A & B Plumbing & Heating Company STATE LICENSE # 2769 CITY LICENSE # 11305 C11-517-2

UNITS	DESCRIPTION	FEE	TOTAL
1	Bathub	1.00	1.00
	Shower	1.00	
3	Lavatory	1.00	3.00
2	Toilet	1.00	2.00
	Urinal	1.00	
	Floor Drain	1.00	
	Floor Sink	1.00	
	Wash Tray	1.00	
1	Sink	1.00	1.00
1	Garbage Disposal	1.00	1.00
	Garbage Disposal (comm.)	3.00	
	Clothes Dryer (gas)	1.00	
1	Clothes Washer	1.00	1.00
	Clothes Washer (comm.)	5.00	
1	Dishwasher	1.00	1.00
	Dishwasher (commercial)	5.00	
	Dental Unit	10.00	
	Drinking Fountain	1.00	
	Any Water using Equipment	1.00	
1	Water Heater (gas) (elect.)	1.00	1.00
1	Sewer System — New, Replacement, or any Drainage System	4.00	4.00
	Grease or Sand Trap	2.00	
	Trailer Trap	2.00	
	Septic Disposal System	4.00	
WATER SOFTENERS			
	Nonpermanent Type	4.00	
	Permanent Type (connected to Drainage)	5.00	
SWIMMING POOLS			
	Private or Wading Pool	10.00	
	Public or Semi-public	20.00	

UNITS	DESCRIPTION	FEE	TOTAL
WATER DISTRIBUTION SYSTEM			
1	Single Family Dwelling	4.00	4.00
	Multiple Family Dwelling plus each unit	4.00 2.00	
	Bldg. Group "A" thru "G" per each floor	6.00	
	Hotel or Motel plus each bath	4.00 1.50	
	Trailer Park plus each space	80.00 1.00	
	Irrigation	4.00	
GAS PIPING SYSTEM			
1	Single Family Dwelling	3.00	3.00
	Multiple Family Dwelling plus each unit	6.00 1.00	
	Commercial Bldg. per floor plus each unit	3.00 3.00	
2	Gas Appliance (any type)	1.00	2.00
AUTOMATIC FIRE EXTINGUISHING SYSTEM			
	Underground Piping	10.00	
	Distribution Piping ea. ft.	.01	
	Sprinkler Head each	.10	
	In Range Hood and Vent	5.00	
DRY STANDPIPE SYSTEM			
	Piping	50.00	
	Each Outlet	1.00	
WET STANDPIPE SYSTEM			
	Piping	5.00	
	Fire Hose Cabinet	1.00	
MINIMUM PERMIT FEE			
		4.00	
PIPELINE CONTRACTOR, SECT. 14-B.P.F.			
TOTAL PERMIT FEE \$ 24.00			

I hereby certify that I have carefully examined and read the above application; that the same is true and correct; and that the work herein described is to be done in accordance with all the provisions of the applicable Ordinances of the City of Las Vegas, Nevada and the State Laws, whether herein specified or not.

Signed: [Signature] Date: 4/17/73
REGISTERED MASTER PLUMBER, SPEC. CONTR. OR OWNER
 Building Department: [Signature] Date: _____
 #12870 Permit No. 9880 Permit Fee \$ 24.00

RECEIPT

#731 \$024.00 — 7

CITY OF LAS VEGAS
 DEPT. OF BUILDING & SAFETY
 MUST BE MACHINE VALIDATED
 2.0 APR 73

Sharon Peraza 4-25-79

CITY OF LAS VEGAS, NEVADA
 DEPARTMENT OF BUILDING & SAFETY — APPLICATION AND PERMIT FOR PLUMBING

ADDRESS OF CONSTRUCTION: 4033 Evening Breeze Court OWNER'S NAME: Cheqez, Inc.

CIRCLE: (New Bldg.) Add'n.; Remodel; TYPE OF BLDG.: SFD. APT. PUBLIC COMM.

CONTRACTOR'S NAME: A & B Plumbing & Heating Company STATE LICENSE # 2769 CITY LICENSE # 11305 C11-517-2

UNITS	DESCRIPTION	FEE	TOTAL
1	Bathtub	1.00	1.00
	Shower	1.00	
3	Lavatory	1.00	3.00
2	Toilet	1.00	2.00
	Urinal	1.00	
	Floor Drain	1.00	
	Floor Sink	1.00	
	Wash Tray	1.00	
1	Sink	1.00	1.00
1	Garbage Disposal	1.00	1.00
	Garbage Disposal (comm.)	3.00	
	Clothes Dryer (gas)	1.00	
1	Clothes Washer	1.00	1.00
	Clothes Washer (comm.)	5.00	
1	Dishwasher	1.00	1.00
	Dishwasher (commercial)	5.00	
	Dental Unit	10.00	
	Drinking Fountain	1.00	
	Any Water using Equipment	1.00	
1	Water Heater (gas) (elect.)	1.00	1.00
1	Sewer System — New, Replacement, or any Drainage System	4.00	4.00
	Grease or Sand Trap	2.00	
	Trailer Trap	2.00	
	Septic Disposal System	4.00	
WATER SOFTENERS			
	Nonpermanent Type	4.00	
	Permanent Type (connected to Drainage)	5.00	
SWIMMING POOLS			
	Private or Wading Pool	10.00	
	Public or Semi-public	20.00	

UNITS	DESCRIPTION	FEE	TOTAL
WATER DISTRIBUTION SYSTEM			
1	Single Family Dwelling	4.00	4.00
	Multiple Family Dwelling plus each unit	4.00	
	Bldg. Group "A" thru "G" per each floor	2.00	
	Hotel or Motel plus each bath	6.00	
	Trailer Park plus each space	4.00	
	Irrigation	1.50	
		80.00	
		1.00	
		4.00	
GAS PIPING SYSTEM			
1	Single Family Dwelling	3.00	3.00
	Multiple Family Dwelling plus each unit	6.00	
	Commercial Bldg. per floor plus each unit	1.00	
		3.00	
		3.00	
2	Gas Appliance (any type)	1.00	2.00
AUTOMATIC FIRE EXTINGUISHING SYSTEM			
	Underground Piping	10.00	
	Distribution Piping ea. ft.	.01	
	Sprinkler Head each	.10	
	In Range Hood and Vent	5.00	
DRY STANDPIPE SYSTEM			
	Piping	50.00	
	Each Outlet	1.00	
WET STANDPIPE SYSTEM			
	Piping	5.00	
	Fire Hose Cabinet	1.00	
MINIMUM PERMIT FEE			
		4.00	
PIPELINE CONTRACTOR; SECT. 14 B.P.F.			
		20.00	
TOTAL PERMIT FEE \$ 24.00			

I hereby certify that I have carefully examined and read the above application; that the same is true and correct; and that the work herein described is to be done in accordance with all the provisions of the applicable Ordinances of the City of Las Vegas, Nevada and the State Laws, whether herein specified or not.

Signed: *[Signature]* Date: 4/17/73
 REGISTERED MASTER PLUMBER, SPEC. CONTR. OR OWNER
 Building Department: *[Signature]* Date: _____
 #12870 Permit No. 9880 Permit Fee \$ 24.00

RECEIPT
 4731 \$024.00 - 7
 CITY OF LAS VEGAS
 DEPT. OF BUILDING & SAFETY
 MUST BE MACHINE VALIDATED
 20 APR 73

Sharon Perera 4-25-79

CITY OF LAS VEGAS, NEVADA

PLAN D

DEPARTMENT OF BUILDING & SAFETY - ELECTRICAL APPLICATION & PERMIT

ADDRESS OF CONSTRUCTION: 4033 Evening Breeze Court OWNER'S NAME: Chequer, Inc.
 CIRCLE: New Bldg. Add'n.; Remodel; TYPE OF BLDG: SFD. APT. PUBLIC COMM.
 CONTRACTOR'S NAME: Whittaker Electric Co. STATE LICENSE # 9961-62 CITY LICENSE # 11-857-2-0006

NUMBER	FIXTURE OR INSTALLATION	UNIT PRICE	TOTAL
	Rm addition, carport or garage enclosure	4.00	
	Temporary power	4.00	
49	Light, receptacle or switch-outlet	.20	9.80
	Wall or ceiling space heater	.35	
1	Garbage grinder outlet	.35	.35
1	Dishwasher outlet	.35	.35
1	Clothes dryer outlet	.35	.35
1	Automatic clothes washer	.35	.35
1	Electric range outlet	.35	.35
	Electric water heater outlet	.35	
	Special purpose outlet	.35	
	X-ray unit and its appurtenances	5.00	
	Watts of festoon lighting (Watts) First 3,000 watts for each additional thousand watts	4.00 1.50	
	Horsepower-each motor first horsepower or less for each additional horsepower	1.75 .35	
1	Electric service (including any single meter socket) for each additional socket	3.00 .35	3.00
1	Air conditioning service	1.50	1.50
	Each KW(KVA) Generator (Transformer, Welder) First 100 KVA for each additional KW(KVA)	2.00 .01	
1	Speaker, signal or alarm outlet	.15	.15
	Amplifiers	.50	
	Control panels	.25	
	Main control racks	1.00	
	T.V. and radio antennas-master system only	.75	
	Minimum fee for any permit	4.00	
TOTAL FEE*			\$16.20

Approval for the work under this permit will be given only after refuse and debris have been removed from job site and public right of way.

I hereby certify that I have carefully examined and read the above application; that the same is true and correct; and that the work herein described is to be done in accordance with all the provisions of the applicable Ordinances of the City of Las Vegas, Nevada and State laws whether herein specified or not.

SIGNED Paul S. Carter DATE 6-20-73
 MASTER (ELECTRICIAN) ~~XXXXXXXXXXXX~~
 PAUL S. CARTER
 BUILDING DEPARTMENT 1717 DATE _____
 #12860 PERMIT NO. 6972 PERMIT FEE: \$ 16.20

RECEIPT
 8685 \$016.20 - 6
 CITY OF LAS VEGAS
 DEPT. OF BUILDING & SAFETY
 MUST BE MACHINE VALIDATED
 26 JUN 73

Sharon Pereira 4-25-79

CITY OF LAS VEGAS, NEVADA

PLAN D

DEPARTMENT OF BUILDING & SAFETY - ELECTRICAL APPLICATION & PERMIT

ADDRESS OF CONSTRUCTION: 4033 Evening Breeze Court OWNER'S NAME: Chequer, Inc.

CIRCLE: New Bldg. Add'n., Remodel, TYPE OF BLDG: SFD APT. PUBLIC COMM.

CONTRACTOR'S NAME: Whittaker Electric Co. STATE LICENSE #: 9961-02 CITY LICENSE #: C11-857-2-0006

NUMBER	FIXTURE OR INSTALLATION	UNIT PRICE	TOTAL
	Rm addition, carport or garage enclosure	4.00	
	Temporary power	4.00	
49	Light, receptacle or switch-outlet	.20	9.80
	Wall or ceiling space heater	.35	
1	Garbage grinder outlet	.35	.35
1	Dishwasher outlet	.35	.35
1	Clothes dryer outlet	.35	.35
1	Automatic clothes washer	.35	.35
1	Electric range outlet	.35	.35
	Electric water heater outlet	.35	
	Special purpose outlet	.35	
	X-ray unit and its appurtenances	5.00	
	Watts of festoon lighting (Watts) First 3,000 watts for each additional thousand watts	4.00 1.50	
	Horsepower each motor first horsepower or less for each additional horsepower	1.75 .35	
1	Electric service (including any single meter socket) for each additional socket	3.00 .35	3.00
1	Air conditioning service	1.50	1.50
	Each KW(KVA) Generator (Transformer, Welder) First 100 KVA for each additional KW(KVA)	2.00 .01	
1	Speaker, signal or alarm outlet	.15	.15
	Amplifiers	.50	
	Control panels	.25	
	Main control racks	1.00	
	T.V. and radio antennas-master system only	.75	
	Minimum fee for any permit	4.00	
TOTAL FEE*			\$16.20

Approval for the work under this permit will be given only after refuse and debris have been removed from job site and public right of way.

I hereby certify that I have carefully examined and read the above application; that the same is true and correct; and that the work herein described is to be done in accordance with all the provisions of the applicable Ordinances of the City of Las Vegas, Nevada and State laws whether herein specified or not.

SIGNED Paul S. Carter DATE 6-20-73
MASTER (ELECTRICIAN)
PAUL S. CARTER

BUILDING DEPARTMENT 17/17 DATE _____

#12860 PERMIT NO. 6972 PERMIT FEE: \$ 16.20

RECEIPT

8685 \$016.20 - 6

CITY OF LAS VEGAS
 DEPT. OF BUILDING & SAFETY

MUST BE MACHINE VALIDATED

26 JUN 73

Sharon Perera 4-25-79

CITY OF LAS VEGAS, NEVADA

DEPARTMENT OF BUILDING & SAFETY - ELECTRICAL APPLICATION & PERMIT

ADDRESS OF CONSTRUCTION: Sundown Townhouses 4033 Evening Breeze Place OWNER'S NAME: Cheger, Inc.

CIRCLE: New Bldg. Add'n.; Remodel: TYPE OF BLDG. SPD APT. PUBLIC COMM. CITY LICENSE # 11-857-2-6006

CONTRACTOR'S NAME: Whittaker Electric Co. STATE LICENSE # 9961-C2

NUMBER	FIXTURE OR INSTALLATION	UNIT PRICE	TOTAL
	Rm addition, carport or garage enclosure	4.00	
1	Temporary power	4.00	\$4.00
	Light, receptacle or switch outlet	.20	
	Wall or ceiling space heater	.35	
	Garbage grinder outlet	.35	
	Dishwasher outlet	.35	
	Clothes dryer outlet	.35	
	Automatic clothes washer	.35	
	Electric range outlet	.35	
	Electric water heater outlet	.35	
	Special purpose outlet	.35	
	X-ray unit and its appurtenances	5.00	
	Watts of festoon lighting (Watts) First 3,000 watts for each additional thousand watts	4.00 1.50	
	Horsepower each motor first horsepower or less for each additional horsepower	1.75 .35	
	Electric service (including any single meter socket) for each additional socket	3.00 .35	
	Air conditioning service	1.50	
	Each KW(KVA) Generator (Transformer, Welder) First 100 KVA for each additional KW(KVA)	2.00 .01	
	Speaker, signal or alarm outlet	.15	
	Amplifiers	.50	
	Control panels	.25	
	Main control racks	2.00	
	T.V. and radio antennas-master system only	.75	
	Minimum fee for any permit	4.00	
TOTAL FEE			\$4.00

Approval for the work under this permit will be given only after refuse and debris have been removed from job site and public right of way.

I hereby certify that I have carefully examined and read the above application; that the same is true and correct; and that the work herein described is to be done in accordance with all the provisions of the applicable Ordinances of the City of Las Vegas, Nevada and State laws whether herein specified or not.

SIGNED Raul S. Carter DATE 7-11-73
MASTER (ELECTRICIAN) XXXXXXXXXXXX

BUILDING DEPARTMENT R. Miller DATE _____
PERMIT NO. 7062 PERMIT FEE: \$ 4.00

RECEIPT
9080. \$004.00 - 6

CITY OF LAS VEGAS
DEPT. OF BUILDING & SAFETY

MUST BE MACHINE VALIDATED
12 JUL 73

Sharon Pereira 4-25-79

CITY OF LAS VEGAS, NEVADA

DEPARTMENT OF BUILDING & SAFETY - ELECTRICAL APPLICATION & PERMIT

ADDRESS OF CONSTRUCTION: Sundown Townhouses 4033 Evening Breeze Place OWNER'S NAME: Cheger, Inc.

CIRCLE: New Bldg.; Add'n.; Remodel; TYPE OF BLDG. (SPD) APT. PUBLIC COMM. CITY LICENSE # C11-857-2-6006

CONTRACTOR'S NAME: Whittaker Electric Co. STATE LICENSE # 9961-C2

NUMBER	FIXTURE OR INSTALLATION	UNIT PRICE	TOTAL
	Rm addition, carport or garage enclosure	4.00	
1	Temporary power	4.00	\$4.00
	Light, receptacle or switch outlet	.20	
	Wall or ceiling space heater	.35	
	Garbage grinder outlet	.35	
	Dishwasher outlet	.35	
	Clothes dryer outlet	.35	
	Automatic clothes washer	.35	
	Electric range outlet	.35	
	Electric water heater outlet	.35	
	Special purpose outlet	.35	
	X-ray unit and its appurtenances	5.00	
	Watts of festoon lighting (Watts) First 3,000 watts for each additional thousand watts	4.00 1.50	
	Horsepower each motor first horsepower or less for each additional horsepower	1.75 .35	
	Electric service (including any single meter socket) for each additional socket	3.00 .35	
	Air conditioning service	1.50	
	Each KW(KVA) Generator (Transformer, Welder) First 100 KVA for each additional KW(KVA)	2.00 .01	
	Speaker, signal or alarm outlet	.15	
	Amplifiers	.50	
	Control panels	.25	
	Main control racks	2.00	
	T.V. and radio antennas-master system only	.75	
	Minimum fee for any permit	4.00	
	TOTAL FEE		\$4.00

Approval for the work under this permit will be given only after refuse and debris have been removed from job site and public right of way.

I hereby certify that I have carefully examined and read the above application; that the same is true and correct; and that the work herein described is to be done in accordance with all the provisions of the applicable Ordinances of the City of Las Vegas, Nevada and State laws whether herein specified or not.

SIGNED Raul S. Carter DATE 7-11-73
 MASTER (ELECTRICIAN) ~~XXXXXXXXXXXX~~
RAUL S. CARTER
 BUILDING DEPARTMENT [Signature] DATE _____
 #12860 PERMIT NO. 7062 PERMIT FEE: \$ 4.00

RECEIPT
 9080. \$004.00 - 6
 CITY OF LAS VEGAS
 DEPT. OF BUILDING & SAFETY
 MUST BE MACHINE VALIDATED
 12 JUL 73

Sharon Ferera June 11, 1973

LOG NO. & AREA: 1-32-4 CONST. VAL. _____

DEPARTMENT OF BUILDING & SAFETY APPLICATION & BUILDING PERMIT — for: Dwellings, Duplexes, Misc. Residential Const.

ADDRESS OF CONSTRUCTION: 4033 Evening Breeze Place OWNER: Laktree

LOT(S) 1 BLOCK K SUBDIVISION Sundown #1 ZONE: P.U.D.

Existing structure on lot: Dwelling Accessory bldgs. Vacant lot Other

PROPOSED CONSTRUCTION: (1) single family dwelling USE: Residence

MATERIALS OF CONSTRUCTION: Wood Frame Concrete Block Reinforced Concrete Steel Frame

SQ. FEET OF FLOOR AREAS: 1st 1250 2nd _____ 3rd _____ Other: 232 TOTAL SQ. FT. 1482

FIRE ZONE: 1 2 (3) Occupancy Group (1) J 1-2 CONST. TYPE: I II III IV (V)

ARCHITECT: L.C. M... .. ENGINEER: _____ NO. of UNITS 1 NO. of STORES 1

Plans Submitted: Yes No Calculations Submitted: Yes No Sewer Fee Req'd: Yes No

CONTRACTOR: Cheger, Inc. STATE LICENSE # 11114 CITY LICENSE # 7358

ADD'L. PERMITS REQ'D: Air Cond. Elec. Plumbing Signs Paving Fence Public Walks Curb-gutters Incinerators Fire Sprinkling System

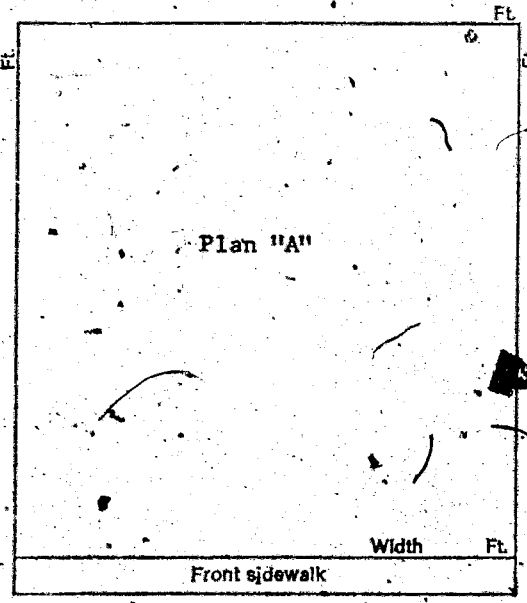

- CONDITIONS OF THE PERMIT:**
1. I agree to call the City Building Department for inspections before concrete is poured, before rough wiring, electrical, plumbing, framing is covered. Also for air conditioning, sheet-rock and sheathing inspection.
 2. I agree that when the job is completed, that I will call for final inspection before occupancy.
 3. I agree to perform all construction in accordance with City Ordinances and Building Codes.
 4. The Contractor's signature below denotes authority from the owner to sign in his behalf and that the owner is aware of all requirements of this application and permit. Separate permits must be taken out for work outlined above this agreement.
 5. I have read and understand the contents of this application and permit; I hereby state that the information I have supplied on this application is true and correct.

SIGNED: _____ Contractor
 BY: [Signature] Agent or Owner
 _____ Date
 CLARK COUNTY HEALTH DEPT. _____ Date
 LAS VEGAS FIRE DEPARTMENT _____ Date

PLANNING DEPT.: [Signature] Date: 3/28/73
 PUBLIC WORKS DEPT.: [Signature] Date: 5-28
 BUILDING DEPT.: [Signature] Date: 3/29/73
 12850 PERMIT NO.: 10262 PERMIT FEE \$ 70.00

RECEIPT
 3477 \$070.00 - 8
 CITY OF LAS VEGAS
 DEPT. OF BUILDING & SAFETY
 MUST BE MACHINE VALIDATED
 - 2 APR 73

Sharon Ferrel June 11, 1973

LOG NO. & AREA: P-32-4
 DEPARTMENT OF BUILDING & SAFETY
 APPLICATION & BUILDING PERMIT — for: Dwellings, Duplexes, Misc. Residential Const.

ADDRESS OF CONSTRUCTION: 4033 Evening Breeze Place. OWNER: Laketree

LOT(s): 1 BLOCK K SUBDIVISION Sundown #1 ZONE: P.U.D.

Existing structure on lot: Dwelling Accessory bldgs. Vacant lot Other

PROPOSED CONSTRUCTION: (1) single family dwelling USE: Residence

MATERIALS OF CONSTRUCTION: Wood Frame Concrete Block Reinforced Concrete Steel Frame

SQ. FEET OF FLOOR AREAS: 1st 1250 2nd _____ 3rd _____ Other: 232 TOTAL SQ. FT. 1482
 1250

FIRE ZONE: 1 2 (3) Occupancy Group (1) (2) 1-2 CONST. TYPE: I II III IV (V)

ARCHITECT: L.C. Miller + Assoc. ENGINEER: _____ NO. of UNITS: 1 NO. of STORES: 1

Plans Submitted: Yes No Calculations Submitted: Yes No Sewer Fee Req'd: Yes No

CONTRACTOR: Chéger, Inc. STATE LICENSE # 11114 CITY LICENSE # 7358

ADD'L. PERMITS REQ'D: Air Cond. Elec. Plumbing Signs Paving Fence Public Walks Curb-gutters
 Incinerators Fire Sprinkling System

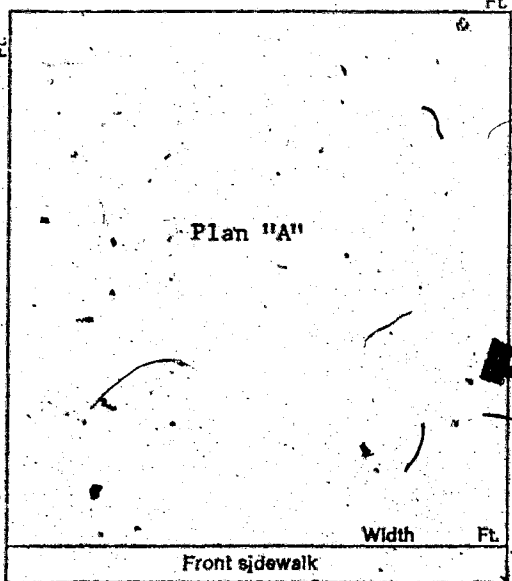

- CONDITIONS OF THE PERMIT:**
1. I agree to call the City Building Department for inspections before concrete is poured, before rough wiring, electrical, plumbing, framing is covered. Also for air conditioning, sheet-rock and sheathing inspection.
 2. I agree that when the job is completed that I will call for final inspection before occupancy.
 3. I agree to perform all construction in accordance with City Ordinances and Building Codes.
 4. The Contractor's signature below denotes authority from the owner to sign in his behalf and that the owner is aware of all requirements of this application and permit. Separate permits must be taken out for work outlined above this agreement.
 5. I have read and understand the contents of this application and permit; I hereby state that the information I have supplied on this application is true and correct.

SIGNED: _____ Contractor
 BY: *Sharon Ferrel* Agent or Owner

CLARK COUNTY HEALTH DEPT. Date _____
 LAS VEGAS FIRE DEPARTMENT Date _____

PLANNING DEPT.: *[Signature]* Date: 3/29/73
 PUBLIC WORKS DEPT.: *[Signature]* Date: 5-28
 BUILDING DEPT.: *[Signature]* Date: 3/29/73

1285 PERMIT NO.: 10262 PERMIT FEE \$ 70.00

RECEIPT
 3477 \$070.00 - 8
 CITY OF LAS VEGAS
 DEPT. OF BUILDING & SAFETY
 MUST BE MACHINE VALIDATED
 - 2 APR 73

Sharon Ferrel June 11, 1973

CITY OF LAS VEGAS, NEVADA
DEPARTMENT OF BUILDING & SAFETY

RECEIPT
— FOR
SEWER CONNECTION FEE

JOB ADDRESS: 4033 Evening Breeze Place OWNER'S NAME: Laketree

LOT 1 BLOCK K SUBDIVISION: Sundown #1

QUANTITY	OCCUPANCY	UNIT FEE	AMOUNT
1	S. F. Dwelling	\$150.00	\$150.00

PAID BY: Laketree
Chequers Inc

TOTAL	\$150.00
Less Credit	- 0.00
TOTAL FEE \$	\$150.00

*Credit for existing sewer is applied to the new sewer connection fee based on previous type of occupancy and only when the new occupancy requires an additional fee.

This receipt does not authorize the owner or his representative to start any work without obtaining a plumbing permit.

WR3 3/29/73
DEPARTMENT OF BUILDING & SAFETY

RECEIPT NO. 9492 SEWER FEE \$ 150.00

73182

RECEIPT
3485 \$150.00 - 3
CITY OF LAS VEGAS
DEPT. OF
BUILDING & SAFETY
MUST BE MACHINE VALIDATED
- 2 APR 73

Sharon Ferrara June 11, 1973

ADDRESS OF CONSTRUCTION: 4133 Evening Breeze Place OWNER'S NAME: _____

CIRCLE: Addition Remodel New Bldg. TYPE OF BLDG: SEB APT, COMM, PUBLIC 611-526-2-0182

CONTRACTOR'S NAME: Reger's Steel Metal STATE LICENSE # 10196 CITY LICENSE # _____

UNITS	DESCRIPTION	FEE	TOTAL	UNITS	DESCRIPTION	FEE	TOTAL
1	Unit hook - floor, wall or suspended	1.00			EVAPORATIVE COOLERS:		
	FOR EACH FORCED AIR OR GRAVITY TYPE FURNACE OR FURNER INCLUDING DUCTS AND VENT ATTACHED TO SUCH APPLIANCES:				5 outlets or under	3.00	
	Up to and including 100,000 Btu's	4.00			Over 5 and up to and including 10	5.00	
	Over 100,000 Btu's	6.00	4.00		Each additional outlet over 10	.25	
	FOR EACH HEATING APPLIANCE, REFRIGERATION UNIT, COMMUNITY COOLING AND HEATING UNIT, AIR CONDITIONING UNIT, DESIGN OR DUCTS:				VENTILATION:		
	Up to and including 10,000 Btu's per hour	4.00	4.00		For each fan connected to a building	1.00	3.00
	Over 10,000 Btu's per hour up to and including 100,000 Btu's per hour	7.00	7.00		For each commercial or industrial ventilation system	5.00	
	Over 100,000 Btu's per hour up to and including 1,000,000 Btu's per hour	12.00			For each commercial kitchen hood	5.00	
	Over 1,000,000 Btu's per hour up to and including 10,000,000 Btu's per hour	20.00			MISCELLANEOUS:		
	Over 10,000,000 Btu's per hour up to and including 100,000,000 Btu's per hour	30.00			For each stand and cooling tower	2.00	
	FOR EACH AIR HANDLING UNIT INCLUDING DUCTS ATTACHED THERETO:				Duct work only - each opening	.9	2.25
	Up to and including 10,000 CFM	2.00			For each pipe penetration of each commercial building at 4" diameter	15.00	
	Over 10,000 CFM	4.00			For piping installed for the removal of gas, steam, or other vapors only	1.00	3.00
					For each appliance, piece of equipment, or mechanical work in the permit application included in this schedule, the permit fee shall be the same as that of the permit fee by using the cost of installation for the variation amount.		
					FOR THE ISSUANCE OF EACH PERMIT	1.00	
					TOTAL PERMIT FEES	21.25	

I hereby certify that a full satisfactory examination and read the above application that the same is true and correct and that the work herein described is to be done in accordance with all the provisions of the applicable Ordinances of the City of Las Vegas, Nevada and the State Laws, whether herein specified or not.

Approval of the work under this permit is to be given only after the fee has been received from job site and public time of day.

SIGNED: J. E. Rieger III Date: 5/17/73

BUILDING DEPARTMENT: _____ Date: _____

PERMIT NO. 3933 PERMIT FEES 21.25

RECEIPT
6898 2021.25 - 0
CITY OF LAS VEGAS
MUST BE MACHINE VALIDATED
22 MAY 73

41930

Sharon Perena June 17, 1973

ADDRESS OF CONSTRUCTION: 4033 Evening Breeze Place
 OWNER'S NAME: Chequer, Inc.
 TYPE OF BLDG.: SFD. APT. PUBLIC COMM.
 CITY: 611-857-2-6006
 CONTRACTOR'S NAME: Whittaker Electric Co. STATE LICENSE #: 9901-C2 LICENSE #:

NUMBER	FIXTURE OR INSTALLATION	UNIT PRICE	TOTAL
	Rm addition, carport or garage enclosure	4.00	
	Temporary power	4.00	
52	Light, receptacle or switch outlet	.20	10.40
	Wall or ceiling space heater	.35	
1	Garage grinder outlet	.35	.25
1	Dishwasher outlet	.35	.35
1	Clothes dryer outlet	.35	.35
1	Automatic clothes washer	.35	.35
1	Electric range outlet	.35	.35
	Electric water heater outlet	.35	
	Special purpose outlet	.35	
	X-ray unit and its appurtenances	5.00	
	Watts of festoon lighting (Watts) First 3,000 watts for each additional thousand watts	4.00 1.50	
	Horsepower each motor first horsepower or less for each additional horsepower	1.75 .35	
	Electric service (including any single meter socket) for each additional socket	3.00 .35	3.00
1	Air conditioning service	1.50	1.50
	Each KW(KVA) Generator (Transformer Welder) First 100 KVA for each additional KW(KVA)	2.00 .01	
1	Speaker, signal or alarm outlet	.15	.15
	Amplifiers	.50	
	Control panels	.25	
	Main control racks	1.00	
	T.V. and radio antennas master system only	.75	
	Minimum fee for any permit	4.00	
	TOTAL FEE		\$16.80

Application for this permit will be void if the fee and deposit have been removed from the permit and public right of way.

I hereby certify that I have carefully examined and read the above application and that the same is true and correct, and that the work herein described is to be done in accordance with all the provisions of the applicable Ordinances of the City of Las Vegas, Nevada and State laws and the health and safety of the public.

SIGNED: Paul J. Carter DATE: 6-21-73
 MASTER ELECTRICIAN
 BUILDING DEPARTMENT: 1777 DATE: _____
 PERMIT NO: 6979 PERMIT FEE \$ 16.80

RECEIPT
 8692 \$5016.80 - 6
 CITY OF LAS VEGAS
 BUILDING & SAFETY
 MUST BE MACHINE RECORDED
 26 JUN 73

Done 11-9-81

DEPT. of BLDG & SAFETY - CITY of LAS VEGAS, NEVADA

OWNER Laketree ADDRESS 4033 Evening Breeze Place DATE 4-2-73
GEN CONT Cheger Inc TYPE OF STRUCTURE SED
PERMIT NO 10262 LEGAL DESCRIPTION L 1 B k Sundown # 1

BUILDING		MECHANICAL		ELECTRICAL	
LOCATION <u>244-16-73</u>	PLUMBING CONT. <u>CEV</u>	PERMIT NO. <u>9890</u>	DATE <u>4-20-73</u>	TEMP. POLE CONT.	PERMIT NO. _____ DATE _____
FIREPLACE FTS _____	HEAT & VENT. AC CONT. <u>Regina</u>	PERMIT NO. <u>3933</u>	DATE <u>5-22-73</u>	INSPECTION <u>797-13-73</u>	DATE _____
FOOTINGS <u>244-16-73</u>	SEWER CONT. <u>Cheger Inc</u>	PERMIT NO. <u>9492</u>	DATE _____	ELECTRICAL CONT. <u>Whittaker</u>	PERMIT NO. <u>6979</u>
FOUNDATION WALL _____	ROUGH SOIL <u>244-20-73</u>	PERMIT NO. _____	DATE _____	PERMIT NO. <u>6979</u>	DATE <u>6-21-73</u>
FLOOR FRAMING _____	ROUGH WATER <u>244-20-73</u>	ROUGH GAS _____	DATE _____	FIXTURES CONT.	PERMIT NO. _____ DATE _____
BLAS <u>244-16-73</u>	TOP-OUT <u>244-20-73</u>	ROUGH DUCT <u>244-20-73</u>	DATE _____	SLAB <u>19-7-73</u>	ROUGH _____
CHIMNEY STEEL (FIREPLACE) _____	REF. ROUGH PIPING _____	FINAL PLUMBING <u>244-14-74</u>	DATE _____	FINAL ROUGH _____	FINAL FIXTURE _____
WALL STEEL _____	FINAL PLUMBING <u>244-14-74</u>	FINAL GAS <u>244-13-73</u>	DATE _____	FINAL ELECTRICAL <u>19-11-73</u>	TEMPORARY SERVICE _____
COLUMN STEEL _____	FINAL AIR COND. <u>244-13-73</u>	FINAL REFRIG. _____	DATE _____	MISCELLANEOUS _____	GRADING & DRAINAGE _____
BEAM STEEL _____	FINAL SEWER <u>244-20-73</u>	FINAL SEPTIC TANK _____	DATE _____	ON-SITE PARKING SPACES _____	ENG APPROVAL OF _____
FRAMING <u>244-3-73</u>	FINAL SEPTIC TANK _____			OFF-SITE IMPROVEMENTS _____	
ROOF SHEATHING <u>244-3-73</u>					
INTERIOR _____					
EXTERIOR <u>244-3-73</u>					
DRYWALL <u>244-11-73</u>					
LATHING _____					
BACKING (STONS) _____					
PLASTER SCRATCH _____					
BROWN _____					
URBAN REDEVELOPMENT APPROVAL _____					
FINAL BLDG _____					
DATE _____					

APPROVED FOR OCCUPANCY & METER CR 11-6-73 INSPECTOR _____ DATE _____
PLEASE NOTE REMARKS ON REVERSE SIDE LOG: # _____ AREA: # _____ 23.0'

4033 Evening Breeze Place T. 32-4

DEPT. of BLDG & SAFETY - CITY of LAS VEGAS, NEVADA

OWNER Laketree ADDRESS 4033 Evening Breeze Ct. DATE 4-2-73
GEN CONT Cheger Inc TYPE OF STRUCTURE SED
PERMIT NO 10253 LEGAL DESCRIPTION L 3 B N Sundown # 1

BUILDING		MECHANICAL		ELECTRICAL	
LOCATION <u>244-16-73</u>	PLUMBING CONT. <u>CEV</u>	PERMIT NO. <u>9890</u>	DATE <u>4-20-73</u>	TEMP. POLE CONT. <u>1062</u>	PERMIT NO. _____ DATE _____
FIREPLACE FTS _____	HEAT & VENT. AC CONT. _____	PERMIT NO. _____	DATE _____	INSPECTION _____	DATE _____
FOOTINGS <u>244-16-73</u>	SEWER CONT. <u>Cheger Inc</u>	PERMIT NO. <u>9482</u>	DATE _____	ELECTRICAL CONT. <u>Whittaker</u>	PERMIT NO. <u>6972</u>
FOUNDATION WALL _____	ROUGH SOIL <u>244-20-73</u>	PERMIT NO. _____	DATE _____	PERMIT NO. <u>6972</u>	DATE <u>6-21-73</u>
FLOOR FRAMING _____	ROUGH WATER <u>244-20-73</u>	ROUGH GAS _____	DATE _____	FIXTURES CONT.	PERMIT NO. _____ DATE _____
BLAS <u>244-16-73</u>	TOP-OUT <u>244-20-73</u>	ROUGH DUCT <u>244-20-73</u>	DATE _____	SLAB <u>19-7-73</u>	ROUGH _____
CHIMNEY STEEL (FIREPLACE) _____	REF. ROUGH PIPING _____	FINAL PLUMBING <u>244-14-73</u>	DATE _____	FINAL ROUGH _____	FINAL FIXTURE _____
WALL STEEL _____	FINAL PLUMBING <u>244-14-73</u>	FINAL GAS <u>244-13-73</u>	DATE _____	FINAL ELECTRICAL <u>19-12-13-73</u>	TEMPORARY SERVICE _____
COLUMN STEEL _____	FINAL AIR COND. <u>244-13-73</u>	FINAL REFRIG. _____	DATE _____	MISCELLANEOUS _____	GRADING & DRAINAGE _____
BEAM STEEL _____	FINAL SEWER <u>244-20-73</u>	FINAL SEPTIC TANK _____	DATE _____	ON-SITE PARKING SPACES _____	ENG APPROVAL OF _____
FRAMING <u>244-3-73</u>	FINAL SEPTIC TANK _____			OFF-SITE IMPROVEMENTS _____	
ROOF SHEATHING <u>244-3-73</u>					
INTERIOR _____					
EXTERIOR <u>244-3-73</u>					
DRYWALL <u>244-11-73</u>					
LATHING _____					
BACKING (STONS) _____					
PLASTER SCRATCH _____					
BROWN _____					
URBAN REDEVELOPMENT APPROVAL _____					
FINAL BLDG _____					
DATE _____					

APPROVED FOR OCCUPANCY & METER CR 12-11-73 INSPECTOR _____ DATE _____
PLEASE NOTE REMARKS ON REVERSE SIDE LOG: # _____ AREA: # _____ 23.0'

4033 Evening Breeze Ct. T. 32-4