

1917 HASSELL AVE.

LOT 105 BLK 3 COLLEGE HGTS ZONE R-1

Glenn Gatewood 75-79

CITY OF LAS VEGAS, NEVADA  
DEPARTMENT OF BUILDING AND SAFETY  
APPLICATION FOR FENCE, WALL OR  
RETAINING WALL

LOG NO. 1966  
AREA: \_\_\_\_\_  
INDEX CARD: \_\_\_\_\_  
TELEPHONE: \_\_\_\_\_  
CONSTRUCTION VALUATION: 126  
INSPECTION VALUATION: 100  
PERMIT FEE: 3.00  
PERMIT NUMBER: 32481  
DATE: 2/2 1966

ADDRESS OF CONSTRUCTION: 1917. Vanell OWNER'S NAME: 1st Western OWNER'S ADDRESS: \_\_\_\_\_  
Lot (s) 105 Block 3 Subdivision College Heights Zone: R-1

Materials of Concrete Construction: Block ( ) Concrete ( ) Wire (X) Wood ( ) Other ( )

Total Square Feet: \_\_\_\_\_ Total Linear Feet: 60  
STATE LICENSE # 8427 CITY LICENSE # 10349

CONTRACTOR'S NAME: T. M. Dandridge  
Architect's Name: \_\_\_\_\_ PLANS SUBMITTED: Yes \_\_\_ No \_\_\_  
Engineer's Name: \_\_\_\_\_ CALCULATIONS: Yes \_\_\_ No \_\_\_

Street Name: \_\_\_\_\_  
Front Yard: \_\_\_\_\_ Feet

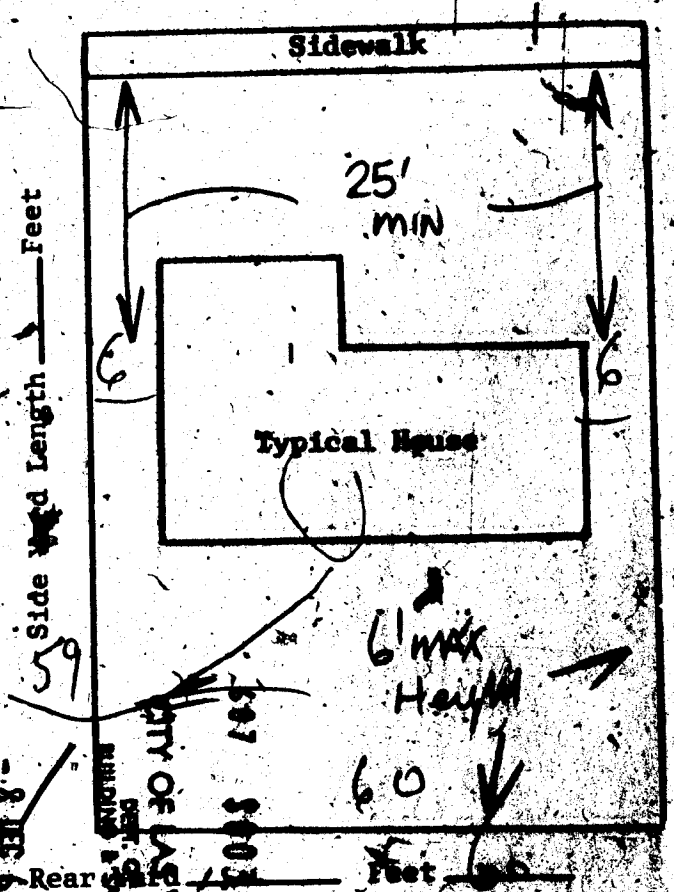

I understand that any portion of this (fence) (wall) constructed or erected on City property or right-of-way will be removed from said location at my expense upon request received from the City of Las Vegas, Nevada. I understand that the (fence) (wall) shall not enclose water meter, light standard, fire alarm box and shall not come closer than two (2') feet in any direction from any fire hydrant. I further state that I am familiar with effective Ordinances of the City of Las Vegas, Nev. and effective Statutes of the State of Nevada covering construction and use of above type; I agree to perform said construction in conformity therewith. I further agree that issuance of a permit on above application will not excuse me from conforming with said Ordinances and Statutes, despite any errors on the part of the Building Inspector or Engineer in checking plans and applications herewith submitted.

I have read and understand the contents of above application; I hereby state that same are true and correct.

SIGN HERE: T. M. Dandridge  
By: Robert D. Van Horn

APPROVED BY: 2-7-66  
PLANNING DEPT. & CODE ASSISTANCE DATE: \_\_\_\_\_  
FIRE DEPARTMENT DATE: \_\_\_\_\_  
ENGINEERING DEPT. DATE: \_\_\_\_\_  
BUILDING & SAFETY DEPT. 2-8-66 DATE: \_\_\_\_\_

23.14 Note: Owner of property shall be responsible for all inspections required.

L. Collins 3-21-82

DEPT. of BLDG & SAFETY - CITY of LAS VEGAS, NEVADA

OWNER Paglia Const. Co. ADDRESS 1917 Hassell Ave DATE 5-3-63  
GEN. CONT. Same TYPE OF STRUCTURE SFD  
PERMIT NO. 17405 LEGAL DESCRIPTION Lot 105 Block 3 College Hts. #2

BUILDING	MECHANICAL	ELECTRICAL
LOCATION <u>015 to 3-103</u>	PLUMBING CONT. <u>MMU</u>	TEMP. POLE CONT. <u>MMU</u>
FIREPLACE FTS. <u>0</u>	PERMIT NO. <u>13150</u> DATE <u>8-19-63</u>	PERMIT NO. <u>14397</u> DATE <u>7-30-63</u>
FOOTINGS <u>JB6-3-63</u>	HEAT & VENT. AC CONT. <u>Hammond</u>	INSPECTION <u>Hammond</u> DATE <u>7-19-63</u>
FOUNDATION WALL <u>0</u>	PERMIT NO. <u>13150</u> DATE <u>8-19-63</u>	ELECTRICAL CONT. <u>Hammond</u>
FLOOR FRAMING <u>0</u>	SEWER CONT. <u>MMU</u>	PERMIT NO. <u>14397</u> DATE <u>7-30-63</u>
SLAB <u>NA 7-3-63</u>	PERMIT NO. <u>13150</u> DATE <u>8-19-63</u>	FIXTURES CONT. <u>0</u>
CHIMNEY STEEL (FIREPLACE) <u>0</u>	ROUGH SOIL <u>WV 6-19-63</u>	PERMIT NO. <u>14397</u> DATE <u>7-30-63</u>
WALL STEEL <u>HA 7-26-63</u>	ROUGH WATER <u>WV 6-19-63</u>	SLAB <u>Order donk 5-19-63</u>
COLUMN STEEL <u>0</u>	TOP-OUT <u>H.E.G. 8-19-63</u>	ROUGH <u>0</u>
BEAM STEEL <u>HA 7-26-63</u>	ROUGH GAS <u>0</u>	FINAL ROUGH <u>0</u>
FRAMING <u>HA 8-13-63</u>	AC ROUGH DUCT <u>0</u>	FINAL FIXTURE <u>0</u>
ROOF SHEATHING <u>HA 8-13-63</u>	REF. ROUGH PIPING <u>0</u>	FINAL ELECTRICAL <u>0</u>
DRYWALL <u>HA 8-27-63</u>	FINAL PLUMBING <u>Hammond 9-27-63</u>	TEMPORARY SERVICE <u>0</u>
LATHING <u>0</u>	FINAL GAS <u>0</u>	MISCELLANEOUS <u>0</u>
BACKING (SAND) <u>0</u>	FINAL AIR COND. <u>HA 9-23-63</u>	GRADING & DRAINAGE <u>0</u>
PLASTER SCRATCH <u>0</u>	FINAL REFRIG. <u>0</u>	ON-SITE PARKING SPACES <u>0</u> APP. <u>0</u>
PLASTER BROWN <u>0</u>	FINAL SEWER <u>WV 8-24-63</u>	ENG. APPROVAL OF <u>0</u>
URBAN REDEVELOPMENT APPROVAL <u>0</u>	FINAL SEWER TANK <u>0</u>	OFF-SITE IMPROVEMENTS <u>0</u>
FINAL BLDG. DATE <u>9-23-63</u>		

APPROVED FOR OCCUPANCY & METER W. H. ... INSPECTOR W. H. ... DATE 9-23-63

PLEASE NOTE REMARKS ON REVERSE SIDE (1248) LOG # AREA # 23.04

1917 Hassell Ave. T 38 3

DEPARTMENT OF BUILDING & SAFETY  
CITY OF LAS VEGAS, NEVADA

OWNER FIRST WESTERN ADDRESS 1917 HASSELL DATE 2/9/66

CONTRACTOR T & M INDUSTRIES PERMIT NO. 32481

LOT 105 BLOCK 3 SUBDIVISION College Hts. #2

KARDEX CARD  
FENCE & RETAINING WALLS

Fence (wire, wood, etc.)	Walls (masonry, rock, etc.)
Location <u>20-3-1-66</u>	Location <u>0</u>
Final Inspection <u>0</u>	Footings <u>0</u>
	Wall Steel 1st <u>0</u> 2d <u>0</u> 3d <u>0</u>
	Final Inspection <u>0</u>
Retaining Wall (masonry)	Retaining Wall (concrete)
Location <u>0</u>	Location <u>0</u>
Footings <u>0</u>	Footings <u>0</u>
Wall Steel 1st <u>0</u> 2d <u>0</u> 3d <u>0</u>	Wall Steel 1st <u>0</u> 2d <u>0</u> 3d <u>0</u>
Bond Bar 1st <u>0</u> 2d <u>0</u> 3d <u>0</u>	Final Inspection <u>0</u>
Final Inspection <u>0</u>	

23.14 B ADDRESS 1917 HASSELL AREA 0

L. Collins 3-21-82

DEPT. of BLDG & SAFETY—CITY of LAS VEGAS, NEVADA  
OWNER Paglia Const. Co. ADDRESS 1917 Hassell Ave DATE 5-3-63  
GEN. CONT. Same TYPE OF STRUCTURE STD  
PERMIT NO. 17405 LEGAL DESCRIPTION Lot 105 Block 3, College Hts. #2

BUILDING	MECHANICAL	ELECTRICAL
LOCATION <u>OB 6-3-63</u>	PLUMBING CONT. <u>MMH</u>	TEMP. POLE CONT. _____
FIREPLACE FTS _____	PERMIT NO. <u>13150</u> DATE <u>8-19-62</u>	PERMIT NO. _____ DATE _____
FOOTINGS <u>SB 3-63</u>	HEAT & VENT. AC CONT. <u>Hammond</u>	INSPECTION _____ DATE _____
FOUNDATION WALL _____	PERMIT NO. <u>12750/107</u> DATE <u>9-19-62</u>	ELECTRICAL CONT. <u>Hammond</u>
FLOOR FRAMING _____	SEWER CONT. <u>MMH</u>	PERMIT NO. <u>1497</u> DATE <u>2-20-63</u>
SLAB <u>HA 7-3-63</u>	PERMIT NO. <u>13150</u> DATE <u>8-19-62</u>	FIXTURES CONT. _____
CHIMNEY STEEL (FIREPLACE) _____	ROUGH SOIL <u>W 6-19-63</u>	PERMIT NO. _____ DATE _____
WALL STEEL <u>HA 7-26-63</u>	ROUGH WATER <u>W 6-19-63</u>	SLAB _____
COLUMN STEEL _____	TOP-OUT <u>H.E.G. 5-11-63</u>	ROUGH <u>Order done 5-19-63</u>
BEAM STEEL <u>HA 7-26-63</u>	ROUGH GAS _____	FINAL ROUGH _____
FRAMING <u>E H 8-19-63</u>	AC ROUGH DUCT _____	FINAL FIXTURE _____
ROOF SHEATHING <u>HA 8-13-63</u>	REF. ROUGH PIPING _____	FINAL ELECTRICAL _____
DRYWALL _____	FINAL PLUMBING <u>Hammond 9-27-62</u>	TEMPORARY SERVICE _____
LATHING _____	FINAL GAS _____	MISCELLANEOUS _____
BACKING (SPONG) _____	FINAL AIR COND. <u>HA 9-23-62</u>	GRADING & DRAINAGE _____
PLASTER SCRATCH _____	FINAL REFRIG. _____	ON-SITE PARKING SPACES _____ APP. _____
PLASTER BROWN _____	FINAL SEWER <u>W R 6-29-63</u>	ENG. APPROVAL OF _____
URBAN REDEVELOPMENT APPROVAL _____	FINAL SEWER TANK _____	OFF-SITE IMPROVEMENTS _____
FINAL BUILDING DATE _____		

APPROVED FOR OCCUPANCY & METER Alto INSPECTOR 9-29-63 DATE 9-25-63  
PLEASE NOTE REMARKS ON REVERSE SIDE (1248) LOG # \_\_\_\_\_ AREA # \_\_\_\_\_ 23.04  
1917 Hassell Ave. T 38 3

DEPARTMENT OF BUILDING & SAFETY  
CITY OF LAS VEGAS, NEVADA  
OWNER FIRST WESTERN ADDRESS 1917 HASSELL KARDX CARD  
CONTRACTOR T & M INDUSTRIES PERMIT NO. 32481 FENCE & RETAINING WALLS  
DATE 2/9/66  
LOT 105 BLOCK 3 SUBDIVISION College Hts. #2 WIRE FENCE

Fence (wire, wood, etc.)	Walls (masonry, rock, etc.)
Location _____	Location _____
Final Inspection <u>2-3-1-66</u>	Footings _____
	Wall Steel 1st _____ 2d _____ 3d _____
	Final Inspection _____
Retaining Wall (masonry)	Retaining Wall (concrete)
Location _____	Location _____
Footings _____	Footings _____
Wall Steel 1st _____ 2d _____ 3d _____	Wall Steel 1st _____ 2d _____ 3d _____
Bond Beam 1st _____ 2d _____ 3d _____	Final Inspection _____
Final Inspection _____	

23.14 B ADDRESS 1917 HASSELL AREA \_\_\_\_\_