

6449 Delphinium

L41 B11 Jade Park # 3 Zone RMH

Sharon Pereira March 13, 1979

CITY OF LAS VEGAS, NEVADA

5-19

LOG NO. & AREA T-18 CONST. VAL. \$ 2500

DEPARTMENT OF PUBLIC SERVICES
DIVISION OF BUILDING AND SAFETY

APPLICATION & BUILDING PERMIT - for:
Dwellings, Duplexes, Misc. Residential Const.

ADDRESS OF CONSTRUCTION: 6449 Delphinium Avenue OWNER: HOME SERVICE CORP.

LOT(s) 41 BLOCK 11 SUBDIVISION JADE PARK #3 ZONE RMA

Existing structure on lot: Dwelling Accessory Bldg. Vacant Lot Other

PROPOSED CONSTRUCTION: MOBILE HOME ESTATE LOT USE: NES

MATERIALS OF CONSTRUCTION: Wood Frame Concrete Block Reinforced Concrete Steel Frame

SQUARE FEET OF FLOOR AREAS: 1st 6000 2nd 0 3rd 0 Other 0 TOTAL SQ. FT. 6000

FIRE ZONE: _____ Occupancy Group: _____ CONST. TYPE: _____

ARCHITECT: _____ ENGINEER: TUREGUN & ASSOCIATES NO. of UNITS: _____ NO. of STORIES: _____

Plans Submitted: Yes No Calculations Submitted: Yes No Sewer Fee Req'd.: Yes No

CONTRACTOR: SUN HOME BUILDERS, INC. STATE LICENSE # 6660 CITY LICENSE # C11 444 206059

ADD'L. PERMITS REQ'D.: Air Cond. Elec. Plumbing Signs Paving Fence Public Walks Curb-gutters
Incinerators Fire Sprinkling System

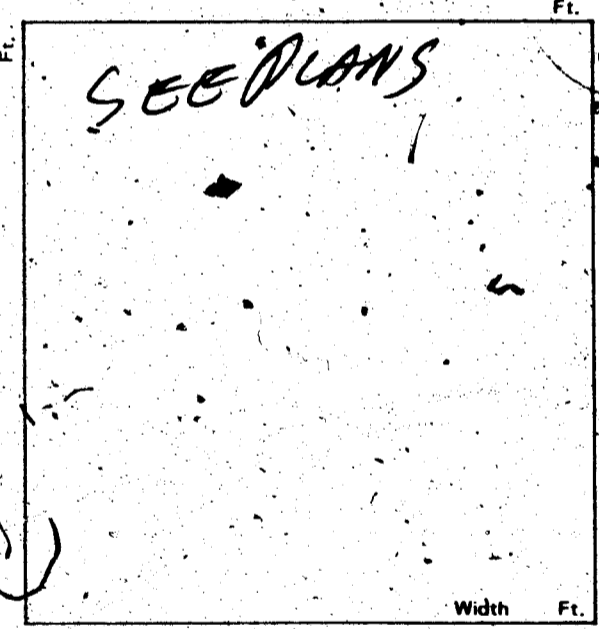

CONDITIONS OF THE PERMIT:

1. I agree to call the City Building Department for inspections before concrete is poured, before rough wiring, electrical, plumbing, framing is covered. Also for Air conditioning, drywall and sheathing inspection.
2. I agree that when the job is completed that I will call for final inspection before occupancy.
3. I agree to perform all construction in accordance with City Ordinances and Building Codes.
4. The Contractor's signature below denotes authority from the owner to sign in his behalf and that the owner is aware of all requirements of this application and permit. Separate permits must be taken out for work outlined above this agreement.
5. I have read and understand the contents of this application and permit, I hereby state that the information I have supplied on this application is true and correct.

Approval for the work under this permit will be given only after refuse and debris have been removed from job site and public right of way.

SIGNED: SUN HOME BUILDERS, INC. Contractor

BY: K. R. Handley Agent or Owner
K. R. Handley, Executive Vice President

PLANNING DEPT.: _____ Date: 1-6-78

PUBLIC WORKS DEPT.: Charles Jank Date: 4/11/78

BUILDING DIVISION: [Signature] Date: 1/19/78

PERMIT NO.: 3044-30 PERMIT FEE \$ 18

154-01-220

RECEIPT

MUST BE MACHINE VALIDATED

Sharon Perera March 13, 1979

8-03

CITY OF LAS VEGAS, NEVADA

LOG NO: & AREA _____

CONST. VAL. \$ 987.00

DEPARTMENT OF PUBLIC SERVICES
DIVISION OF BUILDING & SAFETY

APPLICATION & BUILDING PERMIT - for:
Fence, Wall, Retaining Wall.

ADDRESS OF CONSTRUCTION: 6449 Delphinium Ave.

OWNER: Home Savings

LOT(s): 41 BLOCK 11 SUBDIVISION Jade Park 3

ZONE RMM

Materials of Construction: Block Concrete Wire Wood Other

Yes No

ARCHITECT: _____ ENGINEER: Yuregin & Ass.

PLANS:

CALCS:

CONTRACTOR: Anthony & Son Masonary STATE LICENSE #: 3917

CITY LICENSE # _____

Remarks: 65' x 6'
40' x 5'
70' x 4'
70' x 3'

TOTAL SQUARE FEET: 658 TOTAL LINEAL FEET: 195'

CONDITIONS OF THE PERMIT:

- Any type of retaining wall must be engineered by a Civil or Structural Engineer.
- If a home owner takes out the Building Permit and if the owner sublets the work to a Contractor, then the Contractor must take out the permit and pay for it.
- No fence or wall can be built on City property or rights-of-way, but this is not intended to preclude construction within utility easements if utilities will not be damaged or made inaccessible.
- The fence or wall shall not enclose any water meter, light standard, or fire alarm box and shall not come closer than 24" from the nearest fire hydrant outlet.
- Department Inspectors must approve footings before concrete is poured and block wall reinforcing before grouting.
- Maximum height of any wall or fence is 6 feet and rear yards; 4' maximum in front yard with the vertical surface above the height of 2' - 50% open.
- I must not obstruct required onsite parking space (2 spaces for each dwelling unit) by the erection of this fence or wall.
- By the signing of this application I herewith agree to the requirements outlined above.

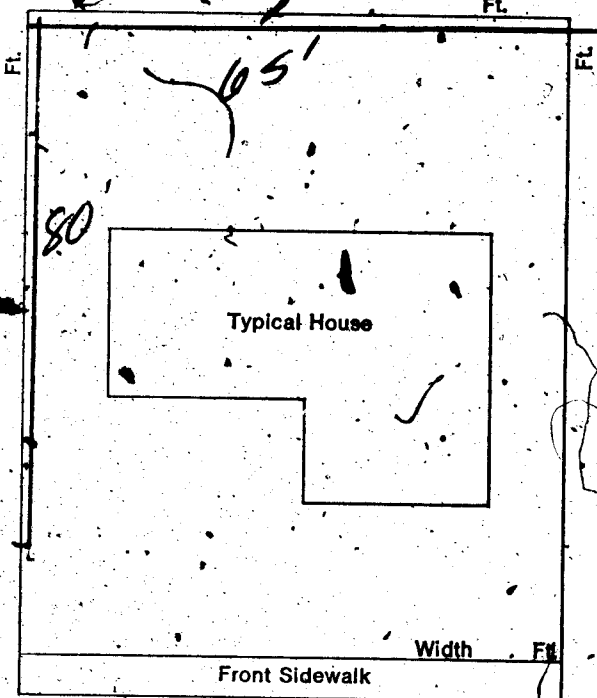

SIGNED: [Signature] DATE: _____
CONTRACTOR AGENT OWNER

PLANNING DEPT: _____ Date: 1-6-78

PUBLIC WORKS DEPT: [Signature] Date: 1/11/78

BUILDING DIVISION: [Signature] Date: 1-19-78

#12850. PERMIT.NO: 3135-32 PERMIT FEE \$12.00

RECEIPT

MUST BE MACHINE VALIDATED

DEPARTMENT OF BUILDING & SAFETY
 CITY OF LAS VEGAS, NEVADA
 OWNER Home Savings
 ADDRESS Delphinium Ave.
 DATE 1-20-78
 CONTRACTOR Anthony & sons
 PERMIT NO. 3125-31

LOT _____ BLOCK _____ SUBDIVISION _____ Block fence

Fence (wire, wood, etc.)	Walls (masonry, rock, etc.)
Location <u>SC 125-28</u>	Location _____
Final Inspection _____	Footings _____
	Wall Steel 1st _____ 2d _____ 3d _____
	Final Inspection <u>SC 125-28</u>

Retaining Wall (masonry)	Retaining Wall (concrete)
Location _____	Location _____
Footings _____	Footings _____
Wall Steel 1st _____ 2d _____ 3d _____	Wall Steel 1st _____ 2d _____ 3d _____
Bond Beam 1st _____ 2d _____ 3d _____	Final Inspection _____
Final Inspection _____	

23:14 B ADDRESS 6449 Delphinium Ave. AREA _____

DIVISION of BUILDING & SAFETY - CITY of LAS VEGAS, NEVADA
 OWNER Home Service Corp ADDRESS 6449 Delphinium Ave. DATE 1-20-78
 GEN. CONT. Sun Home Builders
 PERMIT NO. 3044-30 LEGAL DESCRIPTION L 41 B 11 Jade Park # 3
 TYPE OF STRUCTURE mobile Home estates

BUILDING	MECHANICAL	ELECTRICAL
Investigation _____	Plumbing Cont. _____ Date _____	Temp. pole cont. _____ Date _____
Location & Footing _____	Permit No. _____	Permit No. _____ Date _____
Stem Wall _____	Heat & Vent. A/C Cont. _____ Date _____	Inspection _____ Date _____
Concrete Slab Floor _____	Permit No. _____	Electrical Cont. _____ Date _____
Floor Framing _____	Sewer Cont. <u>Sun Home Builders</u>	Permit No. _____ Date _____
Fireplace Footing _____	Permit No. <u>3043</u> Date _____	Fixtures Cont. _____ Date _____
Chimney Ste _____	Rough Soil _____	Permit No. _____ Date _____
Vert. Steel Reinf. _____	Rough Water _____	Slab _____
Horiz. Steel Reinf. _____	Top-Out _____	Rough _____
Roof Sheathing _____	Rough Gas _____	Final Rough _____
Framing _____	A/C Rough Duct _____	Final Fixture _____
Backing for siding _____	Ref. Rough Piping _____	Final Electrical _____
Ext. Lath _____	Final Plumbing _____	Temporary Service _____
Ext. Scratch _____	Final Gas _____	MISCELLANEOUS
Ext. Brown _____	Final Air Cond. _____	Grading & Drainage _____
Int. Lath _____	Final Refrig. _____	On-Site Parking Spaces _____ App _____
Int. Brown _____	Final Sewer _____	Eng. Approval of _____
Drywall _____	Final Septic Tank _____	Off-Site Improvements _____
Insulation _____		
Final Building _____		
Appr. for Occu. _____		

INSPECTOR: E. Clark DATE 2-11-79

APPROVED FOR OCCUPANCY & METER
 PLEASE NOTE REMARKS ON REVERSE SIDE 6449 Delphinium Ave. LOG # _____ AREA # _____ T1-3 76-11-4