

3401 Drover

L29 B1 College Park 26 Zone R-1

L. Watson 3-14-79

CITY OF LAS VEGAS, NEVADA

LOG NO. & AREA \_\_\_\_\_ CONST. VAL. \$ 16,960.00  
 DEPARTMENT OF BUILDING & SAFETY APPLICATION & BUILDING PERMIT — for:  
 Dwellings, Duplexes, Misc. Residential Const.

ADDRESS OF CONSTRUCTION: 3401 Drover Avenue OWNER: PARDEE CONSTRUCTION CO.

LOT(s) 29 BLOCK 1 SUBDIVISION College Park 26- ZONE: R-1

Existing structure on lot: Dwelling  Accessory bldgs.  Vacant lot  Other

PROPOSED CONSTRUCTION: SPD USE: None

MATERIALS OF CONSTRUCTION: Wood Frame  Concrete Block  Reinforced Concrete  Steel Frame

SQ. FEET OF FLOOR AREAS: 1st 1150 2nd \_\_\_\_\_ 3rd \_\_\_\_\_ Other 427 TOTAL SQ. FT. 1,577

FIRE ZONE: 1  2  Occupancy Group   1-2 \_\_\_\_\_ CONST. TYPE: I II III IV

ARCHITECT: \_\_\_\_\_ ENGINEER: \_\_\_\_\_ NO. of UNITS 1 NO. of STORIES 1

Plans Submitted: Yes  No  Calculations Submitted Yes  No  Sewer Fee Req'd. Yes  No

CONTRACTOR: PARDEE CONSTRUCTION STATE LICENSE # 3633-A CITY LICENSE # 01155

ADD'L. PERMITS REQ'D: Air Cond.  Elec.  Plumbing  Signs  Paving  Fence  Public Walks  Curb-gutters   
 Incinerators  Fire Sprinkling System

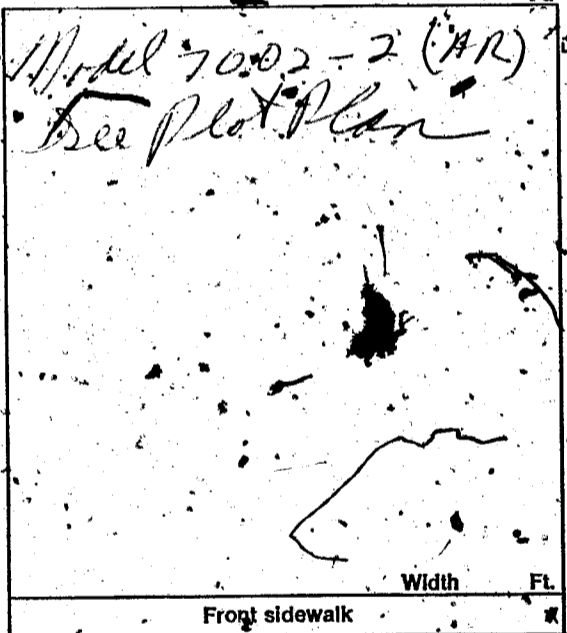

CONDITIONS OF THE PERMIT:

- I agree to call the City Building Department for inspections before concrete is poured, before rough wiring, electrical, plumbing, framing is covered. Also for air conditioning, sheet-rock and sheathing inspection.
- I agree that when the job is completed that I will call for final inspection before occupancy.
- I agree to perform all construction in accordance with City Ordinances and Building Codes.
- The Contractor's signature below denotes authority from the owner to sign in his behalf and that the owner is aware of all requirements of this application and permit. Separate permits must be taken out for work outlined above this agreement.
- I have read and understand the contents of this application and permit; I hereby state that the information I have supplied on this application is true and correct.

SIGNED: PARDEE CONSTRUCTION CO. Contractor  
 BY: \_\_\_\_\_ Agent or Owner

CLARK COUNTY HEALTH DEPT. \_\_\_\_\_ Date \_\_\_\_\_  
 LAS VEGAS FIRE DEPARTMENT \_\_\_\_\_ Date \_\_\_\_\_

PLANNING DEPT.: PA Date: 12-6-72  
 PUBLIC WORKS DEPT.: PA Date: 12-7  
 BUILDING DEPT.: NM Date: 12-8-72

12850 PERMIT NO.: 833.6 PERMIT FEE \$ 70.00

RECEIPT  
 7490 \$070.00 - 8  
 CITY OF LAS VEGAS  
 DEPT. OF BUILDING & SAFETY  
 MUST BE MACHINE VALIDATED  
 - 8 DEC 72

G. Lattin 3-14-79

CITY OF LAS VEGAS, NEVADA

LOG NO. & AREA \_\_\_\_\_ DEPARTMENT OF BUILDING & SAFETY APPLICATION & BUILDING PERMIT - for: CONST. VAL. \$ 16,960.00 Dwellings, Duplexes, Misc. Residential Const.

ADDRESS OF CONSTRUCTION: 3401 Drover Avenue OWNER: PARDEE CONSTRUCTION CO.

LOT(s) 29 BLOCK 1 SUBDIVISION College Park 26-1 ZONE RT

Existing structure on lot: Dwelling [ ] Accessory bldgs. [ ] Vacant lot [x] Other [ ]

PROPOSED CONSTRUCTION: SFD USE: SFD

MATERIALS OF CONSTRUCTION: Wood Frame [x] Concrete Block [ ] Reinforced Concrete [ ] Steel Frame [ ]

SQ. FEET OF FLOOR AREAS: 1st 1150 2nd \_\_\_\_\_ 3rd \_\_\_\_\_ Other 427 TOTAL SQ. FT. 1,577

FIRE ZONE: 1 2 3 Occupancy Group X XI 1-21 CONST. TYPE: I II III IV V

ARCHITECT: \_\_\_\_\_ ENGINEER: \_\_\_\_\_ NO. of UNITS 1 NO. of STORIES 1

Plans Submitted: Yes [x] No [ ] Calculations Submitted Yes [x] No [ ] Sewer Fee Req'd. Yes [x] No [ ]

CONTRACTOR: PARDEE CONSTRUCTION STATE LICENSE # 3633-A CITY LICENSE # 01155

ADD'L. PERMITS REQ'D: Air Cond. [x] Elec. [x] Plumbing [x] Signs [ ] Paving [ ] Fence [ ] Public Walks [ ] Curb-gutters [ ] Incinerators [ ] Fire Sprinkling System [ ]

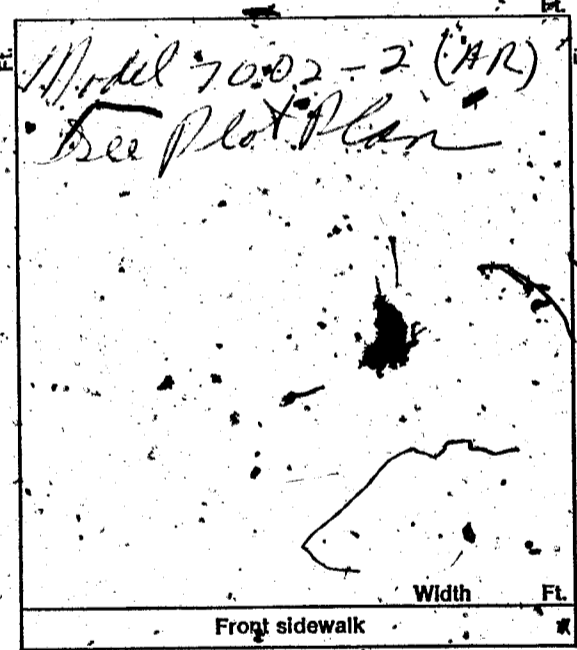

CONDITIONS OF THE PERMIT:

- 1. I agree to call the City Building Department for inspections before concrete is poured, before rough wiring, electrical, plumbing, framing is covered. Also for air conditioning, sheet-rock and sheathing inspection.
2. I agree that when the job is completed that I will call for final inspection before occupancy.
3. I agree to perform all construction in accordance with City Ordinances and Building Codes.
4. The Contractor's signature below denotes authority from the owner to sign in his behalf and that the owner is aware of all requirements of this application and permit. Separate permits must be taken out for work outlined above this agreement.
5. I have read and understand the contents of this application and permit; I hereby state that the information I have supplied on this application is true and correct.

SIGNED: PARDEE CONSTRUCTION CO. Contractor

BY: \_\_\_\_\_ Agent or Owner

CLARK COUNTY HEALTH DEPT. Date \_\_\_\_\_ LAS VEGAS FIRE DEPARTMENT Date \_\_\_\_\_

PLANNING DEPT. Date: 12-6-72
PUBLIC WORKS DEPT. Date: 12-7
BUILDING DEPT. Date: 12-8-72
12850 PERMIT NO.: 833.6 PERMIT FEE \$70.00

RECEIPT
7490 \$070.00 - 8
CITY OF LAS VEGAS
DEPT. OF BUILDING & SAFETY
MUST BE MACHINE VALIDATED
- 8 DEC 72

3-14-79

CITY OF LAS VEGAS, NEVADA  
DEPARTMENT OF BUILDING & SAFETY

RECEIPT  
FOR  
SEWER CONNECTION FEE

JOB ADDRESS: 3401 Drover Avenue OWNERS NAME: Pardee Construction

LOT 29 BLOCK 1 SUBDIVISION College Park 26-2

QUANTITY	OCCUPANCY	UNIT FEE	AMOUNT

PAID BY: \_\_\_\_\_

TOTAL \_\_\_\_\_

Less Credit \_\_\_\_\_

TOTAL FEE \$ \_\_\_\_\_

\*Credit for existing sewer is applied to the new sewer connection fee based on previous type of occupancy and only when the new occupancy requires an additional fee.

This receipt does not authorize the owner or his representative to start any work without obtaining a plumbing permit.

*[Signature]*  
DEPARTMENT OF BUILDING & SAFETY DATE

RECEIPT NO. 7986 SEWER FEE \$150

# 73102

RECEIPT  
7448 \$150.00 - 3  
CITY OF LAS VEGAS  
DEPT. OF BUILDING & SAFETY  
MUST BE MACHINE VALIDATED  
- 8 DEC 72

14. Latwood 3-14-79

**CITY OF LAS VEGAS, NEVADA**  
**DEPARTMENT OF BUILDING & SAFETY — AIR CONDITIONING APPLICATION & PERMIT**

ADDRESS OF CONSTRUCTION: 3401 Droyer Avenue

OWNER'S NAME: Pardee Construction Co. of Nevada

CIRCLE: Addition; Remodel; New Bldg;

TYPE OF BLDG.: SFD APT. COMM. PUBLIC

CONTRACTOR'S NAME: Tropic-Aire Conditioning

STATE LICENSE: 10126 A CITY LICENSE: 03382

UNITS	DESCRIPTION	FEE	TOTAL	UNITS	DESCRIPTION	FEE	TOTAL
	Unit heater — floor, wall or suspended	4.00			<b>EVAPORATIVE COOLERS:</b>		
	<b>FOR EACH FORCED-AIR OR GRAVITY-TYPE FURNACE OR BURNER INCLUDING DUCTS AND VENT ATTACHED TO SUCH APPLIANCES:</b>				5 outlets or under	3.00	
	Up to and including 100,000 B.t.u.'s	4.00			Over 5 and up to and including 10	5.00	
	Over 100,000 B.t.u.'s	6.00			Each additional outlet over 10	.25	
	<b>FOR EACH HEATING APPLICATION, REFRIGERATION UNIT, COMFORT COOLING AND HEATING UNIT, ABSORPTION UNIT, COMPRESSOR OR BOILER:</b>				<b>VENTILATION:</b>		
	Up to and including 3 ton or horsepower, or absorption system up to and including 100,000 B.t.u.'s	4.00			For each fan connected to a single duct	1.00	
4 ton	Over 3 ton or 3 horsepower up to and including 10, or absorption system over 100,000 B.t.u.'s up to and including 250,000 B.t.u.'s	7.00	7.00		For each commercial or industrial ventilation system	5.00	
	Over 10 ton or 10 horsepower up to and including 30, or absorption system over 250,000 B.t.u.'s up to and including 1,000,000 B.t.u.'s	12.00			For each commercial kitchen hood	5.00	
	Over 30 ton or 30 horsepower up to and including 50, or absorption system over 1,000,000 B.t.u.'s up to and including 1,700,000 B.t.u.'s	20.00			<b>MISCELLANEOUS:</b>		
	Over 50 ton or 50 horsepower, or absorption system over 1,700,000 B.t.u.'s	30.00			For each water cooling tower	8.00	
	<b>FOR EACH AIR HANDLING UNIT INCLUDING DUCTS ATTACHED THERETO:</b>				Duct work only — each opening	.25	
	Up to and including 10,000 CFM	2.00			For installation or relocation of each commercial or industrial incinerator	15.00	
	Over 10,000 CFM	4.00			Gas piping related to the air cond. work in single family dwelling only	3.00	
					For each appliance, piece of equipment, any mechanical work or alteration or replacement not included in this schedule, the permit fee shall be computed the same as building permit fees by using the cost of installation for the valuation amount.		
					<b>FOR THE ISSUANCE OF EACH PERMIT</b>	3.00	
					<b>TOTAL PERMIT FEE \$</b>	<b>10.00</b>	

I hereby certify that I have carefully examined and read the above application; that the same is true and correct; and that the work herein described is to be done in accordance with all the provisions of the applicable Ordinances of the City of Las Vegas, Nevada and the State Laws, whether herein specified or not.

SIGNED: Ruth L. Wilson Date: 1-17-73  
 Air Conditioning Contractor - Owner

BUILDING DEPARTMENT: N. Miller Date: 1-22-73

PERMIT NO. 3747 PERMIT FEE \$ 10.00

**RECEIPT**

9388 \$010.00 — 4

CITY OF LAS VEGAS  
 DEPT. OF BUILDING & SAFETY

MUST BE MACHINE VALIDATED  
 22 JAN 73

14. *W. J. ...* 3-14-79

**CITY OF LAS VEGAS, NEVADA**  
**DEPARTMENT OF BUILDING & SAFETY — AIR CONDITIONING APPLICATION & PERMIT**

ADDRESS OF CONSTRUCTION: 3401 Dwyer Avenue

OWNER'S NAME: Pardee Construction Co. of Nevada

CIRCLE: Addition; Remodel; New Bldg;

TYPE OF BLDG.: SFD APT. COMM. PUBLIC

CONTRACTOR'S NAME: Tropic-Aire Conditioning

STATE LICENSE: 10126 A CITY LICENSE: 03382

UNITS	DESCRIPTION	FEE	TOTAL	UNITS	DESCRIPTION	FEE	TOTAL
	Unit heater — floor, wall or suspended	4.00			<b>EVAPORATIVE COOLERS:</b>		
	<b>FOR EACH FORCED-AIR OR GRAVITY-TYPE FURNACE OR BURNER INCLUDING DUCTS AND VENT ATTACHED TO SUCH APPLIANCES:</b>				5 outlets or under	3.00	
	Up to and including 100,000 B.t.u.'s	4.00			Over 5 and up to and including 10	5.00	
	Over 100,000 B.t.u.'s	6.00			Each additional outlet over 10	.25	
	<b>FOR EACH HEATING APPLICATION, REFRIGERATION UNIT, COMFORT COOLING AND HEATING UNIT, ABSORPTION UNIT, COMPRESSOR OR BOILER:</b>				<b>VENTILATION:</b>		
	Up to and including 3 ton or horsepower, or absorption system up to and including 100,000 B.t.u.'s	4.00			For each fan connected to a single duct	1.00	
<u>4 ton</u>	Over 3 ton or 3 horsepower up to and including 10, or absorption system over 100,000 B.t.u.'s up to and including 250,000 B.t.u.'s	7.00	<u>7.00</u>		For each commercial or industrial ventilation system	5.00	
	Over 10 ton or 10 horsepower up to and including 30, or absorption system over 250,000 B.t.u.'s up to and including 1,000,000 B.t.u.'s	12.00			For each commercial kitchen hood	5.00	
	Over 30 ton or 30 horsepower up to and including 50, or absorption system over 1,000,000 B.t.u.'s up to and including 1,700,000 B.t.u.'s	20.00			<b>MISCELLANEOUS:</b>		
	Over 50 ton or 50 horsepower, or absorption system over 1,700,000 B.t.u.'s	30.00			For each water cooling tower	8.00	
	<b>FOR EACH AIR HANDLING UNIT INCLUDING DUCTS ATTACHED THERETO:</b>				Duct work only — each opening	.25	
	Up to and including 10,000 CFM	2.00			For installation or relocation of each commercial or industrial incinerator	15.00	
	Over 10,000 CFM	4.00			Gas piping related to the air cond. work in single family dwelling only	3.00	
					For each appliance, piece of equipment, any mechanical work or alteration or replacement not included in this schedule, the permit fee shall be computed the same as building permit fees by using the cost of installation for the valuation amount.		
					<b>FOR THE ISSUANCE OF EACH PERMIT</b>	<b>3.00</b>	
					<b>TOTAL PERMIT FEES</b>	<b>10.00</b>	

I hereby certify that I have carefully examined and read the above application; that the same is true and correct; and that the work herein described is to be done in accordance with all the provisions of the applicable Ordinances of the City of Las Vegas, Nevada and the State Laws, whether herein specified or not.

SIGNED *Ruth R. Wilson* Date 1-17-73  
 Air Conditioning Contractor - Owner

BUILDING DEPARTMENT *N. Mills* Date 1-22-73

PERMIT NO. 3747 PERMIT FEE \$ 10.00

**RECEIPT**

9388 \$010.00 — 4

CITY OF LAS VEGAS  
 DEPT. OF BUILDING & SAFETY

MUST BE MACHINE VALIDATED  
 22 JAN 73

*A. Latwood 3-14-79*

CITY OF LAS VEGAS, NEVADA

DEPARTMENT OF BUILDING & SAFETY — APPLICATION AND PERMIT FOR PLUMBING

ADDRESS OF CONSTRUCTION: 3401 Drovers Ave. (1-29) OWNER'S NAME: PARDEE CONSTRUCTION (7002-2AB)

CIRCLE: New Bldg. (Add'n; Remodel); TYPE OF BLDG.: SFD. APT. PUBLIC COMM.

CONTRACTOR'S NAME: KITZMAN'S PLUMBING OF NEV. STATE LICENSE # 10472 CITY LICENSE # 14

UNITS	DESCRIPTION	FEE	TOTAL
1	Bathtub	1.00	1.00
1	Shower	1.00	1.00
3	Lavatory	1.00	3.00
2	Toilet	1.00	2.00
	Urinal	1.00	
	Floor Drain	1.00	
	Floor Sink	1.00	
	Wash Tray	1.00	
1	Sink	1.00	1.00
1	Garbage Disposal	1.00	1.00
	Garbage Disposal (comm.)	3.00	
1	Clothes Dryer (gas)	1.00	1.00
1	Clothes Washer	1.00	1.00
	Clothes Washer (comm.)	5.00	
	Dishwasher	1.00	
	Dishwasher (commercial)	5.00	
	Dental Unit	10.00	
	Drinking Fountain	1.00	
	Any Water-using Equipment	1.00	
1	Water Heater (gas) (elect.)	1.00	1.00
1	Sewer System — New, Replacement, or any Drainage System	4.00	4.00
	Grease or Sand Trap	2.00	
	Trailer Trap	2.00	
	Septic Disposal System	3.00	
WATER SOFTENERS			
	Nonpermanent Type	4.00	
	Permanent Type (connected to Drainage)	5.00	
SWIMMING POOLS			
	Private or Wading Pool	10.00	
	Public or Semi-public	20.00	

UNITS	DESCRIPTION	FEE	TOTAL
WATER DISTRIBUTION SYSTEM			
1	Single Family Dwelling	4.00	4.00
	Multiple Family Dwelling plus each unit	4.00 2.00	
	Bldg. Group "A" thru "G" per each floor	6.00	
	Hotel or Motel plus each bath	4.00 1.50	
	Trailer Park plus each space	20.00 1.00	
	Irrigation	4.00	
GAS PIPING SYSTEM			
1	Single Family Dwelling	3.00	3.00
	Multiple Family Dwelling plus each unit	6.00 1.00	
	Commercial Bldg. per floor plus each unit	3.00 3.00	
	Gas Appliance (any type)	1.00	
AUTOMATIC FIRE EXTINGUISHING SYSTEM			
	Underground Piping	10.00	
	Distribution Piping ea. ft.	.01	
	Sprinkler Head each	1.00	
	In Range Hood and Vent	5.00	
DRY STANDPIPE SYSTEM			
	Piping	50.00	
	Each Outlet	1.00	
WET STANDPIPE SYSTEM			
	Piping	6.00	
	Fire Hose Cabinet	1.00	
	MINIMUM PERMIT FEE	4.00	
PIPELINE CONTRACTOR; SECT. 14.8 P.F. \$			
TOTAL PERMIT FEE \$ <u>22.50</u>			

I hereby certify that I have carefully examined and read the above application; that the same is true and correct; and that the work herein described is to be done in accordance with all the provisions of the applicable Ordinances of the City of Las Vegas, Nevada and the State Laws, whether herein specified or not.

Signed: *A. R. Ruffolo* Date: 12-1-72  
REGISTERED MASTER PLUMBER, SECT. 14.8 P.F. CONTRACTOR OR OWNER  
 Building Department: *N. Mills* Date: \_\_\_\_\_  
 Permit No. 8110 Permit Fee \$ 22.50

RECEIPT

8153 \$022.00 - 7

CITY OF LAS VEGAS  
 DEPT. OF BUILDING & SAFETY  
 MUST BE MACHINE VALIDATED

26 DEC 72

*7 9*

*M. L. Lattwood 3-14-79*

**CITY OF LAS VEGAS, NEVADA**

**DEPARTMENT OF BUILDING & SAFETY - ELECTRICAL APPLICATION & PERMIT**

ADDRESS OF CONSTRUCTION: 3401 Drover Ave., L.V. Nev. OWNER'S NAME: Pardee Constr. of Nev. College Park No. 26 - 2  
 CIRCLE: New Bldg. Add'n, Remodel, TYPE OF BLDG.: SFD ART. PUBLIC COMM. 31-1-29  
 CONTRACTOR'S NAME: Sparks Electric Co., Inc. STATE LICENSE # 5191 A CITY LICENSE # 04851

NUMBER	FIXTURE OR INSTALLATION	UNIT PRICE	
10	Fixture or sockets	.15	1.50
45	Light, receptacle or switch outlet	.20	9.00
	Wall or ceiling space heater	.35	
	Blast coil heater per kilowatt	.35	
1	Garbage grinder outlet	.35	.35
	Dishwasher outlet	.35	
	Clothes dryer outlet	.35	
1	Automatic clothes washer	.35	.35
	Electric range outlet	.35	
	Electric water heater outlet	.35	
	Mercury arc lamp and equipment	.35	
	Special purpose outlet	.35	
	X-ray unit and its appurtenances	5.00	
	Watts of festoon lighting (Watts) First 3,000 watts	4.00	
	for each additional thousand watts	1.50	
1	Horsepower - all motors first horsepower or less	1.75	1.75
2	for each additional horsepower	.35	.70
	Temporary power and lights (temporary pole)	4.00	
1	Electric service (including any single meter socket)	3.00	3.00
	for each additional socket	.35	
	Air conditioning service amps	1.50	
	Each KW (KVA) Generator (Transformer) (Welder) KW (KVA)	2.00	
	First 100 KVA - For each additional KW, (KVA)	.01	
	Special inspection per hour	4.00	
	Speaker outlets	.15	
	Signal or Alarm outlets	.15	
	Amplifiers	.50	
	Control panels	.25	
	T. V. outlets - master system only	.15	
	Radio outlets	.15	
	Main control racks	1.00	
	T. V. and Radio antennas - mastersystem only	.75	
	Minimum fee for any permit	4.00	
	Total fee		16.65

I hereby certify that I have carefully examined and read the above application; that the same is true and correct; and that the work herein described is to be done in accordance with all the provisions of the applicable Ordinances of the City of Las Vegas, Nevada and State laws whether herein specified or not.

SIGNED *Bill C. Sparks* DATE 2-23-73  
MASTER (ELECTRICIAN), (TECHNICIAN), (OWNER)  
 BUILDING DEPARTMENT *Janet Dwyer* DATE 2-23-73  
 #12860 PERMIT NO. 555 PERMIT FEE: \$ 16.65

**RECEIPT**  
 1401 \$016.65  
 CITY OF LAS VEGAS  
 DEPT. OF BUILDING & SAFETY  
 MUST BE MACHINE VALIDATED  
 23 FEB 73

DEPARTMENT OF BUILDING & SAFETY  
CITY OF LAS VEGAS, NEVADA

BARREX CARD  
FENCE & RETAINING  
WALLS

OWNER Pardee DATE 5-4-73

CONTRACTOR Jambo PERMIT NO. 11057

LOT 29 BLOCK 26 SUBDIVISION College Park # 26 block fence

Fence (wire, wood, etc.)		Walls (masonry, rock, etc.)	
Location		Location	<u>le 5-3-73</u>
Final Inspection		Footing	<u>8c 5-3-73</u>
		Wall Steel 1st	<u>sc 4-22-73</u> 3d
		Final Inspection	<u>sc 4-5-73</u>
Retaining Wall (masonry)		Retaining Wall (concrete)	
Location		Location	
Footing		Footing	
Wall Steel 1st	2d 3d	Wall Steel 1st	2d 3d
Bond Beam 1st	2d 3d	Final Inspection	
Final Inspection			

23.14 B ADDRESS 3401 Drover LOG NO. \_\_\_\_\_ AREA \_\_\_\_\_

DEPT. of BLDG & SAFETY - CITY of LAS VEGAS, NEVADA

OWNER Pardee Const ADDRESS 3401 Drover Ave. DATE 12-8-72

GEN. CONT. Pardee TYPE OF STRUCTURE SFD

PERMIT NO. 8336 LEGAL DESCRIPTION L 29 B 1 College Park 26

BUILDING	MECHANICAL	ELECTRICAL
LOCATION <u>sc 2-18-72</u>	PLUMBING CONT. <u>R. G. Gorman</u>	TEMP. POLE CONT.
FIREPLACE FTS	PERMIT NO. <u>2110</u> DATE <u>12-26-72</u>	PERMIT NO. _____ DATE _____
FOOTINGS <u>sc 2-18-72</u>	HEAT & VENT. AC CONT. <u>Topice Ave.</u>	INSPECTION DATE _____
FOUNDATION WALL	PERMIT NO. <u>3177</u> DATE <u>7-22-73</u>	ELECTRICAL CONT. <u>Spa. A.</u>
FLOOR FRAMING	SEWER CONT. <u>Pardee Const.</u>	PERMIT NO. <u>5351</u> DATE <u>2-23-73</u>
SLAB <u>sc 2-18-72</u>	PERMIT NO. <u>7986</u> DATE _____	FIXTURES CONT.
CHIMNEY STEEL (FIREPLACE)	ROUGH SOIL <u>sc 1-19-73</u>	PERMIT NO. _____ DATE _____
WALL STEEL	ROUGH WATER <u>sc 1-19-73</u>	SLAB
COLUMN STEEL	TOP-OUT <u>sc 2-26-73</u>	ROUGH <u>VP 2-2-73</u>
BEAM STEEL	ROUGH GAS <u>sc 2-26-73</u>	FINAL ROUGH
FRAMING <u>sc 2-28-73</u>	AC ROUGH DUCT <u>sc 2-26-73</u>	FINAL FIXTURE
ROOF SHEATHING	REF. ROUGH PIPING	FINAL ELECTRICAL <u>VP 5-9-73</u>
INTERIOR	FINAL PLUMBING <u>sc 4-24-73</u>	TEMPORARY SERVICE
DRYWALL <u>sc 3-13-73</u>	FINAL GAS <u>sc 4-24-73</u>	
LATHING	FINAL AIR COND. <u>sc 4-24-73</u>	MISCELLANEOUS
BACKING (STONE)	FINAL REFRIG. <u>sc 1-19-73</u>	GRADING & DRAINAGE
PLASTER SCRATCH	FINAL SEWER <u>sc 1-19-73</u>	ON-SITE PARKING SPACES _____ APP. _____
PLASTER BROWN	FINAL BEPTIC TANK	ENG. APPROVAL OF _____
URBAN REDEVELOPMENT APPROVAL		OFF-SITE IMPROVEMENTS _____
FINAL BLDG _____ DATE _____		

APPROVED FOR OCCUPANCY METER sc 4-2-73 INSPECTOR \_\_\_\_\_ DATE \_\_\_\_\_

PLEASE NOTE REMARKS ON REVERSE SIDE

LOG # \_\_\_\_\_ AREA # \_\_\_\_\_ 23.04

3401 Drover Ave. T 49-2