

1243 Douglas

L17 B9 Westleigh Tr. #3 Zone R-1

L. J. [unclear] 3-14-79

1969

CITY OF LAS VEGAS, NEVADA

LOG NO. & AREA

CONST. VAL. \$ 350.00

DEPARTMENT OF BUILDING & SAFETY

APPLICATION & BUILDING PERMIT — for: Fence, Wall, Retaining Wall.

ADDRESS OF CONSTRUCTION: 1243 DOUGLAS DR

OWNER: B.G. Minnick

LOT(s) 17 BLOCK 9 SUBDIVISION Westleigh 12 # 3 ZONE: R-1

Materials of Construction: Block Concrete Wire Wood Other PLANS: Yes No

ARCHITECT: ENGINEER: CALCS:

CONTRACTOR: STATE LICENSE # CITY LICENSE #

TOTAL SQUARE FEET: TOTAL LINEAL FEET: 175

Remarks:

CONDITIONS OF THE PERMIT:

- 1. Any type of retaining wall must be engineered by a Civil or Structural Engineer.
2. If a home owner takes out the Building Permit and if the owner sublets the work to a Contractor, then the Contractor must take out the permit and pay for it.
3. No fence or wall can be built on City property or rights-of-way, but this is not intended to preclude construction within utility easements if utilities will not be damaged or made inaccessible.
4. The fence or wall shall not enclose any water meter, light standard, or fire alarm box and shall not come closer than 24" from the nearest fire hydrant outlet.
5. Department Inspectors must approve footings before concrete is poured and block wall reinforcing before grouting is done.
6. Maximum height of any wall or fence is 6', side and rear yards; 4' maximum in front yard with the vertical surface above the height of 2' - 50% open and further that fencing within 25' of the intersection of curb faces on corner and through lots is limited to a maximum height of 30".
7. I must not obstruct required onsite parking space (1 space for each dwelling unit) by the erection of this fence or wall.
8. By the signing of this application I herewith agree to the requirements outlined above.

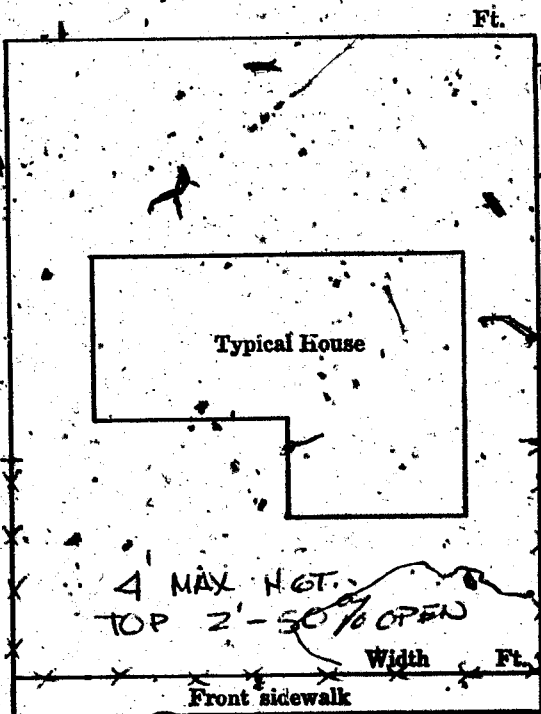

Douglas

SIGNED: [Signature] DATE: CONTRACTOR AGENT OWNER

PLANNING DEPT: [Signature] Date: 1-28-69
ENGINEERING DEPT: Date:
BUILDING DEPT: G. Wenzl Date: 1-28-69
#1285 PERMIT NO: 45765 PERMIT FEE \$ 4.00

RECEIPT
17 \$004.00
CITY OF LAS VEGAS
DEPT. OF BUILDING & SAFETY
MUST BE MACHINE VALIDATED
2-8 JAN 69

DEPARTMENT OF BUILDING & SAFETY
CITY OF LAS VEGAS, NEVADA

(KARDEX CARD)
FENCE & RETAINING
WALLS

OWNER B. A. Minnick

ADDRESS 1243 Douglas Dr.

DATE 1/28/69

CONTRACTOR Owner

PERMIT NO. 45765

LOT 17

BLOCK 9

SUBDIVISION West side #1

Wood

Fence (wire, wood, etc.)

Walls (masonry, rock, etc.)

Location _____

Location _____

Final Inspection 2-10-69

Footing _____

Wall Steel 1st _____ 2d _____ 3d _____

Final Inspection _____

Retaining Wall (masonry)

Retaining Wall (concrete)

Location _____

Location _____

Footing _____

Footing _____

Wall Steel 1st _____ 2d _____ 3d _____

Wall Steel 1st _____ 2d _____ 3d _____

Bond Beam 1st _____ 2d _____ 3d _____

Final Inspection _____

Final Inspection _____

23.14 B

ADDRESS 1243 Douglas Dr.

LOG NO. _____

AREA _____

DEPT. of BLDG & SAFETY - CITY of LAS VEGAS, NEVADA

OWNER Harry Minnick ADDRESS 1243 Douglas DATE 5-4-65
 GEN. CONT. Same TYPE OF STRUCTURE Storage Shed
 PERMIT NO. 30204 LEGAL DESCRIPTION Lot 17 Blk 9 Westleigh #3

LOCATION	BUILDING		MECHANICAL		ELECTRICAL	
	INTERIOR	EXTERIOR	PLUMBING CONT.	DATE	TEMP. BOLE CONT.	DATE
FIRPLACE FTG.			PERMIT NO.	DATE	PERMIT NO.	DATE
FOOTINGS			HEAT & VENT. AC CONT.	DATE	INSPECTION	DATE
FOUNDATION WALL			PERMIT NO.	DATE	ELECTRICAL CONT.	DATE
FLOOR FRAMING			SEWER CONT.	DATE	PERMIT NO.	DATE
SLAB			ROUGH SOIL	DATE	FIXTURES CONT.	DATE
CHIMNEY STEEL (PREPLACE)			ROUGH WATER		PERMIT NO.	DATE
WALL STEEL			TDP-DUT		SLAB	
COLUMN STEEL			ROUGH GAS		ROUGH	
BEAM STEEL			AC ROUGH DUCT		FINAL ROUGH	
FRAMING			REF ROUGH PIPING		FINAL FIXTURE	
ROOF SHEATHING			FINAL PLUMBING		FINAL ELECTRICAL	
DRYWALL			FINAL GAS		TEMPORARY SERVICE	
LATHING			FINAL AIR COND.			
BACKING (SAND)			FINAL REFRIG.		MISCELLANEOUS	
PLASTER			FINAL SEWER		GRADING & DRAINAGE	
SCRATCH			FINAL SEPTIC TANK		ON-SITE PARKING SPACES	PP.
BROWN					ENG APPROVAL OF	
URBAN REDEVELOPMENT APPROVAL					OFF-SITE IMPROVEMENTS	
FINAL BLDG.						

APPROVED FOR OCCUPANCY & METER _____ INSPECTOR _____ DATE _____
 PLEASE NOTE REMARKS ON REVERSE SIDE
 1243 Douglas
 LOT # _____ AREA # _____ 2304