

901 Desert Lane

L5 Buena Vista Add Zone R-3

A. Gatewood 3-7-79

CITY OF LAS VEGAS, NEVADA

LOG NO. & AREA

DEPARTMENT OF BUILDING & SAFETY

CONST. VAL. \$ 370<sup>00</sup>

APPLICATION & BUILDING PERMIT - for: Fence, Wall, Retaining Wall.

ADDRESS OF CONSTRUCTION

901 Desert Lane

OWNER: B. Hayboer

LOT(s)

BLOCK

SUBDIVISION

BUENA VISTA ADD

ZONE

R3

Materials of Construction:

Block

Concrete

Wire

Wood

Other

Yes

No

ARCHITECT:

ENGINEER:

PLANS:

CALCS:

CONTRACTOR:

P. J. J. J.

STATE LICENSE #

4012

CITY LICENSE #

100-9

TOTAL SQUARE FEET

TOTAL LINEAL FEET

185'

Remarks:

Remarks section with handwritten '2' in the first row.

CONDITIONS OF THE PERMIT:

- 1. Any type of retaining wall must be engineered by a Civil or Structural Engineer.
2. If a home owner takes out the Building Permit and if the owner sublets the work to a Contractor, then the Contractor must take out the permit and pay for it.
3. No fence or wall can be built on City property or rights-of-way, but this is not intended to preclude construction within utility easements if utilities will not be damaged or made inaccessible.
4. The fence or wall shall not enclose any water meter, light standard, or fire alarm box and shall not come closer than 24" from the nearest fire hydrant outlet.
5. Department Inspectors must approve footings before concrete is poured and block wall reinforcing before grouting is done.
6. Maximum height of any wall or fence is 6', side and rear yards; 4' maximum in front yard with the vertical surface above the height of 2' - 50% open.
7. I must not obstruct required onsite parking space (1 space for each dwelling unit) by the erection of this fence or wall.
8. By the signing of this application I herewith agree to the requirements outlined above.

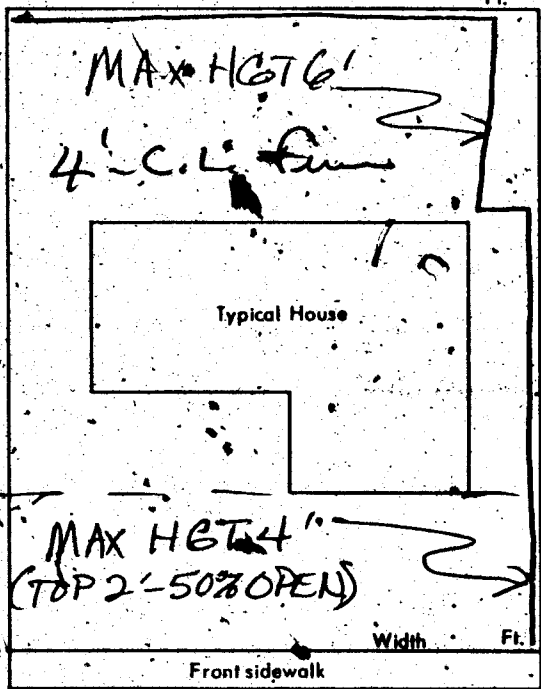

SIGNED:

Signature of contractor

DATE:

3-19-70

CONTRACTOR

AGENT

OWNER

PLANNING DEPT.:

M.C.

Date:

3-19-70

PUBLIC WORKS DEPT.:

Date:

BUILDING DEPT.:

J. Wenzel

Date:

3-19-70

#12850

PERMIT NO.:

51635

PERMIT FEE \$

6.00

RECEIPT

768 \$006.00 - 8

CITY OF LAS VEGAS DEPT. OF BUILDING & SAFETY

MUST BE MACHINE VALIDATED

20 MAR 70

DEPARTMENT OF BUILDING & SAFETY  
CITY OF LAS VEGAS, NEVADA

KARDEX CARD  
FENCE & RETAINING  
WALLS

DATE 3/20/70

OWNER B. Haybor

PERMIT NO. 51635

CONTRACTOR Fencing Inc.

Subcontractor Same Material Add

LOT 5

BLOCK Subdivision

Wire

Fence (wire, wood, etc.)

Walls (masonry, rock, etc.)

Location \_\_\_\_\_

Location \_\_\_\_\_

Final Inspection W&S 7-10

Footing \_\_\_\_\_

Wall Steel 1st \_\_\_\_\_ 2d \_\_\_\_\_ 3d \_\_\_\_\_

Final Inspection \_\_\_\_\_

Retaining Wall (masonry)

Retaining Wall (concrete)

Location \_\_\_\_\_

Location \_\_\_\_\_

Footing \_\_\_\_\_

Footing \_\_\_\_\_

Wall Steel 1st \_\_\_\_\_ 2d \_\_\_\_\_ 3d \_\_\_\_\_

Wall Steel 1st \_\_\_\_\_ 2d \_\_\_\_\_ 3d \_\_\_\_\_

Bond Beam 1st \_\_\_\_\_ 2d \_\_\_\_\_ 3d \_\_\_\_\_

Final Inspection \_\_\_\_\_

Final Inspection \_\_\_\_\_

23.14 B

ADDRESS 901 Desert Lane

LOG NO. \_\_\_\_\_

AREA \_\_\_\_\_

DEPT. of BLDG. & SAFETY - CITY of LAS VEGAS, NEVADA  
OWNER BRUCE LITTLE ADDRESS 901 Desert Lane DATE 11-22-61  
GEN. CONT. Bruce Gilbertson TYPE OF STRUCTURE 4-plex  
PERMIT NO. 6886 LEGAL DESCRIPTION See application

LOCATION <u>11-22-61</u> FIREPLACE FTG. _____ FOOTINGS <u>11-22-61</u> PILES _____ FOUND. <u>11-22-61</u> PIERS _____ FLOOR _____ SLAB <u>11-22-61</u> ANCHOR BOLTS _____ BASE PLATES _____ WALL STEEL _____ COLUMN STEEL _____ BEAM STEEL _____ FRAMING <u>11-22-61</u> ROOF SHEATHING <u>11-22-61</u> STEEL FABRICATION _____ STEEL CONNECTION _____ INTERIOR _____ EXTERIOR _____ LATHING _____ BACKING _____ PLASTER <u>11-22-61</u> SCRATCH <u>11-22-61</u> FINAL BLDG. <u>11-22-61</u> DATE <u>11-22-61</u> GRADING & DRAINAGE _____ ON-SITE PARKING _____ SPACES _____	PLUMBING CONT. <u>11-22-61</u> DATE <u>11-22-61</u> PERMIT NO. _____ HEAT & VENT. CONT. <u>11-22-61</u> DATE <u>11-22-61</u> PERMIT NO. _____ SEWER CONT. _____ PERMIT NO. <u>11-22-61</u> DATE <u>11-22-61</u> ROUGH SOIL <u>11-22-61</u> ROUGH WATER <u>11-22-61</u> TOP-OUT _____ ROUGH GAS _____ AC ROUGH DUCT <u>11-22-61</u> REF. ROUGH PIPING _____ SEWER <u>11-22-61</u> SEPIC TANK _____ FINAL PLUMBING <u>11-22-61</u> FINAL GAS _____ FINAL HEATING _____ FINAL AIR COND _____ FINAL REFRIG. _____	TEMP. PDLE CONT. _____ DATE _____ PERMIT NO. _____ INSPECTION _____ DATE _____ ELECTRICAL CONT. <u>11-22-61</u> PERMIT NO. <u>11-22-61</u> DATE <u>11-22-61</u> OUTLETS <u>11-22-61</u> MOTORS _____ H.P. _____ SLAB _____ ROUGH <u>11-22-61</u> FINAL ROUGH _____ FIXTURES CONT. _____ PERMIT NO. <u>11-22-61</u> DATE _____ FIXTURES <u>11-22-61</u> FINAL FIXTURE <u>11-22-61</u> URBAN REDEVELOPMENT APPROVAL _____ DATE _____
---	---	---

APPROVED FOR OCCUPANCY 11-22-61

APPROVED FOR METER 11-22-61

PLEASE NOTE REMARKS ON REVERSE SIDE

901 Desert Lane

LOG # 117

AREA 23.04

23.04