

1515 Fremont

SEE APPLICATION FOR LEGAL

G. Gatewood 4-30-79

1956

CITY OF LAS VEGAS
DEPARTMENT OF BUILDING AND SAFETY
APPLICATION FOR BUILDING PERMIT

VALUATION \$ 1000.00
FEES \$ 6.00

DATE: 10/29 1956

ADDRESS OF PROPOSED CONSTRUCTION: 1515 Fremont St.
Lot(s) _____ Block: _____ Subdivision: Portals SW 1/4 NE 1/4 SW 1/4 Sec 35 T. 20S R. 61E

BUILDING PERMIT NO. 27506
OWNER'S NAME: Miles Stracman
(If unsubdivided, attach legal description)

Zone: C-2 Fire Zone: 1 2 3 Occupancy Group: A B S D E F G H I J 1 2 3 4 5

Type of Construction: I II III IV V Materials of Construction: Frame and Stucco (✓) Concrete Reinforced Block () Concrete () Steel Frame ()

Stories: 1 Floor Areas: 1st 192 2nd _____ 3rd _____ Total: _____

NATURE OF PROPOSED WORK: Temp. sales office on plot PROPOSED USE: 12X16

Existing Building(s) on Lot: None

CONTRACTOR'S NAME: Martin Const. Co. State License # 2301 City License # A-50377

Architect's Name: _____ Plans Submitted: yes no

Engineer's Name: _____ Calculations Submitted: yes no

Plumbing Permit Needed: yes no Electrical Permit Needed: yes no

Location of Sewer: street alley Use of Septic Tank Approved: yes no

Offsite Improvements Existing: yes no Agreement Signed: yes no

Building Line from Center of Street: _____ Feet: _____

On plot plan below, draw in existing building(s) and indicate distance to property lines; draw in proposed construction showing distance to existing building(s) and to property lines. Show North Arrow, property dimensions and Street Name:

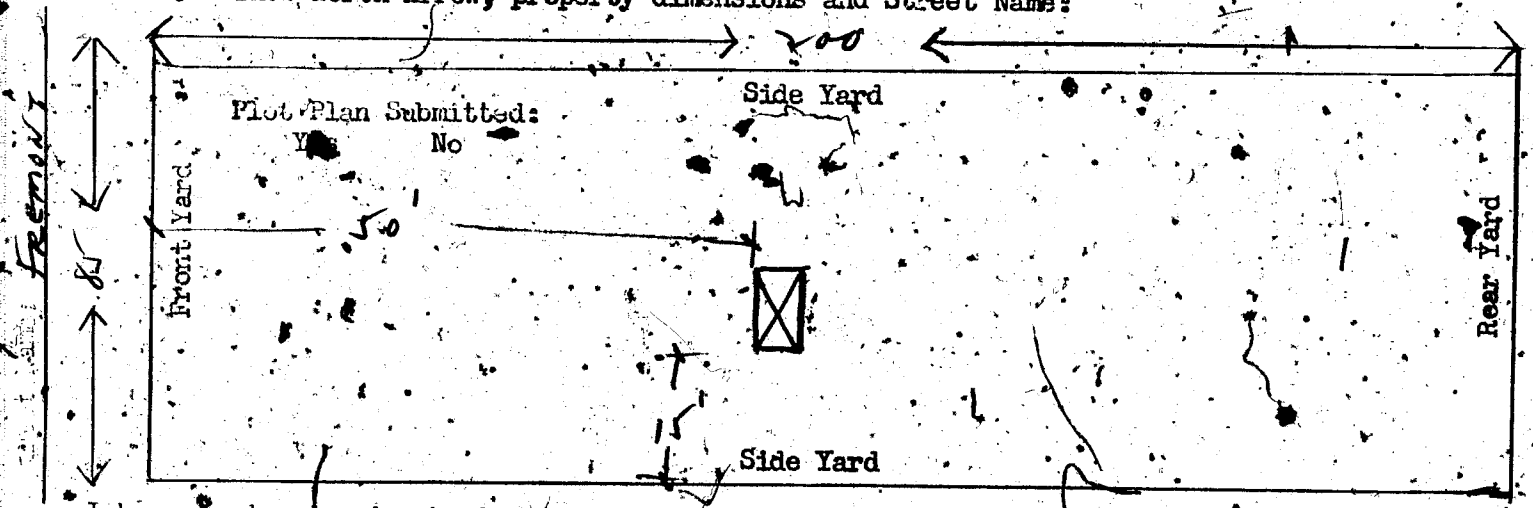

I have read and understand the contents of above application; I hereby state that same are true and correct. I further state that I am familiar with effective Ordinances of the City of Las Vegas, Nevada, and effective statutes of the State of Nevada, covering construction and use of above type; I agree to perform said construction in conformity therewith. I further agree that issuance of a permit on above application will not excuse me from conforming with said Ordinances and Statutes, despite any errors on the part of the Building Inspector or Engineer in checking plans and applications herewith submitted.

APPROVED: [Signature] 10/29/56
Planning Department date

APPLICATION: Martin Const. Co.

Engineering Department date
[Signature] 10/29/56
Building Department date

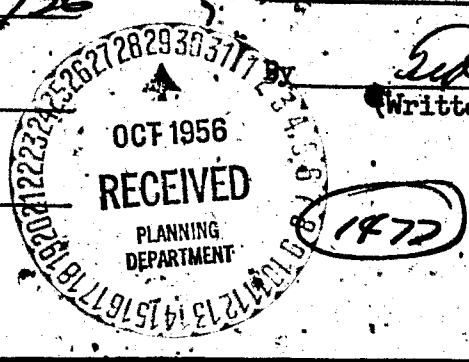

[Signature]
(Written authorization is necessary)

