

3717 EL PARQUE

H. Gatewood 3-23-79

CITY OF LAS VEGAS, NEVADA
DEPARTMENT OF BUILDING & SAFETY

PERMIT FEE \$4.00
APPLICATION & PERMIT FOR
PLUMBING

JOB ADDRESS: 3717 El Parque

OWNER'S NAME: First Western Savings & Loan Assn.

LOT BLOCK SUBDIVISION Bldg. type: SFD APT COMM

Circle: New bldg; Old bldg; Add'n; Remodel; Pool; Wtr. Sftner; Lawn Sprkr; Other

CONTRACTOR: Alfred E. Lee

State Lic. # 9433 City Lic. # 4966

QUANTITY	FIXTURE OR INSTALLATION	Unit Price	AMOUNT
	Bathtub	1.00	
	Clothes dryer (gas)	1.00	
	Clothes washer	1.00	
	Dental unit	1.00	
	Dishwasher	1.00	
	Drinking fountain	1.00	
	Fire sprinkling - underground piping	5.00	
	Fire sprinkling - distribution piping per each foot	.01	
	Fire sprinkling heads - per each head	.10	
	Floor drain \$1.00 Floor sink	1.00	
	Gas appliance, (any type)	1.00	
	Gas piping system - single family dwelling	8.00	
	Gas piping system - multiple family \$3 per each unit plus	1.00	
	Gas piping system - commercial bldg. per each floor	3.00	
	Grease trap	1.00	
	Irrigation system	4.00	4.00
	Lavatory	1.00	
	Minimum fee for any permit	4.00	
	Piping, Drainage	4.00	
	Sewer replacement	4.00	
	Septic disposal system - Health Dept. approval required	4.00	
	Shower	1.00	
	Sink - kitchen type	1.00	
	Swimming pool - private - wading pool	8.00	
	Swimming pool - public - semi-public	12.00	
	Toilet	1.00	
	Urinal	1.00	
	Water distribution system, single family dwelling	4.00	
	Water distribution system multiple dwg. \$4 + each unit	1.00	
	Water distribution system, Group "A" thru "G" per each floor	4.00	
	Water distribution system, Group "H" (hotel) \$4 + per bath*	.50	
	Water heater (gas) (electric)	1.00	
	Water using equipment	1.00	
	Water softener nonpermanent type	4.00	
	Water softener permanent (connected to drainage)	5.00	
	Wash tray	1.00	

I hereby certify that I have carefully examined & read the above application; that the same is true & correct; and the work herein described is to be done in accordance with the provisions of City of Las Vegas Ordinances & State Laws, whether herein specified or not. * As defined in City Code and Ordinances.

TOTAL FEE \$ 4.00

SIGNED: Alfred E. Lee Date: 5-7-68
Registered Plumber Spec. Cont'r, Owner

Engineering Dept. Date Building Department Date

Sewer Conn. Fees Paid in Engr. Dept. PERMIT NO 23767 PERMIT FEE \$4.00
23.10 #12870

RECEIPT

9135 \$004.00 - .7

CITY OF LAS VEGAS
DEPT. OF BUILDING & SAFETY

Must be machine validated

- 9 MAY 68

Thesee Kivaker 9-15-81

Department of Building & Safety
City of Las Vegas, Nevada

Special Kardex
Elec. only, Plbg. only, A.C. only

Owner 1st Western Address 3717 El Parque Date: 5/9/68
Contractor _____ Permit No. _____
Lot _____ Block _____ Subdivision _____

Electric Only	Plumbing Only	Heat & Vent. A. C. Only
Contractor _____	Contractor <u>Alfred E. Lee</u>	Contractor _____
Permit No. _____	Permit No. <u>23767</u>	Permit No. _____
Slab _____	Rough Soil _____	A.C. Rough Duct _____
Rough Elect _____	Rough Water _____	Ref. Ro. Piping _____
Final Rough _____	Top Out _____	Rough Gas _____
Final Fixture _____	Rough Gas _____	Final Refrig _____
Final Elec _____	Final Plbg. <u>WJ 5-9-68</u>	Final Air Cond _____
Temp. Service _____	Final Gas _____	Final Gas _____
	Final Sewer _____	
	Final Septic Tank _____	

-23.06 D Address Alfred E. 3717 El Parque Log No. Sprinkler Area _____

DEPARTMENT OF BUILDING & SAFETY
CITY OF LAS VEGAS, NEVADA

KARDEX CARD
FENCE & RETAINING
WALLS

OWNER Douglas Spencer & Assoc ADDRESS 3717 El Parque DATE 9-4-64
CONTRACTOR Arden Bldg Corp PERMIT NO. 27728
LOT 5 BLOCK 1 SUBDIVISION Las Verdes Hts #4 Wood fence ✓

Fence (wire, wood, etc.)	Walls (masonry, rock, etc.)
Location _____	Location _____
Final Inspection <u>7-21-65</u>	Footing _____
	Wall Steel 1st _____ 2d _____ 3d _____
	Final Inspection _____
Retaining Wall (masonry)	Retaining Wall (concrete)
Location _____	Location _____
Footing _____	Footing _____
Wall Steel 1st _____ 2d _____ 3d _____	Wall Steel 1st _____ 2d _____ 3d _____
Bond Beam 1st _____ 2d _____ 3d _____	Final Inspection _____
Final Inspection _____	

23.14 B ADDRESS 3717 El Parque AREA _____

These Kymaker 9-15-81

DEPT. of BLDG & SAFETY - CITY of LAS VEGAS, NEVADA

OWNER Princess Homes ADDRESS 3717 El Parque DATE 2-13-61
 GEN. CONT. Mirantj TYPE OF STRUCTURE Finish of 3
 PERMIT NO. 23708 LEGAL DESCRIPTION Lot 5 Blk 1 Las Verdes

BUILDING	MECHANICAL	ELECTRICAL
LOCATION _____	PLUMBING CONT. _____	TEMP. POLE CONT. _____
FIREPLACE FTS. _____	PERMIT NO. _____ DATE _____	PERMIT NO. _____ DATE _____
FOUNDINGS _____	HEAT & VENT. AC CONT. _____	INSPECTION _____ DATE _____
FOUNDATION WALL _____	PERMIT NO. _____ DATE _____	ELECTRICAL CONT. _____
FLOOR FRAMING _____	SEWER CONT. _____	PERMIT NO. _____ DATE _____
SLAB _____	PERMIT NO. _____ DATE _____	FIXTURES CONT. _____
CHIMNEY STEEL (FIREPLACE) _____	ROUGH SOIL _____	PERMIT NO. _____ DATE _____
WALL STEEL _____	ROUGH WATER _____	SLAB _____
COLUMN STEEL _____	TOP-OUT _____	ROUGH _____
BEAM STEEL _____	ROUGH GAS _____	FINAL ROUGH _____
FRAMING _____	AC ROUGH DUCT _____	FINAL FIXTURE _____
ROOF SHEATHING _____	REF. ROUGH PIPING _____	FINAL ELECTRICAL <u>Milled 3-5-61</u>
INTERIOR _____	FINAL PLUMBING <u>Whitehead 3-26-61</u>	TEMPORARY SERVICE _____
EXTERIOR _____	FINAL GAS _____	MISCELLANEOUS _____
DRYWALL _____	FINAL AIR COND. <u>Whitehead 3-4-61</u>	GRADING & DRAINAGE _____
LATHING _____	FINAL REFRIG. _____	ON-SITE PARKING SPACES _____ APP. _____
BACKING (SIDING) _____	FINAL SEWER _____	ENG. APPROVAL OF _____
PLASTER SCRATCH _____	FINAL SEPTIC TANK _____	OFF-SITE IMPROVEMENTS _____
PLASTER BROWN _____		
URBAN REDEVELOPMENT APPROVAL _____		
FINAL BLDG. <u>3-25-61</u> DATE _____		

APPROVED FOR OCCUPANCY & METER Stubb INSPECTOR 3-25-61 DATE _____

PLEASE NOTE REMARKS ON REVERSE SIDE

3717 El Parque

DEPT. of BLDG & SAFETY - CITY of LAS VEGAS, NEVADA

OWNER PRINCESS HOMES INC ADDRESS 3717 El Parque DATE 12-17-63
 GEN. CONT. JB Diverse co TYPE OF STRUCTURE SD
 PERMIT NO. 14886 LEGAL DESCRIPTION Lot 5, Blk 1, Las Verdes Hts 4

BUILDING	MECHANICAL	ELECTRICAL
LOCATION <u>3717 El Pk</u>	PLUMBING CONT. _____	TEMP. POLE CONT. _____
FIREPLACE FTS. _____	PERMIT NO. <u>4548</u> DATE <u>1-1-63</u>	PERMIT NO. _____ DATE _____
FOUNDINGS _____	HEAT & VENT. AC CONT. <u>2-2-63</u>	INSPECTION _____ DATE _____
FOUNDATION WALL _____	PERMIT NO. <u>4548</u> DATE <u>2-26-63</u>	ELECTRICAL CONT. _____
FLOOR FRAMING _____	SEWER CONT. _____	PERMIT NO. <u>4548</u> DATE <u>3-25-63</u>
SLAB _____	PERMIT NO. _____ DATE _____	FIXTURES CONT. _____
CHIMNEY STEEL (FIREPLACE) _____	ROUGH SOIL _____	PERMIT NO. <u>4548</u> DATE <u>3-25-63</u>
WALL STEEL _____	ROUGH WATER _____	SLAB _____
COLUMN STEEL _____	TOP-OUT _____	ROUGH _____
BEAM STEEL _____	ROUGH GAS _____	FINAL ROUGH _____
FRAMING _____	AC ROUGH DUCT _____	FINAL FIXTURE _____
ROOF SHEATHING _____	REF. ROUGH PIPING _____	FINAL ELECTRICAL _____
INTERIOR _____	FINAL PLUMBING _____	TEMPORARY SERVICE _____
EXTERIOR _____	FINAL GAS _____	MISCELLANEOUS _____
DRYWALL _____	FINAL AIR COND. _____	GRADING & DRAINAGE _____
LATHING _____	FINAL REFRIG. _____	ON-SITE PARKING SPACES _____ APP. _____
BACKING (SIDING) _____	FINAL SEWER <u>3-2-63</u>	ENG. APPROVAL OF _____
PLASTER SCRATCH _____	FINAL SEPTIC TANK _____	OFF-SITE IMPROVEMENTS _____
PLASTER BROWN _____		
URBAN REDEVELOPMENT APPROVAL _____		
FINAL BLDG. _____ DATE _____		

APPROVED FOR OCCUPANCY & METER _____ INSPECTOR _____ DATE _____

PLEASE NOTE REMARKS ON REVERSE SIDE

1-17-64 Canceled 3717 El Parque

T79 4

Anna H... 3-2-84

CITY OF LAS VEGAS, NEVADA

LOG NO. & AREA _____ DATE _____ CONST. VAL \$ 1,860

DEPARTMENT OF BUILDING AND SAFETY 070-461-012 DEVELOPMENT PERMIT AND BUILDING PERMIT
PHONE 386-6251

ADDRESS OF CONSTRUCTION 3717 El Parque FOR: Fence, Wall, Retaining Wall
OWNER Joan & Daniel Weed

CONTRACTOR Owner STATE LICENSE NO. _____ CITY LICENSE NO. _____

LOT(s) 5 BLOCK 1 SUBDIVISION LAS VERDE HTS #4 ZONE R-1

PROPOSED CONSTRUCTION: Block Wall
BUILDING PERMIT NO. 1545 ENGINEER _____

Approval for the work under this permit will be given only after refuse and debris have been removed from job site and public right of way.

Remarks:

TOTAL SQUARE FEET: 744 TOTAL LINEAL FEET: _____

OTHER INSPECTIONS AND FEES

1. Inspections outside of normal business hours = \$25.00 per hour (minimum charge three hours).
2. Re-inspection fee during normal business hours assessed under provisions of TABLE 3-A of the Uniform Building Code = \$15.00 each.
3. Inspections during normal business hours for which no fee is specifically indicated = \$15.00 per hour (minimum charge one half hour).
4. Additional plan review required by changes, additions or revisions at approved plans = \$25.00 per hour (minimum charge two hours).

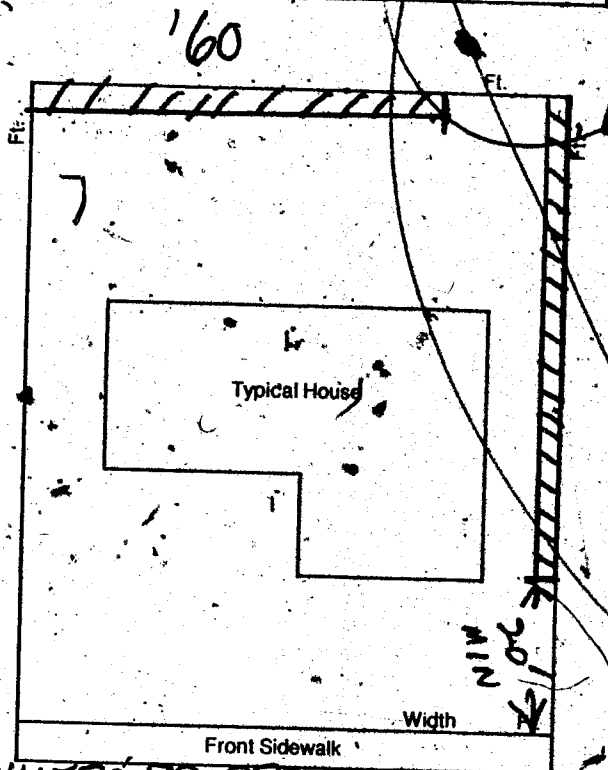

CONDITIONS OF THE PERMIT:

1. Any type of retaining wall must be engineered by a Civil or Structural Engineer.
2. If a home owner takes out the Building Permit and if the owner sublets the work to a Contractor, then the Contractor must take out the permit and pay for it.
3. No fence or wall can be built on City property or rights-of-way, but this is not intended to preclude construction within utility easements if utilities will not be damaged or made inaccessible.
4. The fence or wall shall not enclose any water meter, light standard, or fire alarm box and shall not come closer than 24" from the nearest fire hydrant outlet.
5. Department Inspectors must approve footings before concrete is poured and block wall reinforcing before grouting is done.
6. Maximum height of any wall or fence is 6', side and rear yards; 4' maximum in front yard with the vertical surface above the height of 2' - 50% open.
7. I must not obstruct required onsite parking space (2 spaces for each dwelling unit) by the erection of this fence or wall.
8. By the signing of this application I herewith agree to the requirements outlined above.

Wall shall conform to the standard block wall hand out by the City of Las Vegas or to plans on job.

NV530-78-8721 Republic Ins. Co. Policy *plans on job.*
Shown address

SIGNED Daniel Weed CONTRACTOR - AGENT / OWNER
Harry Von Busch 2/27/84
 PLANNING DEPT. DATE
OK 2/27/84
 BUILDING DEPT. DATE

1. JULI RECEIPT	
WALL	\$ 32.50
STL	\$ 32.50
TOTL	\$ 32.50
CHEK	\$ 32.50
A#1545 SR#001/01	
CITY - LAS VEGAS	
BLDG. & SAFETY	
02/28/84	

I hereby certify that I have reviewed this application and the proposed plans and have found that the proposed development meets the requirements of the City of Las Vegas Flood Hazard Reduction Ordinance for the issuance of this Development Permit.

Kent Nash 2-27-84
LAND DEVELOPMENT AND FLOOD CONTROL ENGINEER DATE

PLAN REVIEW FEE	
PERMIT FEE	32.50
TOTAL FEES	32.50

3/83 Permit Expires 180 Days After Abandonment of Work

MUST BE MACHINE VALIDATED

Done *Handy* 4-25-84

FENCE & RETAINING WALLS				
OWNER	JOAN & DANIEL WEED		DATE	2-27-84
ADDRESS	3717 E1 Parque			
CONTRACTOR	Owner	PERMIT NO.	1545	FINAL INSPECTION
PLOT	5	BLOCK	Y.	SUBDIVISION Las Verde Hts #4
LOG #		AREA		
FENCES (wire, wood, block, & retaining walls)				
1	Location	<i>pt. 5 wall 4-14-84</i>		
2	Footing			
3	Wall Steel & Grout	<i>CM4-13-84</i>		
	1st		2nd	
4	Bond Beam			
	1st		2nd	
5	Final	<i>pt. 5 wall only 4-18-84</i> <i>CM4-18-84</i>		
Specify Type Of Fence				
2-1-33 DIV. OF BLDG. & SAFETY CITY OF LAS VEGAS REV. 10-78				