

7180 Doe

VICKIE B

4-3-86

CITY OF LAS VEGAS, NEVADA

LOG NO. & AREA _____ DATE: 3/31/86 CONST. VAL. \$ 29,700.00

DEPARTMENT OF BUILDING AND SAFETY
PHONE 386-6251

DEVELOPMENT PERMIT AND BUILDING PERMIT FOR Fence, Wall, Retaining Wall

ADDRESS OF CONSTRUCTION 7180 DOE AVE

OWNER Edward Busch

CONTRACTOR Wagner

STATE LICENSE NO. _____

CITY LICENSE NO. _____

LOT(S) _____ BLOCK _____ SUBDIVISION SEC 3 T 315 R 60E ZONE: R-E

PROPOSED CONSTRUCTION: BLK WALL

BUILDING PERMIT NO. 5864 ENGINEER _____

Approval for the work under this permit will be given only after refuse and debris have been removed from job site and public right of way.

Remarks:

TOTAL SQUARE FEET: 11880 TOTAL LINEAL FEET: 1980

OTHER INSPECTIONS AND FEES

1. Inspections outside of normal business hours = \$25.00 per hour (minimum charge three hours).
2. Re-inspection fee during normal business hours assessed under provisions of TABLE 6-A of the Uniform Building Code = \$15.00 each.
3. Inspections during normal business hours for which no fee is specifically indicated = \$15.00 per hour (minimum charge one-half hour).
4. Additional plan review required by changes, additions or revisions at approved plans = \$25.00 per hour (minimum charge two hours).

CONDITIONS OF THE PERMIT:

1. Any type of retaining wall must be engineered by a Civil or Structural Engineer.
2. If a home owner takes out the Building Permit and if the owner sublets the work to a Contractor, then the Contractor must take out the permit and pay for it.
3. No fence or wall can be built on City property or rights-of-way, but this is not intended to preclude construction within utility easements if utilities will not be damaged or made inaccessible.
4. The fence or wall shall not enclose any water meter, light standard, or fire alarm box and shall not come closer than 24" from the nearest fire hydrant outlet.
5. Department inspectors must approve footings before concrete is poured and block wall reinforcing before grouting is done.
6. Maximum height of any wall or fence is 6' side and rear yards; 4' maximum in front yard with the vertical surface above the height of 2' - 50% open.
7. I must not obstruct required onsite parking space (2 spaces for each dwelling unit) by the erection of this fence or wall.
8. By the signing of this application I herewith agree to the requirements outlined above.

9. PER CITY DEPT. SHEET

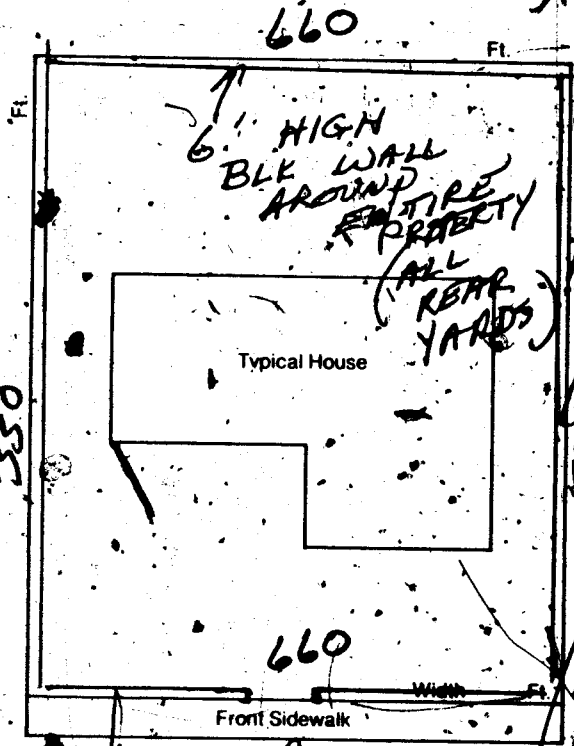

RECEIPT

0004
 WALL 193.50
 CHEK 193.50
 5864A000 12:15

03/31/86

SIGNED _____ CONTRACTOR - AGENT - OWNER

PLANNING DEPT. DATE 3/31/86

BUILDING DEPT. DATE 3/31/86

I hereby certify that I have reviewed this application and the proposed plans and have found that the proposed development meets the requirements of the City of Las Vegas Flood Hazard Reduction Ordinance for the issuance of this Development Permit. PROVIDE FOR DRAINAGE 2310-2401

LAND DEVELOPMENT AND FLOOD CONTROL ENGINEER JSA DATE 3-31-86

PLAN REVIEW FEE _____

PERMIT FEE _____

TOTAL FEES 193.50

MUST BE MACHINE VALIDATED

Permit Expires 180 Days After Abandonment of Work

TRAIL B 6-17-86

FENCE & RETAINING WALLS

OWNER Lloyd Benson DATE 4-2-86

ADDRESS 7180 Doe Ave.

CONTRACTOR owner PERMIT NO. 5864 LOG NO.

LEGAL

FENCES (wire, wood, block, & retaining walls)

Location & Footing		
1st R34-380	2nd	3rd
Block & Vert. Spacing		
1st R34-10-86	2nd R34-17-86	3rd R34-18-86
Grout		
1st	2nd	3rd
Bond Beam		
1st	2nd	
Final R3 5-8-86		

Specify Type of Fence

DEPT. OF BLDG. & SAFETY CITY OF LAS VEGAS REV. 11-84