

6416 EVERGREEN

LOT 26 BLK 17 CHARLESOTN HGTS #26 ZONE R-1

Blow Datewood 4-26-79

CITY OF LAS VEGAS, NEVADA
DEPARTMENT OF BUILDING AND SAFETY
APPLICATION AND PERMIT FOR FENCE,
WALL OR RETAINING WALL

LOG NO. _____
AREA: _____
KARDEX CARD: _____
TELEPHONE: _____

CONSTRUCTION VALUATION: 13,600
INSPECTION VALUATION: 1240
PERMIT FEE: 400
PERMIT NUMBER: 34164
DATE: 6/20/66 19

ADDRESS OF CONSTRUCTION: 6416 EVERGREEN
OWNER'S NAME: R.B. JEWELL
OWNER'S ADDRESS: SAME

Lot (s) 26 Block 17 Subdivision CHAS HATS #26 Zone R-1

Materials of Concrete Construction: Block (X) Concrete () Wire () Wood () Other ()

Total Square Feet: _____ Total Linear Feet: 82

CONTRACTOR'S NAME: MYSELF
STATE LICENSE #: _____ CITY LICENSE #: _____

Architect's Name: _____ PLANS SUBMITTED: Yes No
Engineer's Name: _____ CALCULATIONS: Yes No

Street Name: _____
Front Yard: _____ Feet

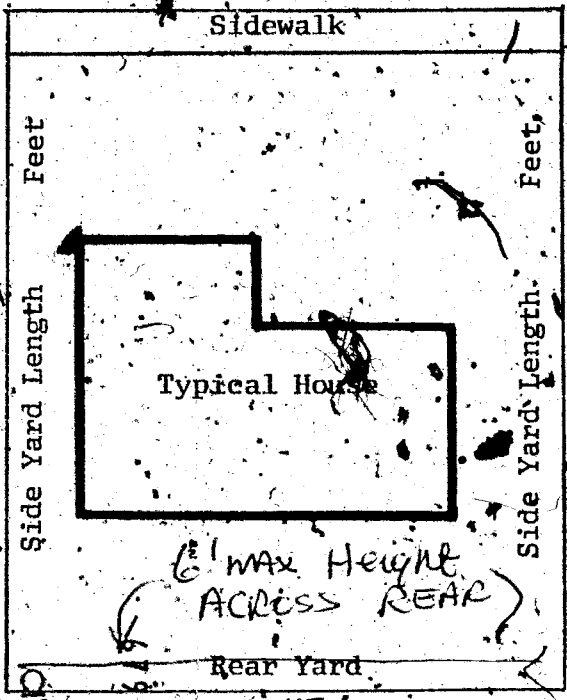

I understand that any portion of this (fence) (wall) constructed or erected on City property or right-of way will be removed from said location at my expense upon request received from the City of Las Vegas, Nevada. I understand that the (fence) (wall) shall not enclose water meter, light standard, fire alarm box and shall not come closer than two (2') feet in any direction from any fire hydrant. I further state that I am familiar with effective Ordinances of the City of Las Vegas, Nev. and effective Statutes of the State of Nevada covering construction and use of the above type. I agree to perform said construction in conformity therewith. I further agree that issuance of a permit on above application will not excuse me from conforming with said Ordinances and Statutes, despite any errors on the part of the Building Inspector or Engineer in checking plans and applications herewith submitted.

I have read and understand the contents of above application; I hereby state that same are true and correct.

SIGN HERE: R.B. Jewell
By: _____

APPROVED BY: _____ DATE: 6/20/66

PLANNING DEPT. & CODE ASSISTANCE DATE

FIRE DEPARTMENT DATE

ENGINEERING DEPARTMENT DATE

BUILDING & SAFETY DEPARTMENT DATE

#1285 P. 34164 P. 400

CITY OF LAS VEGAS
DEPT. OF
BUILDING & SAFETY

\$004.00

FENCE PERMIT ONLY

18496

Ilona Gatewood 4-26-79

1966

PERMIT FEE: \$400

CITY OF LAS VEGAS, NEVADA
DEPARTMENT OF BUILDING & SAFETY
APPLICATION & BUILDING PERMIT
FOR FENCE, WALL, RETAINING WALL

CONSTRUCTION VALUATION: \$ 24900
INSPECTION VALUATION: \$ 12800

LOG NO. & AREA

ADDRESS OF CONSTRUCTION: 416 EVERGREEN

OWNER'S NAME: R.B. JEWELL

OWNER'S ADDRESS: SAME

Lot (s) 26 Block 12 Subdivision Charleston Heights #12 Zone R-1

Materials of Construction: Concrete Block (X) Concrete () Wire () Wood () Other ()

Total Square Feet: Total Lineal Feet: 99

CONTRACTOR'S NAME: OWNER STATE: CITY: LICENSE #: LICENSE #:

Architect's Name: PLANS SUBMITTED: Yes No
Engineer's Name: CALCULATIONS: Yes No

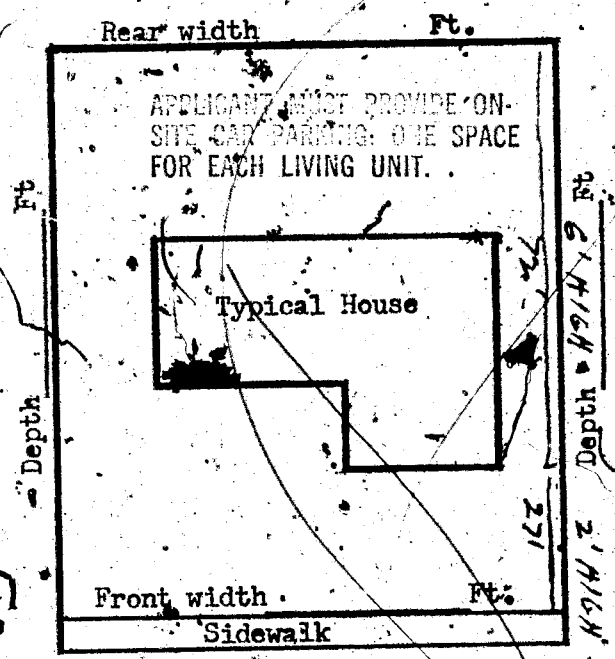

I understand that any portion of this (fence) (wall) constructed or erected on City property or right-of-way will be removed from said location at my expense upon request received from the City of Las Vegas, Nevada. I understand that the (fence), (wall) shall not enclose water meter, light standard, fire alarm box & shall not come closer than two (2') feet in any direction from any fire hydrant. I further state that I am familiar with effective Ordinances of the City of Las Vegas, Nevada & effective Statutes of the State of Nevada covering construction and use of the above type; I agree to perform said construction in conformity therewith. I further agree that issuance of a permit on above application will not excuse me from conforming with said Ordinances and Statutes, despite any errors on the part of the Building Inspector or Engineer in checking plans and applications herewith submitted. I have read and understand the contents of above application & permit; I hereby state that same are true and correct.

SIGN HERE: R.B. Jewell Date: 9/13/66

A-P-P-R-O-V-E-D BY: _____ DATE: 9/13/66
 PLANNING DEPT. & CODE ASSISTANCE
 FIRE DEPARTMENT DATE
 ENGINEERING DEPARTMENT DATE
 BUILDING & SAFETY DEPARTMENT DATE: 9-13-66

RECEIPT
 1926 \$004.00 - 8
 CITY OF LAS VEGAS
 DEPT. OF BUILDING & SAFETY
 Must be machine validated.
 14 SEP 66

#1285 PERMIT NO. 34988 PERMIT FEE \$400
23.14

L. Collins 11-8-81

DEPARTMENT OF BUILDING & SAFETY
CITY OF LAS VEGAS, NEVADA

KARDEX CARD
FENCE & RETAINING
WALLS

OWNER R. B. Jewell ADDRESS 6416 Evergreen DATE June 20, '66

CONTRACTOR Owner PERMIT NO. 34164

LOT 26 BLOCK 17 SUBDIVISION Chas. Hets. #26
Concrete block fence

Fence (wire, wood, etc.)	Walls (masonry, rock, etc.)
Location _____	Location <u>Subdiv 6-17-66 9-14-66</u>
Final Inspection _____	Footing <u>Subdiv 6-17-66 9-14-66</u>
	Wall Steel 1st <u>Subdiv 6-17-66 9-20-66</u>
	Final Inspection <u>Subdiv 9-22-66</u>

Retaining Wall (masonry)	Retaining Wall (concrete)
Location _____	Location _____
Footing _____	Footing _____
Wall Steel 1st _____ 2d _____ 3d _____	Wall Steel 1st _____ 2d _____ 3d _____
Bond Beam 1st _____ 2d _____ 3d _____	Final Inspection _____
Final Inspection _____	

23.14 B ADDRESS 6416 Evergreen LOG NO. _____ AREA _____

DEPARTMENT OF BUILDING & SAFETY
CITY OF LAS VEGAS, NEVADA

KARDEX CARD
FENCE & RETAINING
WALLS

OWNER R. B. Jewell ADDRESS 6416 Evergreen DATE 9/32/66

CONTRACTOR Owner PERMIT NO. 34988

LOT 26 BLOCK 17 SUBDIVISION Charleston Hets. #17
Block Fence

Fence (wire, wood, etc.)	Walls (masonry, rock, etc.)
Location _____	Location _____
Final Inspection _____	Footing _____
	Wall Steel 1st _____ 2d _____ 3d _____
	Final Inspection <u>Subdiv 9-22-66</u>

Retaining Wall (masonry)	Retaining Wall (concrete)
Location _____	Location _____
Footing _____	Footing _____
Wall Steel 1st _____ 2d _____ 3d _____	Wall Steel 1st _____ 2d _____ 3d _____
Bond Beam 1st _____ 2d _____ 3d _____	Final Inspection _____
Final Inspection _____	

23.14 B ADDRESS 6416 Evergreen LOG NO. _____ AREA _____

L. Collins 11-8-81

DEPARTMENT OF BUILDING & SAFETY
CITY OF LAS VEGAS, NEVADA

KARDEX CARD
FENCE & RETAINING
WALLS

OWNER R. B. Jewell ADDRESS 6416 Evergreen DATE June 20, '66

CONTRACTOR Owner PERMIT NO. 34164

LOT 26 BLOCK 17 SUBDIVISION Chas. Hts. #26

Fence (wire, wood, etc.) Concrete block fence
Location _____
Final Inspection _____

Retaining Wall (masonry) Walls (masonry, rock, etc.)
Location _____
Footings _____
Wall Steel 1st _____ 2d _____ 3d _____
Bond Beam 1st _____ 2d _____ 3d _____
Final Inspection _____

23.14 B ADDRESS 6416 Evergreen LOG NO. _____ AREA _____

DEPARTMENT OF BUILDING & SAFETY
CITY OF LAS VEGAS, NEVADA

KARDEX CARD
FENCE & RETAINING
WALLS

OWNER R. B. Jewell ADDRESS 6416 Evergreen DATE 9/32/66

CONTRACTOR Owner PERMIT NO. 34988

LOT 26 BLOCK 17 SUBDIVISION Charleston Hts. #17

Fence (wire, wood, etc.) Block Fence
Location _____
Final Inspection _____

Retaining Wall (masonry) Walls (masonry, rock, etc.)
Location _____
Footings _____
Wall Steel 1st _____ 2d _____ 3d _____
Bond Beam 1st _____ 2d _____ 3d _____
Final Inspection _____

23.14 B ADDRESS 6416 Evergreen LOG NO. _____ AREA _____

La Colina 11-8-87

DEPT. of BLDG & SAFETY - CITY of LAS VEGAS, NEVADA
OWNER: SPROUT HOMES INC. ADDRESS: 6416 Evergreen Ave. DATE: 2-27-62
GEN. CONT. same TYPE OF STRUCTURE: S.F. Dwl.
PERMIT NO. 8131 LEGAL DESCRIPTION: Lot 26 Block 17 Chas. Hts. #26

BUILDING		MECHANICAL		ELECTRICAL	
LOCATION	<u>OB 5-14-62</u>	PLUMBING CONT.	<u>Miller 2-22-62</u>	TEMP. POZE CONT.	
FIREPLACE FTG.		PERMIT NO.	<u>4924</u>	PERMIT NO.	
FOOTINGS	<u>OB 3-14-62</u>	HEAT & VENT. AC CONT.	<u>Nommond 7-15-62</u>	INSPECTION	
FOUNDATION WALL		PERMIT NO.	<u>2589</u>	ELECTRICAL CONT.	<u>Roberts 3-22-62</u>
STEM WALL	<u>OB 3-14-62</u>	SEWER CONT.	<u>Miller 3-22-62</u>	PERMIT NO.	<u>5530</u>
FLOOR FRAMING		PERMIT NO.	<u>4924</u>	DATE	<u>3-22-62</u>
SLAB	<u>OB 3-23-62</u>	ROUGH SOIL	<u>Miller 3-23-62</u>	FIXTURES CONT.	<u>Roberts 3-22-62</u>
CHIMNEY STEEL (FIREPLACE)		ROUGH WATER	<u>Miller 3-23-62</u>	PERMIT NO.	<u>5530</u>
WALL STEEL		TOP-OUT	<u>Miller 4-11-62</u>	DATE	<u>3-22-62</u>
COLUMN STEEL		ROUGH GAS	<u>Miller 4-11-62</u>	SLAB	<u>Miller 9-62</u>
BEAM STEEL		AC ROUGH DUCT	<u>Miller 4-11-62</u>	ROUGH	
STEEL FABRICATION		REF. ROUGH PIPING	<u>Miller 3-14-62</u>	FINAL ROUGH	
FRAMING	<u>OB 4-9-62</u>	FINAL PLUMBING	<u>Miller 3-14-62</u>	FINAL FIXTURE	
ROOF SHEATHING	<u>OB 4-9-62</u>	FINAL GAS	<u>Miller 5-21-62</u>	TEMPORARY SERVICE	
DRYWALL	<u>OB 4-22-62</u>	FINAL AIR COND.	<u>Miller 5-21-62</u>		
LATHING	<u>OB 4-22-62</u>	FINAL REFRIG.	<u>Miller 4-18-62</u>		
BACKING (SIDING)		FINAL SEWER			
PLASTER	<u>Scratch</u>	FINAL SEPTIC TANK			
FINAL BLDG %	<u>JA</u>				
	DATE <u>5-16-62</u>				

MISCELLANEOUS

URBAN REDEVELOPMENT APPROVAL

GRADING & DRAINAGE _____

ON-SITE PARKING SPACES _____ APP. _____

ENG. APPROVAL OF _____

OFF-SITE IMPROVEMENTS _____

APPROVED FOR OCCUPANCY: Anderson 5-16-62 INSPECTOR

APPROVED FOR METER: Miller 5-16-62

PLEASE NOTE REMARKS ON REVERSE SIDE

LOG # _____ AREA # _____ 23.04

6416 Evergreen Ave. T-7 4