

49 S. HAMPTON

SEE APPLICATION

D. Gatewood May 28, 1980

CITY OF LAS VEGAS, NEVADA.

LOG NO. & AREA T-24 CONST. VAL \$ 29,500

DEPARTMENT OF PUBLIC SERVICES
DIVISION OF BUILDING AND SAFETY

APPLICATION & BUILDING PERMIT - for:
Dwellings, Duplexes, Misc Residential Const.

White

ADDRESS OF CONSTRUCTION: 49 South Hampton Lane

OWNER: Bonar/DeMichaelis
A General Partnership

LOT(s) 1 BLOCK 2 SUBDIVISION Charleston Village Green ZONE: RDR-8

Existing structure on lot: Dwelling Accessory Bldgs Vacant Lot Other

PROPOSED CONSTRUCTION: Condominium USE: _____

MATERIALS OF CONSTRUCTION: Wood Frame Concrete Block Reinforced Concrete Steel Frame

SQUARE FEET OF FLOOR AREAS: 1st 1182 2nd 0 3rd 0 Other 434 TOTAL SQ. FT. 1739

FIRE ZONE: 3 Occupancy Group R-3 CONST. TYPE: VN

ARCHITECT: RLP Const. Co. Inc. ENGINEER: Bob McNutt NO. of UNITS 1 NO. of STORIES 1

Plans Submitted: Yes No Calculations Submitted: Yes No Sewer Fee Req'd: Yes No

CONTRACTOR: RLP Const. Co. Inc. STATE LICENSE # 14603 CITY LICENSE # C11814204088

ADD'L. PERMITS REQ'D.: Cond. Elec Plumbing Signs Paving Fence Public Walks Curb-gutters
Incinerators Fire Sprinkling System

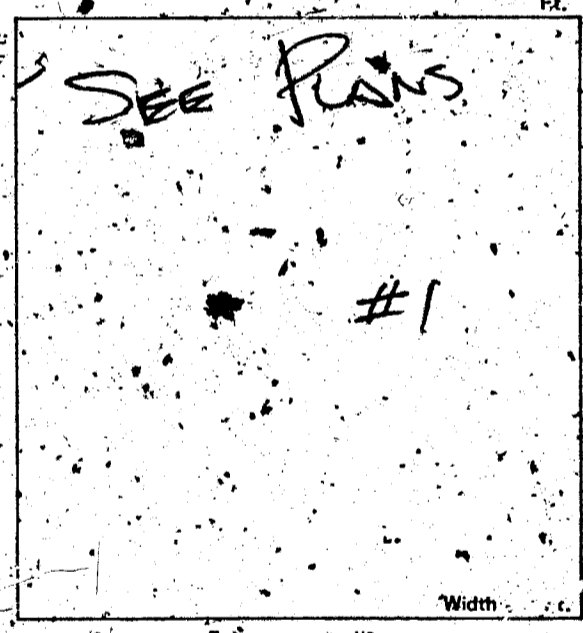

CONDITIONS OF THE PERMIT:

1. I agree to call the City Building Department for inspections before concrete is poured, before rough wiring, electrical, plumbing, framing is covered. Also for Air conditioning, drywall and sheathing inspection.
2. I agree that when the job is completed that I will call for final inspection before occupancy.
3. I agree to perform all construction in accordance with City Ordinances and Building Codes.
4. The Contractor's signature below denotes authority from the owner to sign in his behalf and that the owner is aware of all requirements of this application and permit. Separate permits must be taken out for work outlined above this agreement.
5. I have read and understand the contents of this application and permit; I hereby state that the information I have supplied on this application is true and correct.

Approval for the work under this permit will be given only after refuse and debris have been removed from job site and public right of way.

SIGNED: RLP Construction Co., Inc. Contractor
BY: B. N. Edwards Agent or Owner

PLANNING DEPT.: [Signature] Date: 7/18/78

PUBLIC WORKS DEPT.: A. Wheeler Date: 7-21-78

BUILDING DIVISION: B. Bailey Date: 7-24-78

PERMIT NO. 8315-9 PERMIT FEE'S 130.50

154-01-220

RECEIPT

MUST BE MACHINE VALIDATED

M. Waterwood May 28, 1980

CITY OF LAS VEGAS, NEVADA

DEPARTMENT OF PUBLIC SERVICES—APPLICATION AND PERMIT FOR PLUMBING DIVISION OF BUILDING AND SAFETY

ADDRESS OF CONSTRUCTION: 49 So. Hampton Ln. OWNER'S NAME: Bouge-De Michaelis
 CIRCLE: New Bldg Addn., Remodel; TYPE OF BLDG.: SFD, APT, PUBLIC COMM.
 CONTRACTOR'S NAME: TASSONE mech STATE LICENSE # 1247213 CITY LICENSE # 14636680

UNITS	DESCRIPTION	FEE	TOTAL
1	Bathtub	1.00	
1	Shower	1.00	
2	Lavatory	1.00	
2	Toilet	1.00	
	Urinal	1.00	
	Floor Drain	1.00	
	Floor Sink	1.00	
	Wash Tray	1.00	
	Sink	1.00	
	Garbage Disposal	1.00	
	Garbage Disposal (comm.)	3.00	
	Clothes Dryer (gas)	1.00	
	Clothes Washer	1.00	
	Clothes Washer (comm.)	5.00	
	Dishwasher	1.00	
	Dishwasher (commercial)	5.00	
	Dental Unit	10.00	
	Drinking Fountain	1.00	
	Any Water using Equipment	1.00	
	Water Heater (gas) (elect.)	1.00	
	Sewer System—New, Replacement, or any Drainage System	4.00	
	Grease or Sand Trap	2.00	
	Trailer Trap	2.00	
	Septic Disposal System	4.00	
WATER SOFTENERS			
	Nonpermanent Type	4.00	
	Permanent Type (connected to Drainage)	5.00	
SWIMMING POOLS			
	Private or Wading Pool	10.00	
	Public or Semi-public	20.00	

UNITS	DESCRIPTION	FEE	TOTAL
WATER DISTRIBUTION SYSTEM			
1	Single Family Dwelling	4.00	
	Multiple Family Dwelling plus each unit	4.00, 2.00	
	Commercial Bldg. per floor	6.00	
	Hotel or Motel plus each bath	4.00, 1.50	
	Trailer Park plus each space	20.00, 1.00	
	Irrigation	4.00	
GAS PIPING SYSTEM			
1	Single Family Dwelling	3.00	
	Multiple Family Dwelling plus each unit	6.00, 1.00	
	Commercial Bldg. per floor plus each unit	3.00, 3.00	
	Gas Appliance (any type)	1.00	
AUTOMATIC FIRE EXTINGUISHING SYSTEM			
	Underground Piping	10.00	
	Distribution Piping ea. ft.	.01	
	Sprinkler Head each	.10	
	In Range Hood and Vent	5.00	
DRY STANDPIPE SYSTEM			
	Piping	50.00	
	Each Outlet	1.00	
WET STANDPIPE SYSTEM			
	Piping	5.00	
	Fire Hose Cabinet	1.00	
MINIMUM PERMIT FEE 4.00			
PIPELINE CONTRACTOR; SECT. 14-B.P.F. \$			
TOTAL PERMIT FEE <u>\$22.00</u>			

I hereby certify that I have carefully examined and read the above application, that the same is true and correct, and that the work herein described is to be done in accordance with all the provisions of the applicable Ordinances of the City of Las Vegas, Nevada and the State laws, where herein specified or not.

Approval for the work under this permit will be given only after refuse and debris have been removed from job site and public right of way.

Signed: [Signature] Date: 8-2-78
 Registered Master Plumber, Spec. Contr. or Owner
 Building Division: CM, S. Date: 8-4-78
 Permit No. 8528-1 Permit Fee \$ 22.00

154-01-222

RECEIPT

MUST BE MACHINE VALIDATED

21 Gatewood May 28, 1980

CITY OF LAS VEGAS, NEVADA

DEPARTMENT OF PUBLIC SERVICES—ELECTRICAL APPLICATION & PERMIT
DIVISION OF BUILDING AND SAFETY

ADDRESS OF CONSTRUCTION: 49 S. Hampton Lane OWNER'S NAME: RIP Construction Co.
CIRCLE: New Bldg. Add'n., Remodel, TYPE OF BLDG.: SFD, APT., PUBLIC COMM.
CONTRACTOR'S NAME: Sagebrush Electric STATE LICENSE #: 14989 CITY LICENSE #: 011-09893

NUMBER	FIXTURE OR INSTALLATION	UNIT PRICE	TOTAL
	Rm addition, carport or garage enclosure	4.00	
	Temporary power	4.00	
60	Light, receptacle or switch outlet	.20	12.00
	Wall or ceiling space heater	.35	
1	Garbage grinder outlet	.35	.35
1	Dishwasher outlet	.35	.35
1	Clothes dryer outlet	.35	.35
	Automatic clothes washer	.35	
1	Electric range outlet	.35	.35
	Electric water heater outlet	.35	
	Special purpose outlet	.35	
	X-ray unit and its appurtenances	5.00	
	Watts of festoon lighting (Watts) First 3,000 watts for each additional thousand watts	4.00 1.50	
	Horsepower each motor first horsepower or less for each additional horsepower	1.75 .35	
1	Electric service (including any single meter socket) for each additional socket	3.00 .35	3.00
1	Air conditioning service	1.50	1.50
	Each KW(KVA) Generator (Transformer, Welder) First 100 KVA for each additional KW(KVA)	2.00 .01	
1	Speaker, signal or alarm outlet	.15	.15
	Amplifiers	.50	
	Control panels	.25	
	Main control racks	1.00	
	T.V. and radio antennas-master system only	.75	
	Minimum fee for any permit	4.00	
	TOTAL FEE		18.05

Approval for the work under this permit will be given only after refuse and debris have been removed from job site and public right of way.

I hereby certify that I have carefully examined and read the above application; that the same is true and correct and that the work herein described is to be done in accordance with all the provisions of the applicable Ordinances of the City of Las Vegas, Nevada and State laws whether herein specified or not.

SIGNED: [Signature] DATE: 8/16/78
MASTER (ELECTRICIAN) (TECHNICIAN) (OWNER)
BUILDING DIVISION: DMIS DATE: 8-21-78
PERMIT NO.: 8891-9 PERMIT FEE: \$ 18.05

RECEIPT
MUST BE MACHINE VALIDATED

M. Gatewood May 28, 1980

CITY OF LAS VEGAS, NEVADA

DEPARTMENT OF PUBLIC SERVICES - AIR CONDITIONING APPLICATION & PERMIT
 DIVISION OF BUILDING AND SAFETY

ADDRESS OF CONSTRUCTION: 49 South Hampton

OWNER'S NAME: RLP Construction

CIRCLE: Addition; Remodel; New Bldg TYPE OF BLDG.: SFD APT. COMM. PUBLIC

CONTRACTOR'S NAME: Tropic Air Cond., Inc.

STATE LICENSE # 10426D

CITY LICENSE # 03382

UNITS	DESCRIPTION	FEE	TOTAL	UNITS	DESCRIPTION	FEE	TOTAL
	Unit heater - floor, wall or suspended	4.00			EVAPORATIVE COOLERS:		
	FOR EACH FORCED-AIR OR GRAVITY-TYPE FURNACE OR BURNER INCLUDING DUCTS AND VENT ATTACHED TO SUCH APPLIANCES:				5 outlets or under	3.00	
	Up to and including 100,000 B.t.u.'s	4.00			Over 5 and up to and including 10	5.00	
	Over 100,000 B.t.u.'s	6.00			Each additional outlet over 10	.25	
	FOR EACH HEATING APPLICATION, REFRIGERATION UNIT, COMFORT COOLING AND HEATING UNIT, ABSORPTION UNIT, COMPRESSOR OR BOILER:				VENTILATION:		
	Up to and including 3 ton or horsepower, or absorption system up to and including 100,000 B.t.u.'s	4.00			For each fan connected to a single duct	1.00	
<u>1-4</u>	Over 3 ton or 3 horsepower up to and including 10; or absorption system over 100,000 B.t.u.'s up to and including 250,000 B.t.u.'s	7.00	<u>7.00</u>		For each commercial or industrial ventilation system	5.00	
	Over 10 ton or 10 horsepower up to and including 30; or absorption system over 250,000 B.t.u.'s up to and including 1,000,000 B.t.u.'s	12.00			For each commercial kitchen hood	5.00	
	Over 30 ton or 30 horsepower up to and including 50; or absorption system over 1,000,000 B.t.u.'s up to and including 1,700,000 B.t.u.'s	20.00			MISCELLANEOUS:		
	Over 50 ton or 50 horsepower, or absorption system over 1,700,000 B.t.u.'s	30.00			For each water cooling tower	8.00	
	FOR EACH AIR HANDLING UNIT INCLUDING DUCTS ATTACHED THERETO:				Duct work only - each opening	.25	
	Up to and including 10,000 CFM	2.00			For installation or relocation of each commercial or industrial incinerator*	15.00	
	Over 10,000 CFM	3.00			Gas piping related to the air cond work in single family dwelling only	3.00	
					For each appliance, piece of equipment, any mechanical work or alteration or replacement not included in this schedule, the permit fee shall be computed the same as building permit fees by using the cost of installation for the valuation amount.		
					FOR THE ISSUANCE OF EACH PERMIT		3.00
					TOTAL PERMIT FEE \$ 10.00		

I hereby certify that I have carefully examined and read the above application; that the same is true and correct; and that the work herein described is to be done in accordance with all the provisions of the applicable Ordinances of the City of Las Vegas, Nevada and the State Laws, whether herein specified or not.

Approval for the work under this permit will be given only after refuse and debris have been removed from job site and public right of way.

SIGNED [Signature] Date 8-29-78
 Air Conditioning Contractor - Owner

BUILDING DIVISION B.D. Date 8-30-78

PERMIT NO. 9112-6 PERMIT FEE \$ 10.00

#12890

RECEIPT

MUST BE MACHINE VALIDATED

M. Gatewood May 28, 1988

T24-2

CITY OF LAS VEGAS, NEVADA

LOG NO. & AREA

CONST. VAL. \$ 7750

21-19 DEPARTMENT OF PUBLIC SERVICES
DIVISION OF BUILDING & SAFETY

APPLICATION & BUILDING PERMIT - for:
Fence, Wall, Retaining Wall.

ADDRESS OF CONSTRUCTION: 45 49 So Hampton Ln.

OWNER: RSP Construction

LOT(s) 1#2 BLOCK 1#2 SUBDIVISION Charleston Village Zone: P28

Materials of Construction: Block Concrete Wire Wood Other Yes No

PLANS:

ARCHITECT: ENGINEER: CALCS:

CONTRACTOR: RSP Const. STATE LICENSE # 14603 CITY LICENSE # 04088

TOTAL SQUARE FEET: 1500 TOTAL LINEAL FEET: 250

Remarks:
4 ft

CONDITIONS OF THE PERMIT:

1. Any type of retaining wall must be engineered by a Civil or Structural Engineer.
2. If a home owner takes out the Building Permit and if the owner sublets the work to a Contractor, then the Contractor must take out the permit and pay for it.
3. No fence or wall can be built on City property or rights-of-way, but this is not intended to preclude construction within utility easements if utilities will not be damaged or made inaccessible.
4. The fence or wall shall not enclose any water meter, light standard, or fire alarm box and shall not come closer than 24" from the nearest fire hydrant outlet.
5. Department Inspectors must approve footings before concrete is poured and block wall reinforcing before grouting is done.
6. Maximum height of any wall or fence is 6', side and rear yards: 4' maximum in front yard with the vertical surface above the height of 2' - 50% open.
7. I must not obstruct required onsite parking space (2 spaces for each dwelling unit) by the erection of this fence or wall.
8. By the signing of this application I herewith agree to the requirements outlined above.

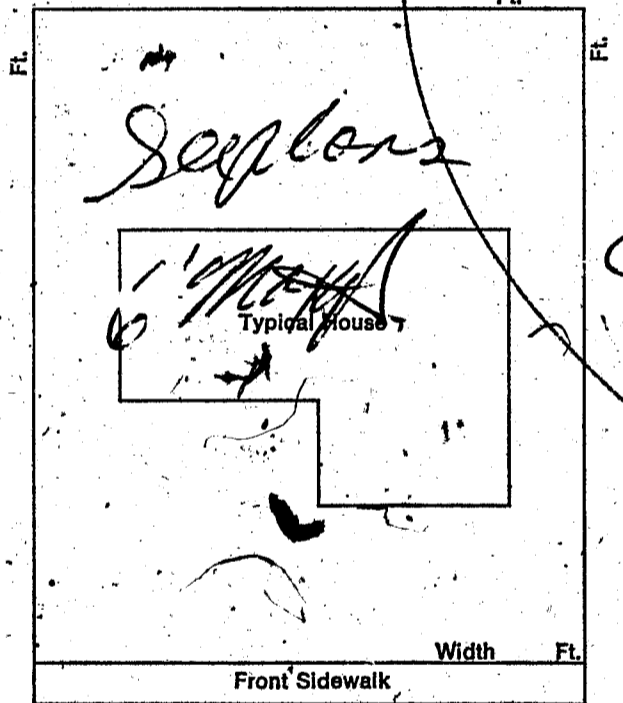

SIGNED: [Signature] DATE: 10-31-78

CONTRACTOR AGENT OWNER

PLANNING DEPT: [Signature] Date: 10-13-78

PUBLIC WORKS DEPT: [Signature] Date: 10-13-78

BUILDING DIVISION: [Signature] Date: 10/13/78

#12850 PERMIT NO: B807-3 PERMIT FEE \$ 1800

RECEIPT

MUST BE MACHINE VALIDATED

Donna Hooley 7-19-83

DIVISION of BUILDING & SAFETY - CITY of LAS VEGAS, NEVADA

OWNER Bonar DeMichaelis ADDRESS 49 South Hampton Lane DATE 7-27-78
 GEN. CONT. RIP Const TYPE OF STRUCTURE Condominium
 PERMIT NO. 8315-9 LEGAL DESCRIPTION L 1 B 2 Charleston Village Green

BUILDING	MECHANICAL	ELECTRICAL
Investigation	Plumbing Cont. <u>James</u>	Temp. pole cont.
Foundation & Footing <u>M 2 7-27-78</u>	Permit No. <u>8528-1</u> Date <u>8-4-78</u>	Permit No. _____ Date _____
Stem Wall	Heat & Vent. A/C Cont. <u>napic</u>	Inspection _____ Date _____
Concrete Slab Floor <u>1 c p 11-78</u>	Permit No. <u>9113-8</u> Date _____	Electrical Cont. <u>Joseph</u>
Floor Framing	Sewer Cont. <u>RIP Const</u>	Permit No. <u>8528-9</u> Date <u>8-21-78</u>
Fireplace Footing	Permit No. <u>8314</u> Date _____	Fixtures Cont. _____
Chimney Steel	Rough Soil <u>KW 8-27-78</u>	Permit No. _____ Date _____
Vert. Steel Reinf.	Rough Water <u>KW 8-27-78</u>	Slab _____
Horiz. Steel Reinf.	Top-Out <u>8-20-78</u>	Rough <u>Rp 9-18-78</u>
Roof Sheathing <u>VH 9-11-78</u>	Rough Gas <u>KW 9-22-78</u>	Final Rough _____
Framing <u>VH 10-4-78</u>	A/C Rough Duct <u>KW 9-22-78</u>	Final Fixture _____
Backing for siding	Ref. Rough Piping	Final Electrical <u>Rp 8-16-79</u>
Ext. Lath <u>VH 10-31-78</u>	Final Plumbing <u>KW 1-28-79</u>	Temporary Service _____
Ext. Scratch	Final Gas <u>KW 2-22-79</u>	
Ext. Brown	Final Air Cond. <u>KW 1-28-79</u>	
Int. Lath	Final Refrig. _____	
Int. Brown	Final Sewer <u>8-11-78</u>	
Drywall <u>VH 10-12-78</u>	Final Septic Tank _____	
Insulation <u>RIP Const</u>		
Final Building <u>VH 8-16-79</u>		
Appr. for Occu. _____		

MISCELLANEOUS

Grading & Drainage _____
 On-Site Parking Spaces _____ App _____
 Eng. Approval of _____
 Off-Site Improvements _____

INSPECTOR: _____ DATE _____

APPROVED FOR OCCUPANCY & METER _____

PLEASE NOTE REMARKS ON REVERSE SIDE

LOG # _____ AREA # _____ 76-114

49 South Hampton Lane

T 24-2