

A. #4505 Halbert

B. #4509 Halbert

C. #4513 Halbert

D. #4517 Halbert

E. #4521 Halbert

*Perimeter wall/see
4501 Halbert

Debra Ingram 12-6-88

CITY OF LAS VEGAS, NEVADA

LOG NO. & AREA _____ DATE _____ CONST. VAL. \$ _____

DEPARTMENT OF BUILDING AND SAFETY
PHONE 386-6251 FOR INSPECTIONS, CALL 799-2071,
ADDRESS OF CONSTRUCTION 4509 HAWK BIRD

ELECTRICAL PERMIT

OWNER KAY-Mac CONSTRUCTION
CONTRACTOR COMPLETE ELECTRIC STATE LICENSE NO. 86071 CITY LICENSE NO. 25554

(PRINT NAME OF MASTER ELECTRICIAN) John P. Brennan MASTER CARD NO. _____ PHONE _____

PROPOSED CONSTRUCTION: _____ USE: _____

ELECTRIC PERMIT NO. 8450

Approval for the work under this permit will be given only after refuse and debris have been removed from job site and public right of way.

UNITS	DESCRIPTION	FEE	TOTAL
PERMIT ISSUANCE			
	For Issuing Each Permit	10.00	<i>10.00</i>
	Supplemental Fee	4.50	
APPLIANCE CHARGE			
Residential or General Commercial			
	Receptacle _____ Switch _____	.40	
	Each Light Fixture, Socket, or Exit Light, Smoke Detector or Exhaust Fan	.30	
	EACH OUTLET FOR SPECIAL PURPOSE: Dishwasher, Garbage Grinder, Trash Compactor, G.P.I., Clothes Washer, Dryer, Electric Range, Ovens, Water Heater, Space Heater, Blast Coil Heater, (PER K.W.), Mercury Lamp, Quartz Lamp, Sodium Lamp, 20AMP Sign Circuit	.75	
	X-Ray Unit	10.00	
	Area Lighting (First 3,000 Watts)	8.00	
	Each Additional 1,000 Watts	3.00	
MOTORS (1 H.P. AND OVER) TRANSFORMERS, ELEVATORS, WELDERS, GENERATORS, CHILLERS, SIGNS AND A/C UNITS (OVER 5 TONS)			
	First H.P. or Ton For each Unit	3.00	
	First KVA For Each Unit	3.00	
	Each Additional H.P., Ton or KVA up to 50	.50	
	Each Additional H.P., Ton or KVA over 50	.35	
	Temporary power or Pole	6.00	<i>6.00</i>
ELECTRIC SERVICE OR MAIN DISCONNECT			
	Up to 200 AMP	6.00	
	400 AMP And 600 AMP	12.50	
	Over 600 AMP To 1200 AMP	25.00	
	Over 1200 AMP	50.00	
	Each Additional Meter Socket	.50	
	Sub Panel, Motor Control Center Disconnect Switch; Transfer Switch (Each)	3.00	
	Swimming Pool (Residential)	20.00	
	Swimming Pool (Semi-Public)	80.00	
	Spas	8.00	
	Recreational Vehicle Spaces (Each)	3.00	

UNITS	DESCRIPTION	FEE	TOTAL
	Busways-Trolley or Plug-in (Ea. 100 Ft.)	3.00	
	Gas Pumps, Dispensers (Each)	3.00	
	Permanent A/C Unit (5 Tons or Less)	3.00	
	Each Air Handler	1.00	
RESIDENTIAL LOW VOLTAGE INSTALLATIONS			
	Speaker Outlets (Each)	.30	
	Signal or Alarm Outlets (Each)	.30	
	Amplifiers	2.00	
	Control Panel	.50	
	TV Master System	.30	
	Telephone or Computer Outlet	.30	
OTHER INSPECTIONS AND FEES: INCLUDES ISSUANCE FEES WHEN APPLICABLE			
	Inspections outside of normal business hours (minimum charge - three hours)	30.00 per hour	
	Reinspection fee assessed under provisions of TABLE 3-A of the Uniform Building Code - \$30.00 EACH	30.00 each	
	Inspections for which no fees specifically indicated (minimum charge - one-half hour)	30.00 per hour	
	Additional plan review required by changes, additions or revisions to approved plans (minimum charge - one-half hour). After work hours - \$30.00 per hour - minimum 1 hour.	30.00 per hour	
	Starter Permit	50.00	
CONTRACT PRICE OR COST OF INSTALLATION			
	Commercial - Burglar Alarms		
	- Music Systems		
	- Data Processing		
	- Communication		
	Conduit Only - Contract Price		
	All Misc. Electric		

Electrical permit fees may be computed the same as building permit fees by using the cost of installation for valuation amount when such work is not included in the above schedule.

RECEIPT
0884
ELEC 16.00
CHEK 16.00
8450A000 15:55

2310-2402 11/29/88

I hereby certify that I have carefully examined and read the above application; that the same is true and correct; and that the work herein described is to be done in accordance with all the provisions of the applicable Ordinances of the City of Las Vegas, Nevada and the State Laws, whether herein specified or not.

SIGNED John P. Brennan OWNER, CONTRACTOR
BUILDING DEPT. DATE 11/29/88
PERMIT FEE 16.00
LESS STARTER PERMIT _____
TOTAL FEES _____
Permit Expires 180 Days After Abandonment of Work

PERMIT NO. _____
MUST BE MACHINE VALIDATED

Abbie Inghram 12-15-88

^{ORRS}
BUILDING DEPARTMENT
CITY OF LAS VEGAS
Complete

CORRECTION NOTICE

Job Located at 4509 Halbert

I have this day inspected this structure and these premises and have found the following violations of City and/or State laws governing same:

- ① Dead front not secured
- ② Dead front has numerous boards missing

Comply by 12-2-88

You are hereby notified to correct above violation and call for re-inspection.

Date 11-30-88 *[Signature]*
Inspector

23.03 Do not remove this tag!

Debbie Ingraham 2-28-89

ELEC. ONLY PLBG. ONLY, A.C. ONLY		
OWNER	<i>Kay-mac Const.</i>	DATE <i>1/29/89</i>
ADDRESS	<i>4509 Halbert</i>	
CONTRACTOR	PERMIT NO.	FINAL INSPECTION
LOT	BLOCK	SUBDIVISION
LOG NO.	AREA <i>Pool</i>	
ELECTRIC ONLY		PLUMBING ONLY
Contractor <i>Complete Elec.</i>	Contractor	
Permit No. <i>8450</i>	Permit No.	
Rough Elec.	Rough Soil	
Final Rough	Rough Water	
Final Elec. <i>32046 RS 12/6/88</i>	Top Out	
Temp. Service	Rough Gas	
HEAT & VENT. A/C ONLY	Final Plbg.	
Contractor	Final Gas	
Permit No.	Sewer Final	
A/C Rough Duct		
Rough Gas		
Final A/C		
Final Gas		

79-2-15 (811-81) DEPT. OF BLDG. & SAFETY
CITY OF LAS VEGAS

Debbie Ingram 10-9-86

2

CITY OF LAS VEGAS, NEVADA

LOG NO. & AREA I-72 DATE 9/18/86 CONST. VAL. \$ 25,000

DEPARTMENT OF BUILDING AND SAFETY PHONE 386-6251
ADDRESS OF CONSTRUCTION 4517 HALBERT AVE OWNER BONANZA LAMB LTD PHONE NO. 870-4922
LOT(s) 6 BLOCK C SUBDIVISION BOULDER HEIGHTS ADDITION I ZONE RI

PROPOSED CONSTRUCTION CONCRETE & FRAME USE _____
THIS PERMIT FOR BLDG. AC ELEC. PLBG. OTHER PERMITS RECD.: FENCE OFF SITE SWIM POOL

FLOOR AREA BSMT _____ 1ST 920 2ND _____ GARAGE _____ PORCH _____ TOTAL 920
CONTRACTOR RODIUS THOMAS DEVELOPMENT INC STATE LICENSE NO. 0024001 CITY LICENSE NO. C11 02162 2

ARCHITECT _____ ENGINEER JOHN VEGA MASTER ELECTRICIAN/CONTRACTOR _____
MASTER PLUMBER/CONTRACTOR _____

OTHER INSPECTIONS AND FEES

1. Inspections outside of normal business hours = \$30.00 per hour (minimum charge three hours).
2. Re-inspection fee during normal business hours assessed under provisions of TABLE 3-A of the Uniform Building Code = \$30.00 per hour.
3. Inspections during normal business hours for which no fee is specifically indicated = \$30.00 per hour (minimum charge one half hour).
4. Additional plan review required by changes, additions of revisions to approved plans = \$30.00 per hour (minimum charge two hours).

CONDITIONS OF THE PERMIT:

1. I agree to call the City Building Department for inspections before concrete is poured, before rough wiring, electrical, plumbing, framing is covered. Also for air conditioning, drywall and sheathing inspection.
2. I agree that when the job is completed that I will call for final inspection before occupancy.
3. I agree to perform all construction in accordance with City Ordinances and Building Codes.
4. The Contractor's signature below denotes authority from the owner to sign in his behalf and that the owner is aware of all requirements of this application and permit. Separate permits must be taken out for work outlined above this agreement.
5. I have read and understand the contents of this application and permit; I hereby state that the information I have supplied on this application is true and correct.
6. Approval for the work under this permit will be given only after refuse and debris have been removed from job site and public right of way.
7. 24 HOUR MINIMUM NOTICE REQUIRED FOR INSPECTIONS.

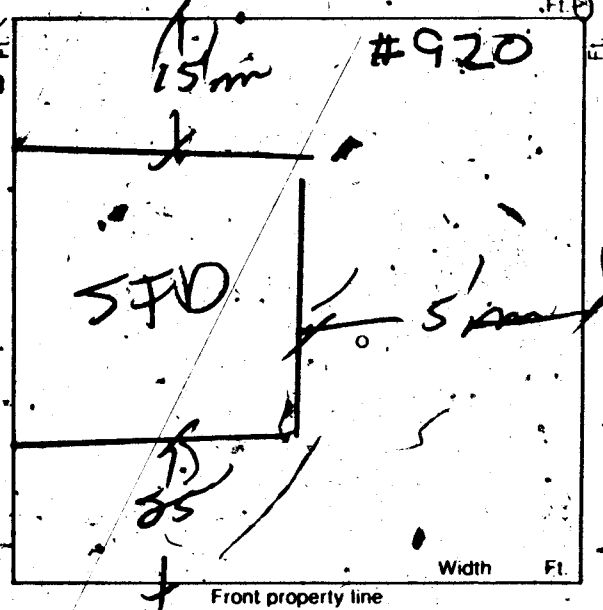

BY: RODIUS THOMAS DEVELOPMENT CO INC OWNER
I HEREBY DECLARE THAT I AM THE LEGAL OWNER OF THE ABOVE PROPERTY.

BY: EDWARD A THOMAS, PRES AGENT

I hereby certify that I have reviewed this application and the proposed plans and have found that the proposed development meets the requirements of the City of Las Vegas Flood Hazard Reduction Ordinance for the issuance of this Development Permit.

Charles Stark 9/19/86
LAND DEVELOPMENT AND FLOOD CONTROL ENGINEER DATE

[Signature] 9/19/86
PLANNING DEPT DATE

[Signature] 9/22/86
BUILDING DEPT DATE

PLUMBING		FEE	ELECTRICAL		FEE
WATER DISTRIBUTION	6.00		RECEPTACLE	SWITCH	40
SEWER SYSTEM - NEW OR MODIFICATION	10.00		EACH LIGHT FIXTURE OR SOCKET		30
FIXTURES - WATER SOFTENER, H.W. HEATER	2.00		SPECIAL OUTLET, APPLIANCE ETC.		70
GARBAGE DISPOSAL - WASHER	2.00		SERVICE/PANEL - SUB/3.00 - 200A/6.00 - 400A/12.50		
FUEL PIPING	6.00		A.C. UNIT OR MOTORS		3.00
IRRIGATION SYSTEM	8.00		2310 - 2402	TOTAL	
MISC.			MISC.		
2310 - 2403			2310 - 2401 ISSUANCE FEE		
TOTAL			7114 - 3654 SEWER CONNECTION		500.00
AIR CONDITIONING		FEE	2310 - 2401 PLAN REVIEW FEE		
NEW UNIT - 3 TON = 7.00 OVER = 16.50			2310 - 2401 BLDG. PERMIT FEE		71.00
FURNACE TO 100,000/9.00 OVER/11.00			TOTAL FEES		671.00
VAPORATIVE COOLER	0.50				
VENTILATION FAN	2.35				
2310 - 2405					
TOTAL					

RECEIVED 04/11/86
SEWR 9000.00
SFD 3347.00
CHK 12347.00
1541A000 13:44

PERMIT NO. _____
MUST BE MACHINE VALIDATED

Permit Expires 180 Days After Abandonment of Work

Debbie Ingraham 10-15-86

Debbie Ingraham 10-14-86

CITY OF LAS VEGAS, NEVADA

LOG NO. & AREA _____ DATE _____ CONST. VAL. \$ _____

DEPARTMENT OF BUILDING AND SAFETY
PHONE 386-6251 4517

PLUMBING PERMIT

ADDRESS OF CONSTRUCTION 4507 Halbert OWNER Bonanza Lamb Ltd. PHONE 870-4922

CONTRACTOR CDM Plumbing STATE LICENSE NO. 0023392 CITY LICENSE NO. 01835-2-028475

LOT(S) 6 BLOCK C SUBDIVISION Boulder Heights Addn I ZONE R-1

PROPOSED CONSTRUCTION: PLUMBING PERMIT NO. 1701 USE: _____

Approval for the work under this permit will be given only after refuse and debris have been removed from job site and public right of way.

UNITS	DESCRIPTION	FEE	TOTAL
PERMIT ISSUANCE			
1	For Issuing Each Permit	10.00	10.00
	For Issuing Each Supplemental Permit	4.50	
FIXTURE CHARGE			
6	Bathtub, Shower, Lavatory, Toilet, Urinal	EA. 2.00	12.00
	Floor Drain, Floor Sink, Wash Tray, Sink	EA. 2.00	
2	Garbage Disposal, Clothes Washer, Dishwasher (residential)	EA. 2.00	4.00
	Garbage Disposal (commercial)	EA. 8.00	
	Clothes Washer, Dishwasher (commercial)	EA. 2.00	
	Clothes Dryer (gas) (venting)	2.00	
	Dental Unit	8.00	
	Drinking Fountain	2.00	
	Refrigerator - Ice Maker, Water Dispenser	2.00	
	Any other water using equipment, Attached Coffee Makers, Ice Makers	2.00	
1	Hot Water Heater (Gas or Electric)	EA. 2.00	2.00
SEWER SYSTEM			
1	New, Replacement, Modification, or Any Drainage Work	10.00	10.00
	Grease or Sand Trap or Interceptor	2.00	
	Trailer Trap (rental parks)	5.00	
WATER SOFTENERS			
	Non Permanent Type (rental)	2.00	
	Permanent Type (connected to drain)	2.00	
WATER DISTRIBUTION SYSTEM			
1	Single Family Dwelling	6.00	6.00
	Multi-Family Dwelling	6.00	
	Plus Each Dwelling Unit	3.00	
	Commercial Building per floor	3.00	
	Plus Each Unit (leased space or office)	2.00	
	Hotel or Motel	8.00	
	Plus Each Unit	3.00	
	Trailer Park	30.00	
	Plus Each Space	2.00	
	Irrigation Single Family Dwelling	8.00	
	Irrigation Commercial Fee Based on Building Code Valuation Chart Construction Valuation		

UNITS	DESCRIPTION	FEE	TOTAL
FUEL PIPING SYSTEM			
	Single Family Dwelling	6.00	
	Multi-Family Dwelling	10.00	
	Plus Each Unit	2.00	
	Commercial Building (per floor)	6.00	
	Plus Each Unit (leased space or office)	6.00	
	Medium Pressure System (San Check)	12.00	
	Each Gas Appliance (Any Type)	2.00	
	Steam Boilers	5.00	
SOLAR ENERGY SYSTEMS			
	Collectors (including piping) (per collector)	5.00	
	Storage Tanks (each)	5.00	
PIPELINE CONTRACT			
	For Onsite Sewer, Gas or Water Contract Value. Fee based on Building Code Permit Valuation Chart.		
OTHER INSPECTIONS AND FEES:			
	Inspection outside of normal business hours (minimum charge—three hours)	25.00 per hour	
	Under provisions of Table 3-A of the Uniform Building Code, work which has been inspected once and not approved may be subject to a Reinspection Fee not less than \$30.00 per each inspection during business hours.	30.00 each	
	Additional plan review required by changes, additions to or revisions to approved plans (minimum charge two hours).	30.00 per hour	
	Plumbing permit fees may be computed the same as building permit fees by using the cost of installation for valuation amount when such work is not included in the above schedule.		
	Construction Valuation		

I hereby certify that I have carefully examined and read the above application, that the same is true and correct, and that the work herein described is to be done in accordance with all the provisions of the applicable Ordinances of the City of Las Vegas, Nevada and the State Laws, whether herein specified or not.

SIGNED Michael H. Totten CONTRACTOR MASTER CARD NO. 138

BY P. Alfano Registered Master Plumber, Spec. Contr. or Owner DATE 10-10-86

3/83 PERMIT EXPIRES 180 DAYS AFTER ABANDONMENT OF WORK

SEWER # 7114-3654 CONNECTION

FIXTURES X

FEE _____ DATE 10/10/86

2310-2403 PERMIT FEE _____

TOTAL FEES 44.00

RECEIPT

0005

ELEC 792.00

VOID

ELEC -792.00

PLBG 792.00

CHEK 792.00

1701A000 11:21

PERMIT NO. _____

MUST BE MACHINE VALIDATED

Albee Ingram 4-20-86

CITY OF LAS VEGAS, NEVADA

LOG NO. & AREA _____ DATE _____ CONST. VAL. \$ _____

DEPARTMENT OF BUILDING AND SAFETY
PHONE 386-6251

AIR CONDITIONING PERMIT

ADDRESS OF CONSTRUCTION 4517 Halbert Avenue OWNER _____ PHONE _____

CONTRACTOR Valley Air Conditioning STATE LICENSE NO. 0014018 CITY LICENSE NO. 18140

LOT(S) _____ BLOCK _____ SUBDIVISION _____ ZONE _____

PROPOSED CONSTRUCTION: _____ USE: _____
AIR COND. PERMIT NO. 2840 -2

UNITS	DESCRIPTION	FEE	TOTAL
PERMIT ISSUANCE			
1	For the issuance of each permit	15.00	15.00
	For issuing each supplemental permit	4.50	
UNIT FEE SCHEDULE			
	For the installation or relocation of each forced-air or gravity-type furnace or burner, including ducts and vents attached to such appliance, up to and including 100,000 Btu/h.	9.00	
	For the installation or relocation of each forced-air or gravity-type furnace or burner, including ducts and vents attached to such appliance over 100,000 Btu/h.	14.00	
	For the installation or relocation of each floor furnace, including vent.	9.00	
	For the installation or relocation of each suspended heater, recessed wall heater or floor-mounted unit heater.	9.00	
	For the installation, relocation or replacement of each appliance vent installed and not included in an appliance permit.	4.50	
	For the repair of, alteration of, or addition to each heating appliance, refrigeration unit, cooling unit, absorption unit, or each heating, cooling, absorption, or evaporative cooling system, including installation of controls regulated by this code.	9.00	
1	For the installation or relocation of each boiler or compressor to and including three horsepower, or each absorption system to and including 100,000 Btu/h.	9.00	9.00
	For the installation or relocation of each boiler or compressor over three horsepower to and including 15 horsepower, or each absorption system over 100,000 Btu/h and including 500,000 Btu/h.	16.50	
	For the installation or relocation of each boiler or compressor over 15 horsepower to and including 30 horsepower, or each absorption system over 500,000 Btu/h to and including 1,000,000 Btu/h.	22.50	
	For the installation or relocation of each boiler or compressor over 30 horsepower to and including 50 horsepower, or for each absorption system over 1,000,000 Btu/h to and including 1,750,000 Btu/h.	33.50	
	For the installation or relocation of each boiler or refrigeration compressor over 50 horsepower, or each absorption system over 1,750,000 Btu/h.	56.00	

Approval for the work under this permit will be given only after refuse and debris have been removed from job site and public right of way.

UNITS	DESCRIPTION	FEE	TOTAL
	For each air-handling unit to and including 10,000 cubic feet per minute, including ducts attached thereto. <i>Note: This fee shall not apply to an air-handling unit which is a portion of a factory-assembled appliance, cooling unit, evaporative cooler or absorption unit for which a permit is required elsewhere in this code.</i>	6.50	
	For each air-handling unit over 10,000 cfm.	11.00	
	For each evaporative cooler other than portable type.	6.50	
	For each ventilation fan	COMMERCIAL 4.50 RESIDENTIAL 2.35	
	For each ventilation system which is not a portion of any heating or air-conditioning system authorized by a permit.	6.50	
	For the installation of each hood which is served by mechanical exhaust, including the ducts for such hood.	6.50	
	For each appliance or piece of equipment regulated by this code but not classed in other appliance categories, or for which no other fee is listed in this code.	6.50	
OTHER INSPECTIONS AND FEES:			
	Inspections outside of normal business hours (minimum charge — three hours)	25.00 per hour	
	Reinspection fee assessed under provisions of TABLE 3-A of the Uniform Building Code = \$15.00 EACH	15.00 each	
	Inspections for which no fee is specifically indicated (minimum charge — one-half hour)	30.00 per hour	
	Additional plan review required by changes, additions or revisions to approved plans (minimum charge — two hours)	30.00 per hour	
	Mechanical permit fees may be computed the same as building permit fees by using the cost of installation for valuation amount when such work is not included in the above schedule.		

2310-2405

RECEIPT

I hereby certify that I have carefully examined and read the above application; that the same is true and correct; and that the work herein described is to be done in accordance with all the provisions of the applicable Ordinances of the City of Las Vegas, Nevada and the State Laws, whether herein specified or not.

Valley Air Conditioning
 SIGNED Robert Meyer CONTRACTOR MASTER CARD NO. _____
 BY R. Adams Spec. Cont. or Owner
 _____ DATE 11-18-86
 _____ BUILDING DEPT.

PERMIT FEE 24.00
 TOTAL FEES _____

MUST BE MACHINE VALIDATED

Expires 180 Days After Abandonment of Work

Debbie Ingram 12-11-86

922

CITY OF LAS VEGAS, NEVADA

LOG NO. & AREA _____ DATE _____ CONST. VAL \$ _____

DEPARTMENT OF BUILDING AND SAFETY

PHONE 386-6251
ADDRESS OF CONSTRUCTION 4517 MacBERT

ELECTRICAL PERMIT

OWNER: Pioneer Land Co PHONE _____

CONTRACTOR: Classic Electric STATE LICENSE NO. 21311 CITY LICENSE NO. 25554

LOT(s) _____ BLOCK _____ SUBDIVISION _____ ZONE _____

PROPOSED CONSTRUCTION: _____ USE: _____

ELECTRIC PERMIT NO. 3311

Approval for the work under this permit will be given only after refuse and debris have been removed from job site and public right of way.

UNITS	DESCRIPTION	FEE	TOTAL
PERMIT ISSUANCE			
1	For Issuing Each Permit	10.00	10.00
	Supplemental Fee	4.50	
APPLIANCE CHARGE			
Residential or General Commercial			
40	Receptacle _____ Switch _____	.40	16.00
7	Each Light Fixture, Socket, or Exit Light	.30	2.10
18	EACH OUTLET FOR Special Purpose: Dishwasher, Garbage Grinder, Trash Compactor, G.F.I., Clothes Washer, Dryer, Electric Range, Ovens, Smoke Detector, Water Heater, Space Heater, Blast Coil Heater (PER K/W), Mercury Lamp, Quartz Lamp, Sodium Lamp, Exhaust Fans, 20 AMP Single Circuit Sign.	.70	12.60
	X-Ray Unit	10.00	
	Area Lighting (First 3,000 Watts)	8.00	
	Each Additional 1,000 Watts	3.00	
MOTORS (1/2 H.P. AND OVER) TRANSFORMERS, ELEVATORS, WELDERS, GENERATORS, CHILLERS, AND SIGNS			
	First H.P. For each Unit	3.00	
	First KVA For Each Unit	3.00	
	Each Additional H.P. or KVA up to 50	.50	
	Each Additional H.P. or KVA over 50	.35	
	Temporary power or Pole	6.00	
ELECTRIC SERVICE OR MAIN DISCONNECT			
1	Up to 200 AMP	6.00	6.00
	400 AMP And 600 AMP	12.50	
	Over 600 AMP To 1200 AMP	25.00	
	Over 1200 AMP	50.00	
	Each Additional Meter Socket	.50	
	Sub Panel or Motor Control Center (Ea.)	3.00	
	Swimming Pool (Residential)	20.00	
	Swimming Pool (Semi-Public)	30.00	
	Spas	8.00	
	Recreational Vehicle Spaces (Each)	3.00	

UNITS	DESCRIPTION	FEE	TOTAL
	Busways-Trolley or Plug-in (Ea. 100 Ft.)	3.00	
	Gas Pumps (Ea.)	3.00	
1	Permanent A/C Unit (Pkg. Units)	3.00	3.00
	Each Air Handler	1.00	
RESIDENTIAL LOW VOLTAGE INSTALLATIONS			
	Speaker Outlets (Each)	.30	
	Signal or Alarm Outlets (Each)	.30	
	Amplifiers	2.00	
	Control Panel	.50	
	TV Master System	.30	
4	Telephone or Computer Outlet	.30	1.20
OTHER INSPECTIONS AND FEES: INCLUDES ISSUANCE FEES WHEN APPLICABLE			
	Inspections outside of normal business hours (minimum charge - three hours)	25.00	per hour
	Reinspection fee assessed under provisions of TABLE 3-A of the Uniform Building Code = \$30.00 EACH.	30.00	each
	Inspections for which no fee is specifically indicated (minimum charge - one-half hour).	30.00	per hour
	Additional plan review required by changes, additions or revisions to approved plans (minimum charge - one-half hour). After work hours - \$30.00 per hour - minimum 1 hour.	30.00	per hour
	Starter Permit	50.00	
CONTRACT PRICE OR COST OF INSTALLATION			
	Commercial - Burglar Alarms		
	- Music Systems		
	- Data Processing		
	- Communication		
	Conduit Only - Contract Price		
	All Misc. Electric		

I hereby certify that I have carefully examined and read the above application; that the same is true and correct; and that the work herein described is to be done in accordance with all the provisions of the applicable Ordinances of the City of Las Vegas, Nevada and the State Laws, whether herein specified or not.

SIGNED: [Signature] CARD NO. _____

D.S. 12.9.86 BUILDING DEPT. DATE

PERMIT EXPIRES 180 DAYS AFTER ABANDONMENT OF WORK

Electrical permit fees may be computed the same as building permit fees by using the cost of installation for valuation amount when such work is not included in the above schedule.

2310-2402 12/09/86

RECEIPT

0004
ELEC 272.60
CHEK 272.60
3811A000 10:06

PERMIT FEE 445.00
LESS STARTER PERMIT
TOTAL FEES

PERMIT NO. _____
MUST BE MACHINE VALIDATED

Dillon Ingraham 6-23-87

OWNER	Bonanza Lamb	ADDRESS	4517 Halbert
DATE	10-6-86	GEN. CONT.	Rodius Thomas Dev
BUILD. TYPE	SFD	PERMIT No.	1541
LEGAL	L 6 B C Boulder Hqts #1	LOG No.	T-72
BUILDING		MECHANICAL	
Pt. Loc. & Ft. <input type="checkbox"/>		Plumbing Cont.	<i>COM. Pllby</i>
Location & Footing <input type="checkbox"/>	<i>TS 10-7-86</i>	Permit No.	<i>1701-11-14-86</i>
Stemwall <input type="checkbox"/>		A/C Cont.	<i>Willie Ann</i>
Concrete Slab Floor <input type="checkbox"/>	<i>TS 10-20-86</i>	Permit No.	<i>2840-2 Date 11-18-86</i>
Chimney Steel <input type="checkbox"/>	<i>TS 11-4-86</i>	Sewer Fee	<i>Rodius-Thomas</i>
Fireplace Footing <input type="checkbox"/>		Irrig. Cont.	
Vert. Steel Rivet <input type="checkbox"/>	<i>TS 11-4-86</i>	Permit No.	Date
Horiz. Steel Rivet <input type="checkbox"/>		Head C&T.	
Roof Sheathing <input type="checkbox"/>	<i>TS 12-9-86</i>	Permit No.	Date
Insulation <input type="checkbox"/>	<i>TS 12-16-86</i>	Rough Soil <input type="checkbox"/>	
Framing <input type="checkbox"/>	<i>DH 12-11-86</i>	Rough Water <input type="checkbox"/>	<i>AT 12-11-86</i>
Ext. Lath		Top-Out	<i>TS 12-8-86</i>
Ext. Scratch		Rough Gas	
Ext. Brown		A/C Rough Duct	<i>TS 12-10-86</i>
Drywall <input type="checkbox"/>	<i>TS 12-31-86</i>	Final Plumbing	<i>TS 1-28-87</i>
Final Building		Final Gas	
Apply for Occupancy Building		Final Air Cond.	<i>TS 1-28-87</i>
Siding <input type="checkbox"/>	<i>TS 1-4-87</i>	Final Sewer	
ELECTRICAL		Rough Head <input type="checkbox"/>	
Electrical Cont.	<i>Chas</i>	Final Head <input type="checkbox"/>	
Permit No.	<i>3311</i>	Final Irrig.	
PT Rough	<i>RS 12-10-86</i>		
Ground Electrode		ELECTRICAL	
Temporary Power		Temp. Pole C&T.	
Meter Tag	<i>13163</i>	Permit No.	Date
Final Electrical	<i>RS 1-27-87</i>	Inspection	Date

Debbie Ingram 10-9-86

CITY OF LAS VEGAS, NEVADA

LOG NO. & AREA T-72 DATE 9/18/86 CONST. VAL \$ 25,000

DEPARTMENT OF BUILDING AND SAFETY. **BUILDING PERMIT - FOR:** Single Family Dwelling, Remodel, Additions, Misc. Residential Construction

PHONE 386-0251 ADDRESS OF CONSTRUCTION 4521 HALBERT AVENUE OWNER BONANZA LAMB LTD PHONE NO. 870-4922

LOT(s) 7 BLOCK C SUBDIVISION BOULDER HEIGHTS ADDITION I ZONE RI

PROPOSED CONSTRUCTION CONCRETE & FRAME USE _____

THIS PERMIT FOR: BLDG. AC ELEC. PLBG. OTHER PERMITS REQD.: FENCE OFF SITE SWIM POOL

OR AREA BSMT _____ 1ST 920 2ND _____ GARAGE _____ PORCH _____ TOTAL 920

CONTRACTOR RODIUS-THOMAS DEVELOPMENT INC STATE LICENSE NO. 0024001 CITY LICENSE NO. C11 02162 2 0318

ARCHITECT _____ ENGINEER JOHN VEGA

MASTER PLUMBER/CONTRACTOR _____ MASTER ELECTRICIAN/CONTRACTOR _____

OTHER INSPECTIONS AND FEES

1. Inspections outside of normal business hours = \$30.00 per hour (minimum charge three hours)
2. Re-inspection fee during normal business hours assessed under provisions of TABLE 3-A of the Uniform Building Code = \$30.00 per hour
3. Inspections during normal business hours for which no fee is specifically indicated = \$30.00 per hour (minimum charge one half hour)
4. Additional plan review required by changes, additions or revisions to approved plans = \$30.00 per hour (minimum charge two hours)

CONDITIONS OF THE PERMIT:

1. I agree to call the City Building Department for inspections before concrete is poured, before rough wiring, electrical, plumbing, framing is covered. Also for air conditioning, drywall and sheathing inspection.
2. I agree that when the job is completed that I will call for final inspection before occupancy.
3. I agree to perform all construction in accordance with City Ordinances and Building Codes.
4. The Contractor's signature below denotes authority from the owner to sign in his behalf and that the owner is aware of all requirements of this application and permit. Separate permits must be taken out for work outlined above this permit.
5. I have read and understand the contents of this application and permit. I hereby state that the information I have supplied on this application is true and correct.
6. Approval for the work under this permit will be given only after refuse and debris have been removed from job site and public right of way.
7. 24 HOUR MINIMUM NOTICE REQUIRED FOR INSPECTIONS.

BY RODIUS-THOMAS DEVELOPMENT INC. OWNER

I HEREBY DECLARE THAT I AM THE LEGAL OWNER OF THE ABOVE PROPERTY.

BY EDWARD A. THOMAS, PRES. AGENT

I hereby certify that I have reviewed this application and the proposed plans and have found that the proposed development meets the requirements of the City of Las Vegas Flood Hazard Reduction Ordinance for the issuance of this Development Permit.

Charles Singh LAND DEVELOPMENT AND FLOOD CONTROL ENGINEER DATE 9/19/86

[Signature] PLANNING DEPT. DATE 9/19/86

[Signature] BUILDING DEPT. DATE 9/22/86

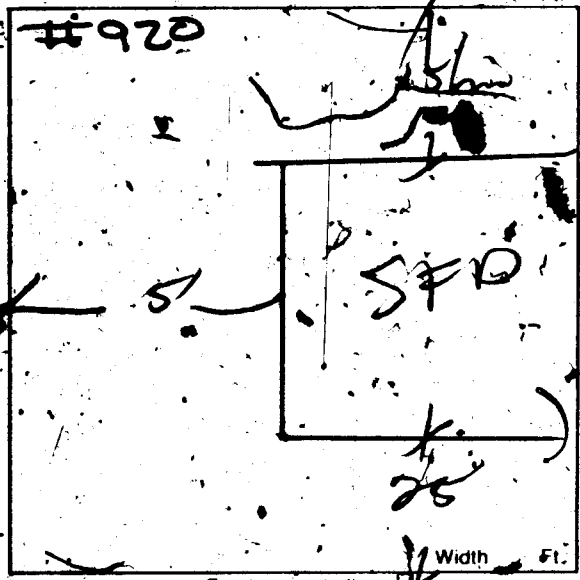

PLUMBING	FEE	ELECTRICAL	FEE
WATER DISTRIBUTION	9.00	RECEPTACLE SWITCH	.40
SEWER SYSTEM NEW OR MODIFICATION	10.00	EACH LIGHT FIXTURE OR SOCKET	.30
FIXTURES - WATER SOFTENER - H.W. HEATER	2.00	SPECIAL OUTLET, APPLIANCE ETC.	.70
GARBAGE DISPOSAL - WASHER	2.00	SERVICE/PANEL - SUB/3.00 - 200A/6.00 - 400A/12.50	
FUEL PIPING	6.00	A.C. UNIT OR MOTORS	3.00
VENTILATION SYSTEM	8.00	2310 - 2402	TOTAL
MISC.		MISC.	
2310 - 2403	TOTAL	2310 - 2401 ISSUANCE FEE	
AIR CONDITIONING	FEE	7114 - 3854 SEWER CONNECTION	<u>500.00</u>
NEW UNIT - 3 TON = 9.00 OVER = 16.50		2310 - 2401 PLAN REVIEW FEE	
FURNACE TO 00.00/9.00 OVER/11.00		2310 - 2401 BLDG. PERMIT	<u>171.00</u>
VAPORATIVE COOLER	6.50	TOTAL FEES	<u>671.00</u>
VENTILATION FAN	2.35		
2310 - 2405	TOTAL		

RECEIPT

PERMIT NO. _____

MUST BE MACHINE VALIDATED

Permit Expires 180 Days After Abandonment of Work

Debbie Ingham 10-15-86

Debbie Ingham 10-14-86

CITY OF LAS VEGAS, NEVADA

LOG NO. & AREA _____ DATE _____ CONST. VAL. \$ _____

DEPARTMENT OF BUILDING AND SAFETY

PLUMBING PERMIT

PHONE 386-6251 4521

ADDRESS OF CONSTRUCTION 4513 Halbert

OWNER Bonanza Lamb - Ltd.

PHONE 870-4922

CONTRACTOR Com Plumbing

STATE LICENSE NO. 0022392

CITY LICENSE NO. 01835-2-028475

LOT(S) 7 BLOCK C SUBDIVISION Boulder Heights Add I ZONE R-1

PROPOSED CONSTRUCTION:

USE:

PLUMBING PERMIT NO. 1701 -1

Approval for the work under this permit will be given only after refuse and debris have been removed from job site and public right of way.

UNITS	DESCRIPTION	FEE	TOTAL
PERMIT ISSUANCE			
1	For Issuing Each Permit	10.00	10.00
	For Issuing Each Supplemental Permit	4.50	
FIXTURE CHARGE			
6	Bathtub, Shower, Lavatory, Toilet, Urinal	EA. 2.00	12.00
	Floor Drain, Floor Sink, Wash Tray, Sink	EA. 2.00	
2	Garbage Disposal, Clothes Washer, Dishwasher (Residential)	EA. 2.00	4.00
	Garbage Disposal (commercial)	EA. 8.00	
	Clothes Washer, Dishwasher (commercial)	EA. 2.00	
	Clothes Dryer (gas) (venting)	2.00	
	Dental Unit	8.00	
	Drinking Fountain	2.00	
	Refrigerator - Ice Maker, Water Dispenser	2.00	
	Any other water using equipment, Attached Coffee Makers, Ice Makers	2.00	
1	Hot Water Heater (Gas or Electric)	EA. 2.00	2.00
SEWER SYSTEM			
1	New, Replacement, Modification, or Any Drainage Work	10.00	10.00
	Grease or Sand Trap or Interceptor	2.00	
	Trailer Trap (rental parks)	5.00	
WATER FIXTURES			
	Non Permanent Type (rental)	2.00	
	Permanent Type (connected to drain)	2.00	
WATER DISTRIBUTION SYSTEM			
1	Single Family Dwelling	6.00	6.00
	Multi-Family Dwelling	6.00	
	Plus Each Dwelling Unit	3.00	
	Commercial Building per floor	3.00	
	Plus Each Unit (leased space or office)	2.00	
	Hotel or Motel	8.00	
	Plus Each Unit	2.00	
	Trailer Park	30.00	
	Plus Each Space	2.00	
	Irrigation Single Family Dwelling	8.00	
	Irrigation Commercial Fee Based on Building Code Valuation Plans		
	Construction Valuation		

UNITS	DESCRIPTION	FEE	TOTAL
FUEL PIPING SYSTEM			
	Single Family Dwelling	6.00	
	Multi-Family Dwelling	10.00	
	Plus Each Unit	2.00	
	Commercial Building (per floor)	6.00	
	Plus Each Unit (leased space or office)	6.00	
	Medium Pressure System (Plan Check)	12.00	
	Each Gas Appliance (Any Type)	2.00	
	Steam Boilers	2.00	
SOLAR ENERGY SYSTEMS			
	Collectors (including piping) per collector	5.00	
	Storage Tanks (each)	5.00	
PIPELINE CONTRACT			
	For Onsite Sewer, Gas or Water Contract Value. Fee based on Building Code Permit Valuation Chart.		
OTHER INSPECTIONS AND FEES:			
	Inspections outside of normal business hours (minimum charge - three hours)	25.00 per hour	
	Under provisions of Table 3-A of the Uniform Building Code, work which has been inspected once and not approved may be subject to a reinspection fee not less than \$30.00 per each inspection during business hours.	30.00 each	
	Additional plan review required by changes, additions to or revisions to approved plans (minimum charge two hours)	30.00 per hour	
	Plumbing permit fees may be computed the same as building permit fees by using the cost of installation for valuation amount when such work is not included in the above schedule.		
	Construction Valuation		

I hereby certify that I have carefully examined and read the above application, that the same is true and correct, and that the work herein described is to be done in accordance with all the provisions of the applicable Ordinances of the City of Las Vegas, Nevada and the State Laws, whether herein specified or not.

SIGNED Michael R. Totton 138 CONTRACTOR MASTER CARD NO.

BY P Alfano 10-10-86 Registered Master Plumber, Spec. Contr. DATE

3/83 PERMIT EXPIRES 180 DAYS AFTER ABANDONMENT OF WORK

SEWER # 7114-3654 CONNECTION

FIXTURES X
FEE
2310-2403 PERMIT FEE
TOTAL FEES 244.00

RECEIPT
PERMIT NO.
MUST BE MACHINE VALIDATED

Debra Ingram 11-20-86

CITY OF LAS VEGAS, NEVADA

LOG NO. & AREA _____ DATE _____ CONST. VAL. \$ _____

DEPARTMENT OF BUILDING AND SAFETY
PHONE 386-6251

AIR CONDITIONING PERMIT

ADDRESS OF CONSTRUCTION 4521 Halbert Avenue OWNER _____ PHONE _____

CONTRACTOR Valley Air Conditioning STATE LICENSE NO. 0014018 CITY LICENSE NO. 18140

LQT(S) _____ BLOCK _____ SUBDIVISION Cool Valley Phase IV ZONE _____

PROPOSED CONSTRUCTION: AIR COND. 2840 -3 USE _____
PERMIT NO. 2840 -3

Approval for the work under this permit will be given only after refuse and debris have been removed from job site and public right of way.

UNITS	DESCRIPTION	FEE	TOTAL
PERMIT ISSUANCE			
1	For the issuance of each permit	15.00	15.00
	For issuing each supplemental permit	4.50	
UNIT FEE SCHEDULE			
	For the installation or relocation of each forced-air or gravity-type furnace or burner, including ducts and vents attached to such appliance, up to and including 100,000 Btu/h.	9.00	
	For the installation or relocation of each forced-air or gravity-type furnace or burner, including ducts and vents attached to such appliance over 100,000 Btu/h.	11.00	
	For the installation or relocation of each floor furnace, including vent.	9.00	
	For the installation or relocation of each suspended heater, recessed wall heater or floor-mounted unit heater.	9.00	
	For the installation, relocation or replacement of each appliance vent installed and not included in an appliance permit.	4.50	
	For the repair, alteration of, or addition to each heating appliance, refrigeration unit, cooling unit, absorption unit, or each heating, cooling absorption, or evaporative cooling system, including installation of controls regulated by this code.	9.00	
1	For the installation or relocation of each boiler or compressor to and including three horsepower, or each absorption system to and including 100,000 Btu/h.	9.00	9.00
2	For the installation or relocation of each boiler or compressor over three horsepower to and including 15 horsepower, or each absorption system over 100,000 Btu/h and including 500,000 Btu/h.	16.50	
	For the installation or relocation of each boiler or compressor over 15 horsepower to and including 30 horsepower, or each absorption system over 500,000 Btu/h to and including 1,000,000 Btu/h.	24.50	
	For the installation or relocation of each boiler or compressor over 30 horsepower to and including 50 horsepower, or for each absorption system over 1,000,000 Btu/h to and including 1,750,000 Btu/h.	33.50	
	For the installation or relocation of each boiler or refrigeration compressor over 50 horsepower, or each absorption system over 1,750,000 Btu/h.	56.00	

UNITS	DESCRIPTION	FEE	TOTAL
	For each air-handling unit to and including 10,000 cubic feet per minute, including ducts attached thereto. <i>Note: This fee shall not apply to an air-handling unit which is a portion of a factory-assembled appliance, cooling unit, evaporative cooler or absorption unit for which a permit is required elsewhere in this code.</i>	6.50	
	For each air-handling unit over 10,000 cfm.	11.00	
	For each evaporative cooler other than portable type.	6.50	
	For each ventilation fan	4.50	
		RESIDENTIAL 2.35	
	For each ventilation system which is not a portion of any heating or air-conditioning system authorized by a permit.	6.50	
	For the installation of each hood which is served by mechanical exhaust, including the ducts for such hood.	6.50	
	For each appliance or piece of equipment regulated by this code but not classed in other appliance categories, or for which no other fee is listed in this code.	6.50	
OTHER INSPECTIONS AND FEES:			
	Inspections outside of normal business hours (minimum charge — three hours)	25.00	per hour
	Reinspection fee assessed under provisions of TABLE 3-A of the Uniform Building Code = \$15.00 EACH	15.00	each
	Inspections for which no fee is specifically indicated (minimum charge — one-half hour).	30.00	per hour
	Additional plan review required by changes, additions or revisions to approved plans (minimum charge — two hours).	30.00	per hour
	Mechanical permit fees may be computed the same as building permit fees by using the cost of installation for valuation amount when such work is not included in the above schedule.		

I hereby certify that I have carefully examined and read the above application; that the same is true and correct; and that the work herein described is to be done in accordance with all the provisions of the applicable Ordinances of the City of Las Vegas, Nevada and the State Laws, whether herein specified or not.

Valley Air Conditioning
SIGNED _____ CONTRACTOR _____ MASTER CARD NO _____
BY Debra Ingram Spec. Cont. or Owner
BUILDING DEPT. 11-20-86 DATE

PERMIT FEE 24.00
TOTAL FEES _____

2310-2405

RECEIPT

Permit Expires 180 Days After Abandonment of Work

MUST BE MACHINE VALIDATED

927
Dennis Ingram 12-11-86

CITY OF LAS VEGAS, NEVADA

LOG NO. & AREA _____ DATE _____ CONST. VAL \$ _____

DEPARTMENT OF BUILDING AND SAFETY

ELECTRICAL PERMIT

PHONE 386-6251
ADDRESS OF CONSTRUCTION 4521 Harbor Dr. OWNER Barbara Lamb PHONE _____

CONTRACTOR CLASSIC ELECTRIC STATE LICENSE NO. 21311 CITY LICENSE NO. 25554

LOT(s) _____ BLOCK _____ SUBDIVISION _____ ZONE _____

PROPOSED CONSTRUCTION: _____ USE: _____

ELECTRIC PERMIT NO. 3311 -1

Approval for the work under this permit will be given only after refuse and debris have been removed from job site and public right of way.

UNITS	DESCRIPTION	FEE	TOTAL
PERMIT ISSUANCE			
1	For Issuing Each Permit	10.00	10.00
1	Supplemental Fee	4.50	4.50
APPLIANCE CHARGE			
Residential or General Commercial			
40	Receptacle	.40	16.00
9	Each Light Fixture, Socket, or Exit Light	.30	2.70
8	EACH OUTLET FOR Special Purpose: Dishwasher, Garbage Grinder, Trash Compactor, G.E.I. Clothes Washer, Dryer, Electric Range, Ovens, Smoke Detector, Water Heater, Space Heater, Blast Coil Heater (PER K.W.), Mercury Lamp, Quartz Lamp, Sodium Lamp, Exhaust Fans, 20 AMP Single Circuit Sign.	.70	5.60
	X-Ray Unit	10.00	
	Area Lighting (First 3,000 Watts)	8.00	
	Each Additional 1,000 Watts	3.00	
MOTORS (1/2 H.P. AND OVER) TRANSFORMERS; ELEVATORS, WELDERS, GENERATORS, CHILLERS, AND SIGNS			
	First H.P. For each Unit	6.00	
	First KVA For Each Unit	3.00	
	Each Additional H.P. or KVA up to 50	.50	
	Each Additional H.P. of KVA over 50	.35	
	Temporary power or Pole	6.00	
ELECTRIC SERVICE OR MAIN DISCONNECT			
1	Up to 200 AMP	6.00	6.00
	300 AMP And 600 AMP	12.50	
	Over 600 AMP To 1200 AMP	25.00	
	Over 1200 AMP	50.00	
	Each Additional Meter Socket	.50	
	Sub Panel or Motor Control Center (Ea.)	3.00	
1	Swimming Pool (Residential)	20.00	
	Swimming Pool (Semi-Public)	30.00	
	Spas	8.00	
	Recreational Vehicle Spaces (Each)	3.00	

UNITS	DESCRIPTION	FEE	TOTAL
	Busways-Trolley or Plug-In (Ea. 100 Ft.)	3.00	
	Gas Pumps (Ea.)	3.00	
1	Permanent A/C Unit (Pkg. Units)	3.00	3.00
	Each Air Handler	1.00	
RESIDENTIAL LOW VOLTAGE INSTALLATIONS			
	Speaker Outlets (Each)	.30	
	Signal or Alarm Outlets (Each)	.30	
	Amplifiers	2.00	
	Control Panel	.50	
	TV Master System	.30	
4	Telephone or Computer Outlet	.30	1.20
OTHER INSPECTIONS AND FEES: INCLUDES ISSUANCE FEES WHEN APPLICABLE			
	Inspections outside of normal business hours (minimum charge - three hours)	25.00 per hour	
	Reinspection fee assessed under provisions of TABLE 3-A of the Uniform Building Code - \$30.00 EACH	30.00 each	
	Inspections for which no fee is specifically indicated (minimum charge - one-half hour)	30.00 per hour	
	Additional plan review required by changes, additions or revisions to approved plans (minimum charge - one-half hour). After work hours - \$80.00 per hour - minimum 1 hour	30.00 per hour	
	Starter Permit	50.00	
CONTRACT PRICE OR COST OF INSTALLATION			
	Commercial - Burglar Alarms		
	- Music Systems		
	- Data Processing		
	- Communication		
	Conduit Only - Contract Price		
	All Misc. Electric		

I hereby certify that I have carefully examined and read the above application, that the same is true and correct, and that the work herein described is to be done in accordance with all the provisions of the applicable Ordinances of the City of Las Vegas, Nevada and the State Laws, whether herein specified or not.

Dennis Ingram
SIGNED BY HOMEOWNER, CONTRACTOR OR Q.I.

CARD NO. _____

D.S.
BUILDING DEPT.

12.9.86
DATE

PERMIT EXPIRES 180 DAYS AFTER ABANDONMENT OF WORK

Electrical permit fees may be computed the same as building permit fees by using the cost of installation for valuation amount when such work is not included in the above schedule.

2310-2402

RECEIPT

PERMIT FEE 49.50
LESS STARTER PERMIT _____
TOTAL FEES _____

PERMIT NO. _____
MUST BE MACHINE VALIDATED

Debra Ingerson 4-2-87

OWNER Bonanza Lamb		ADDRESS 4521 Halbert	
DATE 10-6-86		GEN. CONT. Rodius Thomas Dev	
BUILD. TYPE SFD		PERMIT No. 1541-1	
LEGAL L 7 B E Boulder Heights #1		LOG No. T-72	
BUILDING		MECHANICAL	
Pg Loc. & Ft. <input type="checkbox"/>		Plumbing Cont. Com Pdry.	
Location & Footing <input type="checkbox"/>	TS 10-7-86	Permit No. 1701-1	Date 10-10-86
Stemwall <input type="checkbox"/>		A/C Cont. Valley Air	
Concrete Slab Floor <input type="checkbox"/>	TS 10-2-86	Permit No. 2E40	Date 11-18-86
Chimney Steel <input type="checkbox"/>	TS 11-4-86	Sewer Fee	Rodius Thomas
Fireplace Footing <input type="checkbox"/>		Irrig. Cont.	
Vert. Steel Reinf. <input type="checkbox"/>	TS 11-4-86	Permit No.	Date
Horiz. Steel Reinf. <input type="checkbox"/>		Hood Coll.	
Roof Sheathing DD 12-9-86		Permit No.	Date
Insulation TS 12-16-86		Rough Soil <input type="checkbox"/>	
Framing DD 12-11-86		Rough Water <input type="checkbox"/>	
Ext. Lath		Top Out 12-2-86	
Ext. Scratch		Rough Gas	
Ext. Brown		A/C Rough Duct 12-10-86	
Drywall TS 12-31-86		Final Plumbing 12-3-87	
Final Building		Final Gas	
App. for Occu. Final Building		Final Air Cond. 1-6-3-87	
Subing 12-18-87		Final Sewer	
ELECTRICAL		ELECTRICAL	
Electrical Cont. Chamie Elec		Rough Hood <input type="checkbox"/>	
Permit No. 3311-1	Date 12-9-86	Final Hood <input type="checkbox"/>	
PT Rough 12-10-86		Final Irrig.	
Ground Electrode			
Temporary Power		Temp. Pole Cont.	
Meter Tag # 1530		Permit No.	Date
Final Electrical RS 3-3-87		Inspection	Date